

LAND FOR SALE
OCTOBER 2024

21010 OLD SCENIC HIGHWAY

ZACHARY, LA

stirling





PROPERTY DESCRIPTION

Investment opportunity at 21010 Old Scenic Highway, Zachary, LA, 70791. This property's prime location in the Zachary area makes it an appealing choice for land and other investors seeking potential for future development. With its strategic positioning, this property offers a promising opportunity for growth and expansion.

PROPERTY HIGHLIGHTS

- Strong Demographics
- .96 Acres
- Zoned CG (General Commercial)
- Flood Zone X
- Near the Church Street Intersection

OFFERING SUMMARY

Sale Price:	\$185,000
Lot Size:	0.96 Acres

DEMOGRAPHICS	1 MILE	3 MILES	5 MILES
Total Households	1,806	6,637	10,687
Total Population	5,182	18,635	29,651
Average HH Income	\$110,857	\$106,851	\$99,291

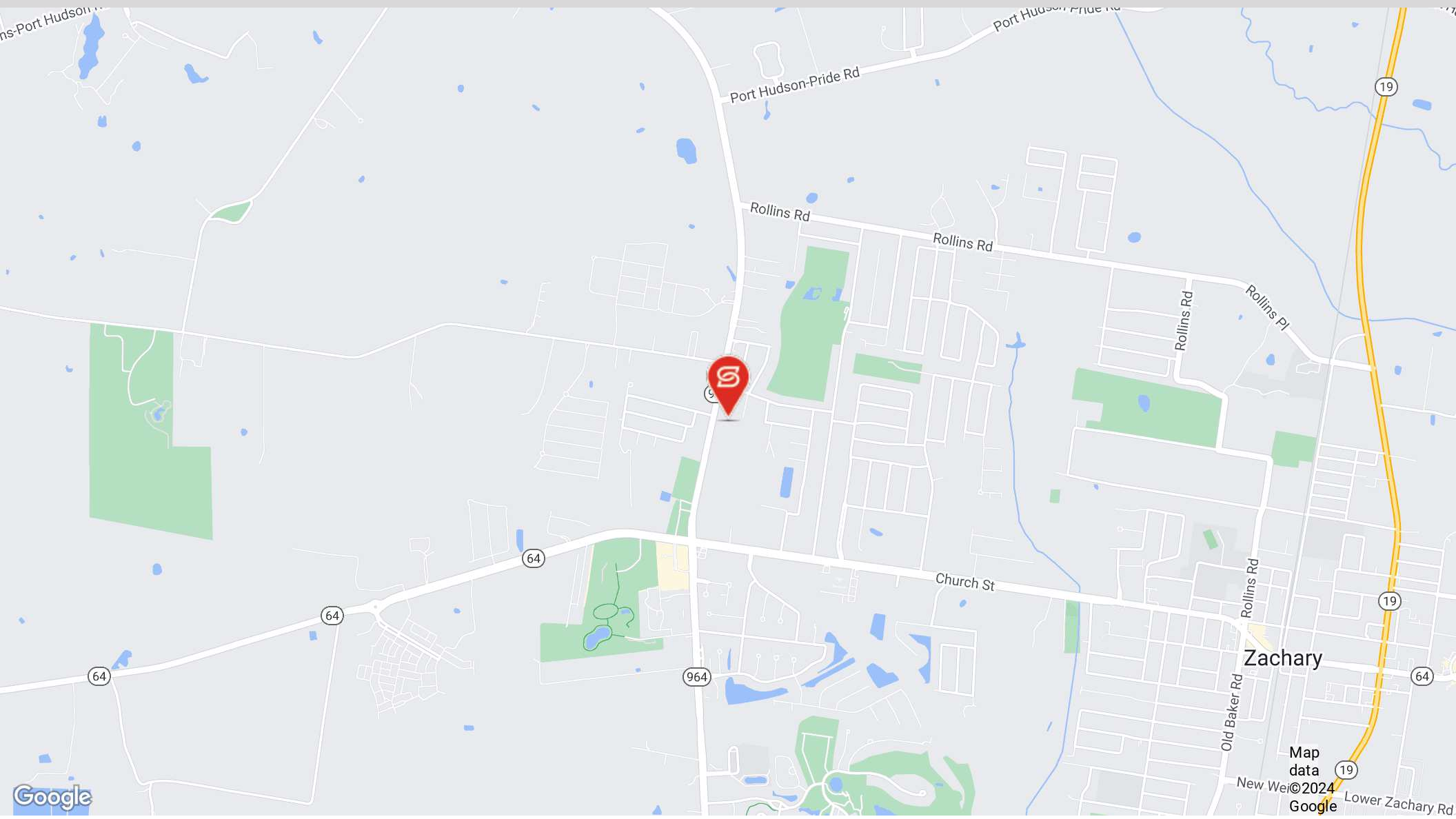

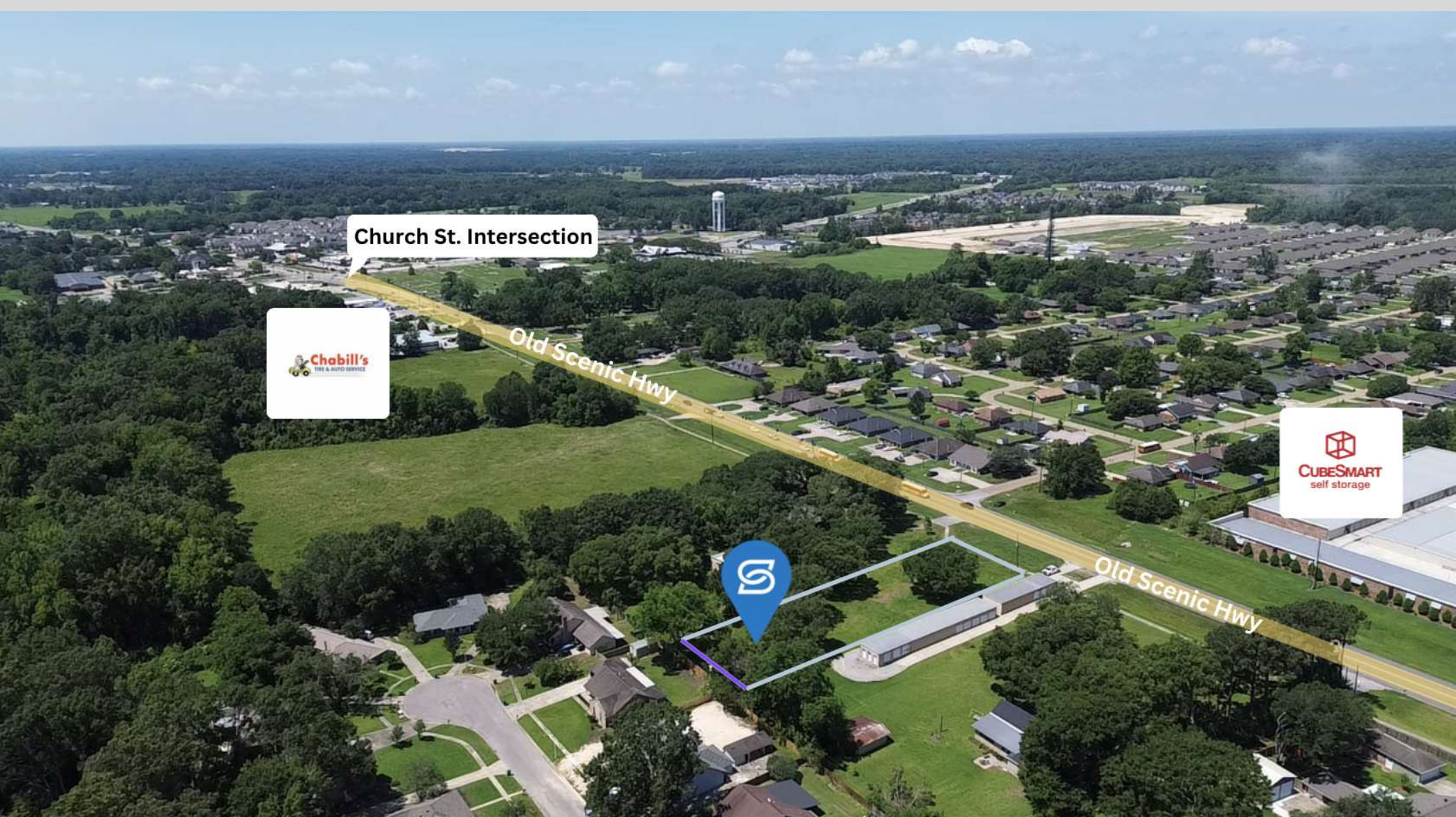

Church St. Intersection

Chabill's
TIRE & AUTO SERVICE

CUBESMART
self storage

JOHN DEARMOND

Licensed in LA

225.202.4649

jdearmond@stirlingprop.com

JUSTIN LANGLOIS, CCIM

Licensed in LA

225.329.0287

jlanglois@stirlingprop.com