

No. 999 08983
C.M.P. 1906 608

OAKLAND PLANTATION

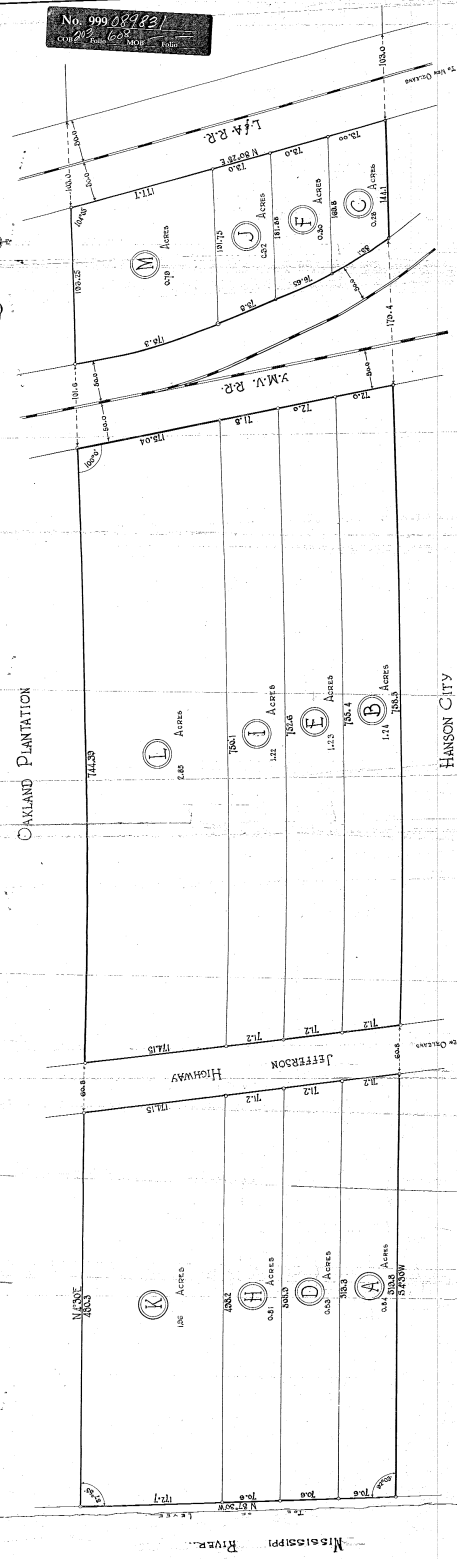

HANSON CITY

Original record on plat 1000 of the 1st of S.E. Quarter (117)
 Property located in Upper Hanson City, Jefferson County, Missouri, containing 124.2 Acres, more or less, being the S.E. 1/4 of S.E. 1/4 of Section 11, Township 15 S., Range 15 E., 3rd Meridian, State of Missouri.

A. J. Whelan, 1872

Survey 1000 of 1864

24. Cassava & Sons
 Surveyors