

REFLECTED CEILING PLAN LEGEND

- 5/8" GYPSUM BOARD CEILING
- 2X2 ACOUSTICAL SUSPENDED CEILING SYSTEM WITH 2X2 TILES
- 2X4 LED LAY-IN LIGHT FIXTURES
- 1X4 LED RECESSED LIGHT FIXTURE
- WALL SCONCE
- SWITCH
- PHOTO CELL
- EMERGENCY LIGHT
- EXIT LIGHT W/ BATTERY BACK-UP

FLOOR PLAN LEGEND

- ROOM NUMBER
- DOOR NUMBER
- WINDOW TYPE
- FIRE EXTINGUISHER CABINET WITH CLASS 2A.10PC 5 LB)
- ELECTRICAL PANEL

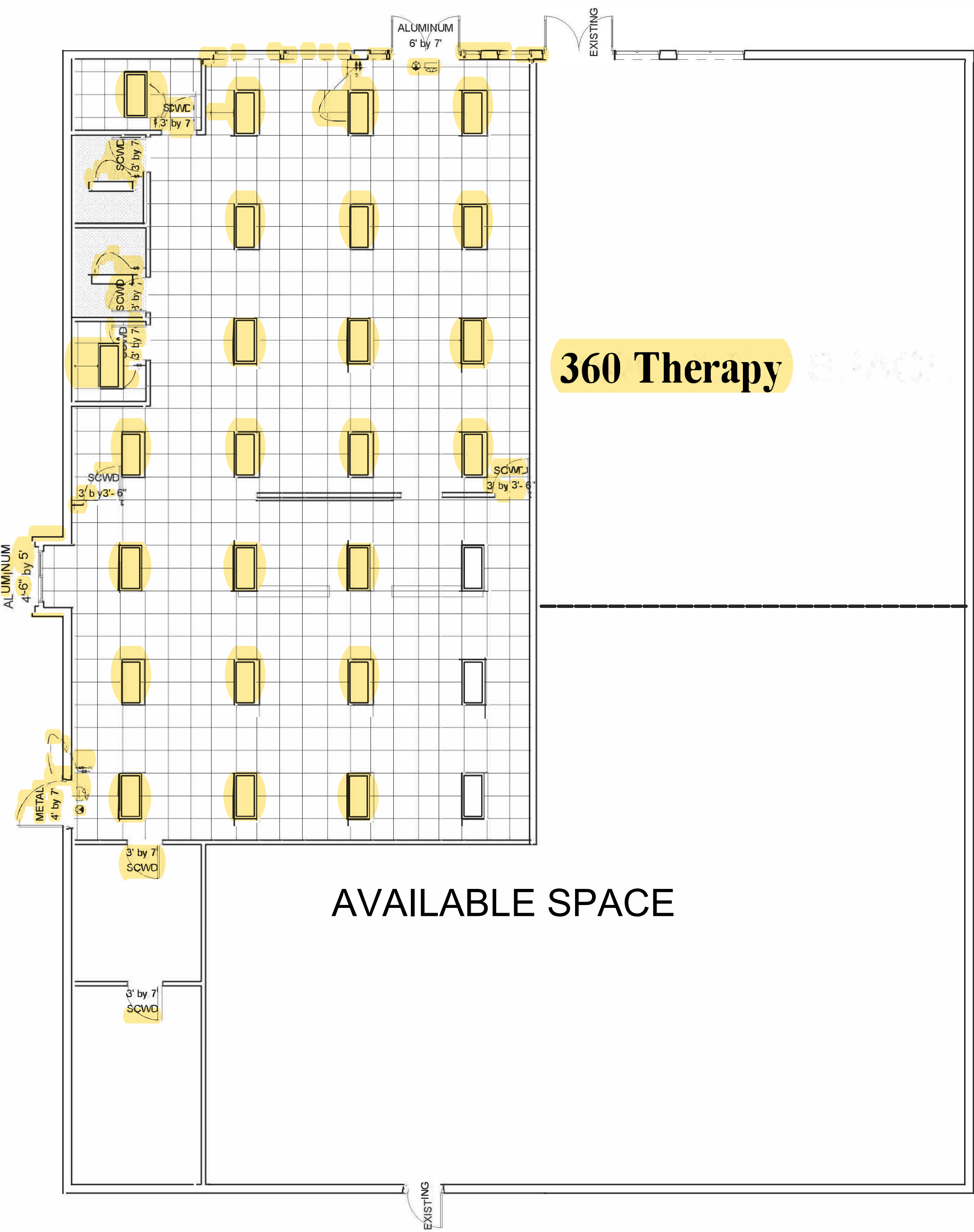

CEILING PLAN
SCALE: 1/8" = 1'-0"

ELECTRICAL INFORMATION

SERVICE: 120/240V, 1 PH., 3 W
MAIN: 200 AMP
ELECTRICAL CONTROLLER TO VERIFY
PANEL: FLUSH MOUNT, 42 CIRCUITS
CIRCUITRY SHALL BE AS SHOWN, AND VERIFIED BY ELECTRICAL CONTROLLER
NOTE: ALL SWITCHES SHALL BE LOCATED WITHIN 6" OF DOOR FRAME OR CORNER OF WALL. VERIFY ALL LOCATIONS WITH OWNER PRIOR TO INSTALLATION.
ALL SMOKE DETECTORS SHALL BE INTERCONNECTED WITH BATTERY BACK-UP AND CARBON MONOXIDE DETECTION
ALL EMERGENCY AND EXIT LIGHTING SHALL HAVE BATTERY BACK-UP - PER IBC 1006.3
ALL SWITCHES, CONTROLS, OUTLETS, ETC. SHALL BE MOUNTED PER ADA GUIDELINES.
PROVIDE FIRE-RATED BOXES AND SEAL AS REQ'D AT ALL RATED WALLS, TYPICAL
PROVIDE A 125V I/PH 1.5 OR 20A RECEPTACLE IN ACCESSIBLE LOCATION FOR HVAC SERVICE - LOCATE WITHIN 25' OF EQUIPMENT - CONNECT TO THE LOAD SIDE OF THE EQUIPMENT MEANS OF DISCONNECT

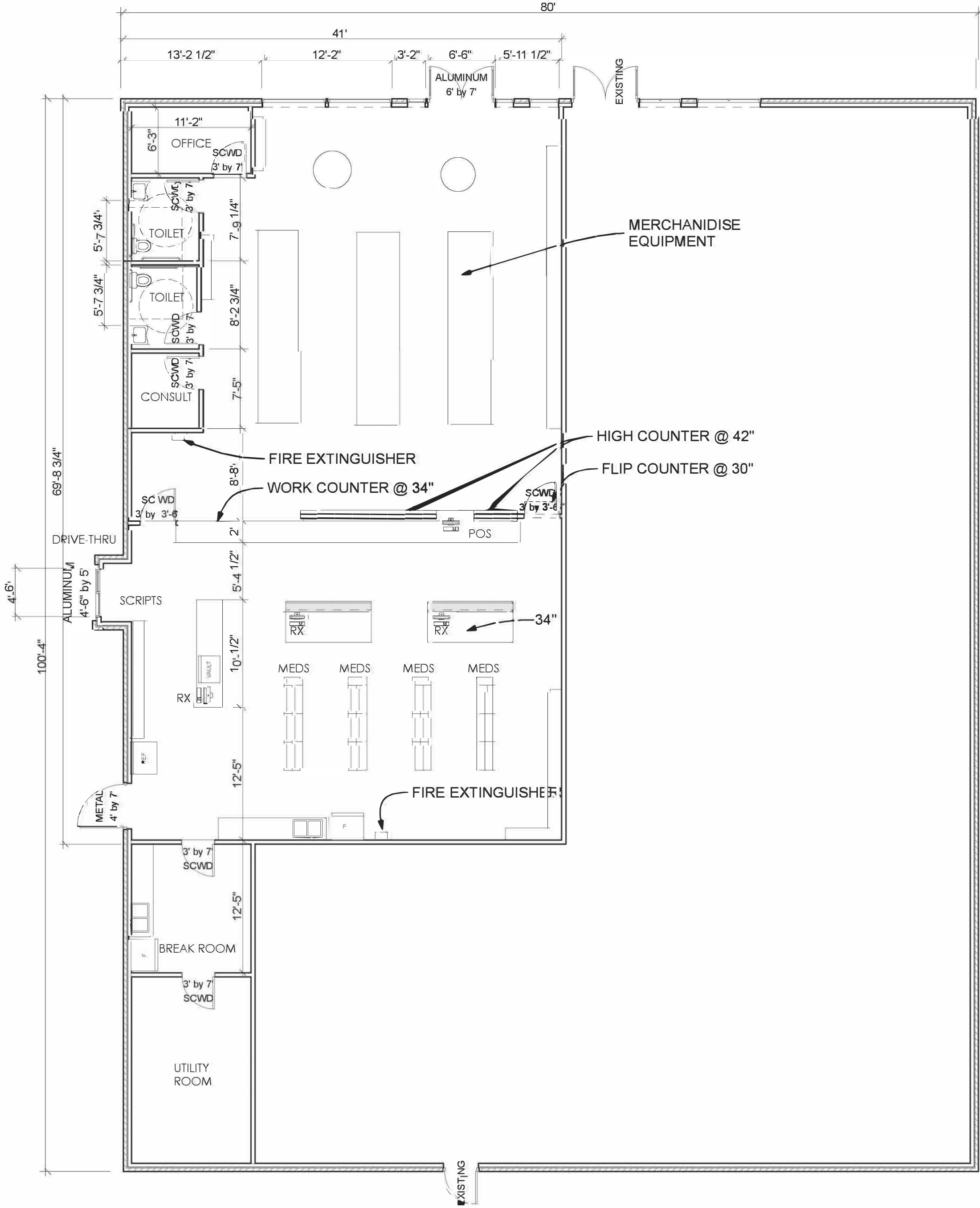

FLOOR PLAN
SCALE: 1/8" = 1'-0"