

SUMMARY

AERIAL

SITE PLAN

PHOTOS

DEMOGRAPHICS

FOR LEASE

AVAILABILITY

- Suite 3: 1,014 SF
- Suite 34: 1,154 - 2,308 SF
- Suite 44: 600 SF

HIGHLIGHTS

- Located on the highly-trafficked Veterans Memorial Blvd. across from the I-10 on- & off-ramps and popular Lafreniere Park.
- Co-tenants include HomeGoods, T.J.Maxx, Sandro's Trattoria, State Farm, FASTSIGNS, Thai Zapp Cafe, Pickleberry Kids, Allstate, Hibbett, and several others.

AREA DESCRIPTION

Anchored by the Southshore's first HomeGoods store and its partner T.J.Maxx, Lafreniere Plaza Shopping Center offers an excellent retail opportunity for both local and national tenants on the high-trafficked Veterans Memorial Boulevard.

The center is situated next to the Interstate 10-Veterans Blvd. on- and off-ramps and is walking distance to Metairie's popular Lafreniere Park. Join co-tenants HomeGoods, T.J.Maxx, Hibbett, Sandro's Trattoria, State Farm, FASTSIGNS, Thai Zapp Cafe, Pickleberry Kids, Allstate, and more.

TRAFFIC COUNTS (ADT 2024)

- On Veterans Memorial Boulevard, at site: 33,411
- On Interstate 10, at site: 123,346





SUMMARY

AERIAL

SITE PLAN

PHOTOS

DEMOGRAPHICS

Click image for larger view

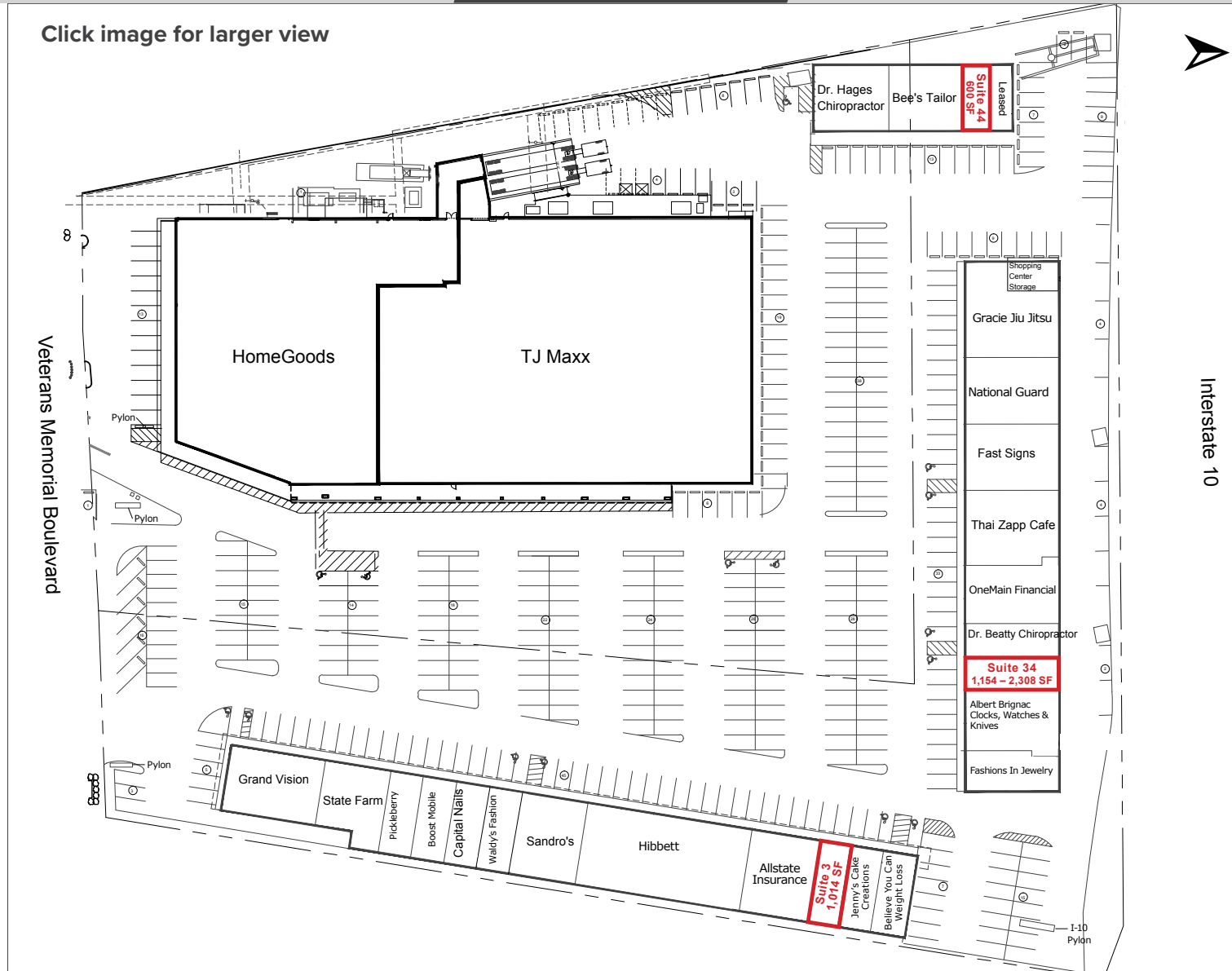

SUMMARY

AERIAL

SITE PLAN

PHOTOS

DEMOGRAPHICS



SUMMARY



AERIAL

SITE PLAN

PHOTOS

DEMOGRAPHICS

2025 DRIVE TIME DEMOGRAPHICS

	5 MIN	10 MIN	15 MIN
 <p>POPULATION</p>	57,647	174,900	303,491
 <p>AVG. HH INCOME</p>	\$94,166	\$103,797	\$102,747
 <p>HOUSEHOLDS</p>	24,772	74,990	132,612

