

GENERAL NOTES

1. THE CONTRACTOR IS RESPONSIBLE FOR MEETING ALL INTERNATIONAL BUILDING CODES, ZONING ORDINANCES AND STATE FIRE MARSHAL REGULATIONS.
2. PROVIDE ACCESSIBILITY FOR THE PHYSICALLY HANDICAPPED CONFORMING TO THE ANSI A117.1 - LATEST EDITION.
3. BATHROOMS MARKED AS HANDICAPPED SHALL BE EQUIPPED AND CONSTRUCTED TO CONFORM WITH ALL ANSI A117.1 REGULATIONS.
4. EXIT DOORS SHALL NOT BE LOCKED DURING PERIODS OF OCCUPANCY AND SHOULD NOT REQUIRE THE USE OF SPECIAL KNOWLEDGE, KEY OR TOOL TO OPERATE FROM THE EGRESS SIDE OF DOOR PER IFC 1008.
5. INTERIOR FINISHES SHALL COMPLY WITH TABLE 603.3 OF THE INTERNATIONAL BUILDING CODE LATEST EDITION.
6. ALL INSULATION AND INSULATION ASSEMBLIES SHALL HAVE A SMOKE DEVELOP FACTOR OF LESS THAN 0.450. CONCEALED INSULATION SHALL HAVE A FLAME SPREAD RATING OF 0-25. EXPOSED INSULATION A FLAME SPREAD RATING OF 0-25.
7. DRAFT STOPPING IS NOT REQUIRED IN BUILDINGS EQUIPPED THROUGHOUT WITH AN AUTOMATIC SPRINKLER SYSTEM IN ACCORDANCE WITH SECTION 903.5.11 AND 903.5.12 OF THE I.B.C.
8. FIRE BLOCKING SHALL BE PROVIDED IN WALLS AND PARTITIONS TO CUTOFF ALL CONCEALED DRAFT OPENINGS BOTH VERT. & HORIZ. AND TO FORM A FIRE BARRIER BETWEEN FLOOR AND FLOOR. ALL OPENINGS AROUND PIPES, DUCTS & AIR CONDUT SHALL BE FIRESTOPPED WITH APPROVED FIRESTOPPING MATERIALS. FIRESTOPPING SHALL BE INSTALLED IN ACCORDANCE WITH SECTION 717 OF THE I.B.C.
9. INTERIOR WALLS AND CEILINGS SHALL HAVE A FLAME SPREAD RATING OF 0-200 AND A SMOKE DEVELOPED FACTOR OF 0-450.
10. PROVIDE HAND OPERATED FIRE EXTINGUISHERS IN ACCORDANCE WITH NFPA 10.

DOOR SCHEDULE

NO.	DOOR SIZE	DOOR TYPE	FRAME	RATING	TYPE	REMARKS
1	3'-0" X 7'-0"	WOOD	METAL	-	A	LEVER W/ CLOSER
2	3'-0" X 7'-0"	-	WOOD	-	-	CASED OPENING
3	4'-0" X 7'-0"	-	WOOD	-	-	CASED OPENING

WINDOW SCHEDULE

QTY.	MARK	WINDOW SIZE	DESCRIPTION
1	A	3'-6" X 4'-0"	3640 DBL. PANED, DOUBLE HUNG, SPLIT WINDOW

AREA DATA

CONDITIONED SPACE	2717 SQ. FT.
WALL CAVITY	225 SQ. FT.
TOTAL LEASED AREA	2942 SQ. FT.
(3) SQ. FT. OF ADDITION INCLUDED	

3 HOUR RATED  
FIRE WALL

3 HOUR RATED  
FIRE WALL

KEY PLAN - EXISTING BUILDING

NO SCALE

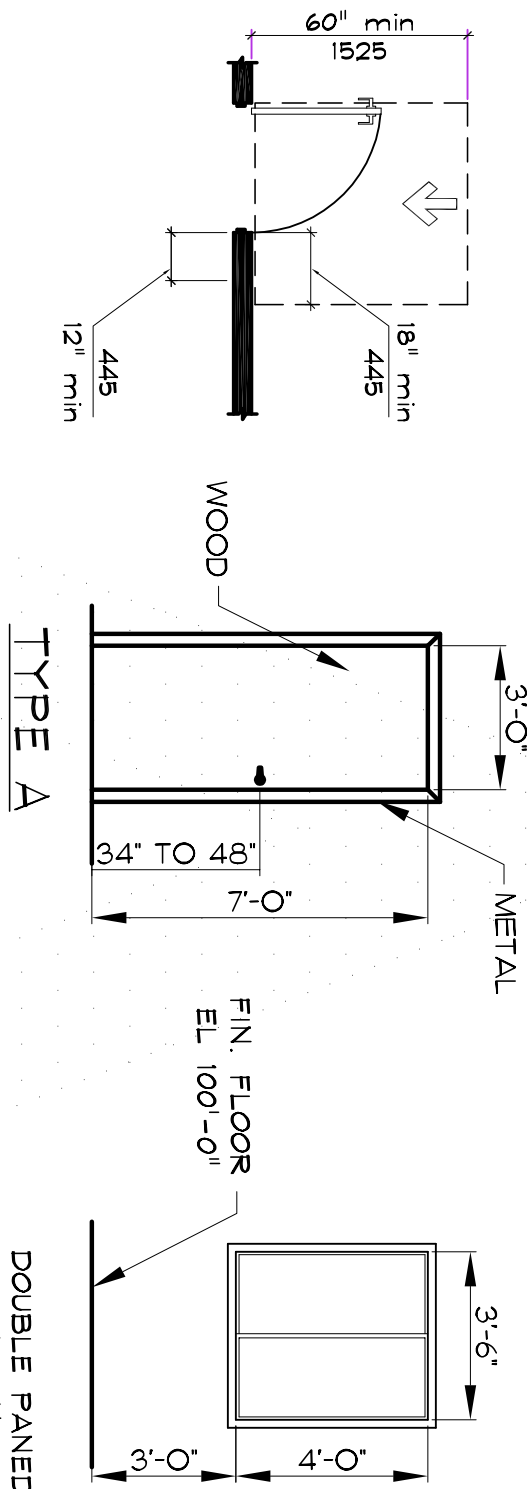

1 HOUR RATED  
FIREWALL TO ROOF  
DECK (UL NO. U45)

EQUIPMENT LIST	
NO	QTY. DESCRIPTION
1	1 BOXING TABLE- STAINLESS STEEL - 30"D X 72"W
2	1 SALAD PREP TABLE- TRUE FOOD SERVICE EQUIP., INC. MODEL TSSU-48-12 STAINLESS STEEL, 30-8"D X 48-8"L, 1/2HP, 115/60/1, 8.6 AMPS
3	1 WARTER TABLE- STAINLESS STEEL - 30"D X 72"W
4	1 TEA MAKER TABLE- STAINLESS STEEL - 30"D X 48"W
5	1 PIZZA PREP TABLE - TRUE FOOD SERVICE EQUIP., INC. MODEL TPP-67, STAINLESS STEEL, 32-1/2"D X 67-1/2"L, 1/2HP, 115/60/1, 8.6 AMPS
6	1 SAUCE TABLE- STAINLESS STEEL - 30"D X 72"W
7	1 DOUGH TABLE- STAINLESS STEEL - 30"D X 72"W
8	1 MOBILE BUN PAN RACK - 30"D X 20"W
9	2 PIZZA OVEN- LINCOLN IMPINGER, MODEL 1450 56 3/4" X 78 1/4", GAS FIRED, 120,000 BTU/Hr, 120V, 5 AMPS, 1-PHASE, 60HZ
10	2 HAND SINK - 15"D X 15"W
11	1 VEGGIE SINK- STAINLESS STEEL, SINGLE BOWL W/ RIGHT DRAINBOARD - 27"D X 37"W
12	1 3-COMPARTMENT SINK- STAINLESS STEEL - 28"D X 90"W
13	1 DISH MACHINE- CLASSICO WAREWASHING, INC., MODEL C750U, 30"D X 24"W, 208V/60HZ/1
14	1 WALK-IN COOLER, 7'-9 1/4" X 9'-8"D X 8'-6 1/4"
15	1 WALK-IN FREEZER, 7'-9 1/4" X 5'-10"D X 8'-6 1/4"
16	1 STATIONARY CAN RACK- STAINLESS STEEL - 24"D X 36"W
17	6 FREE STANDING WIRE SHELVING- STORAGE- 18"D X 48"W 24"D X 36"W
18	2 FREE STANDING WIRE SHELVING- CLEAN DISHES- 24"D X 36"W
19	1 EMPLOYEE LOCKERS- 16"D X 72"W
20	1 TIME CLOCK/ BULLETIN BOARD
21	1 HOT SINK- FLOOR MOUNTED- 24"D X 24"W
22	1 ICE/DRINK DISPENSER COMBO
23	1 ICE/FAKES- 500S, 27-1/2"D X 22 1/2" - HOSHIZAKI AMERICA INC., MODEL KIF-S01MAH, STAINLESS ST., 27-3/8"D X 22 1/2"
24	1 STACK UNIT WASHER/ DRYER- 33"D X 27"W
25	2 GARBAGE
26	1 SLICER TABLE- STAINLESS STEEL- 30"D X 60"W
27	1 BOTTLE COOLER- CARRIER, BEVERAGE-AIR, MODEL MC100, 32"D X 43-1/4" X 78 1/4", 115V, 1/2HP, 10.6 AMPS
28	3 CASH REGISTER
29	1 HOOD- CAPTIVE-AIRE SYSTEMS, INC., 66"D X 84 1/4"
30	1 SLICER- BERKEI, MODEL 800A SERIES, 827A 12" KNIFE, 25-1/2"D X 20"W, 115/60/1, 2.5 AMPS
31	2 FREE STANDING WIRE SHELVING- STORAGE- 18"D X 24"W

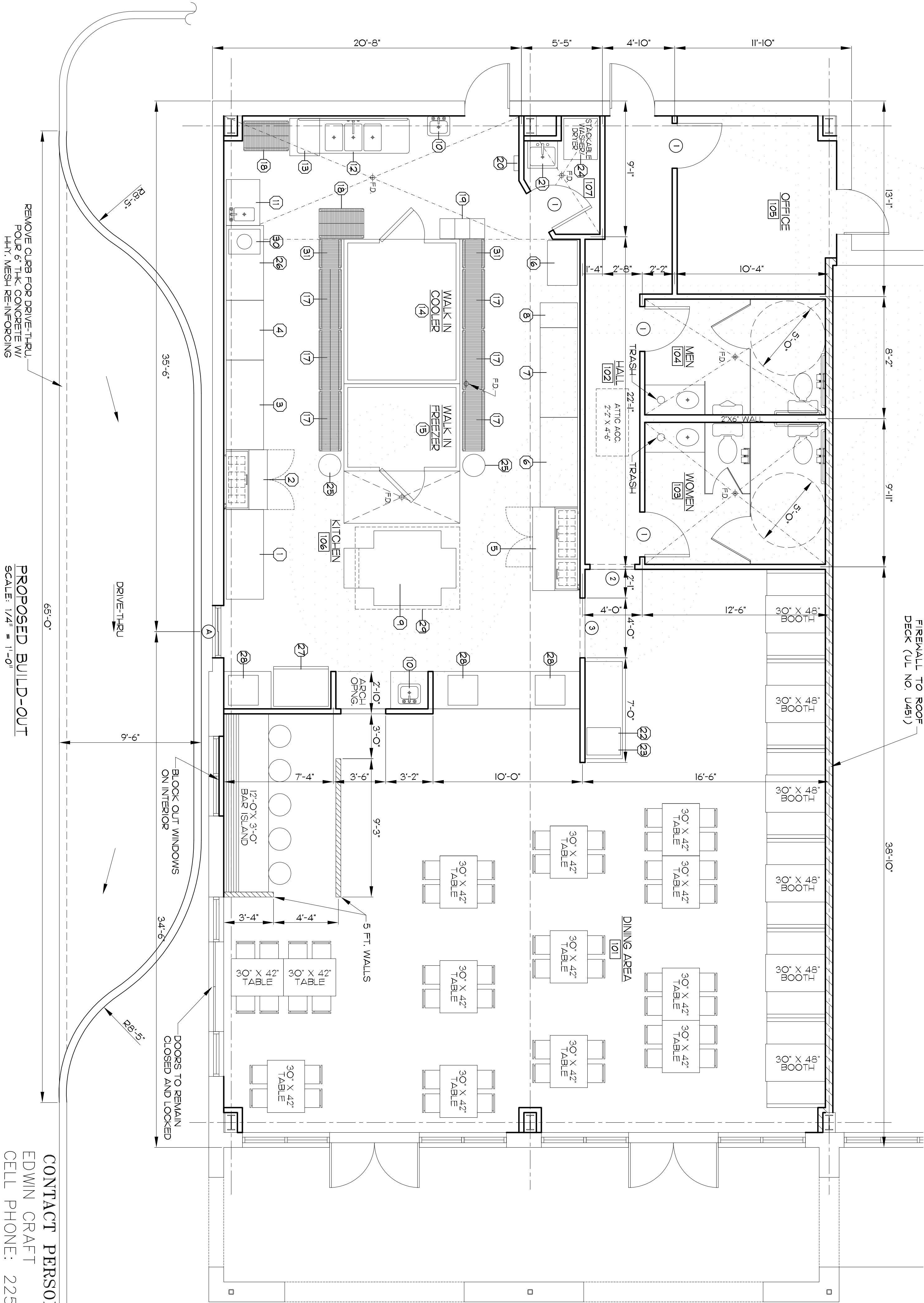

REMOVE CURB FOR DRIVE-THRU  
POUR 6" THK. CONCRETE W/  
H.H.T. MESH RE-INFORCING

PROPOSED BUILD-OUT  
SCALE: 1/4" = 1'-0"

CONTACT PERSON:

EDWIN CRAFT  
CELL PHONE: 225-955-6959

SCALE :  
NOTED  
DRAWN : BAO

SHEET  
NO. 1  
REV.  
NO. 0

PROJECT NO.  
200995

DESCRIPTION: FLOOR PLAN AND SCHEDULES  
DATE: 03-09-09  
REVISION: ISSUED FOR APPROVAL

AFFORDABLE DESIGN SERVICE, L.L.C.  
P.O. BOX 1994 CELL: (225) 675-7350  
PRAIRIEVILLE, LA 70769 PHONE: (225) 622-5501

PROPOSED BUILD OUT  
FOR FOX'S PIZZA  
SUITE "101&102"  
MAIN ST. PELICAN POINT  
HWY. 44  
GONZALES, LA. 70737

PLANS ARE THE PROPERTY OF THE OWNER, BILL ORY, OF AFFORDABLE DESIGN SERVICE, L.L.C.. ALL RIGHTS ARE RESERVED BY THE OWNER, ANY USE, OTHER THAN THAT AUTHORIZED, IS EXPRESSLY PROHIBITED. ANY REPRODUCTION OF THIS PLAN IS EXPRESSLY PROHIBITED. THIS PLAN IS TO BE USED FOR THE SUBDIVISION AND OR LOT INDICATED IN THIS TITLE BLOCK ONLY. USE ON ANY OTHER LOT IS PROHIBITED. JESUS IS LORD.

THIS FIRM NOT BEING AN ARCHITECTURAL , OR ENGINEERING FIRM STAMPS NO LIABILITY FOR THE STRUCTURAL OR ARCHITECTURAL DESIGN INTEGRITY OF THESE PLANS. EVERY EFFORT HAS BEEN MADE TO INSURE ALL DIMENSIONS ARE CORRECT AND ENVIRONMENTAL, STATE AND PARISH REGULATIONS HAVE BEEN MET. IF AN ERROR OR OMISSION DOES OCCUR, IT IS THE SOLE RESPONSIBILITY OF THE OWNER AND OR CONTRACTOR TO CORRECT IT AT HIS OWN EXPENSE AND NOT THE RESPONSIBILITY OF THE DESIGN SERVICE.

