



AVAILABLE

Bernstein Avenue

Wallace Avenue

Ivan Smith
FURNITURE
Saving you more on the look you want.

W. 70th Street

DISTRIBUTION WAREHOUSE AVAILABLE FOR LEASE

505 W. 70th Street, Shreveport, LA 71106

- Up to 101,408 SF warehouse located in South Central Shreveport
- Over 9,000 square feet of office space
- Located off of West 70th Street approximately 0.50 mile from Interstate 49
- 1.8 +/- concrete parking lot with security fence and gate
- 6 dock doors, 5 deck doors, 1 ramp
- 15' ceiling heights
- Zoned C-3
- Offered at \$3.75 per square foot (annual)

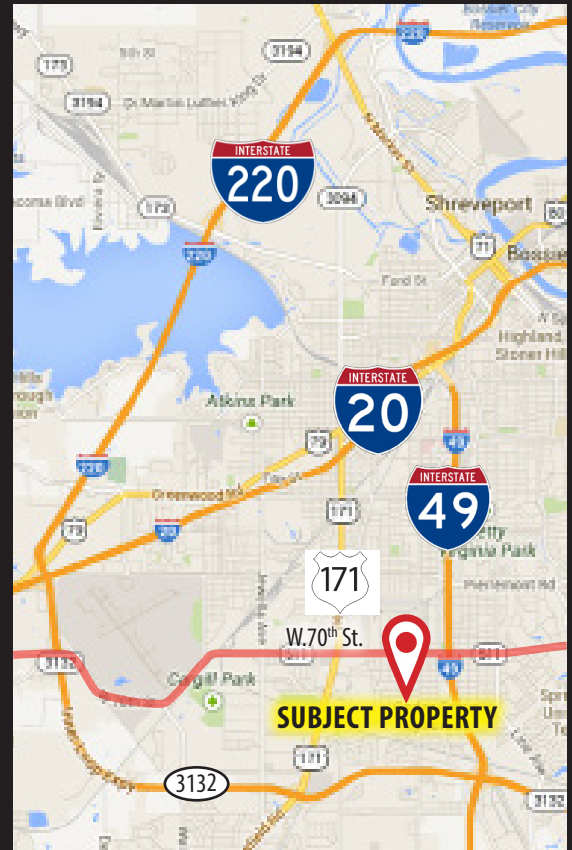

For more information, contact:

G. Archer Frierson, III, CCIM | 318.222.2244 | gfrierson@vintage Realty.com

ALL INFORMATION CONTAINED HEREIN IS BELIEVED TO BE ACCURATE, BUT IS NOT WARRANTED AND NO LIABILITY OF ERRORS OR OMISSIONS IS ASSURED BY EITHER THE PROPERTY OWNER OR VINTAGE REALTY COMPANY OR ITS AGENTS AND EMPLOYEES. PRICES AS STATED HEREIN AND PRODUCT AVAILABILITY IS SUBJECT TO CHANGE AND/OR SALE OR LEASE WITHOUT PRIOR NOTICE, AND ALL SIZES AND DIMENSIONS ARE SUBJECT TO CORRECTION. REV 12/2025



DISTRIBUTION WAREHOUSE

505 W. 70TH STREET
SHREVEPORT, LA 71106

FLOOR PLAN

101,408 SF AVAILABLE

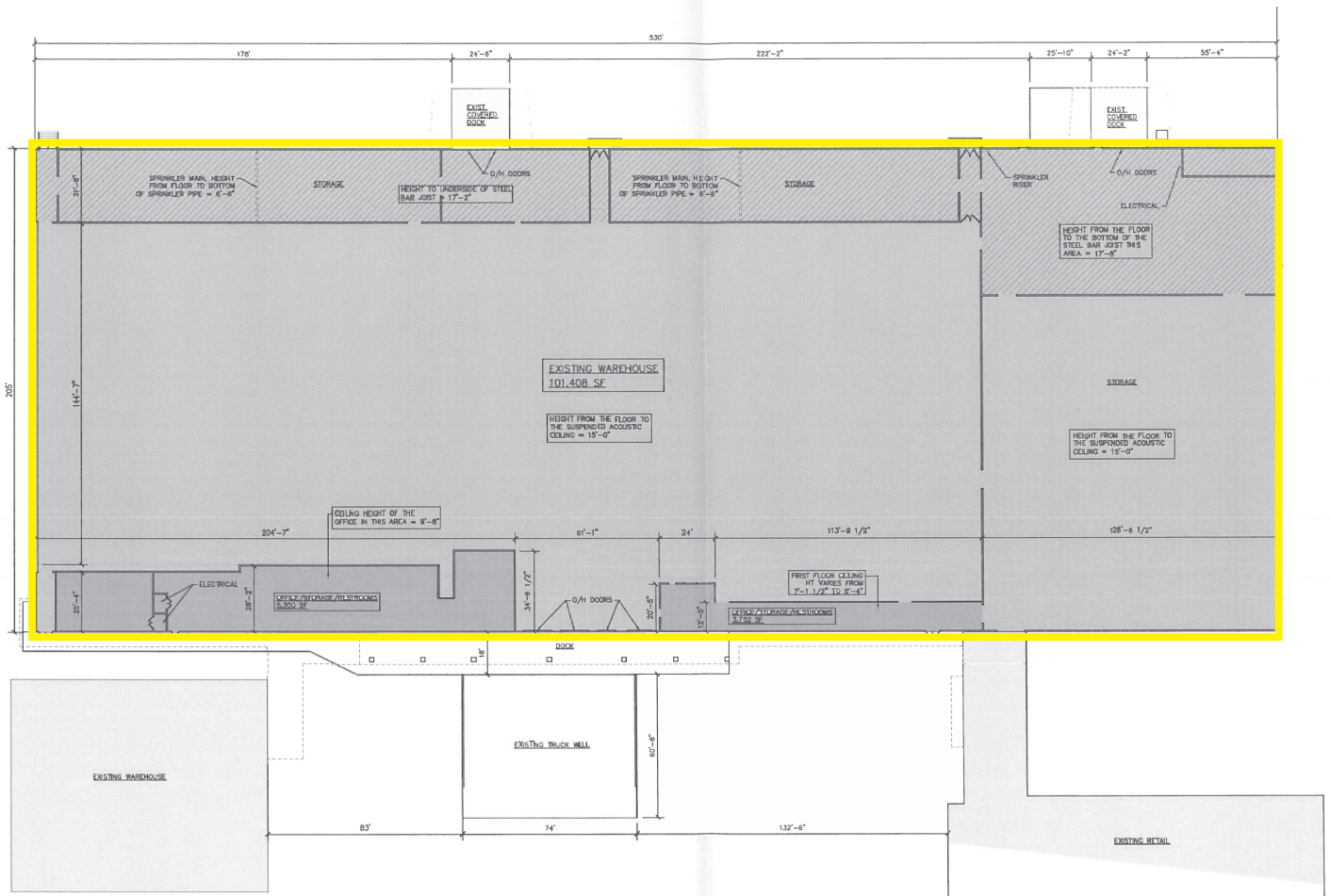

For More Information Contact:

G. Archer Frierson III, CCIM | 318-222-2244

gfrierson@vintagerealty.com | vintagerealty.com

ALL INFORMATION CONTAINED HEREIN IS BELIEVED TO BE ACCURATE, BUT IS NOT WARRANTED AND NO LIABILITY OF ERRORS OR OMISSIONS IS ASSURED BY EITHER THE PROPERTY OWNER OR VINTAGE REALTY COMPANY OR ITS AGENTS AND EMPLOYEES. PRICES AS STATED HEREIN AND PRODUCT AVAILABILITY IS SUBJECT TO CHANGE AND/OR SALE OR LEASE WITHOUT PRIOR NOTICE, AND ALL SIZES AND DIMENSIONS ARE SUBJECT TO CORRECTION. 12/2025

DISTRIBUTION WAREHOUSE

505 W. 70TH STREET
SHREVEPORT, LA 71106



For More Information Contact: _____

G. Archer Frierson III, CCIM | 318-222-2244

gfrierson@vintagerealty.com | vintagerealty.com

ALL INFORMATION CONTAINED HEREIN IS BELIEVED TO BE ACCURATE, BUT IS NOT WARRANTED AND NO LIABILITY OF ERRORS OR OMISSIONS IS ASSURED BY EITHER THE PROPERTY OWNER OR VINTAGE REALTY COMPANY OR ITS AGENTS AND EMPLOYEES. PRICES AS STATED HEREIN AND PRODUCT AVAILABILITY IS SUBJECT TO CHANGE AND/OR SALE OR LEASE WITHOUT PRIOR NOTICE, AND ALL SIZES AND DIMENSIONS ARE SUBJECT TO CORRECTION. 12/2025

