



PARK PLACE

733 E AIRPORT AVE, BATON ROUGE, LA 70806

CBRE

PROPERTY OVERVIEW

733 E AIRPORT AVE, BATON ROUGE, LA 70806

- Multiple Spaces available in Affordable Office Building
- Office space available in prime Baton Rouge location next to Independence Park
- Great Parking
- Close proximity to Airline Hwy, Jefferson Hwy, Government St., and Florida Blvd.
- Multiple restaurants nearby
- ± 3,102 SF across Two Floors

AVAILABLE UNITS

SUITE	SIZE (SF)	RENT / SF	MONTHLY RENT
105	400	\$22.50	\$750
201	1,533	\$13.00	\$1,660
202	1,169	\$13.00	\$1,266



FLOOR PLAN

Suite 105

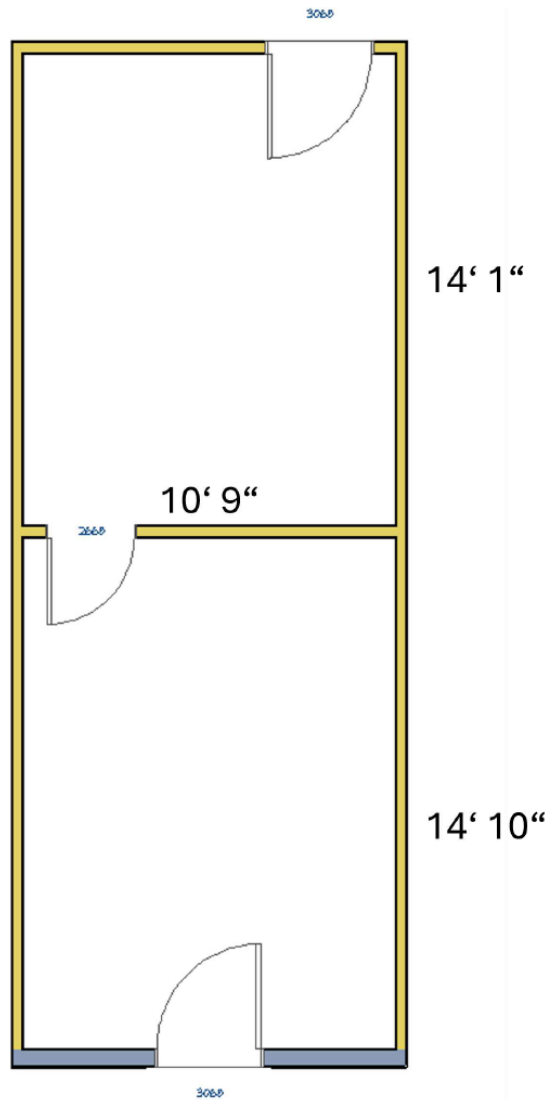

GROUND FLOOR

SHARED COMMON
AREA

400 SQUARE FT

Suites 201 & 202



PARK PLACE

- 1 AMAZON CORTANDA
- 2 GOODWOOD LIBRARY
- 3 TOWN CENTER
- 4 COSTCO



SUBJECT PROPERTY

733 EAST AIRPORT AVE.

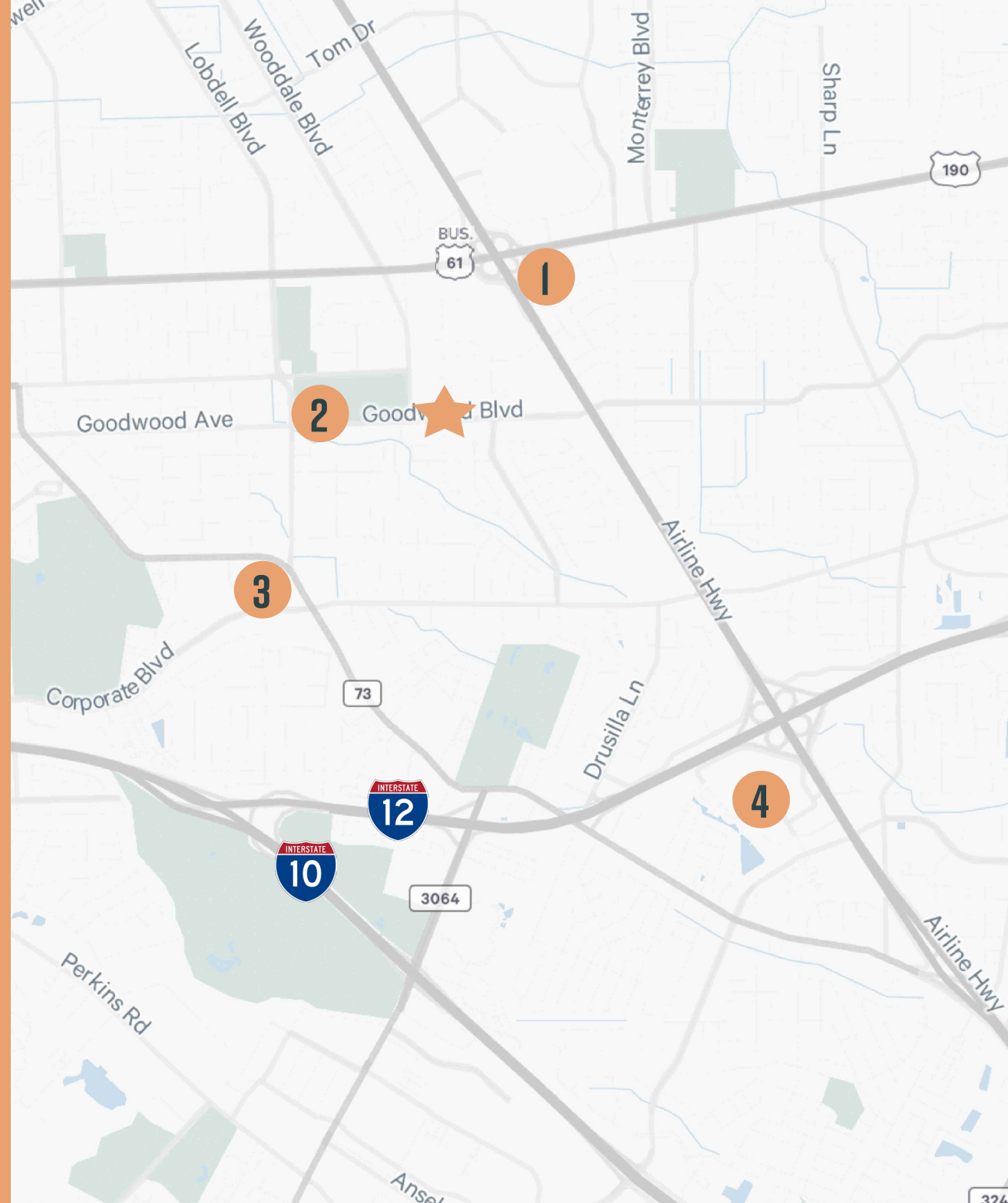

urne Ave

S Choctaw Dr

AREA DEMOGRAPHICS

5 MI

3 MI

1 MI



Airline Hwy

POPULATION



1 Miles
6,105



3 Miles
72,771



5 Miles
214,262

HOUSEHOLDS



1 Miles
2,742



3 Miles
32,991



5 Miles
92,362

AVERAGE HOUSEHOLD INCOME



1 Miles
\$129,261



3 Miles
\$88,568



5 Miles
\$90,548

PARK PLACE

733 E AIRPORT AVE, BATON ROUGE, LA 70806



CONTACTS

Jonann Stutzman
Vice President
+1 225 445 0473
jonann.stutzman@cbre.com

Jake Loach
Associate
+1 256 724 2764
jake.loach@cbre.com

CBRE

© 2023 CBRE, Inc. All rights reserved. This information has been obtained from sources believed reliable but has not been verified for accuracy or completeness. CBRE, Inc. makes no guarantee, representation or warranty and accepts no responsibility or liability as to the accuracy, completeness, or reliability of the information contained herein. You should conduct a careful, independent investigation of the property and verify all information. Any reliance on this information is solely at your own risk. CBRE and the CBRE logo are service marks of CBRE, Inc. All other marks displayed on this document are the property of their respective owners, and the use of such marks does not imply any affiliation with or endorsement of CBRE. Photos herein are the property of their respective owners. Use of these images without the express written consent of the owner is prohibited.