

PECAN ALLEY SUBDIVISION (LOTS 1 - 5)

BEING LOT 16 AND A PORTION OF LOT 17 OF A SUBDIVISION OF THE EASTERN PORTION OF LOT 3, OAK ISLE PLANTATION, LOCATED IN SECTION 34, TOWNSHIP 4 NORTH, RANGE 2 WEST, LOUISIANA MERIDIAN, SOUTHWEST LAND DISTRICT, RAPIDES PARISH, LOUISIANA

- (A) = 10' BUILDING SETBACK
- (B) = 10' UTILITY SERVITUDE

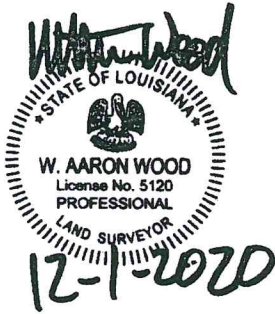

LINE TABLE		
LINE	BEARING	DISTANCE
L1	S 80° 54' 40" E	7.53'
L2	S 80° 54' 40" E	75.00'
L3	S 08° 39' 40" W	20.00'
L4	N 81° 00' 00" W	16.18'
L5	S 08° 39' 40" W	10.00'
L6	S 08° 39' 40" W	10.00'
L7	S 08° 39' 40" W	10.00'
L8	S 08° 39' 40" W	10.00'
L9	S 80° 54' 40" E	75.00'
L10	N 80° 54' 40" W	75.00'
L11	N 80° 44' 14" W	124.49'
L12	N 80° 54' 40" W	399.22'
L13	S 80° 54' 40" E	399.22'
L14	S 80° 44' 14" E	124.49'

BASIS OF BEARINGS:
BEARING ALONG THE SOUTH LINE OF LOT 16 OF A SUBDIVISION OF THE EASTERN PORTION OF LOT 3 OAK ISLE SUBDIVISION, TAKEN FROM REFERENCE PLAT BY ME DATED FEBRUARY 7, 2020.

Dgt BK 3708 16

