

THE NEW ORLEANS  
**EXCHANGE**  
CENTRE

**11<sup>th</sup> FLOOR**  
**935 GRAVIER STREET**

**SUITE DETAILS**

- Suite 1160
- 2,213 rsf available
- Layout features 3 large private offices, large open area, reception area & closet
- Sink can be added for 5 year lease term
- Base rate \$16.50/rsf - \$3,043/month
- Great views of CBD

**PROPERTY FACTS**

- 355,274 rsf on 21 floors
- Built in 1981
- Typical floor plan 20,000 rsf
- Former Chevron Headquarters
- Adjacent unreserved parking garage with 321 spaces
- Internal reserved parking garage with 89 spaces
- Additional unreserved parking with 125 spaces available in adjacent aLoft Hotel garage

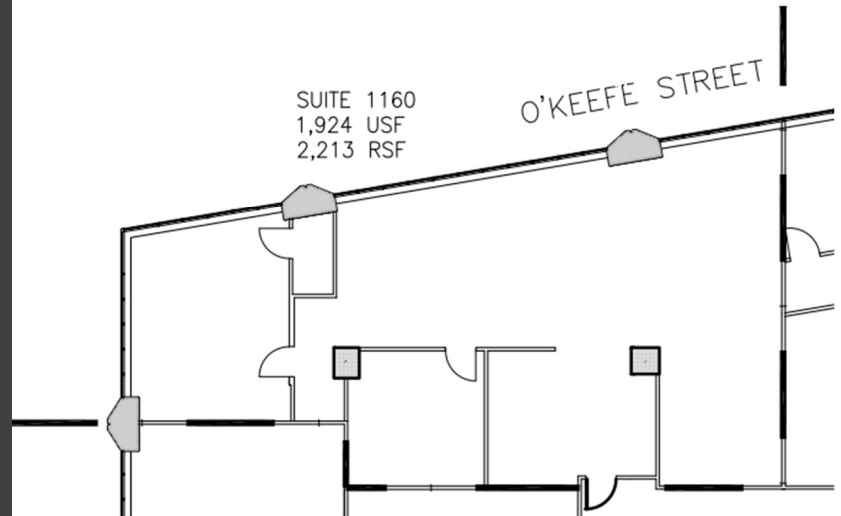

**CORPORATE REALTY**

**JOE GORMAN, CCIM**  
**(504) 581-5005**  
[jgorman@corp-realty.com](mailto:jgorman@corp-realty.com)

**201 St. Charles Ave**  
**Suite 3811**  
**New Orleans, LA 70170**