

# 4,896 Sq.ft. Office/Warehouse for Sale or Lease

## 30047 Industrial Park Drive, Walker, LA 70785



Approximately 4,896 sq. ft of office warehouse space on Industrial Park Drive in Walker, LA. 3,296 sq. ft. of warehouse with 3 roll-up doors. 1,600 sq. ft. office. Available May 1, 2026. List price - \$365,000.00  
Contact Doug Ferris 225-954-4747 [doug@dougferris.com](mailto:doug@dougferris.com)

**RE/MAX**  
**PARTNERS**  
225-250-4450



**FOR MORE INFORMATION CONTACT DOUG FERRIS 225-954-4747 [doug@dougferris.com](mailto:doug@dougferris.com)**

**RE/MAX  
PARTNERS  
225-250-4450**

This information has been obtained from sources deemed to be reliable, but neither Realtor nor Remax Partners make any representations or warranties, expressed or implied, as to the accuracy of this information. References to property lines, dimensions, tenants, square footages or any information contained herein is approximate and subject to change. Purchaser or Lessee must verify any and all information and bears all risk for any inaccuracies. Each office Independently owned and operated.

**RE/MAX**  
**PARTNERS**  
225-250-4450

**12' W X 11.5' H**  
**Roll Up**

**12' W X 11.5' H**  
**Roll Up**

**1,600± Sq. ft.**  
**Office**

**3,296± Sq. ft.**  
**Warehouse**

**Existing Floor Plan**  
**30047 Industrial Park Drive**  
**Walker, LA 70785**

**12.3' W X 12.3' H**  
**Roll Up**

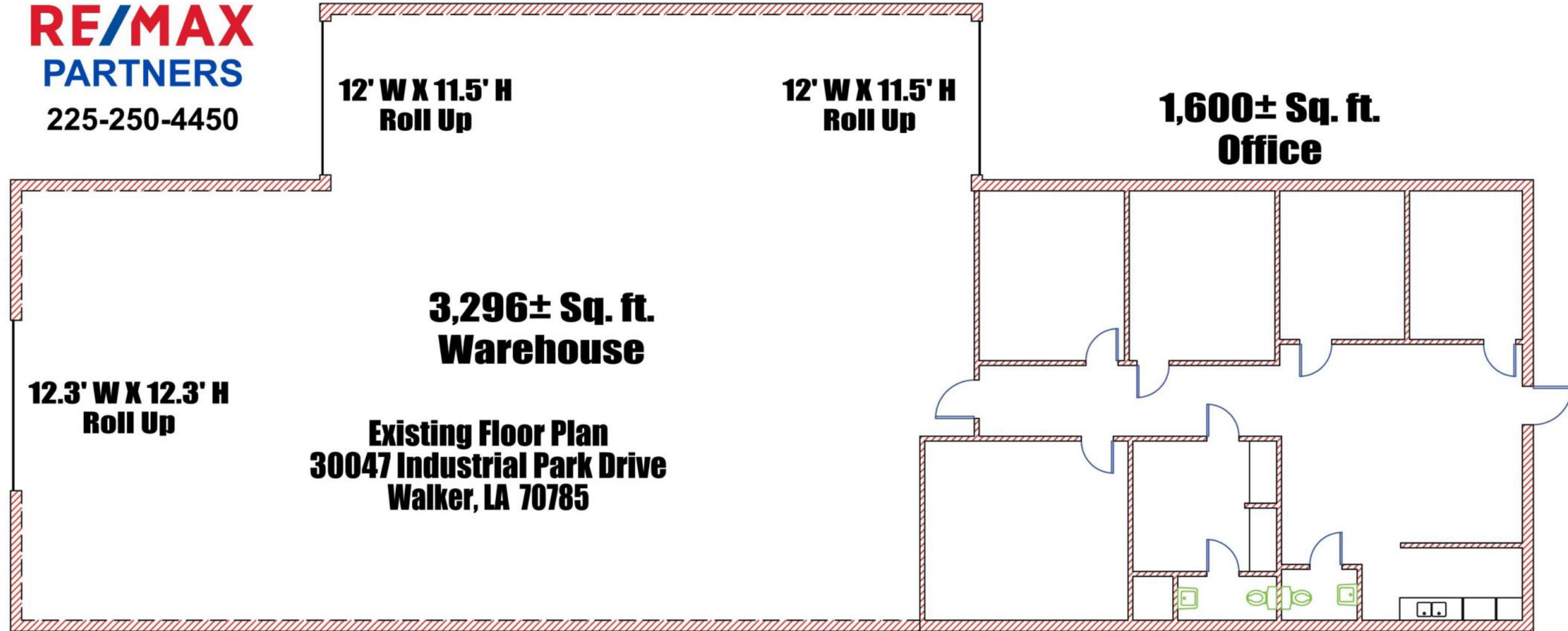

**ALL DIMENSIONS, WALLS, OR CONFIGURATIONS SHOWN HEREON**  
**ARE APPROXIMATE AND SUBJECT TO CHANGE**

**This information has been obtained from sources deemed to be reliable, but neither Realtor nor Remax First make any representations or warranties, expressed or implied, as to the accuracy of this information. References to dimensions, sizes or orientation of rooms, wall locations and door swings are approximate.**

**All information is approximate and MUST BE VERIFIED.**

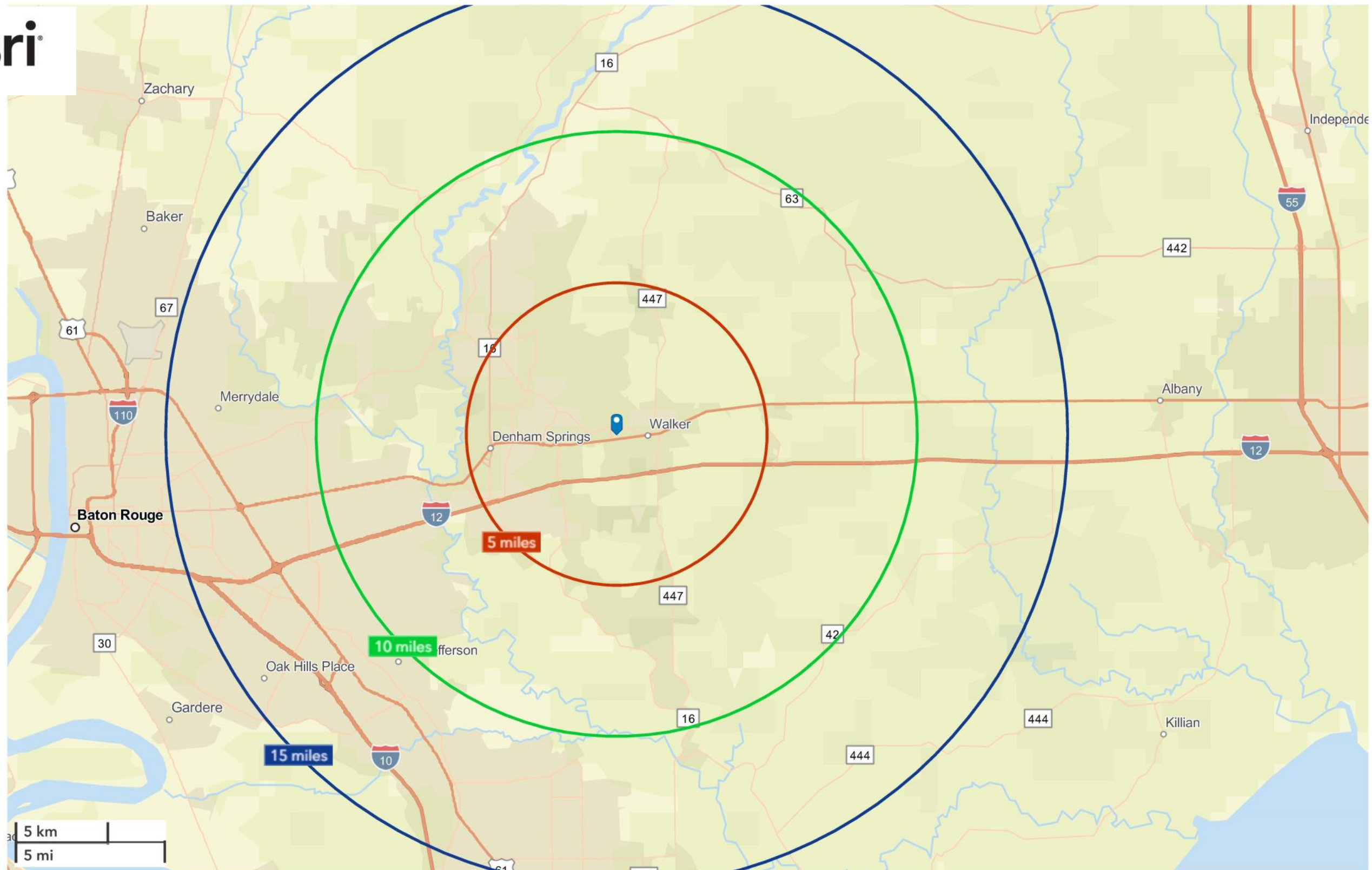

**TRADE AREA DEMOGRAPHICS - DRIVE TIMES**

	<u>5 minutes</u>	<u>10 minutes</u>	<u>15 minutes</u>
2025 Population	65,804	189,982	432,276
2025 Median Household Income	\$75,144	\$80,451	\$76,930
2025 Average Household Income	\$89,542	\$101,852	\$102,679

**FOR MORE INFORMATION CONTACT**  
**DOUG FERRIS 225-954-4747**  
**doug@dougferris.com**

**RE/MAX**  
**PARTNERS**  
**225-250-4450**

This information has been obtained from sources deemed to be reliable, but neither Realtor nor Remax Partners make any representations or warranties, expressed or implied, as to the accuracy of this information. References to property lines, dimensions, tenants, square footages or any information contained herein is approximate and subject to change. Purchaser or Lessee must verify any and all information and bears all risk for any inaccuracies. Each office Independently owned and operated.