

SUMMARY

RETAIL MAP

SITE PLAN

SUITE 176
13,050 SF

SUITE 196
33,150 SF

DEMOGRAPHICS

FOR LEASE

PROPERTY SUMMARY

Plaza 190 Shopping Center benefits from high visibility and convenient access at one of Slidell's busiest intersections at Gause Boulevard (US Highway 190) and US Highway 11. Slidell is located within Louisiana's fastest growing parish and Plaza 190 Shopping Center is in the heart of Slidell's trade area. Anchored by Ochsner-SMH Therapy & Wellness, this center is located in a high retail demand area.

APPROXIMATE GLA

- 115,135 SF

AVAILABLE

- Suite 124 - 1,400 SF
- Suite 168 - 912 SF
- Suite 176 - 13,050 SF
- Suite 196 - 33,150 SF

TENANTS INCLUDE

- Ochsner-SMH Therapy & Wellness
- Dollar Tree
- CiCi's
- Rent-A-Center
- Popeyes
- and many more!

TRAFFIC COUNTS (ADT 2024)

- Gause Boulevard West (Hwy 190): 17,384
- Front Street (Highway 11): 18,811



SUMMARY

RETAIL MAP

SITE PLAN

SUITE 176
13,050 SF

SUITE 196
33,150 SF

DEMOGRAPHICS



SUMMARY

RETAIL MAP

SITE PLAN

SUITE 176
13,050 SF

SUITE 196
33,150 SF

DEMOGRAPHICS

TENANTS

114	Ochsner - SMH	18,000 SF
124	AVAILABLE	1,400 SF
128	Jackson Hewitt	1,200 SF
136	Bakery Outlet	1,200 SF
139	H&R Block	1,600 SF
140/148	CiCis Pizza	6,400 SF
160	TP Nails	800 SF
164	TC Beauty Salon	600 SF
168	AVAILABLE	912 SF
176	AVAILABLE	13,050 SF
184	Goodwill Store	13,500 SF
186	Dollar Tree	10,200 SF
188	Sneaker Lounge	1,800 SF
192	Rent-A-Center	7,500 SF
196	AVAILABLE	33,150 SF
198	Take 5 Oil Change	1,300 SF
199	Popeyes	2,162 SF

Click image for larger view

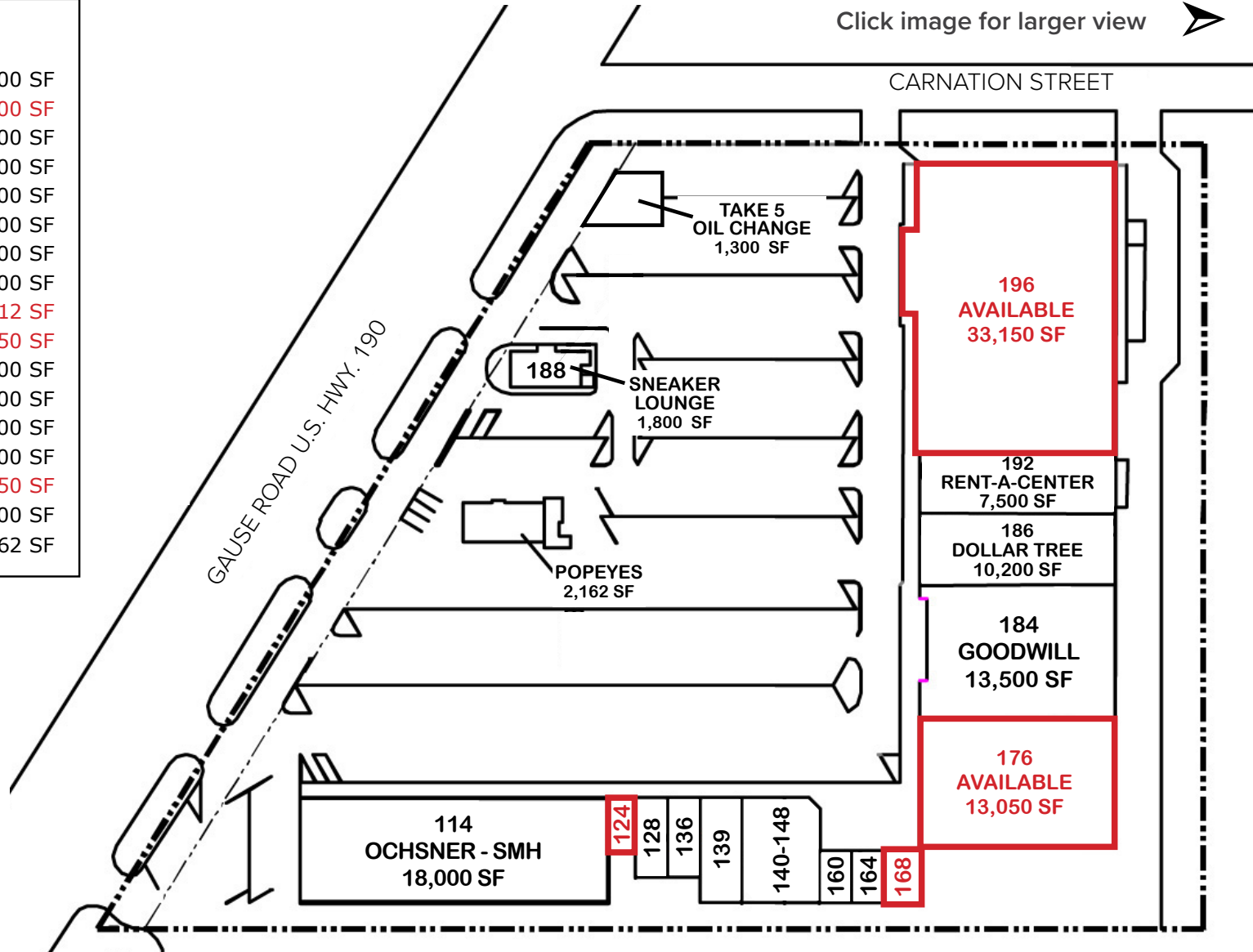

SUMMARY

RETAIL MAP

SITE PLAN

SUITE 176
13,050 SF

SUITE 196
33,150 SF

DEMOGRAPHICS

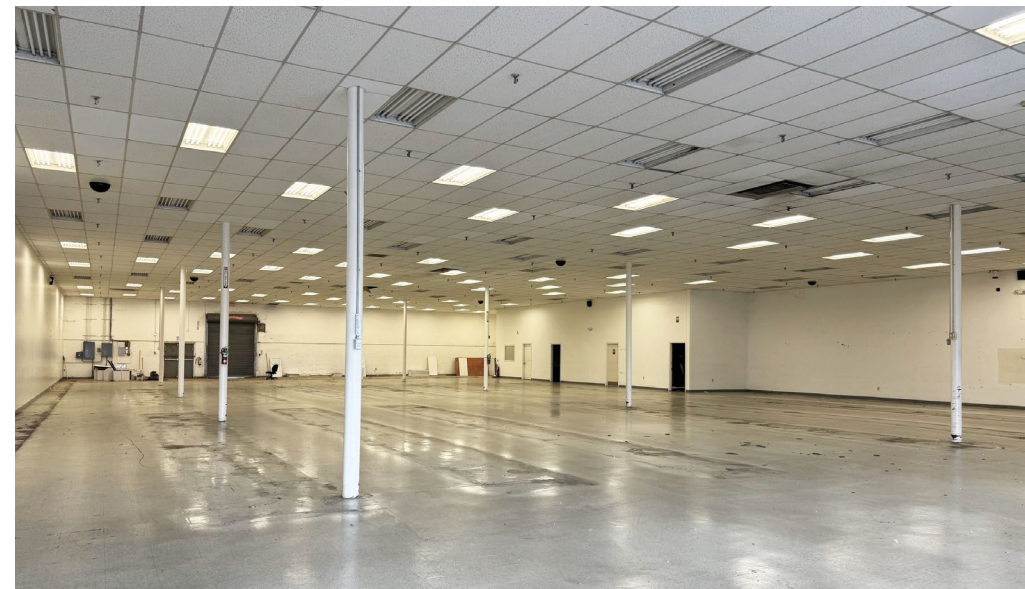
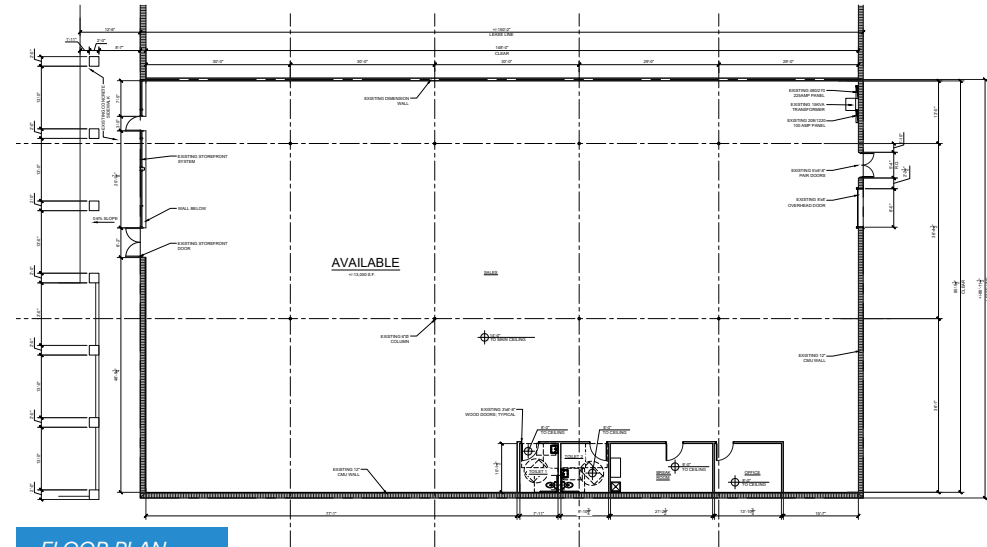

SUMMARY

RETAIL MAP

SITE PLAN

SUITE 176
13,050 SF

SUITE 196
33,150 SF

DEMOGRAPHICS

Click image for larger view

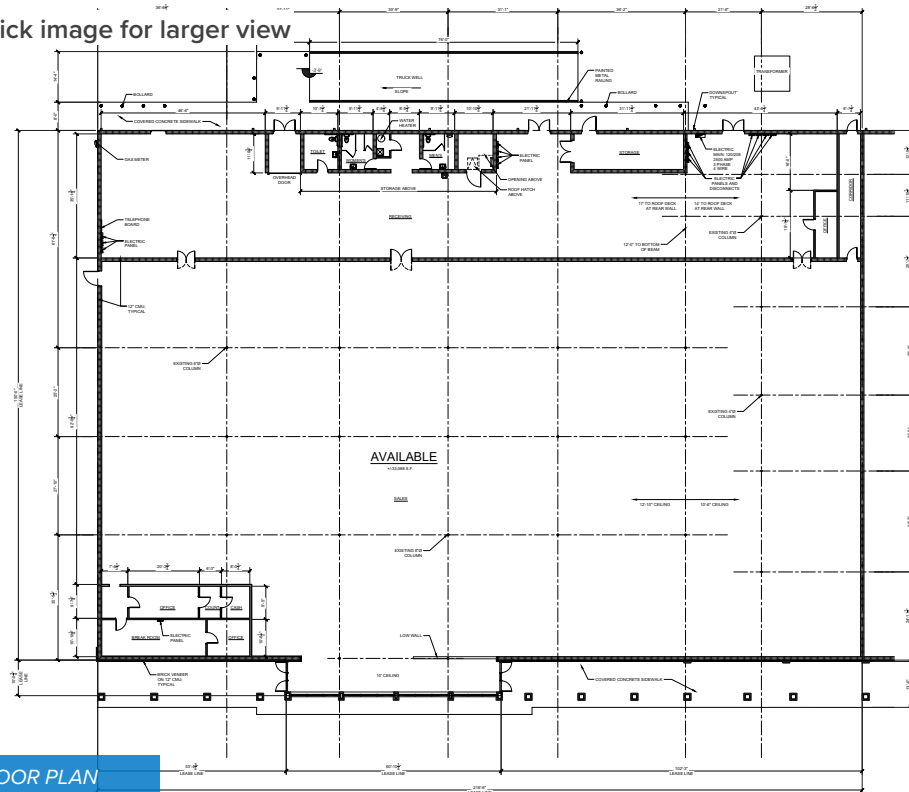

SUMMARY

RETAIL MAP

SITE PLAN

SUITE 176
13,050 SF

SUITE 196
33,150 SF

DEMOGRAPHICS

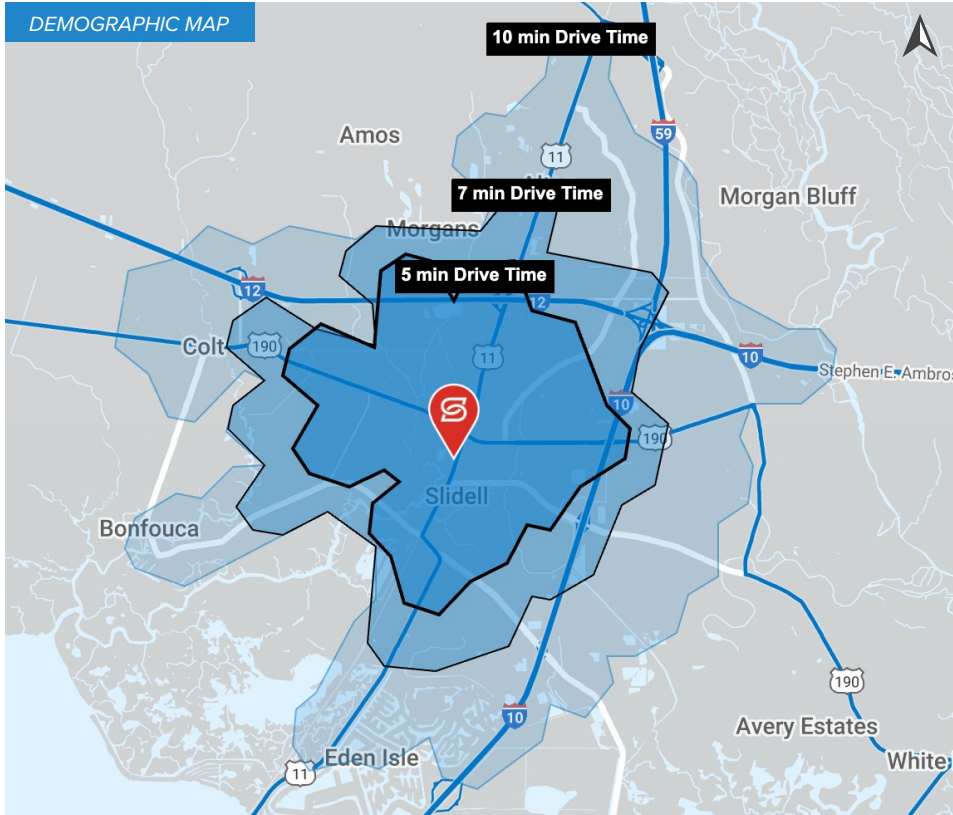

2025 DRIVE TIME DEMOGRAPHICS

5 MIN

7 MIN

10 MIN



POPULATION

22,917

40,019

68,143

5 MIN

7 MIN

10 MIN



AVG. HH
INCOME

\$86,086

\$85,580

\$93,529

5 MIN

7 MIN

10 MIN



HOUSEHOLDS

8,994

15,837

26,412