



5990 Perkins Development Opportunity

5990 Perkins Road, Baton Rouge, Louisiana 70808

Property Description

Infill Development - Subdivide of existing 5 acre tract, ideal for Office Park Development located on Perkins Road between College Drive and Essen Lane. Located in close proximity to Pennington Center, Rouzan and Moss Side Lane areas. Most of the site has a ground elevation above the base flood elevation, this is Flood Zone X. The rear of the site has a ground elevation below the base flood elevation, this is Flood Zone AE. The rear of the site borders Dawson's Creek.

Sale Price

\$1,103,000

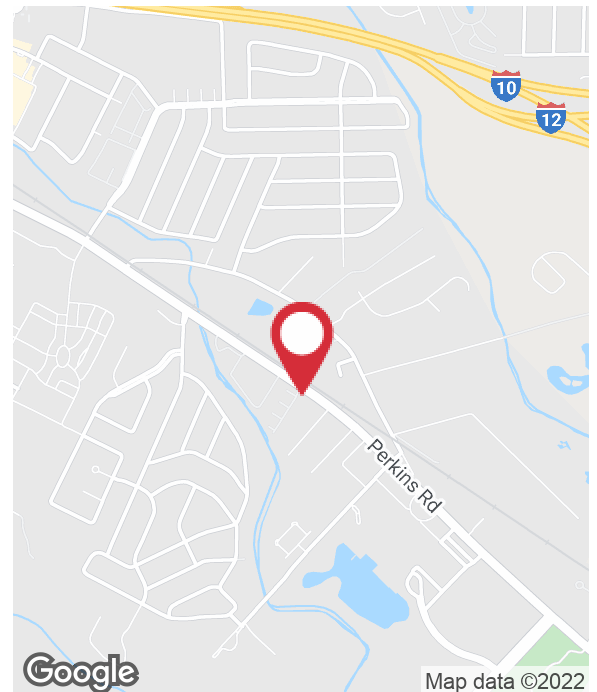

For more information

Chris Town

O: 225 295 0800 | C: 225 202 2789
ctown@latterblum.com

Bryant Cheely

O: 225 295 0800 | C: 225 933 5482
bcheely@latterblum.com

CALL OR EMAIL FOR MORE INFORMATION

NO WARRANTY OR REPRESENTATION, EXPRESS OR IMPLIED, IS MADE AS TO THE ACCURACY OF THE INFORMATION CONTAINED HEREIN, AND THE SAME IS SUBMITTED SUBJECT TO ERRORS, OMISSIONS, CHANGE OF PRICE, RENTAL OR OTHER CONDITIONS, PRIOR SALE, LEASE OR FINANCING, OR WITHDRAWAL WITHOUT NOTICE, AND OF ANY SPECIAL LISTING CONDITIONS IMPOSED BY OUR PRINCIPALS NO WARRANTIES OR REPRESENTATIONS ARE MADE AS TO THE CONDITION OF THE PROPERTY OR ANY HAZARDS CONTAINED THEREIN ARE ANY TO BE IMPLIED. LICENSED IN LOUISIANA.

1700 City Farm Drive
Baton Rouge, LA 70806
225 295 0800 tel
latterblum.com

March 02, 2022

Additional Photos

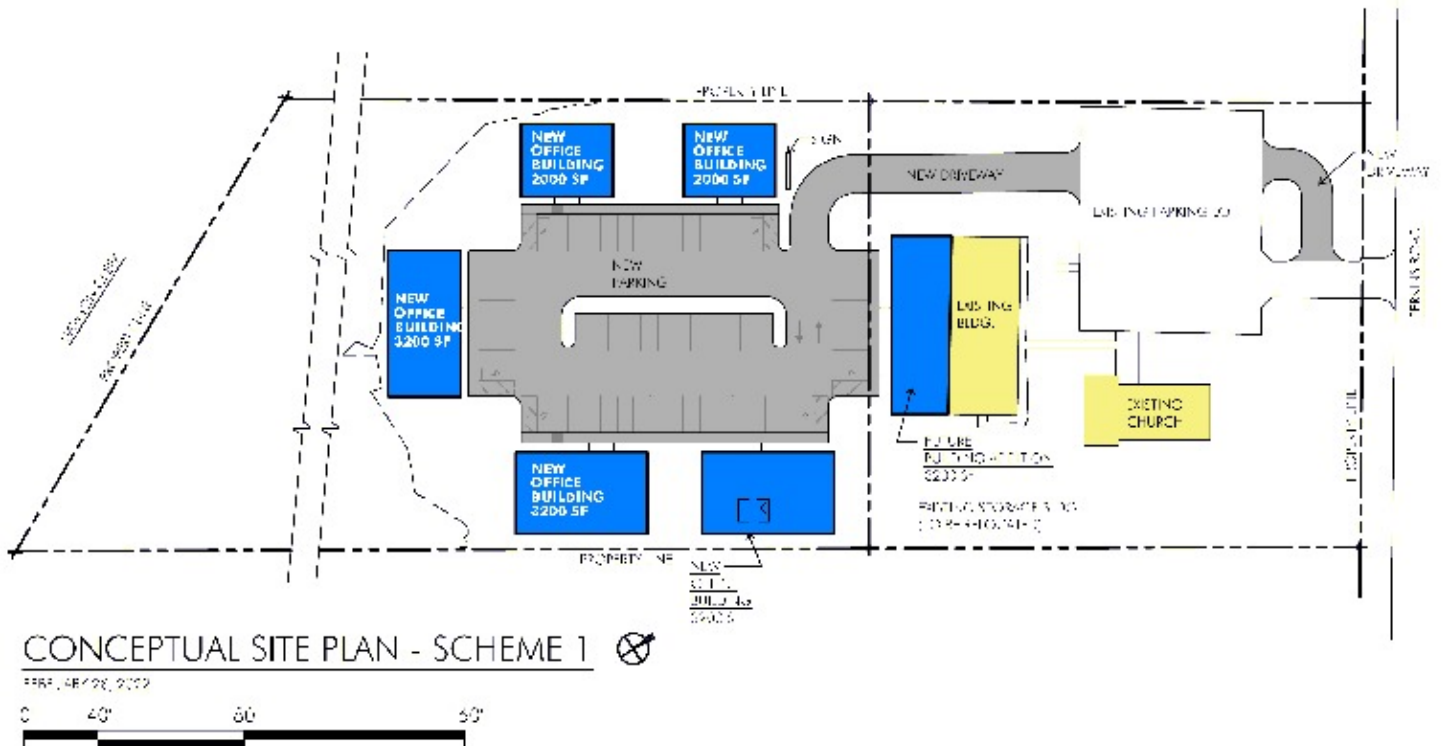

Good Shepherd Lutheran Church, LCMS

5990 Perkins Road
Baton Rouge, LA

Location Maps

