

SQ. NO. 239
FIRST DISTRICT

A Resubdivision of Lots B2 and 17B into Lot 17B1.

NEW ORLEANS, LA
ORLEANS PARISH

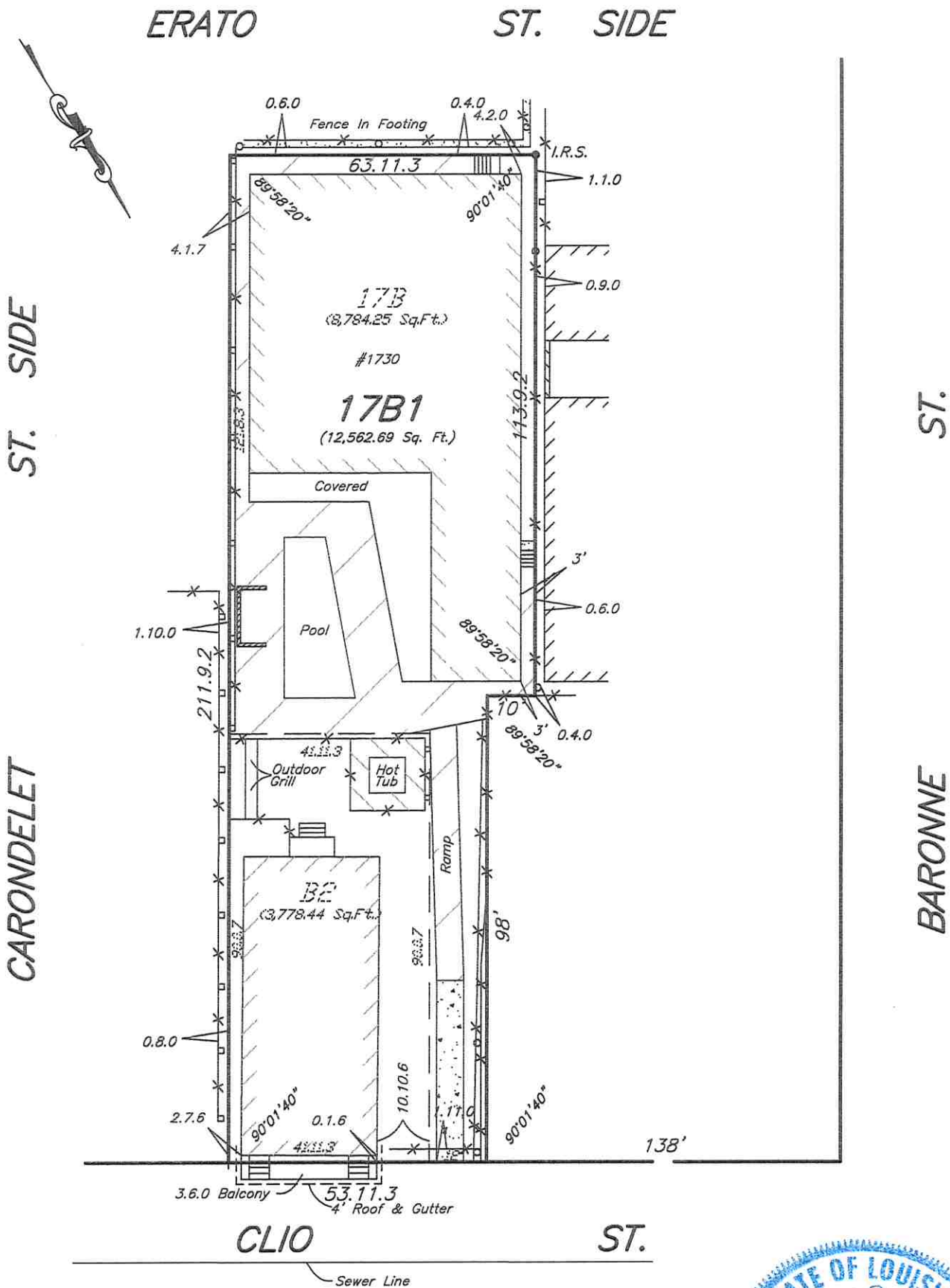

THE SERVITUDES AND RESTRICTIONS SHOWN ON THIS PLAT ARE LIMITED TO THOSE FURNISHED TO US. THERE IS NO REPRESENTATION THAT ALL APPLICABLE SERVITUDES ARE SHOWN HEREON. THE SURVEYOR HAS MADE NO TITLE SEARCH OR PUBLIC RECORD SEARCH IN COMPILING DATA FOR THIS SURVEY.

Note: Improvements may not be to scale for clarity. The dimensions shown prevail over scale. Lot angles as per plan of subd.

Legend:
• I.R.S. 1/2" Iron Rod Set
— Fence
— Sewer Line
— Water Line

Date: September 27, 2023

Scale: 1" = 30'

This plat represents an actual ground survey made by me or under my direct supervision and control and meets the requirements for the Standards of Practice for Boundary Surveys as found in Louisiana Administrative Code TITLE 46:XXI, Chapter 29 for a Class "C" survey.
Made at the request of 1726 Clío, LLC and Sam Worth

Gilbert, Kelly & Couturie, Inc., Professional Land Surveying
2121 N. Causeway Blvd., Metairie LA 70001 (504) 836-2121

Clint Sumner