

## SUMMARY

## SITE PLAN

## AERIAL

## PICAYUNE RETAIL MAP

## DEMOGRAPHICS

## FOR LEASE

### TOTAL GLA

- 110,000 SF

### AVAILABILITY RANGE

- 2,000 - 49,400 SF

### AVAILABLE

- 15,000 - 32,000 SF - Former Church
- 12,000 SF - Former Church
- 5,400 SF - Former Church Coffee Shop
- 2,442 SF - Former Church Storage
- 2,000 SF - Former Cabinet Store

### TENANTS INCLUDE

- Harbor Freight Tools
- Dollar General
- PetSense
- Applebee's
- Goodwill
- Nu-Way Auto Sales
- Baber's
- Taco Bell
- New City Asian Buffet
- Enterprise Rent-A-Car
- Scissors Edge Hair Salon

### AREA RETAIL

Walmart Supercenter, The Home Depot, Planet Fitness, Dirt Cheap, AutoZone, O'Reilly Auto Parts, and many more!

### PROPERTY DESCRIPTION

Located on Memorial Boulevard which serves as the retail corridor of Pearl River County, this property is well positioned to serve the market area. This area serves all of Pearl River County, as well as portions of Hancock County, St. Tammany Parish and Washington Parish. Picayune Place Shopping Center offers co-tenancy of soft goods and service tenants, and has maintained a stable tenant base through the years.

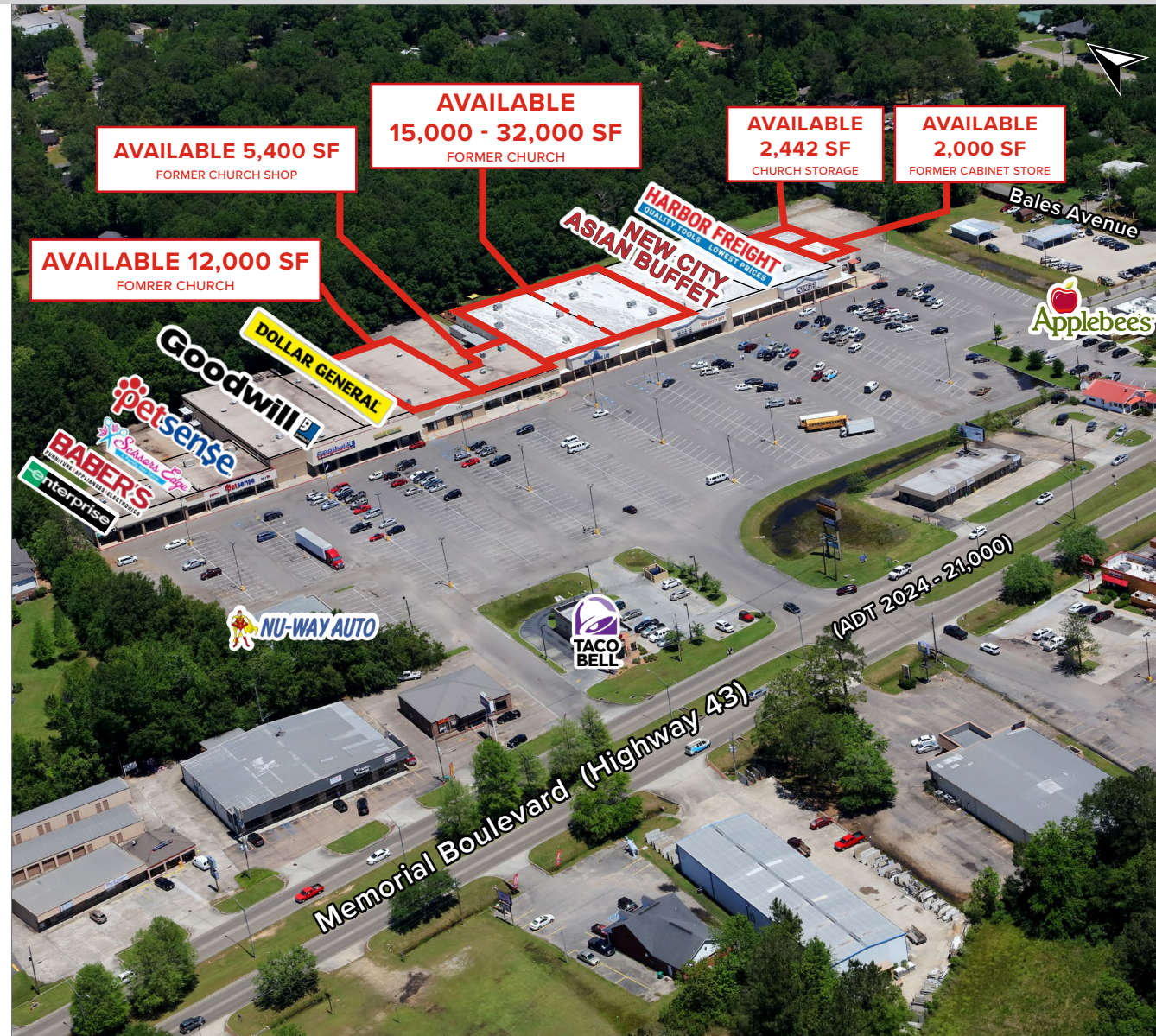

## SUMMARY

## SITE PLAN

## AERIAL

## PICAYUNE RETAIL MAP

## DEMOGRAPHICS

Click image for  
larger view

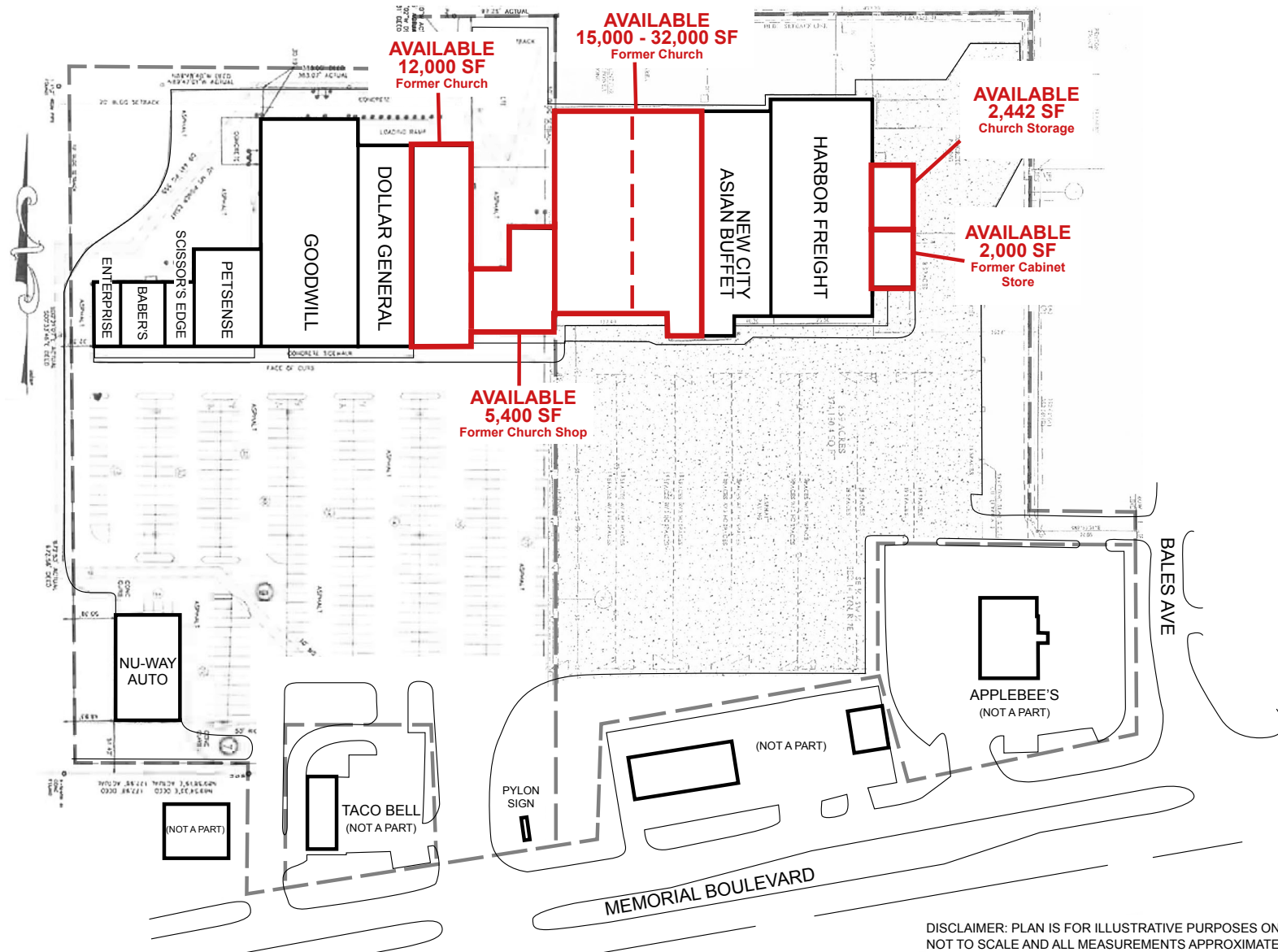

## SUMMARY

## SITE PLAN

## AERIAL

## PICAYUNE RETAIL MAP

## DEMOGRAPHICS

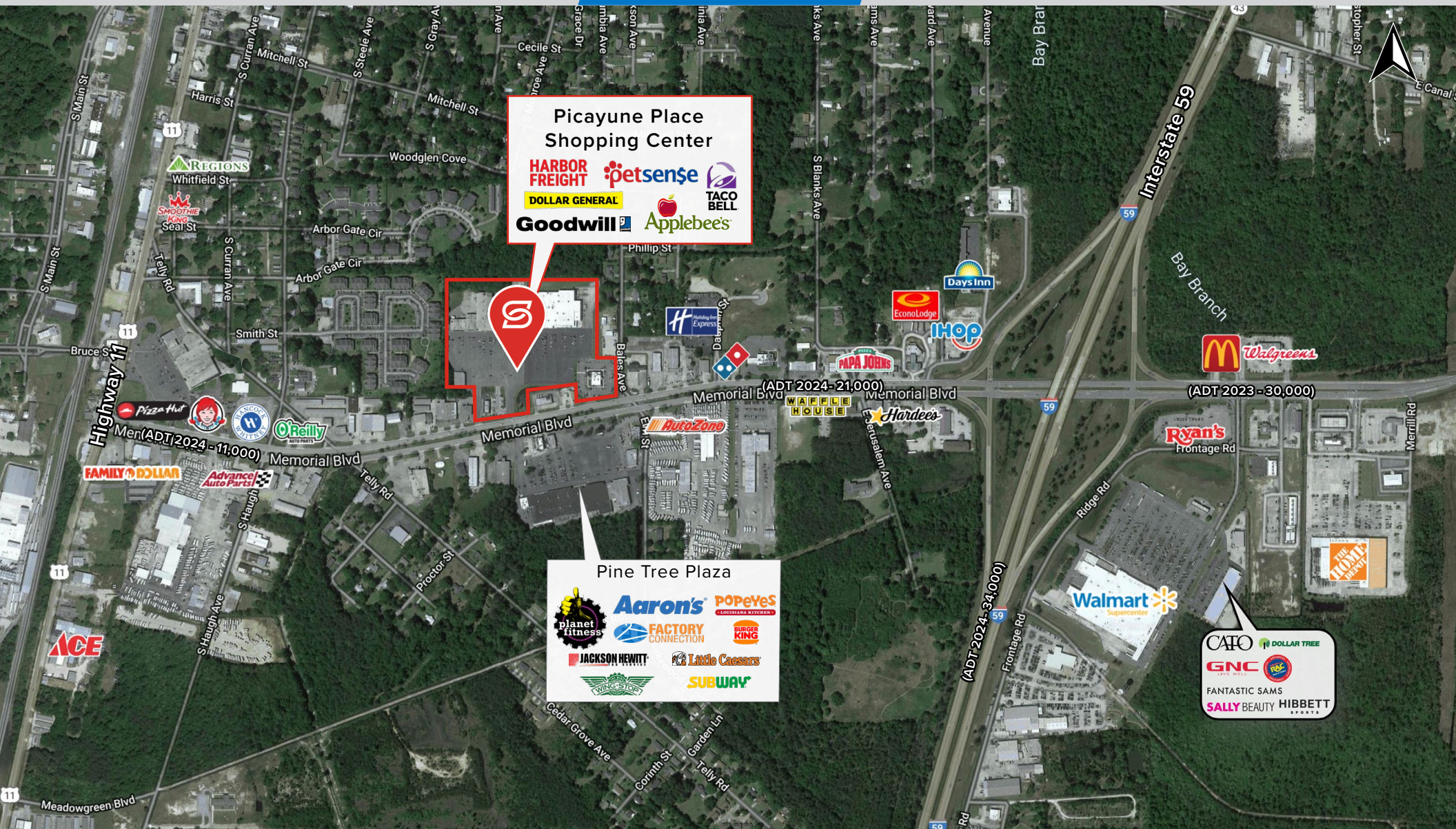

## SUMMARY

## SITE PLAN

## AERIAL

## PICAYUNE RETAIL MAP

## DEMOGRAPHICS



## SUMMARY

## SITE PLAN

## AERIAL

## PICAYUNE RETAIL MAP

## DEMOGRAPHICS

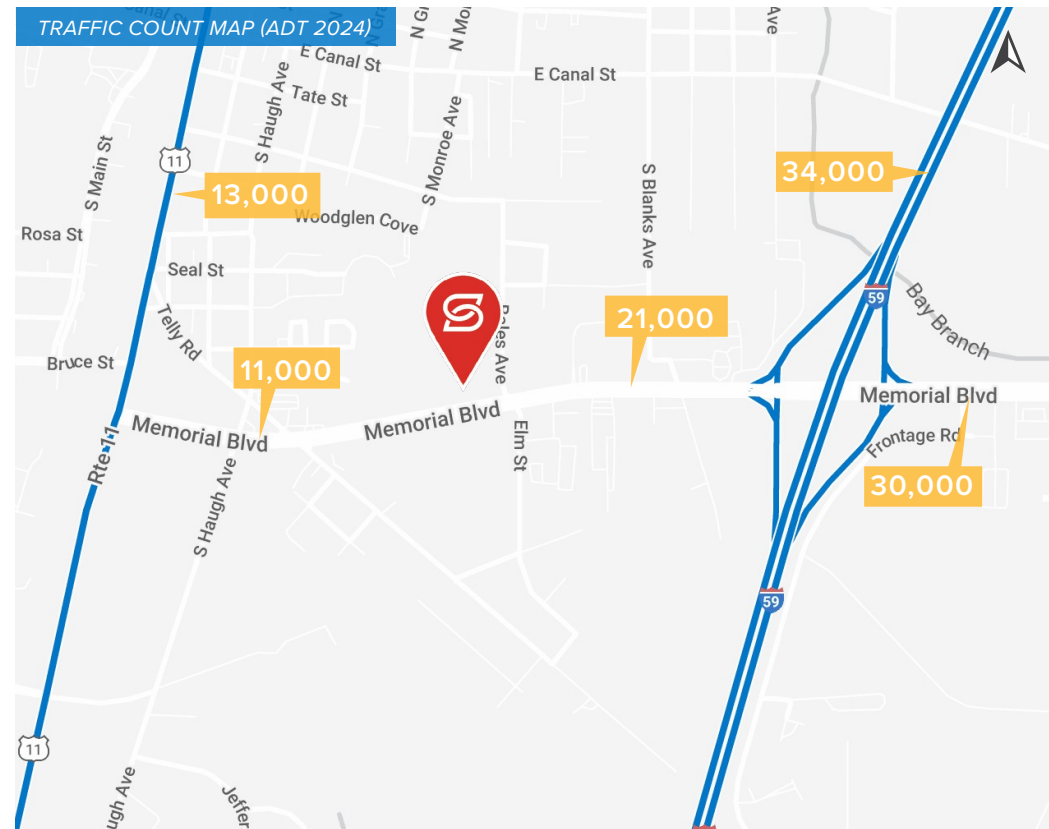
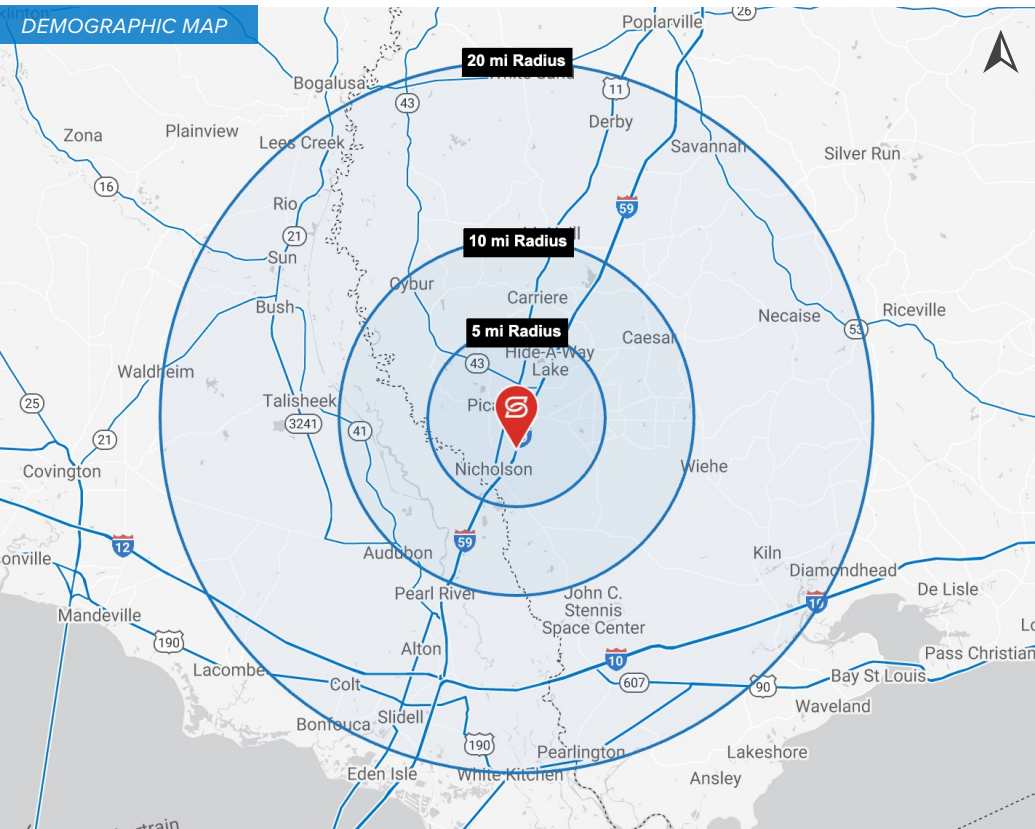

## 2025 DEMOGRAPHICS



POPULATION

	5 MI	10 MI	20 MI
POPULATION	22,871	44,241	172,963



AVG. HH INCOME

	5 MI	10 MI	20 MI
AVG. HH INCOME	\$68,688	\$78,374	\$90,471



HOUSEHOLDS

	5 MI	10 MI	20 MI
HOUSEHOLDS	9,273	17,420	67,708