

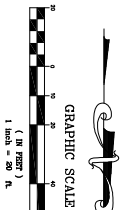

PRELIMINARY
FOR REVIEW & COMMENT

R. JAMES TATUM, P.E./P.L.S.
6920 NORTH MERCHANT COURT
BATON ROUGE, LA 70809
(225) 752.5555 (FAX) 752.5556

6-10-2022
DATE

[illegible]

	EXISTING SANITARY SEWER MANHOLE
	EXISTING JUNCTION BOX
	EXISTING TELEPHONE PEDESTAL
	EXISTING CATCH BASIN
	EXISTING RETICULENE GRATE INLET
	EXISTING GRATE INLET
	EXISTING TRANSFORMER
	EXISTING STORM DRAIN
	EXISTING LIGHT POLE

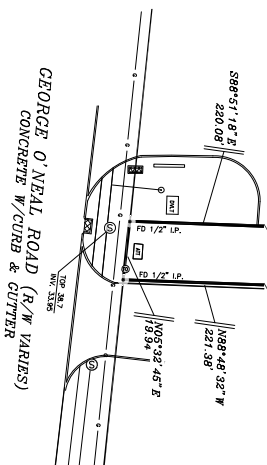

★ ★ CONFLICT WARNING NOTE :
THE CONTRACTOR SHOULD EXPECT CONFLICTS AND SHALL BE RESPONSIBLE FOR DETERMINING THE EXACT LOCATIONS, DEPTH, AND SIZE OF ALL UNDERGROUND UTILITIES AND STRUCTURES AND SHALL BE LIABLE FOR ANY DAMAGE CAUSED BY THE FAILURE TO DO SO. THE CONTRACTOR SHALL CONTACT LOUISIANA ONE CALL AT 1-800-272-3020 PRIOR TO BEGINNING ANY EXCAVATION OPERATION.

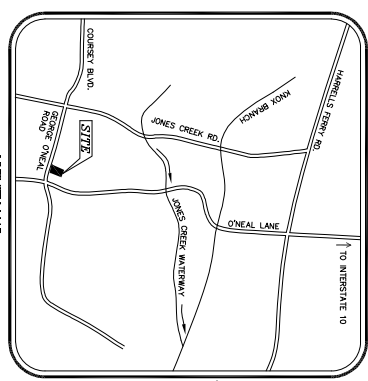
[illegible]

**#15801
REMAINDER OF
TRACT B-1A-2
(1.833 ACRES)**

COTTAGES AT O'NEAL

TRACT B-1-B-
EAL ESTATE & DE

ADDENDUM: DEPENDENT VARIABLE:

X IN TOP OF CURB, SOUTHEAST QUADRANT OF SITE
ELEVATION = 41.59 FT.

UTILITIES

[illegible]

VOIES :

[illegible]

LOCATED IN SECTION 52 & 53, T-7-S, R-2-E,
GREENSBURG LAND DISTRICT,
EAST BATON ROUGE PARISH, LOUISIANA

EXISTING CONDITIONS/DEMOLITION PLAN

EXISTING CONDITIONS/DEMOLITION PLAN LOCATION: 15801 GEORGE O'NEAL ROAD, BATON ROUGE DRAWN BY: BKP CHECKED BY: RJT COGO: W-2-14-20201 V2H-083 (JANIS_A.dwg) W.O. # 221-083	SHEET C-1
--	--------------

TATUM
ENGINEERING CONSULTANTS
BATON ROUGE, LOUISIANA
S. JAMES TATUM, INC.