

FOR LEASE

140 Congress Blvd, Duncan, SC 29334

NAI Earle Furman

\$5.95 SF/YR (NNN)



±3,600 SF to ±53,700 SF Available

- Suite A ±4,500 SF (±2,219 SF warehouse, ±2,281 SF office & 2 dock doors) Available 01.01.2021
- Suite B ±3,600 SF (±2,455 SF warehouse, ±1,145 SF office & 1 dock door) Available Now
- Suite E ±27,600 SF (±26,350 SF warehouse, ±1,250 SF office, 2 dock doors & 1 drive-in door) Available Now
- Suite G ±18,000 SF (±15,230 SF warehouse, ±2,770 SF office & 2 dock doors) Available 01.01.2021
- Combined space available now: ±31,200 SF
- Clear ceiling heights: 24' to 27'
- Fully sprinklered
- Located in Hillside Industrial Park, just off Hwy 290
- Convenient access to I-85 (Exit 63)
- Less than 10 miles to GSP International Airport & SC Inland Port

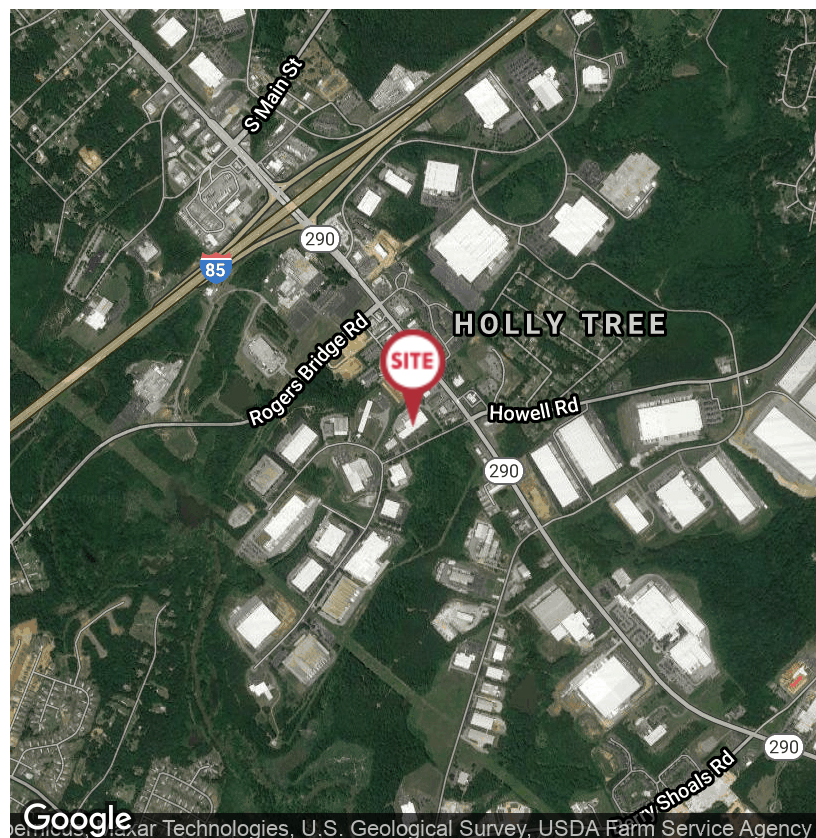

✉ **Joseph "Earle" Furman, Jr., SIOR**
O: +1 864 232 9040
C: +1 864 230 9102
efurman@naiearlefurman.com

No Warranty Or Representation, Express Or Implied, Is Made As To The Accuracy Of The Information Contained Herein, And The Same Is Submitted Subject To Errors, Omissions, Change Of Price, Rental Or Other Conditions, Prior Sale, Lease Or Financing, Or Withdrawal Without Notice, And Of Any Special Listing Conditions Imposed By Our Principals. No Warranties Or Representations Are Made As To The Condition Of The Property Or Any Hazards Contained Therein Are Any To Be Implied.

📍 **101 E Washington St**
Greenville, SC 29601
naief.com

FOR LEASE

140 Congress Blvd, Duncan, SC 29334

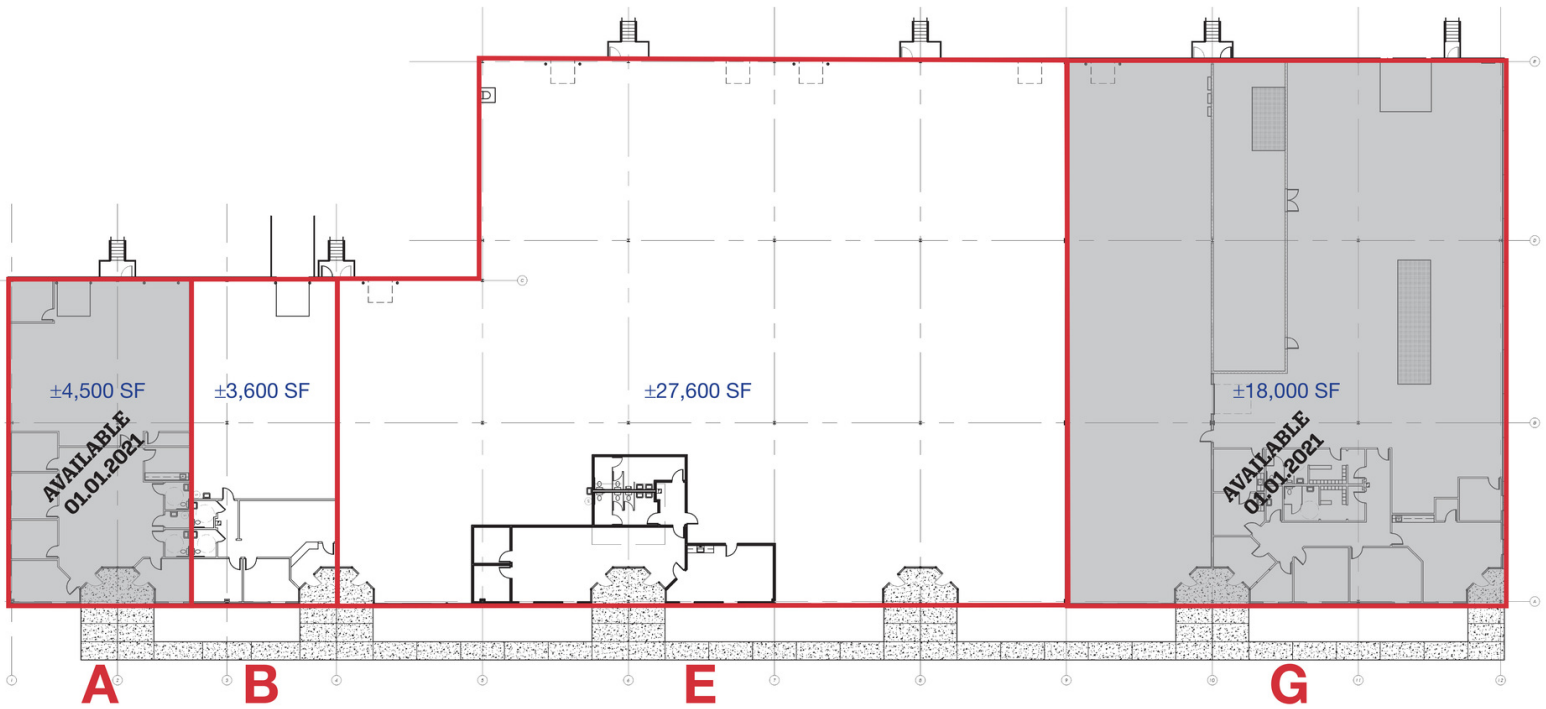

140 Congress Blvd, Duncan, SC
±53,700 Total SF



✉ Joseph "Earle" Furman, Jr., SIOR
O: +1 864 232 9040
C: +1 864 230 9102
efurman@naiearlefurman.com

No Warranty Or Representation, Express Or Implied, Is Made As To The Accuracy Of The Information Contained Herein, And The Same Is Submitted Subject To Errors, Omissions, Change Of Price, Rental Or Other Conditions, Prior Sale, Lease Or Financing, Or Withdrawal Without Notice, And Of Any Special Listing Conditions Imposed By Our Principals. No Warranties Or Representations Are Made As To The Condition Of The Property Or Any Hazards Contained Therein Are To Be Implied.

NAI Earle Furman