

FOR LEASE

107 Southchase Blvd, Fountain Inn, SC

NAI Earle Furman

STAG
INDUSTRIAL

\$3.85 SF/YR (NNN)



±42,000 SF Industrial Space

- Dock doors: 3 with levelers, locks & seals
- Drive-in door: 1 (16' x 12')
- Ceiling height: 24'
- Column spacing: 40' x 40'
- 100% wet sprinkler system
- Fully air conditioned / HVAC
- Lighting: LED
- Construction: Tilt wall concrete
- All utilities available
- Located in Southchase Industrial Park, a Class A industrial park off I-385
- ±19 miles from GSP International Airport

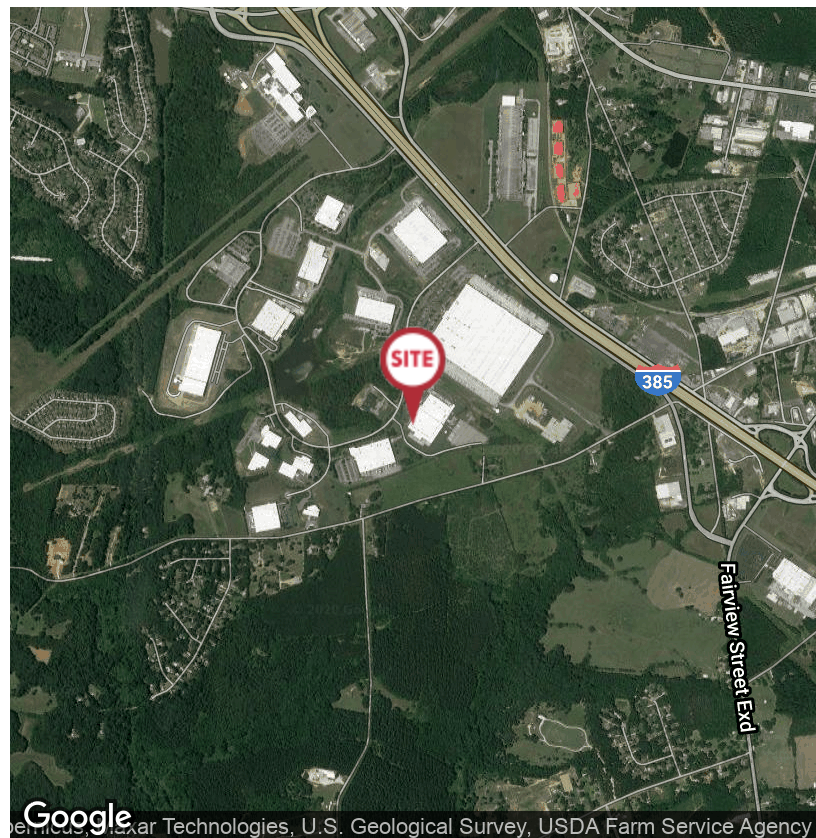

✉ **Grice Hunt, SIOR**
O: +1 864 678 5935
C: +1 864 346 7611
grice@naiearlefurman.com

✉ **Clay Williams**
O: +1 864 678 5938
C: +1 864 706 7622
clay@naiearlefurman.com

✉ **Ford Borders, SIOR**
O: +1 864 678 5943
C: +1 864 270 1010
fborders@naiearlefurman.com

📍 **101 E Washington St**
Greenville, SC 29601
naief.com

Floor Plan

107 Southchase Blvd, Fountain Inn, SC

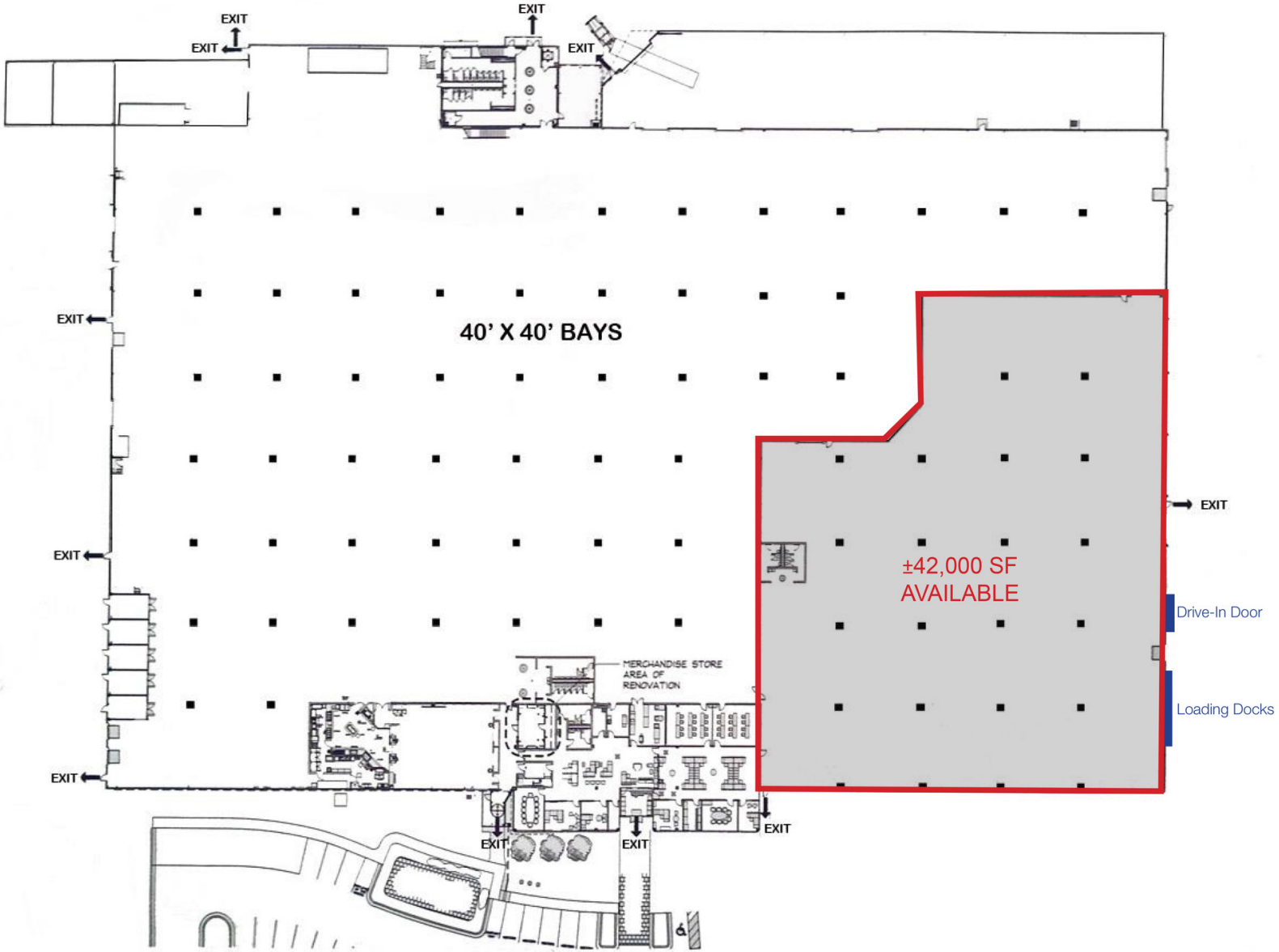

✉ Grice Hunt, SIOR
O: +1 864 678 5935
C: +1 864 346 7611
grice@naiearlefurman.com

✉ Clay Williams
O: +1 864 678 5938
C: +1 864 706 7622
clay@naiearlefurman.com

✉ Ford Borders, SIOR
O: +1 864 678 5943
C: +1 864 270 1010
fborders@naiearlefurman.com

NAI Earle Furman

STAG
INDUSTRIAL

Local Map

107 Southchase Blvd, Fountain Inn, SC

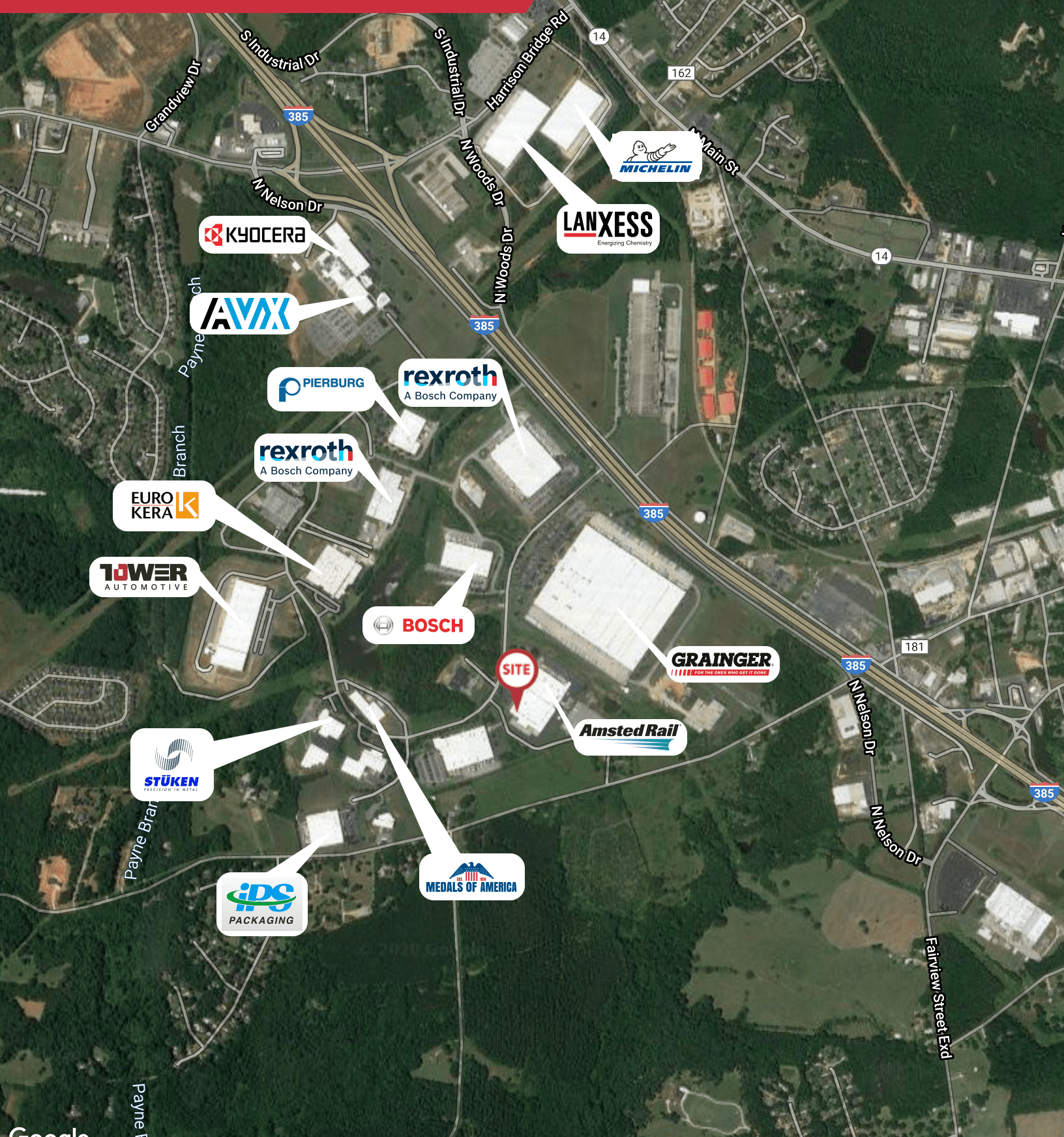

Google

Map data ©2020 Imagery ©2020, Maxar Technologies, U.S. Geological Survey, USDA Farm Service Agency

✉ Grice Hunt, SIOR
O: +1 864 678 5935
C: +1 864 346 7611
grice@naiearlefurman.com

✉ Clay Williams
O: +1 864 678 5938
C: +1 864 706 7622
clay@naiearlefurman.com

✉ Ford Borders, SIOR
O: +1 864 678 5943
C: +1 864 270 1010
fborders@naiearlefurman.com

NAI Earle Furman

STAG
INDUSTRIAL