

URBANITY



WATER CLOSET

PRODUCT ID

(RB.UNY.03G109.01.08 / RB.TAB.0FS210.ME.PA / RB.TUN.0PA661.DU.01)

A vitreous china wall hung, back to wall Water Closet suite, featuring a wash down 4.5/3 litre concealed dual flushing system.

FEATURES

- Vitreous China wall hung water closet
- Contemporary design
- Concealed flushing mechanism with duo water saving buttons
- Fully glazed trap way
- 100% factory vacuum tested

INCLUDED COMPONENTS

- Seat and cover

WARRANTY

- 25 year written warranty against crazing and dunting

STANDARDS APPLICABLE

Specified model meets or exceeds the following:

- BS 3402 : 1969
- BS EN 997 : 2012
- BS EN 33 : 2011

SEAT AND SEAT COVER

Product ID - Duraplex : RB.TES.0PA661.DU.01

- Ergonomically designed duraplex seat and cover with soft closing and quick release mechanism
- Soft close (controlled seat fall) – the seat cover closes slowly with no intervention by the user
- Seat and cover are strong, burn and scratch resistant, totally water proof
- Stainless steel hinges
- Quick release mechanism with lift off hinge design for easy cleaning
- UV protection



URBANITY WATER CLOSET

TECHNICAL INFORMATION

** Approximate measurements for comparison only

CONFIGURATION	WALL HUNG WATER CLOSET
Water per flush	4.5L of water for solid waste and 3L of water for liquid waste
Water depth from rim	205 mm
Trap diameter	97-102 mm
Distance from floor to waste outlet centre	235 mm
Distance between seat post hole centres	180 mm
Bowl Size	325 X 265 X 170 mm
Nominal Dimensions	545 X 360 X 370 mm
Weight (WC)	25 kg

TECHNICAL DRAWINGS

All drawings contain the necessary measurements, which are subject to standard tolerances. They are stated in mm, are drawn on a scale of 1:20 and are non-binding. Exact measurements, in particular for customized installation scenarios, can only be taken from the finished ceramic piece.

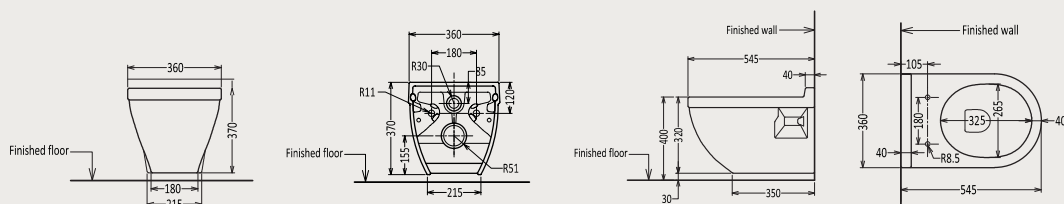

INSTALLATION NOTES

- 97 - 107 mm waste outlet is required for this installation. Waste out let fittings are included within concealed tank unit.
- Install this product according to the installation guide
- Scan for instructions



Royal Ceramics Lanka PLC.

No.20, R.A. De Mel Mawatha, Colombo 03, Sri Lanka.

☎ 076 6 223 344 ✉ info@rcl.lk 🌐 www.rocell.com

FOLLOW US



** Dimensions of fixtures are nominal and may vary within the range of tolerance. These measurements are subject to change or cancellation. No responsibility is assumed for use of superseded or voided leaflet.