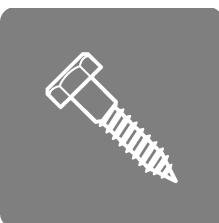

Required Tools Accompanying Logos Referenced within Instructions

Level 	Safety Glasses 	Drill 
Fasteners 	Helper 	Tape Measure 

Step 1 Initial Examination

Inspect the crate for any damages.

If any damages are present on the crate, please contact Signmonkey.com immediately prior to signing for the sign.

Unpack the power connection.

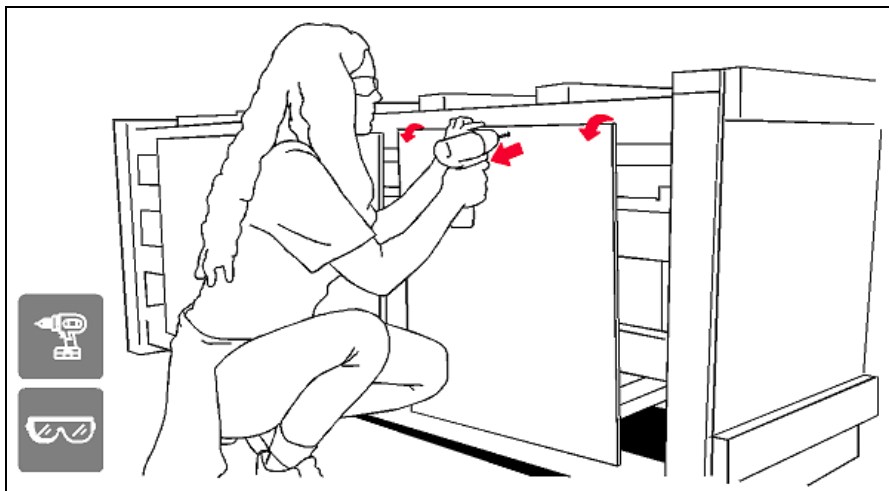

Step 2 Wall Preparation

Measure from the end of the raceway to the power hole.

In most cases this is 10 inches for the end of the raceway and 4.5 inches down from the top of the flange.

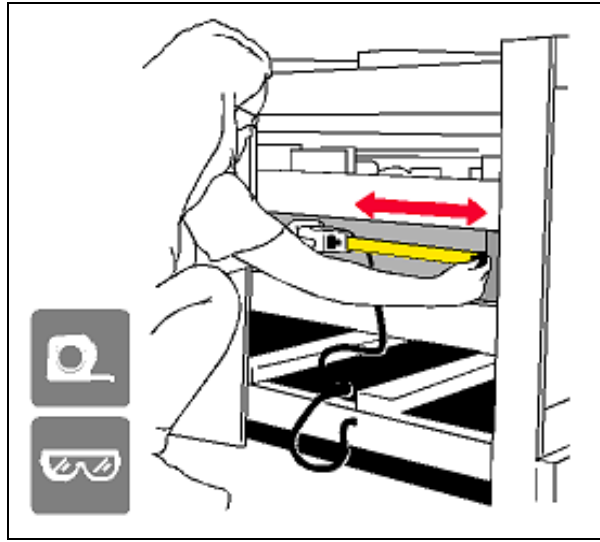

Remove the boards from the top of the crate.

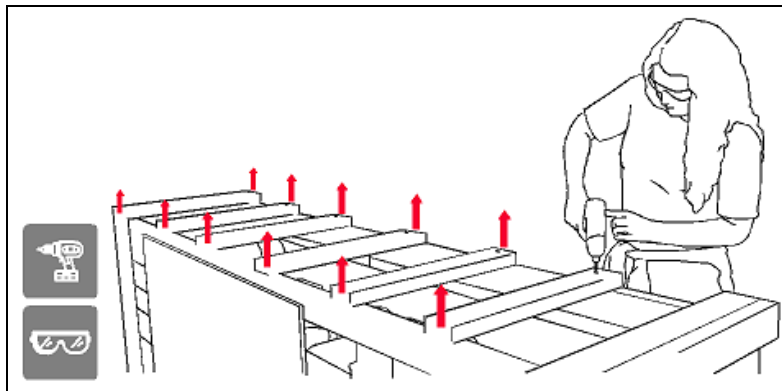

Measure the overall length of the raceway to determine its physical center.

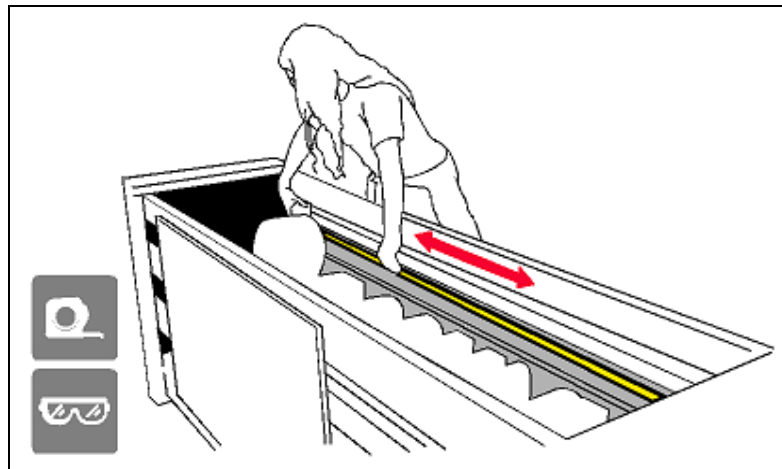

Place a piece of easily removable tape onto the wall at the center location of the raceway. From this point measure over until the edge of the raceway, where another piece of tape should be placed.

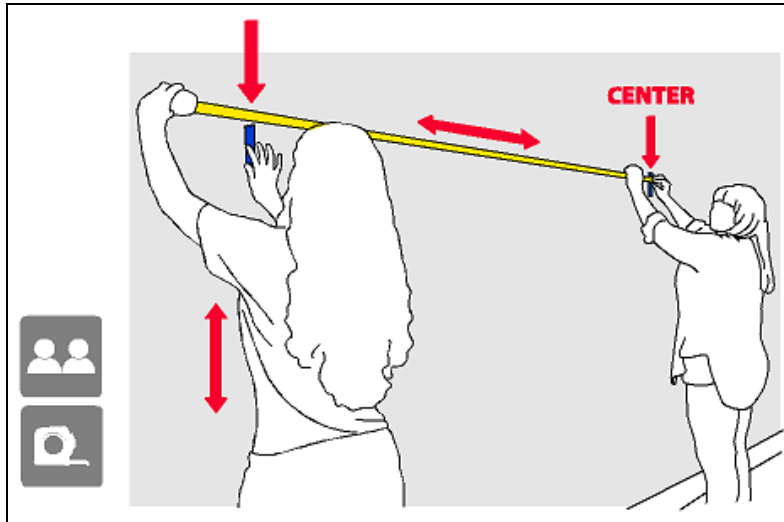

Using the measurement taken from the end of the raceway to the power hole, and the previously established edge, locate and mark the location of the power hole.

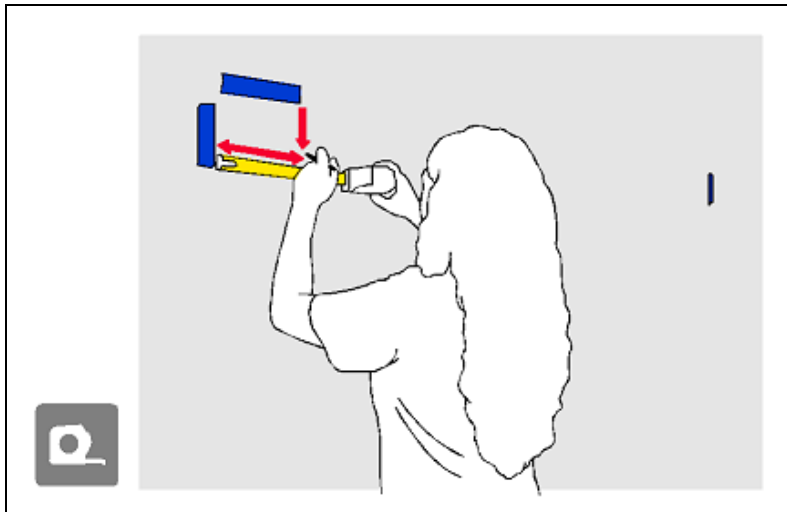

Determine the location of the first mounting hole according to the length and size of your raceway.

Additional information on the location of this mounting hole and the spacing between additional mounting holes can be found in our mounting suggestions document in addition to the installation video.

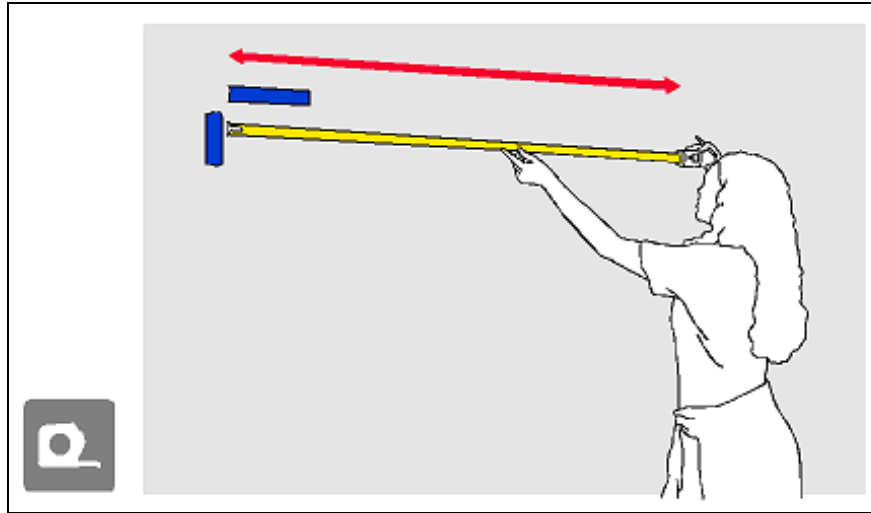

Pre-drill the power hole and the established first mounting hole.

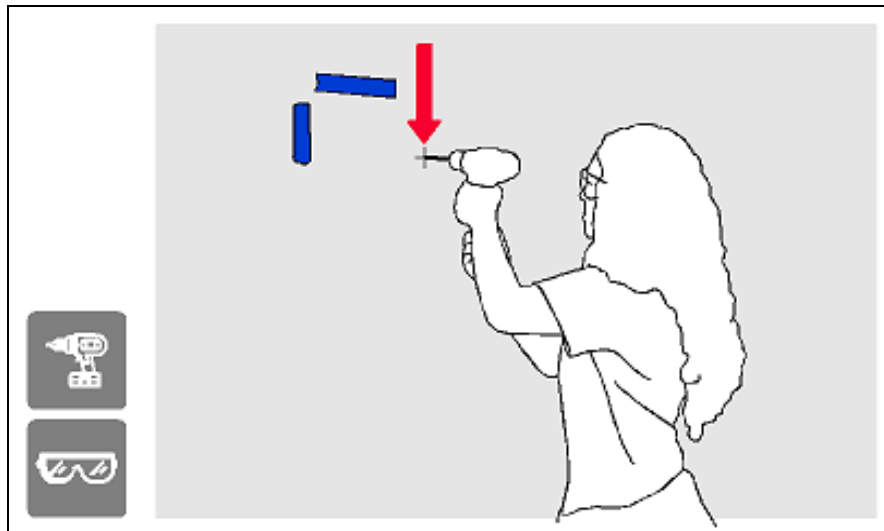

Step 3 Unpacking and Installation of Raceway(s)

Unscrew the raceway's mounting lip from the crate.

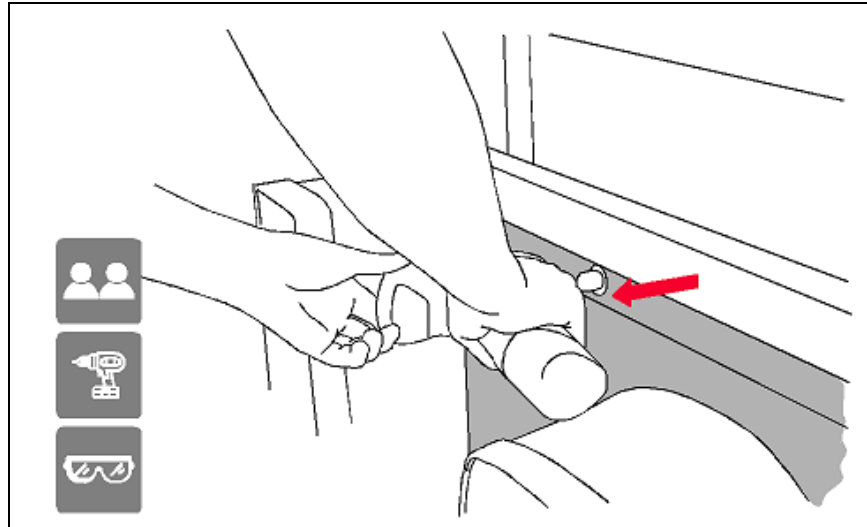

Remove the raceway from the crate, ensuring that the sign is lifted by the raceway itself.

CAUTION: Do NOT lift the sign from the letters themselves. Our signs are built to a high quality, but the individual letters are not designed to support the weight of the entire sign.

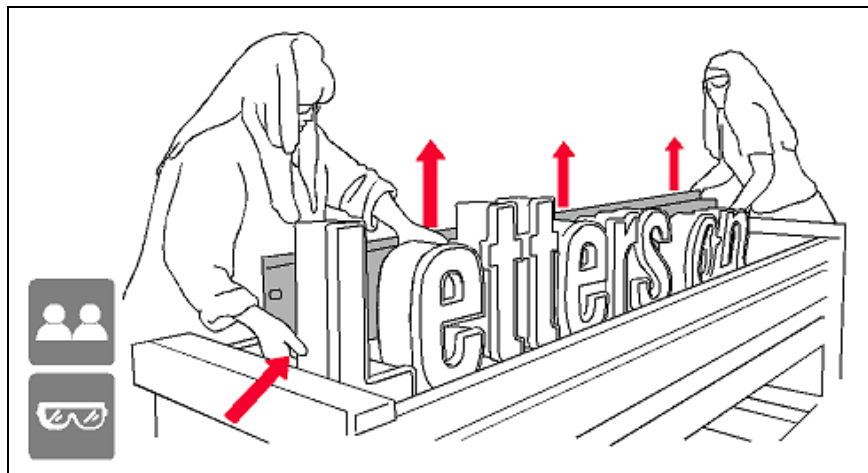

Slide the power wires through the pre-drilled power hole in the wall.

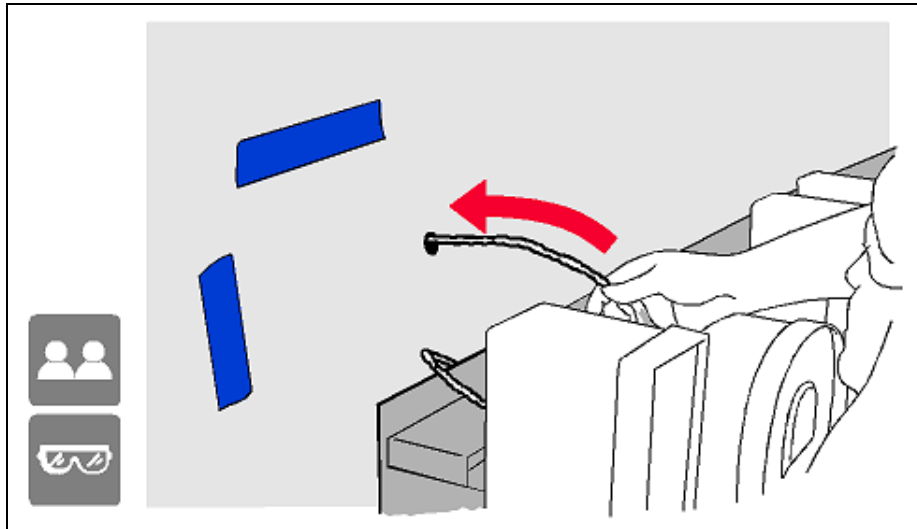

Begin mounting the raceway to the wall through the pre-drilled mounting hole.

Suggestions for fasteners can be found within the literature located on the website.

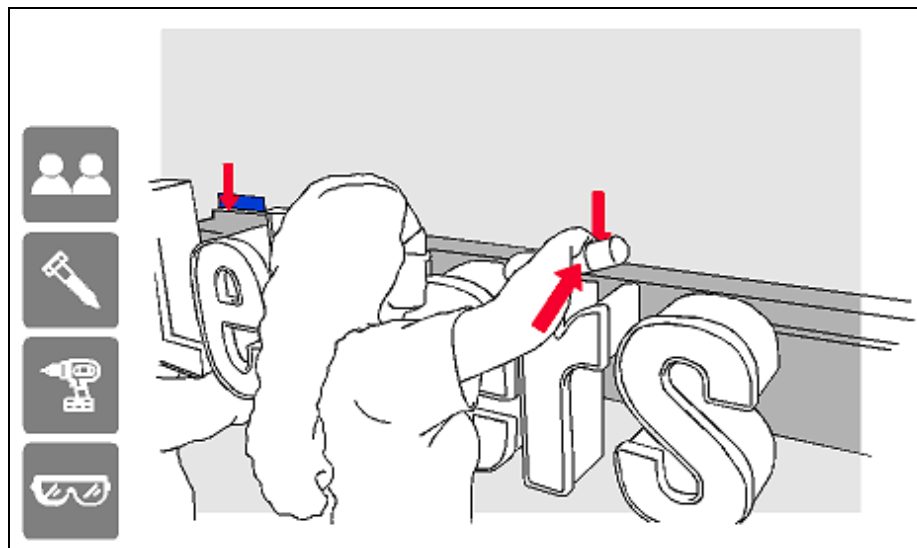

With your helper holding the other end, make connections between any adjoining raceways and slide the ends together.

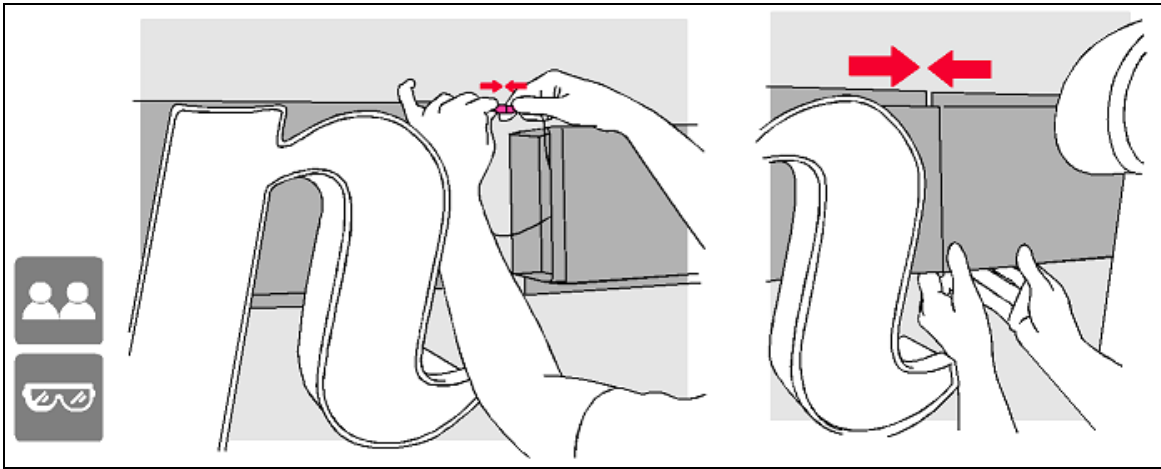

Mount each additional raceway to the wall after leveling to the raceway directly before it. Continue installing all the mounting screws through the top and bottom flange.

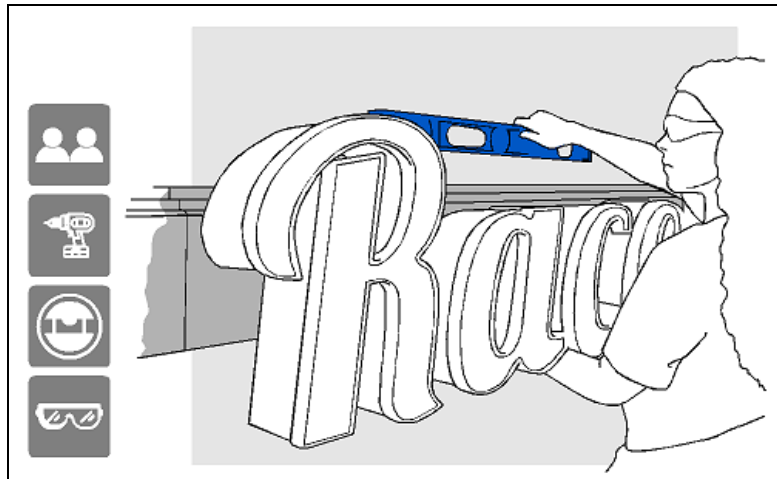

Make the final connection to your power source

Turn your sign on. (You're Done!)