



ST COLMAN'S

HIGH & SIXTH FORM COLLEGE

BALLYNAHINCH

Prospectus



**We are a caring and committed multi-faith school,
confident in meeting the needs of every child.**

Principal's Welcome

Dear Parent/ P7 Student,

Every parent wants the best for their child. That is why choosing a post-primary school where they will spend most of their time as teenagers is such an important decision.

The Governors, pupils and staff of St Colman's are delighted to introduce ourselves and our school in this prospectus. St Colman's is a co-educational school which meets the needs of students from a wide area both rural and urban from the ages of 11 to 19 years.

At St Colman's we believe that happy, contented children will enjoy learning. We achieve this by ensuring that all staff are committed to meeting the needs of every child both pastorally and academically.

The most recent Education and Training Inspectorate report classified St Colman's High & Sixth Form College as 'very good' and the sustained outstanding performance of GCSE (92% 5 A*-C in 2015) places St Colman's in the top ten of non-selective schools in Northern Ireland.



Vice Principal and Friends of St Colman's

Continued capital investment by the school Trustees and Governors has provided a comfortable, safe and well-equipped learning environment providing opportunities to challenge each student academically, physically, spiritually and emotionally.

A vast range of extra-curricular experience enables our students to develop inquiring minds, to question and argue rationally and acquire qualities of self-reliance, self-discipline and self-confidence.

The right school for your child is the one that will contribute positively to their development, academic results and general well-being.

It is with a great sense of pride that we present this prospectus to you for your consideration before you visit us and experience the quality of provision on offer.

Yours Sincerely,

Mr. M. Morgan

MSc, BEd, Cert. Ed., DASE., Dip Sc., PQH.



**Vice Principal
Mrs Carol Potter**



**Friends of St Colman's
Chairperson
Mrs Jackie O'Rourke**

The Story Behind Our Badge

Traditionally school crests have been inspired by geographical or architectural landmarks within their locality, significant local historical events or even by the heraldic coats of arms of distinguished local families. These badges are designed to foster pride in the students for the achievements of their school and the surrounding area so that they too wish to emulate and build upon proud traditions.

The challenge for St Colman's in the design of its new identity was the creation of a brand that not only retains the more traditional core values of Christianity and academia but also one that embraces our ethos of nurturing and supporting all our students to thrive in the modern world. Furthermore we wished for a design which also encapsulated the various pathways taken by our Sixth Year students.

During the development of the school's new crest, key terms used to describe the school's identity and ethos were explored. They fell into two categories: Industry - outwardly exploring what the school's 'business' is, and Values - inwardly considering the school's concerns for its students on a social and interpersonal level.

The final crest conveys each of the key terms through the abstraction of individual elements that act as metaphors. A modern layered approach was adopted. The combination of abstraction and contemporary layering promotes unison of these elements and their respective values. As such, the design chooses not to focus on individual elements but the crest as a whole with the abstraction allowing the viewer to select and focus on what values are important to them.

Working from the back forwards the key components are; shield/Latin scroll, Christian cross, blades of a windmill, glass leading and a flower. Each item or combination of items has been selected for a specific role.

The shield is representative of strength and unison of the school whereby the teachers and students work together to create strength in learning, whilst the Latin scroll helps to emphasise the importance of academia and history.

The cross is representative of St Colman's Christian values being at its core, and its strong links in the local community. These values assist not only helping students focus on more traditional learning but also to develop interpersonal and social skills within their community, school and later, workplace.

The windmill blades form an architectural metaphor that works with the school's very direct Latin motto of 'Facta Non Verba' (Deeds not words). One interpretation suggests 'we can all have knowledge but it's what we do with that knowledge that counts'. The windmill blades are representative of the local landmark 'The Windmill Tower of Ballynahinch'. The windmill is a strong metaphor for the school and its industrious work ethic.

Glass leading and the flower, possibly most important of all is the care for the students' well-being. Of paramount importance is St Colman's pastoral care of its students. Without the school's strong emphasis on the students' mental and physical welfare, it becomes just a business. The flower is a strong visual metaphor representing the 'crop' we yield as the students leave our doors. It signifies their: learning; industry, hard work, diligence, focus, academia and vocation. These combined with the care, empathy and community they experience in St Colman's will help them grow and blossom.

To summarise, a school is an infinitely complex thing. Not a machine, not a business, but somewhere to learn and to grow in a safe and positive environment. We are proud that these concepts are reflected in our crest.

Present Pupil Contributions



My name is Reuben Lavery and I am a Year 8 student at St Colman's High and Sixth Form College, Ballynahinch. I came from St. Patrick's Primary School, Ballynahinch and was so impressed by the range of activities the Principal and staff offer including: Languages and Home Economics. In P7, I was particularly excited about learning in class and at home using my very own iPad.

I think St Colman's is an extraordinary school because you get to meet lots of new friends from so many different primary schools and the teachers are so kind.

If I had to sum St Colman's up in one word it would have to be; 'Fantastic!'.

My name is Hannah Younger and I am a Year 14 student at St Colman's High and Sixth Form College, Ballynahinch. For two years now I have had the privilege of being a Senior Prefect on the Senior Leadership Team.

Previously, I attended Saintfield High School for five years and decided I wanted to attend St Colman's to study A' Level Double Award Health and Social Care and Sociology.

When I first arrived in St Colman's I was anxious and frightened that I was alone. However, those feelings immediately subsided as I was warmly welcomed into a caring, supportive and loving school community.

Overall, I have had unbelievable, adventurous life experiences that I will treasure for a lifetime, from travelling to Belgium with the Comenius Project to Mentoring Year 8 pupils with our Student Council.

Now, I have developed many friendships with individuals of various ages, faiths and cultural beliefs. Reflecting back, I can proudly say that I did make the right choice in choosing St Colman's for Sixth Form Provision.



Community



St Colman's takes its position in the community very seriously. We realise some of our pupils will travel the world, while others settle nearby. Wherever their location we encourage our pupils to be part of their community through: volunteering, fund raising, charity work, community fun days and local sporting clubs. St Colman's makes its site readily available to many local community groups with Zumba, auto testing, Irish dancing, Rugby, Hockey, Soccer and Gaelic clubs regularly using our site and facilities.

We believe that we offer a unique learning environment, where pastoral care and pupil wellbeing are as equally important as examination grades and yet we can still achieve top 10 status among non-selective secondary schools in Northern Ireland.

We offer such a unique package that you will be pleasantly surprised when you see the variety and 'reach' of our contributory primary schools. We have over 38 at present from as far as: Belfast, Lisburn, Killyleagh, Ardlough, Downpatrick, Newcastle, Dromara, Saintfield and Ballygowan.



Contributory Primary Schools

The reputation of St Colman's is based on its academic achievements, the behaviour standards of students and the friendly atmosphere within the school. This reputation is reflected in the ever-growing number of contributory primary schools.

At present, some of these include:



Multi-Faith Based Education

It has been a rewarding experience to welcome students from other faiths to our school. Within our current student body we have members of the Baptist Church, Church of Ireland, Congregational Church, Methodist Church, Presbyterian Church, Roman Catholic Church, Seventh Day Adventist Church and other Christian Churches.

The Religious Education programme delivered at Key Stage 3 in our school affords our pupils with the opportunity to learn about all branches of Christianity and also the major World Religions such as Judaism and Islam.

We continue to be proud of our Catholic identity. Therefore we celebrate the key liturgical festivals throughout the year including: Advent, Lent and Holy Week.

As a school we have come to realise that in an increasingly secular society, many parents wish their child to have some instruction in faith matters rather than no faith at all.

As we move forward as a multi-faith based school, we continue to foster respect, dignity and mutual understanding amongst our students, while also enabling pupils to keep their own faith identity.



Beliefs and Cultural Heritage

In St Colman's we want our pupils to feel valued, unique and responsible young men and women. We encourage team building and the formation of friendships, respect for each other's beliefs and cultural heritage. Most of all we want our students to be happy.



Curriculum



Our aims are to:

- help all pupils to reach their full potential in academic as well as personal targets;
- develop and nurture Christian attitudes which will enable our students to be part of a caring and Just Society;
- help our pupils realise their uniqueness and self worth and how beneficial they are and will be to our community;
- create mature, respectful and confident, self-motivated students.

To achieve these aims, we offer our students the widest possible range of subjects to enhance and broaden their learning. Our ambition is to provide our learners with lifelong skills and qualities that will prepare them for the world of work and adulthood.

Key Stage 3 Subjects on offer include:

- The Arts
- **Art & Design**
- Music
- **English**
- English Literature
- **Literacy**
- Mathematics
- **Numeracy**
- Environment & Society
- **History**
- Geography
- **Science & Technology**
- **Religious Education**
- Additional Mathematics
- **ICT**
- Physical Education
- **Modern Languages**
- French
- **Spanish**
- Relationships & Sexuality Education
- **Personal Development**
- Local & Global Citizenship
- **Education for Employability**



Key Stage 4

Subjects available in Years 11 and 12 are divided into a compulsory core and a range of optional subjects chosen from two groups. Under the SEP (Shared Education Programme) joint classes are undertaken in some subjects with The High School, Ballynahinch.

Currently, St Colman's offers a range of academic as well as vocational subjects, which strive to meet the future career prospects of all our students. Students taking vocational subjects can take courses such as; Hairdressing, Beauty therapy, Plumbing, Carpentry, Patisserie and Motor Vehicle Servicing.



Sixth Form Provision



Sixth Form Provision



In terms of Sixth Form College provision, St Colman's offers one of the widest ranges of subjects in the Co. Down area. St Colman's have always recognised the importance of balance between academic and vocational subjects. This balance enables us to tailor provision to every individual student. With over thirty subjects at Level 2 and 3 to choose from, our highly skilled teachers and Tutors specialise in post-16 education, delivering excellent teaching and learning.

Some subjects are offered in collaboration with The Assumption Grammar School which is an important contribution to the Ballynahinch Area Learning Community. Combined with their academic studies, students are required over the two-year course to participate in our Enrichment Programme.

Our Careers Advisor works with students to ensure successful applications are made to colleges and universities. We regularly have students accepted at Queen's, University of Ulster and other top third level establishments. Students also attend higher education fairs and open days.

Sixth Form Subjects include:

Agriculture & Land Use

Applied Business

Applied ICT

Art & Design

Biology

BTEC Applied Science

BTEC Construction

BTEC Horticulture

BTEC Vehicle Technology

Business Studies

Chemistry

Child Care

Child Development

Computing

**Certificate of Personal
Effectiveness (CoPE)**

Drama

Economics

English Language

English Literature

Essential Skills

Communication

Essential Skills

Application of Number

French

Further Maths

Geography

Government & Politics

Health & Social Care

History of Art

Home Economics

Hospitality

ICT

Irish

Journalism

Key Skills

**Improving Own
Learning**

**Key Skills in
Problem Solving**

**Learning for Life
and Work**

Maths

Media Studies

Moving Image Arts

Music

MVRUS

NVQ Beauty

NVQ Hairdressing

**Occupational
Studies**

OCN Level 2

Personal Success

Physical Education

Physics

Polish

Psychology

Performing Skills

Personal

Effectiveness

Religious Studies

Sociology

Spanish

Statistics

**Technology &
Design**

Travel & Tourism



Literacy

At the heart of our teaching strategies is the question:

"How can I best meet the needs of the learners in front of me?"

A positive disposition towards listening, speaking, reading and writing is promoted as a means of advancing learning. A range of initiatives are organised to promote a positive view of literacy. These include: celebrating Laureates, Newspaper Reading Clubs and the ability to access a world wide range of literature using digital literacy.



Local author Garry McKinney discussing his new book 'Travis the Time Traveller and the terrifying Titanic'.

Library

Reading and Education are one in the same. St Colman's School Library is a comfortable and bright learning centre where all students can access most books of their choice.

The Librarian ensures that the library remains fully stocked and accessible and helps promote an individual and reflective learning environment. The Library is open from 8.00 am until 4.30 pm each day.

Numeracy

Numeracy is very important in St Colman's as it is a vital skill which all pupils need a certain level of proficiency in to cope with the numerical demands in everyday life and throughout school subjects.

At St Colman's Years 8 and 10 students have a specific Numeracy class during which time they are given opportunities to develop their numeracy skills. This time is made flexible to address the needs and requests of the pupils.

Pupils are encouraged to become more responsible for their own learning through the provision of a Mathematics Glossary and Numeracy Mat to KS3 pupils. Year 8 and Year 10 pupils have also been given access to Mathletics, an educational and interactive iPad app. This app provides both online and offline practice and enables parents to become involved in supporting their child's Numeracy development.



Student Leadership in St. Colman's

School Council

The Student Voice is an essential component of St. Colman's ethos.

The Student Voice and School Council help support the pastoral life of the school and contribute greatly to important issues that affect our student's daily.

The School Council is integral to ensuring that important events and issues are recognised and supported. Some of the appeals supported by our School Council are:

- The Trocaire Appeal
- Red Nose Day
- Children In Need
- Disaster Appeals
- Macmillan Nurses

The School Council comprises of the Head Girl, Head Boy and their Deputies and Prefects. Other students are elected by their peers from each year group.

All elected representatives are trained for their role and meet with a Senior Teacher one Wednesday afternoon, each month.



Past Pupil Contribution from Callum Kane



My name is Callum Kane and I am a first year student at Queen's University Belfast. I am studying a BSc in Psychology and intend to complete a Master's Degree in Forensic Psychology. I plan to travel to America to study for one year as part of my degree.

I am proud to say I was a pupil of St. Colman's High and Sixth form College for 7 years and my time at the school equipped me with the necessary knowledge, confidence, motivation and skills needed to achieve my personal goal to progress to higher education. From the moment I walked through the doors of St Colman's I was encouraged to excel and strive to be the best I could be. I found the school to be warm and welcoming and quickly made friends, many of whom I continue to be close friends with today and attend University with. My teachers expected me to do well and

this fuelled my motivation. I felt well supported and often felt they went that extra mile to ensure I had the support I needed to achieve the best results for me. They took time to explain assignments and they often spent time after school helping me around exam times recognising the stress I was under and helping reduce anxieties. The school worked closely with my parents and their contributions were acknowledged and listened to. I achieved excellent results in my GCSE and A' levels and everyone's hard work paid off.

St Colman's afforded me the opportunity to take part in extra-curricular activities and I was more than happy to avail of as much a rounded school experience as I could. I took part in the Comenius Exchange Programme which gave me the opportunity to travel to Belgium and live with a family for a week. I took part in the Duke of Edinburgh award programme and achieved a silver award. Both these experiences increased my confidence and exposure to different challenges while building on different skills. This has all contributed to making my transition to higher education and all that that entails a more positive and less daunting experience.



Callum Kane's A' Level Art masterpiece for CCEA's 'True Colours' exhibition.

Pastoral Care



Pastoral Care

In St Colman's there is mutually close and supportive alignment of the pastoral and academic. There is a climate of ambition and support that enables all pupils to achieve to their full potential across a broad and balanced curriculum of academic subjects, sporting endeavours and cultural enrichment. The pastoral structures in St Colman's ensure that the needs of pupils are addressed swiftly, efficiently and effectively.

Form Teacher

Each pupil has a Form Teacher who has responsibility to know individuals in depth. Pupils meet their Form Teacher every day and receive guidance, encouragement and help as a matter of course. The Form Teacher monitors the pupil's progress and is the first contact for parents in the need to contact the school.

Year Teacher

The Year Teacher has responsibility for the pastoral care of pupils across the whole year group. There is a close working alliance between Year Heads and Form Teachers. Year Heads devise and ensure that pastoral programmes are implemented by Form Teachers.

Trained Counsellors

Whilst there are trained counsellors on the teaching staff pupils are supported by professional counsellors who can be accessed through the Head of Pastoral Care. Pupils are encouraged to seek help for issues, embrace positive self-management and develop their confidence and capabilities.

Guidance

The school has a broad range of pastoral programmes designed to develop maturity, encourage thinking skills and personal capabilities and enrich the lives and opportunities for all in St Colman's.

Copies of
School
Policies are
available on
request

Special Educational Needs

The term 'special educational needs' has a legal definition, referring to children who have learning difficulties or disabilities that make it harder for them to learn than most children of the same age. Many children will have special needs of some kind at some time during their education.

St Colman's recognises that Special Educational Needs cover a wide spectrum of type, duration and severity. We aim to create and maintain a positive learning environment for every child. To ensure this each child has access to a full, broad and balanced curriculum and equal opportunities to achieve. All students with Special Educational Needs (SEN) are identified and assessed as early as possible and support provided throughout their years in school. Every child in St Colman's has the opportunity to develop an appropriate sense of self-esteem and we employ a range of appropriate strategies/resources for teaching, learning and assessment. We foster a good working relationship between parents, school and outside agencies ensuring that adequate provision is made for all children. Learning Support in St Colman's involves all staff and is led by the SENCO.

Provision for children includes:

- Regular training for all staff
- In class support
- Classroom Assistants
- Computer access
- Differentiated teaching/resources/assessments
- Differentiated curriculum
- Outside agencies
- Exam allowances
- Additional literacy/numeracy
- Individual Education Plans



Extra- Curricular



At St Colman's we feel pupil welfare and academic success go hand in hand. A wide range of extracurricular options and opportunities are available to enable our students to balance their school life.

At Post 16 the enrichment programme is compulsory and provides a welcome balance to a hard week's study and revision.

Previous trips include:

- Ski Trips
- Old Trafford
- Tayto Factory
- Art Visits
- Coca-cola Factory
- Cinema Trips
- Historical Tours
- English Cinemagic
- Duke of Edinburgh
- Streamvale Farm
- UTV Live
- The Grand Opera House, Belfast
- Houses of Parliament, London
- Comenius Project in Belgium, Sicily, Poland and Spain.



Comenius Exchange Programme



St Colman's previously participated in the Comenius Project which involved multilateral partnerships between our school and six other European Schools, namely in Belgium, Sicily, France, England and Poland. From 2012-2014 our project was named 'European Mobile School'. The aim of this project was to 'work together, play together and stay together'.

The project involves Christmas box exchanges to all our partner schools, live online chats via Skype, exchanges to Belgium, visiting the European Mobile School in Blankenberge and, our Year 14 pupils hosting their Belgian partners in September.

During hosting week, our Belgian partners visited Northern Ireland and were involved in cultural visits to the Giant's Causeway, the Mournes, Belfast City and Dublin to name a few.



The President/ Duke of Edinburgh Awards



The Duke of Edinburgh award programme has been designed to introduce our pupils to worthwhile leisure activities and voluntary service. It serves to challenge our pupils to discover the satisfaction of achievement in a non-competitive environment. Pupils will gain self-confidence, skills and aspirations by following the programme through to completion. Our Silver award programme is designed so that it is achievable by all whilst developing independence of thought and action, respect and understanding and the ability to lead and work as part of a team.

All pupils undertake four key sections namely volunteering, skills, physical and expedition, each with their own timescales and programme objectives as a licensed organisation.



St Colman's fully encourage and inspire our Year 13 pupils at every stage of their adventure, recognising and rewarding their achievement.

The BALC Learning Community

The Ballynahinch Area Learning Community is a partnership of four schools:

- Assumption Grammar School;
- The High School Ballynahinch;
- St Colmcilles High School;
- St Colman's Ballynahinch and;
- SERC.



All collaboratively work together as one in the local community to provide an extended curriculum and increased learning opportunities for students. The principle aims are to provide young people with opportunities to enrich and extend their experiences appropriate to their background and aspirations.

The school aims to build on the work already in place to extend the curriculum and provide cross community activities. By providing students with the opportunities to work together it is hoped to encourage a more cohesive local community.

Careers Education and Guidance

The ETi inspectorate highlighted the 'very good' support given to students in St Colman's with regards to Careers Education and Guidance.

All students from Year 8 – 14 have timetabled Careers classes in which emphasis is placed on the development of personal awareness skills related to occupational opportunities. Two joint heads of the Careers Department are assisted by a Career's Advisor who is separately funded by St Colman's to give expert advice and assistance. External support is also provided from the Careers Service NI. An extensive programme of careers support is integrated into the school calendar throughout the academic year including:

Facilitation of Careers Convention, UCAS and FE Applications and Open Day, Organisation of Work Experience placement at Key Stage 5, impartial careers information, advice and guidance towards employment opportunities.



Lifestyle

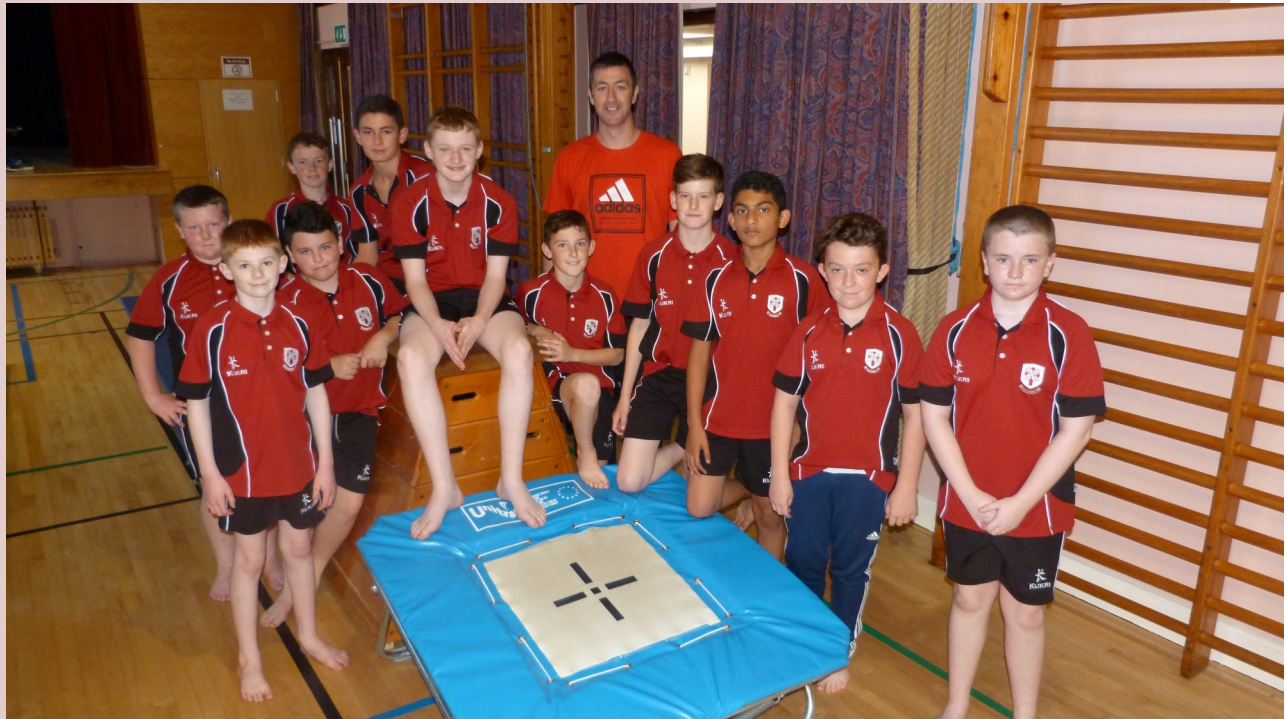

Healthy and enjoyable lifestyle choices are promoted in St Colman's at every opportunity. Sport either through PE or extra-curricular activities offers students the chance to participate in: Rugby, Soccer, Gaelic football, Camogie, Netball and countless other fitness-building, team playing, and individual sports.

Fitness Freddy is a regular visitor and gets everyone (even the teachers) up off their feet in a Fitness Freddy frenzy of dance and movement.

Students are invited to take part in an enrichment programme where they can choose from activities such as first aid training, Defibrillator training, Hair and Beauty, Duke of Edinburgh/ Presidents Award, Certificate in Personal effectiveness and C.o.P.E.



Creativity

Creativity is an important teaching strategy in St Colman's.

We provide an enriched curriculum offering a varied programme of experiences for all our pupils.

Visits by a wide range of experts are well established and beneficial in developing self-confidence as learners mature socially and emotionally.



Fine Arts



Our students experience the joy of discovery, solving problems, being creative in writing, art, music and theatrical studies.



iPad Technology in St Colman's



In keeping with our 'believe and achieve' ethos, we want every student at St Colman's to be fully prepared for a world where digital technology is transforming work and social life. Technology has now reached a level where it can be effectively applied in mainstream education. It has been our ambition for a considerable time to allow students to have access to top quality digital technology as and when needed for their learning. We believe that students' learning and progress can be greatly improved by increasing access to digital technology, and this can be achieved by enabling every student to have a personal device.

In September 2013 we launched the iPads for Learning Scheme. This was initially offered to Year 9 and 11 students, and today all students have access to their own iPad. The school has invested heavily in infrastructure to ensure it can support large numbers of iPads. Each student who joins St Colman's is provided with the latest iPad, protective case, a range of paid and free apps, insurance and warranty, with full backup and technical support available in school for the duration of the scheme. The iPads are available to take home at night. The iPads remain the property of the school throughout the duration of the scheme.

There are two documents that must be read and signed before an iPad will be issued to a student. An 'Acceptable Use Policy for both Pupils and Parents'. All documents, including the AUPs, can be downloaded from the School Website, or obtained from the school office.

iPads for Learning Scheme

Why choose a tablet?

We bought our first iPads two years ago, and have been testing them extensively since then. No other device offers the performance, versatility, range of educational apps and support from both the manufacturer and supplier. The iPad in our view represents the best value for one to one technology. Students (and staff) need little instruction in how to use iPads. Whether it is producing a presentation in Science, searching the internet, completing a quiz, recording a podcast, videoing a role play, analysing technique in PE or using one of the stunning educational apps. We are convinced that one to one use of iPads will greatly enhance students' enjoyment of learning and improve the attainment of your child.

What outcomes are expected?

Students have been using iPads for the past two years. We have noticed that their independence in learning, creativity and problem-solving skills have all developed. Staff have been able to give more highly personalised feedback on their work, and staff and students have been able to work closely together to develop new ways of teaching and learning. Many staff have commented on improvements in both student motivation and behaviour.

Why are parents being asked to pay?

We have invested significantly in the school's ICT infrastructure (around £150,000 to date) specifically in this scheme. We have installed a school-wide wireless network, a superfast Internet connection, supplied iPads and training to staff and pupils. We receive no funding for a scheme such as this, so have to ask parents to contribute towards the costs. We are subsidising the cost by around £25,000 per year group, but cannot run such an ambitious scheme without some parental financial support.

What's included?

The 'iPads for Learning' scheme offers the use of an iPad, a range of free and paid educational apps; a rugged, shockproof, dustproof case with excellent protection against accidental damage; a warranty and insurance policy with no excess. The retail value of this package is in excess of £600.



Examinations

"One of the **top 10** Non Selective Secondary Schools in N.I"



The **2013 Inspection report** stated that 'the quality of education provided by St Colman's was **'very good'**, and the school is meeting very effectively the educational and pastoral needs of the learners'



Prize Evening



Principal Mr. Mark Morgan with Guest speaker Professor Gregory Maguire, Professor of Animation at the University of Ulster Founder of InfoLifeSize and a member of the Board of NI Screen.



***92% of Pupils achieved
5 G.C.S.Es A*-C***

***The number who
achieved 5 G.C.S.Es
A*-C including English
and Maths was an
impressive 65%***

(2015)

Daily Routine

School Timetable

Lesson		Time
Class Registration		9.05-9.15am
Session 1	1	9.15-9.45am
	2	9.45-10.15am
	3	10.15-10.45am
Break		10.45-11.00am
Session 2	4	11.00-11.30am
	5	11.30-12.00pm
	6	12.00-12.30pm
	7	12.30-1.00pm
Lunch		1.00-1.35pm
Session 3	8	1.35-2.05pm
	9	2.05-2.35pm
	10	2.35-3.05pm



Bus Timetable

Catchment Area	Bus Route No.	Location	Departure	Arrival
Lisburn	Service 26a/b	Bus Station	8.45am	9.15am
Belfast	Service 20	Europa Bus Station	8.10am	8.50am
Dromara	Service 36	Bus Station	7.55am	8.10am
Castlewellan	Service 18	Bus Station	7.45am	8.15am
Newcastle	Service 20	Bus Station	8.00am	8.35am
Drumaness	Service 20	McCallister's shop	8.20am	8.50am
Comber to Saintfield	Service 5b	Bus Station	7.50am	8.20am
Saintfield to Ballynahinch	Service 5b	Comber Street, Saintfield	8.20am	8.40am

Map of St Colman's

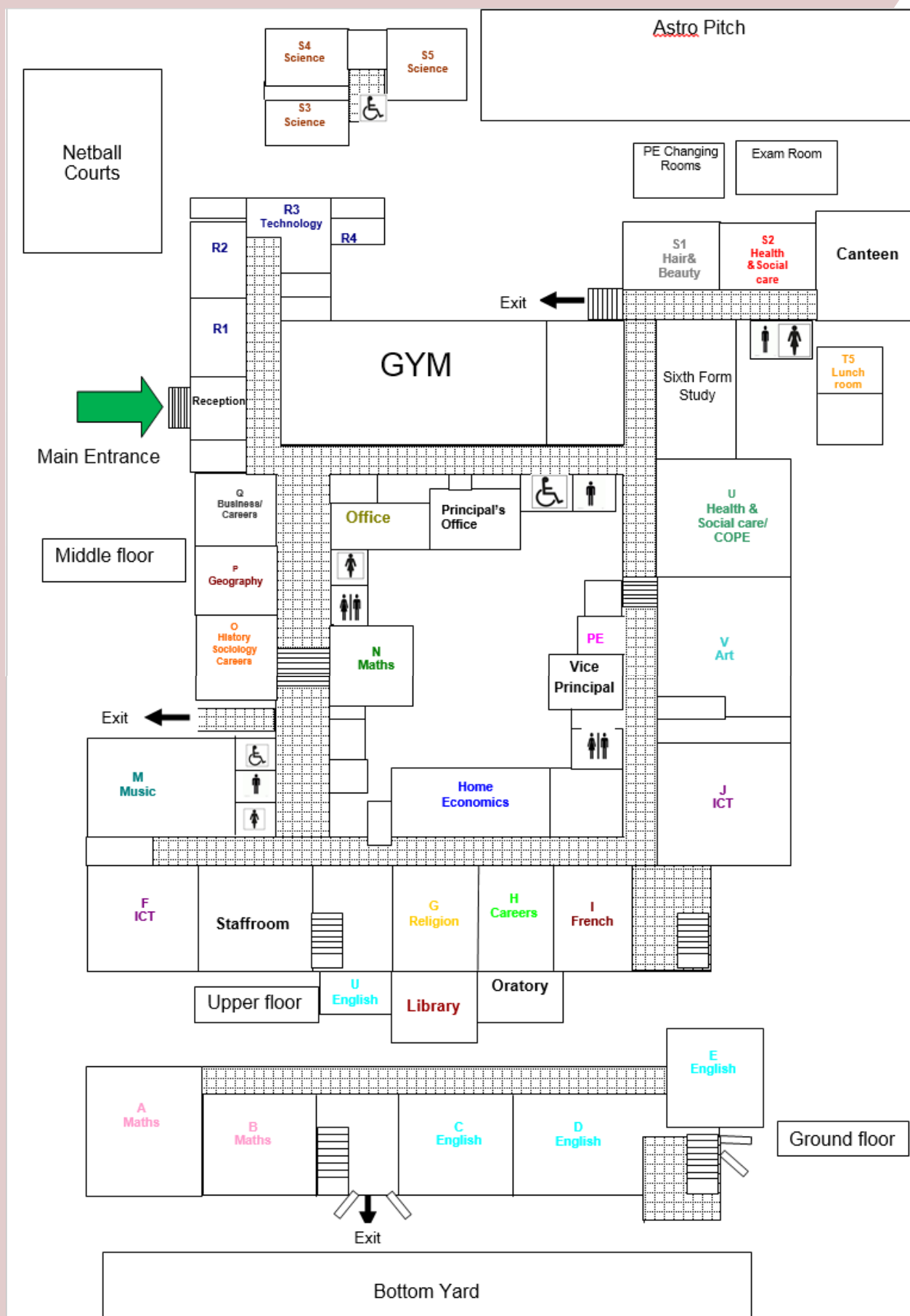



ST COLMAN'S

HIGH & SIXTH FORM COLLEGE
BALLYNAHINCH

Prospectus



Principal Mr M. Morgan, MSc, BEd, Cert Ed, DASE., Dip Sc., PQH
St Colman's High & Sixth Form College,
52 Crossgar Road,
Ballynahinch,
Co. Down,
BT24 8XS

T: 028 9756 2518 F: 028 9756 2218 Reception hours 08.30 - 16.15 (Fri 16.00)

Web: <http://www.stcolmans.co.uk>



www.facebook.com/StColmanHigh



[@StColmanHigh](https://twitter.com/StColmanHigh)



[@StColmanHigh](https://www.instagram.com/StColmanHigh)