



River Holme View

£750,000

Brockholes, Holmfirth, HD9 7BP

An exclusive gated residence of Georgian inspired detached townhouses built by the award winning Kingsman Homes. Each house is finished with a high specification of contemporary fixtures and fittings throughout and has a triple driveway with generous landscaped gardens. The stunning collection of large stone built properties are all built in what used to be the grounds to the 'Old House' with a rural feel and woodland views but still close to all the amenities in the village of Brockholes including good schools and train station - a very desirable position in the Holme Valley.

Plot 4 is turn-key ready and available to view now, whilst plot 8 could be yours later in the year and available traditionally or as a contract build. For more info please contact SnowGate.

River Holme View

Brockholes, Holmfirth, HD9 7BP



- FIVE BEDROOM DETACHED FAMILY HOME
- BESPOKE DEVELOPMENT WITH GATED ACCESS
- INTEGRAL GARAGE & DRIVEWAY
- OPEN PLAN LIVING ACCOMMODATION
- HIGH SPEC FIXTURES & FITTINGS
- LANDSCAPED GARDEN & LARGE PATIO

Overview

Lower Ground Floor

Entrance Hallway

Store Room

Downstairs WC
5'11" x 4'11" (1.813m x 1.512m)

Utility Room
10'2" x 6'5" (3.1m x 1.958m)

Cinema Room/Second Reception Room
17'9" x 12'1" (5.42m x 3.7m)

Integral Garage
17'1" x 16'6" (5.22m x 5.04m)

Ground Floor

Upper Hallway

Dining Kitchen
19'0" x 28'3" (5.8m x 8.63m)

Lounge
18'0" (to kitchen wall) x 17'9" (5.502m (to kitchen wall) x 5.43m)

First Floor
First Floor Landing

Master Bedroom
17'9" x 9'10" (5.43m x 3m)

His & Hers Dressing Room
12'11" x 7'5" (3.955m x 2.285m)

Ensuite Bathroom
10'2" x 7'11" (3.1m x 2.423m)

Bedroom 2
17'9" (max) x 15'1" (5.418m (max) x 4.615)

Bedroom 3
13'2" x 11'7" (4.038m x 3.548m)

Jack & Jill Ensuite
8'6" (max) x 6'6" (2.616m (max) x 1.982m)

Second Floor
Upper Landing
Bedroom 4
17'9" (max) x 17'1" (5.43m (max) x 5.213m)

Bedroom 5
13'11" x 11'4" (4.261m x 3.460m)

Shower Room
8'7" x 5'4" (2.621m x 1.643m)

Parking & Garden

Plot 8 Contract Build

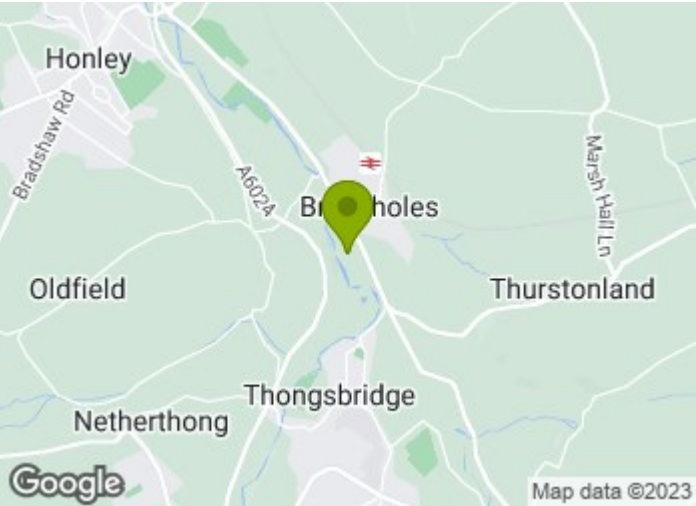

Directions
The development can be accessed via River Holme View in Brockholes.



Floor Plan

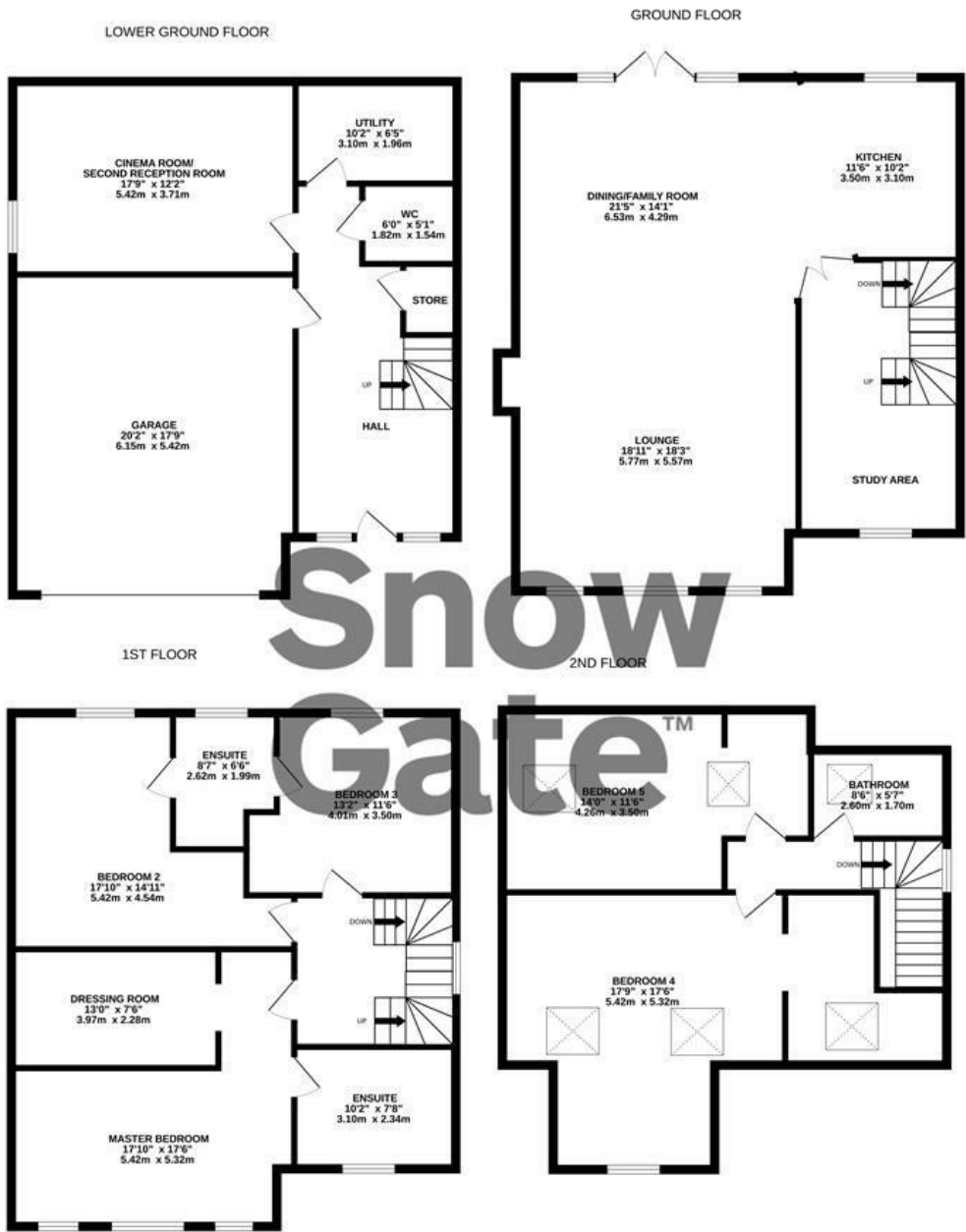

Whilst every attempt has been made to ensure the accuracy of the floorplan contained here, measurements of doors, windows, rooms and any other items are approximate and no responsibility is taken for any error, omission or mis-statement. This plan is for illustrative purposes only and should be used as such by any prospective purchaser. The services, systems and appliances shown have not been tested and no guarantee as to their operability or efficiency can be given.
Made with Metropix ©2023

These particulars, whilst believed to be accurate are set out as a general outline only for guidance and do not constitute any part of an offer or contract. Intending purchasers should not rely on them as statements of representation of fact, but must satisfy themselves by inspection or otherwise as to their accuracy. No person in this firms employment has the authority to make or give any representation or warranty in respect of the property.

