

# CARTEN®

1/10 EP RC TOURING CAR

# T410R

Revolution

# T410

Standard

## INSTRUCTION MANUAL

**4WD** SHAFT  
DRIVEN



SHAFT DRIVEN



ELECTRICAL POWER

[WWW.CARTEN-RC.COM](http://WWW.CARTEN-RC.COM)

## CAUTION

## T410R / T410

**Notice:** Thank you for choosing the carten T410R T410

The following items are needed for completion of the KIT, They are not included with this kit (unless noted), and should be obtained from your local hobby shop.

**Be sure to read the instructions completely prior to assembly.**

### Tools needed To Assemble

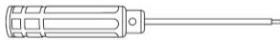

Hex Wrenches(1.5mm / 2.0mm / 2.5mm)

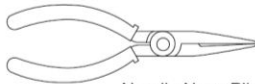

Needle Nose Pliers

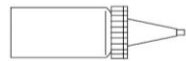

Instant Glue



Box Wrench(5.5mm / 7mm / 10mm)



Scissors



Screw (Sement)

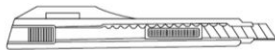

Hobby Knife



Glass or Vinyl Tape

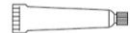

Rubber Glue

### Items Needed To Control Car

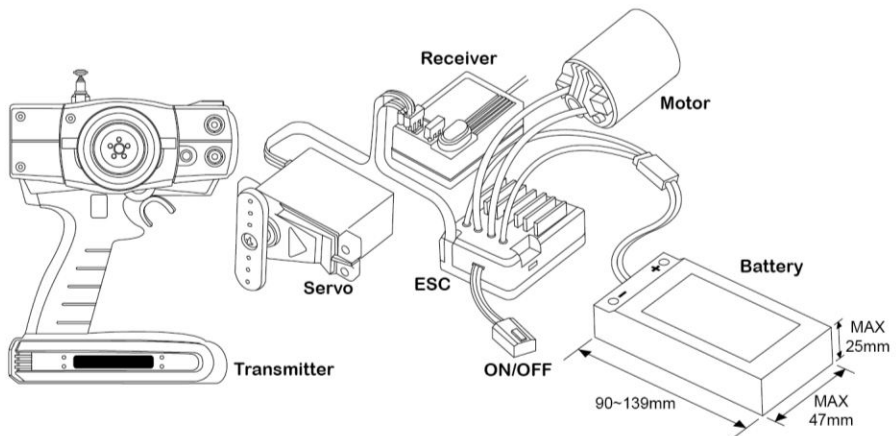

**T410R** Revolution

CARTEN T410R 1/10 EP TOURING CAR

**Specification**

<b>Drivetrain</b>	Shaft Drive 4WD
<b>Track Width</b>	190 mm
<b>Wheelbase</b>	258 mm
<b>Final Gear Ratio</b>	2.47
<b>Gear Ratio</b>	4.56
<b>Tire Diameter</b>	65 mm

**Accessories**

Full Bearing	Aluminum Spur Gear Hub
Steel CVD Drive Shaft	Aluminum 12mm Hex Hub
Carbon Fiber Chassis, Upper Deck, Shock Tower	Aluminum Shocks
Aluminum Motor Mount	Metal Gear Differential
Aluminum Center Drive Shaft	Full Turnbuckle

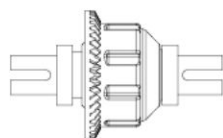

Metal Gear Diff



Oil Shock



Servo Mount Set



Hex Hub



Turnbuckle

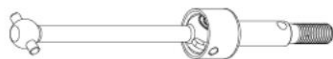

CVD Drive Shaft

**T410** (Standard)

CARTEN T410 1/10 EP TOURING CAR

**Specification**

<b>Drivetrain</b>	Shaft Drive 4WD
<b>Track Width</b>	190 mm
<b>Wheelbase</b>	258 mm
<b>Final Gear Ratio</b>	2.35
<b>Gear Ratio</b>	6.27
<b>Tire Diameter</b>	65 mm

**Accessories**

Full Bearing	Aluminum Spur Gear Hub
Steel CVD Drive Shaft (Front only)	Ball Differential
Aluminum Motor Mount	Full Turnbuckle

Aluminum Center Drive Shaft

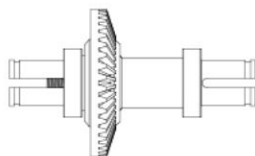
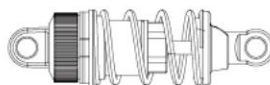
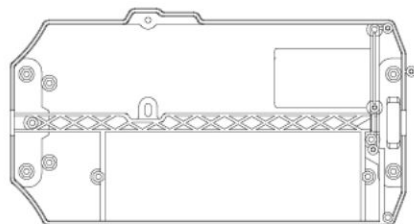
**Ball Diff****Oil Shock****Bathtub Chassis****Turnbuckle**



### 1

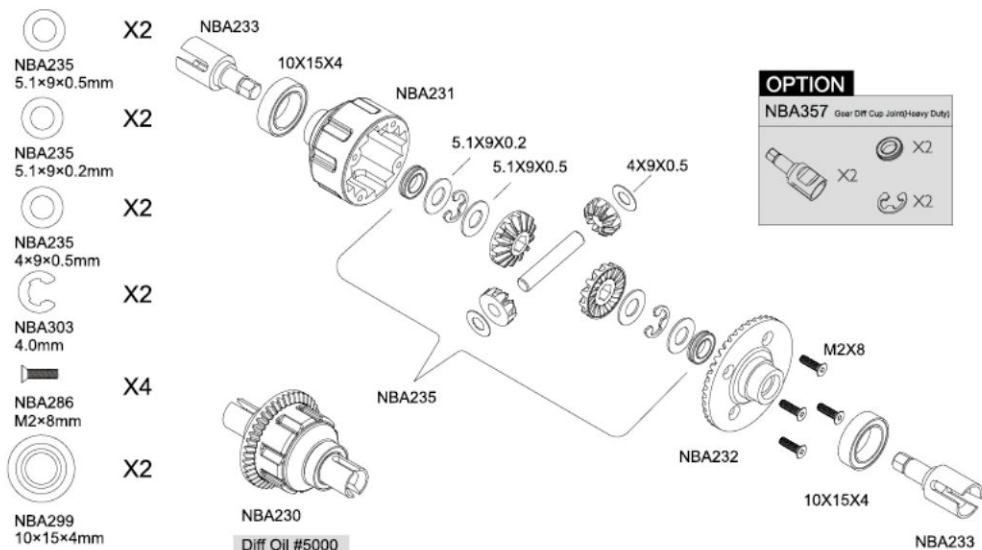

### 2

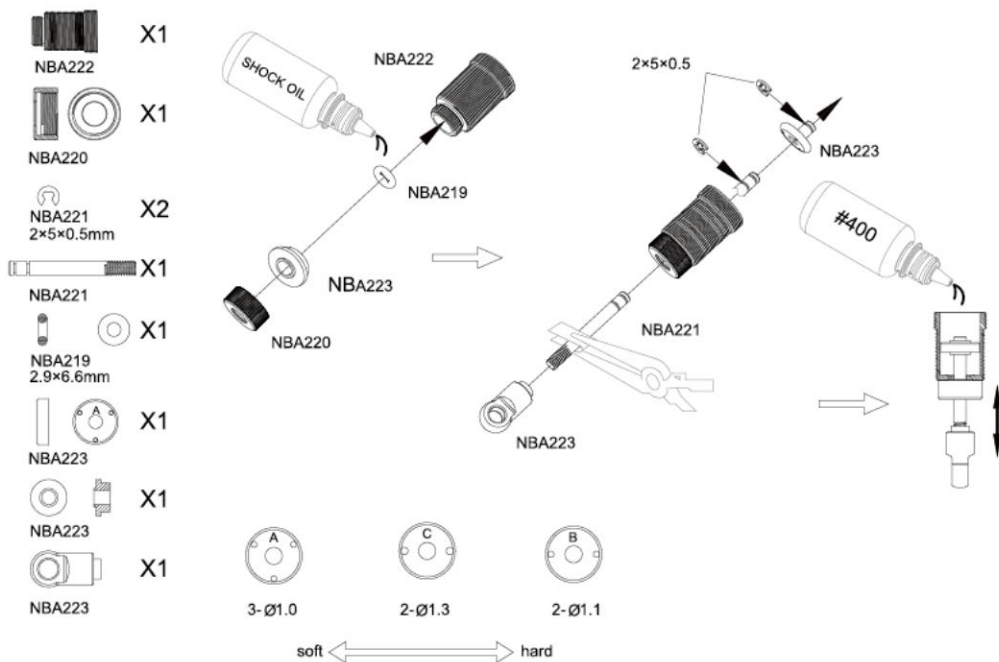

### 3



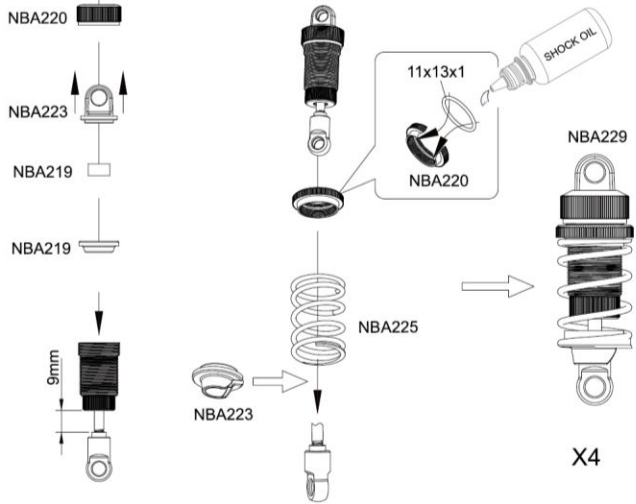

-  X1  
NBA220
-  X1  
NBA220
-  X1  
NBA219  
11x13x1mm
-  X1  
NBA223
-  X1  
NBA223
-  X1  
NBA219
-  X1  
NBA219

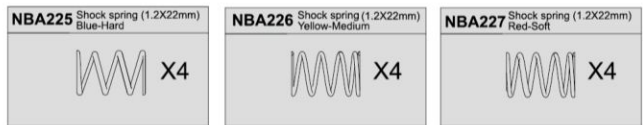

HARD ← → SOFT



### 4

-  X14  
NBA247
-  X2  
NHA417  
M3x27
-  X1  
NHA417  
M3x29
-  X4  
NHA417  
M3x37

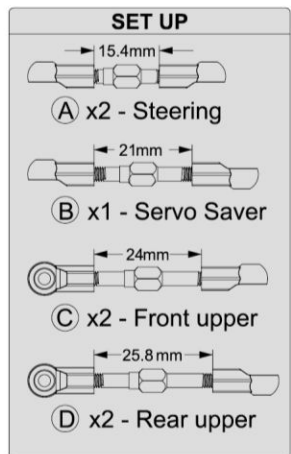
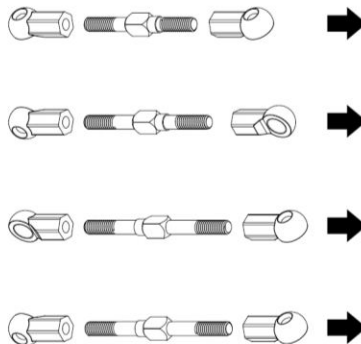

### 5

-  X2  
NBA298  
5x10x4
-  X1  
NBA255  
Oring 5.8x9.6x1.9
-  X1  
NBA255  
2x7.6
-  X1  
NBA279  
M3x6

---

-  X4  
NBA281  
M3x6
-  X1  
NBA279  
M3x6
-  X1  
NBA255  
2.0x7.6
-  X1  
NBA255  
Oring 5.8x9.6x1.9
-  x3  
NBA298  
5x10x4

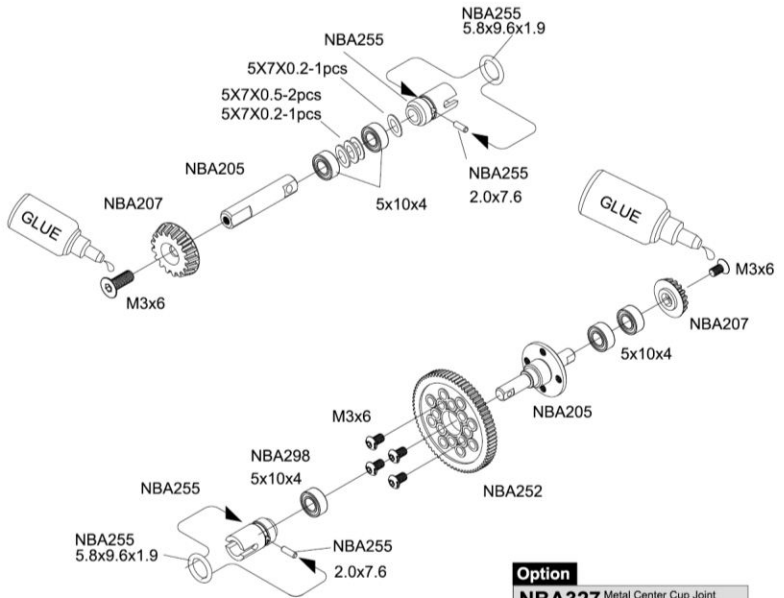

#### Option

**NBA327** Metal Center Cup Joint  
(For Gear Diff)



### 6

-  X4  
NBA280  
M3x8mm

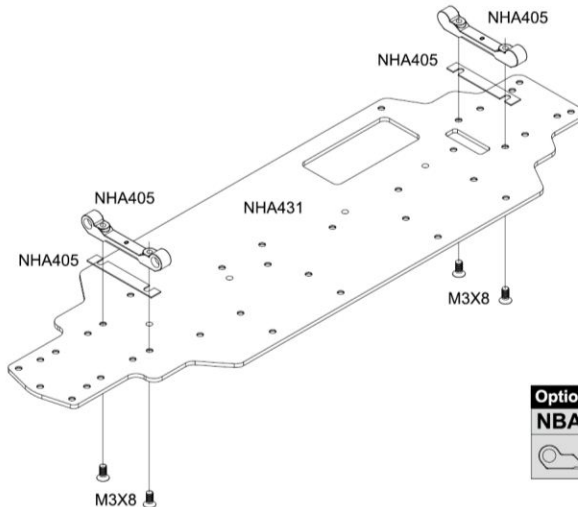

#### Option

**NBA314** Pivot Block (ALUMINUM) 0°



### 7

- X8  
NBA210
- X8  
NBA211
- X4  
NBA280  
M3x8mm
- X4  
NHA423  
3x42
- X8  
NBA289  
M3x8mm
- X4  
NHA430  
M4x10mm

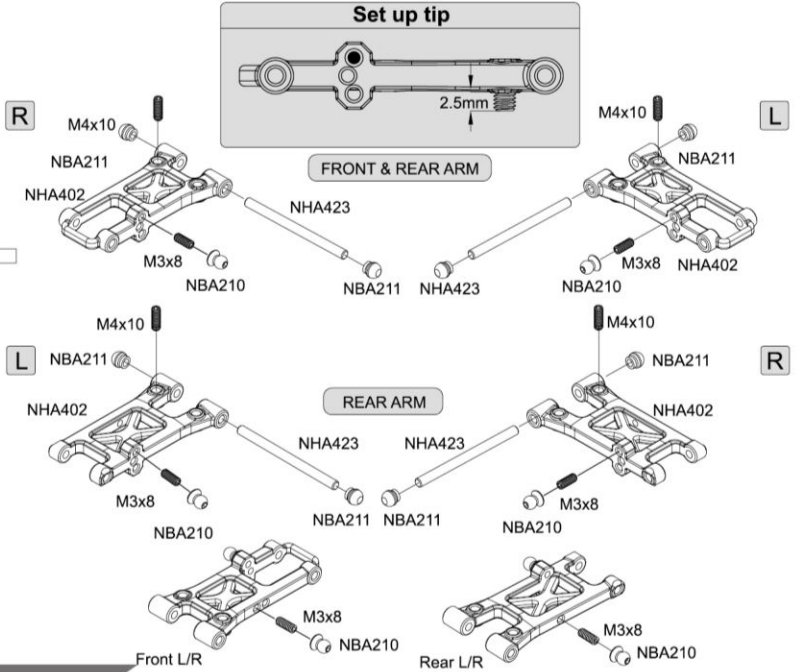

### 8

- X4  
NBA280  
M3x8mm

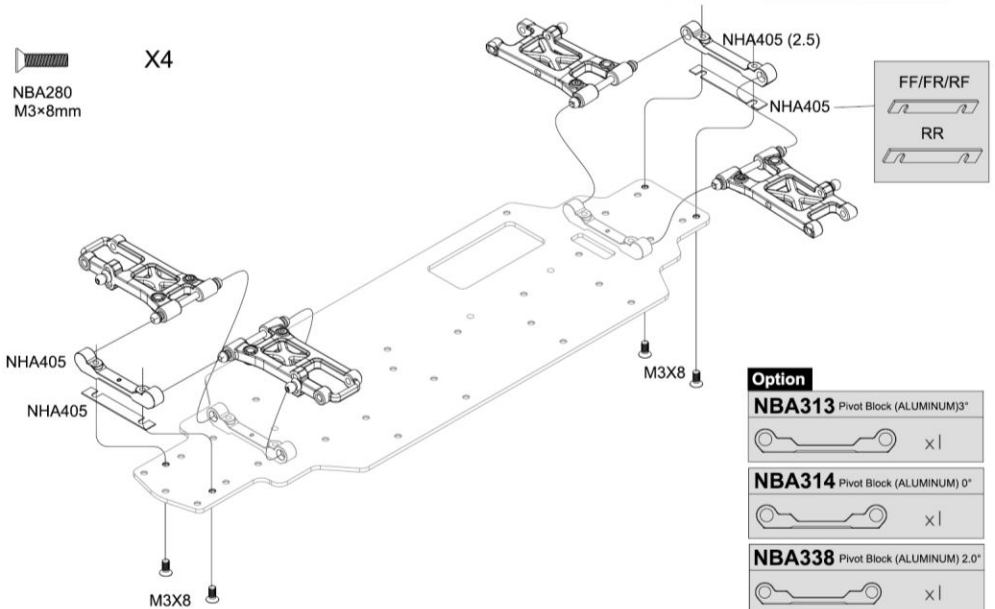

9

NBA280  
M3x8

X8

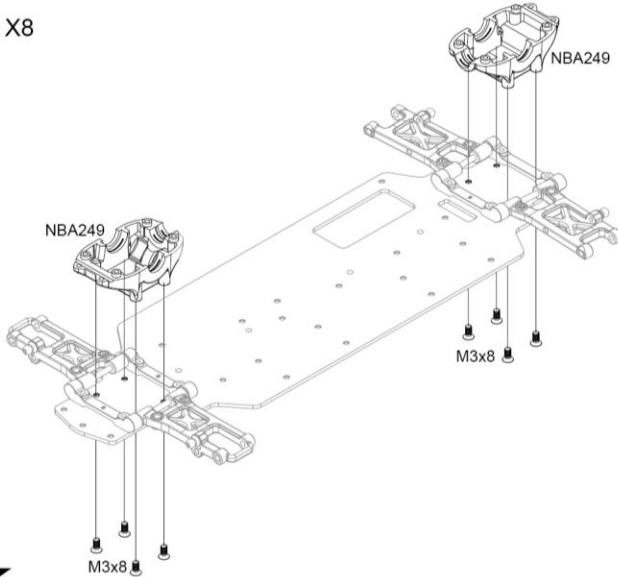

10

NBA279  
M3x6

X2

NBA280  
M3x8

X4

NBA282  
M3x8mm

X1

NBA210  
3x8mm

X1

NBA281  
M3x6mm

X9

NBA254  
(Black)

X1

NBA254  
(Silver)

X2

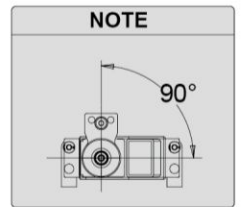
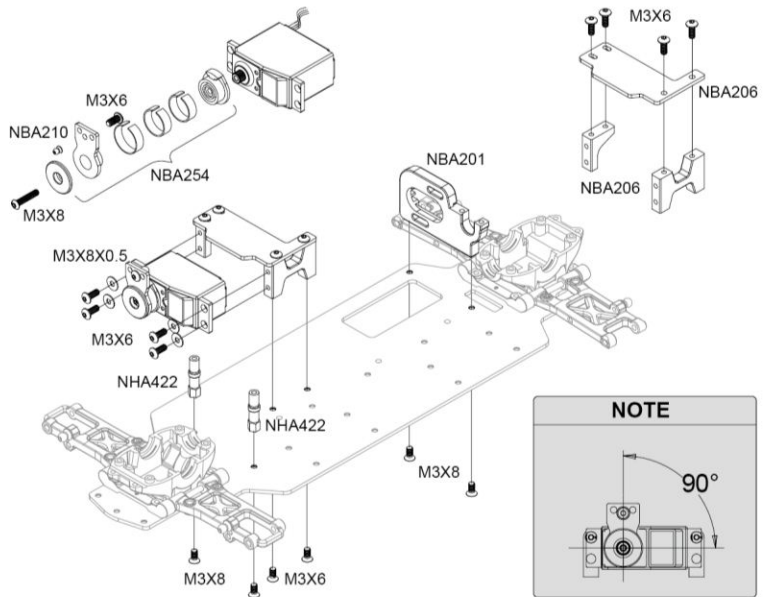

1: Switch on transmitter  
2: Connecting battery and turn on ESC switch

### 11



X2

NBA283  
M3×10mm



X2

NBA282  
M3×8mm

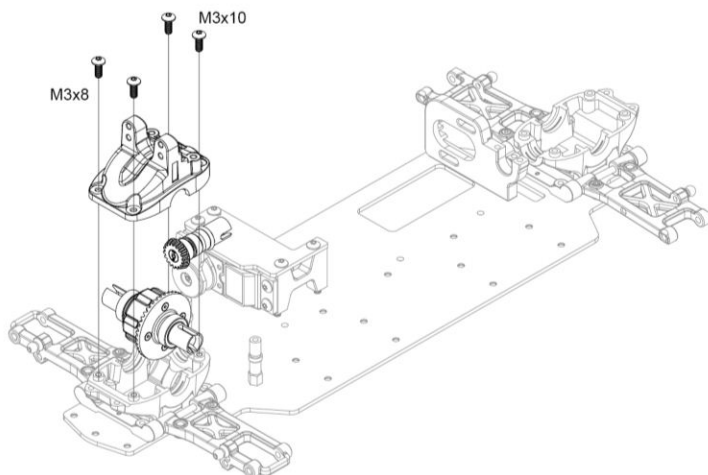

### 12



X2

NBA283  
M3×10mm



X2

NBA282  
M3×8mm

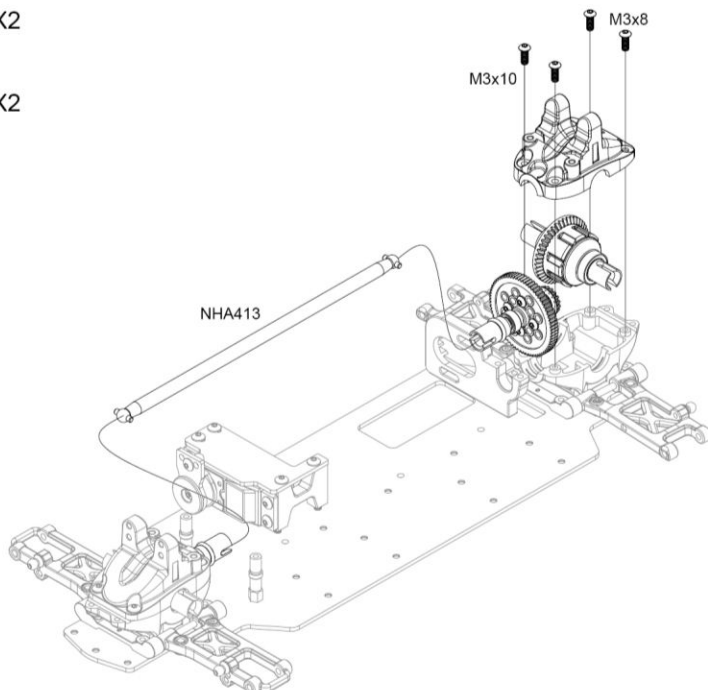

### 13

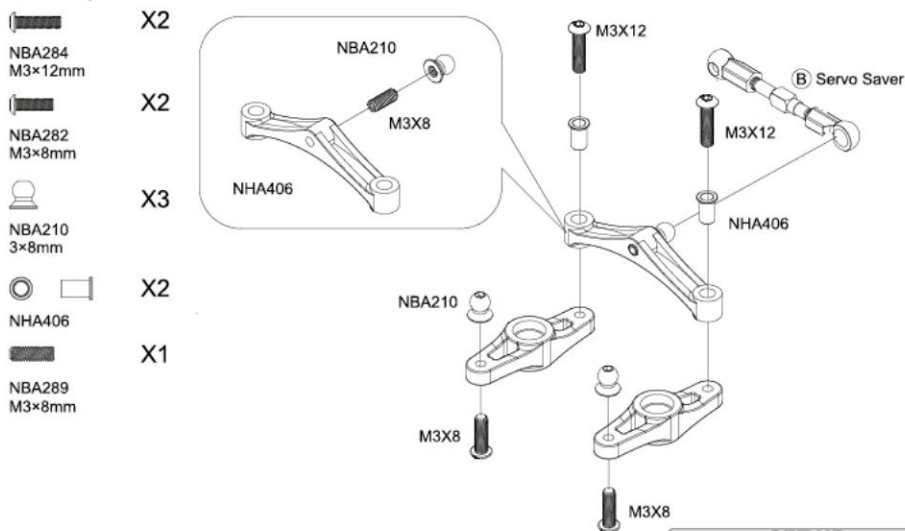

**SET UP**

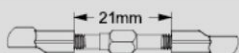

**(B) x1 - Servo Saver**

### 14

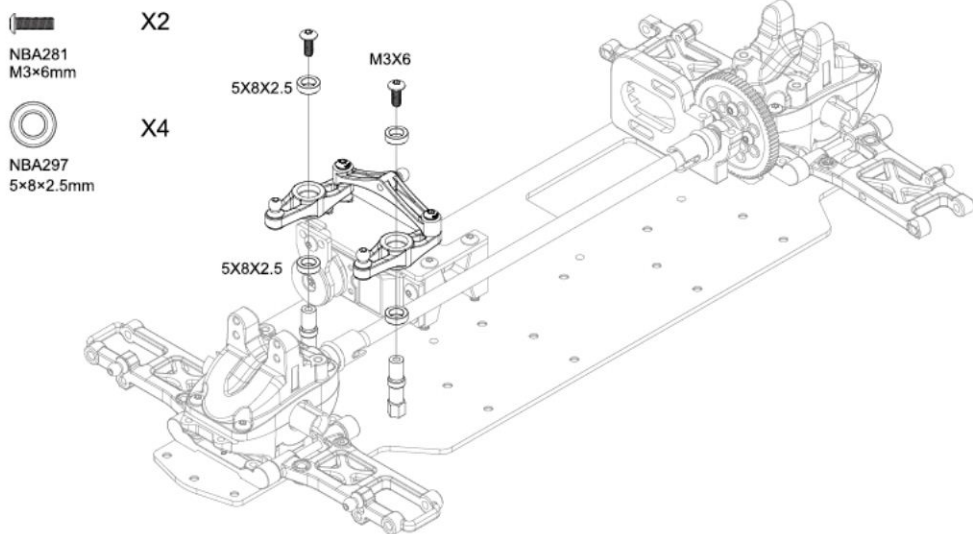



### 15

- NBA282 M3x8 X2
- NBA283 M3x10 X2
- NBA304 2x10 X2
- NBA298 5x10x4 X2
- NBA419 X2
- NBA210 X4
- NBA420 4.8x9 X4
- NBA287 M3x3

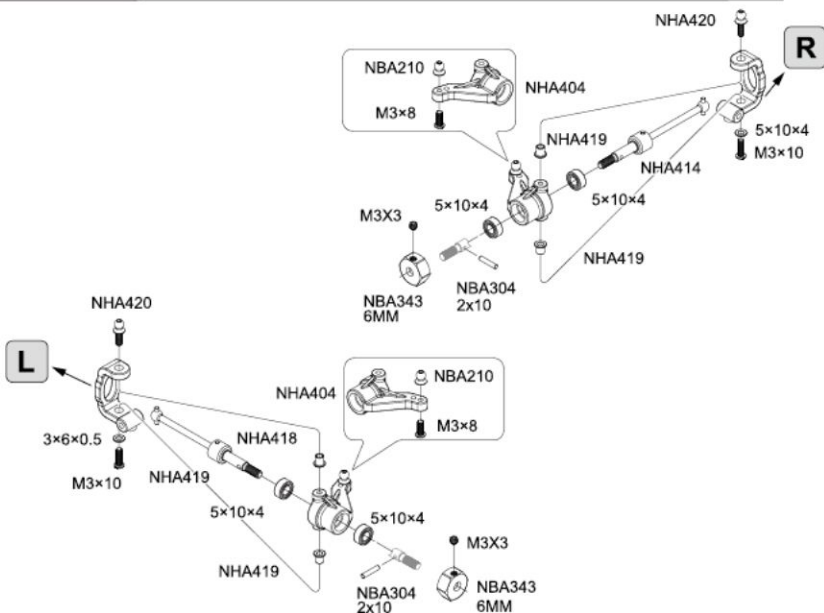

### 16

- NBA288 M3x4 X2
- NBA423 3x26 X2

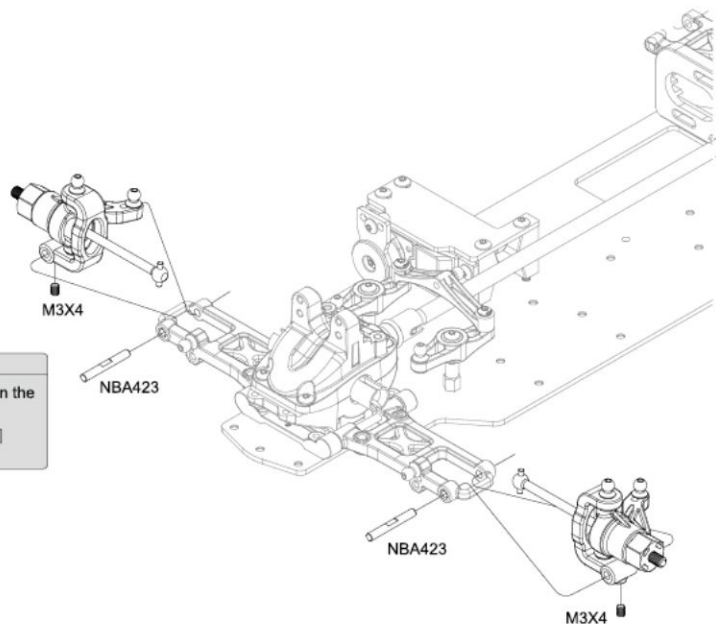

#### NOTE

Tight Grub screw on the groove of the pin



### 17



X4

NBA298  
5x10x4



X2

NBA210



X2

NBA290  
M3x10



X2

NBA304  
2x10



X2

NBA287  
M3x3

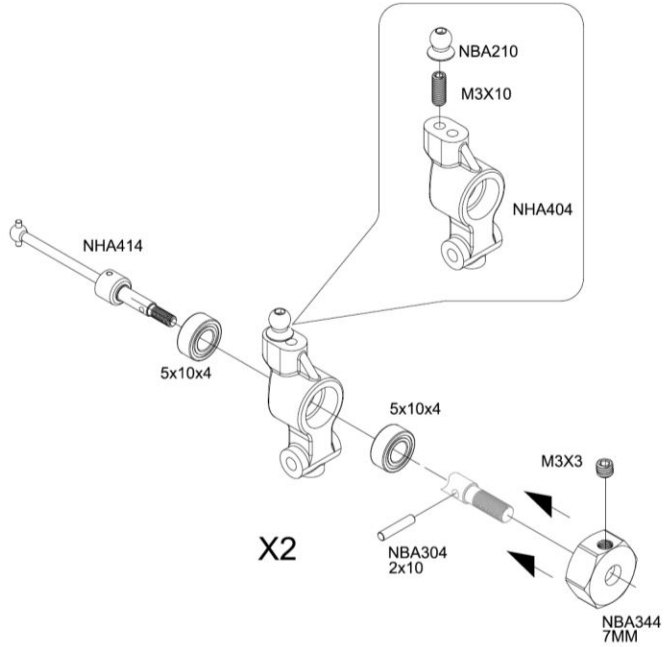

### 18



X2

NBA288  
M3x4



X2

NHA423  
3x26



X2

3x7x3

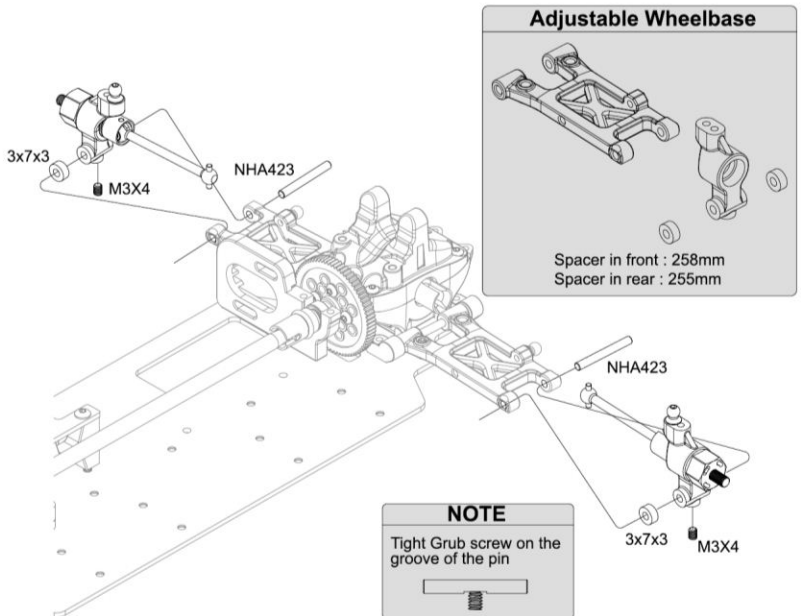

### 19

 X4  
NBA210

 X2  
3x6x4

 X2  
NBA283  
M3x10

 X4  
NBA282  
M3x8

 X2  
NBA281  
M3x6

SET UP

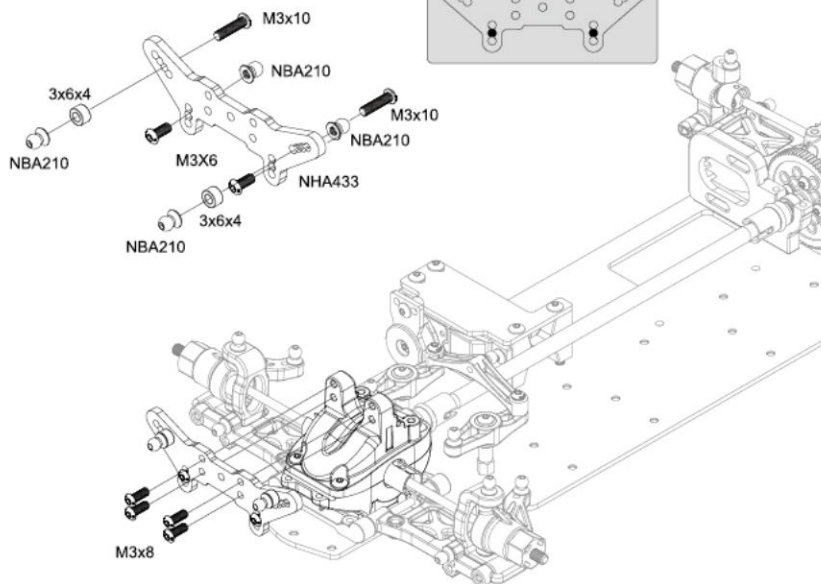

### 20

 X4  
NBA210

 X2  
3x6x4

 X8  
NBA282  
M3x8

 X2  
NBA283  
M3x10

 X2  
NBA281  
M3x6

SET UP

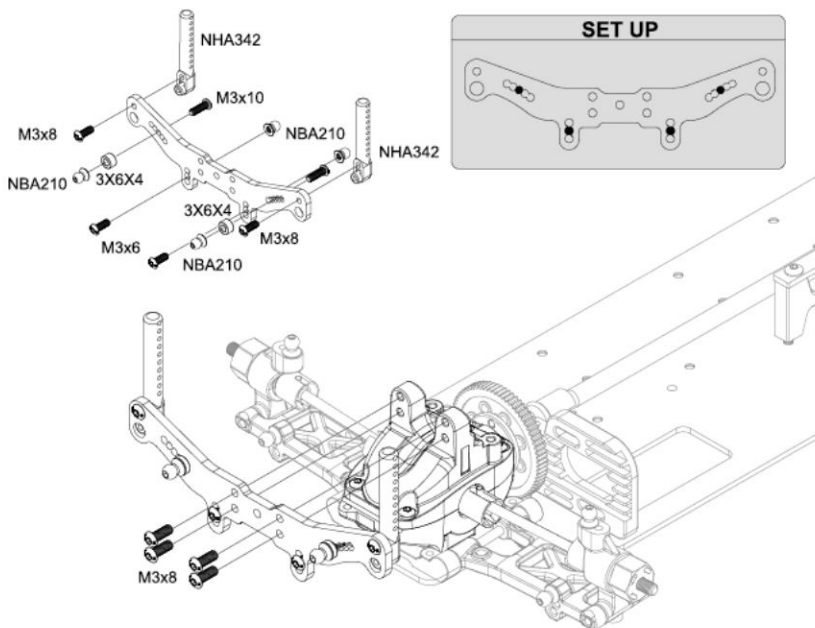

21

## T410R

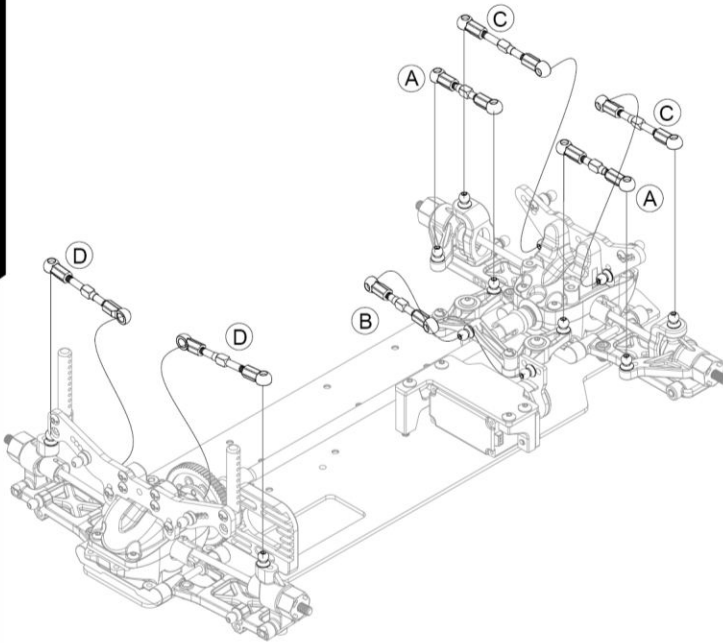

**SET UP**

→ 15.4mm ←  
**A** x2 - Steering

→ 21mm ←  
**B** x1 - Servo Saver

→ 24mm ←  
**C** x2 - Front upper

→ 25.8mm ←  
**D** x2 - Rear upper

22



X8

NBA247



X4

NBA291  
M3x12

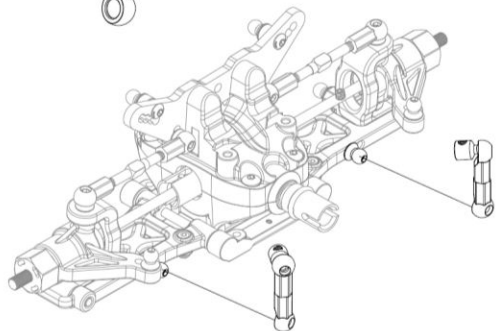
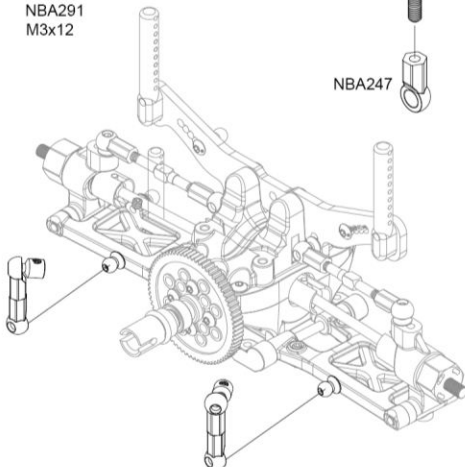
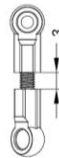

## T410R

### 23

 X4  
NBA287  
M3x3

 X4  
NBA281  
M3x6

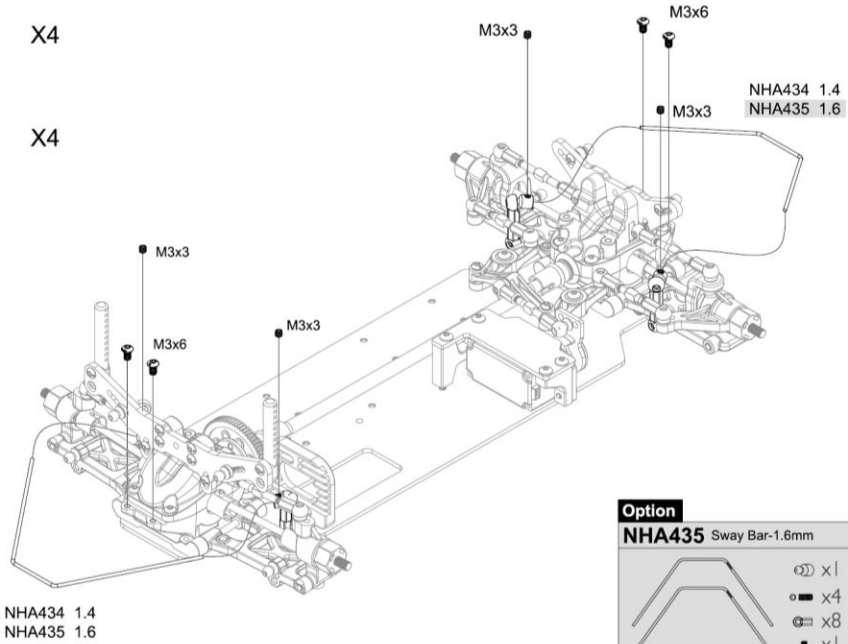

**Option**

**NHA435** Sway Bar-1.6mm

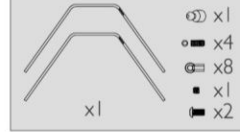

### 24

 X4  
NBA281  
M3x6

 X2  
NBA280  
M3x8

 X4  
NBA279  
M3x6

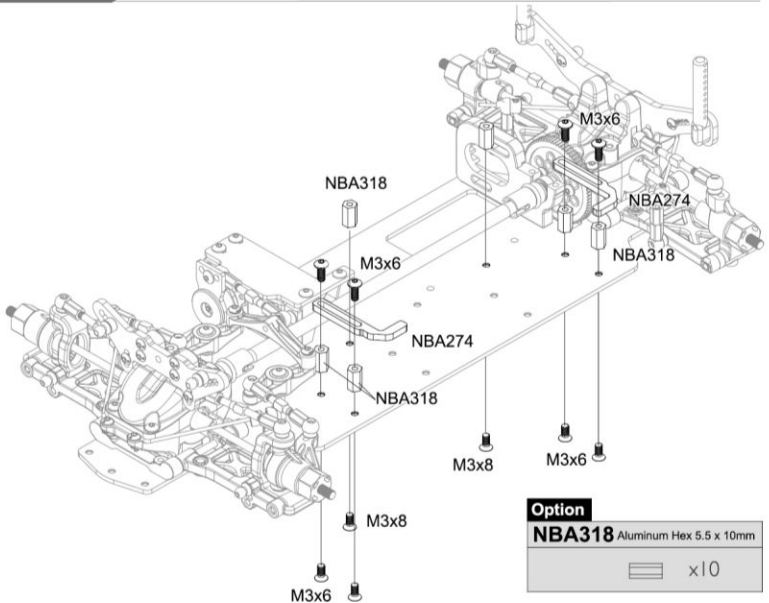





**Option**

**NBA318** Aluminum Hex 5.5 x 10mm



25

-  X1  
NBA281  
M3x6
-  X5  
NBA282  
M3x8
-  X2  
NBA285  
M3x18
-  X1  
NBA287  
M3x3

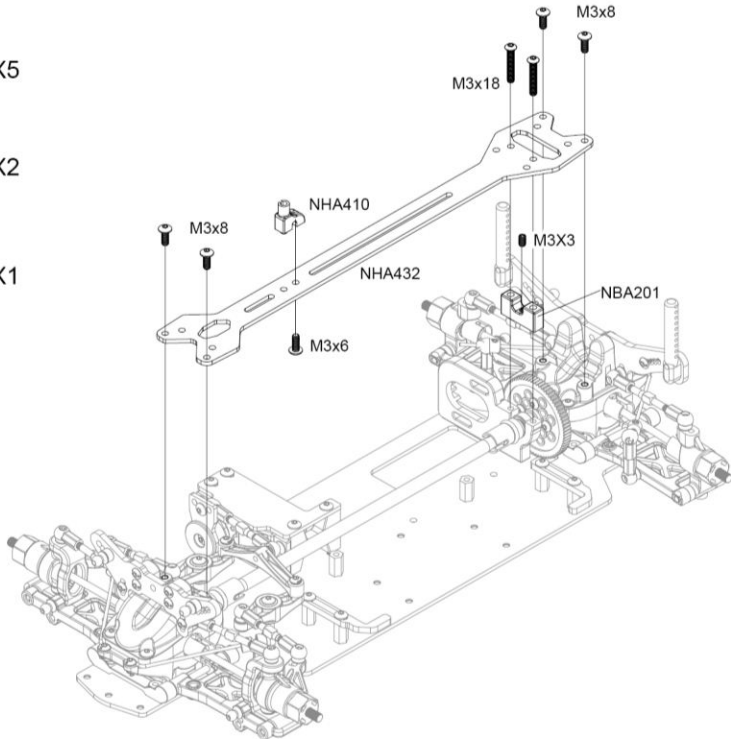

26

FRONT

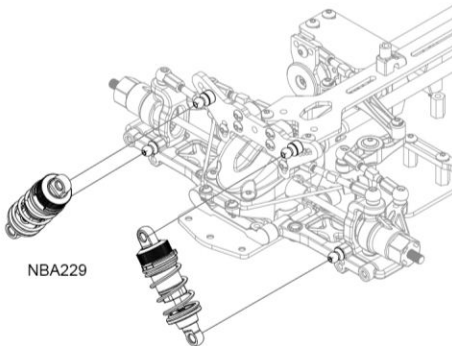

REAR

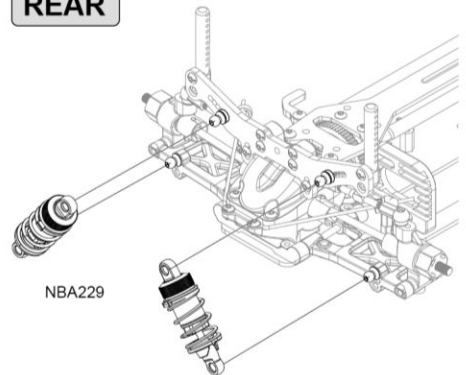



 X2

NBA305

 X2

NBA282  
M3×8mm

 X2

NBA280  
M3×8mm

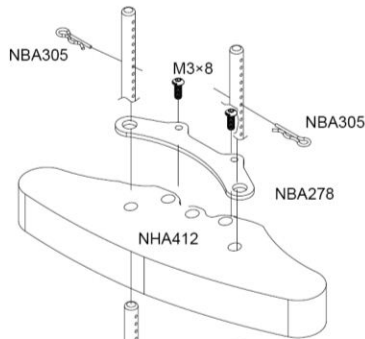

### Option

**NBA336** Bumper For Touring Car Body

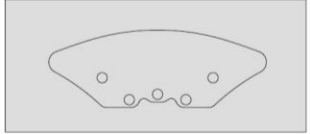

**NHA412** Bumper For Touring Car Body

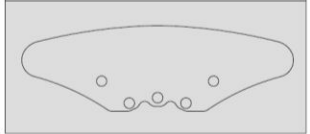

There are two sizes of bumper that Allowed to fit Different kind of Body shell.

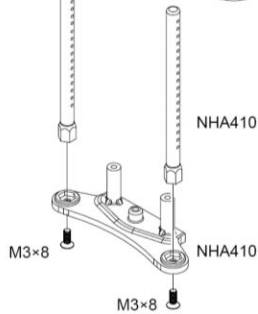

 X3

NBA280  
M3×8mm

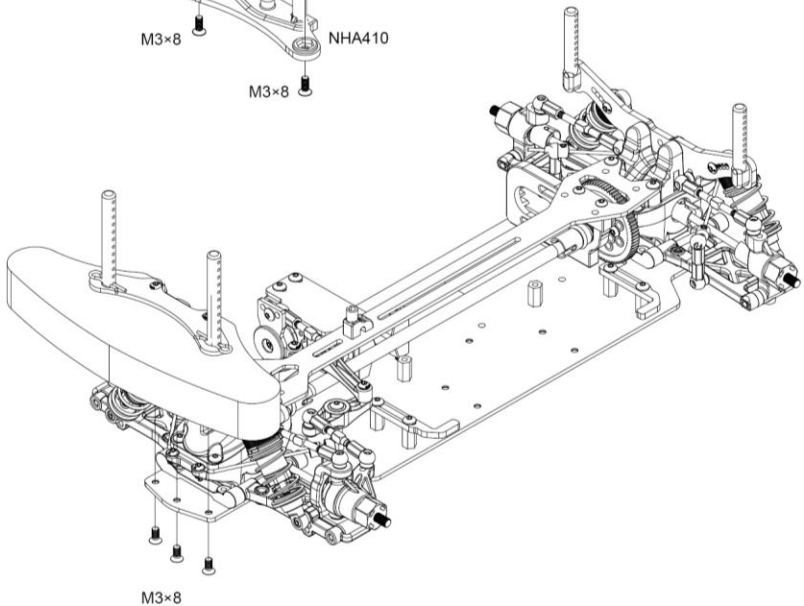



28



X2

NBA283  
M3×10mm



x2

NBA302  
3X8X0.5



x1

NBA287  
M3x3

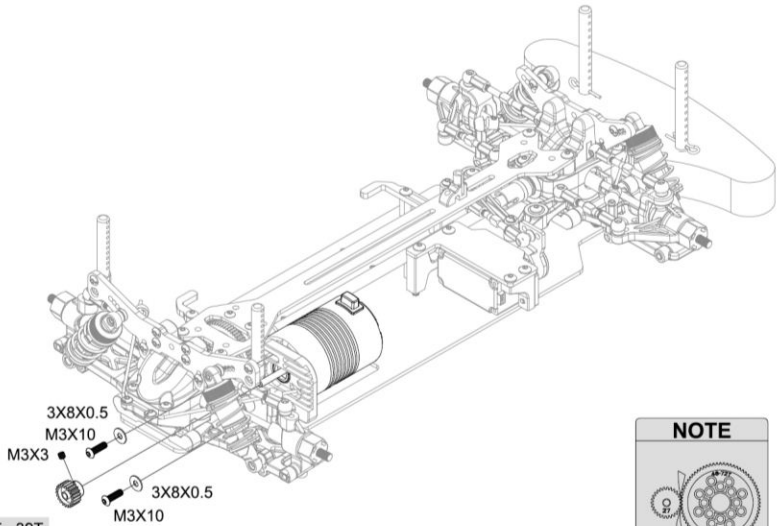

NBA215 39T  
NBA216 31T  
NBA218 27T

### NOTE

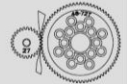

Insert a sheet of paper before installing.

29

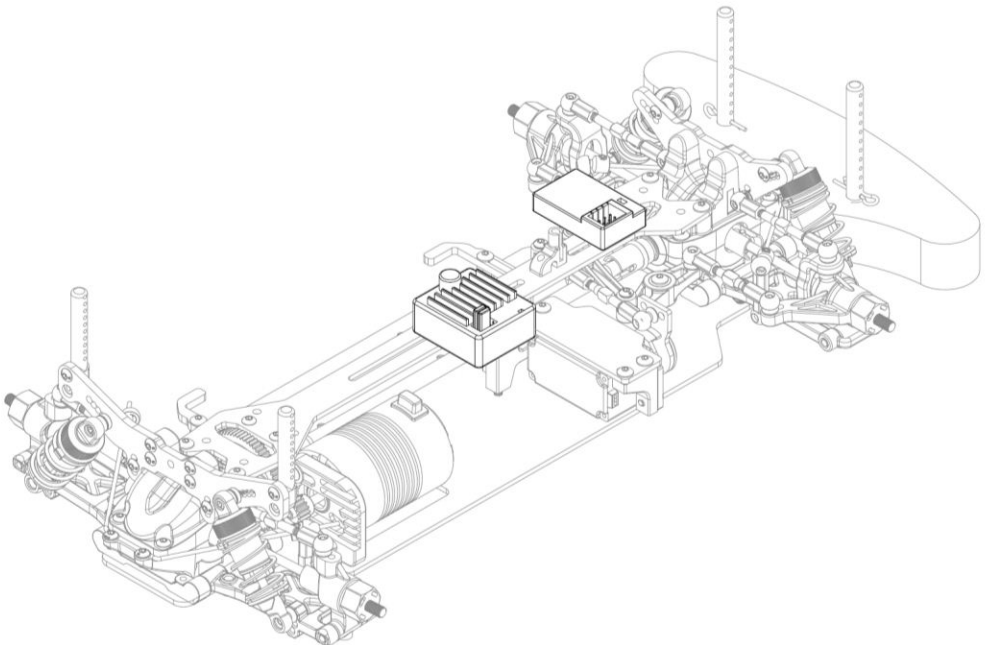

**30**



X4

NBA295  
M4

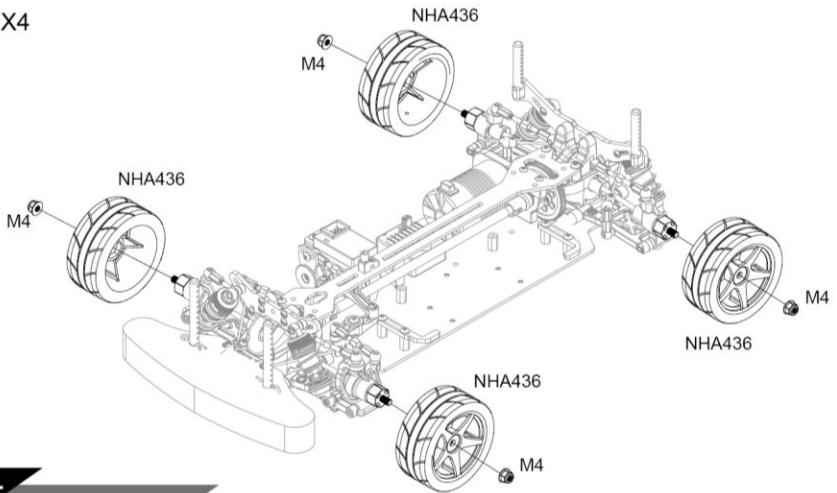

**31**

**NOTE**

Comptible with Lipbattery  
L=138mm  
W=46mm  
H=25mm

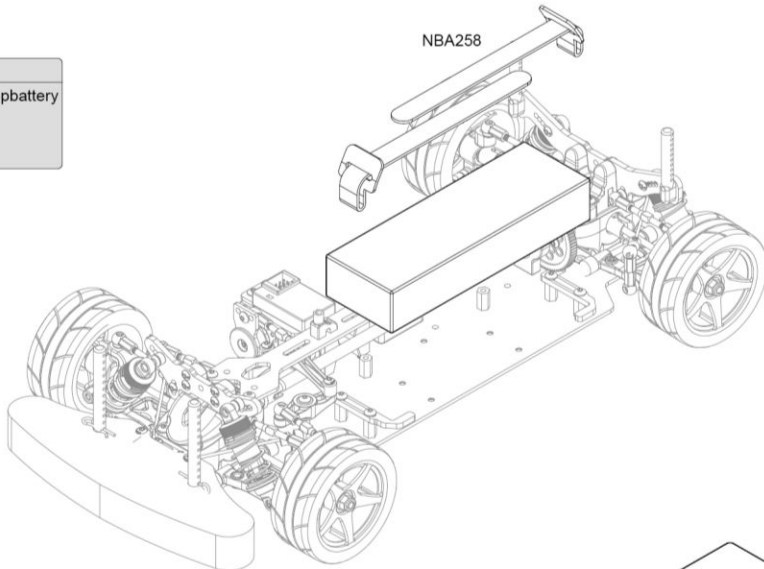

**FRONT**



1



2



3

**REAR**



1



2

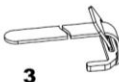

3

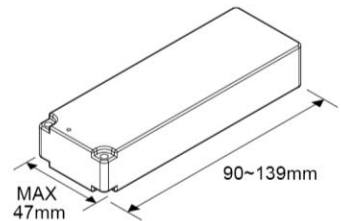



X4

NBA305

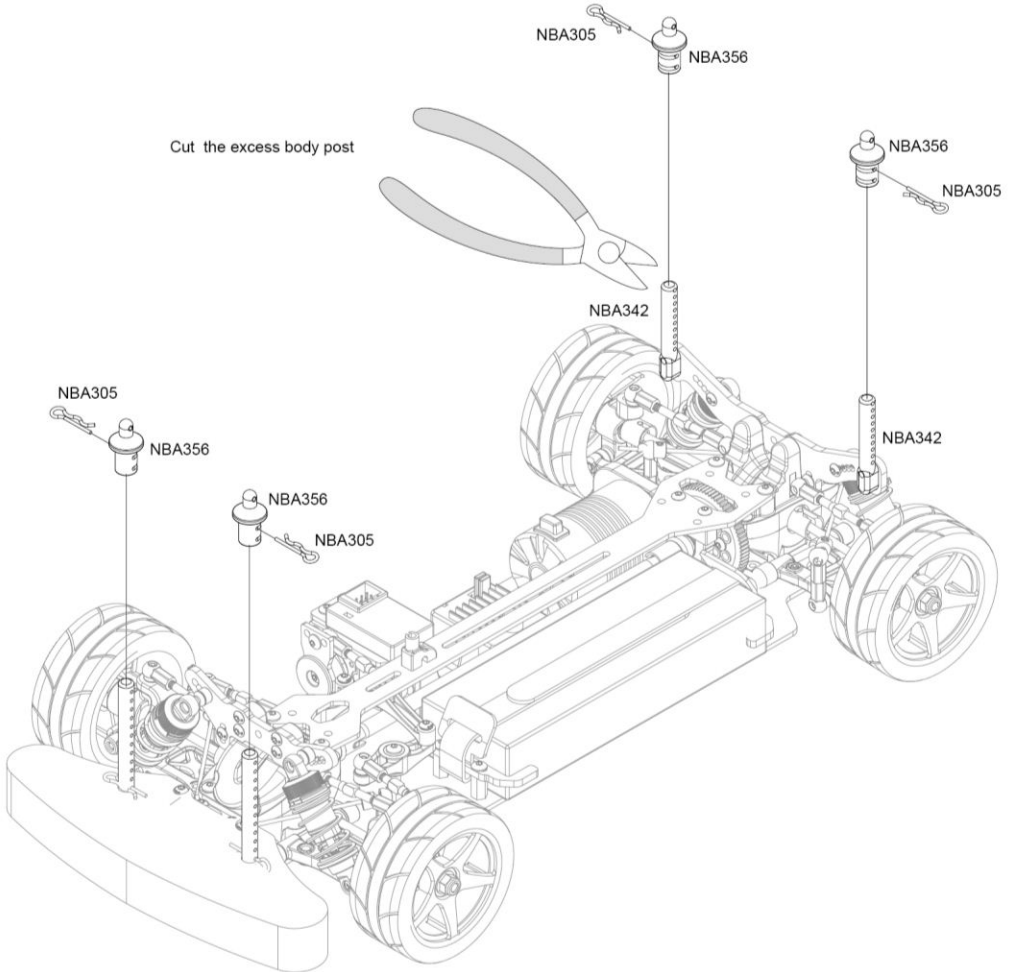

## T410

### 1

- NBA236 X1
- NBA240 X1  
2.6×6×3mm
- NBA297 X2  
5×8×2.5mm
- NBA299 X2  
10×15×4mm
- NBA238 X1  
M2.5×2.5mm
- NBA238 X1  
M2.5
- NBA237 X12  
3/32"
- NBA236 X1  
2.7× 5.9× 0.5mm

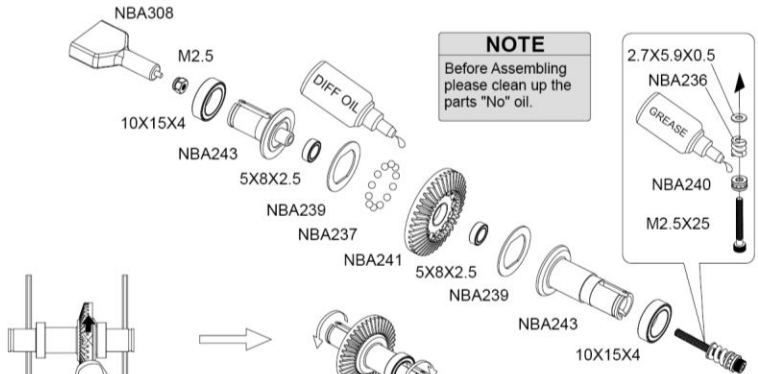

**NOTE**  
Before Assembling please clean up the parts "No" oil.

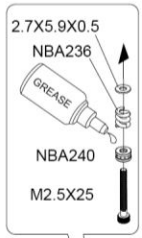

**NOTE**  
The differential should be tightened until the gear cannot be rotated when both of the diff hubs are held. The differentials should turn smoothly after assembling.



**BALL DIFF**

### 2

- NBA221 X2  
2×5×0.5mm
- NBA221 X1
- NBA219 X1  
2.9×6.6mm
- NBA223 X1
- NBA219 X1

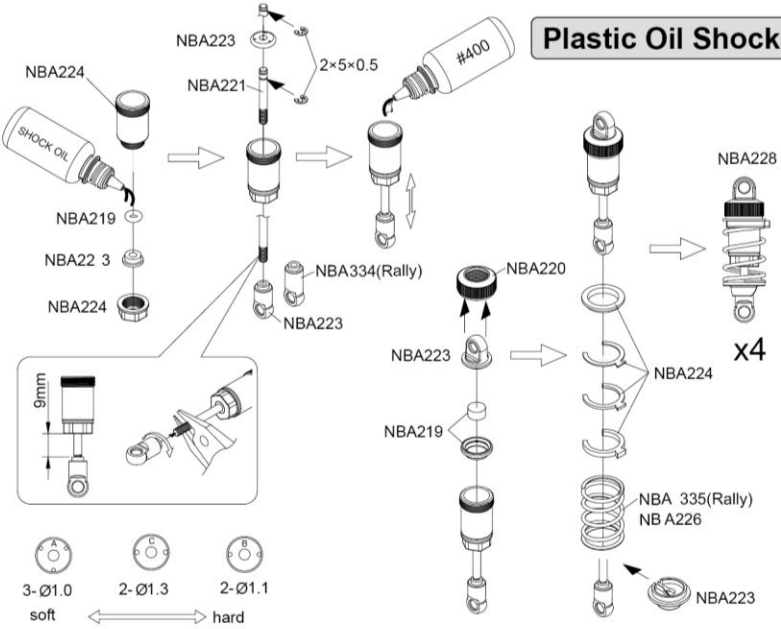



**Plastic Oil Shocks**



### 3

 X14  
NBA247

 X2  
NHA417  
M3x27

 X1  
NHA417  
M3x29

 X4  
NHA417  
M3x37



**SET UP**

← 15.4mm →

Ⓐ x2 - Steering

← 21mm →

Ⓑ x1 - Servo Saver

← 24mm →

Ⓒ x2 - Front upper

← 25.8mm →

Ⓓ x2 - Rear upper

### 4

 X6  
NBA280  
M3x8mm

 X6  
NBA294  
M3

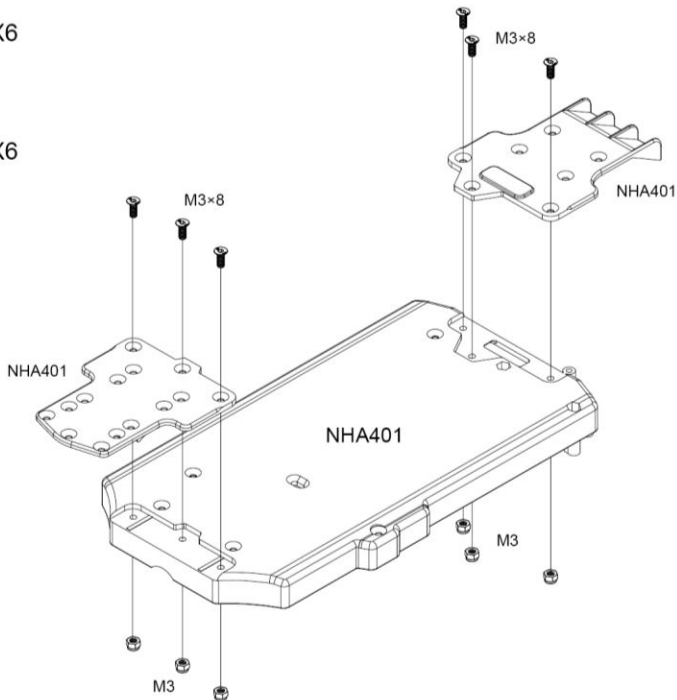

5



X6

NBA280  
M3x8mm

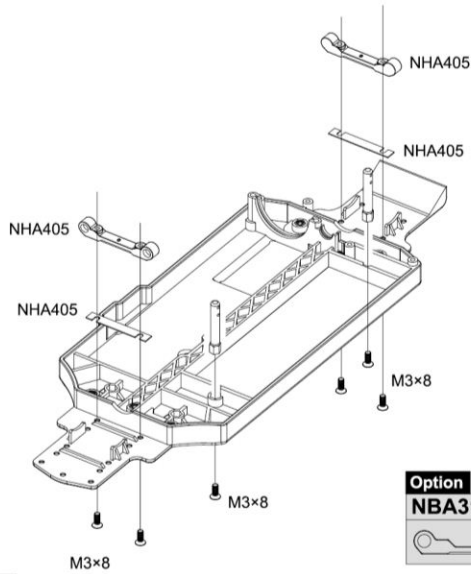

Option

NBA314 Pivot Block (ALUMINUM) 0°



x1

6



X8

NBA210



X8

NBA211



X4

NBA280  
M3x8mm

NHA423  
3x42

X4



X8

NBA289  
M3x8mm



X4

NHA430  
M4x10mm

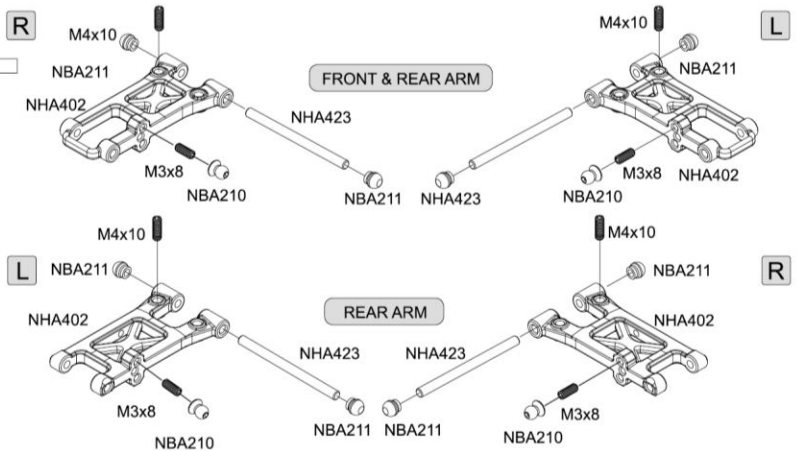
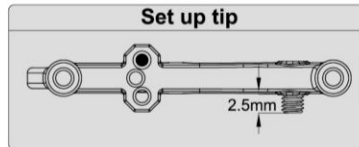



## 7

X4  
NBA280  
M3×8mm

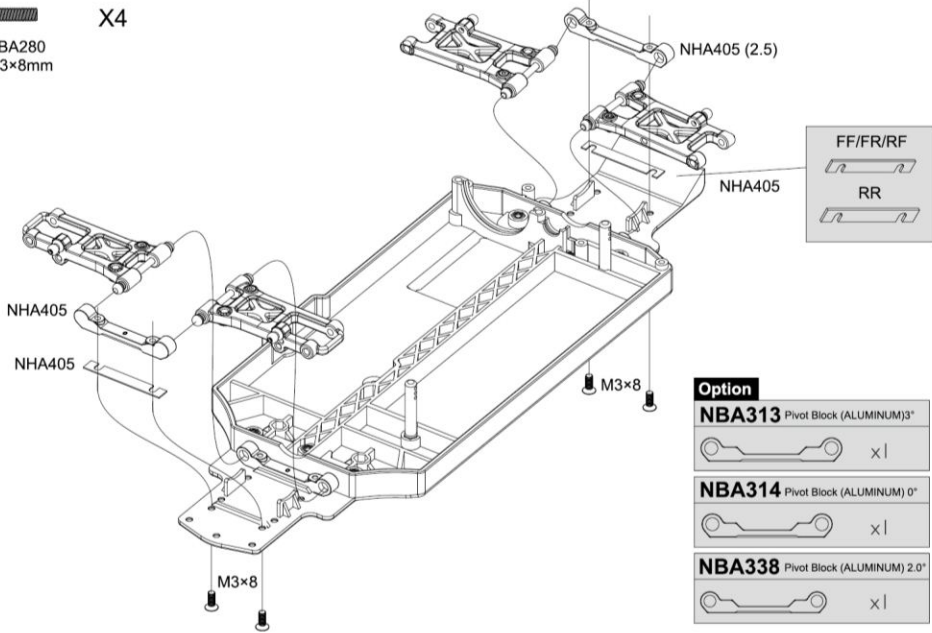

### Option

**NBA313** Pivot Block (ALUMINIUM) 3°



**NBA314** Pivot Block (ALUMINIUM) 0°



**NBA338** Pivot Block (ALUMINIUM) 2.0°



## 8

X1  
NBA281  
M3×6mm

X2  
NBA280  
M3×8mm

X5  
NBA298  
5×10×4mm

X2  
NBA306  
5.8×9.6×1.9mm

X2  
NBA255  
2×7.6mm

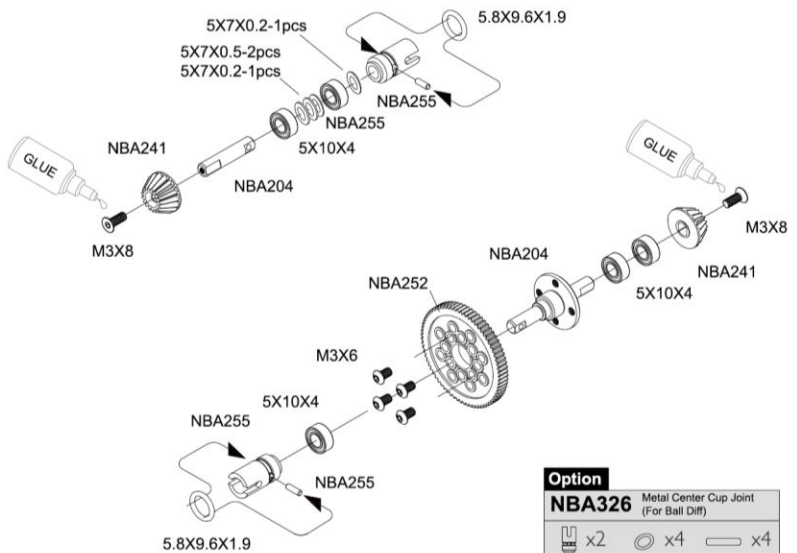

### Option

**NBA326** Metal Center Cup Joint  
(For Ball Diff)

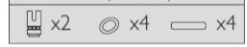



9

X2  
NBA283  
M3×10mm

X2  
NBA282  
M3×8mm

X2

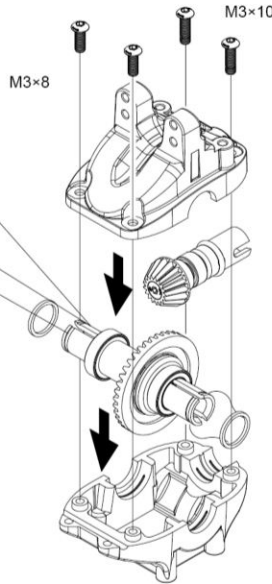
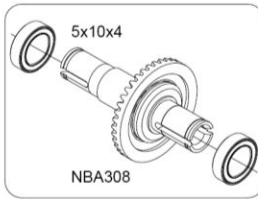

**FRONT**

**Option**

**NBA309** Ball Differential(Metal)



**NBA321** Solid Axle(40T/17T Plastic)

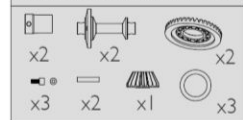

10

X2  
NBA283  
M3×10mm

X2  
NBA282  
M3×8mm

X2

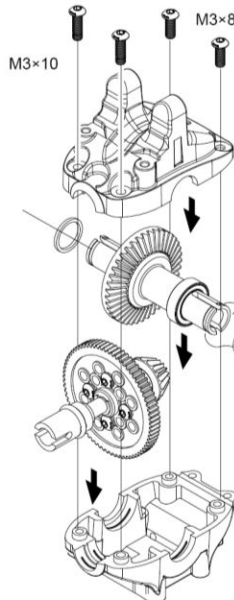

**REAR**

**Option**

**NBA309** Ball Differential(Metal)



## 11

-  X8
- NBA280  
M3X8mm

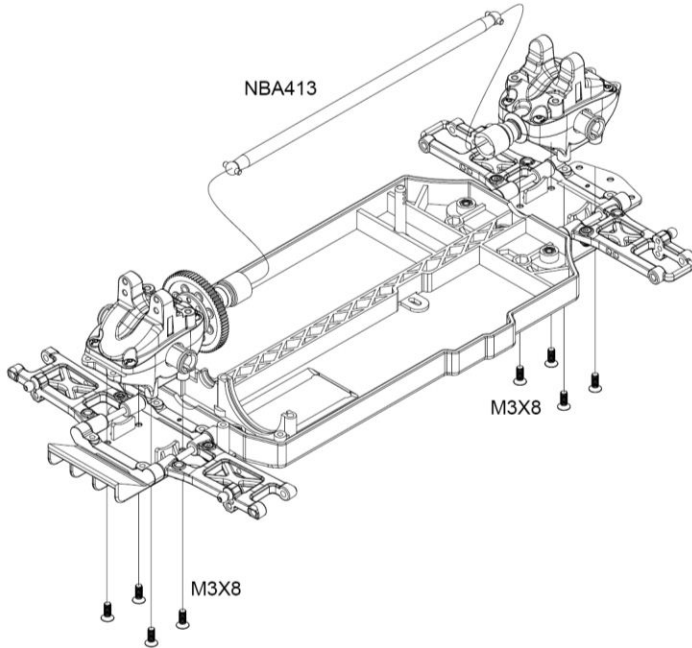

## 12

-  X2
- NBA284  
M3X12mm
-  X6
- NBA282  
M3X8mm
-  X4
- NBA210  
3X8mm
-   X2
- 3x6x4

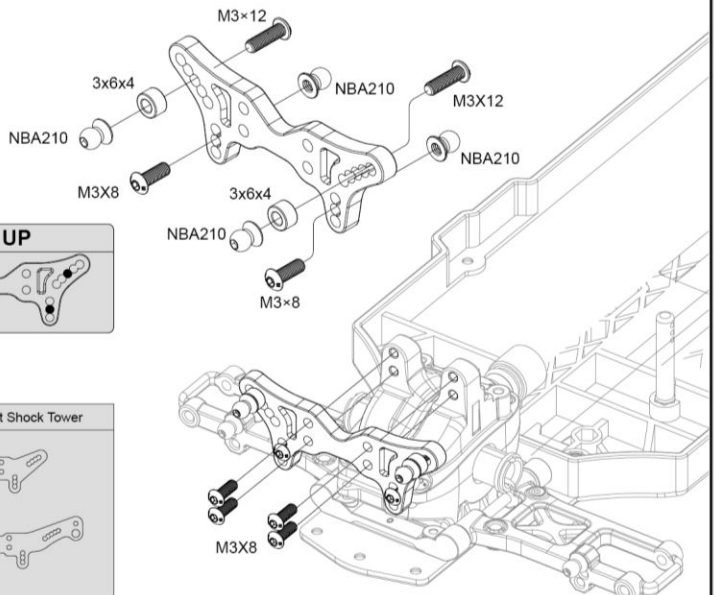
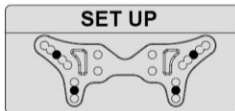

### 13

- X2  
NBA284  
M3X12mm
- X6  
NBA282  
M3X8mm
- X4  
NBA210  
3X8mm
- X2  
NBA283  
M3X10mm
- X2  
3x6x4

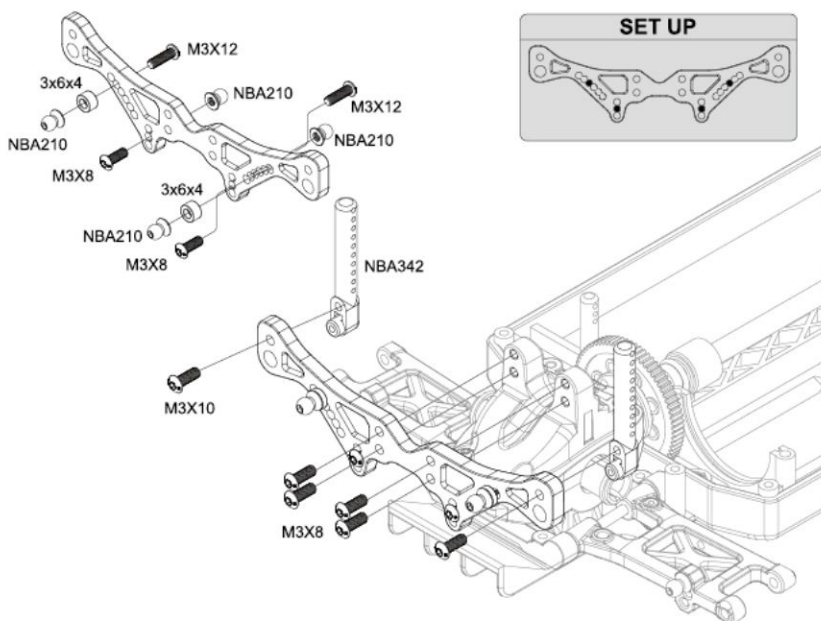

### 14

- X2  
NBA282  
M3x8
- X2  
NBA283  
M3x10
- X2  
NBA298  
5x10x4
- X2  
NHA419
- X4  
NBA210
- X4  
NHA420  
4.8x9

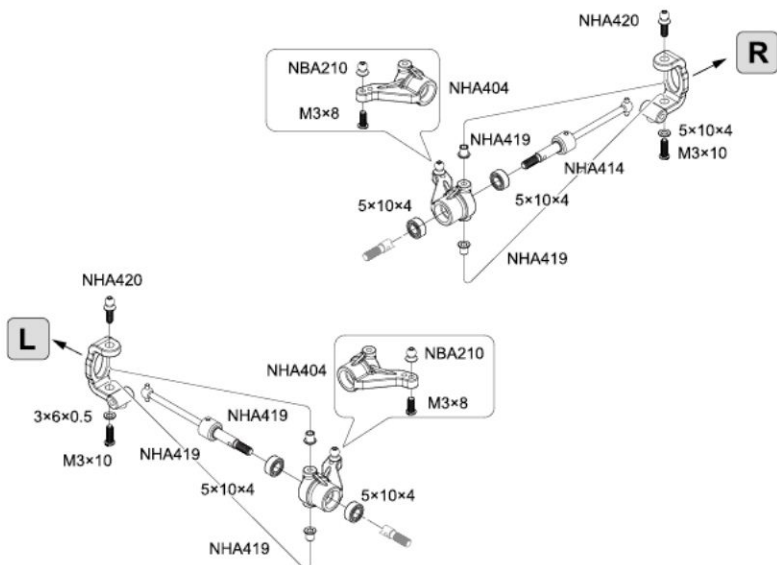

### 15

 X2  
NBA288  
M3X4mm

 X2  
NHA423  
2.5X23mm

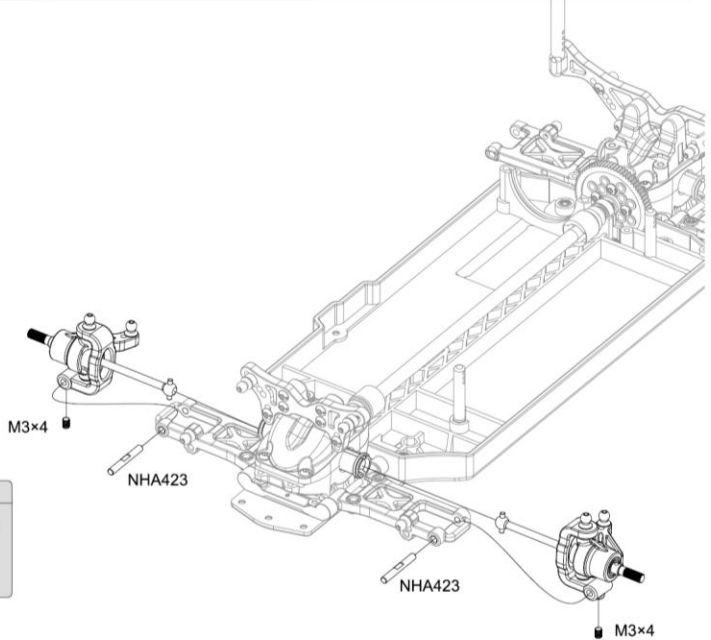

#### NOTE

Tight Grub screw on the groove of the pin



### 16

 X4  
NBA298  
5x10x4mm

 X2  
NBA290  
M3x10mm

 X2  
NBA210  
3x8mm

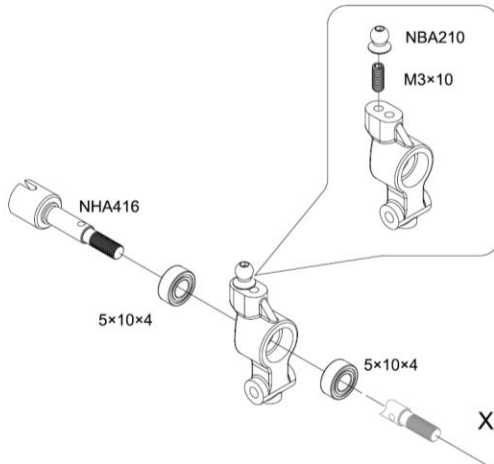

#### Option

**NHA414** CVD Drive Shaft



x2

### 17

 X2

NHA423  
2.5×26mm

 X2

NBA288  
M3×4mm

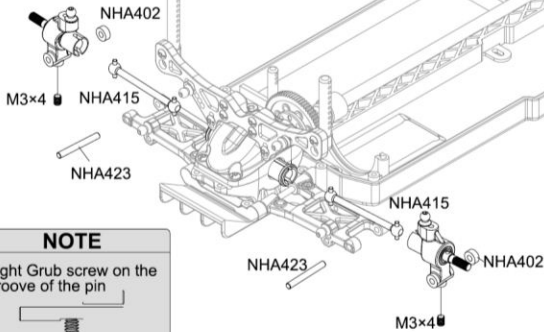

**NOTE**  
Tight Grub screw on the groove of the pin



**Adjustable Wheelbase**

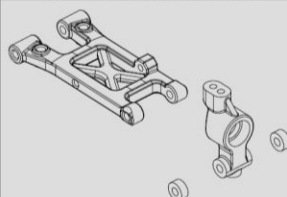

Spacer in front : 258mm  
Spacer in rear : 255mm

### 18

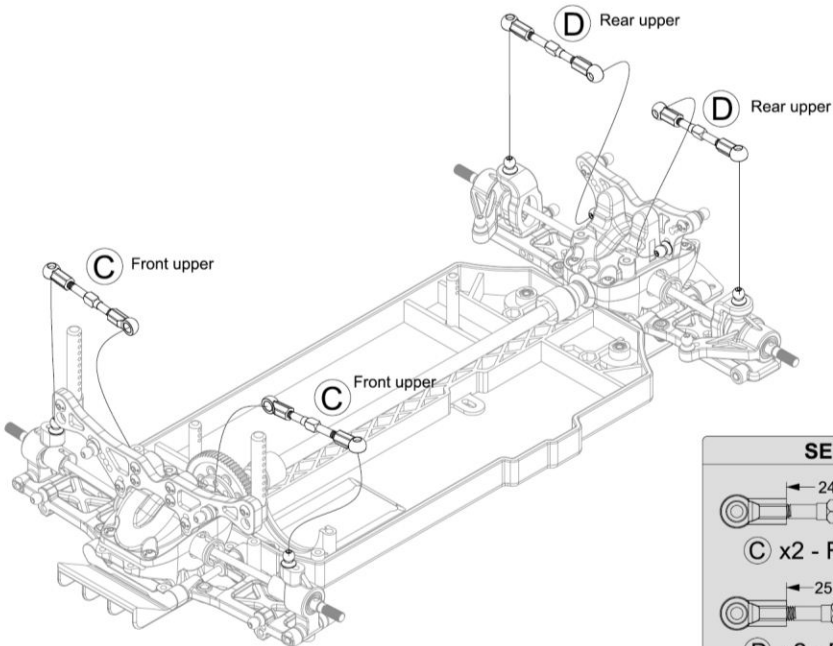

**SET UP**



24mm

**C** x2 - Front upper



25.8mm

**D** x2 - Rear upper

19

X2

NBA284  
M3×12mm

X2

NBA282  
M3×8mm

X3

NBA210  
3×8mm

X2

NHA406

X1

NBA289  
M3×8mm

X4

NBA282  
M3×8mm

X2

NHA420  
3X7 mm

X4

NHA441  
5×8×2.5mm

X2

NBA280  
M3×8mm

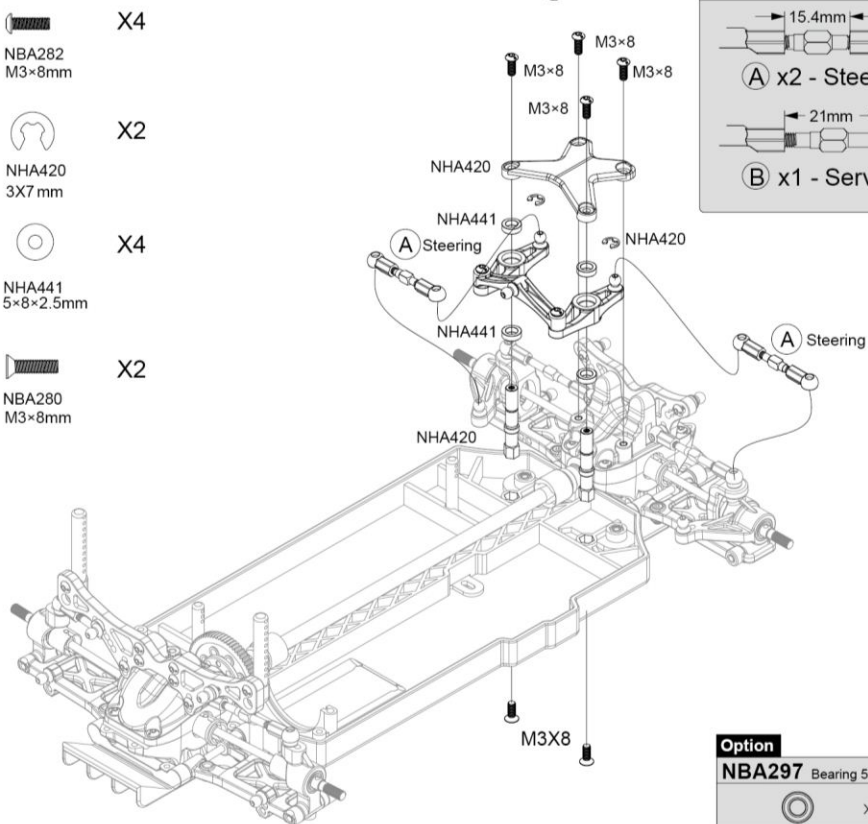
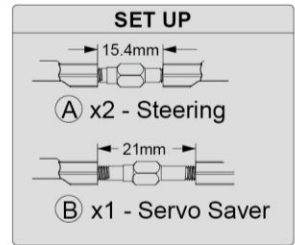
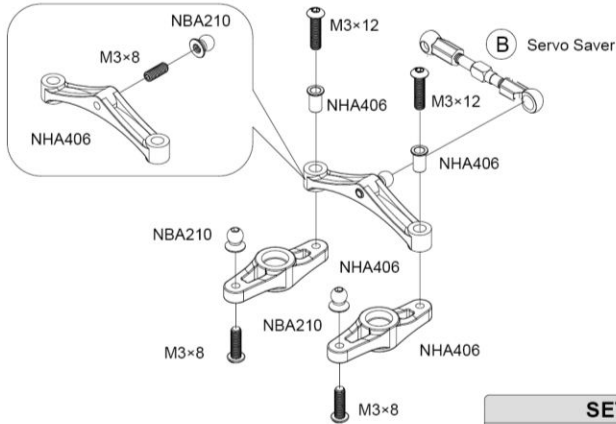

**Option**  
NBA297 Bearing 5x8x2.5

x2



**FRONT**

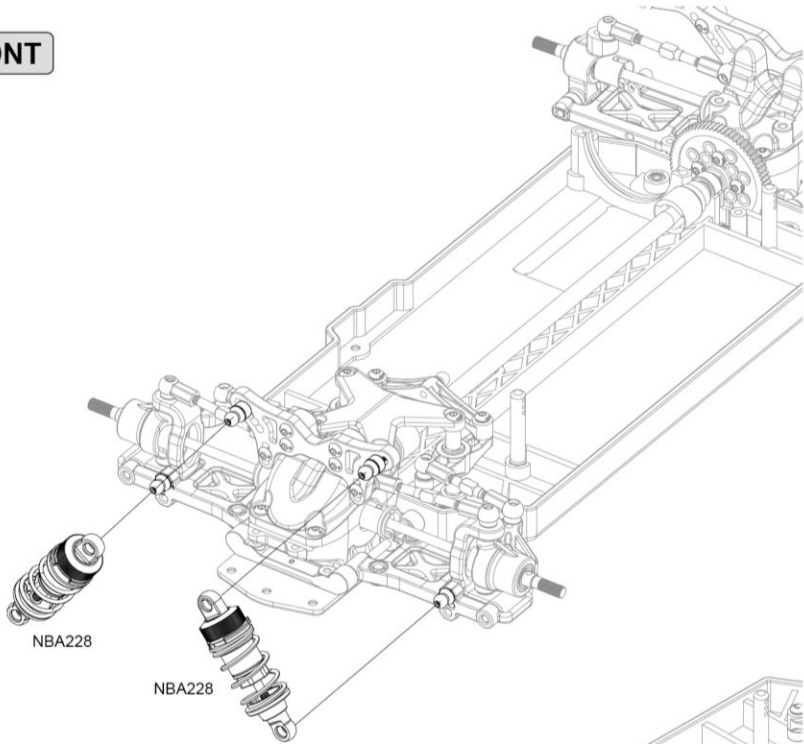

**REAR**

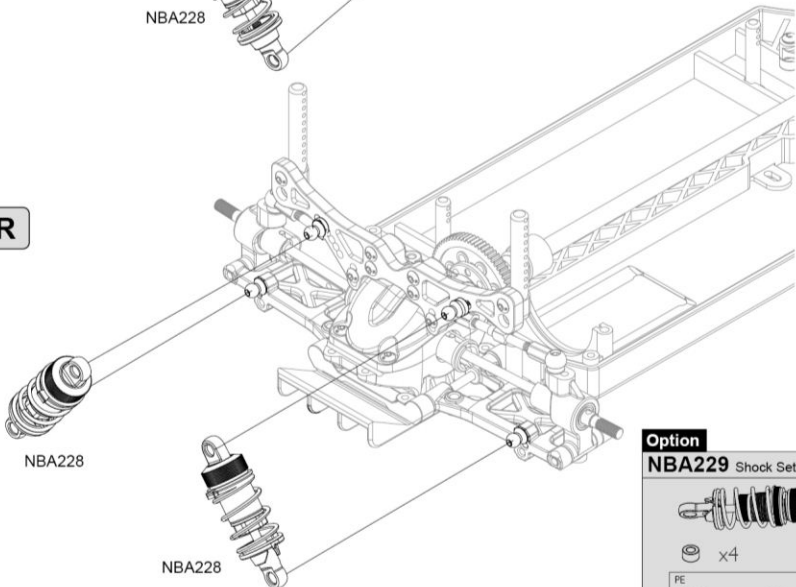

**Option**  
**NBA229 Shock Set (Aluminum)**



x4

**FE**  
 x4 x4



 X3  
NBA282  
M3×8mm

 X1  
NBA281  
M3×6mm

 X1  
NBA254  
(Black)

 X2  
NBA254  
(Silver)

 X1  
NBA210  
3×8mm

 X2  
NBA280  
M3×8mm

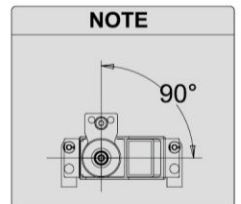
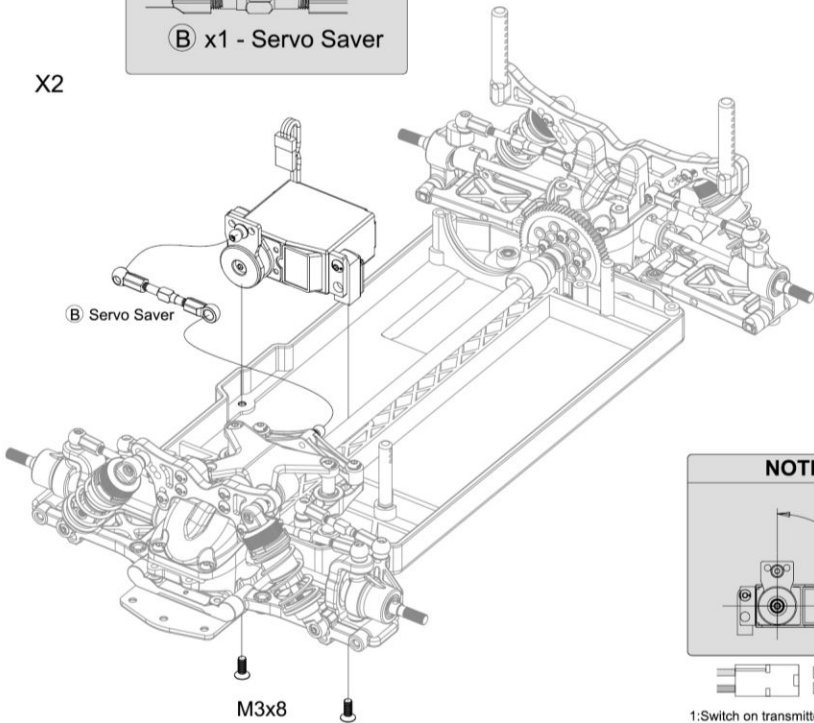
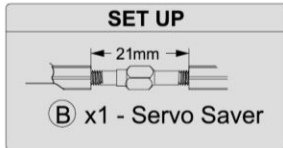
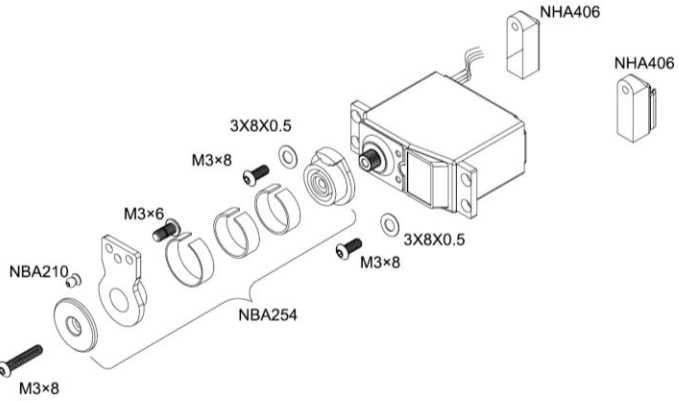

1: Switch on transmitter  
2: Connecting battery and turn on ESC switch

 X2  
NBA305

 X2  
NBA282  
M3×8mm

 X2  
NBA280  
M3×8mm

 X3  
NBA280  
M3×8mm

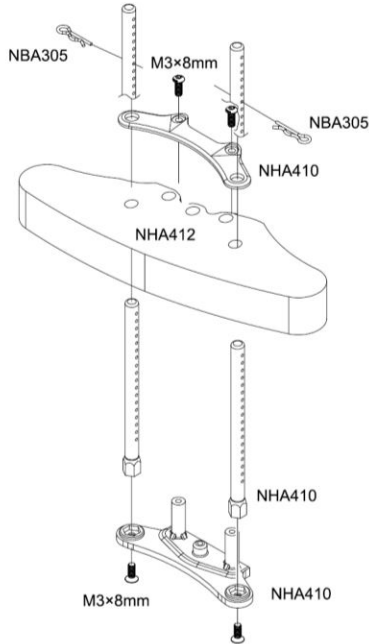

**Option**

**NBA336** Bumper For Touring Car Body



**NHA412** Bumper For Touring Car Body



There are two sizes of bumper that Allowed to fit Different kind of Body shell.

**Option**

**NBA278** Bumper Plate (For Sedan Body)

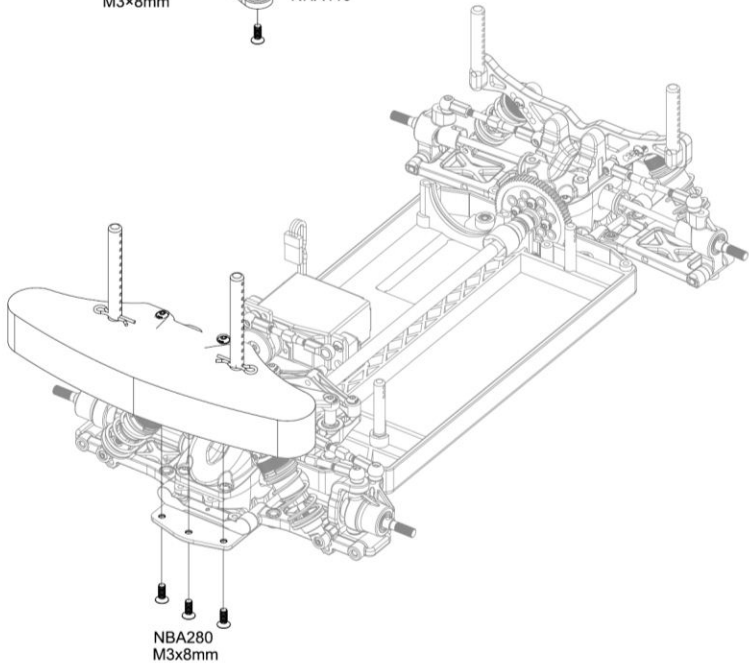

### 23

-  X1  
NBA287  
M3x3mm
-  X2  
NBA301  
3x6x0.5
-  X2  
NHA425  
M3x6

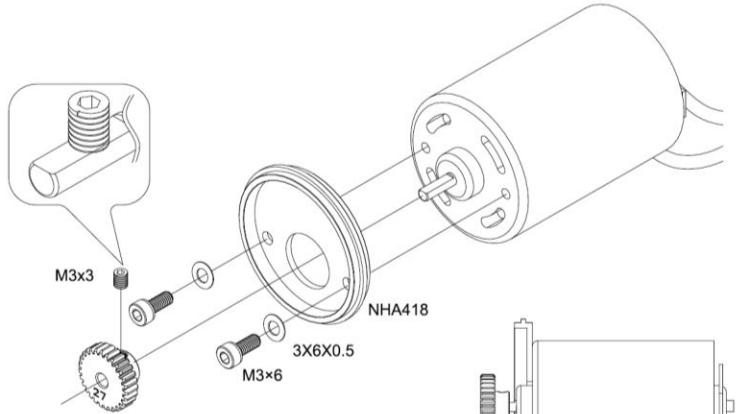

### 24

- NBA216 31T
- NBA218 27T

1.5mm

-  X2  
NHA408  
M3x38
-  X2  
NBA294  
M3
-  X2  
NBA301  
3x6.5x0.5

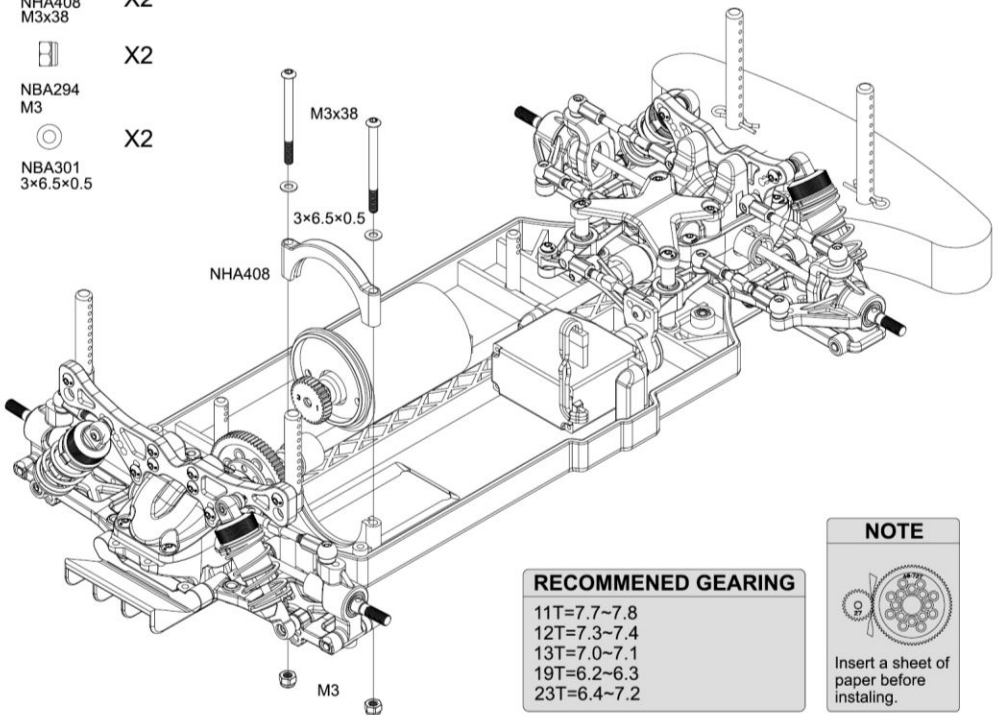

#### NOTE

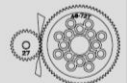

Insert a sheet of paper before installing.

#### RECOMMENDED GEARING

- 11T=7.7~7.8
- 12T=7.3~7.4
- 13T=7.0~7.1
- 19T=6.2~6.3
- 23T=6.4~7.2

**25**

 **X6**  
NBA282  
M3×8mm

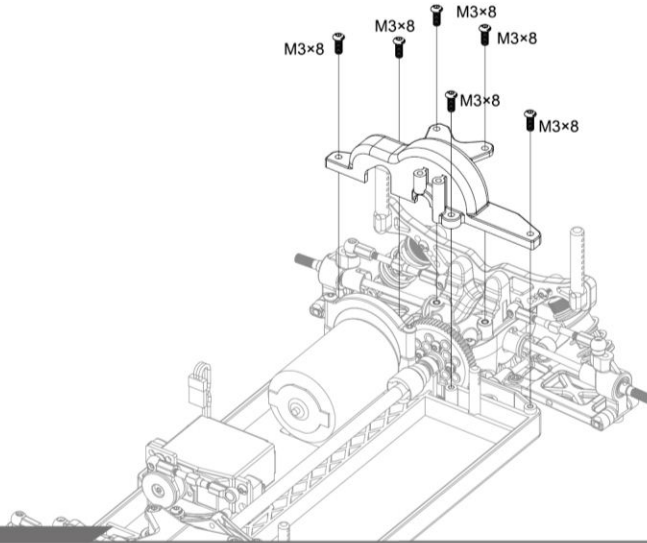

**26**

 **X4**  
NBA304  
2×10mm

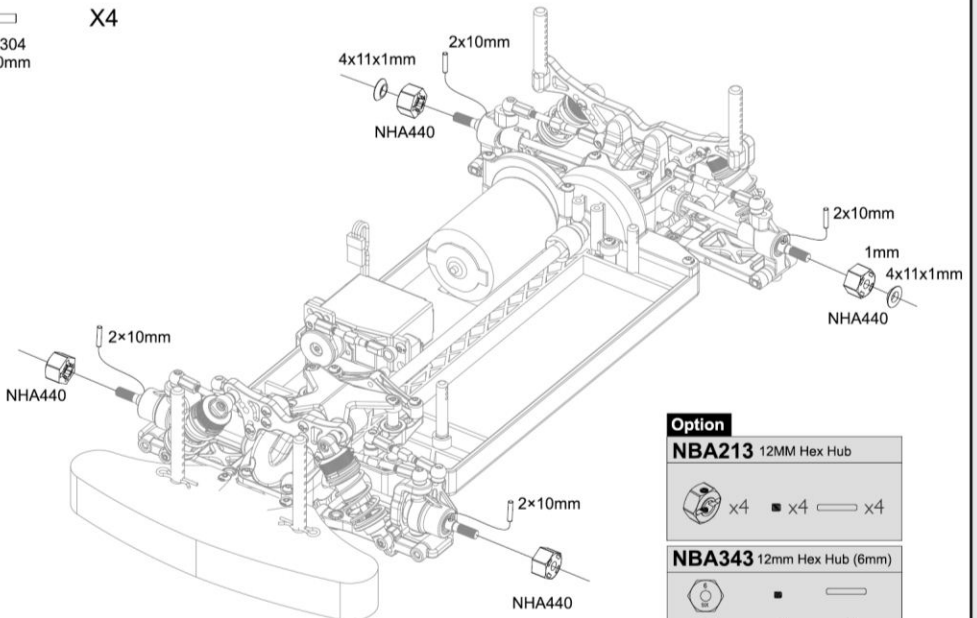

**Option**

**NBA213** 12MM Hex Hub

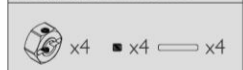

**NBA343** 12mm Hex Hub (6mm)



**NBA344** 12mm Hex Hub (7mm)



## 27

# T410



NBA295  
M4

X4

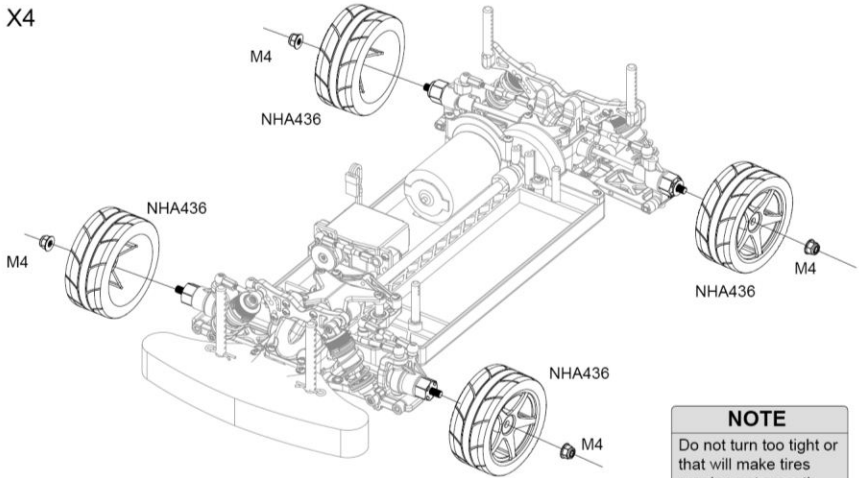

### NOTE

Do not turn too tight or that will make tires running not smooth.

## 28



NBA305

X2

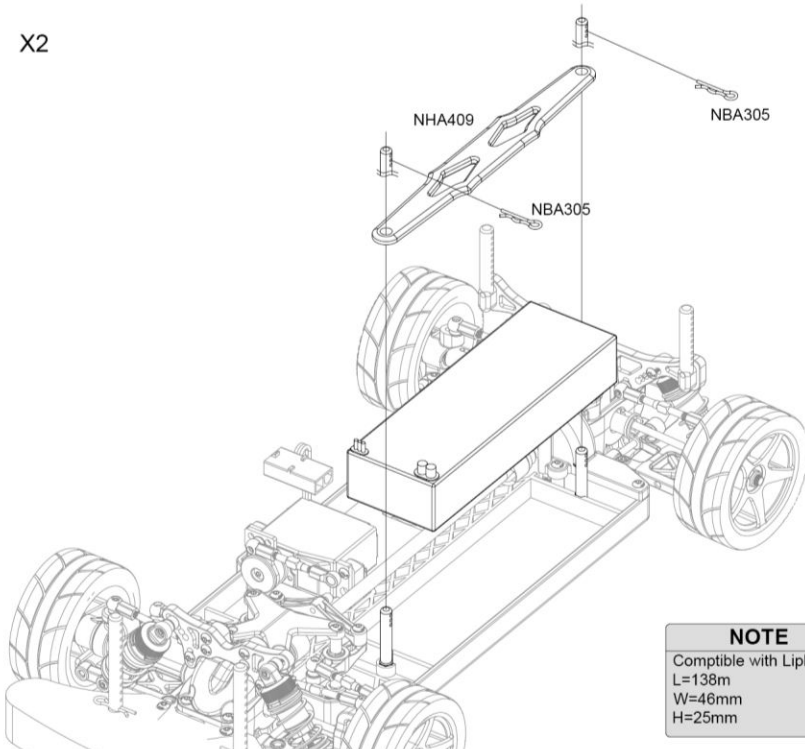

### NOTE

Comptible with Lipbattery  
L=138mm  
W=46mm  
H=25mm



X4

Cut the excess body post

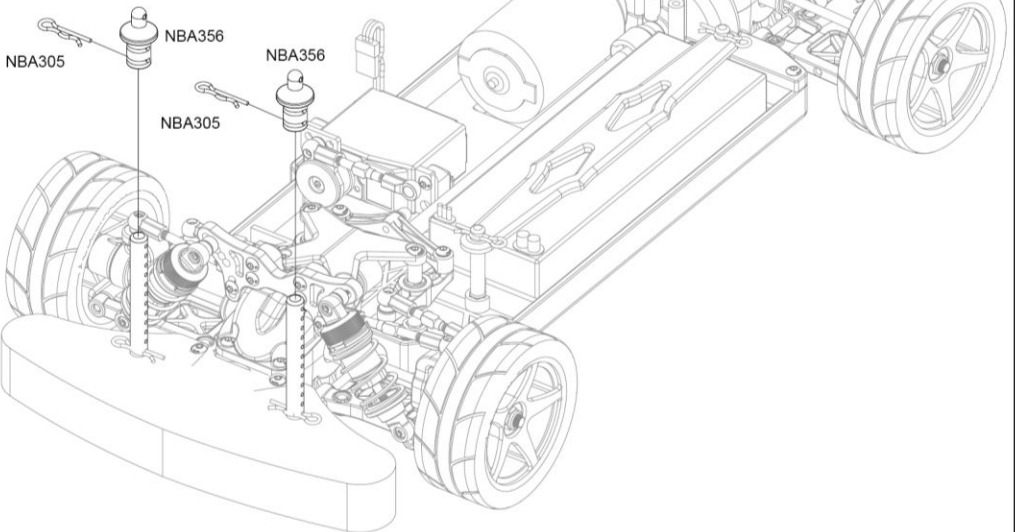
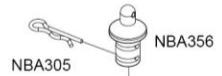
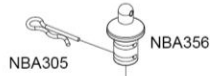
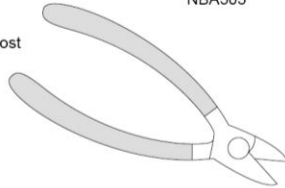

**GEAR RATIO**

SPUR GAER	T410	T410R
72	2.35	2.47
PINION GEAR	BALL DIFF (40/17) GEAR RATIO	GERA DIFF(42/17) GEAR RATIO
21	8.07	8.47
22	7.70	8.08
23	7.37	7.73
24	7.06	7.41
25	6.78	7.11
26	6.52	6.84
27	6.27	6.59
28	6.05	6.35
29	5.84	6.13
30	5.65	5.93
31	5.47	5.74
32	5.29	5.56
33	5.13	5.39
34	4.98	5.23
35	4.84	5.08
36	4.71	4.94
37	4.58	4.81
38		4.68
39		4.56
40		4.45
41		4.34
42		4.23
43		4.14
44		4.04

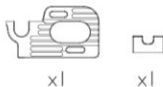

**NBA201** Motor Mount

**NBA204** Drive Shaft And Spur Gear Hub (For Ball Diff)

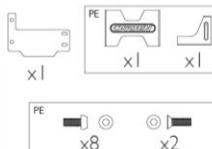
**NBA205** Drive Shaft And Spur Gear Hub (For Gear Diff)

**NBA206** Servo Mount Set

**NBA207** 17T Metal Bevel Gear (Gear Diff)

**NBA210** 4.8x6 mm Ball Stud

**NBA211** Pivot Ball Stud

**NBA213** 12MM Hex Hub

**NBA215** 39T-48P Pinon Gear (Aluminum)

**NBA216** 31T-48P Pinon Gear (Metal)

**NBA217** 31T-48P Pinon Gear (Aluminum)

**NBA218** 27T-48P Pinon Gear (Metal)

**NBA219** Shock Parts(O-rings)

**NBA220** Shock Body sets (Aluminum)

**NBA221** Shock shafts

**NBA222** Shock Body (Aluminum)

**NBA223** Shock Parts

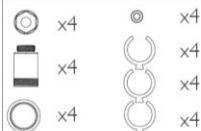
**NBA224** Plastic Shock

**NBA225** Shock spring (1.2X22mm) Blue-Hard

**NBA226** Shock spring (1.2X22mm) Yellow-Medium

**NBA227** Shock spring (1.2X22mm) Red-Soft

**NBA228** Shock Set(Plastic)

**NBA229** Shock Set (Aluminum)

**NBA230** Gear Differential

**NBA231** Gear Diff Case

**NBA232** 42T Bevel Gear (Metal)

**NBA233** Gear Diff Cup Joint

**NBA234** Gear Diff Oring

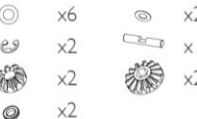
**NBA235** Gear Diff Bevel Gear Set

**NBA236** Ball Diff Parts Set

**NBA237** Diff Ball (3/32)

**NBA238** Ball Diff Screw Set

**NBA239** Ball Diff Shim

**NBA240** Thrust Bearing

**NBA241** Diff gears (Ball Diff)

**NBA242** Diff O-rings (Ball Diff)

**NBA243** Ball Diff cup joint (Plastic)

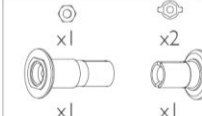
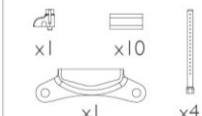
**NBA244** Ball Diff cup joint (Metal)

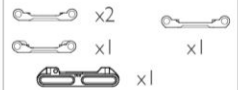
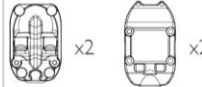
**NBA245** Front Bumper Hold And Body Mount

**NBA247** Ball End (4.8mm)

**NBA248** Suspension Mount Parts

**NBA249** Gear box

**NBA252** Spur Gear 72T

x1

**NBA253** Hex Hub (5MM)

x4



x4

**NBA254** Servo Saver

x1



x1



x1



x1



x2



x1

**NBA255** Cup Joint

x3



x2



x2

**NBA256** Bumper For Sedan Body

x1

**NBA257** Bumper For Hatchback Body

x1

**NBA258** Battery Strap

x2

**NBA259** Antenna Pipe

x1



x1

**NBA274** Battery Holder

x2

**NBA275** Body Mount Plate

x2

**NBA276** Servo Plate

x1

**NBA277** Bumper Plate (For Hatchback Body)

x1

**NBA278** Bumper Plate (For Sedan Body)

x1

**NBA279** Screw Set - FH M3x6

x10

**NBA280** Screw Set - FH M3x8

x10

**NBA281** Screw Set - BH M3x6

x10

**NBA282** Screw Set - BH M3x8

x10

**NBA283** Screw Set - BH M3x10

x10

**NBA284** Screw Set - BH M3x12

x10

**NBA285** Screw Set - BH M3x18

x10

**NBA286** Screw Set - FH M2x8

x10

**NBA287** Set Screw M3x3

x10

**NBA288** Set Screw M3x4

x10

**NBA289** Set Screw M3x8

x10

**NBA290** Set Screw M3x10

x10

**NBA291** Set Screw M3x12

x10

**NBA292** Set Screw M3x18

x10

**NBA293** Set Screw M3x20

x10

**NBA294** M3 Nut

x10

**NBA295** M4 Nut

x4

**NBA296** Bearing 3X6X2.5

x4

**NBA297** Bearing 5\*8\*2.5

x2

**NBA298** Bearing 5X10X4

x8

**NBA299** Bearing 10X15X4

x4

**NBA300** Spacer Set 3X6X2.5

x4

**NBA301** Washer (3\*6.5\*0.5 mm)

x10

**NBA302** Washer (3\*8\*0.5 mm)

x10

**NBA303** E-Clip

x5

**NBA304** Pin2X10

x10

**NBA305** Body pinS

x12

**NBA306** O-Ring

x10

**NBA307** Washer (11\*14\*0.2 mm)

x10

**NBA308** Differential (Plastic)

x2



x1



x6

**NBA309** Ball Differential (Metal)

x1



x1



x3

**NBA310** Gear Differential Set

x2



x1



x1



x6



x2



x2

**NBA312** Fan Holder (For 30mm Fan)

x1



x2



x2



x4



x2

**NBA313** Pivot Block (ALUMINUM) 3°

x1

**NBA314** Pivot Block (ALUMINUM) 0°

x1

**NBA315** Pivot Block (ALUMINUM) 2.5°

x1

**NBA318** Aluminum Hex 5.5 x 10mm

x10

**NBA321** Solid Axle (40T/17T Plastic)

x2



x2



x3



x2



x1



x3

**NBA322** Plastic 40T/17T Bevel Gear (For Solid Axle)

x2



x2

**NBA323** Solid Axle (42T/17T Metal)

x1



x1



x1



x3

**NBA325** 42T Metal Bevel Gear (for Solid Axle)



x1

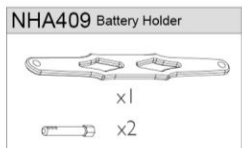
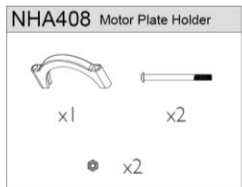
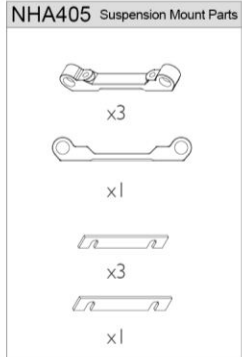
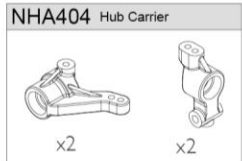
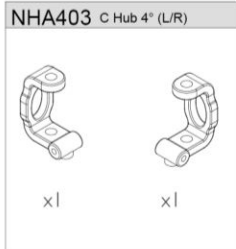
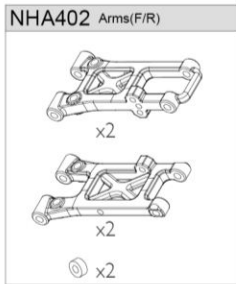
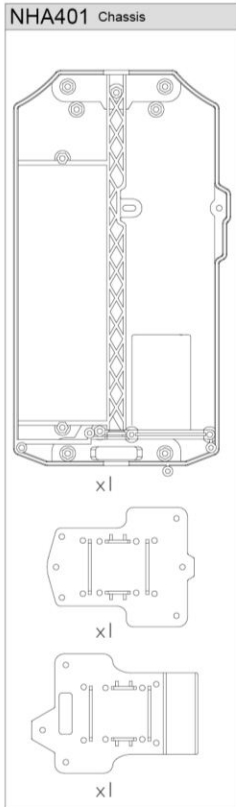
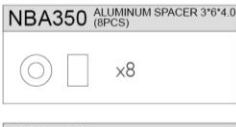
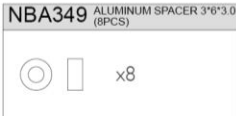
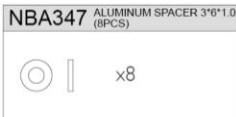
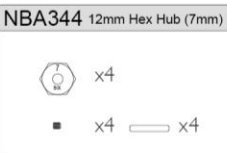
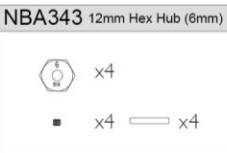
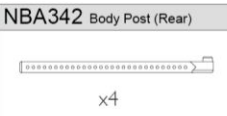
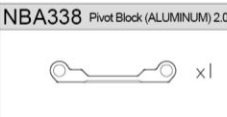
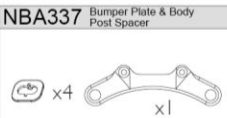
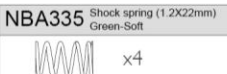
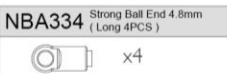
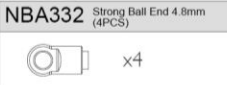

x4

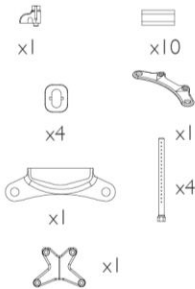

### NHA410 Front Bumper Holder Set



### NHA411 T410 Shock Tower

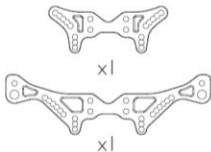

### NHA412 Bumper

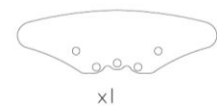

### NHA413 Center Drive Shaft



### NHA414 CVD Drive Shaft

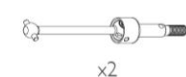

### NHA415 Dog Bone/45mm

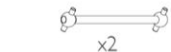

### NHA416 Axle



### NHA417 Turnbuckle Set

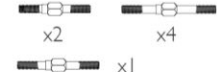

### NHA418 Motor Plate (T410)

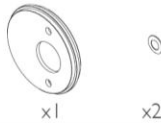

### NHA419 Steering Bush



### NHA420 Ball stud 4.8x9



### NHA421 Steering Post(T410)



### NHA422 Steering Post(T410R)



### NHA423 Suspension Shaft Set



### NHA424 Cap Head Screw M2x6



### NHA425 Cap Head Screw M3x6



### NHA426 Cap Head Screw M3x8



### NHA427 Cap Head Screw M3x10



### NHA428 Cap Head Screw M3x12



### NHA429 Flat Screw M3x14



### NHA430 Set Screw M4x10



### NHA431 T410R-Chassis

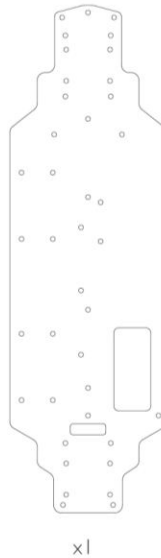

### NHA432 T410R-Upper Deck



### NHA433 Front Shock Tower

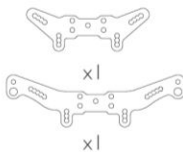

### NHA434 Sway Bar-1.4mm

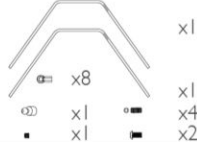

### NHA435 Sway Bar-1.6mm

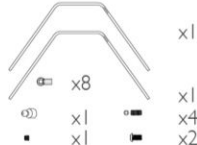

### NHA436 1/10 Tires 5 Spoke Wheel-White(26mm)



### NHA437 1/10 Drift Tires 5 Spoke Wheel-White(26mm)



### NHA438 Wing Set

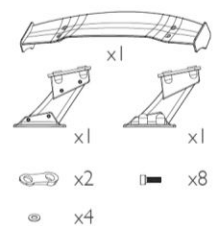

### NHA439 Back mirror and exhaust pipe

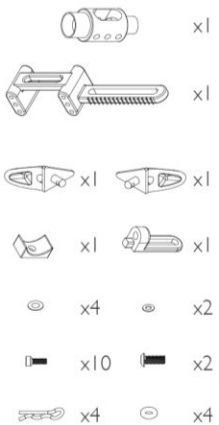

### NHA440 12mm HEX (T 5mm/8mm)



### NHA441 5x8x2.5 Metal bushing



**NHA442** 5"7"0.5 washers



x10

**NHA443** 5"7"0.2 washers



x10

**NHA447** T410 Aluminum Rear Hub



x1

x1

**NHA448** T410 Aluminum Steering Blocks



x1

x1

**NHA449** T410 Aluminum C Hub



x1

x1

**NHA451** 5 Spoke Wheels White /26mm (ET-2mm)



x4

**NHA452** 5 Spoke Wheels White /24mm (ET-2mm)



x4

**NHA454** 1/10 on-road tires 26mm



x4

**NHA457** Shock Spring 1.4"20mm (White)



x4

**NHA458** Shock Spring 1.4"20mm (Blue)



x4

**NHA459** Shock Spring 1.4"20mm (Yellow)



x4

**NHA460** Shock Spring 1.4"20mm (Red)



x4

**NHA461** Shock Spring 1.4"20mm (Green)



x4

**NHA462** Shock Spring 1.4"20mm (Purple)



x4

**NHA475** Heavy duty gear diff set



x2

x2

x2

x4

x2

x3

x2

x2

x2

x4

x5

x1

x1

x2















x2

x2





# T410R

- NBA229**
-  NBA220
  -  NBA223
  -  NBA219
  -  NBA221
  -  NBA222
  -  NBA220
  -  NBA219
  -  NBA223
  -  NBA220
  -  NBA225
  -  NBA226
  -  NBA227
  -  NBA335
  -  NBA223
  -  NBA334(Long)

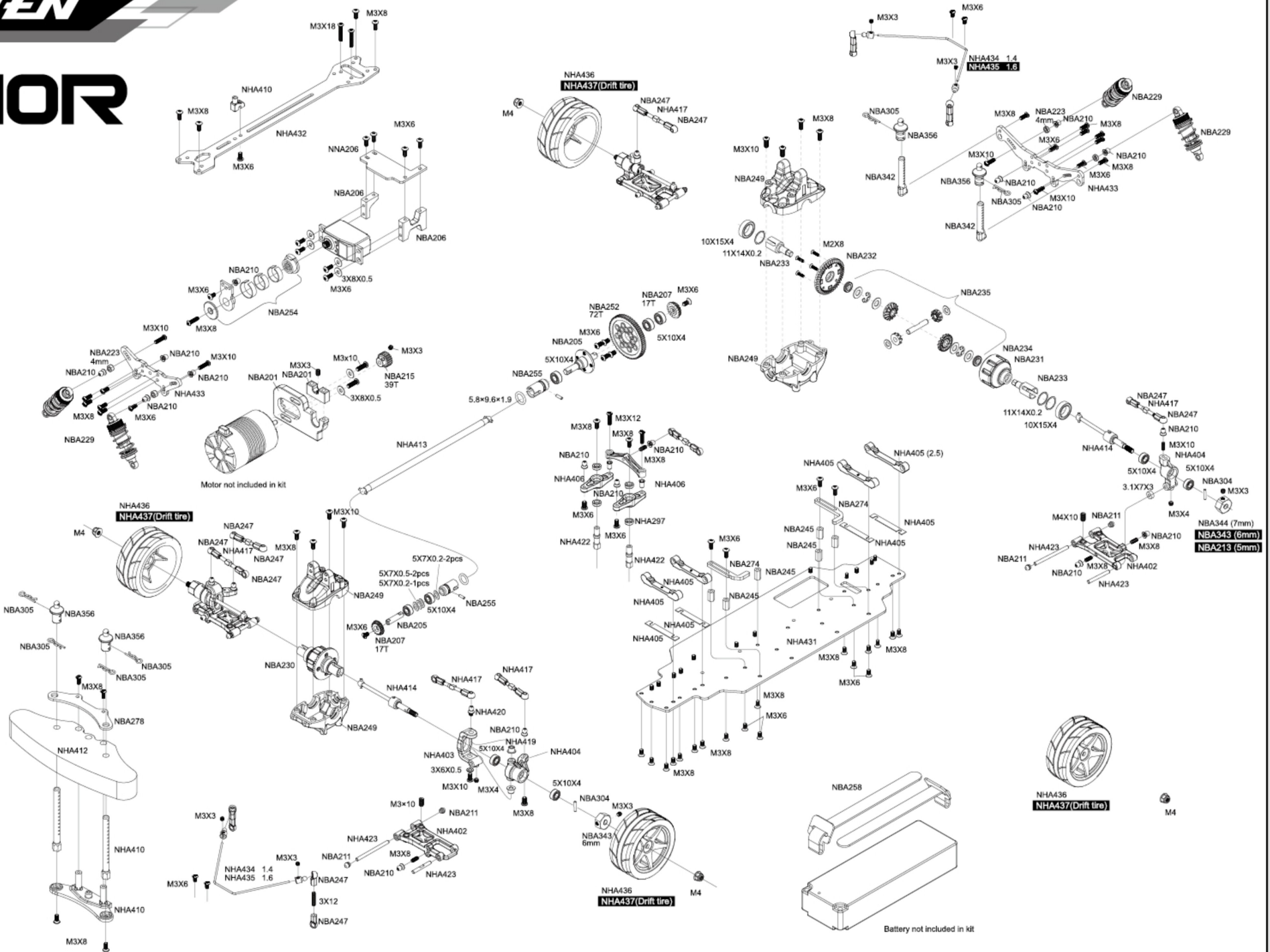



# T410

- NBA228
- NBA224
- NBA223
- NBA219
- NBA223
- NBA221
- NBA224
- NBA219
- NBA223
- NBA224
- NBA225
- NBA226
- NBA227
- NBA335
- NBA223
- NBA334(Long)

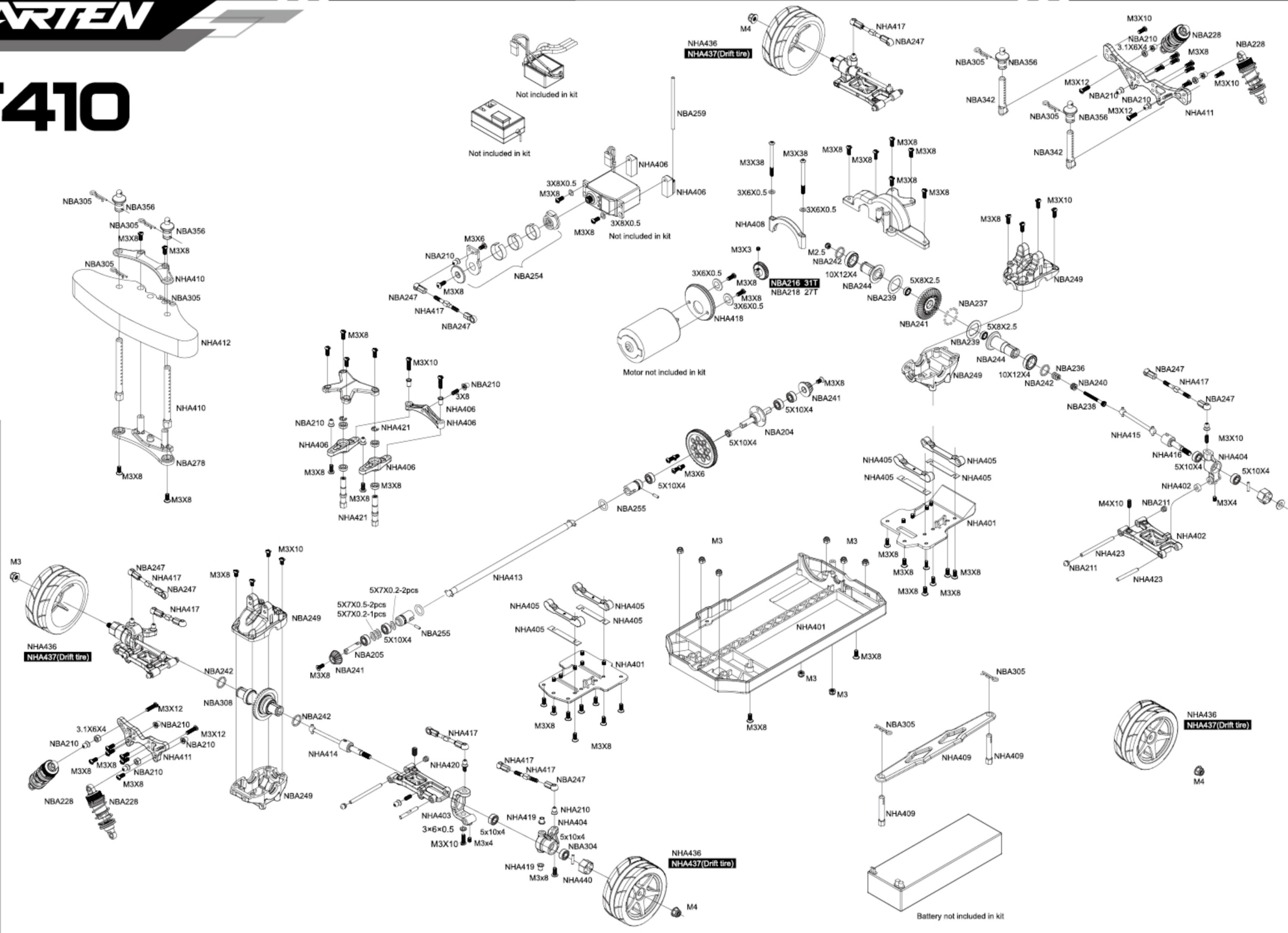







**CARTEN**<sup>®</sup>

1/10 EP RC TOURING CAR

**T410R**

Revolution

**T410**

Standard



CARTEN RC Website v0.2

✉ [service@carten-rc.com](mailto:service@carten-rc.com)