

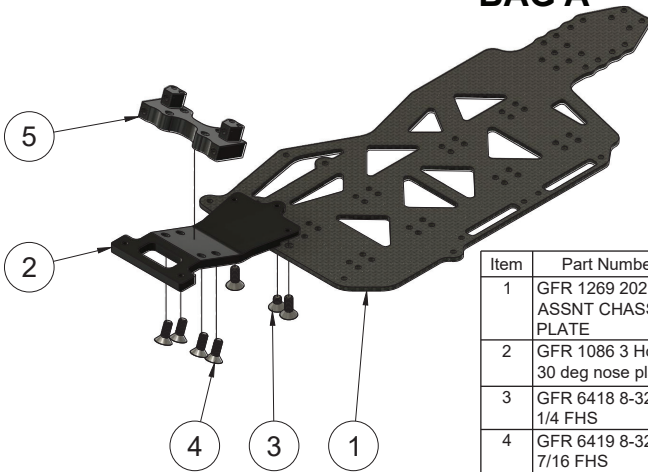

STEP 1 BAG A



Item	Part Number
1	GFR 1269 2021 ASSNT CHASSIS PLATE
2	GFR 1086 3 Hole 30 deg nose plate
3	GFR 6418 8-32 x 1/4 FHS
4	GFR 6419 8-32 x 7/16 FHS
5	GFR 1114 Front Bulkhead

STEP 2



Item	Part Number
1	GFR 1215 Left
2	GFR 2037 Flanged 1/4x38 bearing
3	GFR 1215 Right

STEP 3

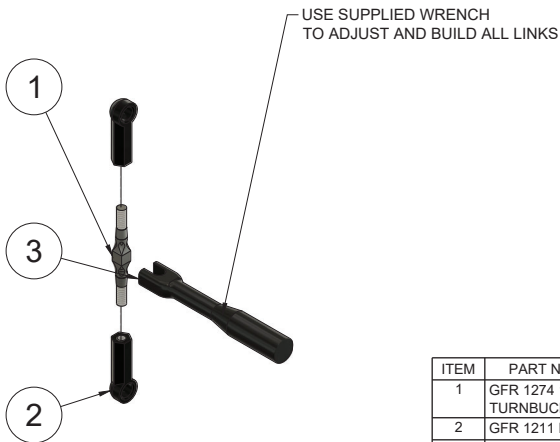

ITEM	PART NUMBER
1	GFR 1274 1.0 TURNBUCKLE
2	GFR 1211 BALL CUP
3	GFR 1255 TURNBUCKLE WRENCH

STEP 4



Item	Part Number
1	GFR 1280 Short Ball Stud
2	STEERING LINK ASSEMBLY
3	GFR 1215 Right
4	GFR 2037 Flanged 1/4x38 bearing
5	GFR 1215 Left

STEP 5

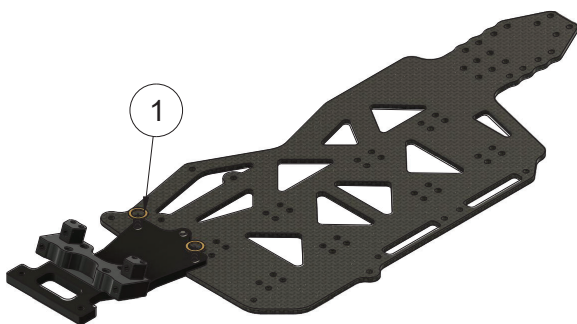

Item	Part Number
1	GFR 6433 1/4x.020 Brass Shim

STEP 6

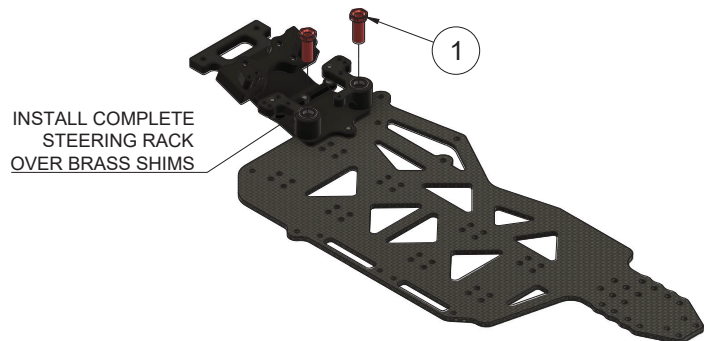

Item	Part Number
1	Long Bellcrank Standoff

STEP 7

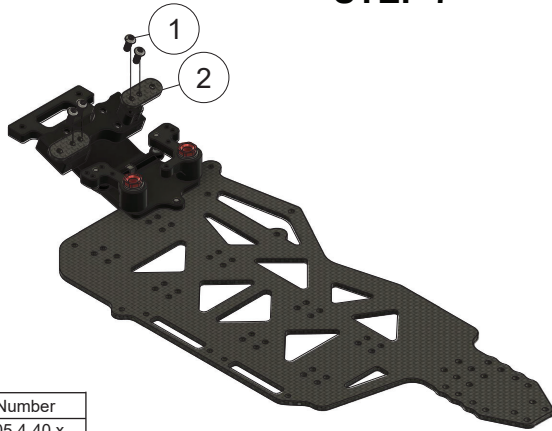

Item	Part Number
1	GFR 6405 4-40 x 5/16 BHS
2	GFR 2179 Camber Link Extensions

STEP 8

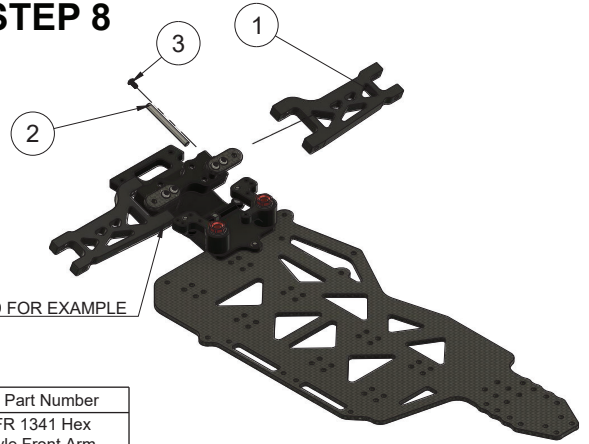

COMPLETED FOR EXAMPLE

Item	Part Number
1	GFR 1341 Hex Style Front Arm
2	GFR 1244 Cap FR Inner Hinge pin
3	GFR 6435 2-56x3/16 BHS

STEP 9

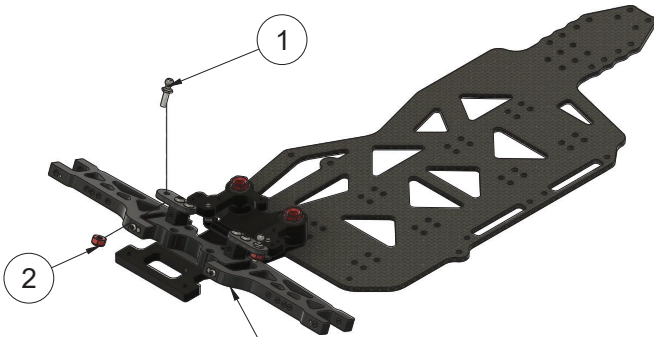

COMPLETED SIDE FOR EXAMPLE

Item	Part Number
1	GFR 1279 Medium Ball Stud
2	GFR 6009 4-40 Locknut

STEP 10



Item	Part Number
1	GFR 1270 2021 ASSNT FR SHOCK TOWER
2	GFR 6405 4-40 x 5/16 BHS

STEP 11 BAG B

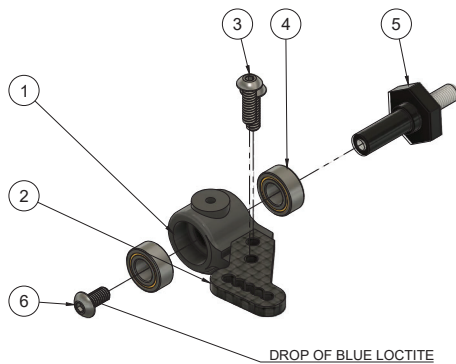

REPEAT STEP FOR LEFT FRONT

Item	Part Number
1	GFR 1284 Steering Block RF
2	GFR 1234 Steering Arm Ext
3	GFR 6407 4-40 x 3/8 BHS
4	GFR 6000 5x10x4 Bearing
5	GFR 1283 Front Axle Hex
6	GFR 6424 3x6mm BHS

STEP 12

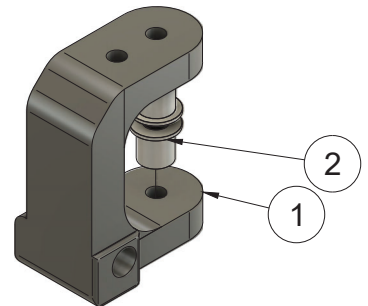

REPEAT STEP FOR LEFT FRONT

Item	Part Number
1	GFR 1285 RF Caster Block
2	GFR 1286 Caster Block Bushing

STEP 13

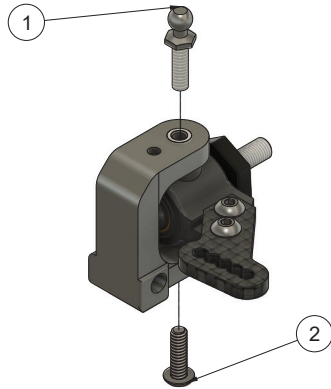

Item	Part Number
1	GFR 1281 Long Ball Studs
2	GFR 6407 4-40 x 3/8 BHS

REPEAT STEP FOR LEFT FRONT

STEP 14

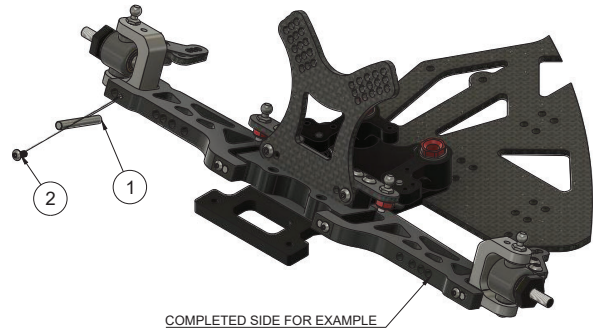

Item	Part Number
1	GFR 1221 Front Out Hing Pin
2	GFR 6435 2-56x3/16 BHS

STEP 15

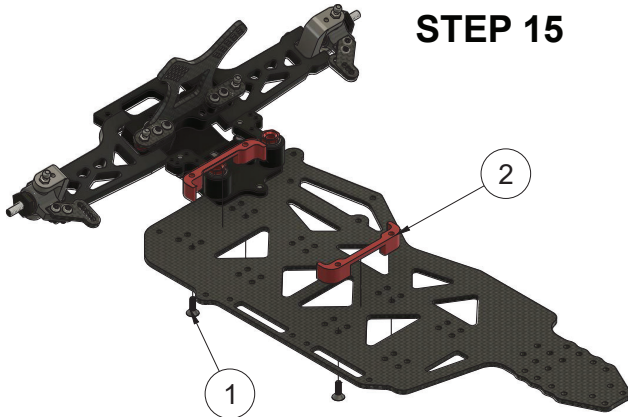

Item	Part Number
1	GFR 6408 4-40x 3/8 FHS
2	GFR 1236 Alum Battery Locator

STEP 16

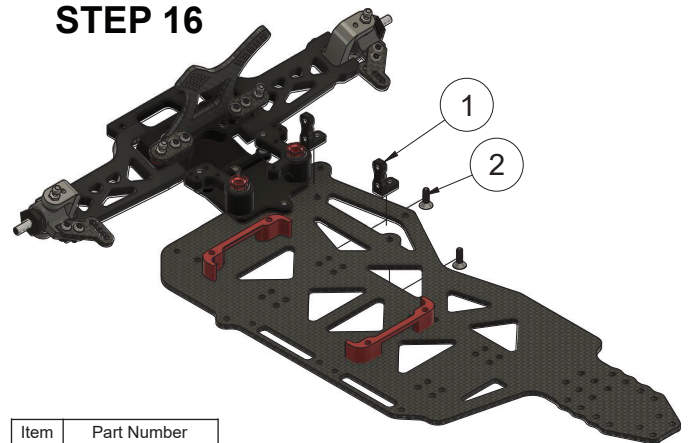

Item	Part Number
1	GFR 1231 Servo Mounts
2	GFR 6408 4-40x 3/8 FHS

STEP 17

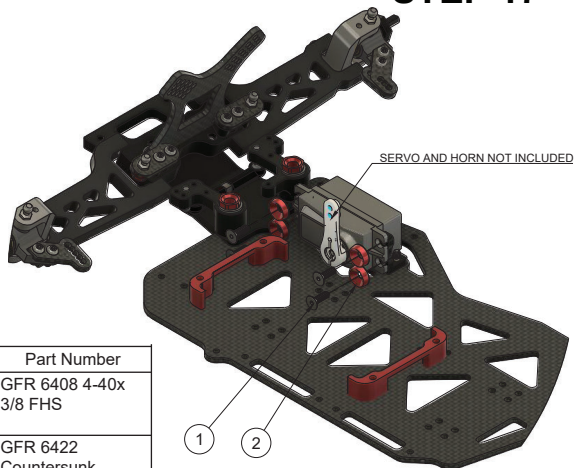

Item	Part Number
1	GFR 6408 4-40x 3/8 FHS
2	GFR 6422 Countersunk Washer

STEP 18

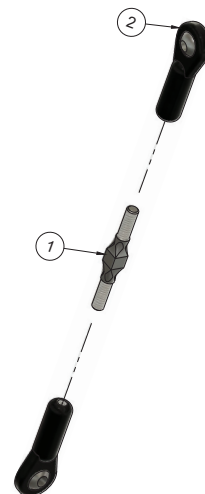

Item	Part Number
1	GFR 1275 1.125 Turnbuckle
2	GFR 6006 Rod End

STEP 19

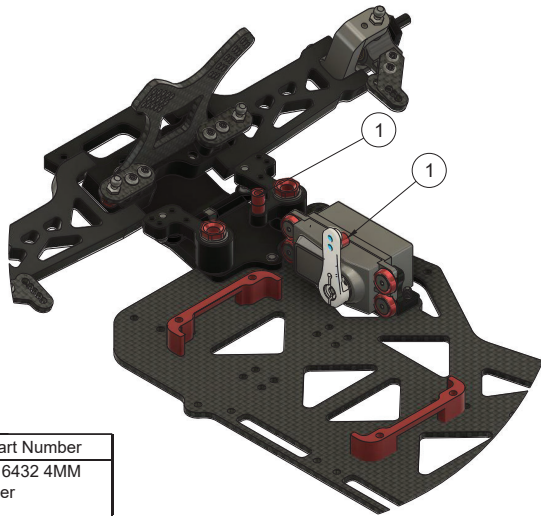

Item	Part Number
1	GFR 6432 4MM Spacer

STEP 20

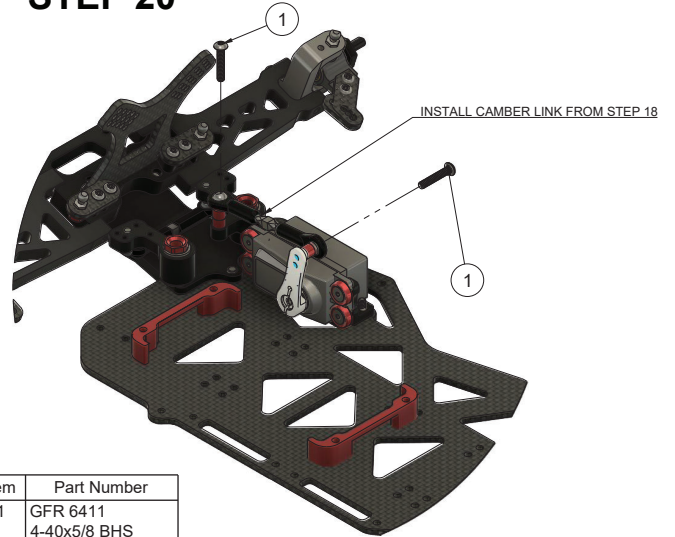

Item	Part Number
1	GFR 6411 4-40x5/8 BHS

REPEAT THIS STEP TO CREATE 2 FRONT CAMBER LINKS

STEP 21

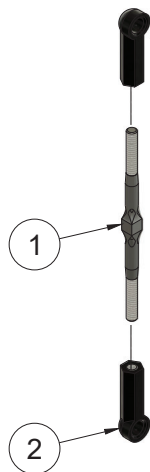

Item	Part Number
1	GFR 1278 2.25 Turnbuckle
2	GFR 1211 Ball Cup

STEP 22



INSTALL FRONT CAMBER LINKS

REPEAT THIS STEP TO CREATE 2 LINKS

STEP 23

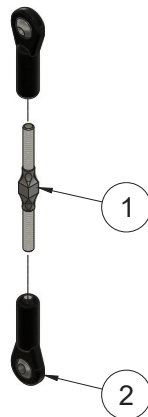

Item	Part Number
1	GFR 1276 1.5 Turnbuckle
2	GFR 6006 Rod End

STEP 24

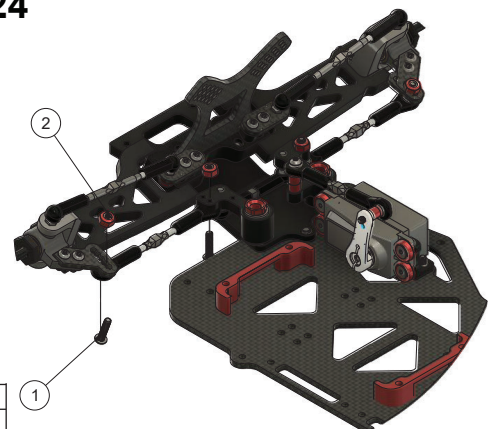

Item	Part Number
1	GFR 6409 4-40x1/2 BHS
2	GFR 6009 4-40 Locknut

ONE SIDE IS INSTALLED FOR REFERENCE

STEP 25 BAG C

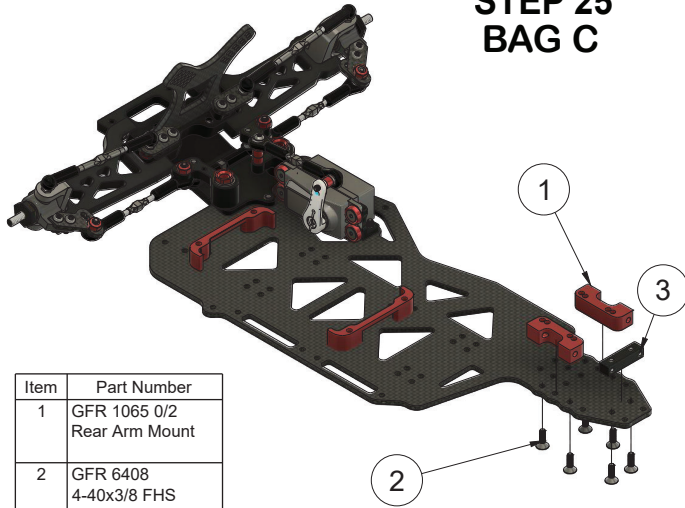

Item	Part Number
1	GFR 1065 0/2 Rear Arm Mount
2	GFR 6408 4-40x3/8 FHS
3	GFR 1069 Tower Block

STEP 26

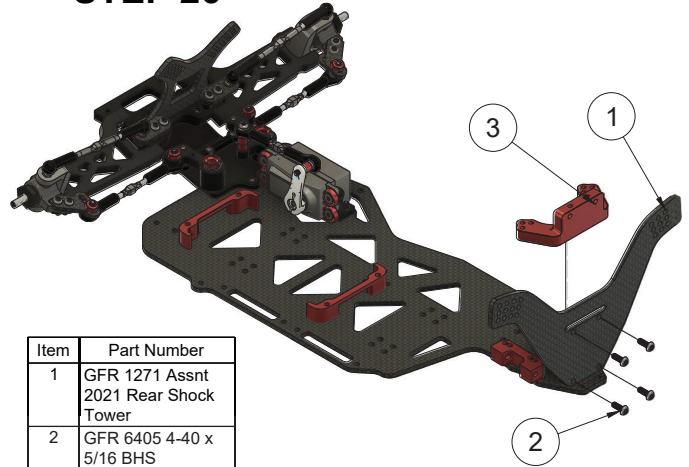

Item	Part Number
1	GFR 1271 Assnt 2021 Rear Shock Tower
2	GFR 6405 4-40 x 5/16 BHS
3	GFR 1288 Rear Camber Link Mount

STEP 27

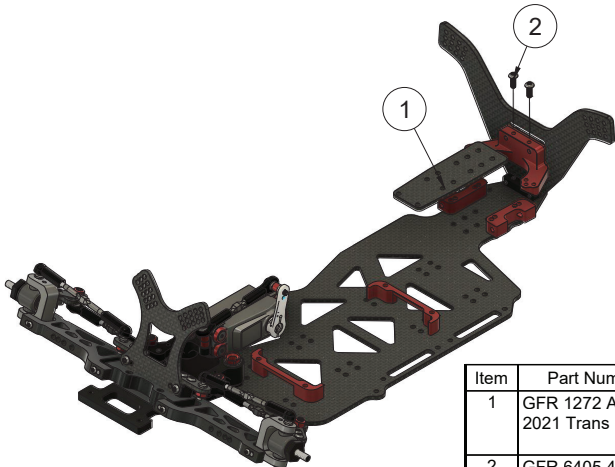

Item	Part Number
1	GFR 1272 Assnt 2021 Trans Brace
2	GFR 6405 4-40 x 5/16 BHS

STEP 28

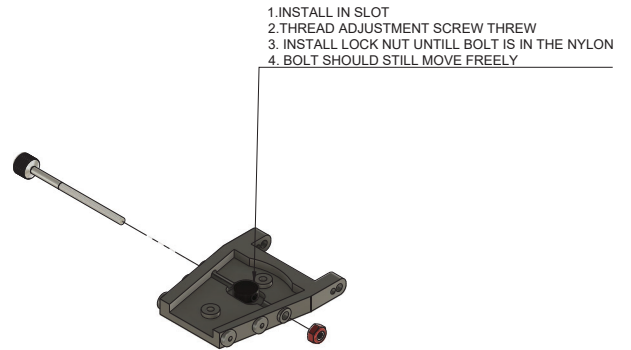

STEP 29

COMPLETE 28-29 AGAIN FOR BOTH SIDES THE THUMB SCREW IS TO THE REAR OF THE CAR ON BOTH SIDES

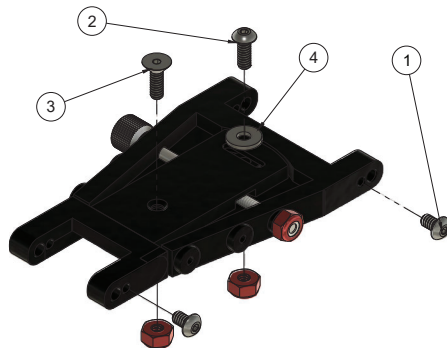

Item	Part Number
1	GFR 6402 4-40x3/16 BHS
2	GFR 6405 4-40 x 5/16 BHS
3	GFR 6408 4-40x3/8 FHS
4	4-40 flat washer

STEP 30

REAR SHOCK TOWER IS HIDDEN FOR ILLUSTRATION

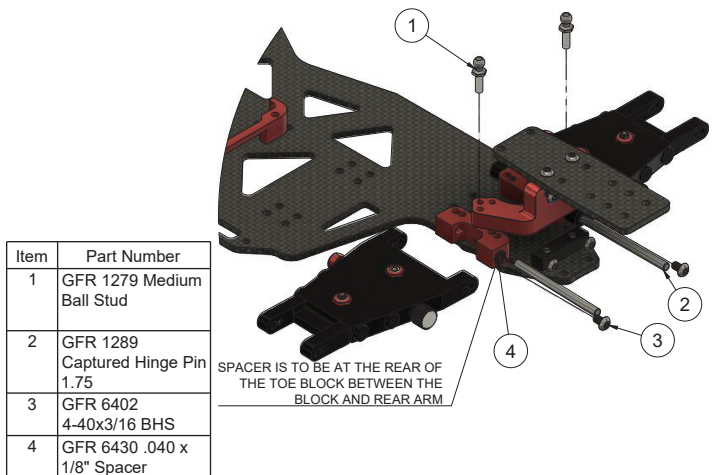

Item	Part Number
1	GFR 1279 Medium Ball Stud
2	GFR 1289 Captured Hinge Pin 1.75
3	GFR 6402 4-40x3/16 BHS
4	GFR 6430 .040 x 1/8" Spacer

COMPLETE BOTH REAR HUBS

STEP 31

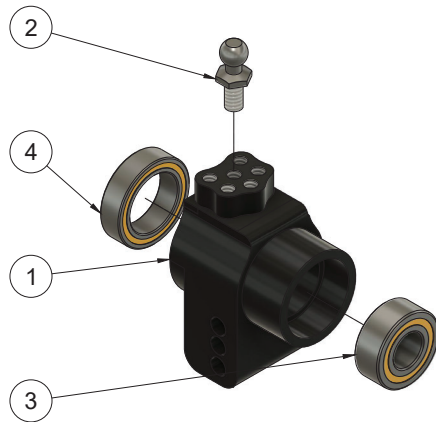

Item	Part Number
1	GFR 1229 Aluminum Hubs
2	GFR 1280 Short Ball Stud
3	GFR 6002 6x13x5 Bearing
4	GFR 6001 10x15x4 Bearing

STEP 32

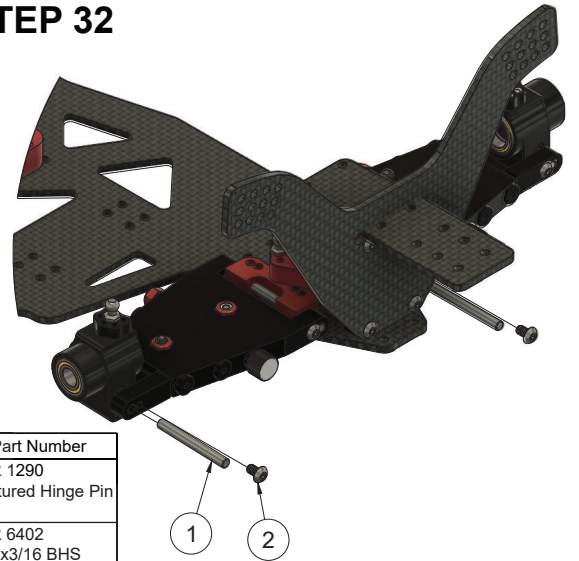

Item	Part Number
1	GFR 1290 Captured Hinge Pin 1.15
2	GFR 6402 4-40x3/16 BHS

STEP 33

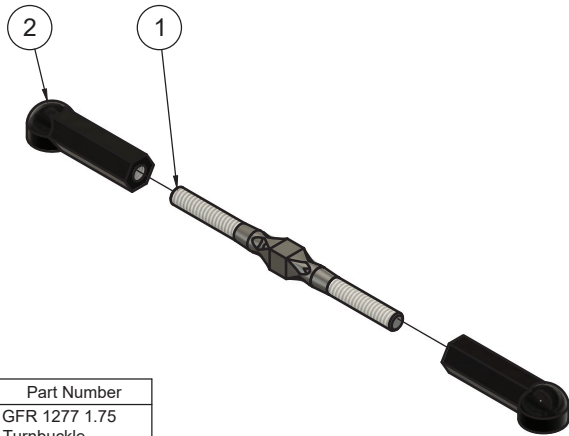

Item	Part Number
1	GFR 1277 1.75 Turnbuckle
2	GFR 1282 Ball Cup

STEP 34

INSTALL BOTH CAMBER LINKS



STEP 35 BAG D

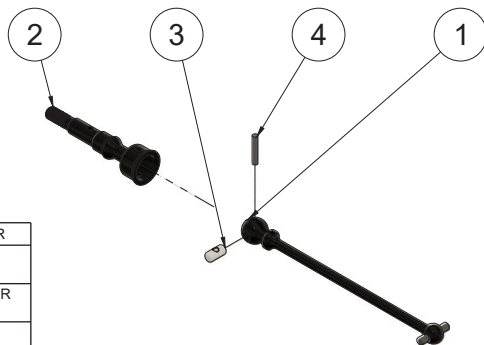

ITEM	PART NUMBER
1	GFR 1140 68MM DOGBONE
2	GFR 1230 RUBBER TIRE REAR AXLE
3	GFR 1134 CVA SWIVEL INSERT
4	GFR 6429 SOLID PIN

STEP 36

INSTALL BOTH CVAs IN HUBS



STEP 37

Item	Part Number
1	GFR 6428 Roll Pin
2	GFR 6400 1-72 x 3/36 SHS
3	GFR 1235 7mm Wheel Hex

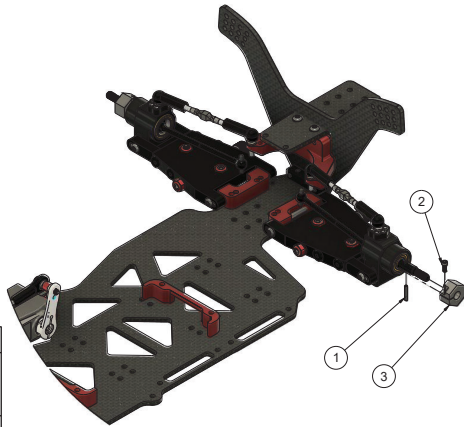

STEP 38

Item	Part Number
1	GFR 1265 M4 Wheel Nut

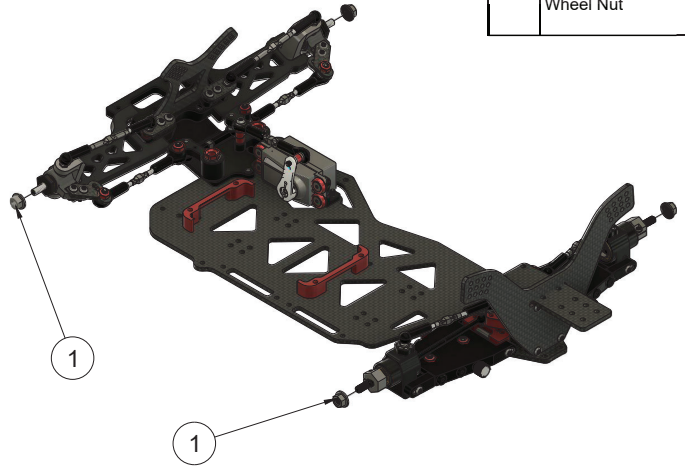

STEP 39 BAG E

APPLY DIFF LUB TO DIFF BALS

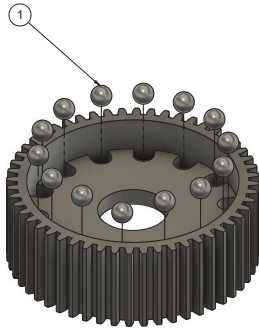

Item	Part Number
1	3/32 Carbide Ball

STEP 40

REPEAT THIS STEP FOR THE OTHER OUTDRIVE

APPLY DIFF LUB UNDER DIFF DRIVE RING

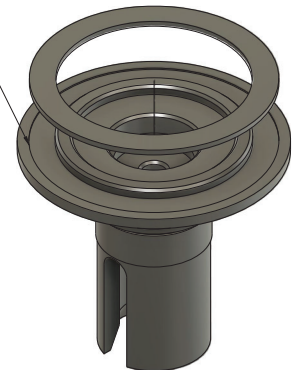

STEP 41

INSTALL THE FIRST WASHER THEN
APPLY GREASE TO THE TOP
THEN LINE UP THE 6 THRUST BALLS ON WSHER AROUND BOLT

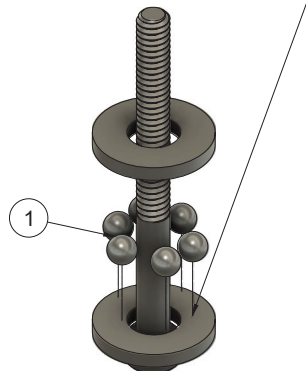

Item	Part Number
1	5/64 Thrust Ball

STEP 42

INSTALL TIP : PUT DIFF BOLT ON
END OF HEX DRIVER
FOR BETTER CONTROL



STEP 43

INSTALL AS SHOWN

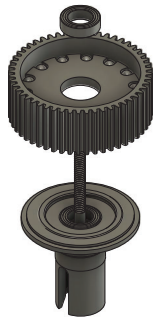

STEP 44

As you tighten the diff bolt, you will notice the T-nut ears moving closer to the bottom of the outdrive slot. This compresses the spring behind the T-nut. The spring should be completely compressed at the time the T-nut reaches the end of the slot. Caution! Pay close attention to the feeling when the spring is completely compressed. Do not overtighten the bolt. When you feel the spring completely compressed, loosen the diff bolt 1/8" of a turn. Your diff should now operate smoothly but with resistance as the outdrives move in opposite directions. After you have driven the car once, re-check the diff setting.

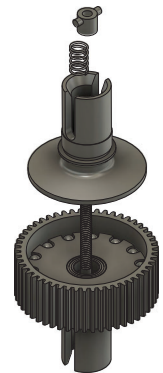

STEP 45

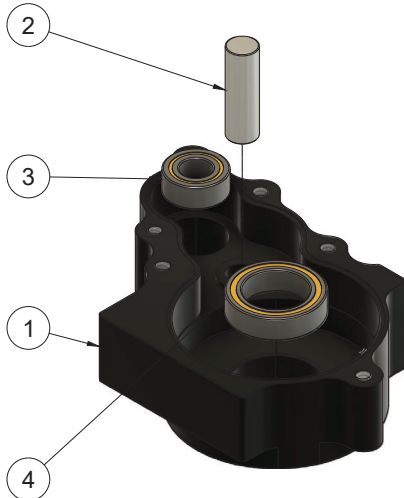

Item	Part Number
1	GFR 1117 Trans Case
2	GFR 1180 Idler Shaft
3	GFR 6000 5x10x4 Bearing
4	GFR 6001 10x15x4 Bearing

STEP 46

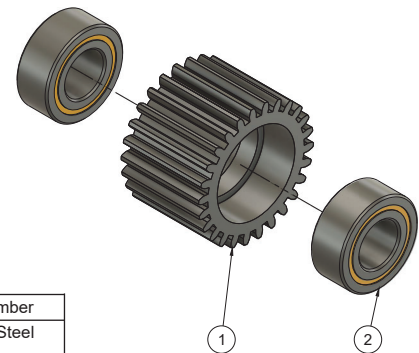

Item	Part Number
1	GFR 1186 Steel Idler Gear
2	GFR 6000 5x10x4 Bearing

STEP 47

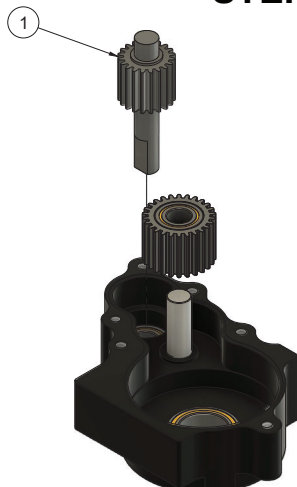

Item	Part Number
1	GFR 1182 Top Shaft

STEP 48

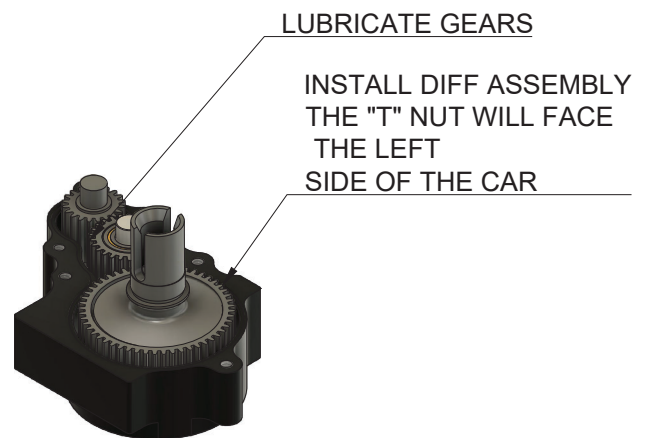

STEP 49

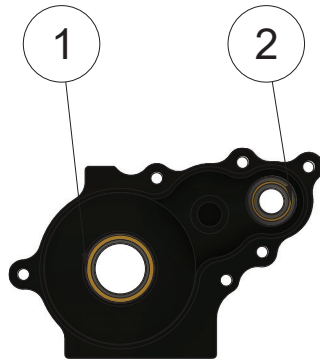

ITEM	PART NUMBER
1	GFR 6001 10X15X4 BEARING
2	GFR 6000 5X10X4 BEARING

STEP 50

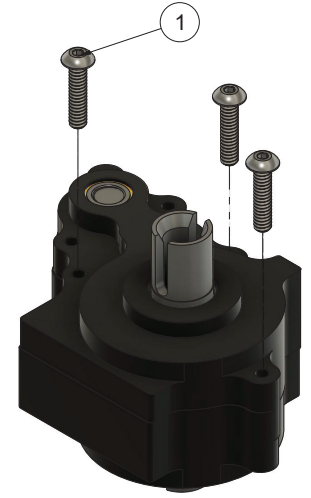

Item	Part Number
1	GFR 6409 4-40x1/2 BHS

STEP 51

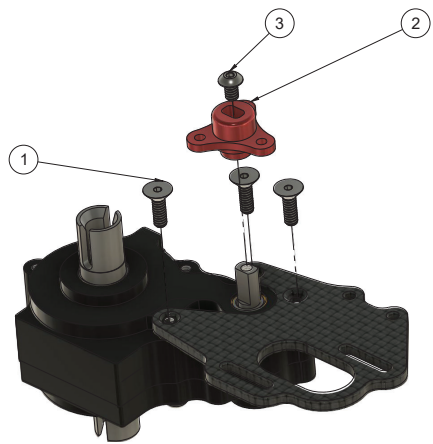

Item	Part Number
1	GFR 6408 4-40x3/8 FHS
2	GFR 1183 Slipper Eliminator Red
3	GFR 6402 4-40x3/16 BHS

STEP 52

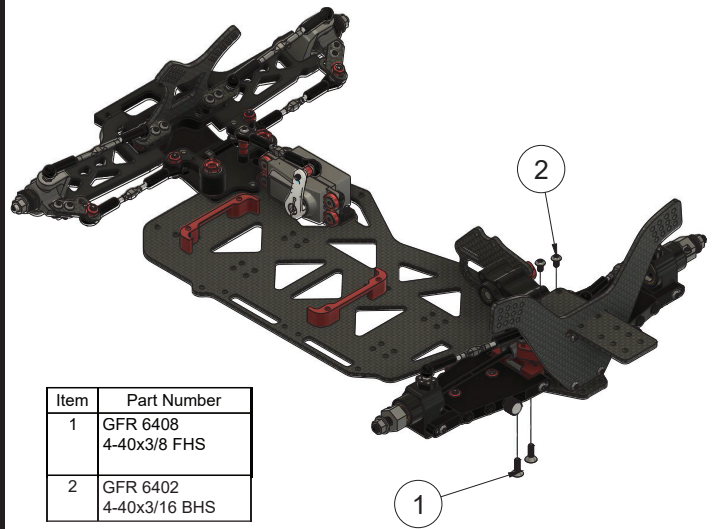

Item	Part Number
1	GFR 6408 4-40x3/8 FHS
2	GFR 6402 4-40x3/16 BHS

STEP 53 BAG F

E-CLIP,PISTON,E-CLIP

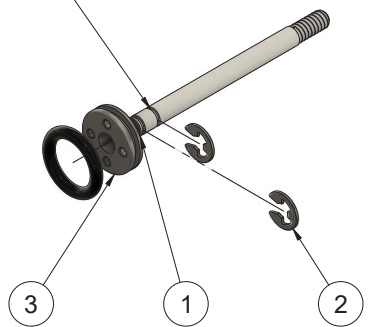

Item	Part Number
1	GFR 4094 Medium Shock Shaft
2	GFR 6007 E-Clip
3	GFR 4069 Small Bore IRS Piston

STEP 54

INSTALL COMPLETE SHOCK SHAFT ASSEMBLY INTO SHOCL BODY

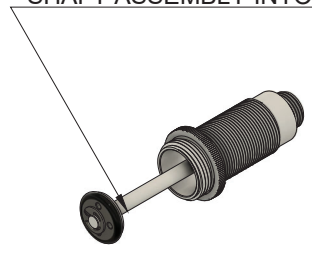

STEP 55

ADD A COUPLE DROPS OF SHOCK OIL ON O-RINGS

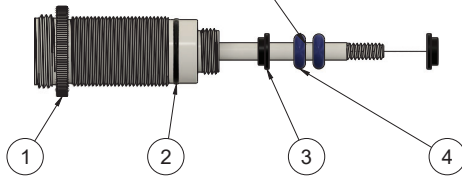

Item	Part Number
1	GFR 4102 Long Shock Body
2	Small bore shock shaft asmb
3	GFR 4085 SB Shock Guide
4	GFR 4071 Shock Shaft O Rings

STEP 56

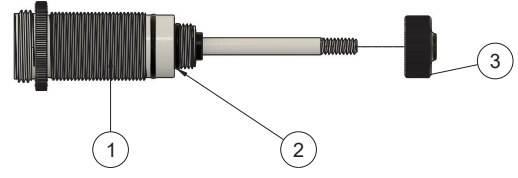

Item	Part Number
1	GFR 4102 Long Shock Body
2	GFR 6441 0.75x4.5 Oring
3	GFR 4086 SB Shock Bottom Cap

STEP 57

REPEAT STEPS 53-57 TO COMPLETE ALL SHOCKS

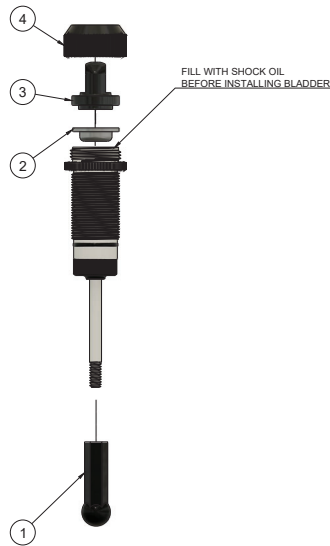

Item	Part Number
1	GFR 6442 1X12 Oring
2	GFR 4064 SB Shock Adjuster Collar

STEP 58

REPEAT FOR ALL SHOCKS



Item	Part Number
1	GFR 1211 Ball Cup
2	GFR 4068 SB Shock Bladder
3	GFR 4063 2pc Shock Cap
4	GFR 4063 2pc Shock Cap Nut

STEP 59

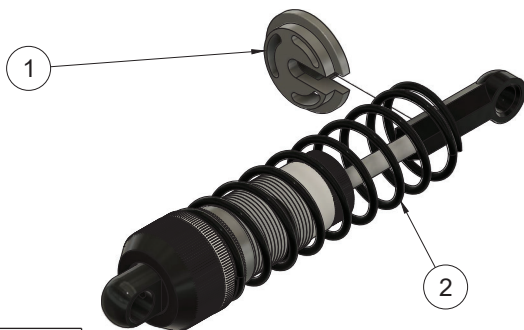

Item	Part Number
1	GFR 4067 SB Shock Spring Retainer
2	GFR 136BL1 1.8 Black Shock Spring

STEP 60

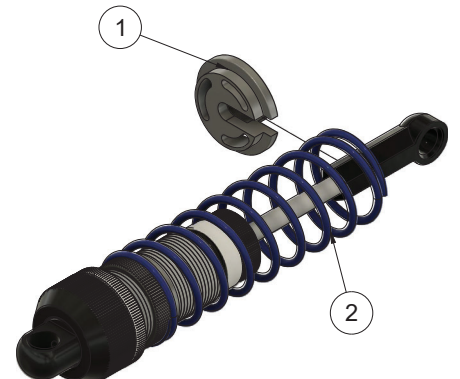

Item	Part Number
1	GFR 4067 SB Shock Spring Retainer
2	GFR 136PU 1.8 Purple Shock Spring

STEP 61

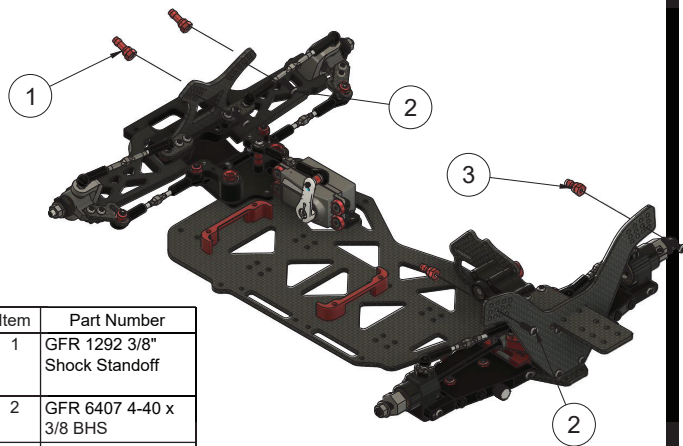

Item	Part Number
1	GFR 1292 3/8" Shock Standoff
2	GFR 6407 4-40 x 3/8 BHS
3	GFR 1291 1/4" Shock Standoff

STEP 62

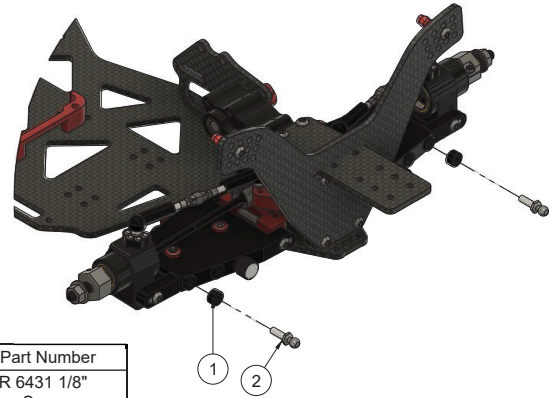

Item	Part Number
1	GFR 6431 1/8" Nylon Spacer
2	GFR 1279 Medium Ball Stud

STEP 63

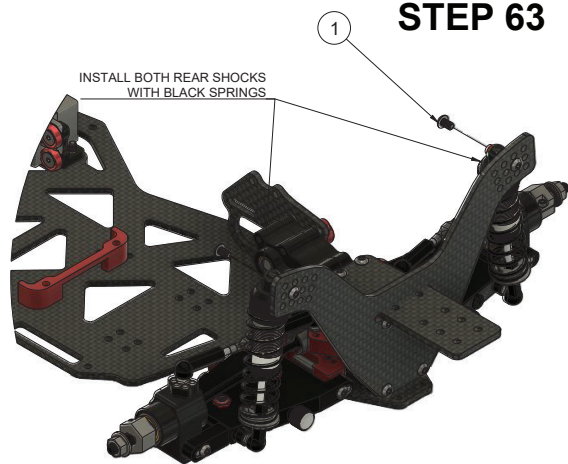

Item	Part Number
1	GFR 6402 4-40x3/16 BHS

STEP 64

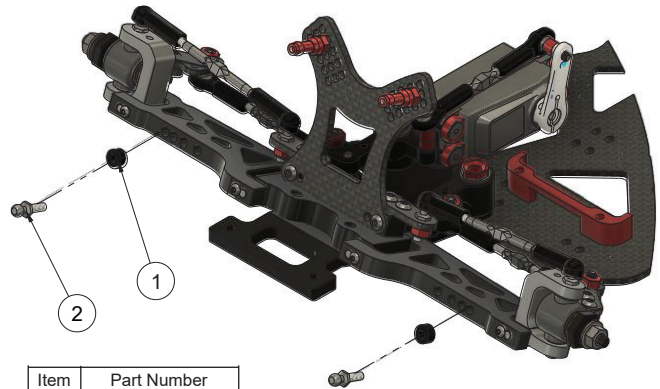

Item	Part Number
1	GFR 6431 1/8" Nylon Spacer
2	GFR 1279 Medium Ball Stud

STEP 65



Item	Part Number
1	GFR 6402 4-40x3/16 BHS

STEP 66 BAG G



Item	Part Number
1	GFR 1263 FRONT BUMPER MOUNT
2	GFR 6408 4-40x 3/8 FHS

STEP 67

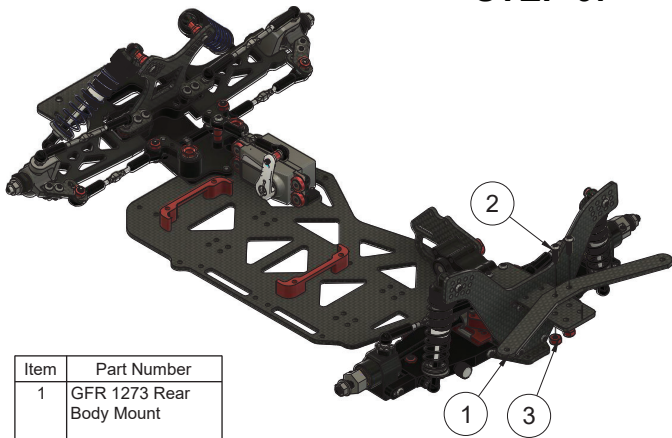

Item	Part Number
1	GFR 1273 Rear Body Mount
2	GFR 6407 4-40 x 3/8 BHS
3	GFR 6009 4-40 locknut

STEP 68

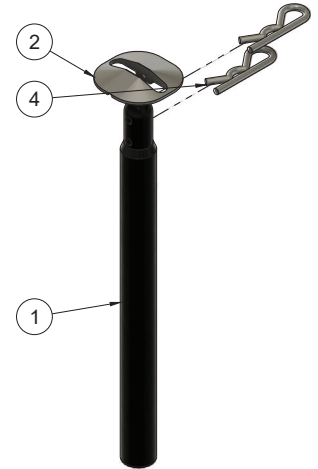

Item	Part Number
1	3" Body Post
2	GFR 1264 Body Post Seat
3	Delete
4	GFR 6440 BodyClip

BUILD ALL 4 BODY POST THE SAME

STEP 69

THE 2-3.5" POST WILL BE FOR THE FRONT
THE 2-3" POST WILL BE FOR THE REAR

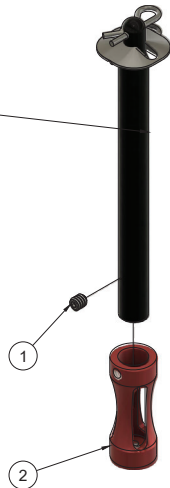

Item	Part Number
1	GFR 6401 4-40 Set Screw
2	GFR 1017 Body Post Holder

STEP 70

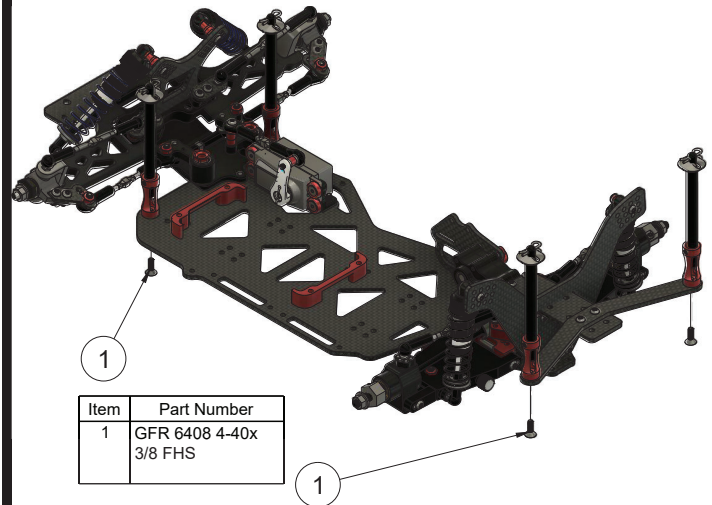

Item	Part Number
1	GFR 6408 4-40x 3/8 FHS

