

INSTRUCTION MANUAL

TRUGGY SRX8Q

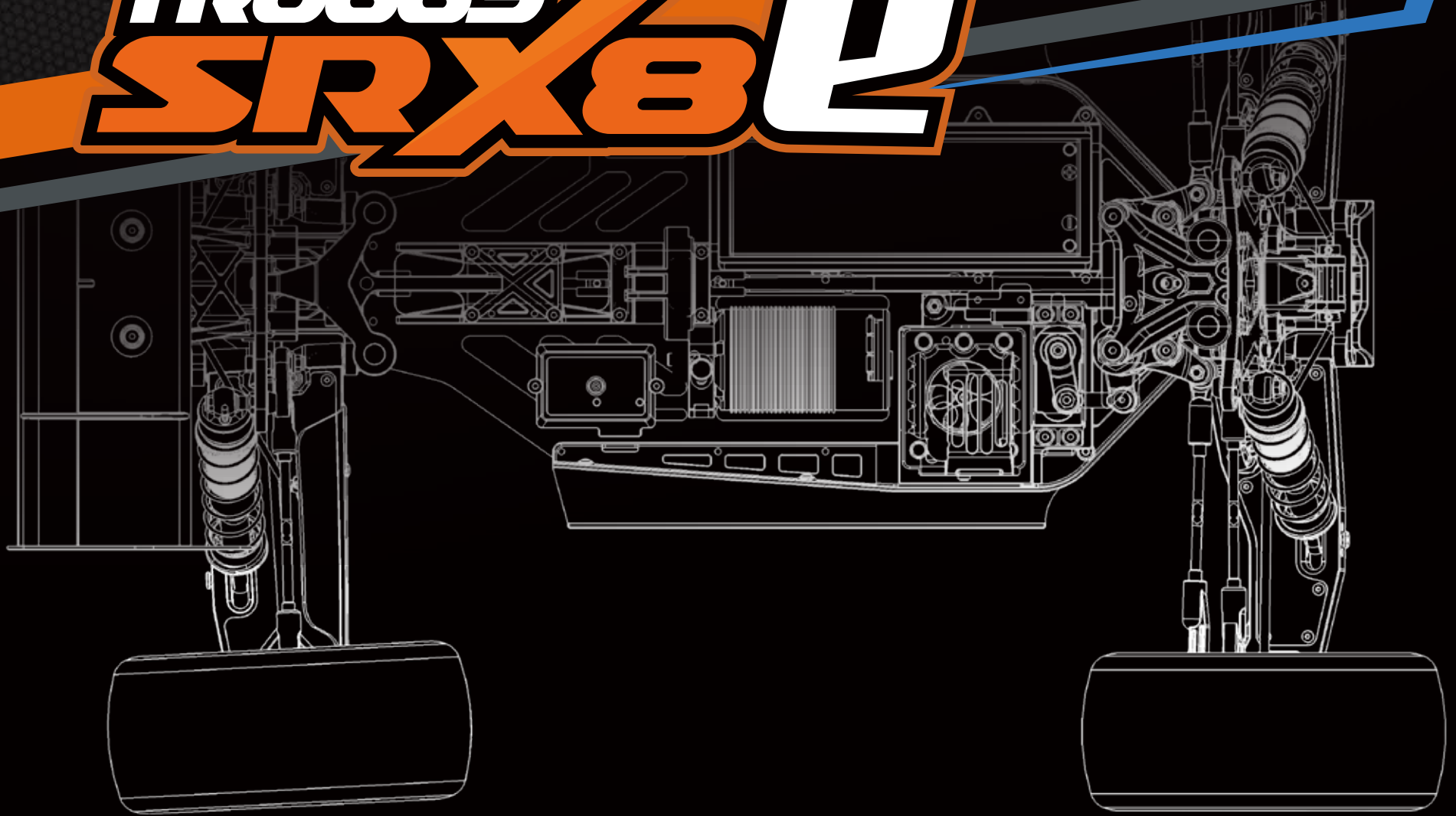

SERPENT

INTRODUCTION

Thank you very much for selecting this Serpent rc car and thus become a member of the ever growing worldwide Serpent racing family. Serpent started in 1980 and has been growing its product-line and fan-base ever since.

The Serpent SRX8T-e is a state of the art 1/8 scale 4wd Truggy which will give you the true Serpent racing experience. The assembly manual will guide you through all the steps to complete the car, so you can hit the track with a good base-set-up soonest. The Serpent design department succeeded to create a superbly performing car combined with ease of assembly and maintenance. The high quality standards of all parts and hardware will make racing your Serpent car a very rewarding activity !

Through our team, website and social media we will keep you up-to-date on all developments of the Serpent cars. We hope to meet you on the track and through our various media! Enjoy the drive !

Team Serpent
Multiple World Champions

INSTRUCTIONS

Serpent's long tradition of excellence extends to the instruction manuals, and this instruction manual is no exception. The easy-to-follow layout is richly illustrated with 3D-rendered full-color images to make your building experience quick and easy. Following the instructions will result in a well-built, high-performance race-car that will soon be able to unleash its full potential at the racetrack. The kit includes bags, with bag numbers, which refer to the same step in the manual. Open only the indicated bag(s) per step and finish that part of the assembly. Remaining parts will be needed later on in the assembly process.

PLASTIC PARTS

The Serpent moulded parts are very durable and hard. When assembling longer screws in new composite parts, make sure to use new hex bits in your (power) tools. Pre-threading also helps to avoid screw damage.

SETUP

In certain assembly steps you need to make basic adjustments, which will give you a good initial setup for your Serpent SRX8T-e. Fine-tuning the initial setup is an essential part of building a high-performance race car like your Serpent SRX8T-e.

EXPLODED VIEWS AND PARTS LIST

The exploded views and parts lists for the Serpent SRX8T-e are presented in the Reference Guide section in the back of this manual. The exploded views show all the parts of a particular assembly step along with the Serpent part number and hotlink to the Serpent website. Part numbers in orange indicates that this part is an optional. Optionals part names and numbers are showed below.

CUSTOMER SERVICE

Serpent has made a strong effort to make this manual as complete and clear as possible. Additional info may be published in our website: www.serpent.com or you may ask your dealer or the Serpent distributor for advice, or email Serpent direct: info@serpent.com. The Serpent Facebook, Twitter and Youtube pages give additional means of support and communications.

SAFETY

Read and take note of the 'Read this First section' before proceeding to assemble the car-kit. This car-kit is intended for persons aged 16 or older.

READ THIS FIRST!

- This is a highly technical hobby product, intended to be used in a safe racing environment. This car is capable of speeds in excess of 80 km/h or 50mph. Please follow these guidelines when building and operating this model.
- Parental guidance is required when the builder/user of this car is under 16.
- Follow the building instructions. If in doubt, contact your dealer or importer.
- Be sure to use the proper tools when assembling the car. Always exercise caution when using electric tools, knives and other sharp objects.
- Be careful when using liquids like lubrication oil, fuel or glue. Do not swallow.
- Follow the manufacturer's instruction in case you experience irritation after using the product.
- Be careful when operating the car. Stay away from any rotating parts such as wheels, gears and transmission. Stay away from motor, engine and exhaust pipe system or speedo during and immediately after use, as these parts may be very hot. We advise to use protective hand gloves.
- Only operate this car in a safe environment, like a special racing track or a closed parking lot. Avoid using this car on public roads, crowded places or near infants.
- Before operating this car, always check the mechanical status of the car. Also check that the transmitter and receiver frequencies correspond and are not used by any other racer at the same time. Check that the batteries of the transmitter and receiver- are fully charged.
- After use, always check all the mechanics of the car. We advise to clean the car immediately after use, and inspect the parts for wear or fractures. Replace when necessary. Do not use water, methanol, thinner or other solvents to clean the car.
- After your session, disconnect the main battery from the speed control.
- Store the car in a dry and heated place to avoid corrosion of metal parts.
- Avoid using this car in wet conditions as the water will cause corrosion on the metal parts and bearings and these parts will cease to function properly. If driven in the wet, ensure that all the electric equipment is waterproofed and after use, that all moving parts are dried immediately.

CONTENTS

• CENTER DIFF ASSEMBLY.....	4
• FR/RR DIFF ASSEMBLY.....	6
• REAR ASSEMBLY.....	8
• FRONT ASSEMBLY.....	15
• CENTRAL ASSEMBLY.....	21
• STEERING ASSEMBLY.....	25
• ELECTRONICS ASSEMBLY.....	28
• SHOCK ASSEMBLY.....	31
• WING INSTALLATION.....	34
• WHEEL AND TIRE ASSEMBLY.....	35
• FINAL ASSEMBLY.....	36
• EXPLODED VIEWS.....	37
• TEAM SERPENT NETWORK.....	46

LINES DESCRIPTION

Each step contains a variety of numbers, lines, and symbols. The numbers represent the order in which the parts should be assembled. The lines are described below.

1 2 3

Step number; the order in which you should assemble the indicated parts



Length after assembly



Assembly path of one item into another



Group of items (within lines) should be assembled first



Direction the item should be moved



Glue one item to another



Press/Insert one item into another



Connect one item to another



Gap between two items

ICONS DESCRIPTION

Each step contains a variety of symbols described below.



Carefully, read and check extensively.



Apply a small amount of cyano glue. Use wear protection for eyes and hands.



Detail view to explain assembly or order of parts better.



Default set-up: This symbol indicates the default setup.



Grease: apply a small amount of grease to the parts shown.



Left and right parts should be assembled in the same way.



Thread lock: apply a small amount on the parts shown. Before to apply the threadlock, make sure to degrease the parts very well, as otherwise the threadlock will not work.



Silicone oil: use the indicated silicone oil for the shocks and differentials.



Parts or items not included in the kit.



Optional part, not standard in the kit.

CENTER DIFF ASSEMBLY

STEP 1 CENTER DIFF BAG

STEP 2

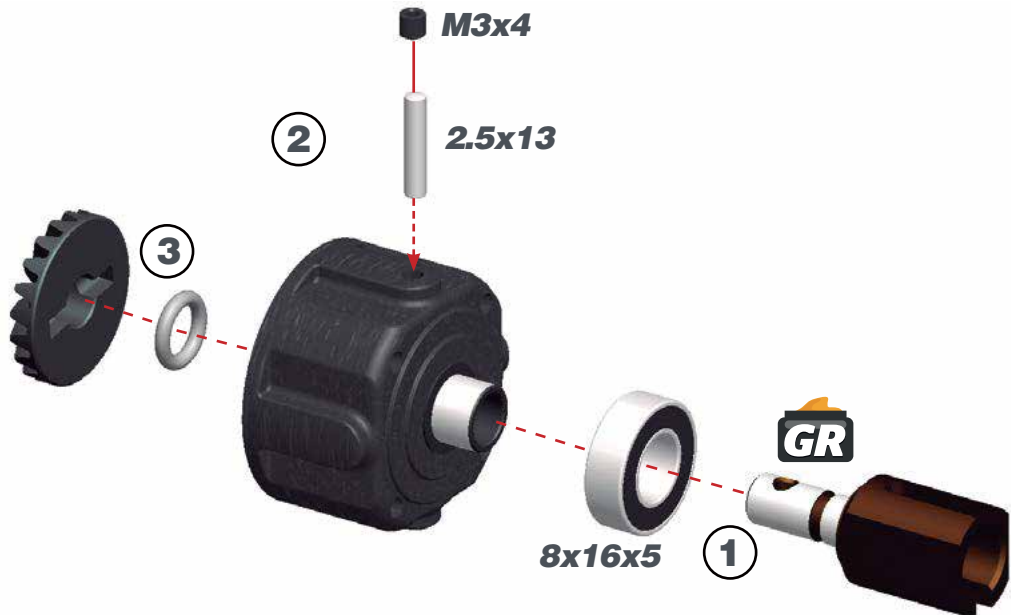

Note the correct pin location.

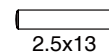
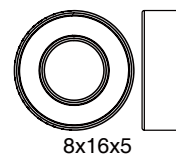
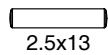
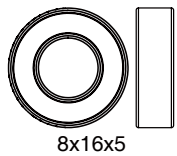
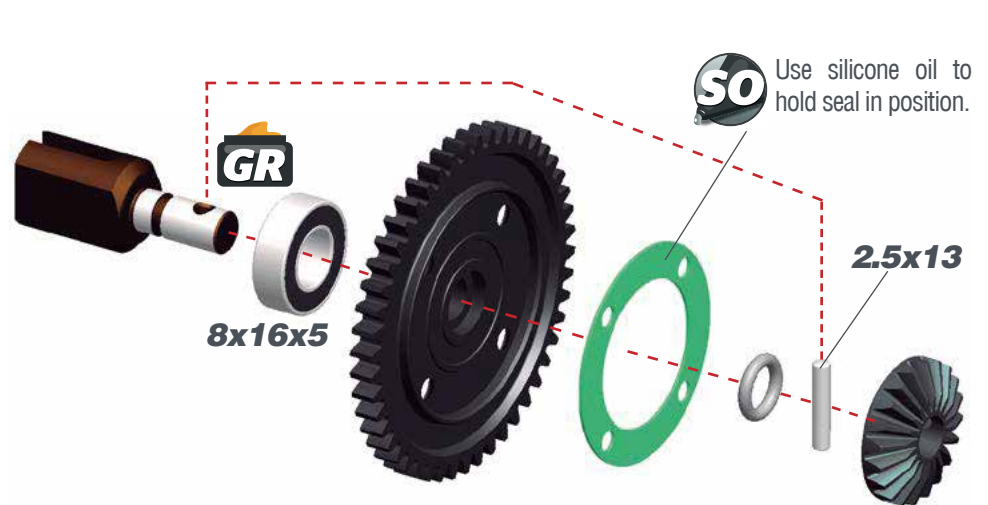

STEP 3

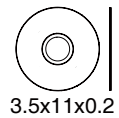
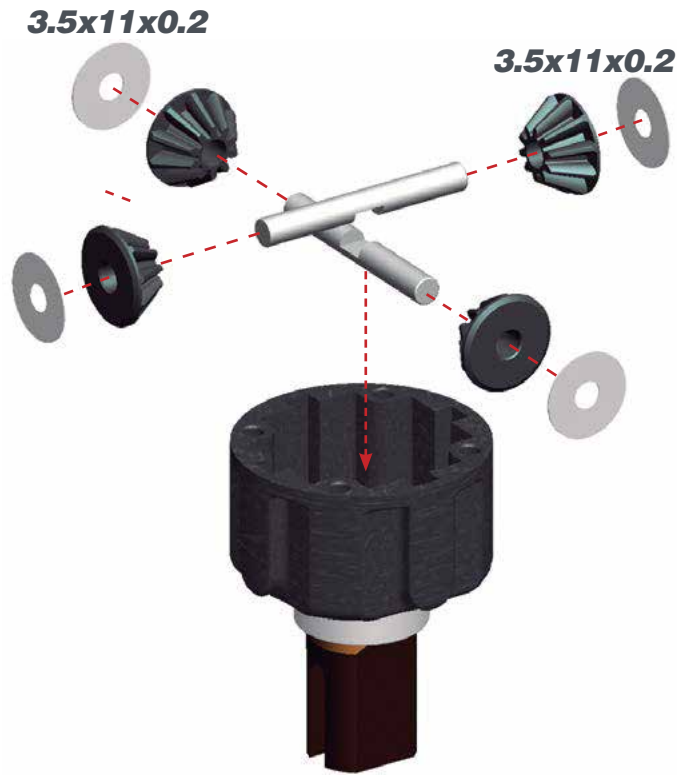

STEP 4

! Fill the differential with silicone oil between 1 and 1.5 mm above the crosspin, do NOT overfill. Use the silicone oil supplied in the kit. For the correct cst value please check the default setupsheet.



🔍 AMOUNT OF OIL IN THE DIFFS
 Use a digital scale to measure the exact amount of oil in the diff.

Differential weight = 44.00 +/- 0.10 grams.



STEP 5

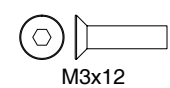
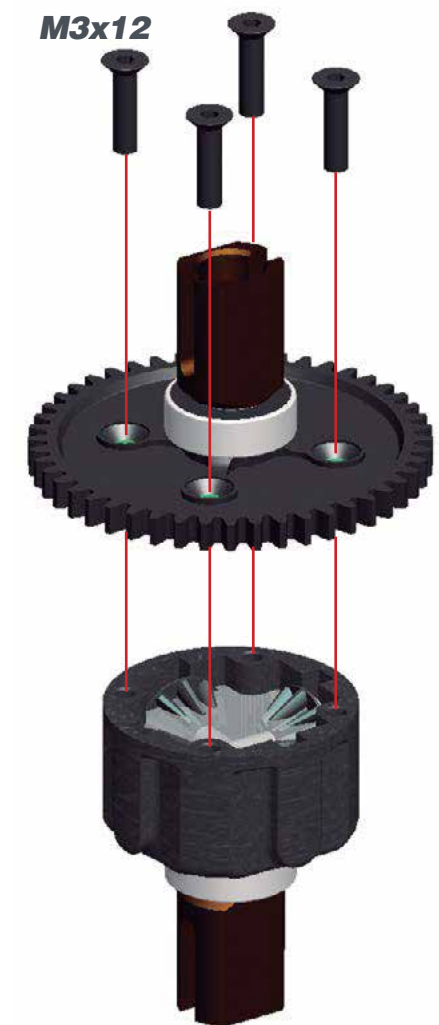

STEP 6 FR RR DIFF BAG

STEP 7



Note the correct pin location.

A magnified view of the diff housing and gear assembly, showing a pin inserted into a specific hole. A magnifying glass icon is positioned over the pin location.

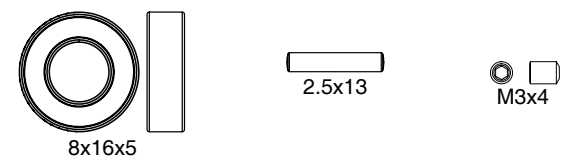
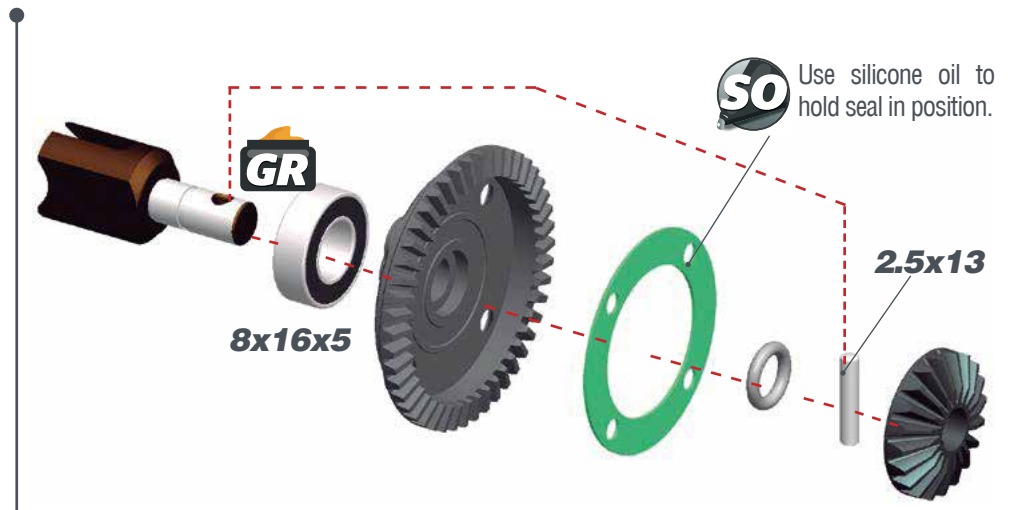
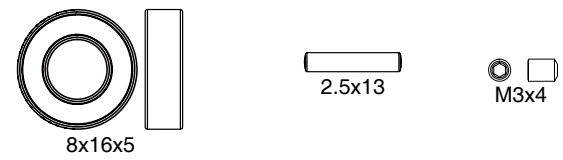

STEP 8

3.5x11x0.2

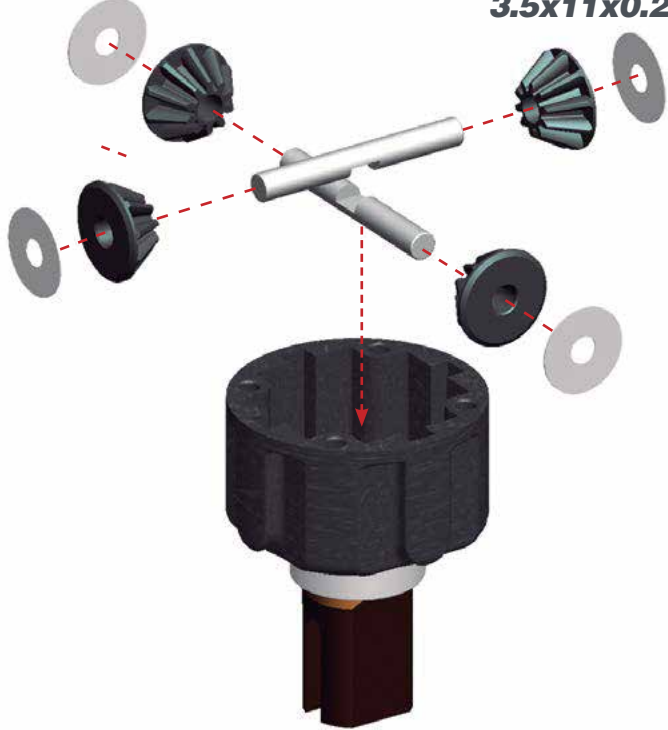

STEP 9

3.5x11x0.2



Fill the differential with silicone oil between 1 and 1.5 mm above the crosspin, do NOT overfill. Use the silicone oil supplied in the kit. For the correct cst value please check the default setupsheet.

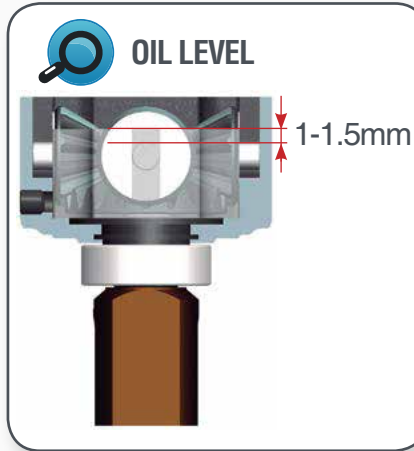

AMOUNT OF OIL IN THE DIFFS

Use a digital scale to measure the exact amount of oil in the diff.

Differential weight = 44.00 +/- 0.10 grams.



STEP 10

M3x12

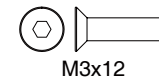
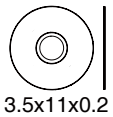

STEP 11

BAG 1



! After building the differential with new gears, new differential case and bearings, the diff may feel a little tight. The connected parts need at least an hour run-time to create a perfect match. Attention: When you assemble the diff with too much initial play, the gears will not run-in properly and may wear quickly. After 1 or 2 hours of running the car, re-check the gear-mesh between the ring gear and the pinion. All parts should have run-in properly now. You may add or remove 8x11x0.1 shims as needed.



STEP 12

12.1

! After 1 or 2 hours of running the car, re-check the gear-mesh between the ring gear and the pinion. All parts should have run-in properly. You may add or remove 13x16x0.1 shims as needed.

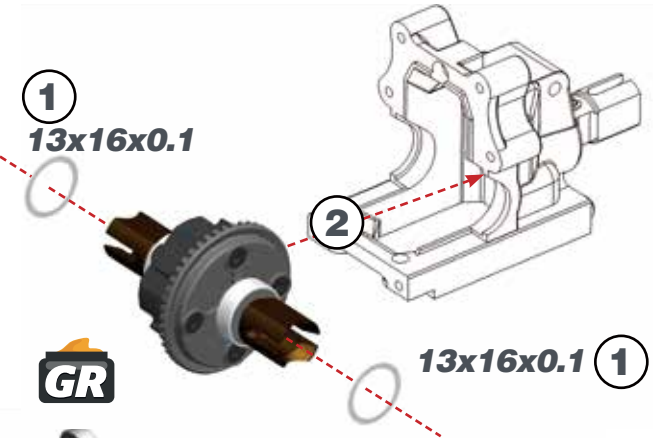

12.2

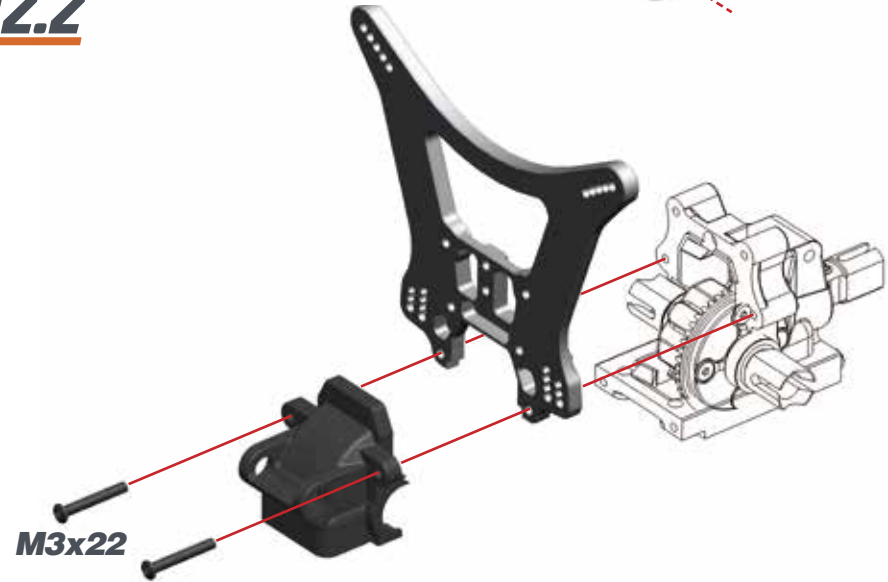

M5x4

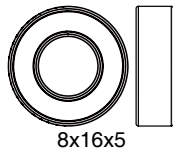

8x16x5

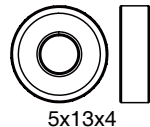

5x13x4

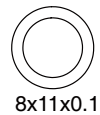

8x11x0.1

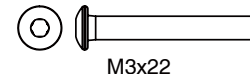

M3x22

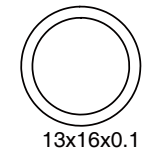

13x16x0.1

STEP 13

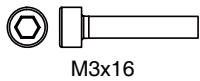
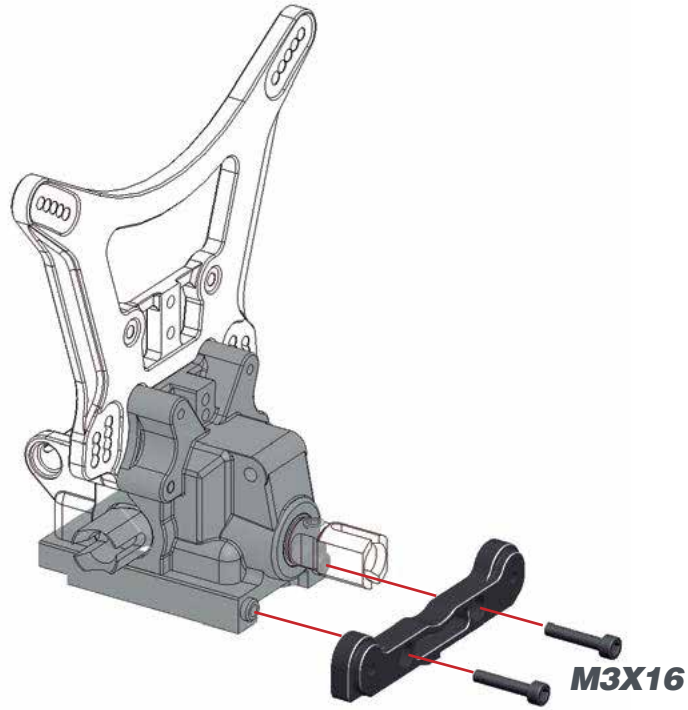

STEP 14 **BAG 2**

14.1

L=R

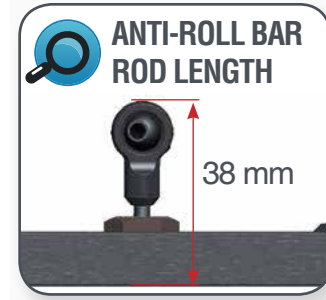

14.2

M2.5X6

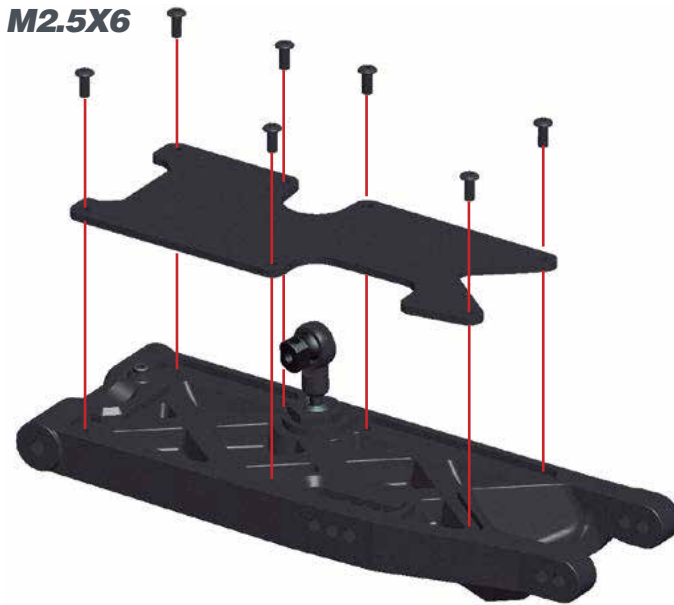

STEP 15

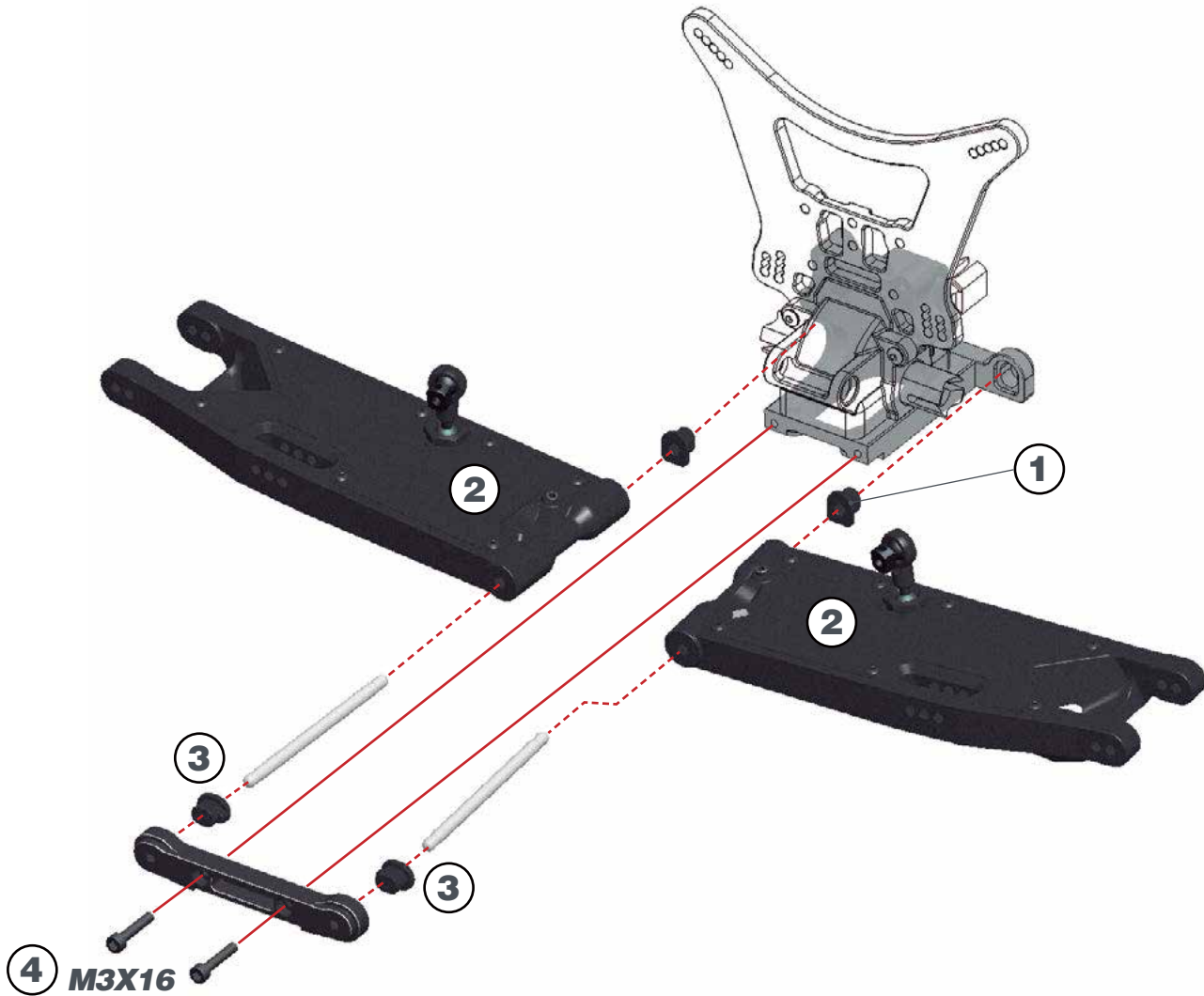

L=R REAR ANTI-SQUAT INSERTS CHART

1	1.5	2	2.5	3
●	●	●	●	●
DEF. SETUP				

L=R REAR TOE IN INSERTS CHART

2	2.5	2.75	3	3.25	3.5	4
●	●	●	●	●	●	●
DEF. SETUP						

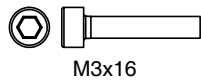

STEP 16

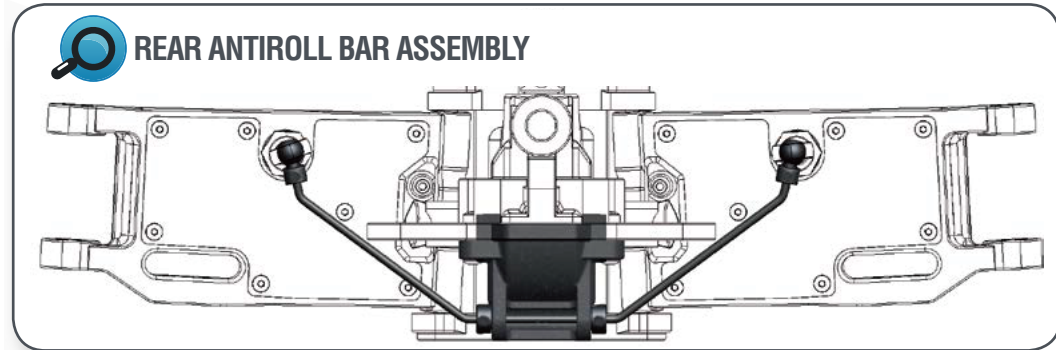
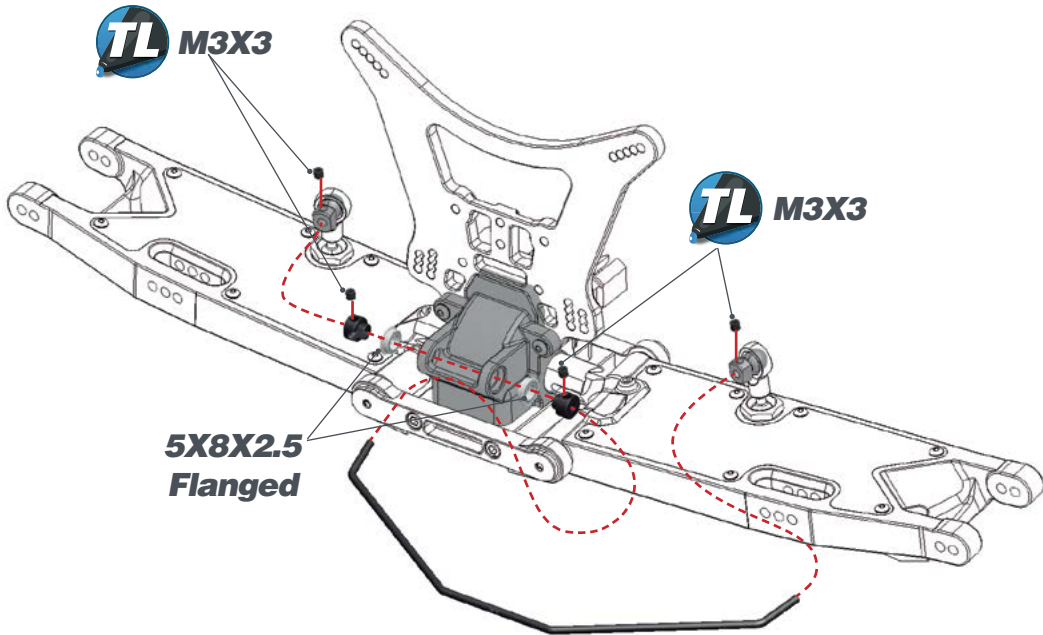

STEP 17

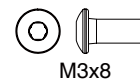
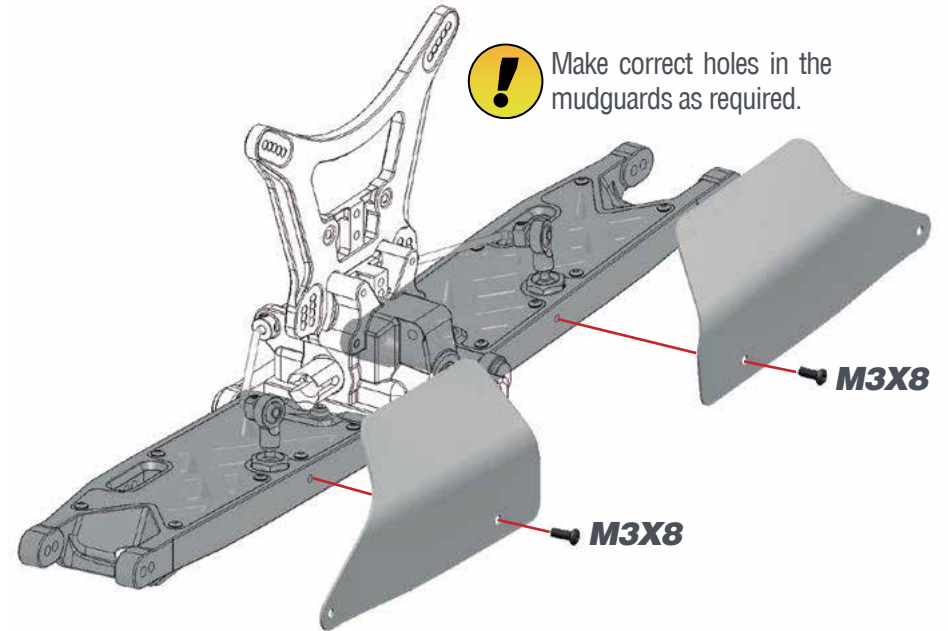



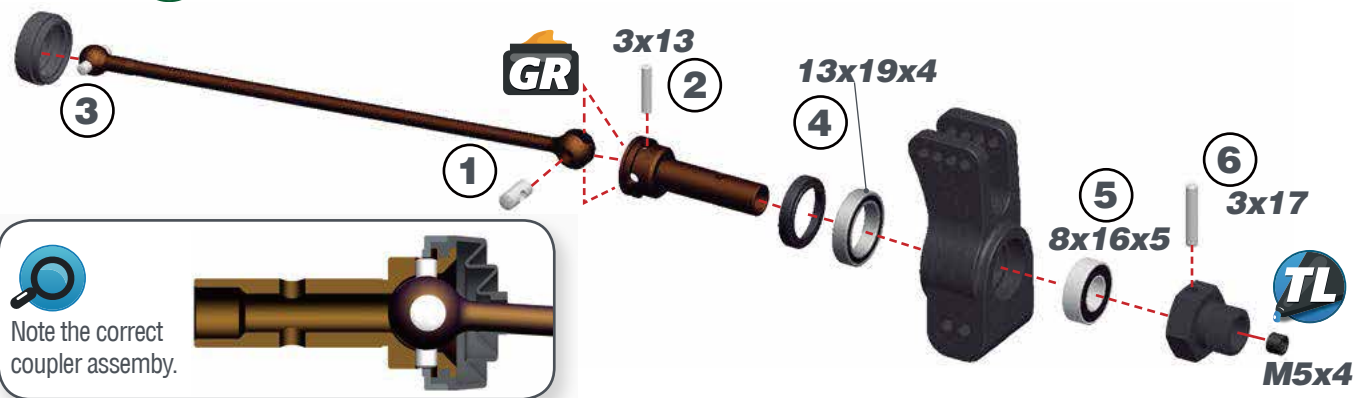

STEP 18 BAG 3

18.1 L=R

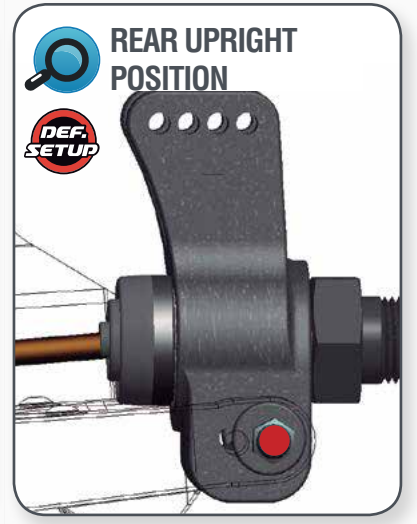
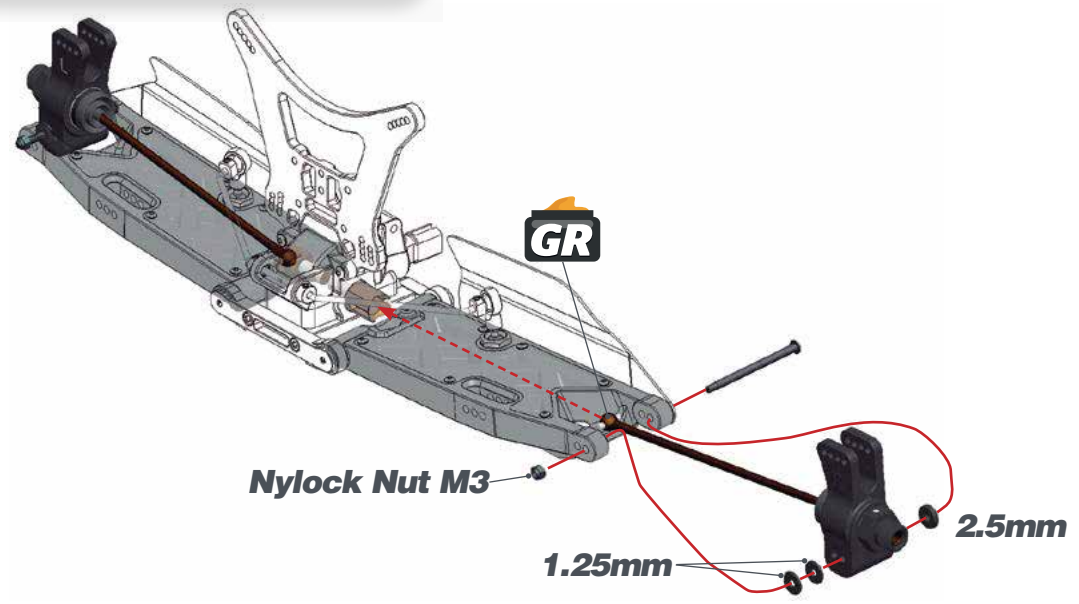

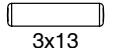
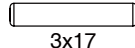
18.2

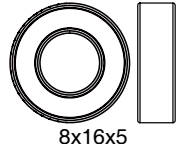
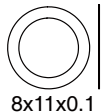
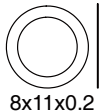

-  3x13
-  3x17
-  13x19x4
-  8x16x5
-  8x11x0.1
-  8x11x0.2
-  M5x4
-  Nylock Nut M3

STEP 19 BAG 4

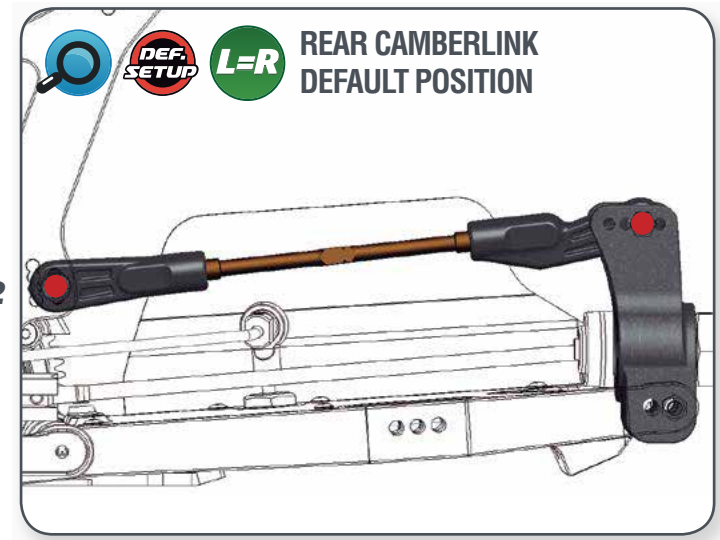
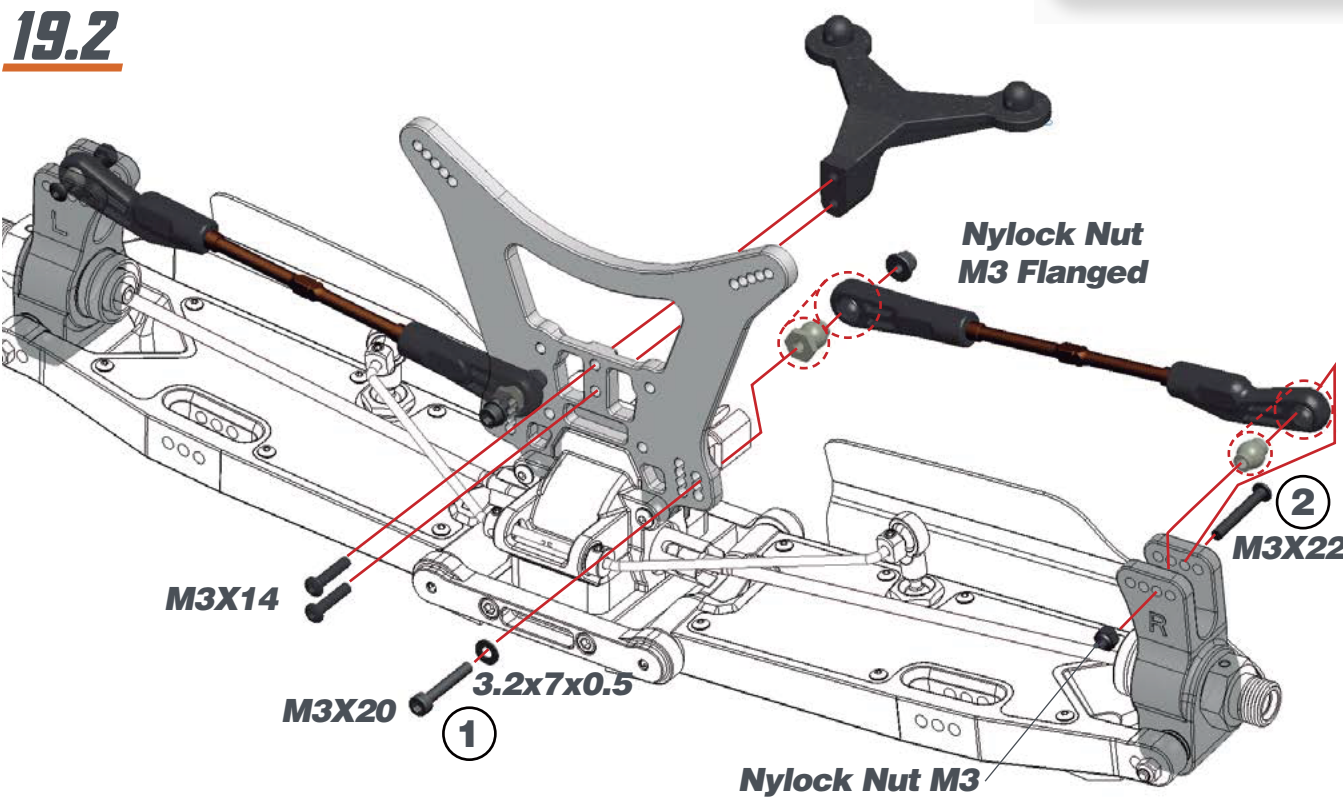
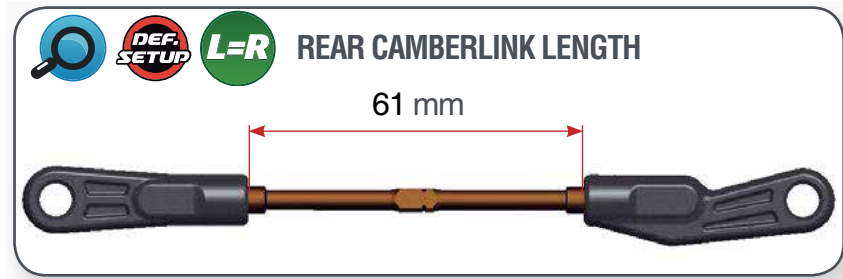

- 
 M3x14
- 
 M3x20
- 
 3.5x7x0.5
- 
 Nylock Nut M3
 Flanged
- 
 M3x22
- 
 Nylock Nut M3

STEP 20

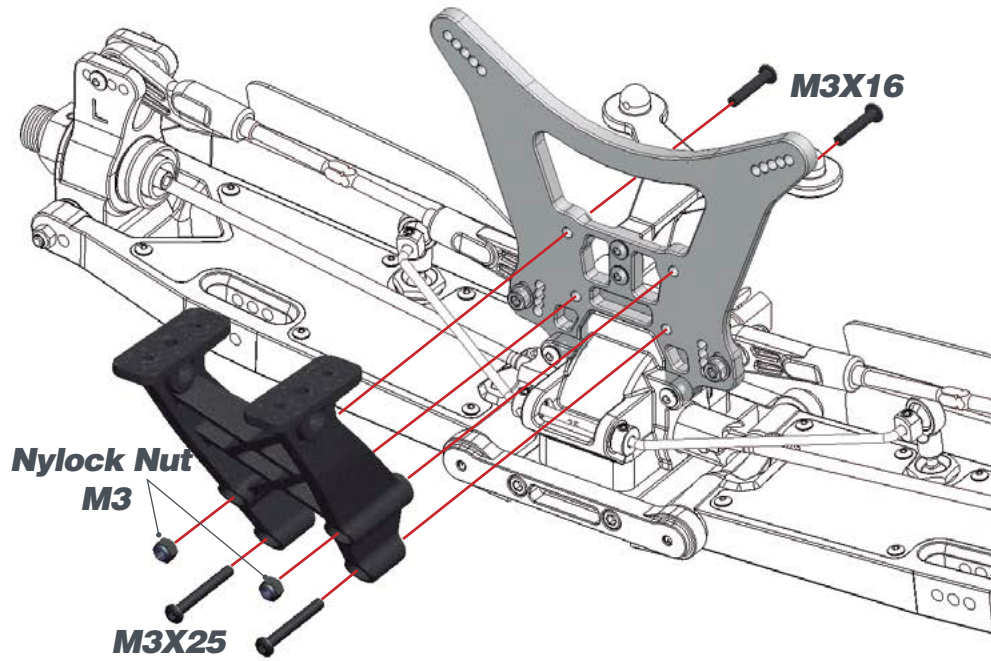

STEP 21

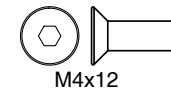
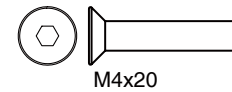
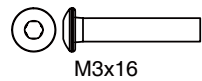
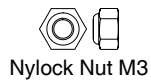
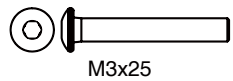
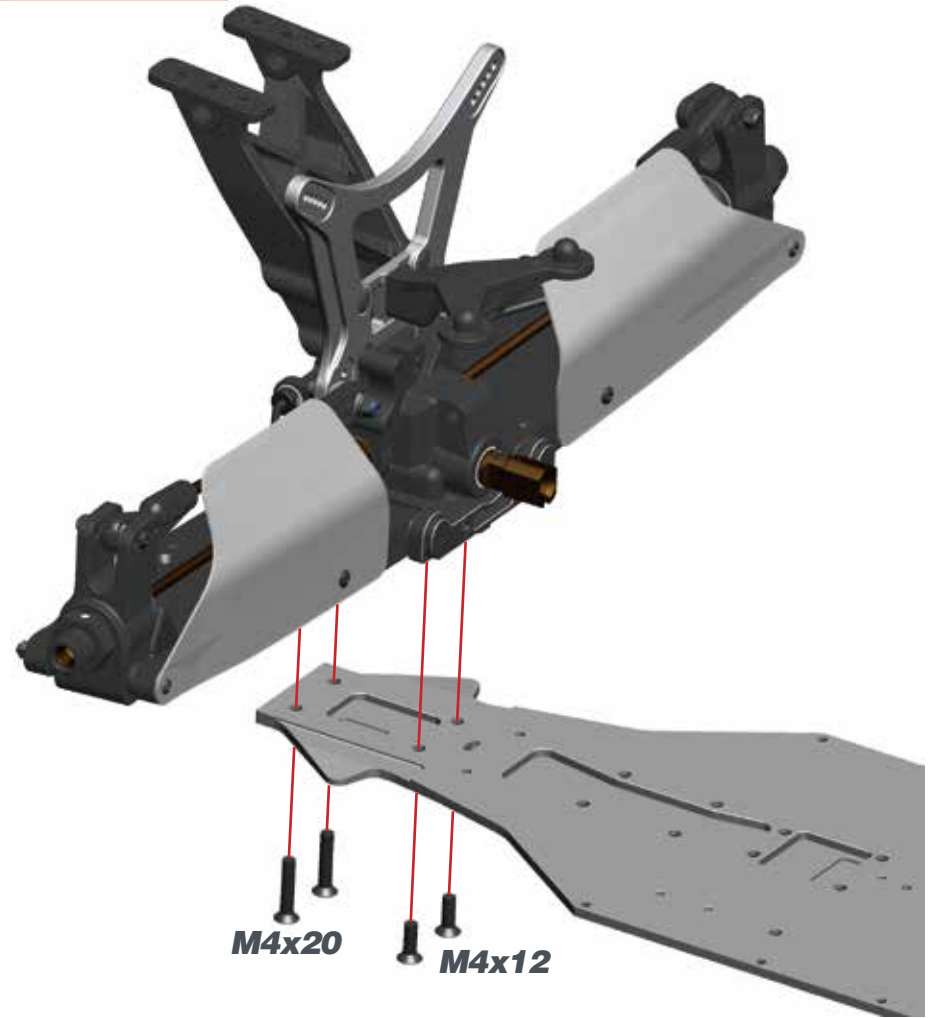

STEP 22 BAG 5





After building the differential with new gears, new differential case and bearings, the diff may feel a little tight. The connected parts need at least an hour run-time to create a perfect match. Attention: When you assemble the diff with too much initial play, the gears will not run-in properly and may wear quickly. After 1 or 2 hours of running the car, re-check the gear-mesh between the ring gear and the pinion. All parts should have run-in properly now. You may add or remove 8x11x0.1 shims as needed.



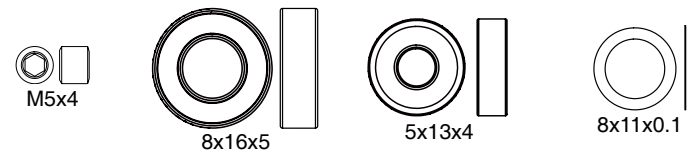

STEP 23

23.1



After 1 or 2 hours of running the car, re-check the gear-mesh between the ring gear and the pinion. All parts should have run-in properly. You may add or remove 13x16x0.1 shims as needed.

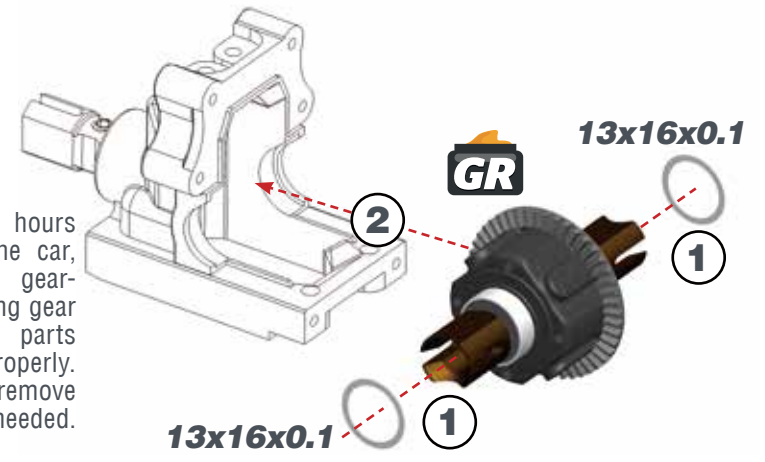

23.2

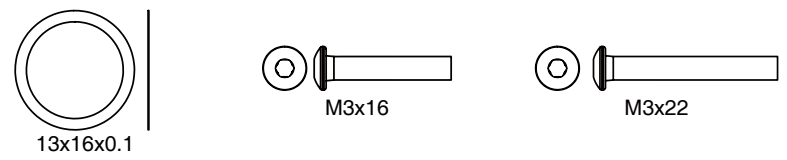
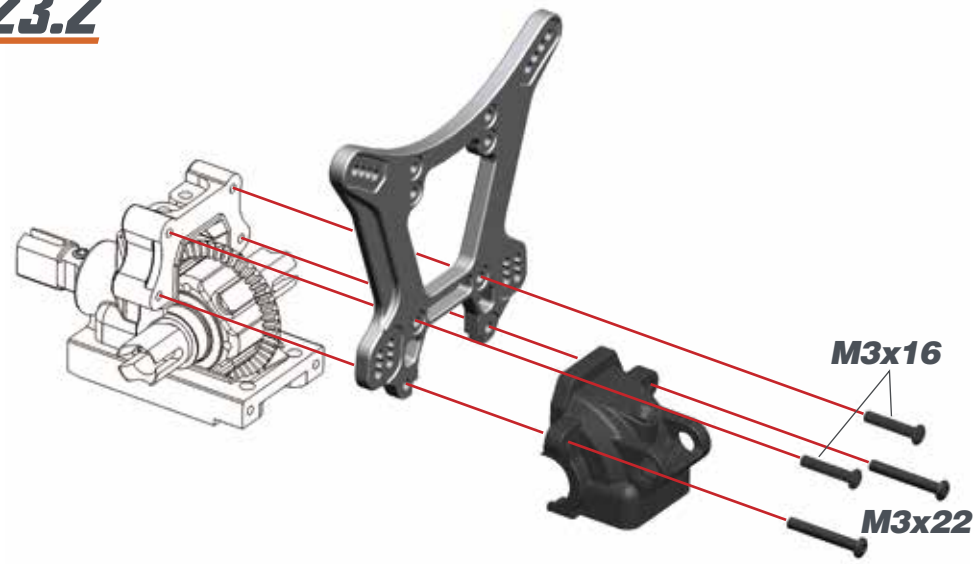

STEP 24

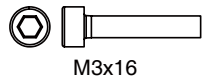
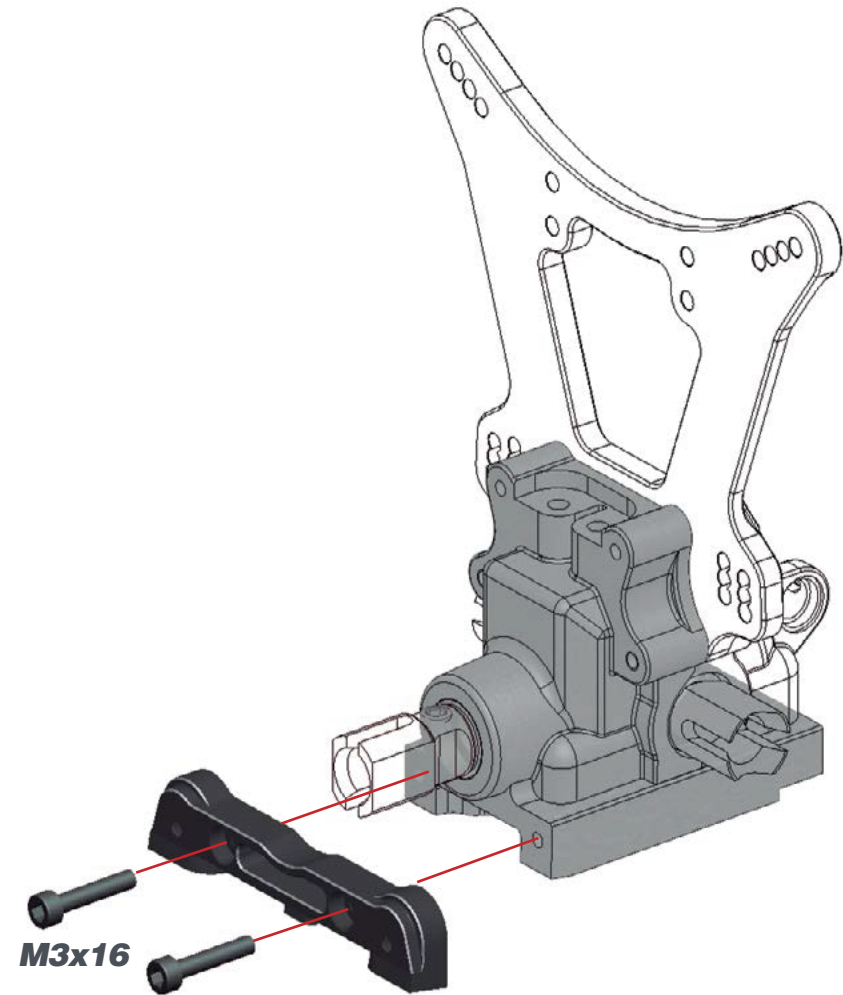

STEP 25 BAG 6

25.1

L=R ! Tighten anti-roll bar cap until there is no play, and it moves freely.



25.2

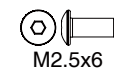

STEP 26

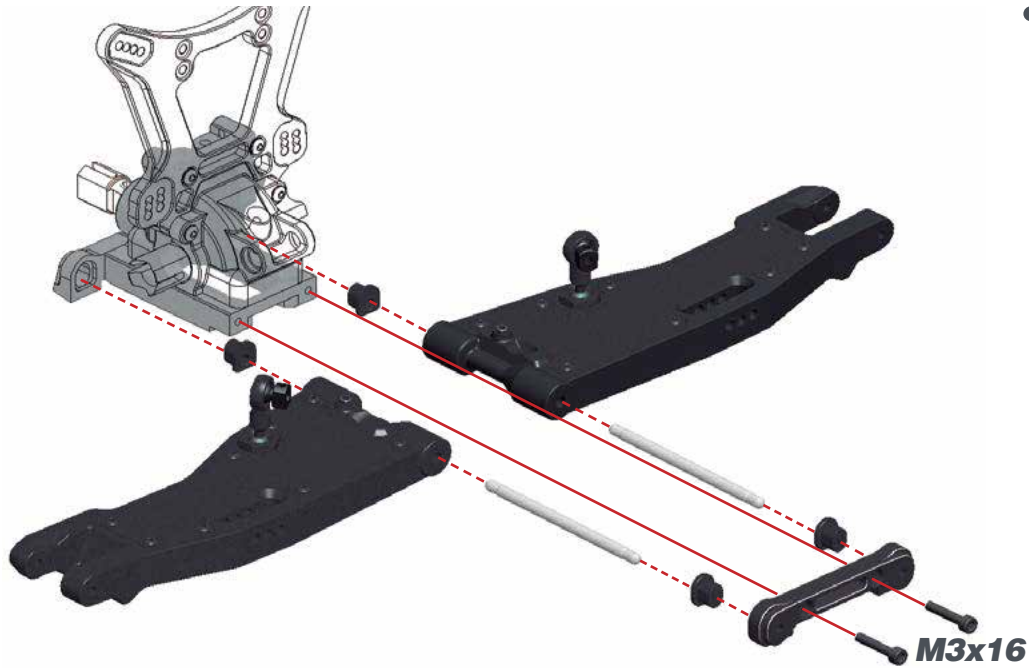

L=R FRONT REAR INSERTS

0	1	2
●	●	●

DEF. SETUP

L=R FRONT SUSPENSION KICKUP INSERTS

9	9.5	10	10.5	11
●	●	●	●	●

DEF. SETUP

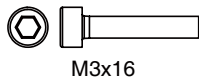

STEP 27

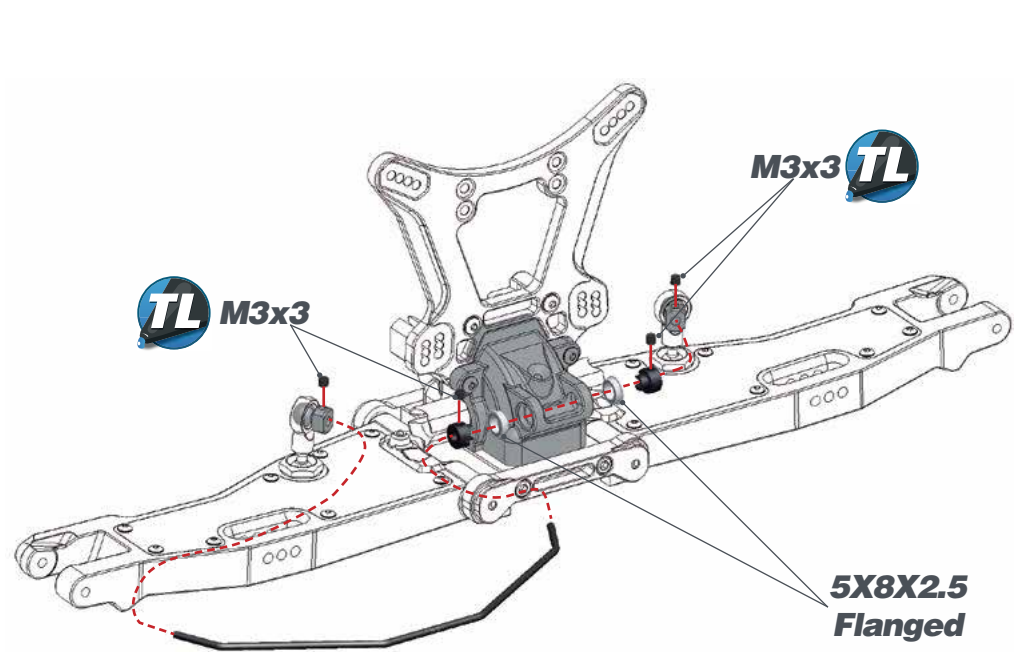

FRONT ANTIROLL BAR ASSEMBLY



STEP 28 BAG 7

28.1 **L=R**

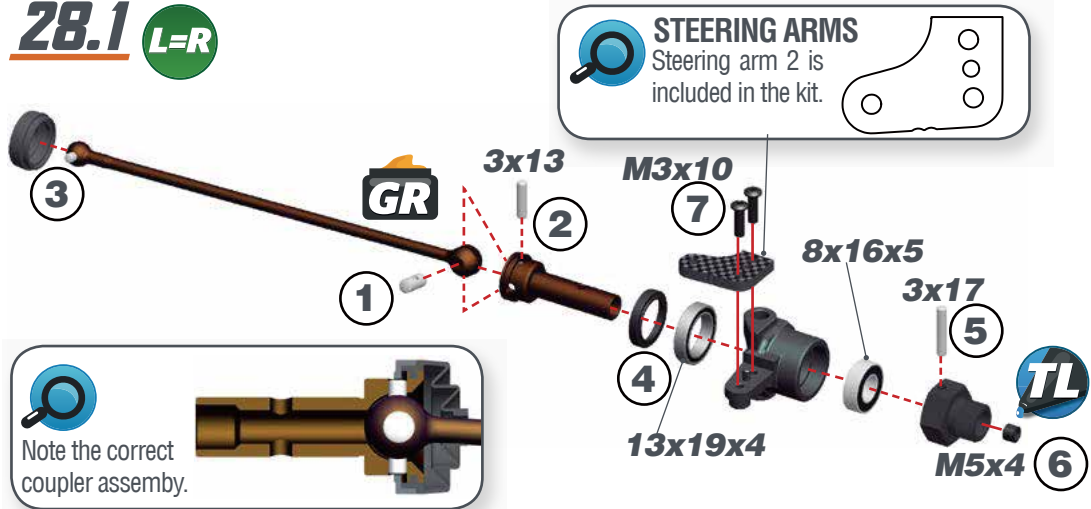



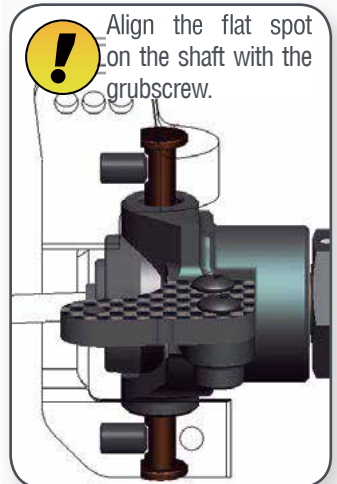
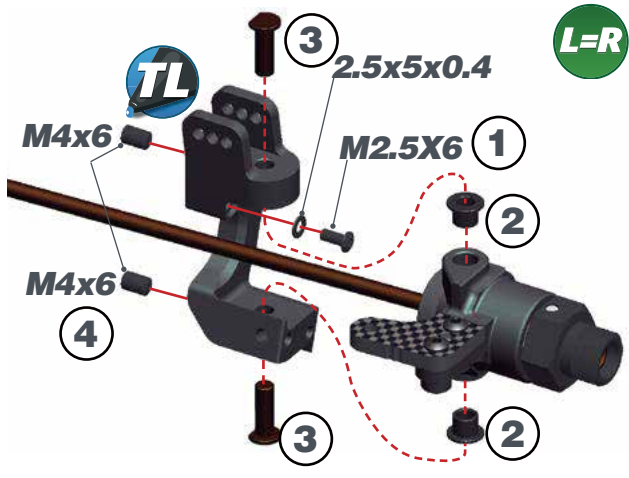

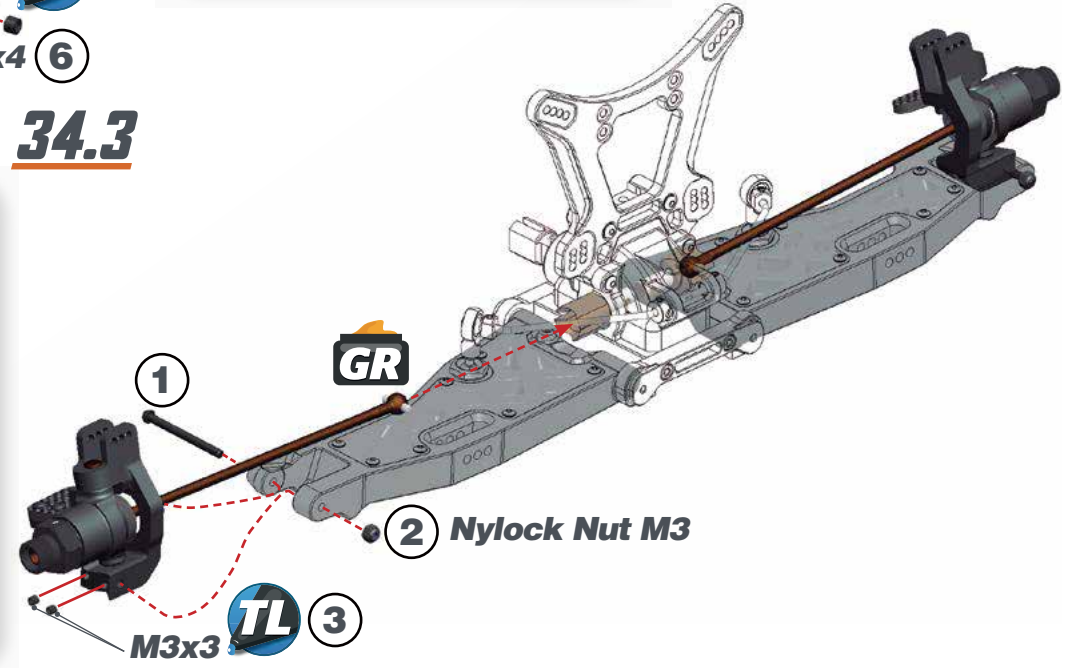

28.2

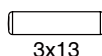
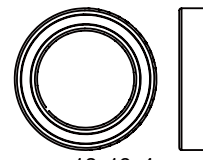
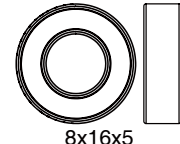
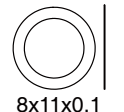
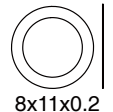
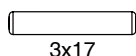

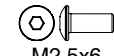
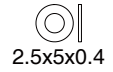
34.3



-  3x13
-  13x19x4
-  8x16x5
-  8x11x0.1
-  8x11x0.2
-  3x17
-  M5x4
-  M3x10
-  M2.5x6
-  2.5x5x0.4
-  M4x6
-  M3x3
-  Nylock Nut M3

STEP 29 BAG 8

29.1

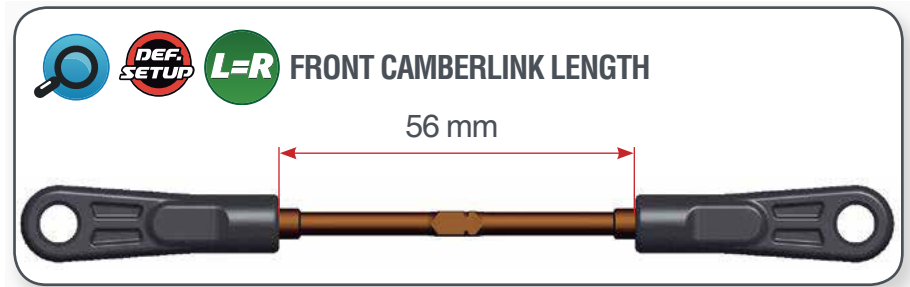

29.2

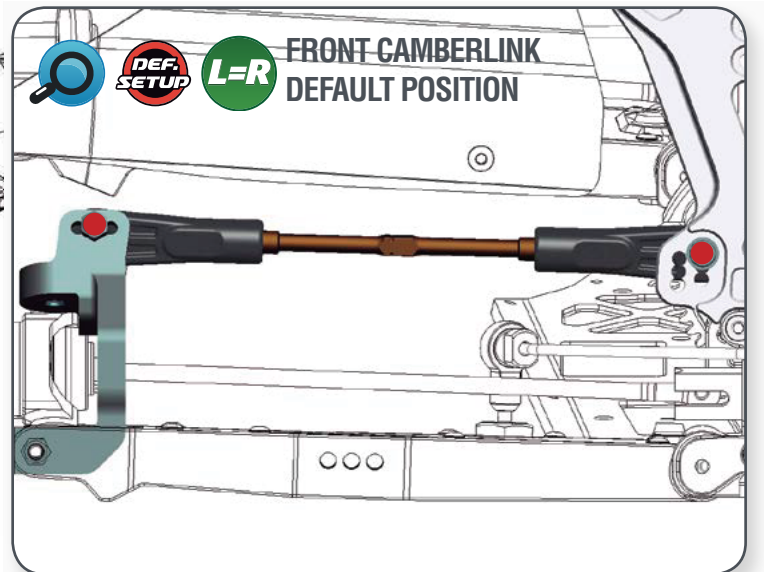
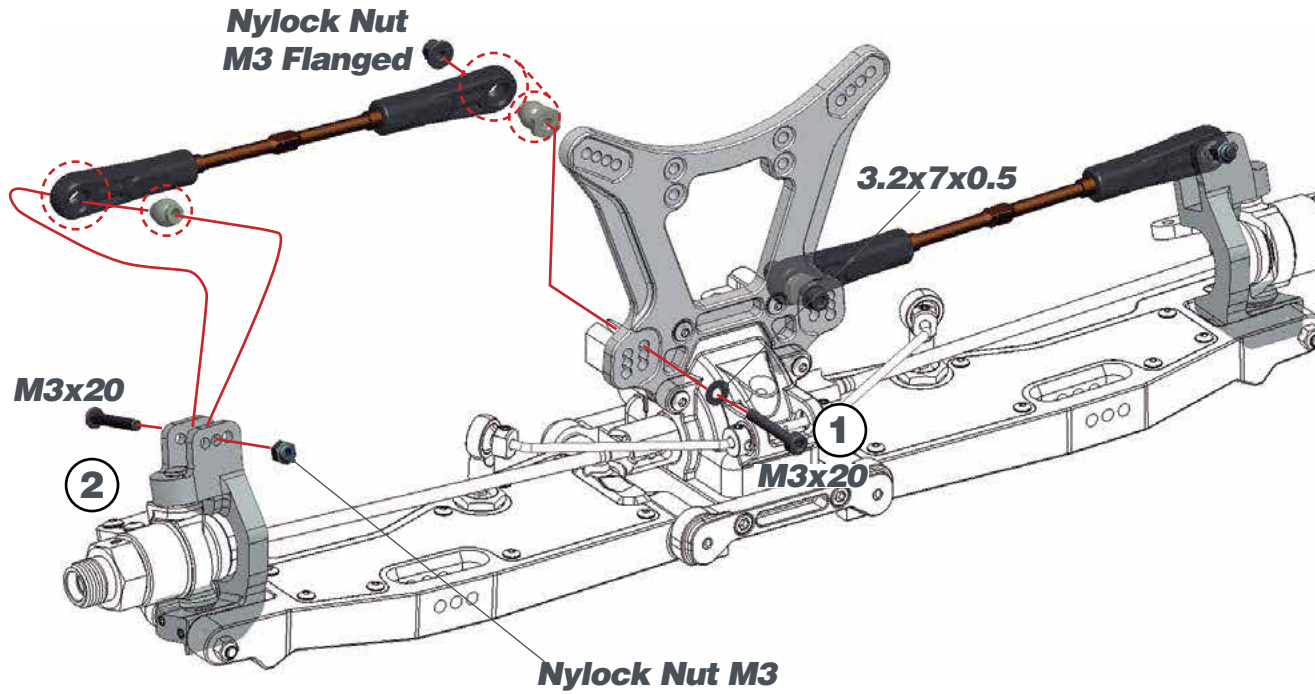

- 
 M3x20
- 
 3.5x7x0.5
- 
 Nylock Nut M3
 Flanged
- 
 M3x20
- 
 Nylock Nut M3

STEP 30

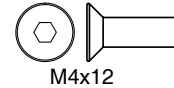
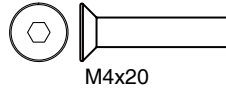
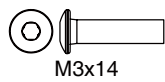
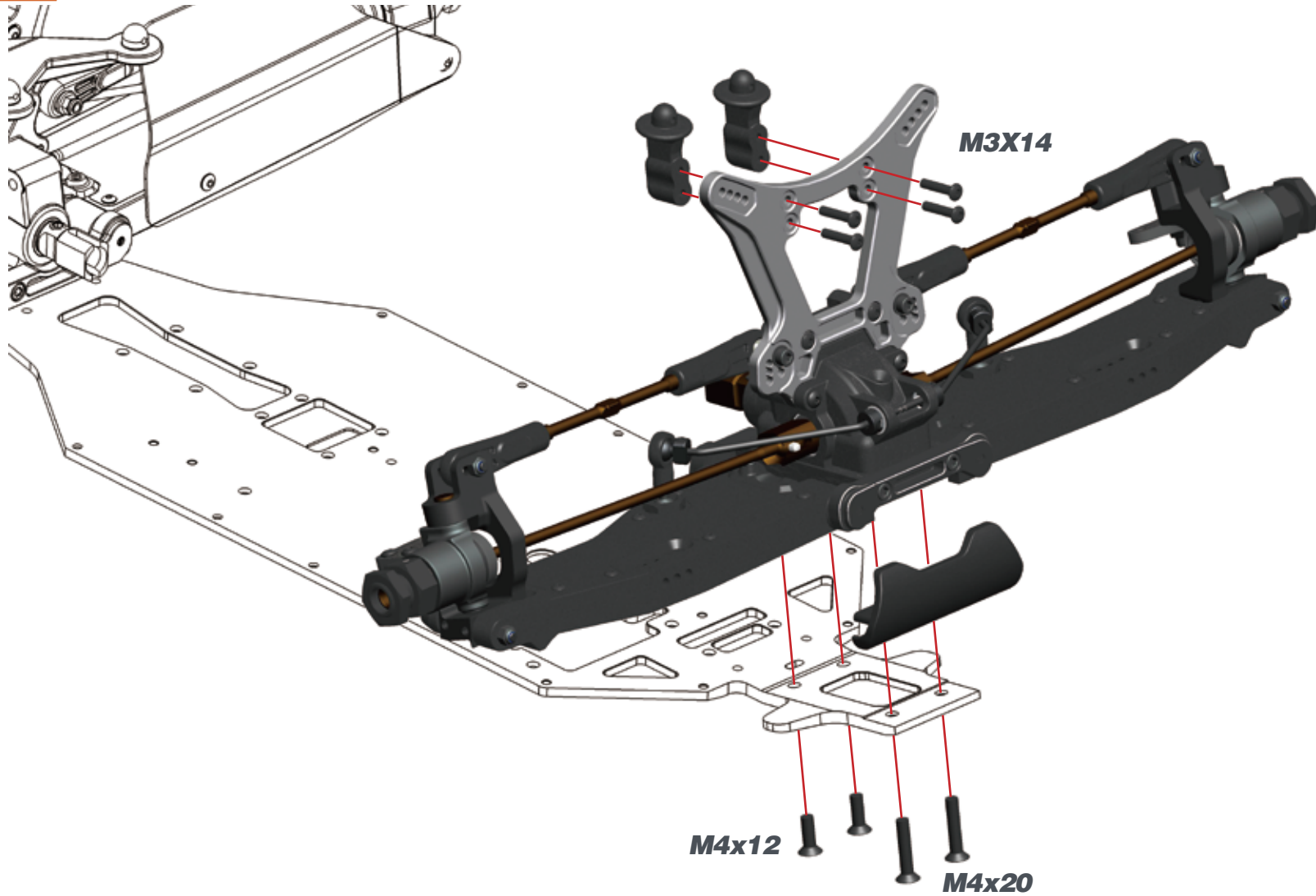

STEP 31

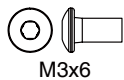
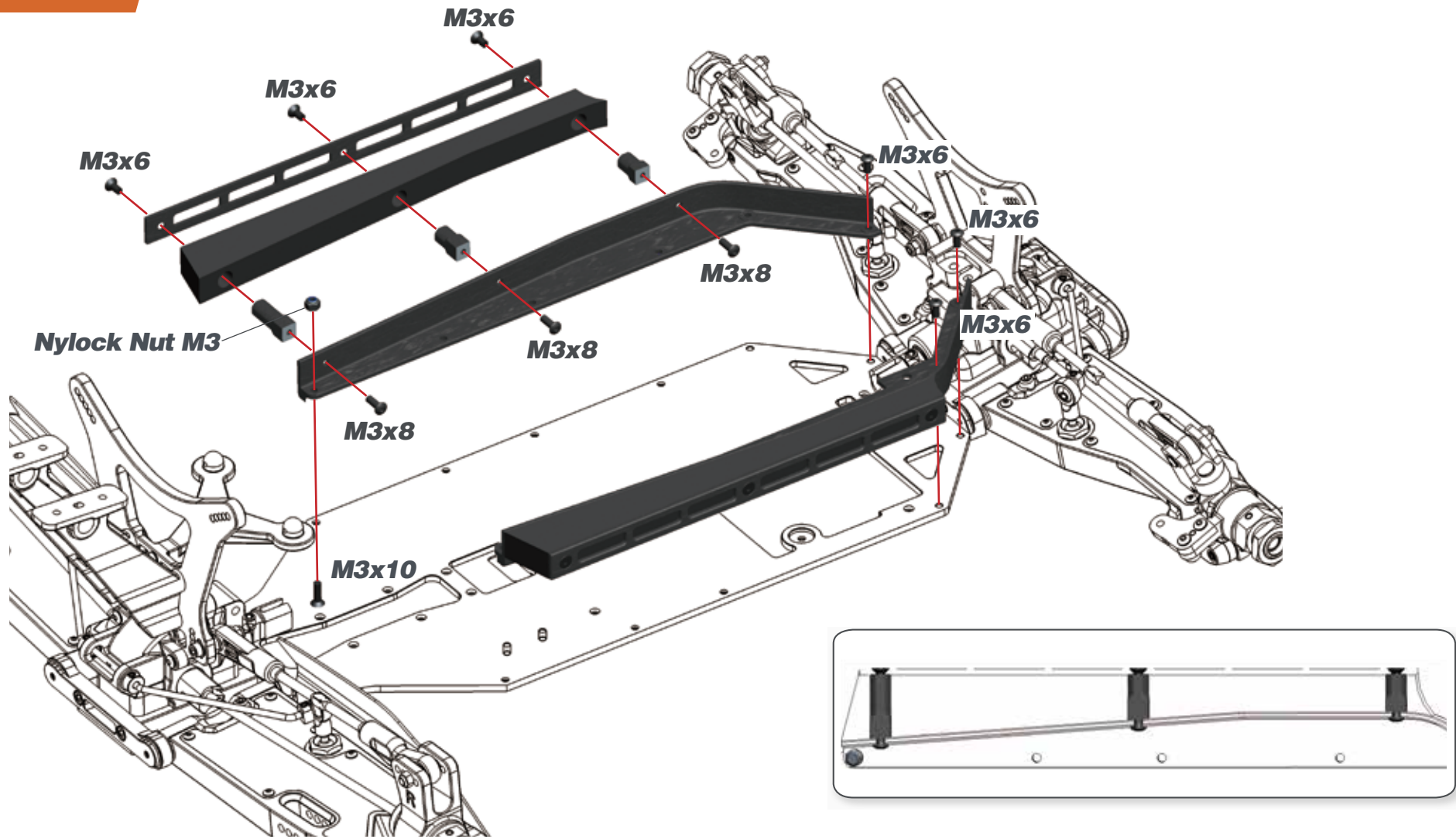

M3x6



M3x6

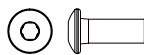

M3x8



Nylock Nut M3

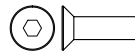

M3x10

STEP 32 BAG 9

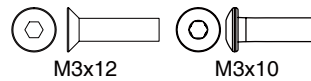
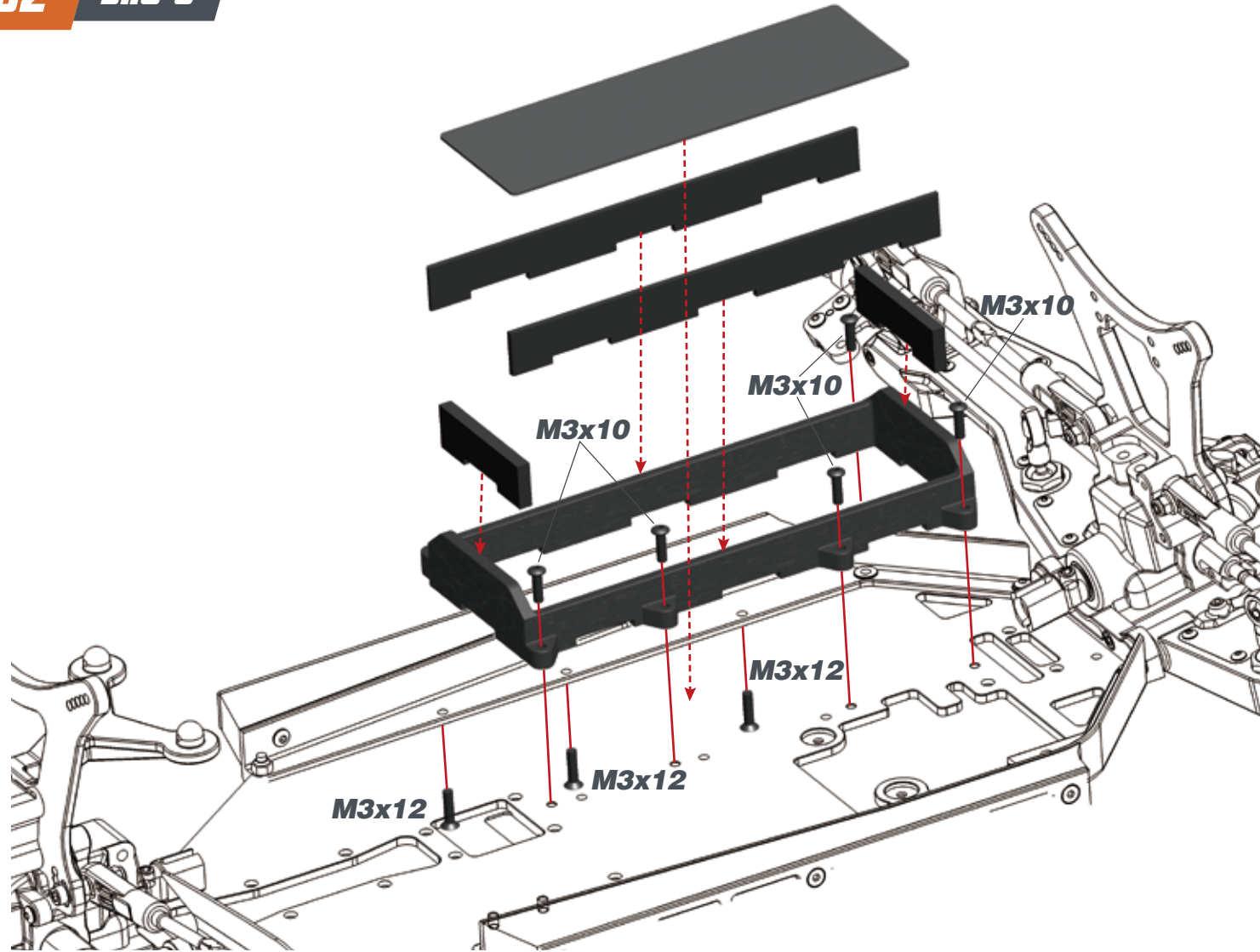

STEP 33

33.1

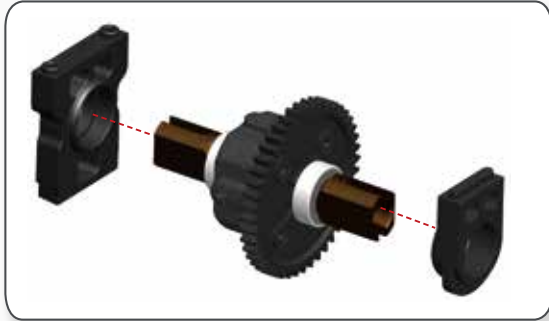

33.2

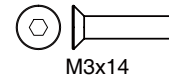
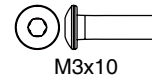
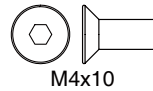
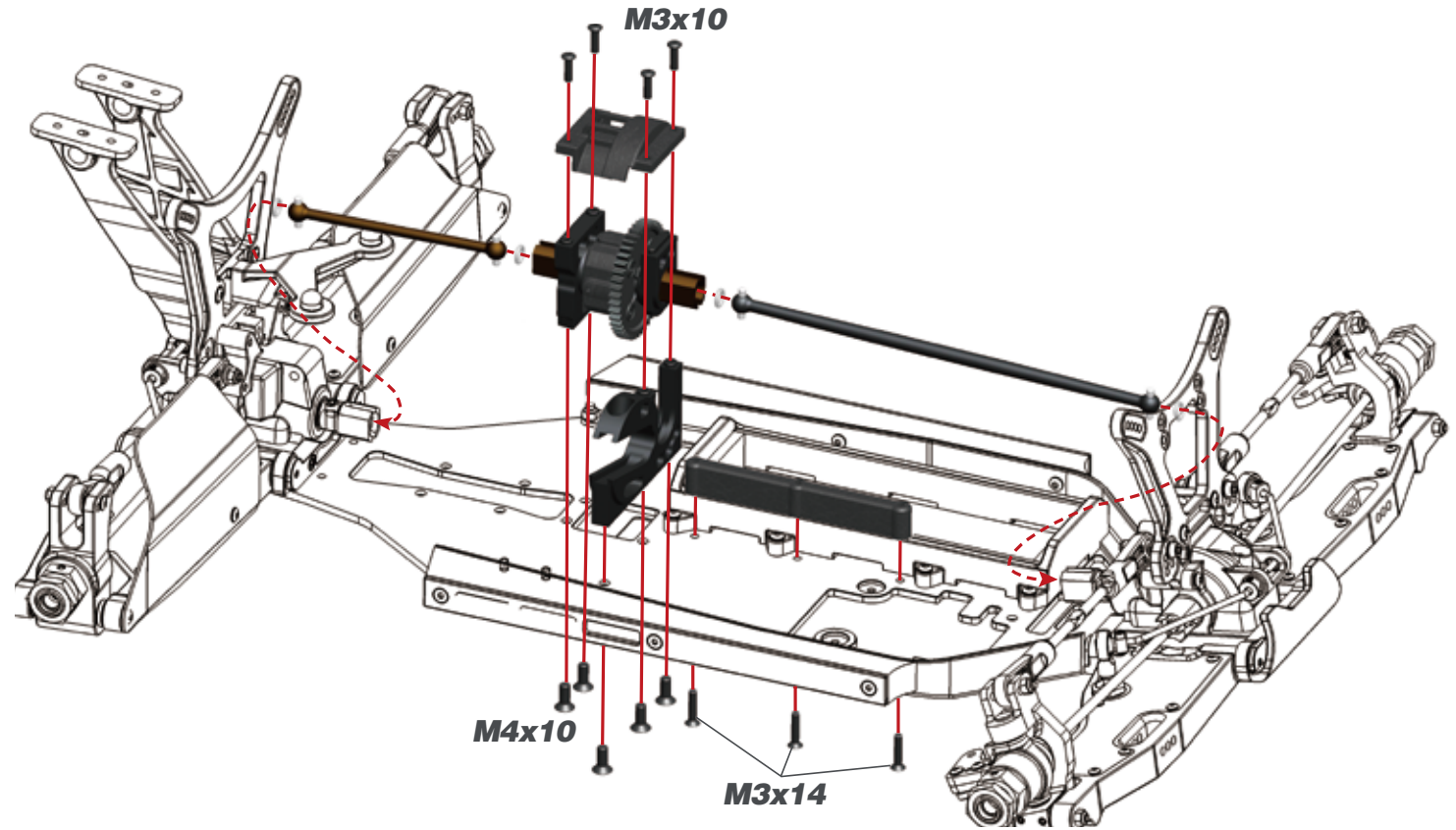

STEP 34

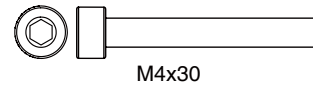
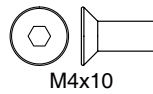
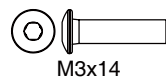
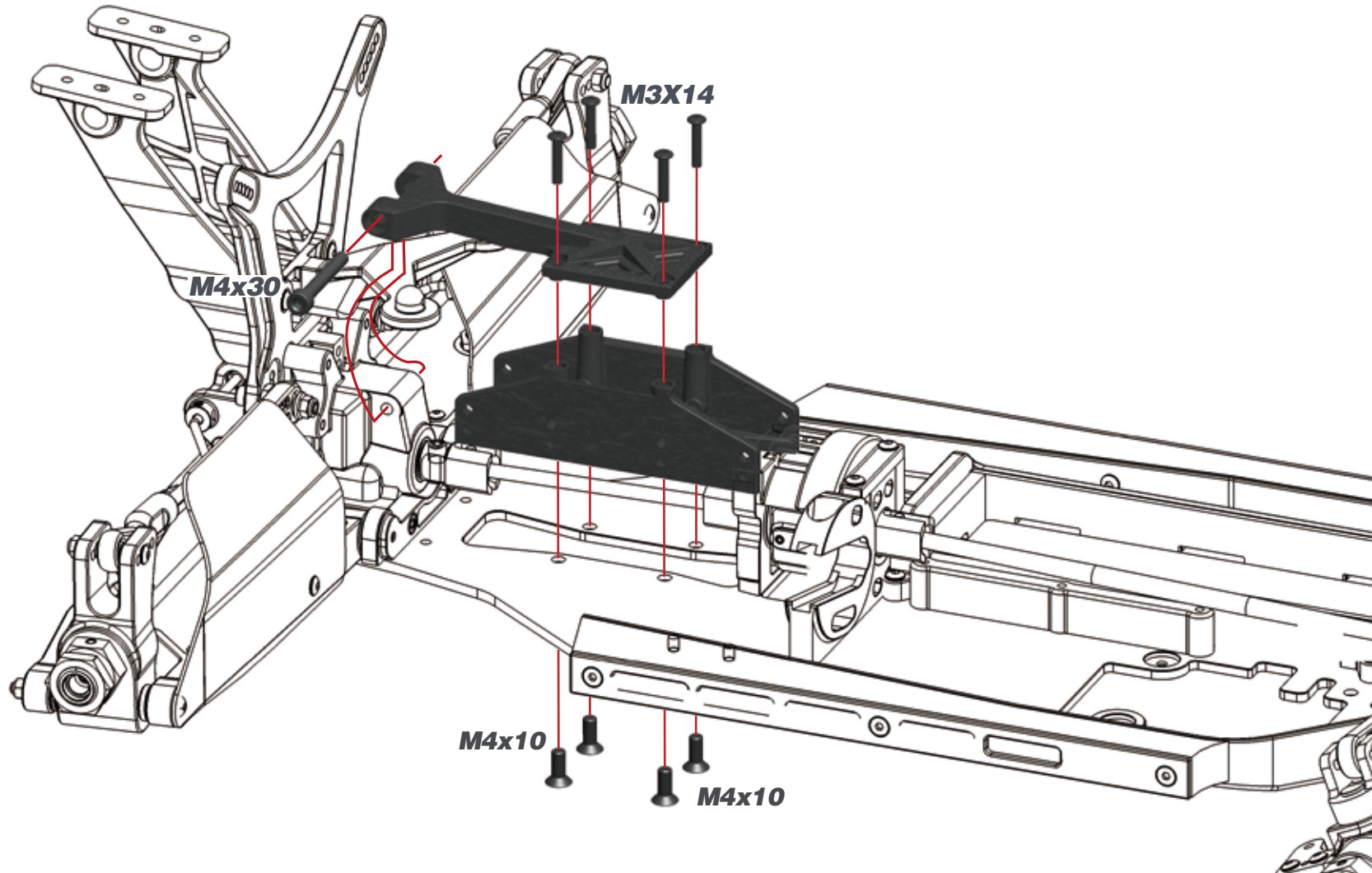

STEP 35 BAG 10

STEP 36

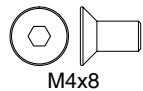
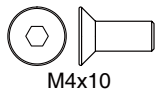
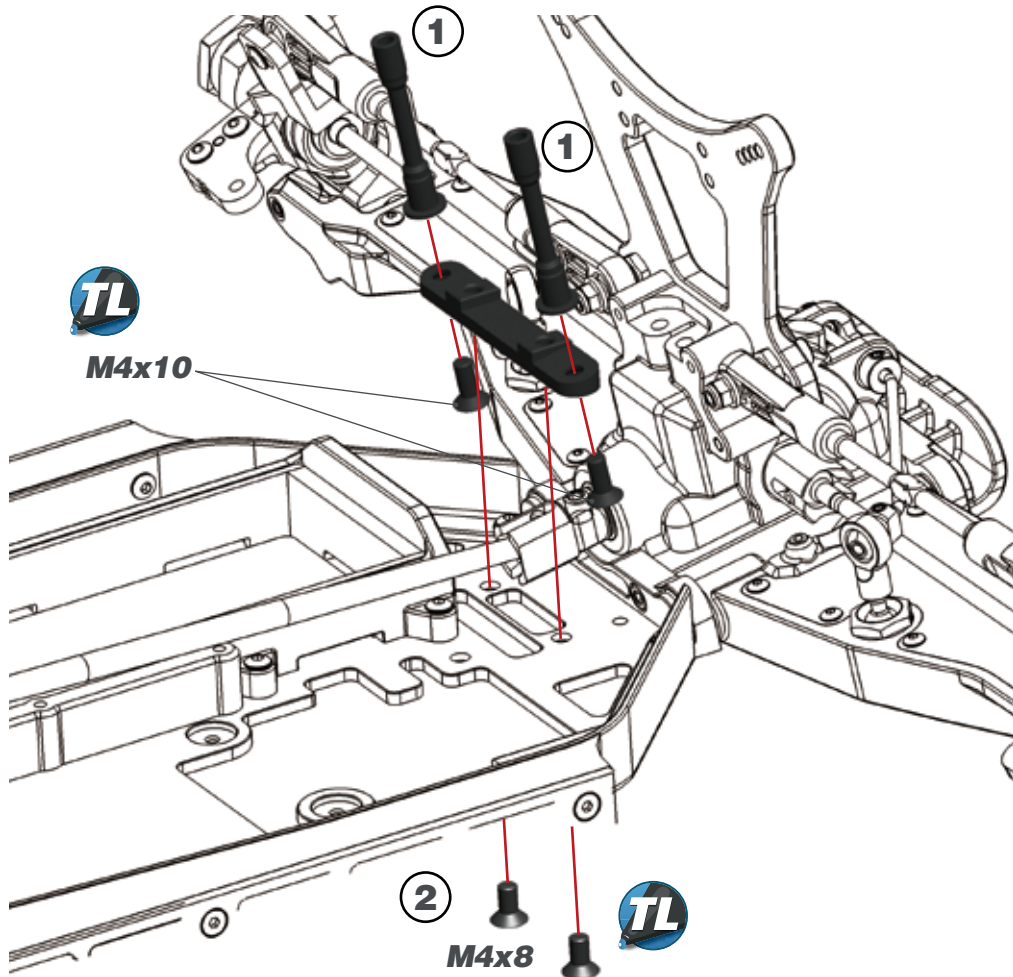

36.1



36.2

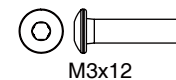
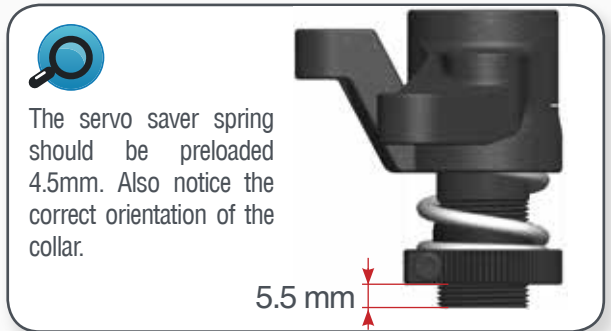
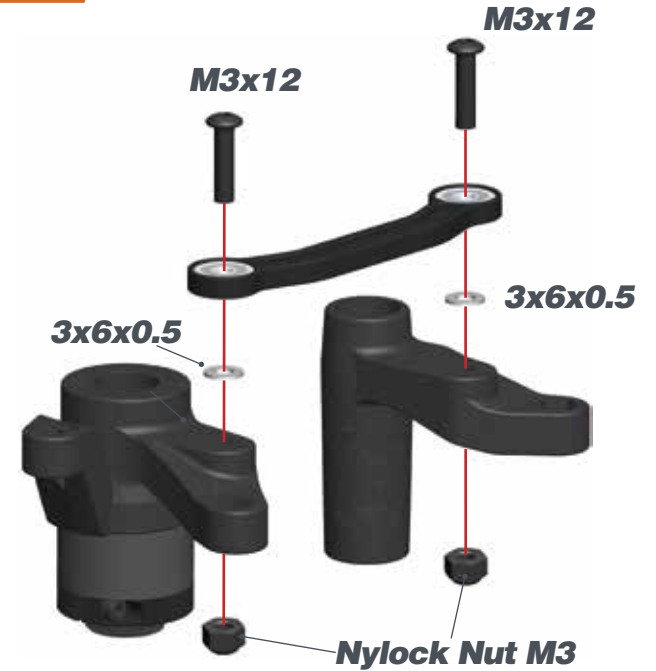

STEP 37

37.1



STEERING TRACKROD LENGTH

52.5 mm



37.2

Nylock Nut M3

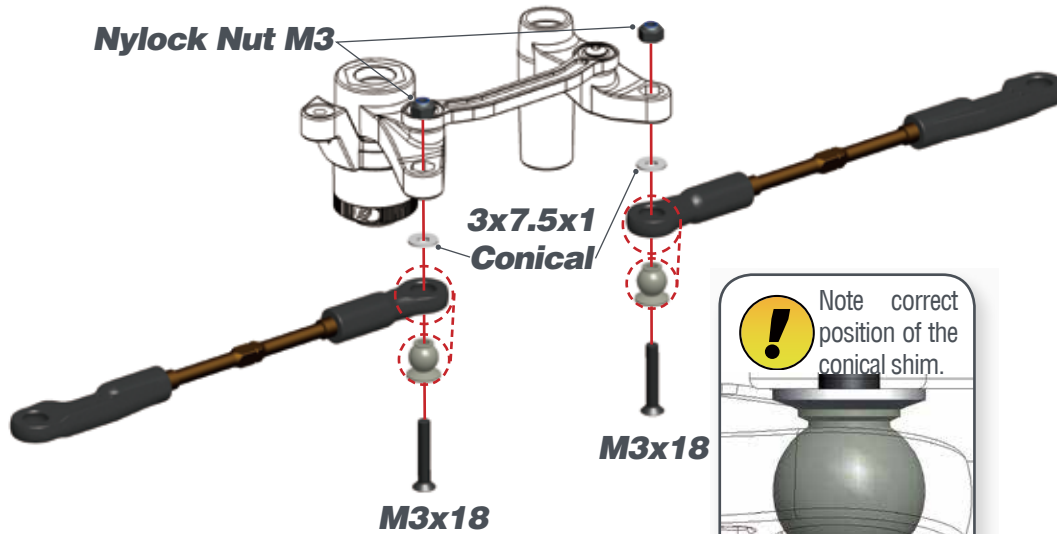

STEP 38

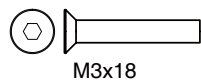
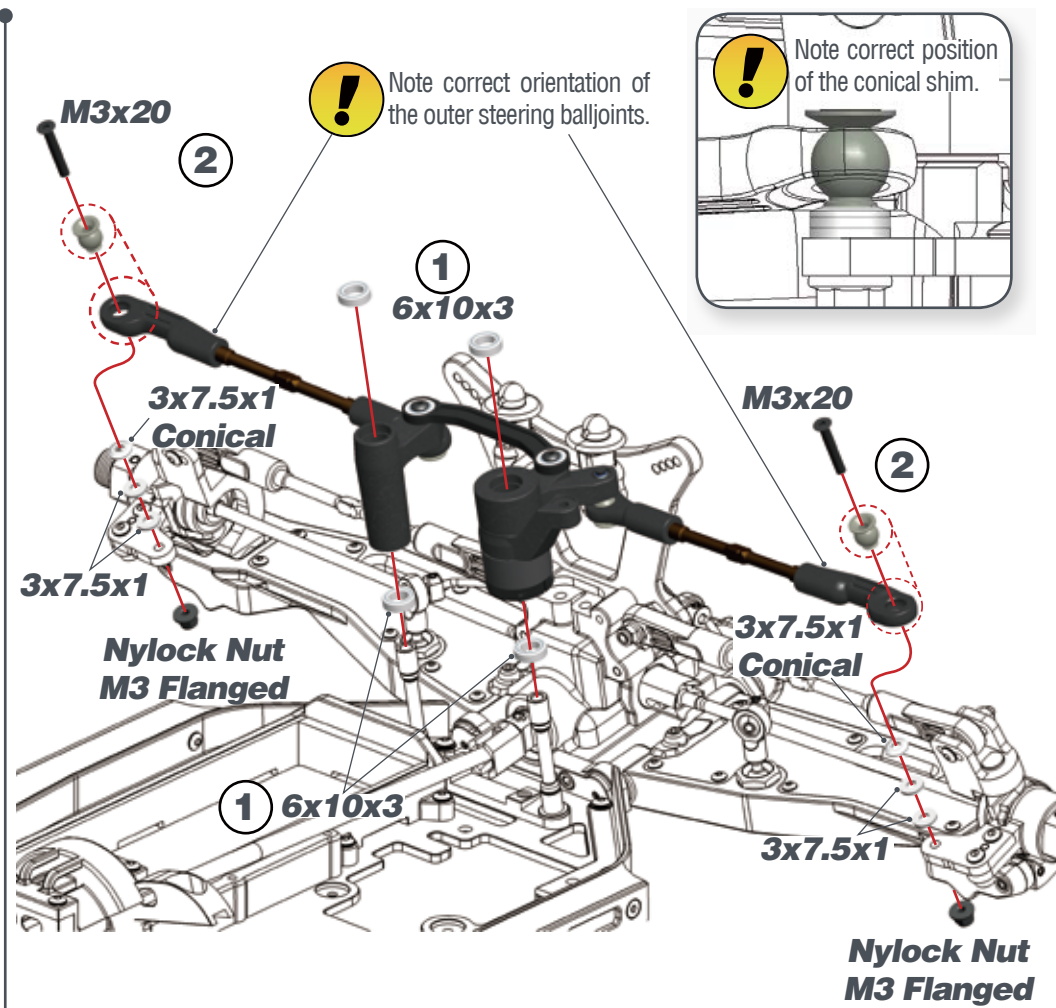

STEP 39 BAG 11

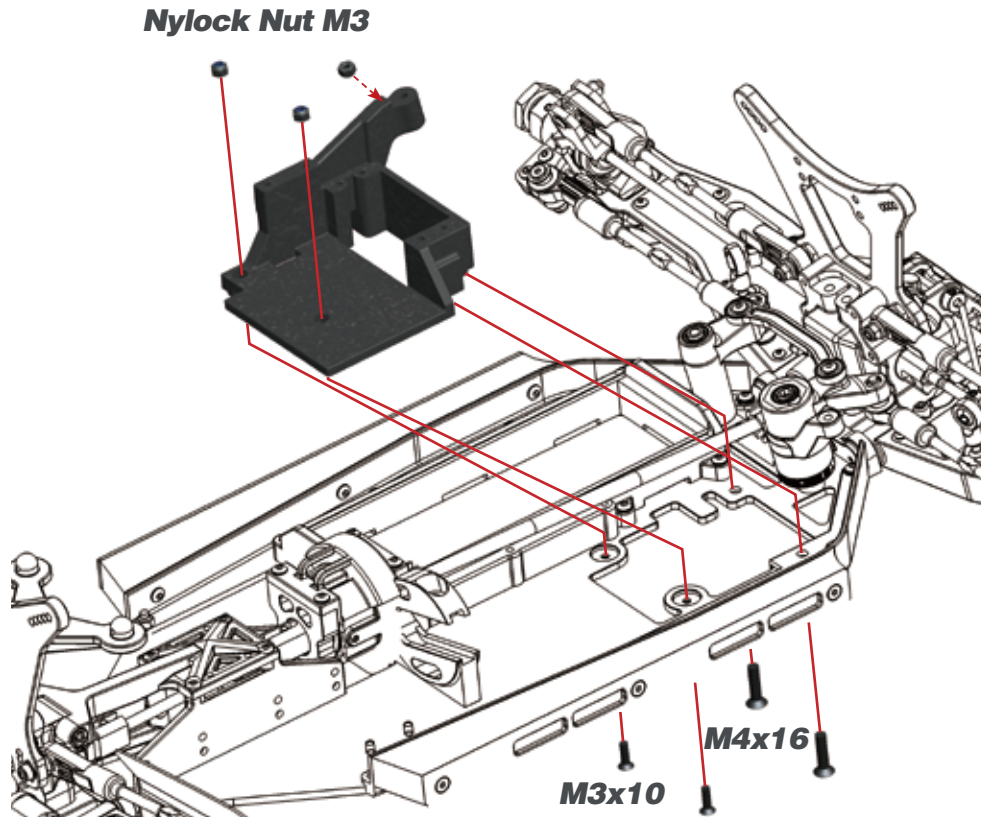

STEP 40

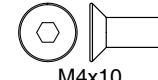
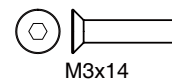
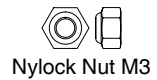
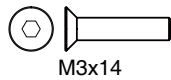
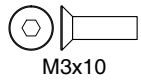
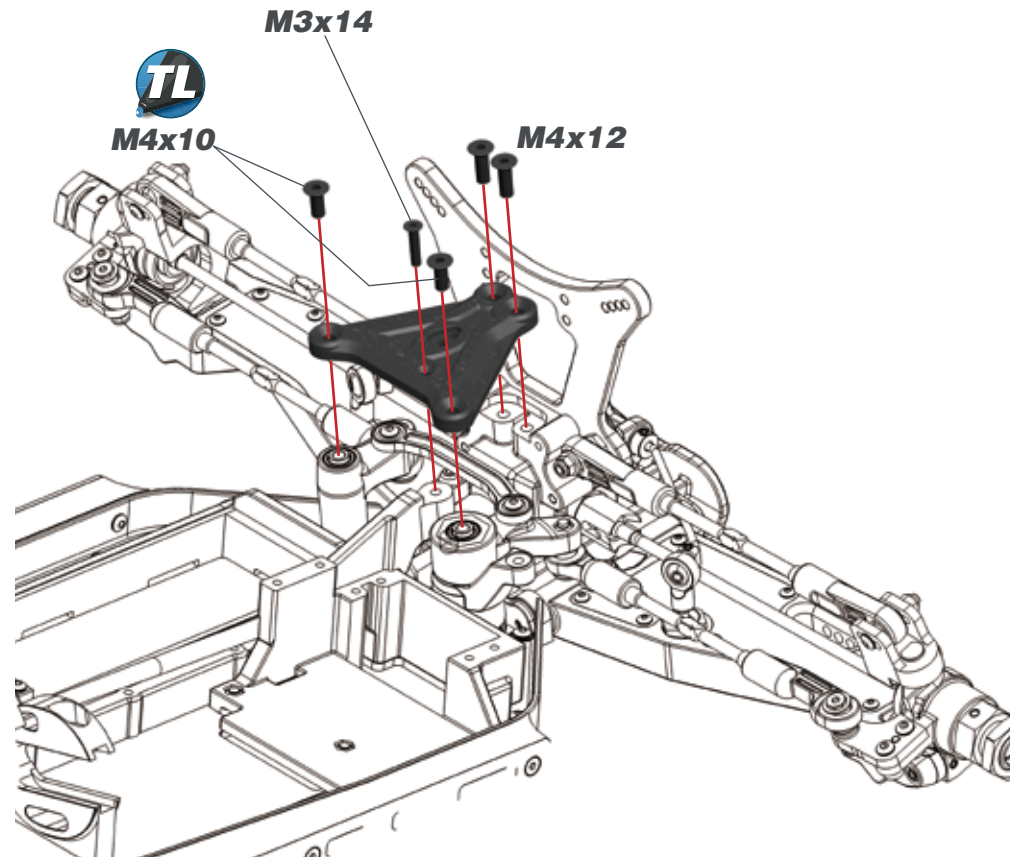

STEP 41

41.1

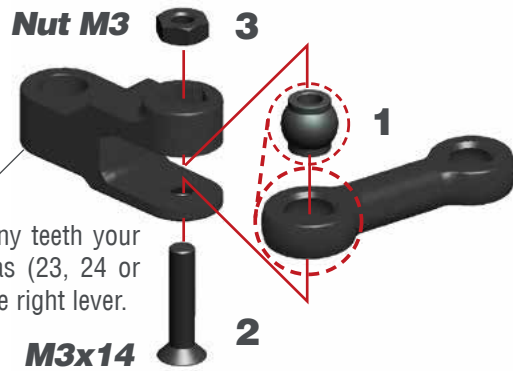

! Check how many teeth your servo spline has (23, 24 or 25) and use the right lever.

41.2



41.3

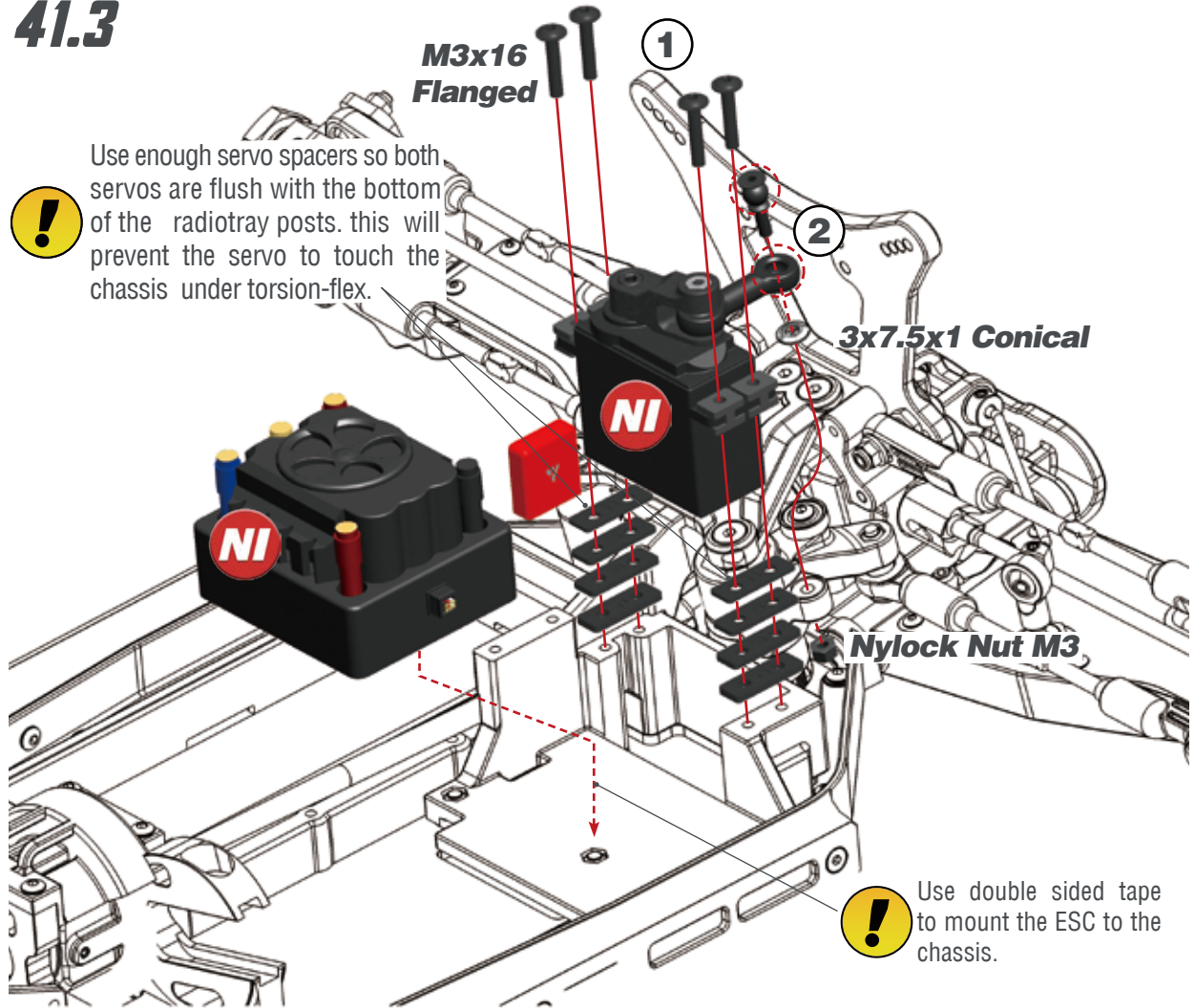

! Use enough servo spacers so both servos are flush with the bottom of the radiotray posts. This will prevent the servo to touch the chassis under torsion-flex.

! Use double sided tape to mount the ESC to the chassis.

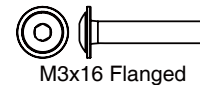
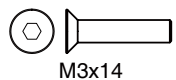

STEP 42 BAG 12

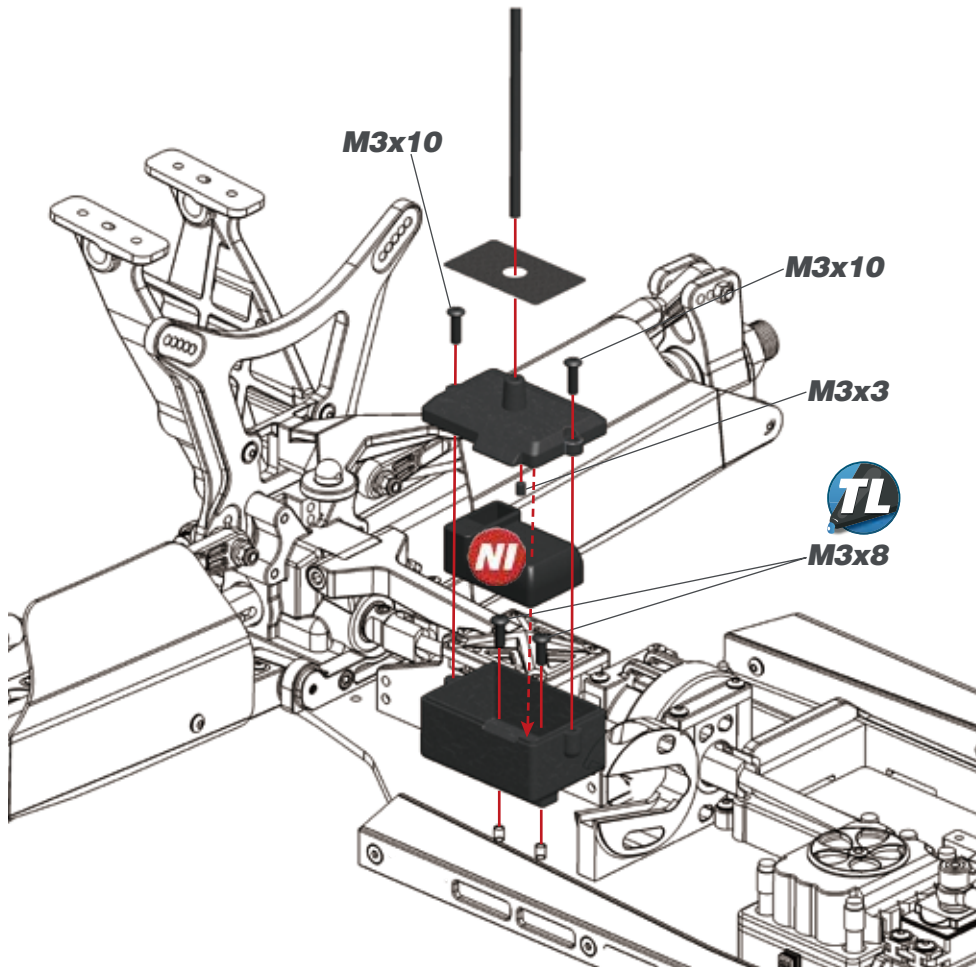

M3x3

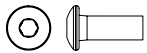

M3x8

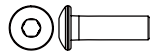

M3x10

STEP 43

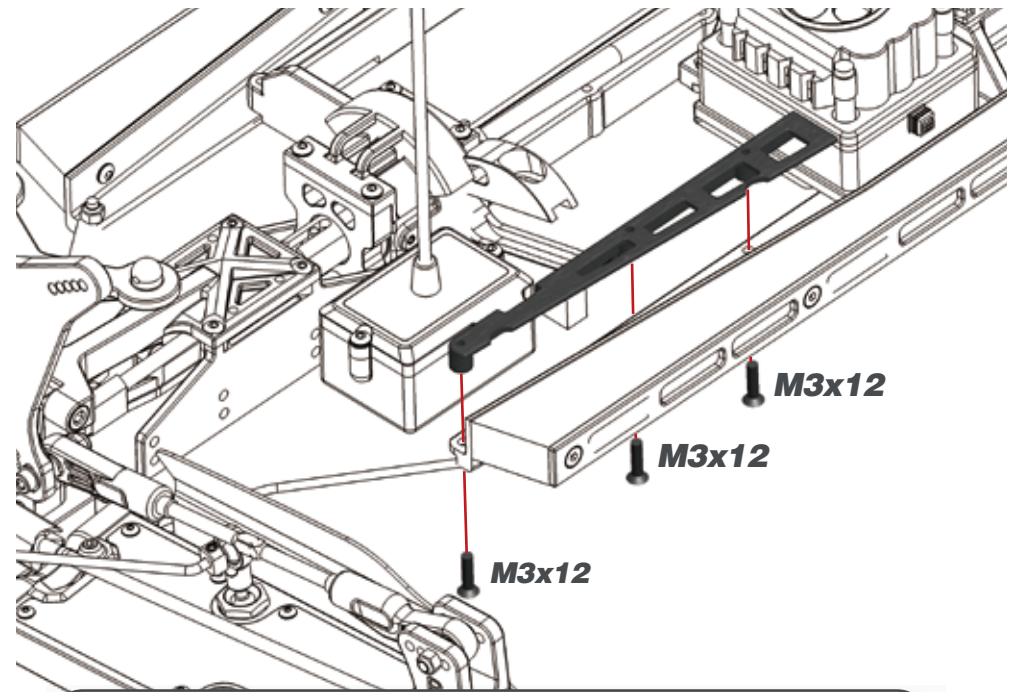

WIRES DIAGRAM

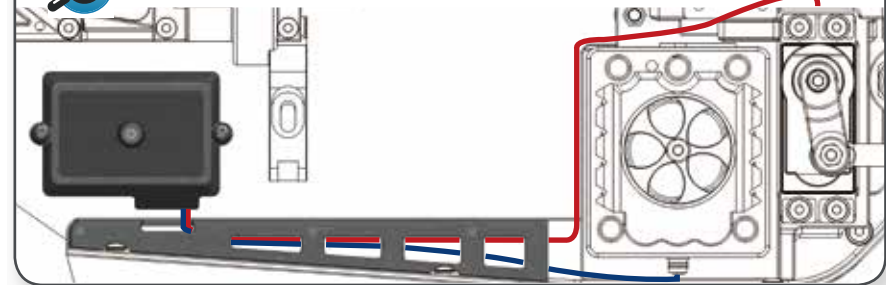

M3x12

STEP 44

44.1



Pinion is not included in the kit. Assemble the proper pinion for your set-up.



44.2

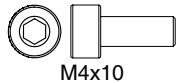
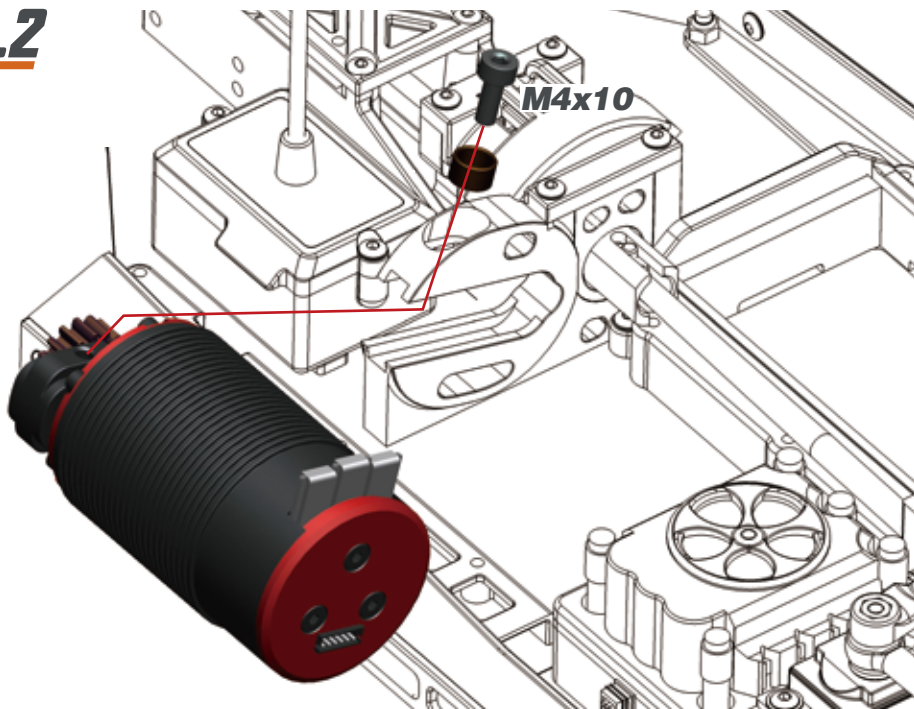

M4x10

STEP 45

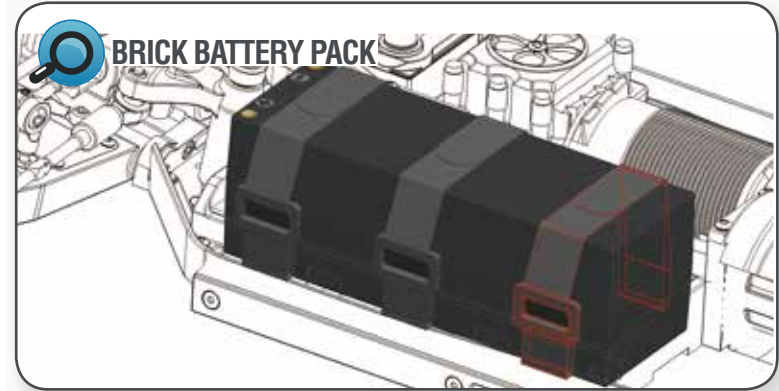
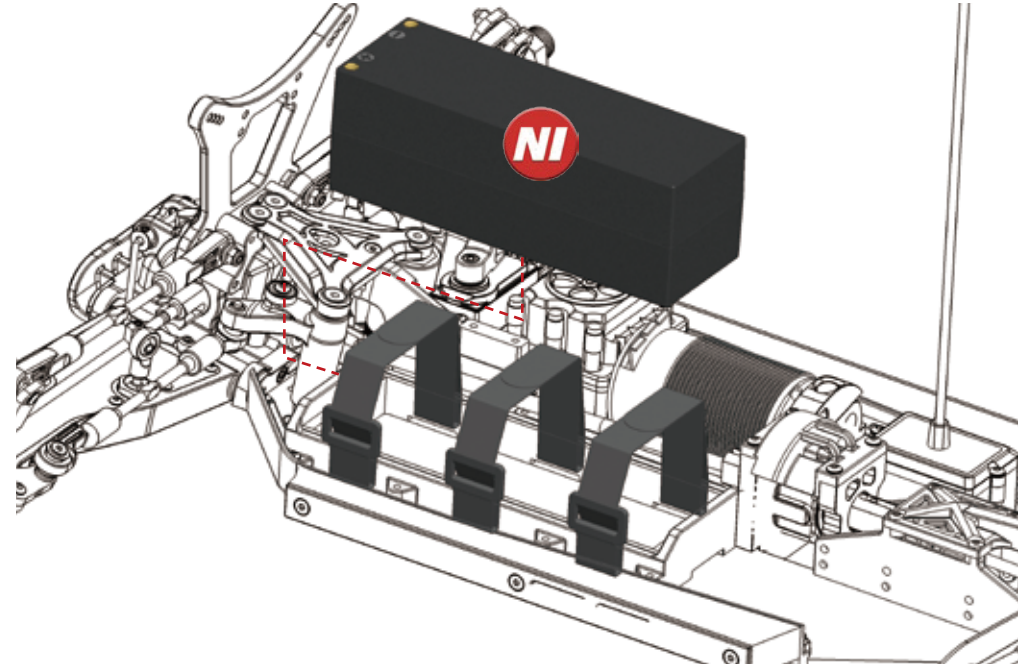

BRICK BATTERY PACK

STEP 46 BAG 13 FR SHOCKS / BAG 14 RR SHOCKS / STEP 47

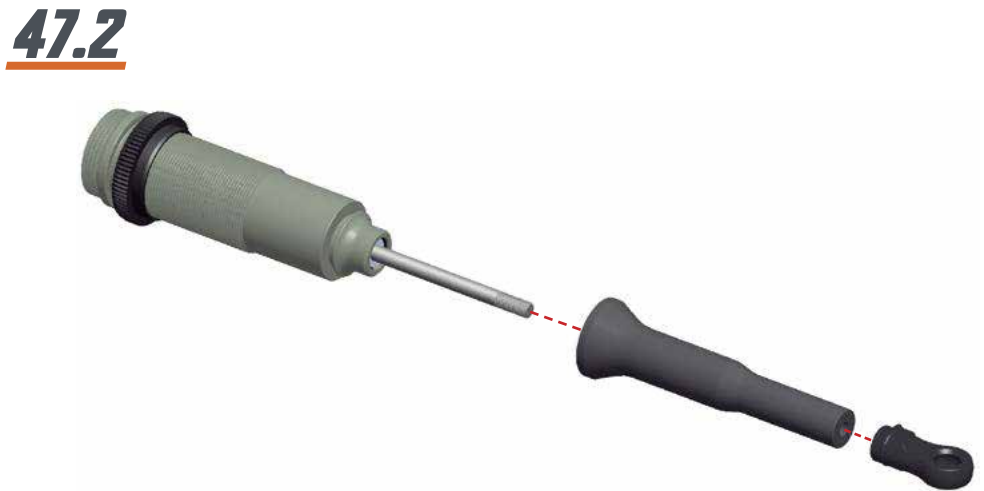
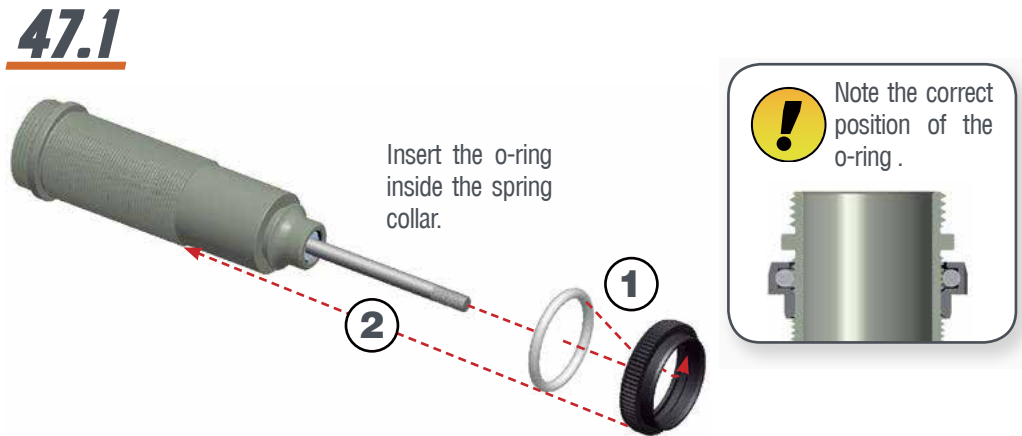
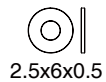
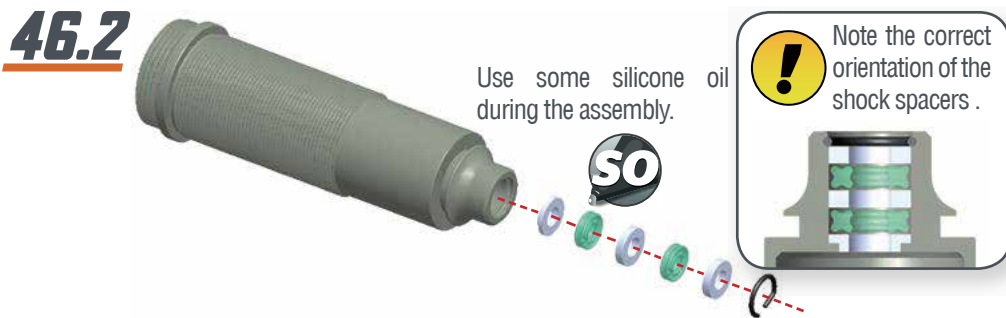

STEP 48

48.1

Push the membrane into the shock cap.



48.2

1- Fill up with silicone oil fully using the silicone oil supplied in the kit. For the correct cst value please check the default setupsheet.

2- Extend the shockrod fully

3- Move the shockrod slowly up and down to let ALL air bubbles escape.

4- Apply the gasket and cap and close fully.



48.3

1-Bleed: push the shock-rod all the way in slowly, to allow excessive oil to escape.

2- With shockrod fully in, mount the o-ring and screw.

M2.3x4



SHOCKS LENGTH: Measure the shock length fully extended.

FRONT **REAR**

49 mm 53 mm

STEP 49

Assemble the spring and spring-cup (align correctly) to complete the shock.



STEP 50 BAG 15

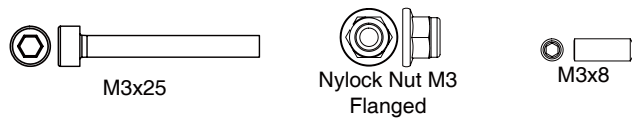
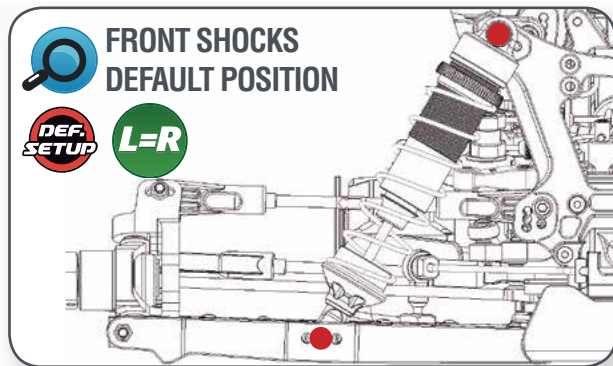
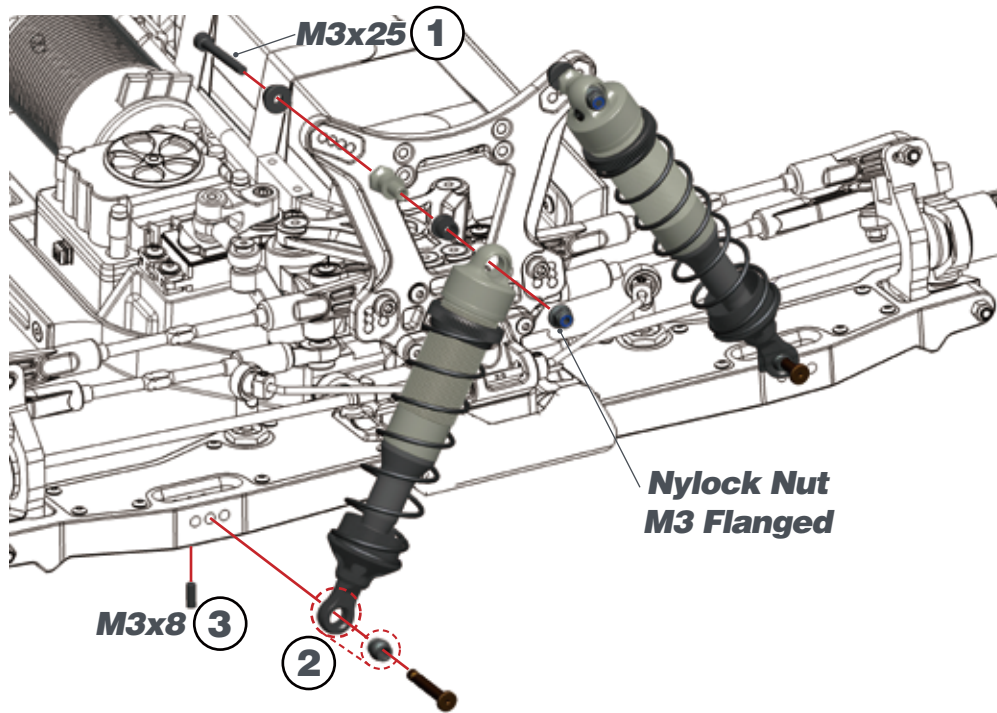

STEP 51

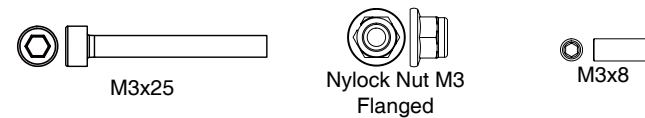
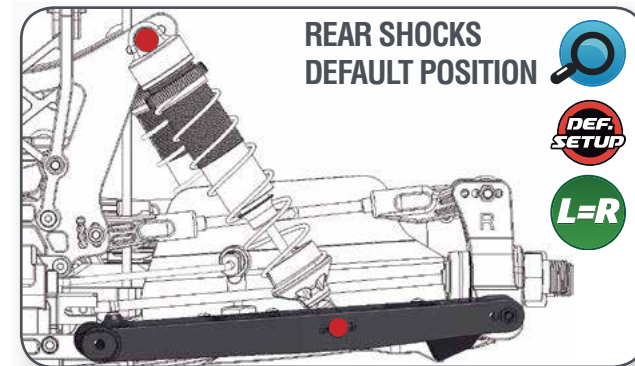
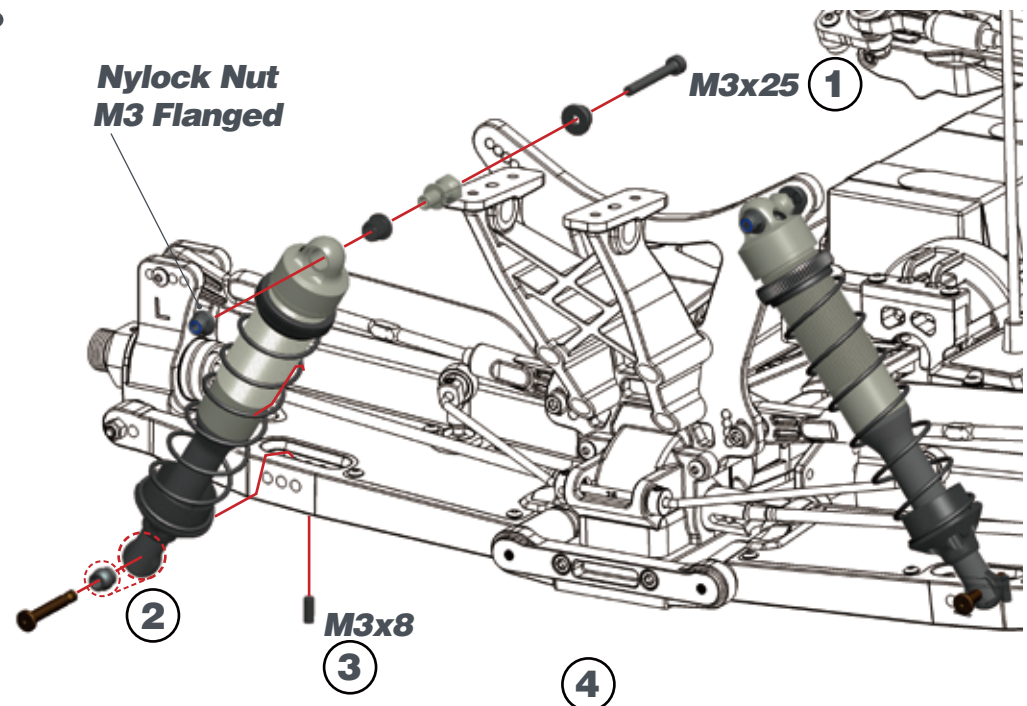

STEP 52

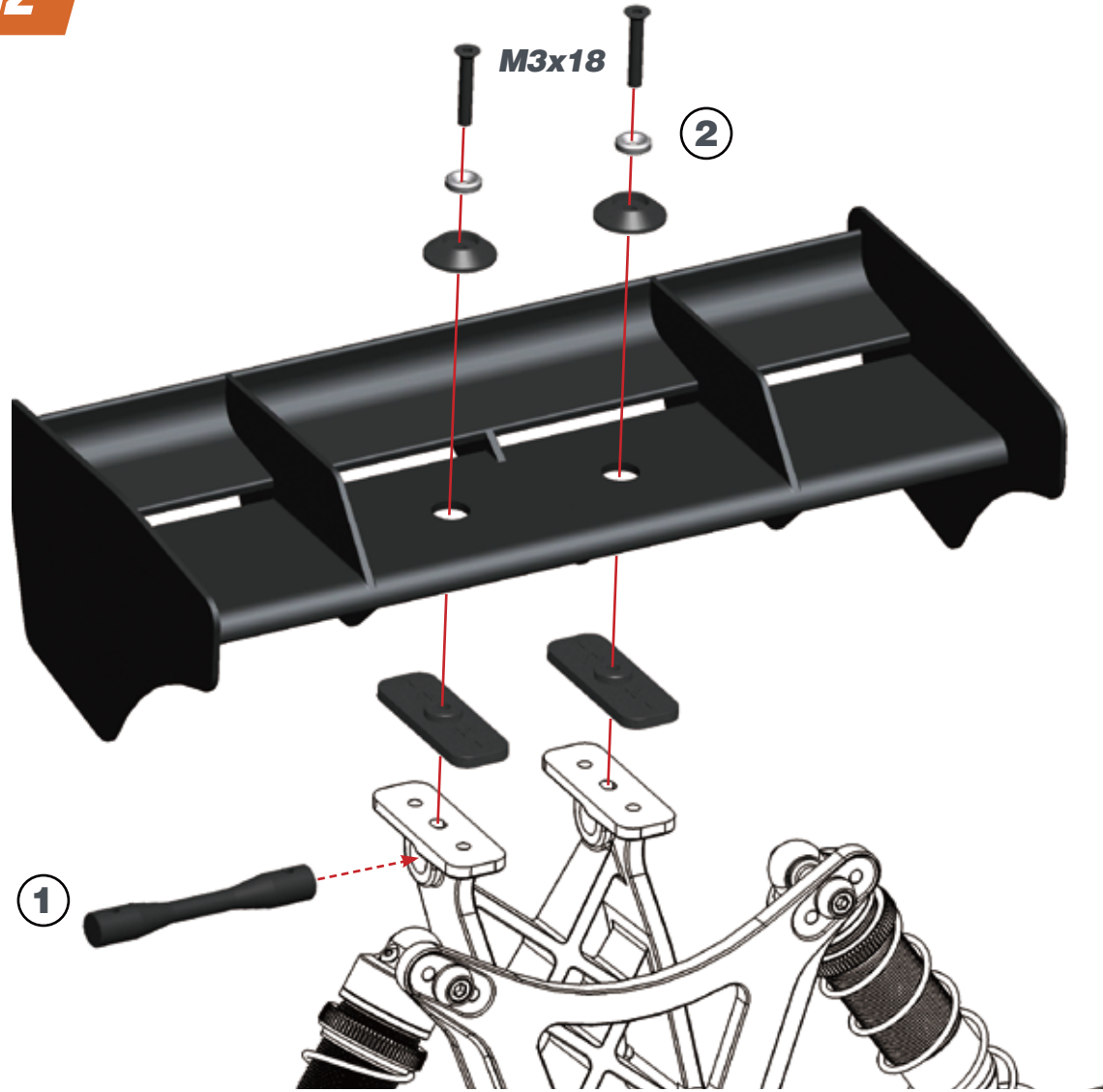

ANGLED WING SPACERS CHART

2°	← ⊗ ⊙ ↗ →
4°	← ↗ ⊙ ↘ → DEF. SETUP
6°	← ↘ ⊙ ⊗ →

REAR ↔ **FRONT**

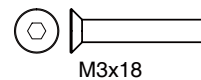

M3x18

STEP 53

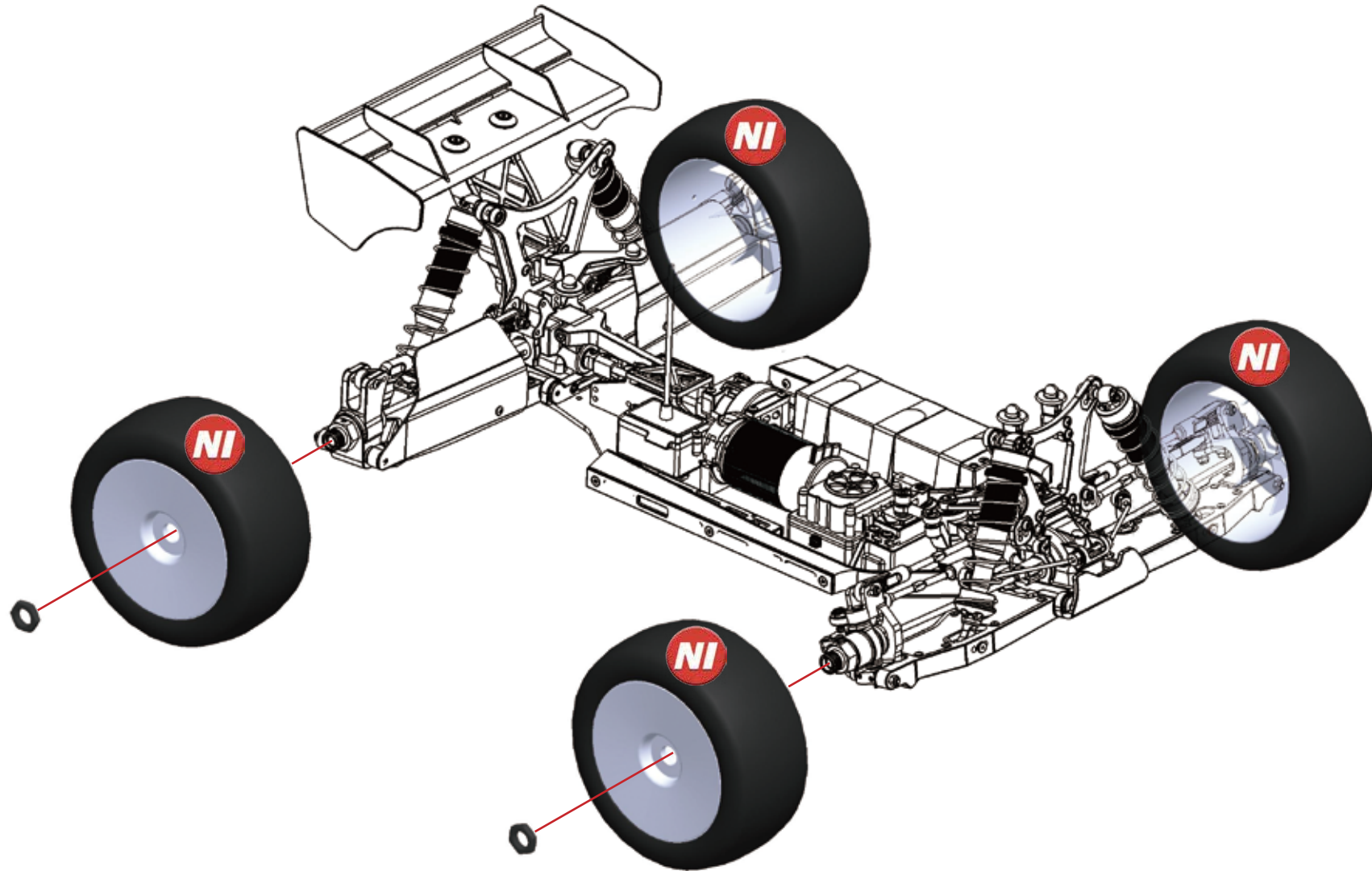

STEP 54

1- Cut the body along the cutting line with special scissors (not included). Make holes for the bodypost and antenna as needed with a body reamer (not included). Make a longer bodypost hole in the rear, to allow for chassis flex movement.

2- Before painting the body, apply the pre-cut masking sheet elements to the inside of the body. Follow the cleaning & painting instructions supplied by the polycarbonate paint supplier you choose.

3- Apply the Serpent and Cobra logo-decals on the body and wing.

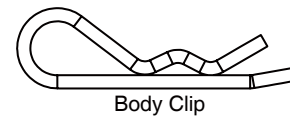
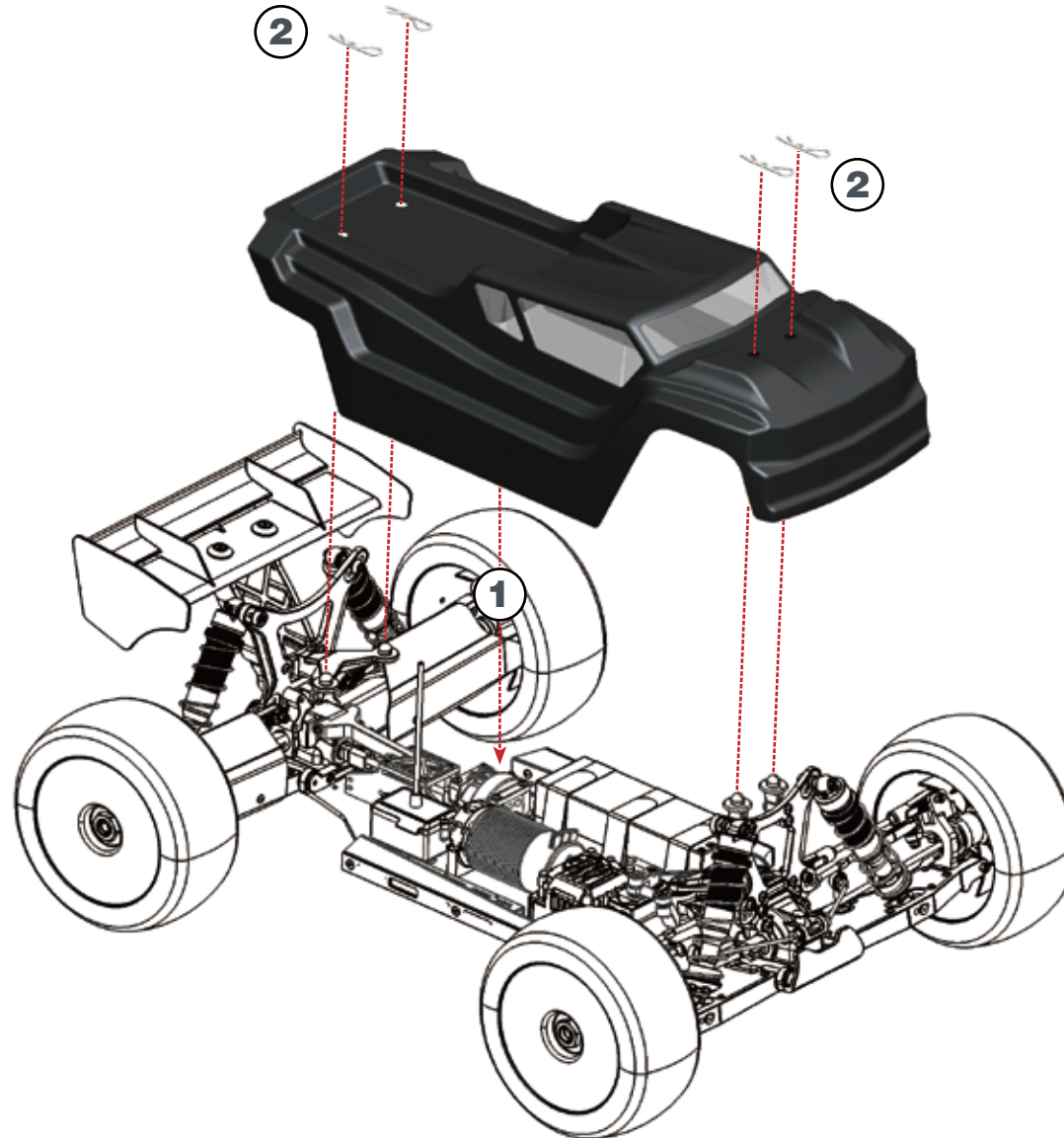

Body Clip

INDEX

<i>DIFFERENTIALS EXPLODED VIEW</i>	<i>38</i>
<i>REAR EXPLODED VIEW</i>	<i>39</i>
<i>FRONT EXPLODED VIEW</i>	<i>40</i>
<i>ASSEMBLY INSTRUCTIONS</i>	<i>41</i>
<i>STEERING EXPLODED VIEW</i>	<i>42</i>
<i>SHOCKS EXPLODED VIEW</i>	<i>43</i>
<i>FINAL 1 EXPLODED VIEW</i>	<i>44</i>
<i>FINAL 2 EXPLODED VIEW</i>	<i>45</i>

REAR EXPLODED VIEW

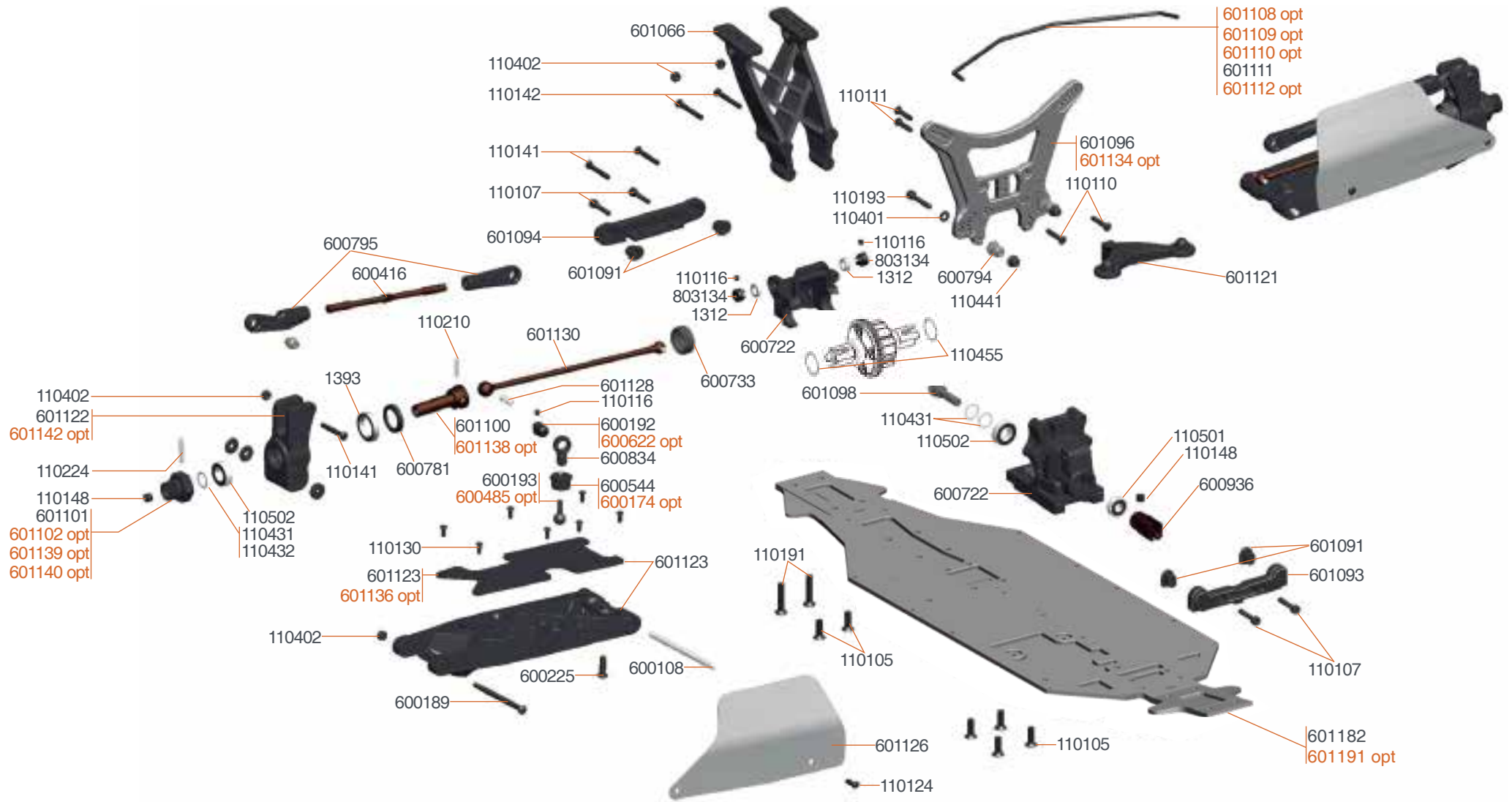

- 600174 Antirollbar nut (2)
- 600485 Pivotball threaded anti roll bar alu (2)
- 600622 Pivotball antirollbar alu (4)
- 600853 Gear coupler alu SRX8
- 601102 Wheelhexagon +1mm (2) SRX8T

- 601108 Antiroll bar rr 2.2mm SRX8T
- 601109 Antiroll bar rr 2.3mm SRX8T
- 601110 Antiroll bar rr 2.4mm SRX8T
- 601112 Antiroll bar rr 2.6mm SRX8T
- 601134 Shocktower rr carbon SRX8T

- 601138 Wheel axle alu (2) SRX8T
- 601139 Wheelhexagon 0mm light (2) SRX8T
- 601140 Wheelhexagon +1mm light (2) SRX8T
- 601142 Upright L+R alu SRX8T
- 601191 Chassis alu lightweight SRX8T-E

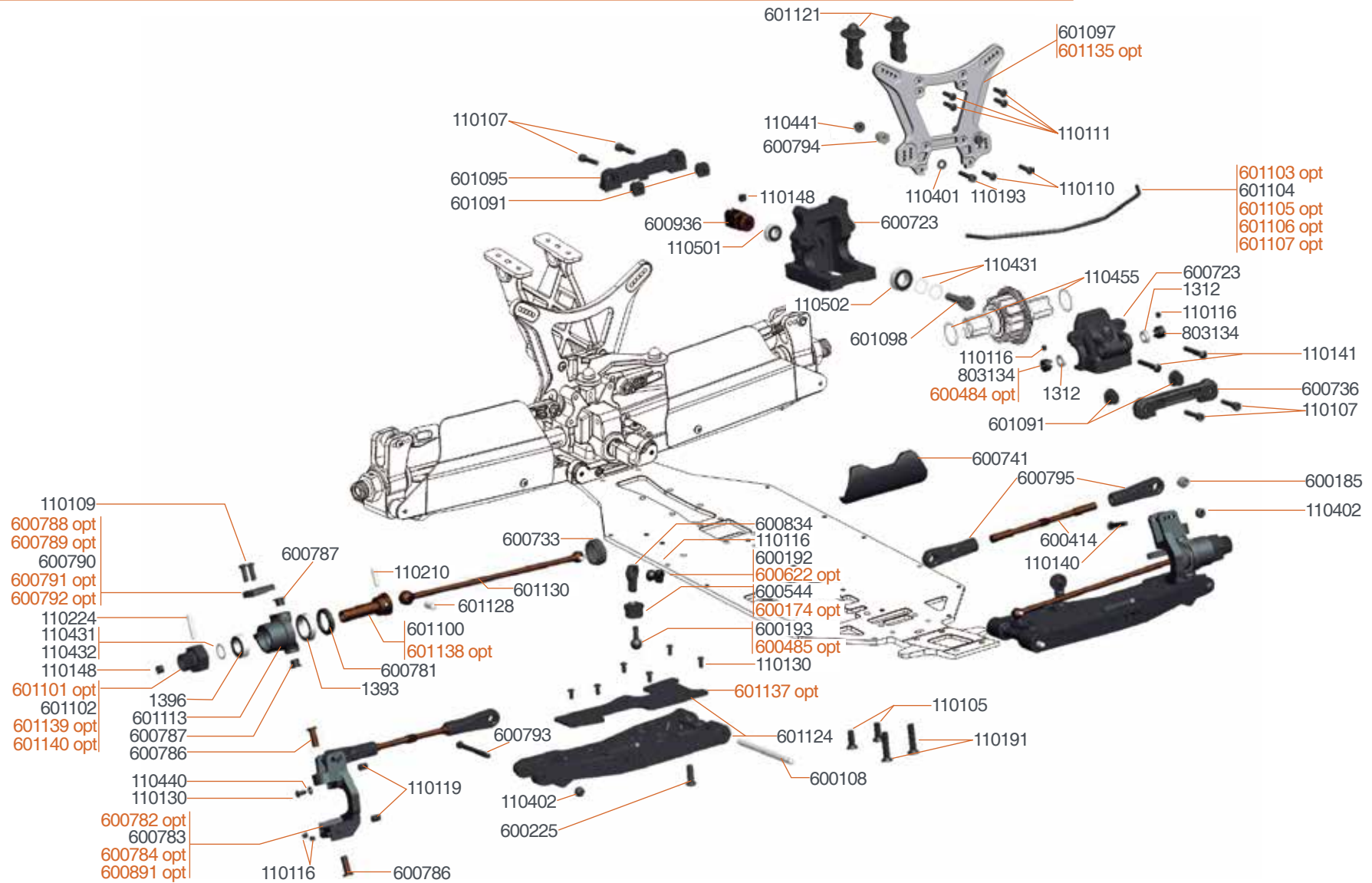

- 600174 Antirrollbar nut (2)
- 600484 Antirrollbar spacer 3mm alu (2)
- 600485 Pivotball threaded anti roll bar alu (2)
- 600622 Pivotball antirrollbar alu (4)
- 600782 C-hub 13deg L+R alu SRX8
- 600784 C-hub 17deg L+R alu SRX8
- 600788 Steering arm 0 carbon (2) SRX8

- 600789 Steering arm 1 carbon (2) SRX8
- 600791 Steering arm 3 carbon (2) SRX8
- 600792 Steering arm 4 carbon (2) SRX8
- 600891 C-hub 19deg L+R alu SRX8
- 601101 Wheelhexagon 0mm (2) SRX8T
- 601103 Antirroll bar fr 2.2mm SRX8T
- 601105 Antirroll bar fr 2.4mm SRX8T

- 601106 Antirroll bar fr 2.5mm SRX8T
- 601107 Antirroll bar fr 2.6mm SRX8T
- 601135 Shocktower fr carbon SRX8T
- 601137 Wishbone insert carbon fr SRX8T (2)
- 601138 Wheel axle alu (2) SRX8T
- 601139 Wheelhexagon 0mm light (2) SRX8T
- 601140 Wheelhexagon +1mm light (2) SRX8T



601185 Body support set SRX8T-E

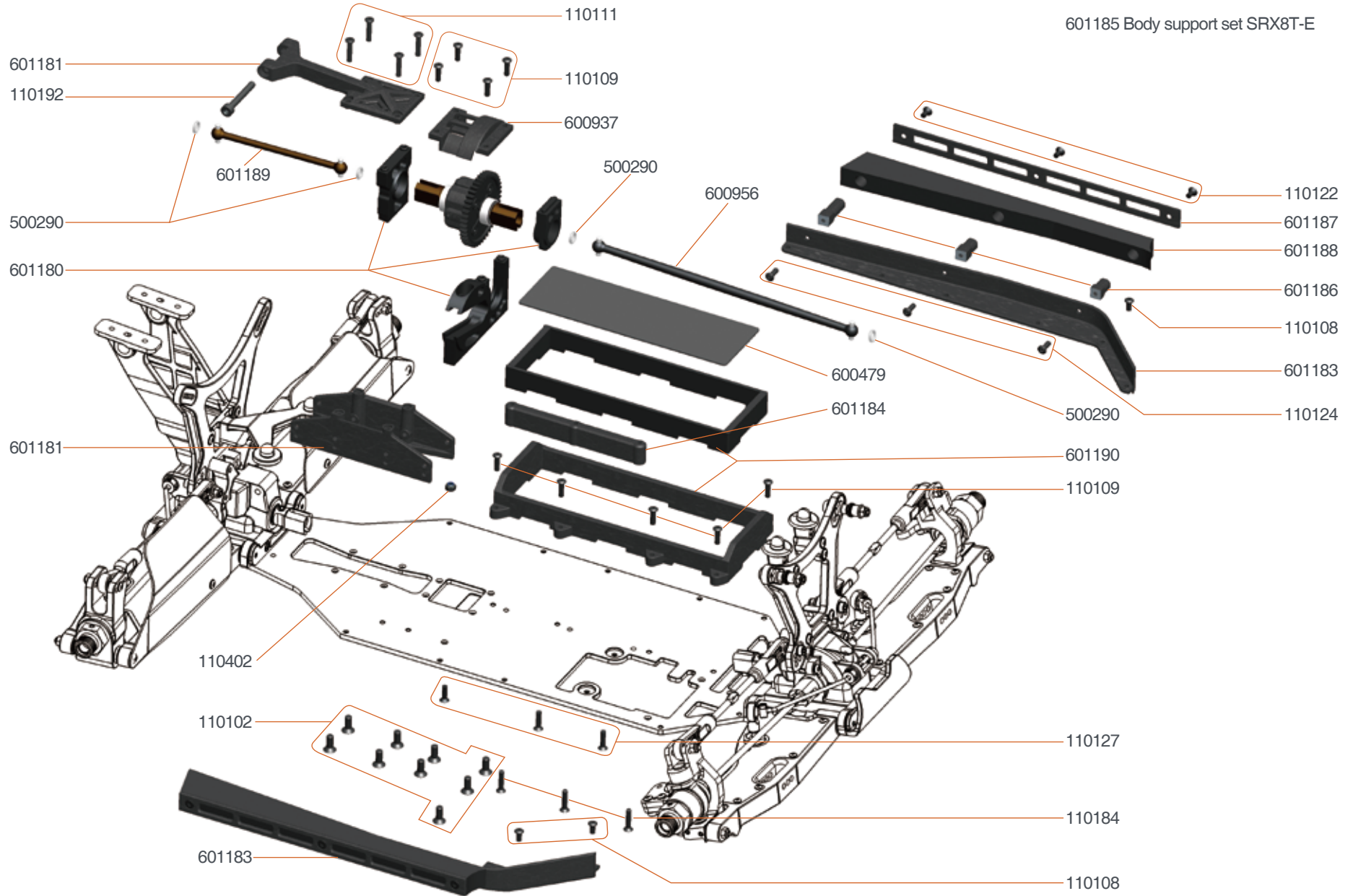

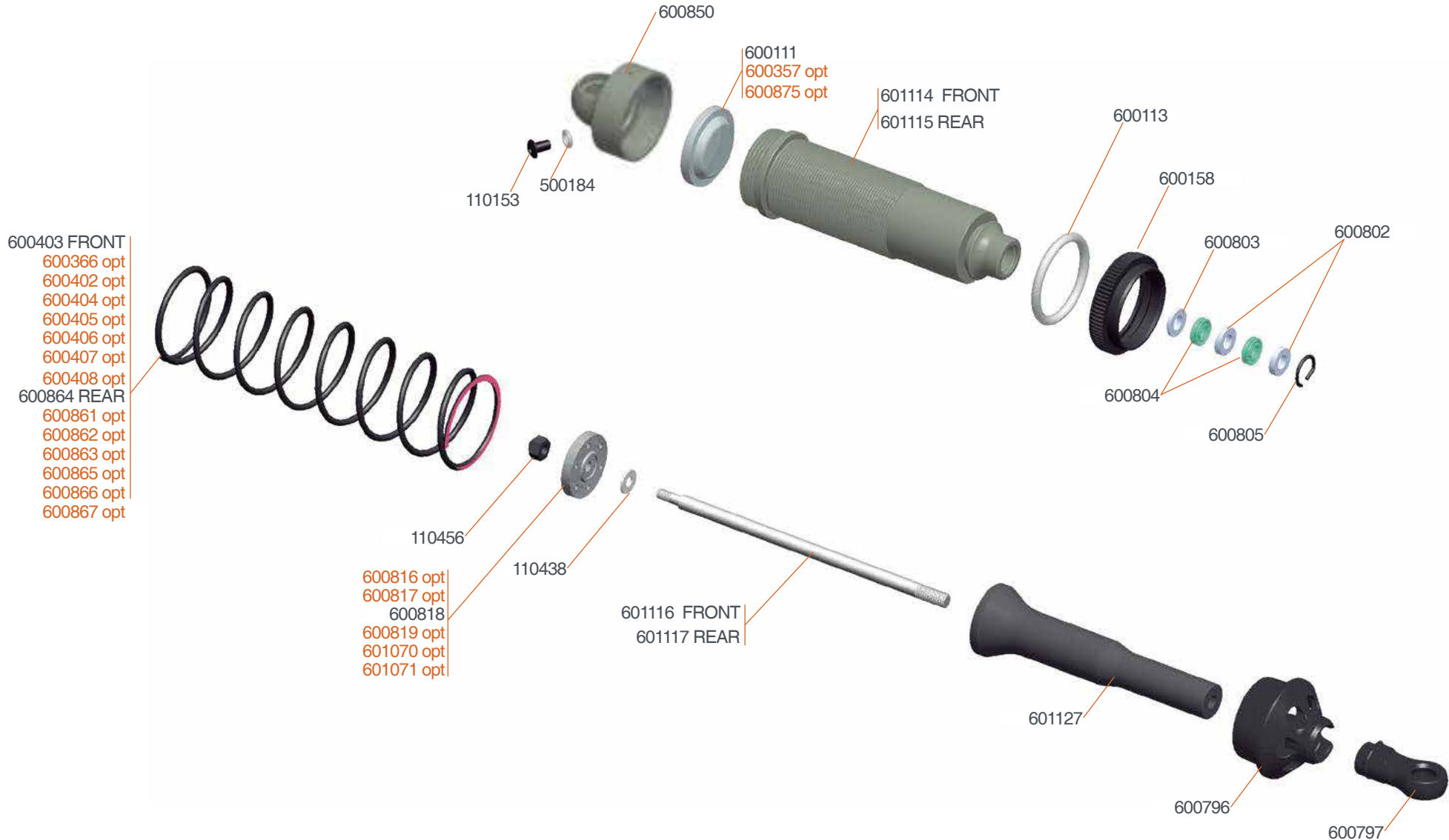

- 600357 Membrane webbed silicone (4)
- 600861 Shockspring RR 3.0 lbs orange (2)
- 600862 Shockspring RR 3.2 lbs red (2)
- 600865 Shockspring RR 3.8 lbs purple (2)
- 600866 Shockspring RR 4.0 lbs green (2)
- 600867 Shockspring set RR (6x2)

- 600366 Spring set FR Truggy (7x2)
- 600402 Spring set FR Pink 4,8lbs (2)
- 600404 Spring set FR Purple 5.2 lbs (2)
- 600405 Spring set FR Green 5,4 lbs (2)
- 600406 Spring set FR Gray 5,6 lbs (2)
- 600407 Spring set FR Yellow 5.8 lbs (2)

- 600408 Spring set FR White 6.0 lbs (2)
- 600816 Shock piston blank (4) SRX8
- 600817 Shock piston 5 holes (4) SRX8
- 600819 Shock piston 8 holes (4) SRX8
- 600875 Shock top gasket (4) SRX8
- 600863 Shockspring RR pink 3.4lbs (2)

- 601070 Shock piston angled 1.2mm 8holes (4) SRX8
- 601071 Shock piston angled 1.3mm 8holes (4) SRX8



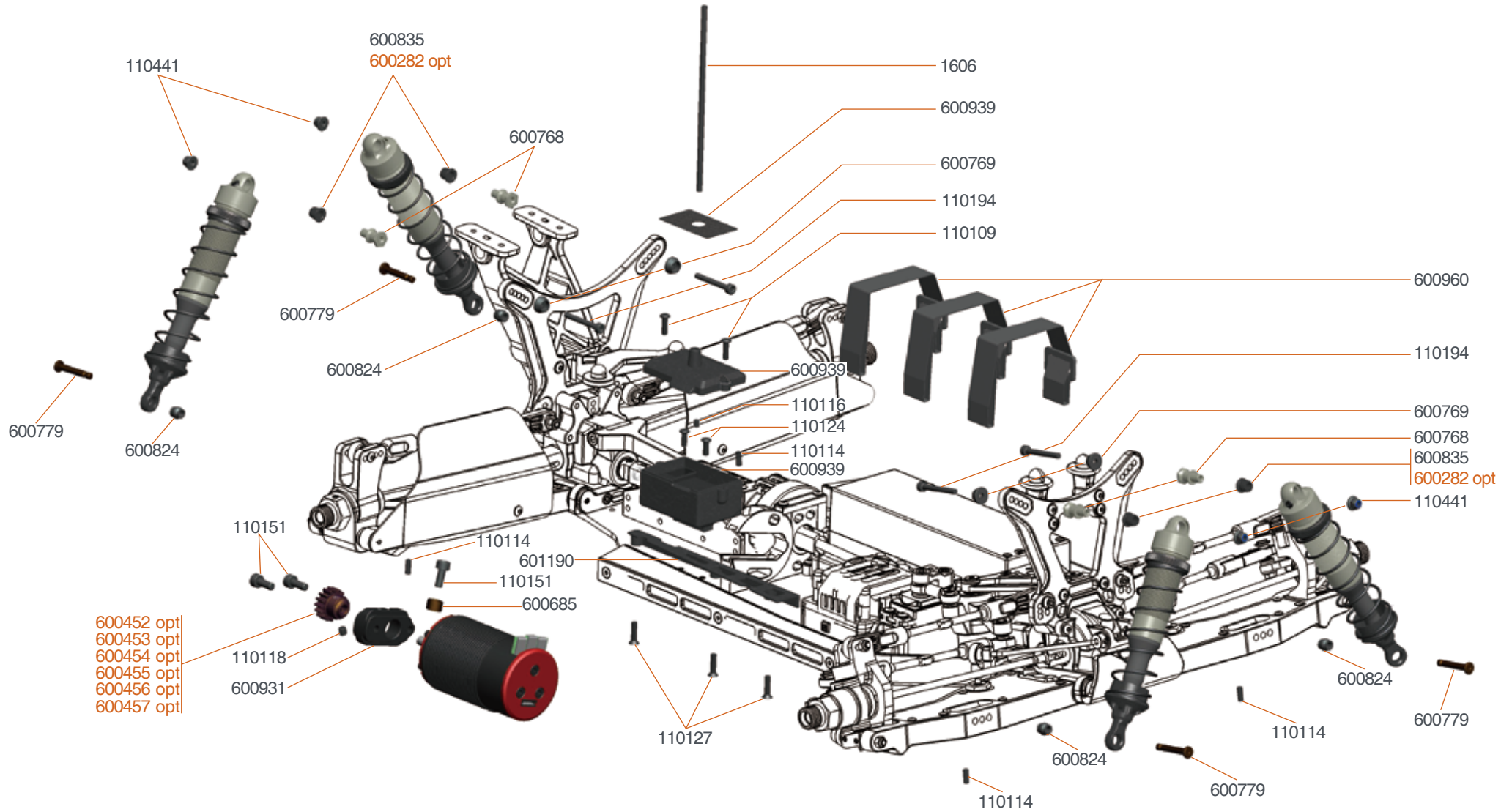

600282 Shock-pivot bushing delrin (4)
600452 Pinion 12T
600453 Pinion 13T

600454 Pinion 14T
600455 Pinion 15T
600456 Pinion 16T

600457 Pinion 17T

FINAL 2 EXPLODED VIEW

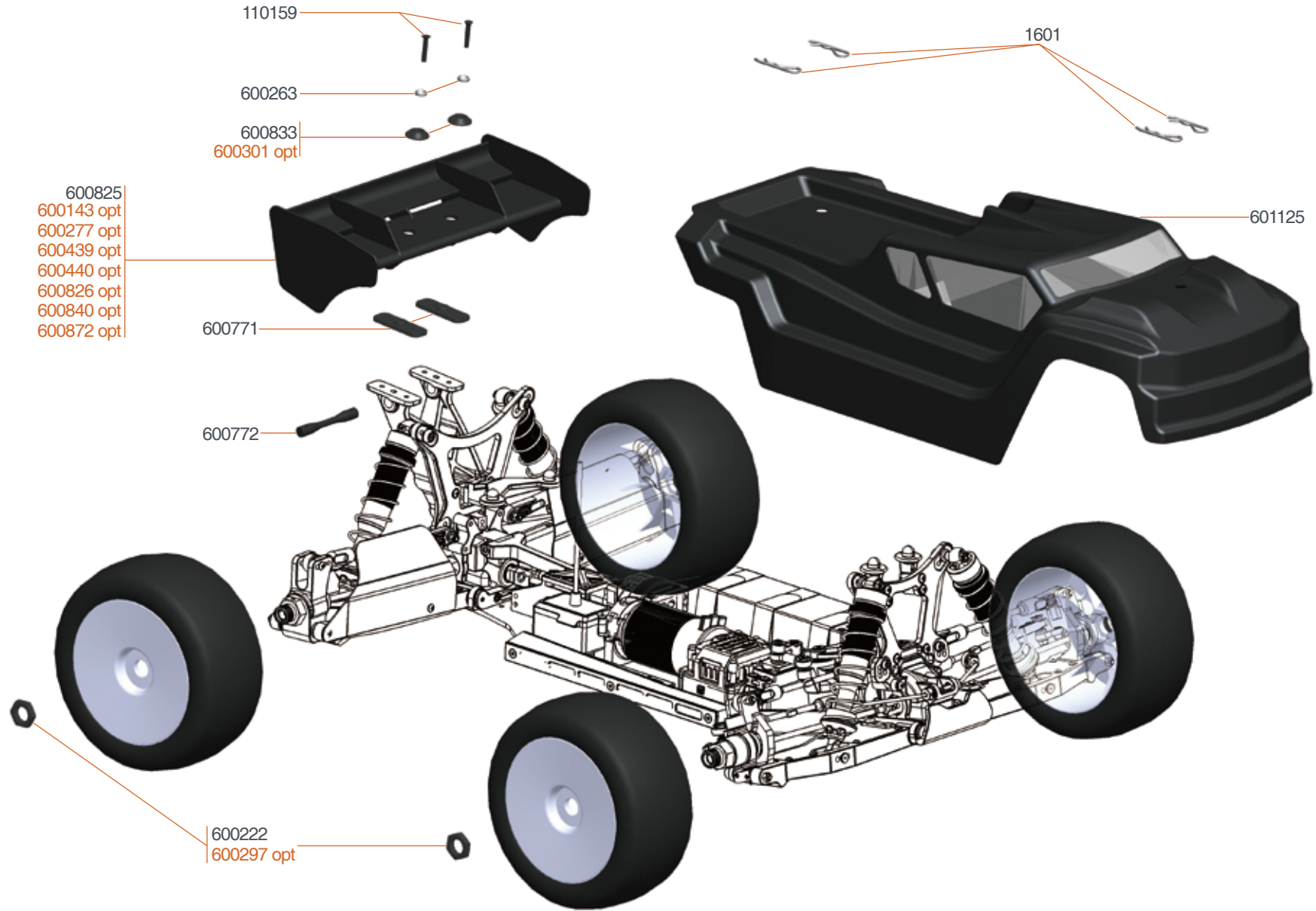

600143 Wing white nylon
 600277 Wing black nylon
 600297 Wheelnut light 17mm (4)

600301 Wing washer alu (2)
 600439 Wing white low 811
 600440 Wing black low 811

600826 Wing straight MD white 1/8
 600840 Wing lexan HD with gurney 1/8
 600872 Wing gurney

TEAM SERPENT NETWORK

SRX8 TRUGGY SPARE PARTS www.serpent.com/600064/spares/



SRX8 TRUGGY OPTIONALS PARTS www.serpent.com/600064/Optionals/



SERPENT TOOLS www.serpent.com/product/Tools/



SERPENT MERCHANDISING www.serpent.com/product/Merchandising/



SERPENT WEBSITE AND BLOG

www.serpent.com
www.teamserpent.com
www.dragon-rc.com

SERPENT PROMO PAGES <http://promo.serpent.com>

SERPENT FACEBOOK GROUPS <http://promo.serpent.com/indexfb.htm>

SERPENT ADVANCED MANUALS <http://promo.serpent.com/sam/>

SERPENT SOCIAL MEDIA



www.facebook.com/SerpentMRC



www.youtube.com/user/SerpentMRC



www.twitter.com/SerpentMRC



www.plus.google.com/+SerpentModelcars/posts



www.weibo.com/teamserpent

INSTRUCTION MANUAL

TRUGGY SRX8E



Manual SRX8T-e #83245-1

SERPENT