

EXECUTE
1/10 SPORT FWD MINI TOURING CAR **FM1S**

INSTRUCTION MANUAL

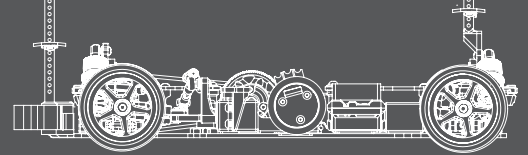

Bag A , HW A , HW B , HW K

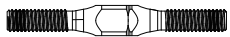

Turnbuckle M3 x 29mm
XP-10156



Turnbuckle M3 x 18mm
XP-10157

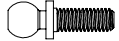

4.8mm Ball End 8mm Thread
XP-10150

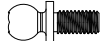

4.8mm Ball End 6mm Thread
XP-10149



4.8mm Ball End 5mm Thread
XP-10148

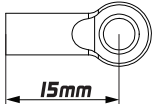

4.8mm Flat Type Ball End 15mm
XP-10251 Optional XP-10636

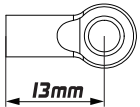

4.8mm Flat Type Ball End 13mm
XP-10252 Optional XP-10635

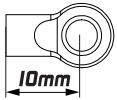

4.8mm Flat Type Ball End 10mm
XP-10253 Optional XP-10634



Anti-Roll Bar Connector
XP-10282



Hex Set Screw M3 x 10mm
XP-40055

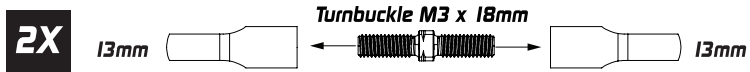

For Rear Camber Link

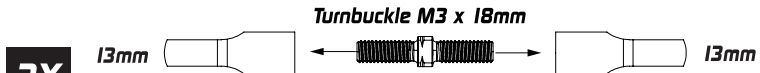
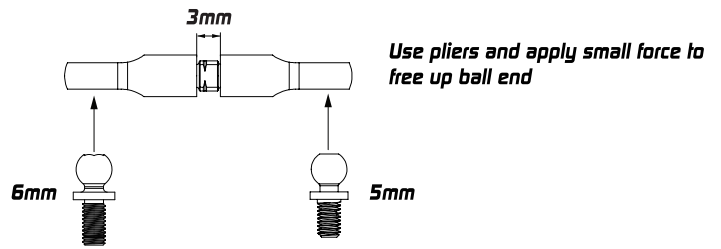

For Front Camber Link

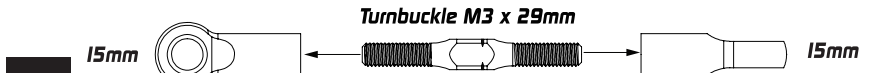
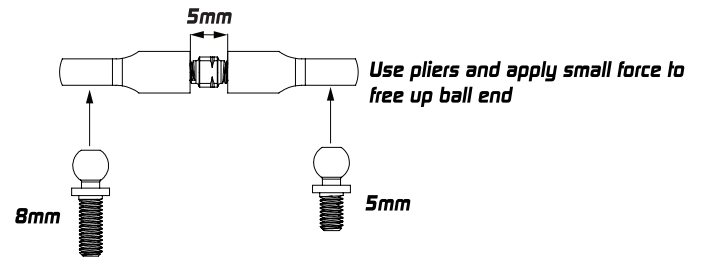

For Steering

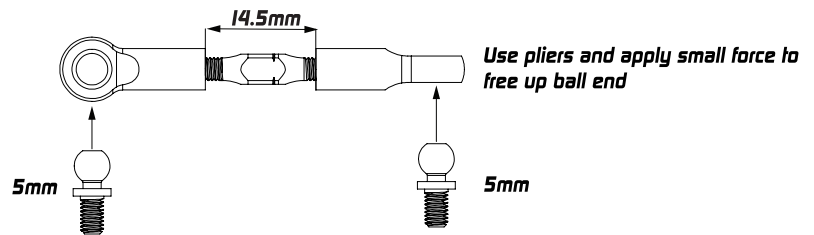

For Servo

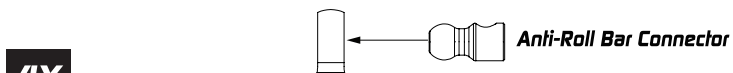
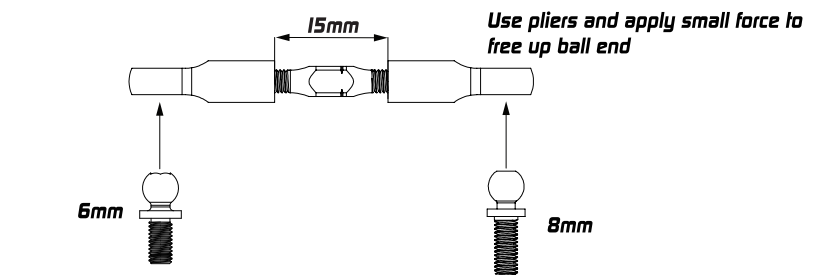

For Anti-Roll Bar

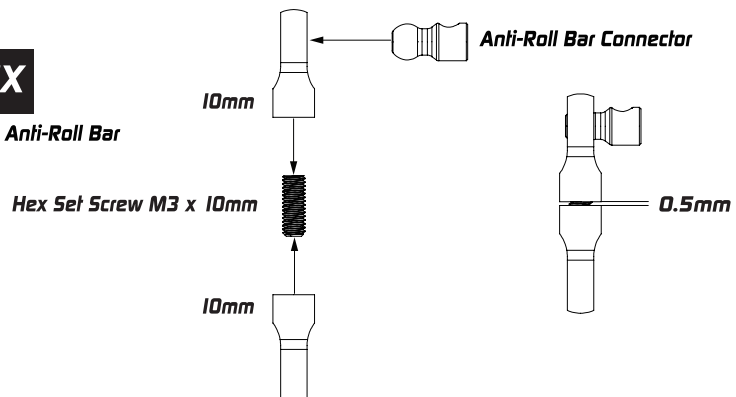

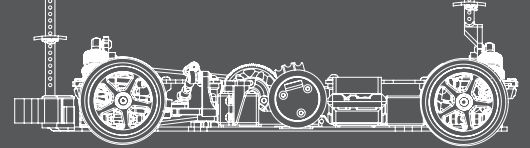

Bag B , HW H and HW J

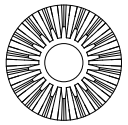

Bevel Gears 18T
XP-10009



Bevel Gears 10T
XP-10009

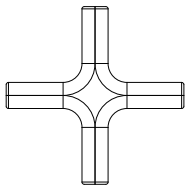

Gear Diff Cross Pin
XP-10009

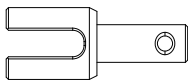

Steel Gear Diff Outdrive Adapter
XP-10288
Optional XP-10125

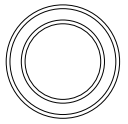

Bearing 10 x 15 x 4mm
XP-40065



O-ring 5 x 2mm
XP-10184



Pin 2 x 9.8mm
XP-40069

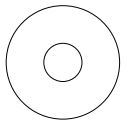

Spacer 5 x 15 x 0.4mm
XP-10181



Spacer 3.6 x 9.5 x 0.2mm
XP-10182



Flat Head Screw M2.5 x 8mm
XP-40044

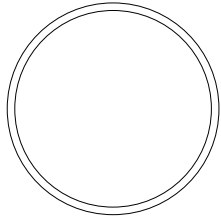

O-ring 25 x 1mm
XP-10183

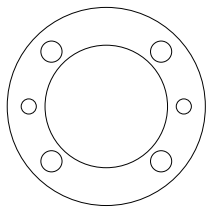

Diff Gasket
XP-10179

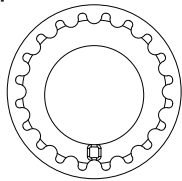

Composite Adjustment
Ball-Bearing Hub
XP-10107

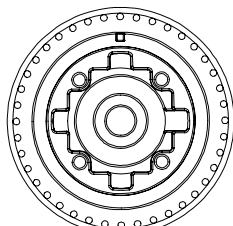

Gear Differential Case
XP-10008

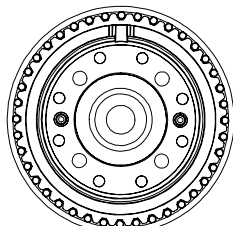

Gear Differential Cover
XP-10008

Optional



Silicone Gear Differential X-RING 5x2mm
XP-10600

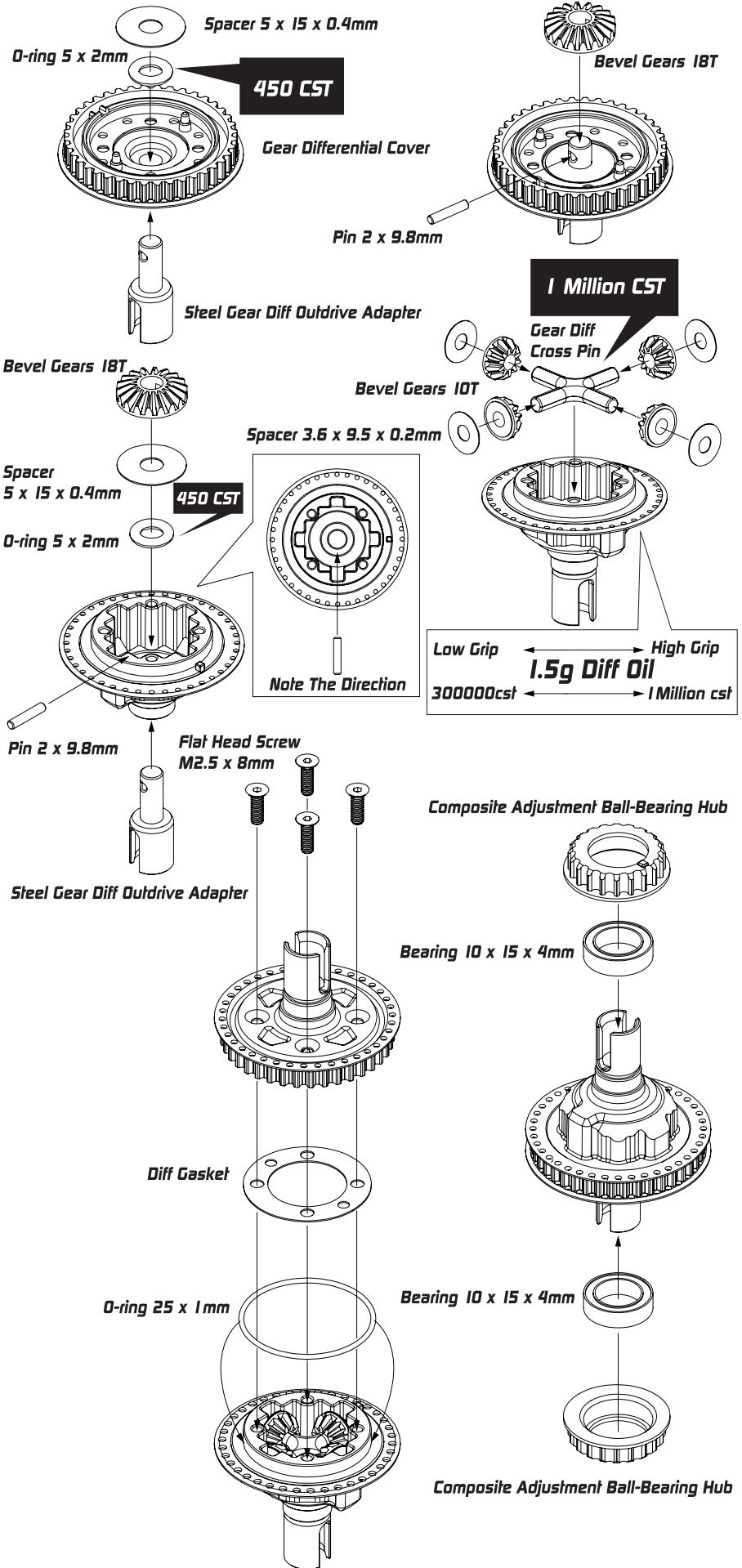

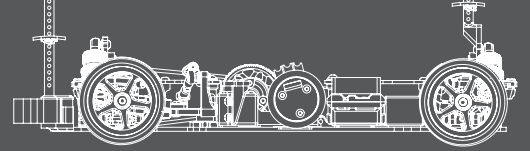

Bag C, HW C, HW H, HW K

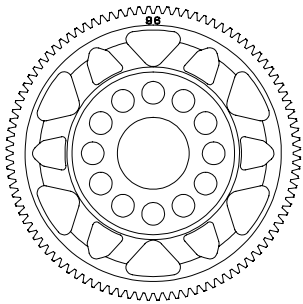

Spur Gear 64P 96T
XP-40082

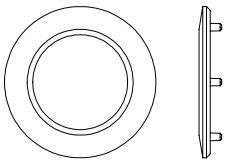

Center Pulley Cover
XP-10644

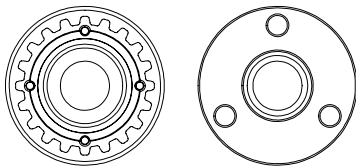

Center Pulley A
XP-10644 Optional XP-10629

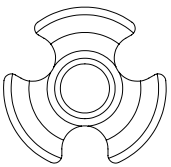

Spur Gear Adaptor
XP-10688

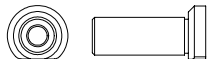

Center Pulley Post 13.5mm
XP-10698



Round Head Screw RM3 x 6mm
XP-40037



Bearing 5 x 8 x 2.5mm
XP-40061



Bearing 5 x 10 x 3mm
XP-40063

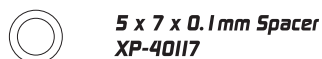

5 x 7 x 0.1mm Spacer
XP-40117



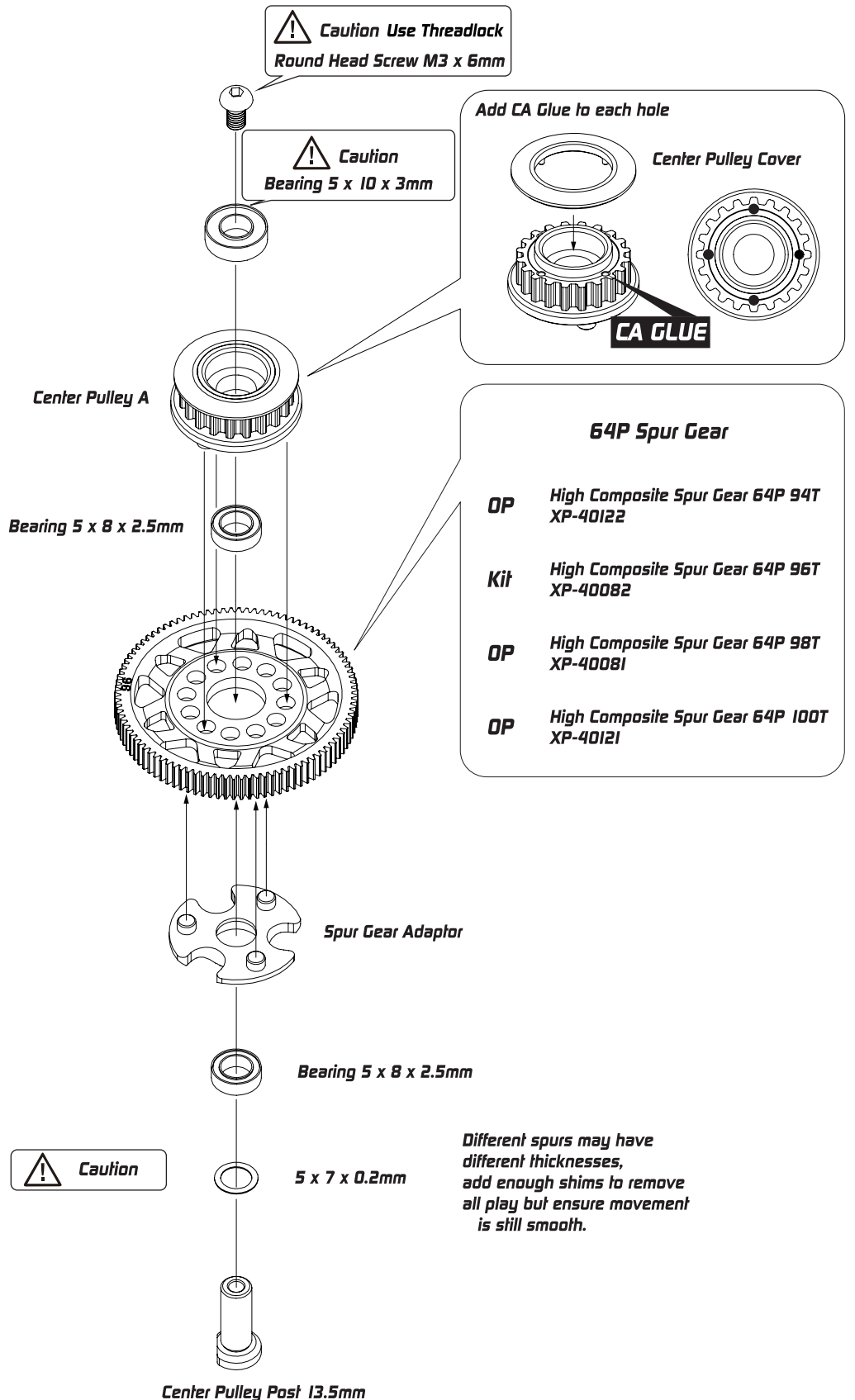

5 x 7 x 0.2mm Spacer
XP-40086

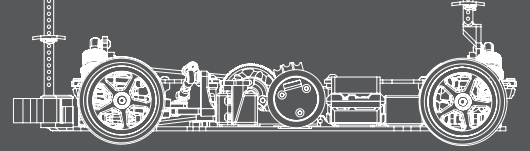



Bag D, E, I, J and FRP, HW H, K

-  **Battery Stopper**
XP-10180
-  **Bearing 3 x 6 x 2.5mm**
XP-40060
-  **Spacer 3 x 5 x 0.2mm**
XP-40066

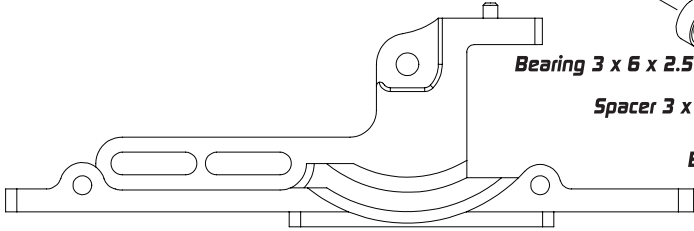

Motor Mount XP-10687

Flat Head Screw FM3 x 12mm

Spacer 3 x 5 x 0.2mm

Bearing 3 x 6 x 2.5mm

Spacer 3 x 5 x 0.2mm

Bearing 3 x 6 x 2.5mm

Spacer 3 x 5 x 0.2mm

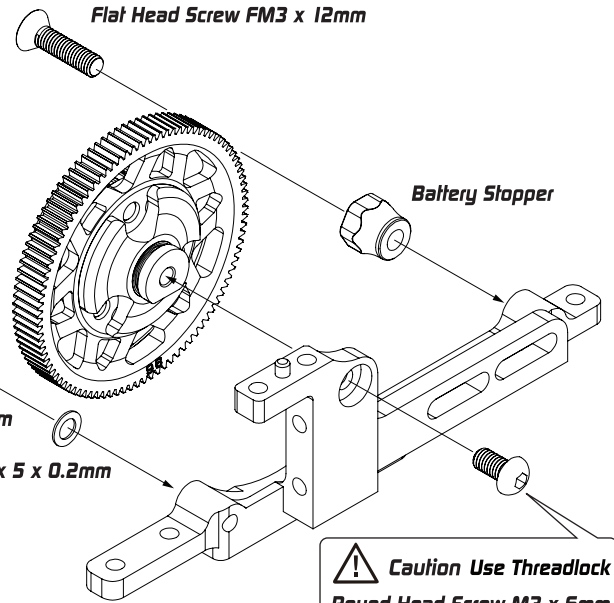

Flat Head Screw FM3 x 12mm

Battery Stopper

Caution Use Threadlock
Round Head Screw M3 x 6mm

Flat Head Screw FM3 x 12mm
XP-40050

Caution
Please Note The Direction

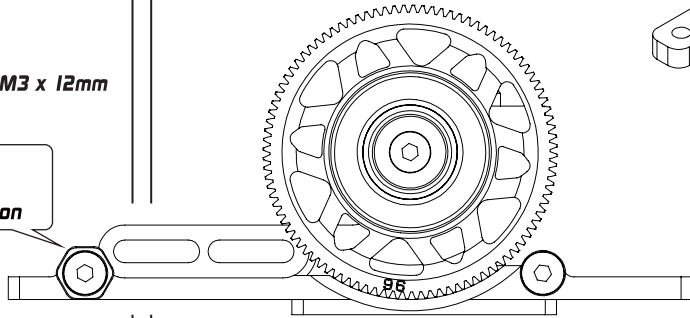

Flat Head Screw FM3 x 6mm

FRP 3.0mm Servo Mount Plate
Flat Head Screw FM3 x 6mm

Round Head Screw RM3 x 6mm
XP-40037

Round Head Screw RM3 x 8mm
XP-40038

Round Head Screw RM3x10mm
XP-40039

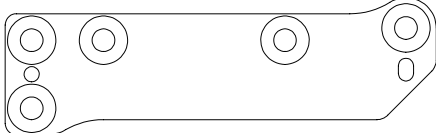

FRP 3.0mm Servo Mount Plate
XP-10729 Optional XP-10743

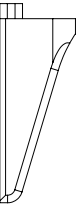

Composite Side Servo Mount
XP-10741 Optional XP-10727

FRP 4.0mm Servo Mount Spacer
XP-10734

3 x 5.5 x 1mm Composite Spacer
XP-10740
Optional XP-10240

4.8mm Ball End 8mm Thread

Caution
From Servo Link

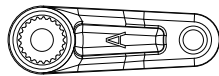

Servo Horn 23T for Sanwa, KO
XP-10163

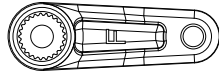

Servo Horn 25T for Futaba
XP-10163



Flat Head Screw FM3 x 6mm
XP-40046

FRP 4.0mm Servo Mount Spacer

Round Head Screw
RM3x10mm

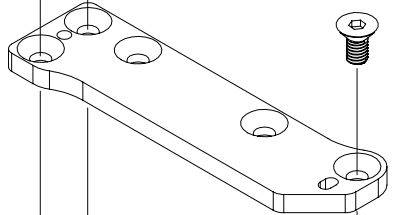

Composite Side Servo Mount

Round Head Screw RM3 x 6mm

No Electronics are included

Round Head Screw RM3 x 8mm

Servo Horn

Round Head Screw RM3 x 6mm

Round Head Screw RM3 x 8mm

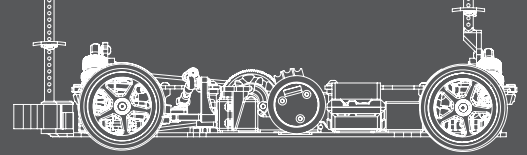

Bag E, G and FRP, HW H and K

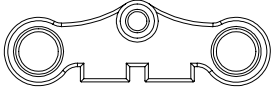

Optional XP-10113

Composite Steering Plate For Dual Servo Saver XP-10740

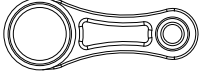

Optional XP-10111

Composite Dual Servo Saver Arm XP-10740



Bearing 5 x 8 x 2.5mm XP-40061



Bearing 3 x 6 x 2.5mm XP-40060



Round Head Screw RM3 x 6mm XP-40037



Flat Head Screw FM3 x 6mm XP-40046

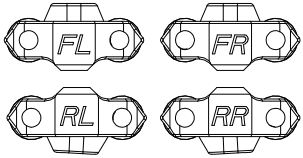

Composite Lower 2-Piece Suspension Holder FL, FR, RL, RR XP-10260

Optional

Diagonal Offset

Use either 0.5 or 1 mm to shift the roll center in a diagonal direction from the center.

4X

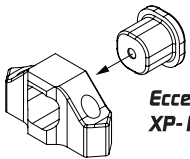

Eccentric Bushing Set XP-10127

Alu Lower 2-Piece Suspension Holder XP-10123

Horizontal Offset

Choice of either 0.5 or 1 mm offset from center

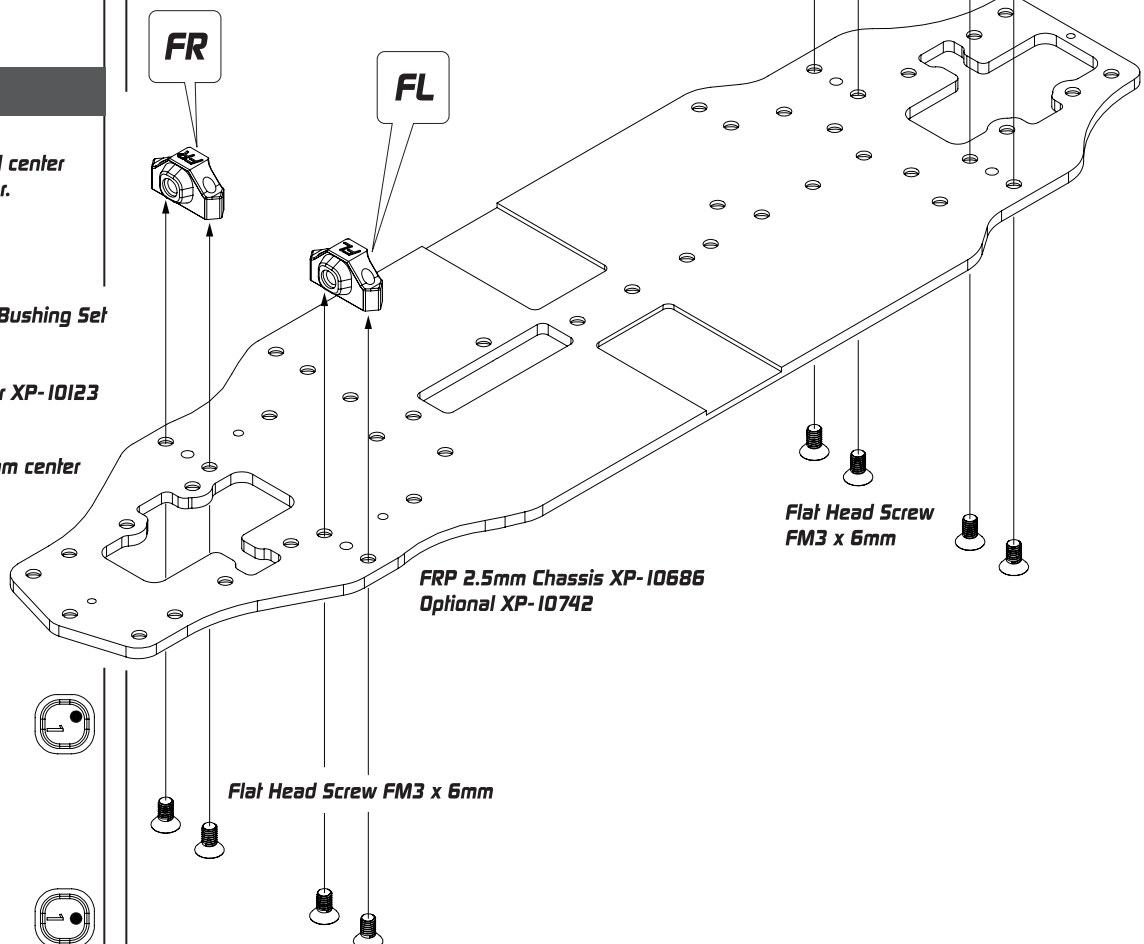
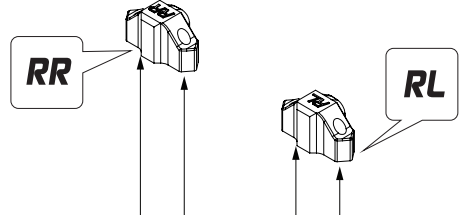
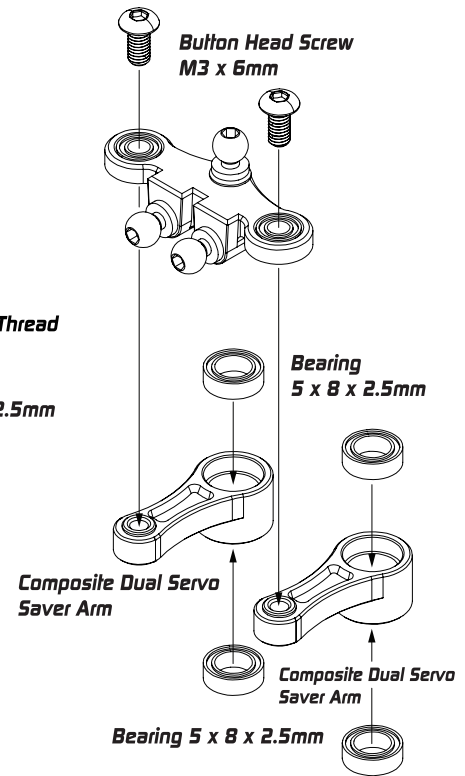
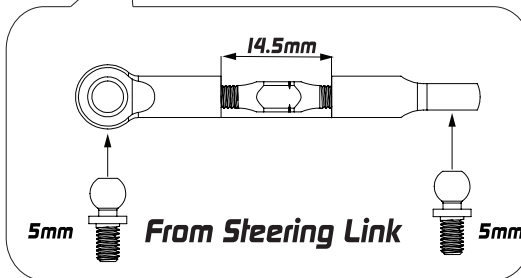
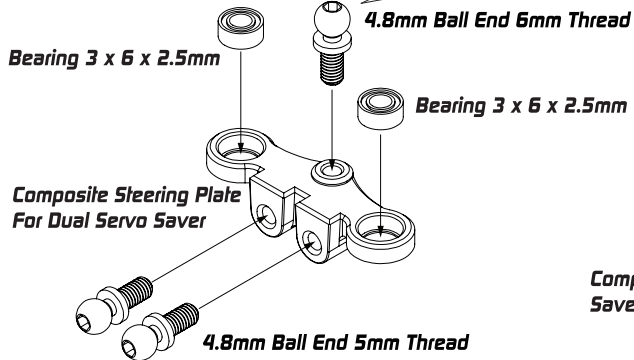
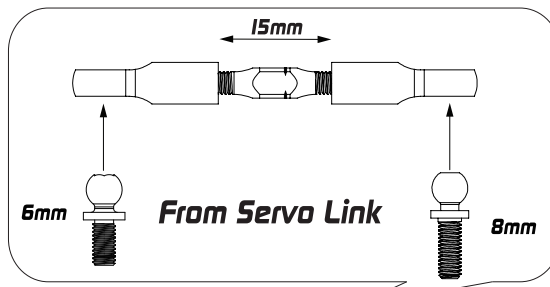
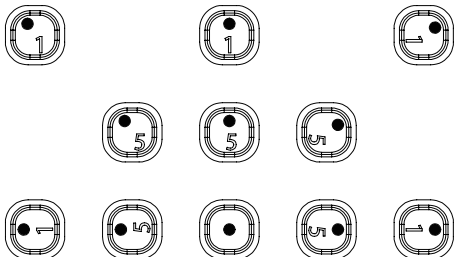

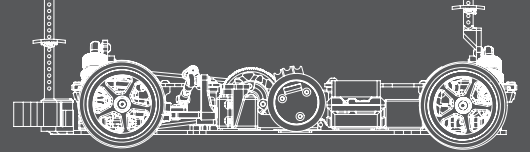

Bag F and HW K

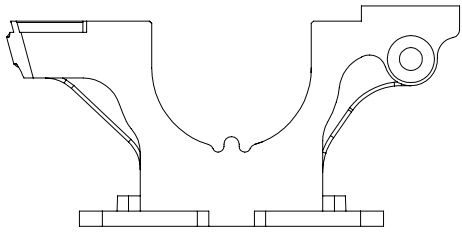

**Composite Lower Bulkhead
XP-10229**



**Flat Head Screw FM3 x 8mm
XP-40048**

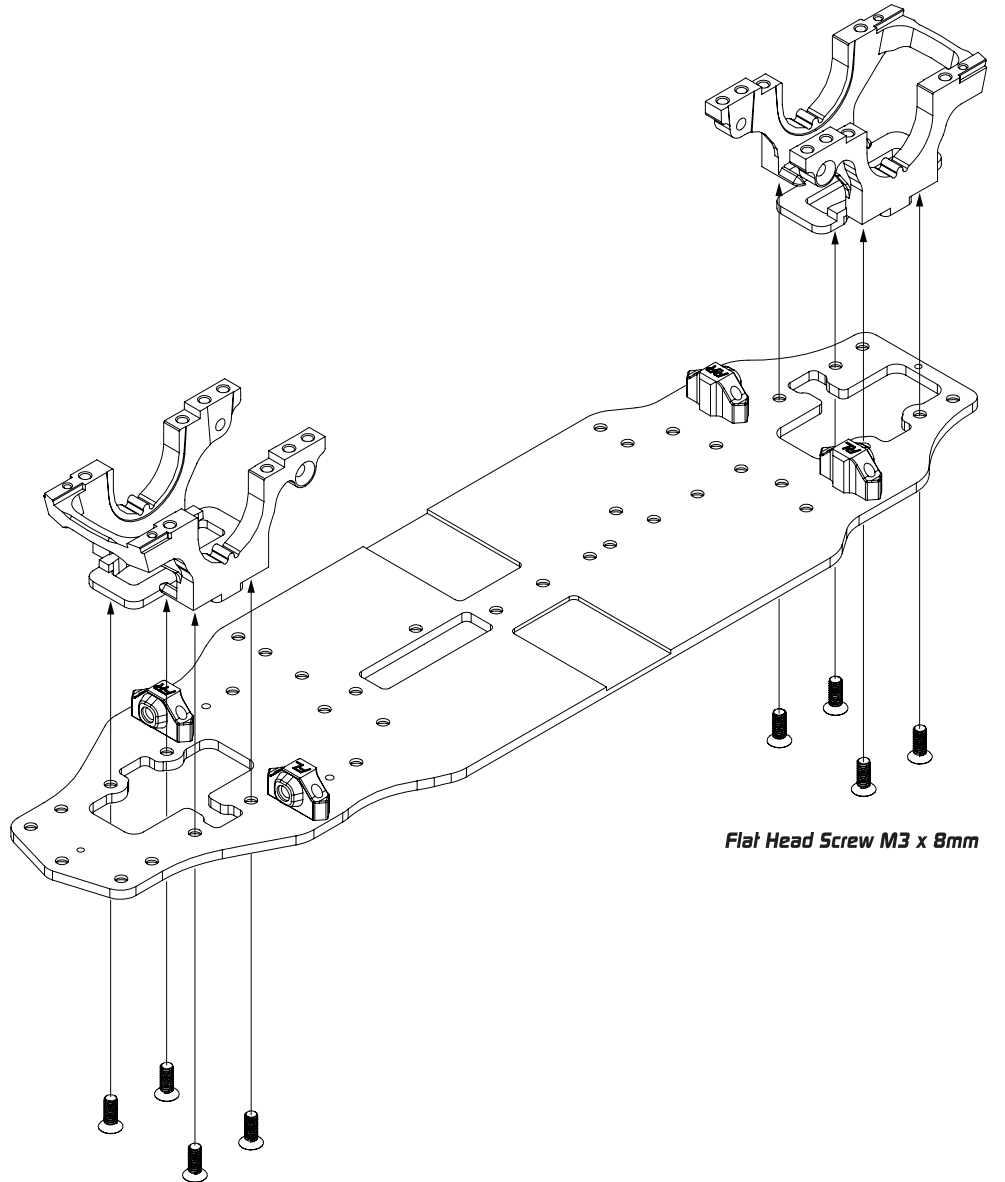

Flat Head Screw M3 x 8mm

Flat Head Screw M3 x 8mm

Optional

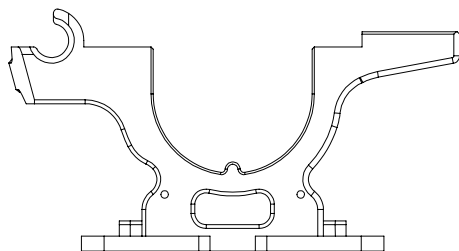
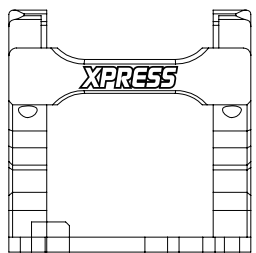

**Alu Lower Bulkhead
XP-10115**

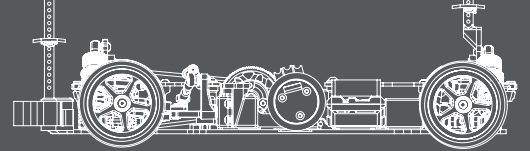

Bag F and HW D, E and K

 Flat Head Screw FM3 x 6mm
XP-40046

 Flat Head Screw FM3 x 8mm
XP-40048

 Flat Head Screw FM3 x 10mm
XP-40049

 Round Head Screw RM3 x 8mm
XP-40038

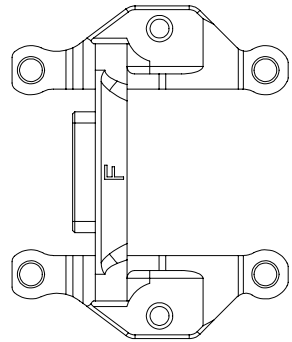

Composite One Piece Upper Clamp Front
XP-10230 Optional XP-10104

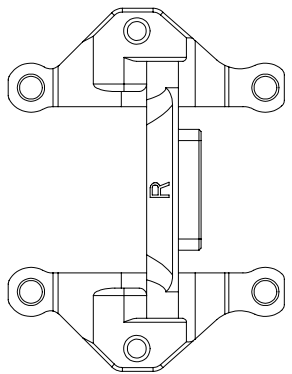

Composite One Piece Upper Clamp Rear
XP-10230 Optional XP-10130



Aluminum Center Post
XP-10259

Flat Head Screw
FM3 x 8mm

Default Diff Position

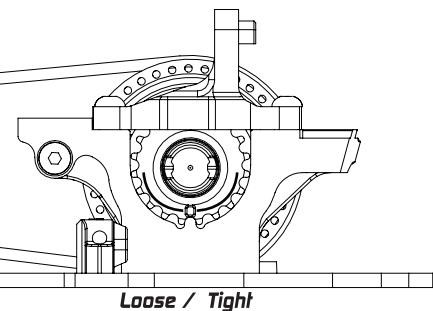

Loose / Tight

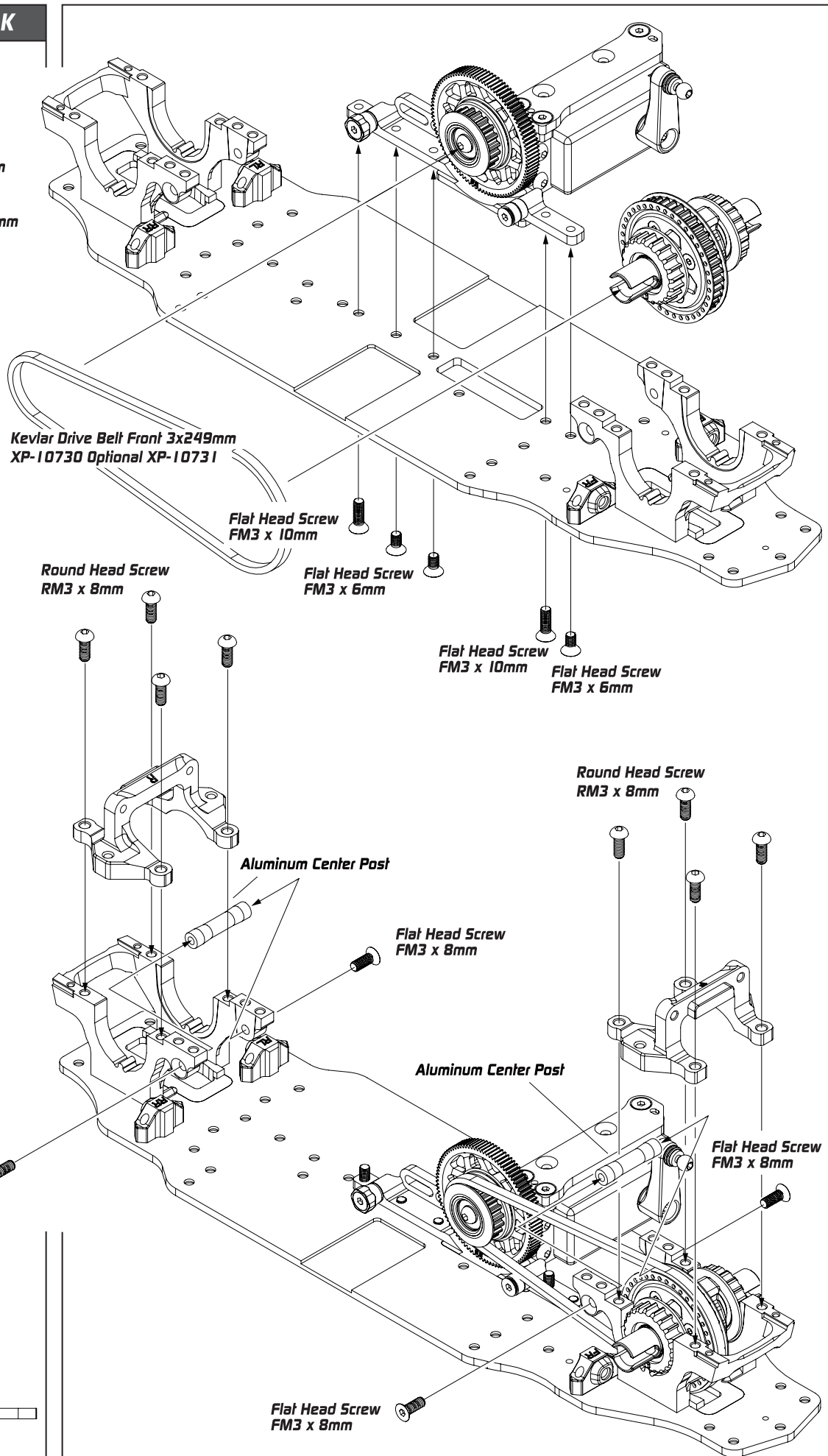

Kevlar Drive Belt Front 3x249mm
XP-10730 Optional XP-10731

Flat Head Screw
FM3 x 10mm

Round Head Screw
RM3 x 8mm

Flat Head Screw
FM3 x 6mm

Flat Head Screw
FM3 x 10mm

Flat Head Screw
FM3 x 6mm

Round Head Screw
RM3 x 8mm

Aluminum Center Post

Flat Head Screw
FM3 x 8mm

Aluminum Center Post

Flat Head Screw
FM3 x 8mm

Flat Head Screw
FM3 x 8mm

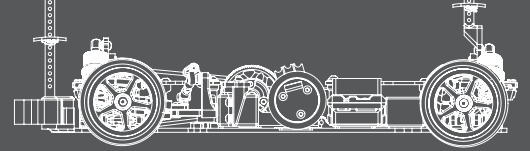

Bag E and HW K



Flat Head Screw FM3 x 6mm
XP-40046



Round Head Screw RM3 x 6mm
XP-40037



Composite Steering Post
For Dual Servo Saver 11.5mm
XP-10740

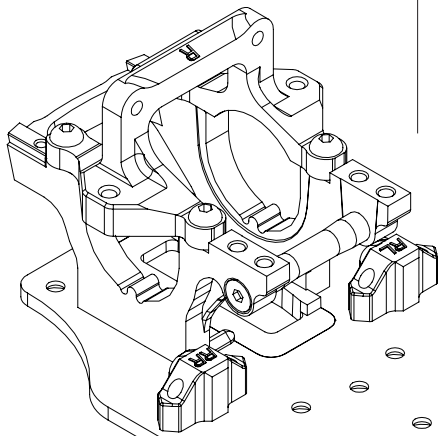

Round Head Screw RM3 x 6mm

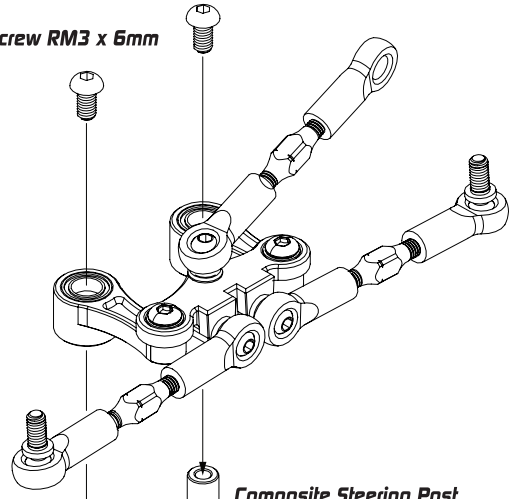

Composite Steering Post

Composite Steering Post

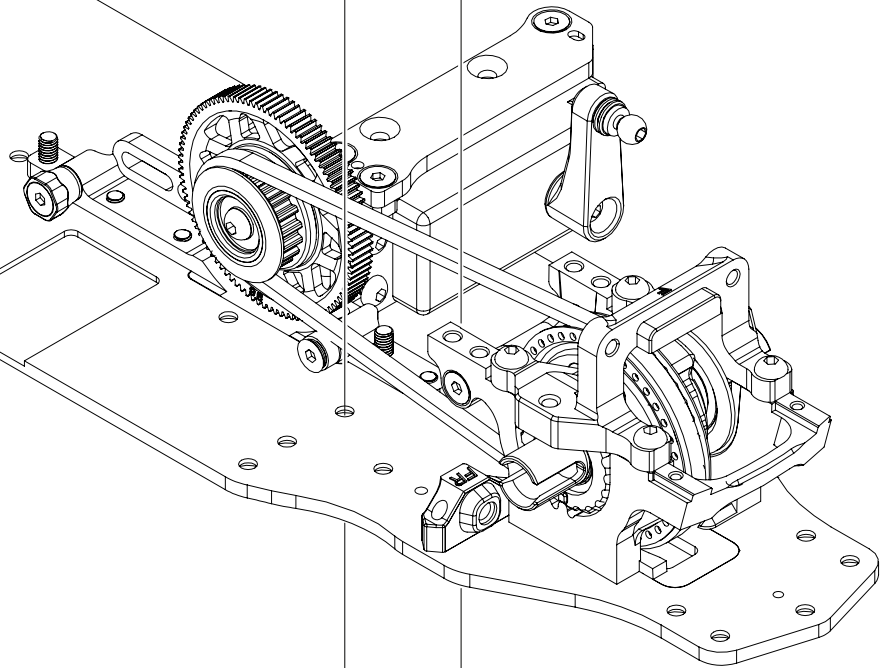

Flat Head Screw FM3 x 6mm

Optional



Aluminum Steering Post
For Dual Servo Saver 11.5mm
XP-10494

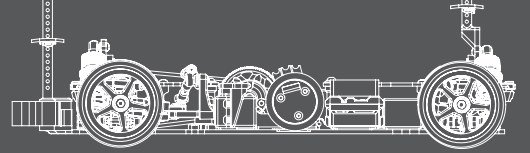

Bag F, I and FRP, HW C, H and K



Belt Tensioner
XP-10163



Bearing 3 x 6 x 2.5mm
XP-40060



Flanged Bearing 3 x 6 x 2.5mm
XP-40126



Spacer 3 x 5 x 0.2mm
XP-40066



Round Head Screw RM3 x 6mm
XP-40037



Round Head Screw RM3 x 8mm
XP-40038



Round Head Screw RM3 x 16mm
XP-40042



Nut 3 x 5.5mm
XP-40067



Composite Upper Deck Collar For Flex Elimination
XP-10739 Optional XP-10683

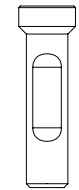

Motor Mount Post With Flange
XP-10738

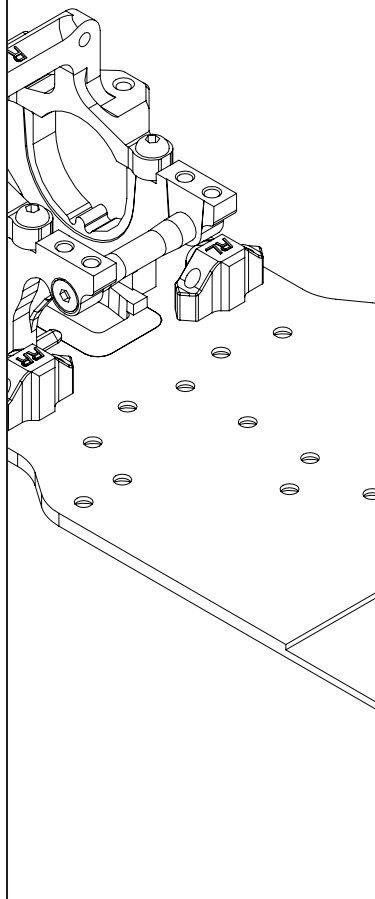

Round Head Screw M3 x 16mm

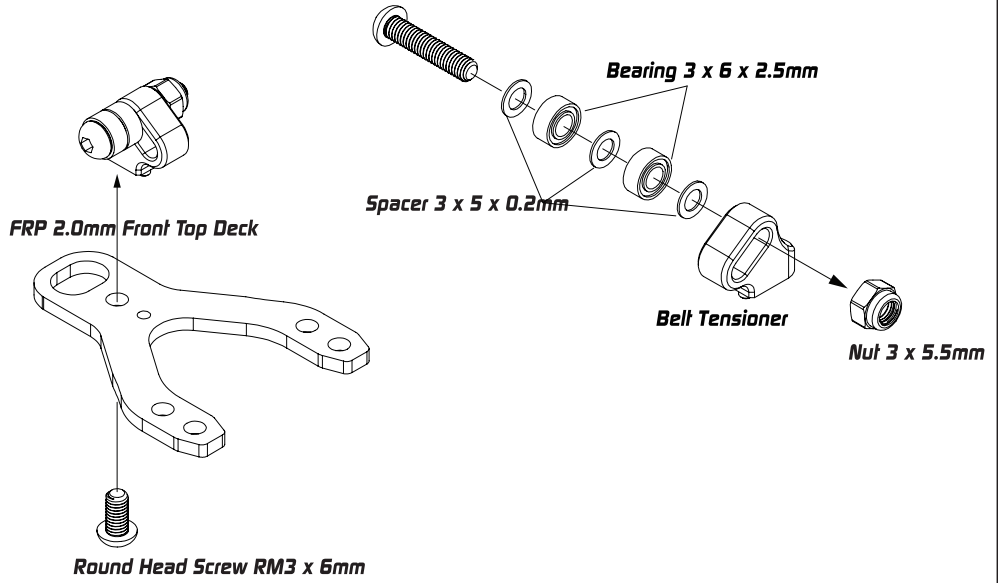

High Flex Setup (Default)

No Flex Setup

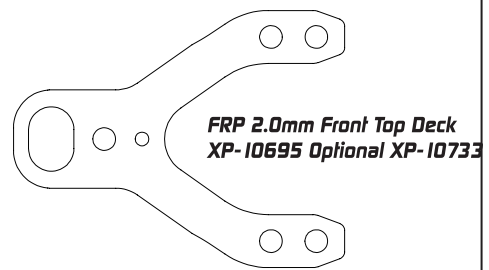
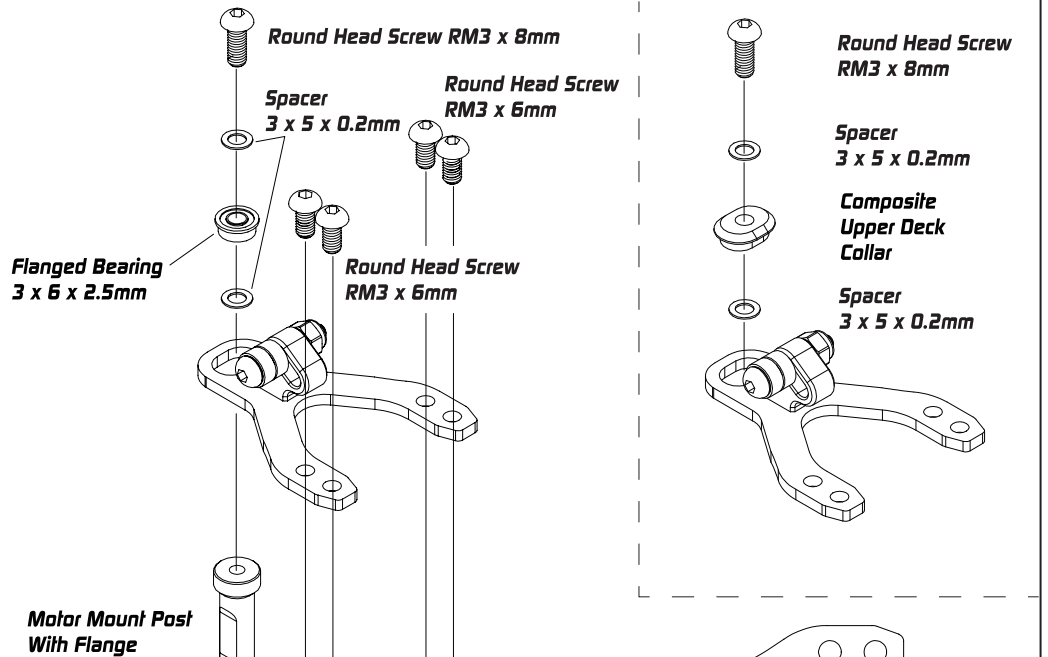

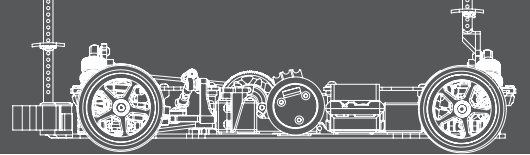

Bag F, I and FRP, HW C, H and K



Flanged Bearing 3 x 6 x 2.5mm
XP-40126



Spacer 3 x 5 x 0.2mm
XP-40066



Round Head Screw RM3 x 6mm
XP-40037



Round Head Screw RM3 x 8mm
XP-40038

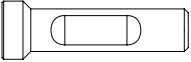

Motor Mount Post With Flange
XP-10738

Low Flex
Default Setup

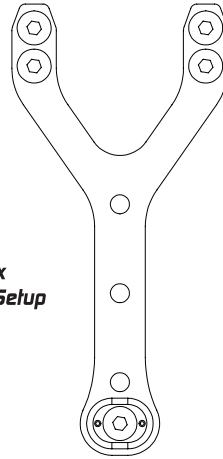

High Flex

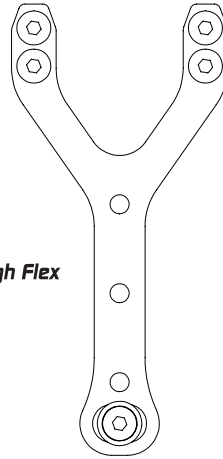

Low Flex Setup (Default)

High Flex Setup

Round Head Screw
RM3 x 6mm



Round Head Screw
RM3 x 8mm



Spacer
3 x 5 x 0.2mm



Composite Upper Deck Collar



Spacer
3 x 5 x 0.2mm



Round Head Screw
RM3 x 8mm



Spacer
3 x 5 x 0.2mm



Flanged Bearing
3 x 6 x 2.5mm



Spacer
3 x 5 x 0.2mm



Motor Mount Post With Flange



Composite Upper Deck Collar
For Flex Elimination
XP-10739 Optional XP-10683



FRP 2.0mm Rear Top Deck XP-10694
Optional XP-10732

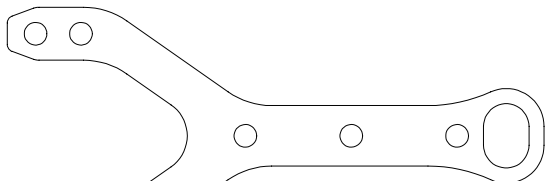

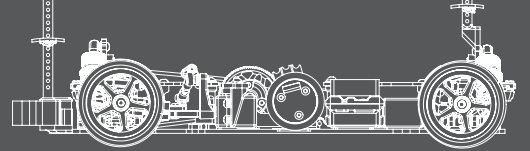

Bag D and H , HW F and I

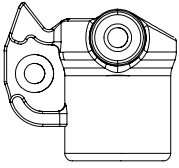

Composite Steering Block Right
XP-10277
Optional
XP-10462 , XP-10389

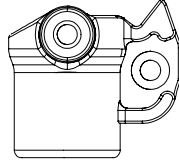

Composite Steering Block Left
XP-10277
Optional
XP-10462 , XP-10389

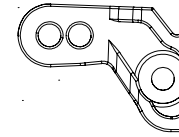

Composite Steering Block Plate Right
XP-10277
Optional
XP-10462 , XP-10311

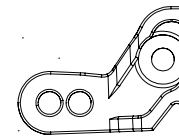

Composite Steering Block Plate Left
XP-10277
Optional
XP-10462 , XP-10311

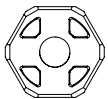

Composite Wheel Hub
XP-10262
Optional
XP-10129 , XP-20015 , XP-20016



Bearing 5 x 10 x 4mm
XP-40064



Pin 2 x 9.8mm
XP-40069



Round Head Screw RM3 x 8mm
XP-40038

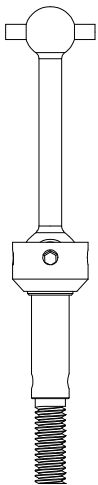

Steel Universal Shaft
XP-10313
Optional
XP-10375 , XP-10384



Driveshaft Protector Blade
XP-10128

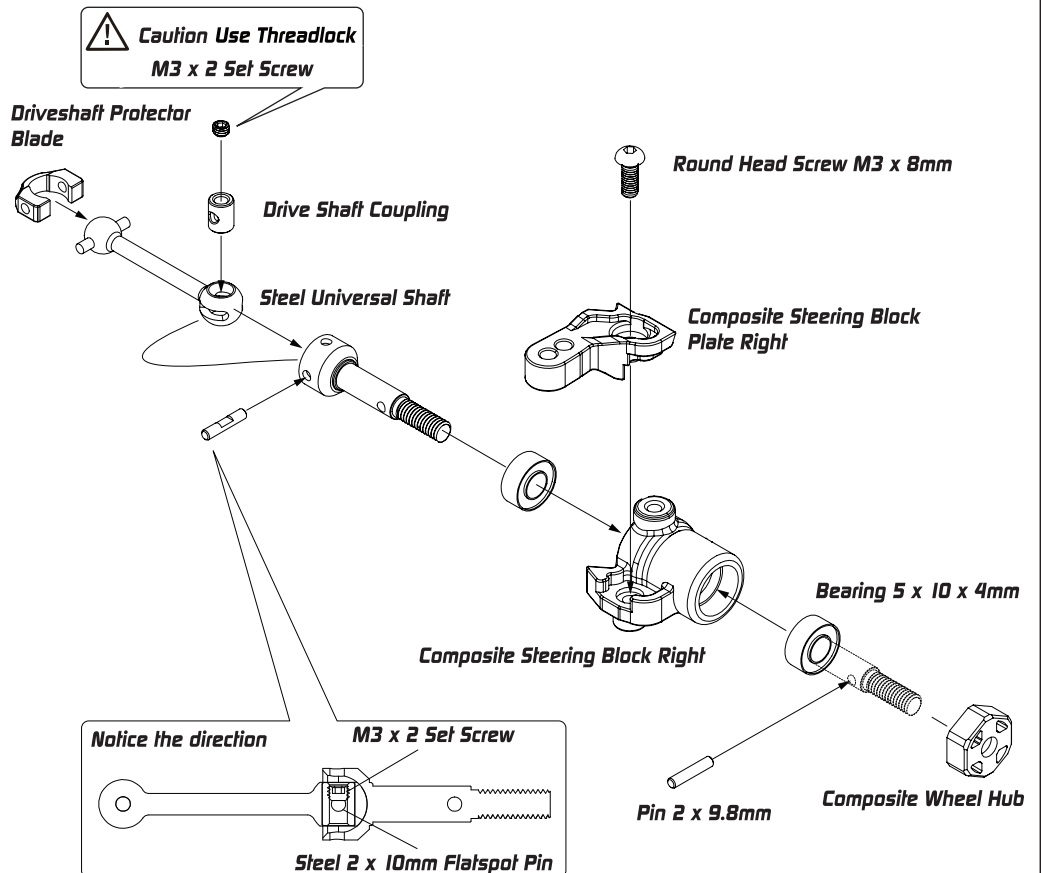
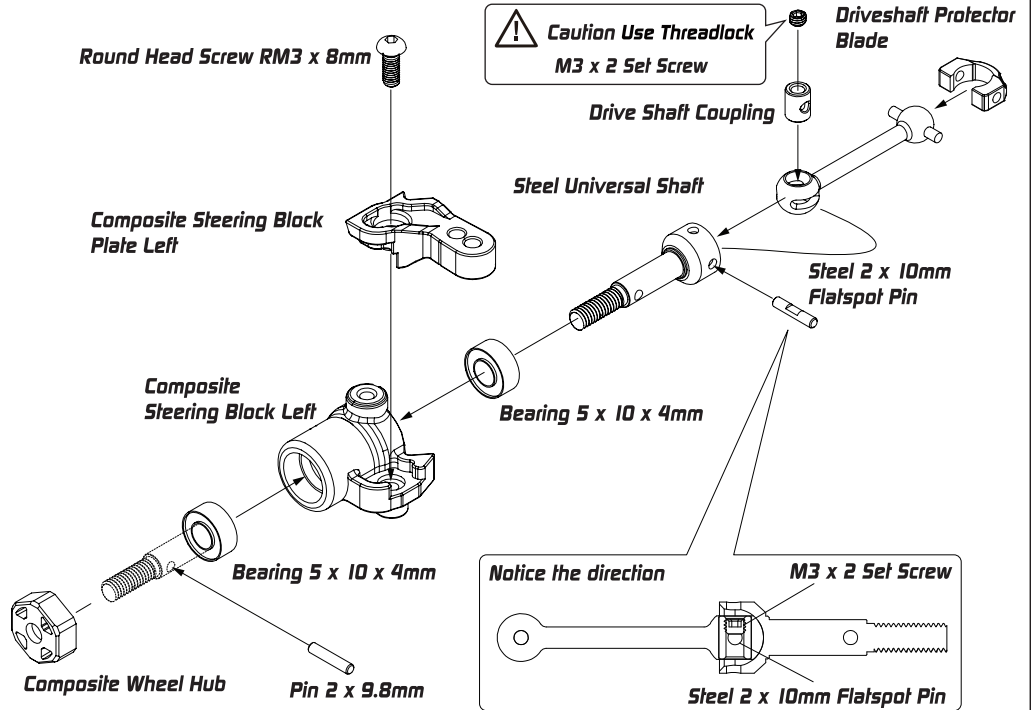

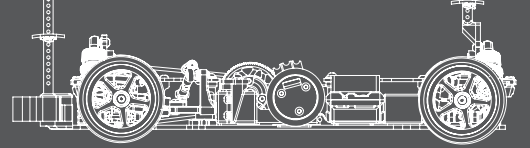

Bag E , H and J , HW I and K

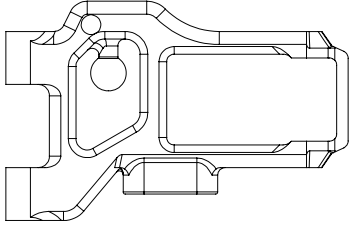

Composite Suspension Arm Front
XP-10276
Optional XP-10459

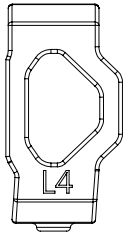

Composite C-Hub 4° deg
Left XP-10278
Optional
XP-10390 , XP-10461

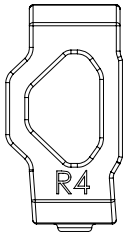

Composite C-Hub 4° deg
Right XP-10278
Optional
XP-10390 , XP-10461



Suspension Pivot Pin 3 x 42mm
XP-10139

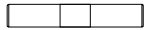

3x18mm C Hub Upright Pivot Pin
XP-10289



Hex Set Screw M3 x 4mm
XP-40053



Hex Set Screw M3 x 8mm
XP-40054



Composite Spacer 1mm
XP-10740
Optional XP-10240



Composite Spacer 2mm
XP-10278
Optional XP-10241

Composite C-Hub - 4° deg Left

L4

Thread the hole before inserting the pin

Hex Set Screw M3 x 8mm

Hex Set Screw M3 x 4mm

Composite Spacer 2mm

Composite Suspension Arm Front

3x18mm C Hub Upright Pivot Pin

Please Note The Direction

Composite Spacer 2mm

Hex Set Screw
M3 x 8mm

Composite Spacer 1mm

Composite C-Hub - 4° deg Right

Suspension Pivot Pin 3 x 42mm

R4

Thread the hole before inserting the pin

Hex Set Screw M3 x 4mm

Hex Set Screw M3 x 8mm

Composite Suspension Arm Front

3x18mm C Hub Upright Pivot Pin

Composite Spacer 2mm

Please Note The Direction

Hex Set Screw M3 x 8mm

Composite Spacer 2mm

Composite Spacer 1mm

Suspension Pivot Pin 3 x 42mm

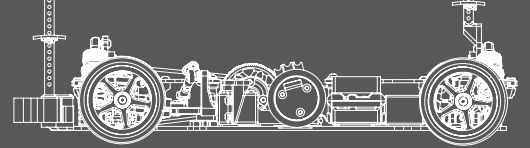

HW G

  King Pin Collar
XP-10164

 King Pin
XP-10164

4.8mm Ball End 8mm Thread

King Pin Collar

King Pin

8mm

5mm

5mm

From Front Camber Link

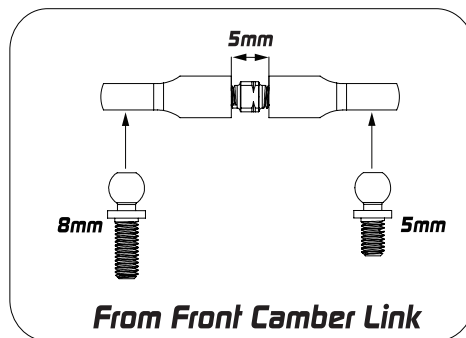

5mm

8mm

5mm

From Front Camber Link

4.8mm Ball End 8mm Thread

King Pin Collar

King Pin

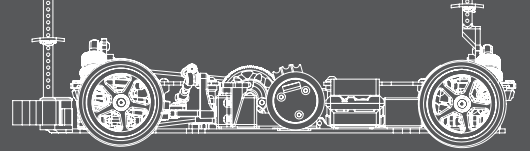

Bag G and HW K



Flat Head Screw FM3 x 6mm
XP-40046



Composite Suspension Mount - FF
XP-10260

Optional



Diagonal Offset
Use either 0.5 or 1mm to shift the roll center in a diagonal direction from the center.



Alu Front Lower 1-Piece Suspension Holder - FF
XP-10114



Eccentric Bushing Set
XP-10127

Horizontal Offset
Choice of either 0.5 or 1mm offset from center

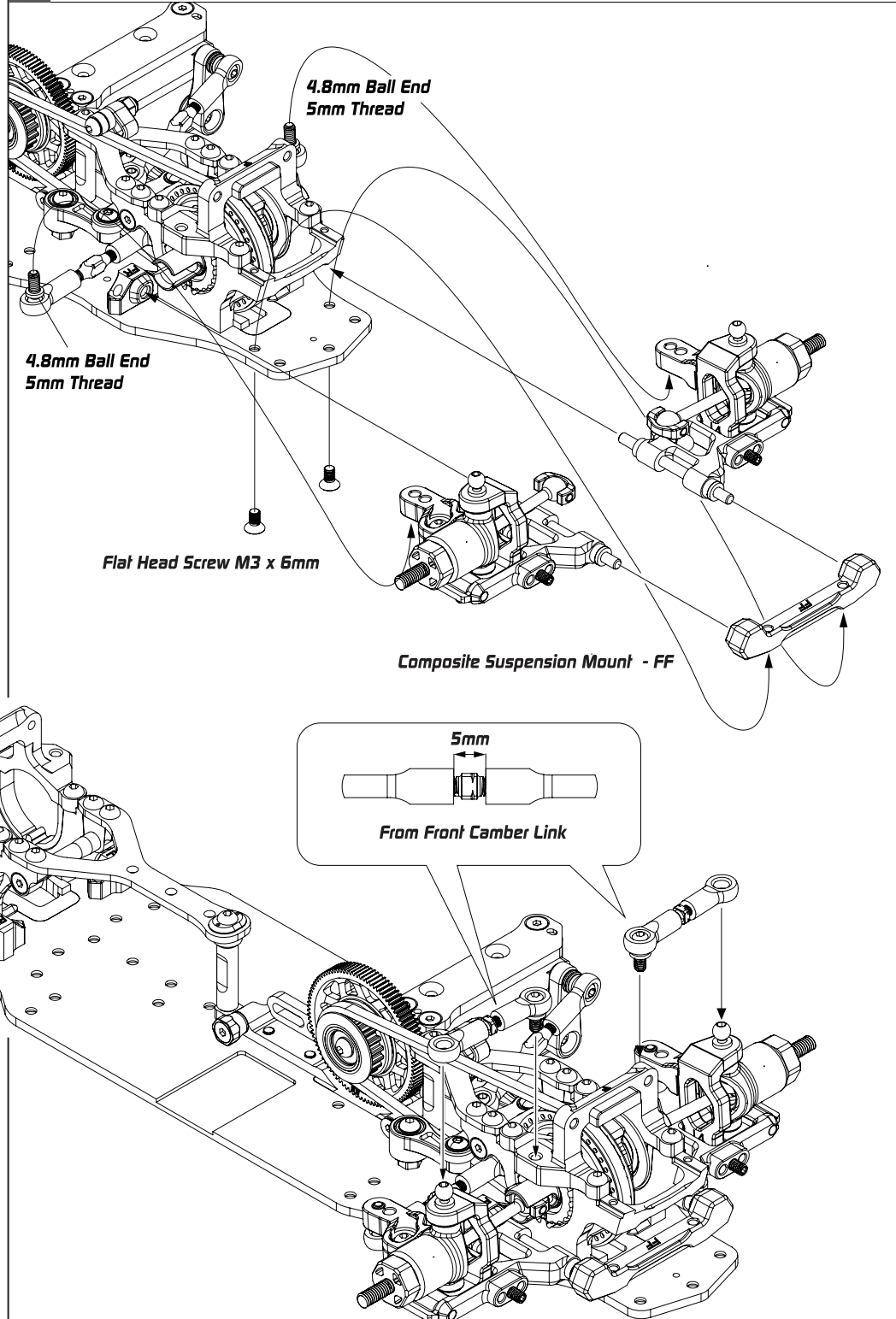

Optional

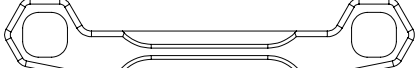
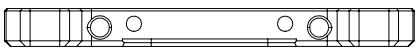

Alu Front Lower 1-Piece Suspension Holder - FF
XP-10114

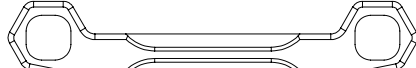
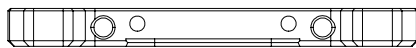

Brass Front Lower 1-Piece Suspension Holder - FF
XP-10199



Bag D, H, I and J, HW F, I and K

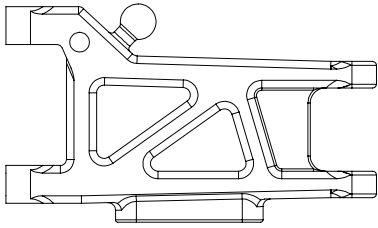

Composite Suspension Arm Rear
XP-10276
Optional XP-10459

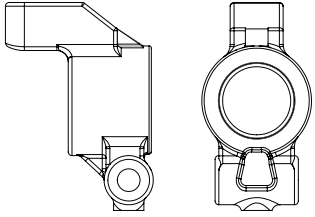

XM15 Composite Suspension Rear Upright
XP-10275
Optional XP-10460



Bearing 5 x 10 x 4mm
XP-40064

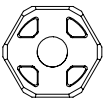

Composite Wheel Hub
XP-10262
Optional
XP-10129, XP-20015, XP-20016



Pin 2 x 9.8mm
XP-40069

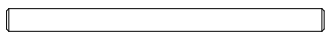

Suspension Pivot Pin 3 x 42mm
XP-10139

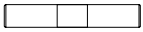

3x18mm C Hub Upright Pivot Pin
XP-10289



Hex Set Screw M3 x 8mm
XP-40054

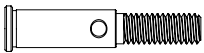

Rear Wheel Axle
XP-10744

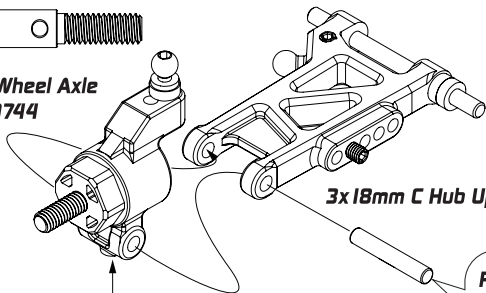

3x18mm C Hub Upright Pivot Pin

Hex Set Screw
M3 x 4mm

Thread the hole before inserting the pin

Please Note The Direction

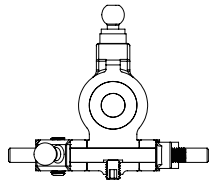

Please Note The Direction

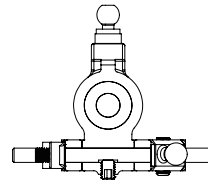

Hex Set Screw
M3 x 4mm

Thread the hole before inserting the pin

2X



Composite Spacer 1mm
XP-10740
Optional XP-10240



Composite Spacer 2mm
XP-10278
Optional XP-10241

4.8mm Ball End 6mm Thread

Composite Spacer 2mm

Bearing
5 x 10 x 4mm

3mm

6mm

5mm

From Rear Camber Link

Bearing 5 x 10 x 4mm

Composite Rear Upright

Pin 2 x 9.8mm

Composite Wheel Hub

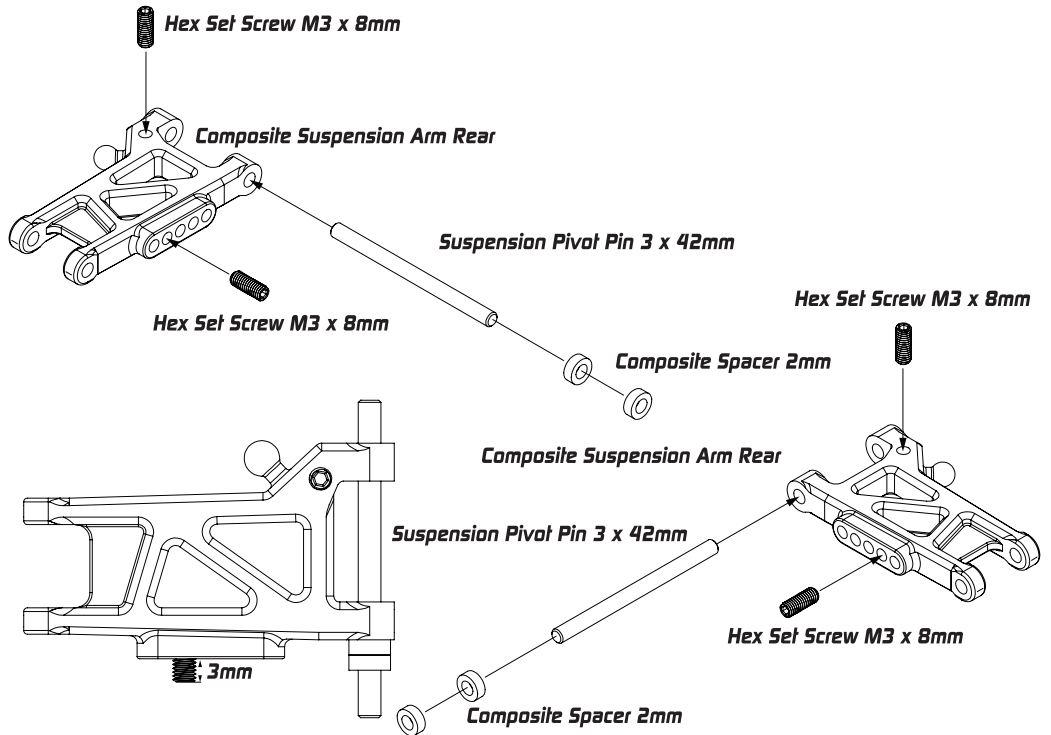

Hex Set Screw M3 x 8mm

Composite Suspension Arm Rear

Suspension Pivot Pin 3 x 42mm

Hex Set Screw M3 x 8mm

Hex Set Screw M3 x 8mm

Composite Spacer 2mm

Composite Suspension Arm Rear

Suspension Pivot Pin 3 x 42mm

Hex Set Screw M3 x 8mm

3mm

Composite Spacer 2mm

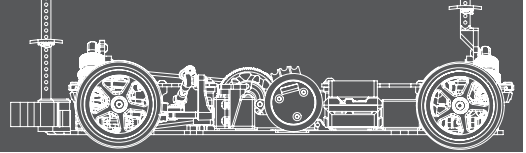

Bag G and HW K



Composite Suspension Mount - RR
XP-10260



Flat Head Screw FM3 x 6mm
XP-40046

Optional

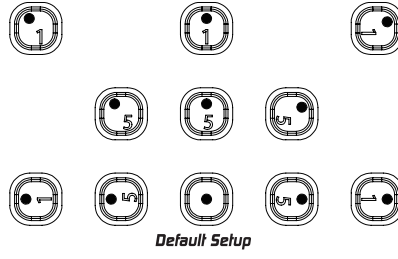

Diagonal Offset
Use either 0.5 or 1 mm to shift the roll center in a diagonal direction from the center.

Alu Rear Lower 1-Piece Suspension holder - RR
XP-10124

Horizontal Offset
Choice of either 0.5 or 1 mm offset from center

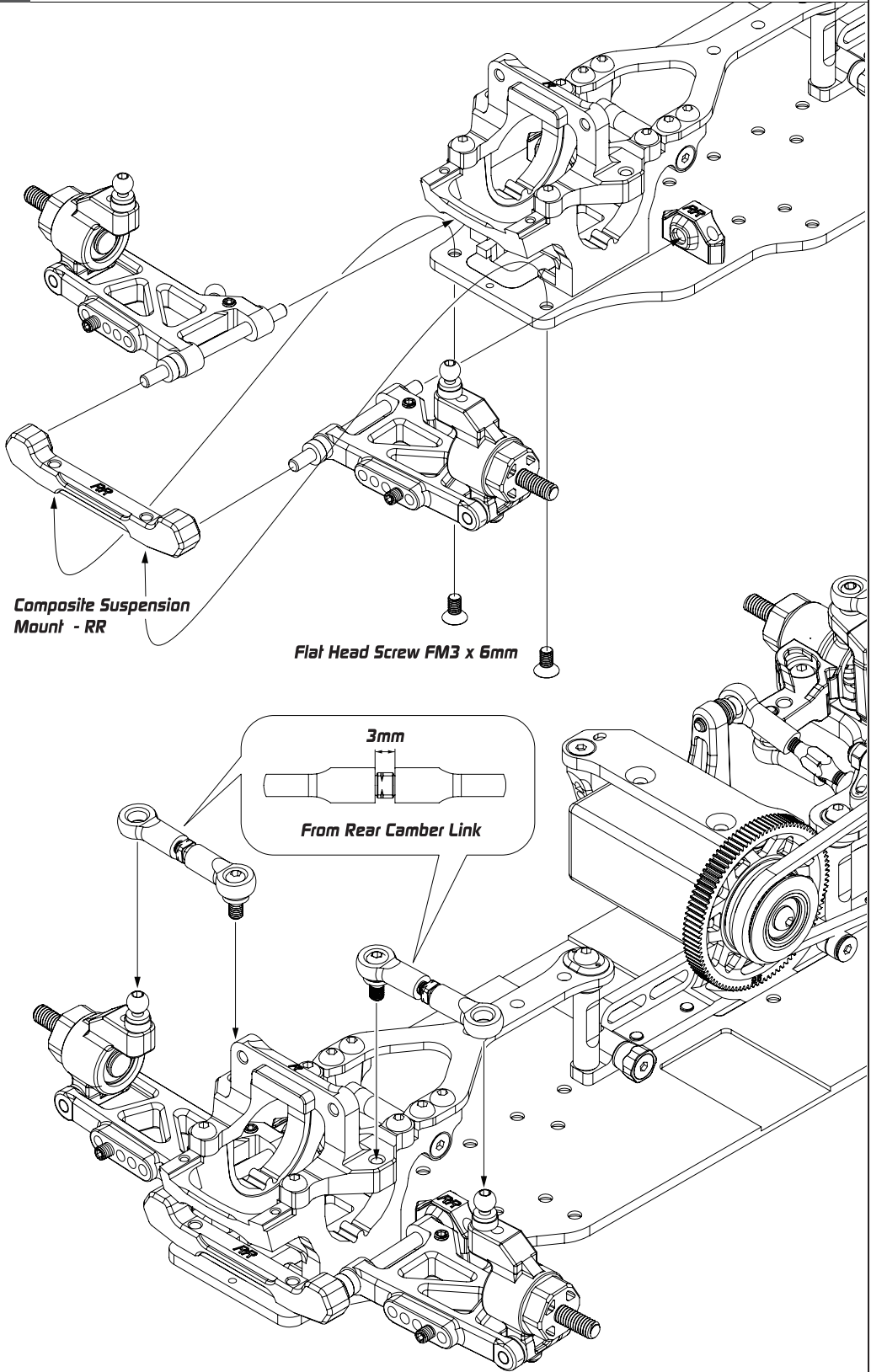
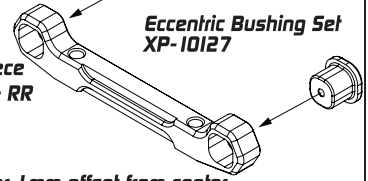

Optional

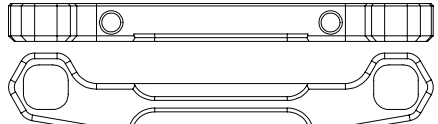

Alu Rear Lower 1-Piece Suspension holder - RR
XP-10124

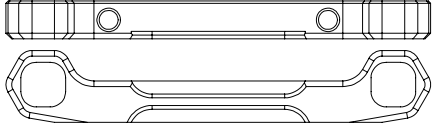

Brass Rear Lower 1-Piece Suspension holder - RR
XP-10200

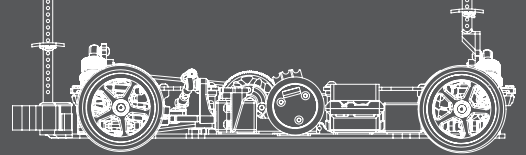

BAG F, HW I and K

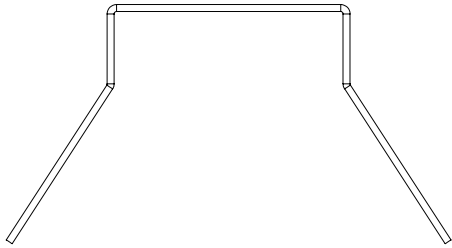

1.3mm Anti-Roll Bar XP-10314

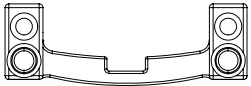

Stabilizer Mount XP-10230

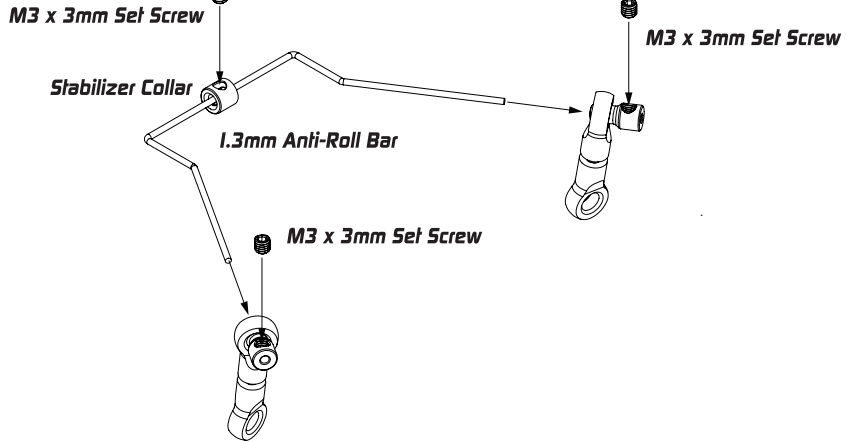

Front

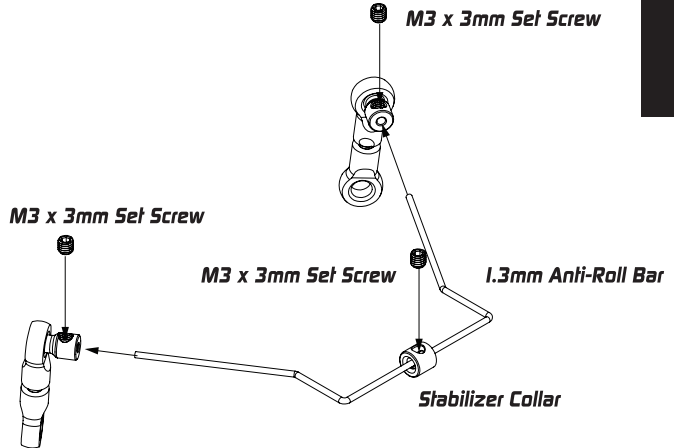
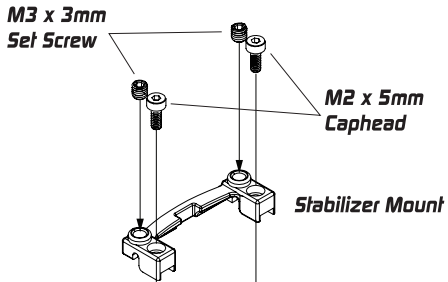

Rear

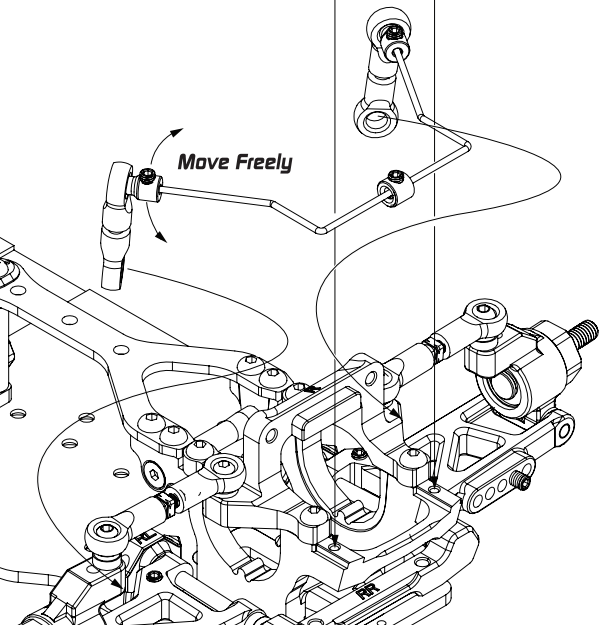
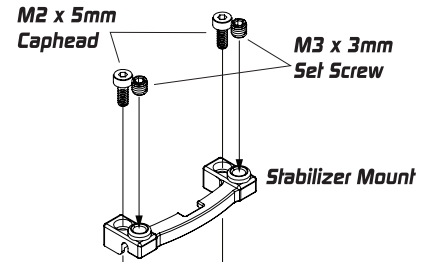
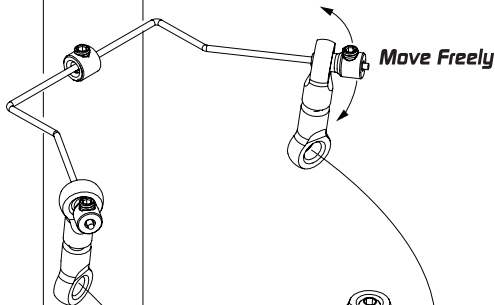

Stabilizer Collar XP-10327

M3 x 3mm Set Screw XP-40052

Cap Hex Screw 2x5mm XP-40034

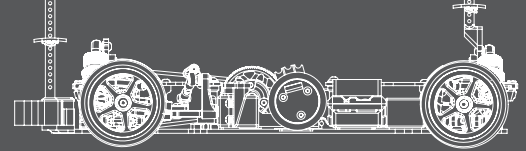

Bag K , HW J

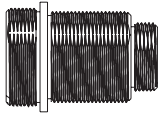

Composite Shock Body
XP-10322
Optional XP-10057

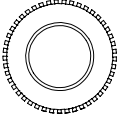

Alu Upper Shock Cap
XP-10256

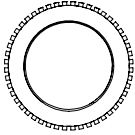

Alu Spring Tension Adjust Nut
XP-10258



Alu Lower Shock Cap
XP-10257



Shock Top Connector
XP-10015



2 Hole Piston
XP-10016



Shock Lower Connector
XP-10015



Shaft Cover
XP-10016



Shaft Spacer
XP-10016

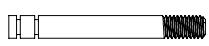

Shock Shaft
XP-10050



Shock Absorber Membrane
XP-10051

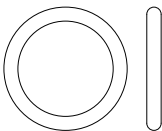

Silicone O Ring For Spring Adjust Nut
XP-10051



Shock O-Ring
XP-10051



E-Clip 2.5mm
XP-40057

Silicone O Ring For Spring Adjust Nut

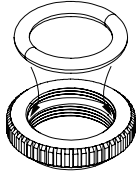

Alu Spring Tension Adjust Nut

E-Clip 2.5mm

E-Clip 2.5mm

2 Hole Piston

Composite Shock Body

Shock Shaft

Alu Spring Tension Adjust Nut

Shock O-Ring

Shaft Spacer

Shaft Cover

Alu Lower Shock Cap

450Cst

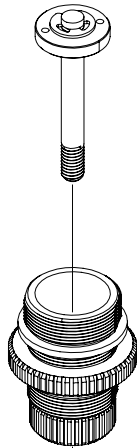

11mm

Shock Lower Connector

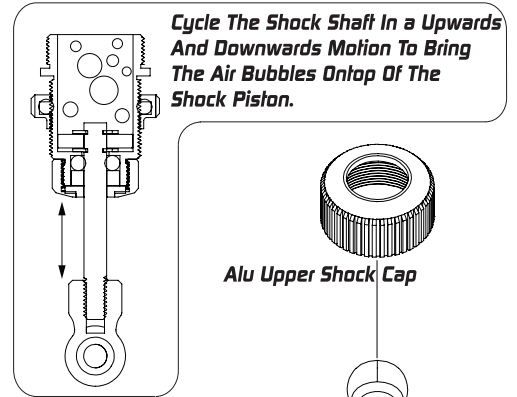

Cycle The Shock Shaft In a Upwards And Downwards Motion To Bring The Air Bubbles Ontop Of The Shock Piston.

Alu Upper Shock Cap

Shock Top Connector

Shock Absorber Membrane

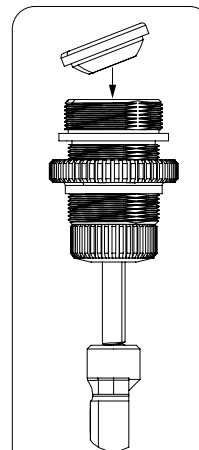

Install the shock bladder slowly on an angle as shown.

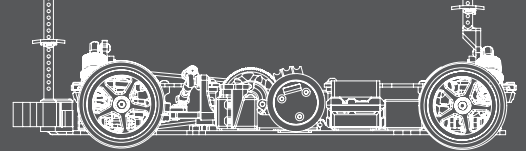

Bag K, L and FRP, HW B, I, K



Spring Retainer
XP-10015



Pivot Ball 4.8 mm
XP-10045

Rear Shock Tower
XP-10280

Optional XP-10385 XP-10374

Default Setup

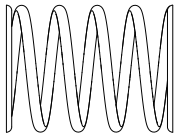
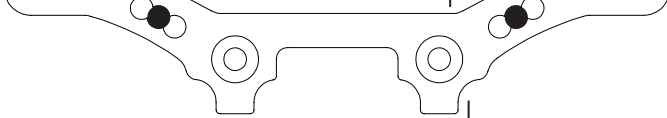

Touring Spring Ø1.4 - Blue

XP-10363

Optional

XP-10076

XP-10077

XP-10078

XP-10079

XP-10080

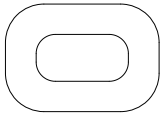

Body Height Adjuster Support
XP-10001

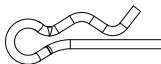

Body Clip
XP-10055



Flat Head Screw FM3 x 8mm
XP-40048



Round Head Screw RM3 x 6mm
XP-40037

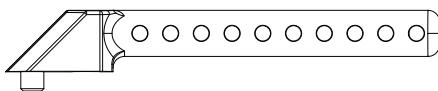

Rear Body Post
XP-10561

Spring Retainer

4X

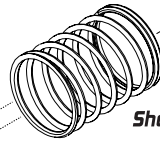

Shock Spring Blue

4X

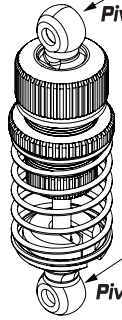

Pivot Ball 4.8 mm

Pivot Ball 4.8 mm

Body Height Adjuster Support

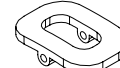

Body Height Adjuster Support

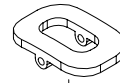

Body Clip

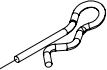

Rear Shock Tower

Body Clip

Flat Head Screw FM3 x 8mm

Round Head Screw M3 x 6mm

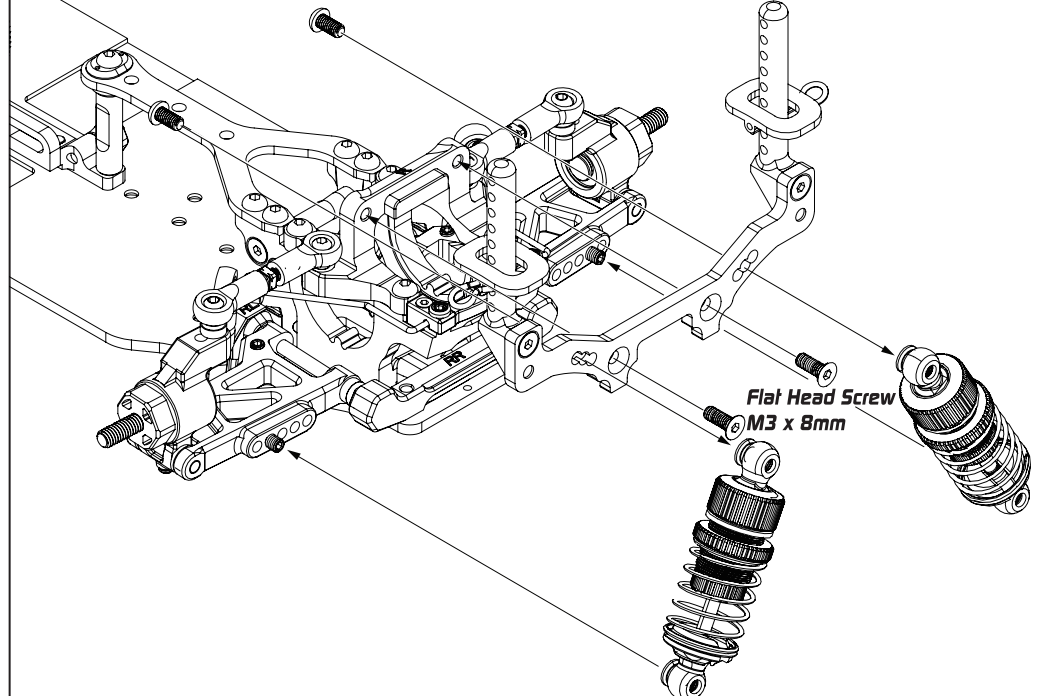

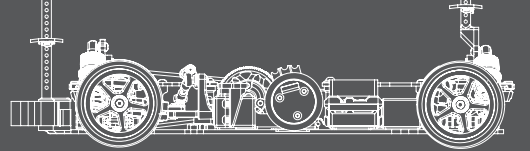

Bag L , FRP , HW K

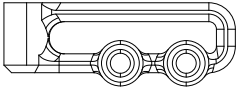

Composite Lipo Battery Backstop
XP-10180
Optional XP-10192 , XP-10654



Flat Head Screw FM3 x 8mm
XP-40048



Flat Head Screw FM3 x 6mm
XP-40046

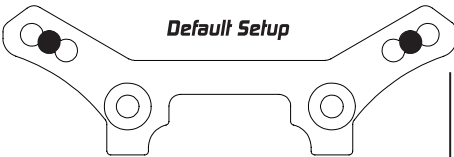

Default Setup

Execute XM15 Front Shock Tower
XP-10279
Optional XP-10373 , XP-10376 , XP-10386



Round Head Screw RM3 x 6mm
XP-40037

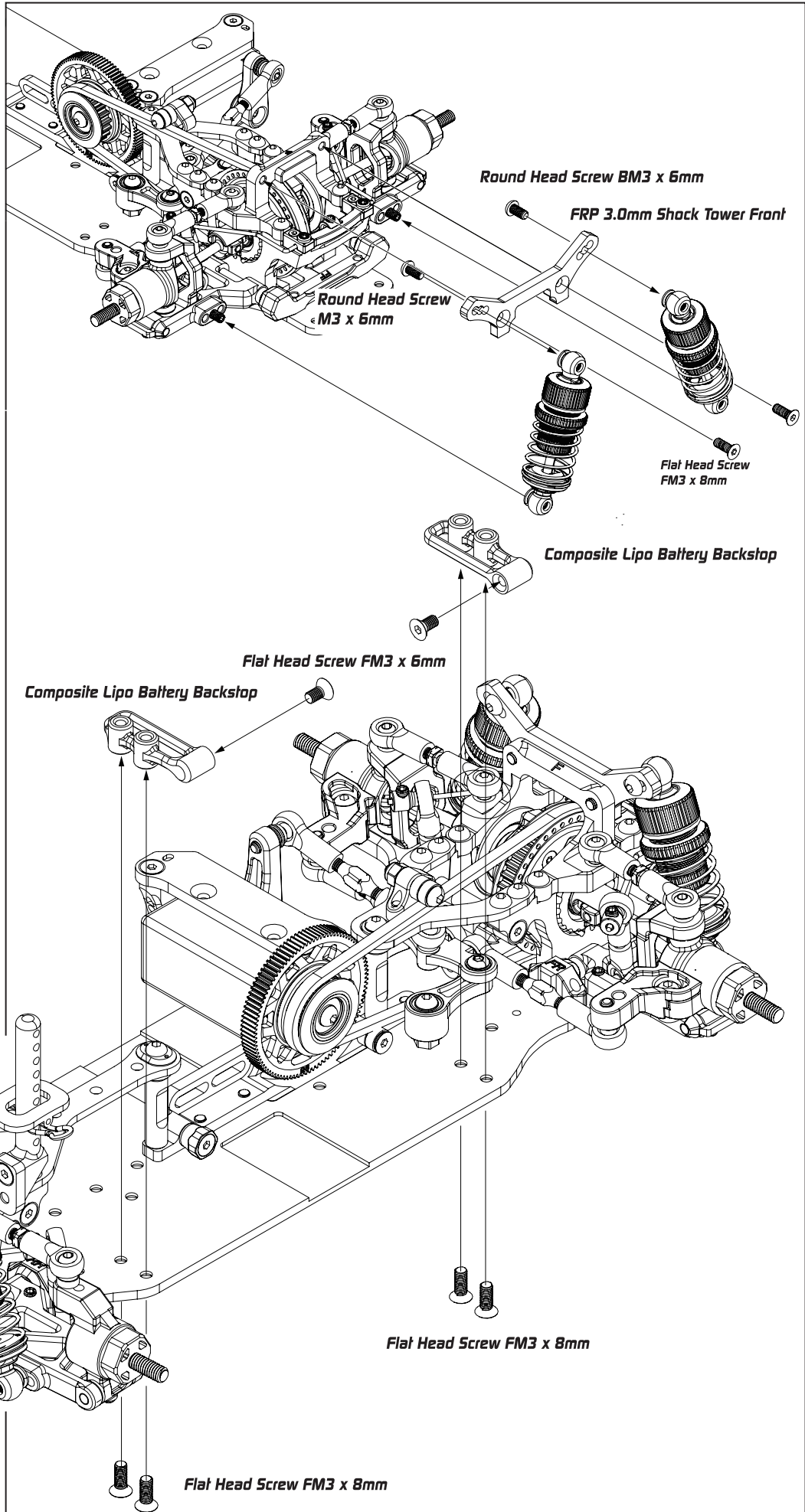

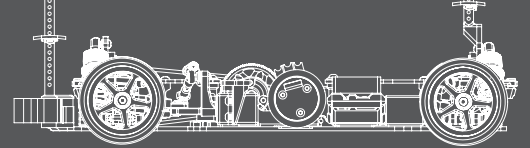

Bag L , HW E , K

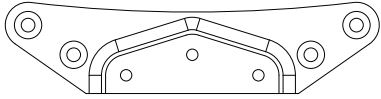

Lower Bumper
XP-10561

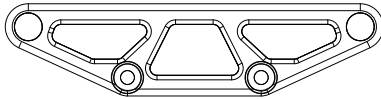

Bumper Plate For Light Bumper
XP-10561
Optional XP-10243 , XP-10387

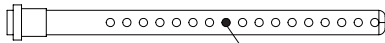

Front Body Post
XP-10561

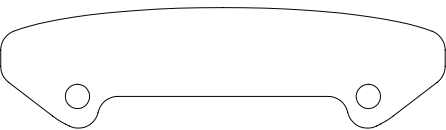

Foam Bumper
XP-10721

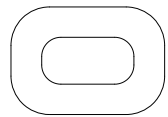

Body Height Adjuster Support
XP-10561

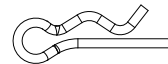

Body Clip
XP-10055



Flat Head Screw FM3 x 6mm
XP-40046



Flat Head Screw FM3 x 8mm
XP-40048



Flat Head Screw FM3 x 10mm
XP-40049

Front Body Post

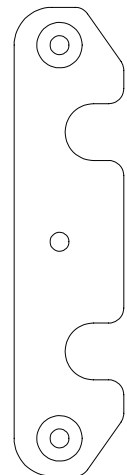

Front Brass (58g)
XP-10722

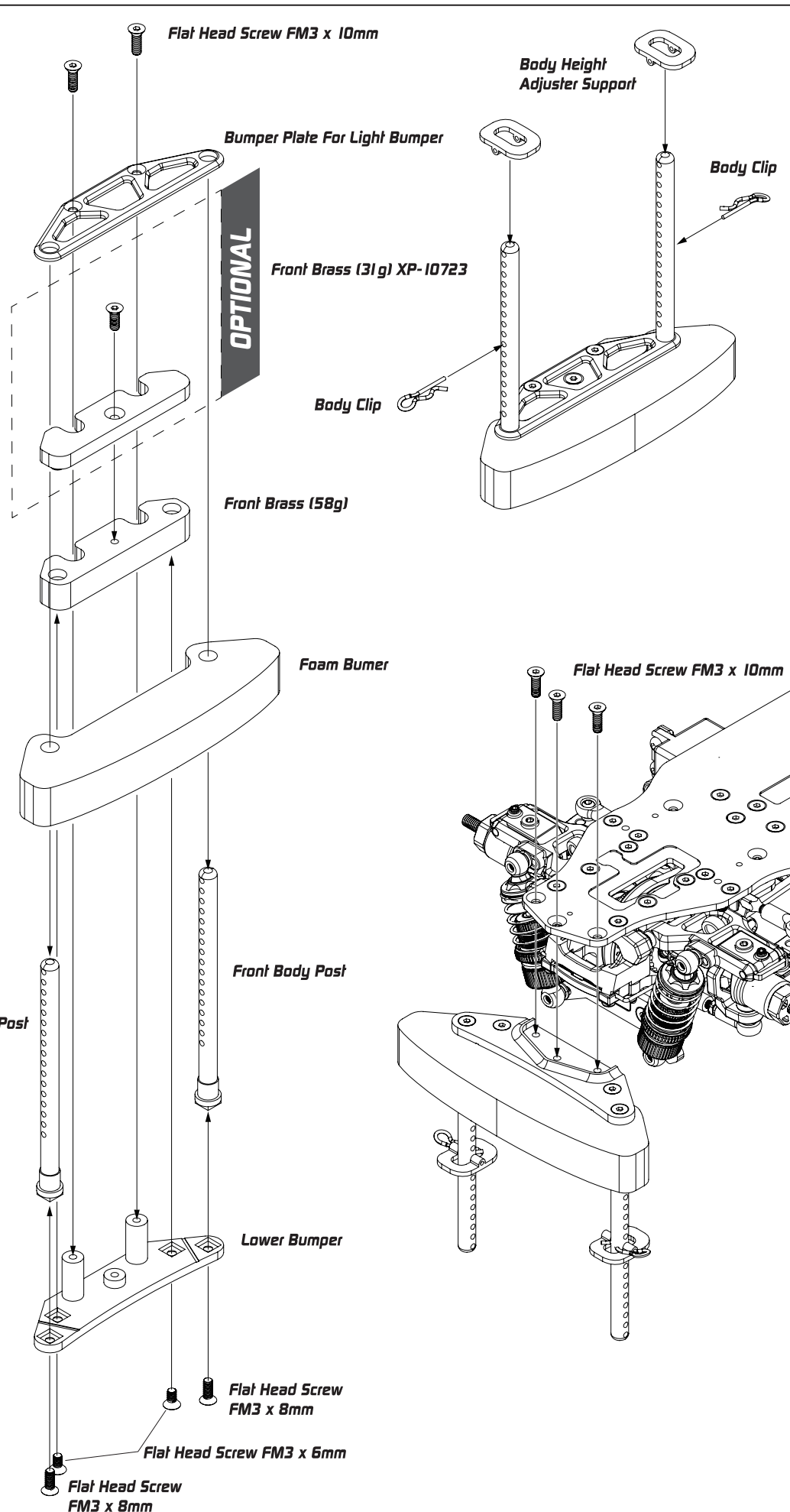

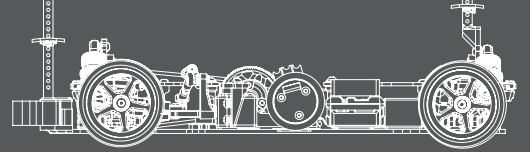

HW K



Lock Nut 7mm
XP-40068



Round Head Screw RM3 x 6mm
XP-40037

[ESC Not Included]

[Receiver Not Included]

[Double Sided Tape Not Included]

[Motor Not Included]

Round Head Screw
M3 x 6mm

[Pinion Not Included]

[Tires Not Included]

Lock Nut 7mm

[Battery Not Included]

Lock Nut 7mm

[Tires Not Included]

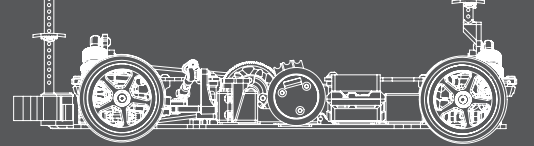

FM1S Original Parts		FM1S Option Parts	
Model Number	Product Name	Model Number	Product Name
XP10005	Battery Mount Set	XP10105	Front CamberLink Mount 2pcs
XP10008	Gear Differential Case and Cover	XP10111	Aluminum Dual Servo Saver Arm 2pcs
XP10009	Gear Differential Bevel Satellite Gears Set	XP10112	Aluminum Steering Post For Dual Servo Saver 2pcs
XP10011	Gear Differential Repair Parts	XP10113	Aluminum Steering Plate For Dual Servo Saver 4mm
XP10015	Damper Plastic Parts Set	XP10114	Aluminum FF Lower 1 Piece Suspension Mount
XP10016	Damper Part Replacement Set	XP10115	Aluminum One Piece Lower Bulkhead
XP10022	Gear Differential Set	XP10119	Aluminum Shim 3x5.5x1.0mm Red 20pcs
XP10050	Replacement Shock Shaft Set 4pcs	XP10120	Aluminum Shim 3x5.5x2.0mm Red 20pcs
XP10051	Replacement Silicone Parts Set	XP10123	Aluminum 2 Piece Suspension Mount 2pcs
XP10055	Body Clips 20pcs	XP10124	Aluminum RR Lower one Piece Suspension Mount
XP10057	Aluminum Damper Cylinder Shock Body	XP10125	Aluminum Gear Diff Outdrive Adapter 2pcs
XP10107	Composite Ball Bearing Tension Adjustment Hub 4pcs	XP10126	Steel Spool Outdrive Adapter 2pcs
XP10128	Driveshaft Protector Blade 8pcs	XP10127	Eccentric Bushing Set
XP10139	3.0mm Suspension Pivot Pin 4pcs	XP10129	Aluminum 5mm Wheel Hub Red 2pcs
XP10148	4.8mm Ball End 5mm Thread 10pcs	XP10130	Aluminum Rear One Piece Upper Clamp
XP10149	4.8mm Ball End 6mm Thread 10pcs	XP10131	Rear CamberLink Mount 2pcs
XP10150	4.8mm Ball End 8mm Thread 10pcs	XP10133	Aluminum Solid Axle
XP10151	4.8mm Ball End 10mm Thread 10pcs	XP10141	Aluminum Low Profile Shock Set 2pcs
XP10156	Steel Tumbuckle 29 mm 4pcs	XP10142	Aluminum Shock Body 2pcs
XP10179	Gear Differential Gasket 5pcs	XP10143	Shock Shaft 2pcs
XP10180	Composite Battery Stopper Set and Layshaft Bearing Holder Set	XP10186	Brass Chassis Balancing Weights 15g 10g 4pcs
XP10181	Gear Differential Spacer 5x15.5x0.4mm 10pcs	XP10191	Aluminum Rf One Piece Suspension Mount
XP10182	Gear Differential Spacer 3.6x9.5x0.2mm 10pcs	XP10192	Aluminum Adjustable Battery Stoppers
XP10183	Silicone Gear Differential O-RING 25x1mm 10pcs	XP10193	Aluminum Spring Retainer
XP10184	Silicone Gear Differential O-RING 5x2mm 10pcs	XP10194	Aluminum FR One Piece Suspension Mount
XP10229	Composite Lower Bulkhead 2pcs	XP10196	Brass RF One Piece Suspension Mount
XP10230	Front and Rear Composite One Piece Upper Clamp	XP10197	Brass FR One Piece Suspension Mount
XP10236	4.8mm Ball End 5mm Thread 4pcs	XP10198	Brass 2 Piece Suspension Mount
XP10237	4.8mm Ball End 6mm Thread 4pcs	XP10199	Brass FF 1 Piece Suspension Mount
XP10238	4.8mm Ball End 8mm Thread 4pcs	XP10200	Brass RR 1 Piece Suspension Mount
XP10239	4.8mm Ball End 10mm Thread 4pcs	XP10224	Aluminum 5mm Ackermann Steering Plate For Dual Servo Saver
XP10251	4.8mm Flat Type Ball End 15mm 4pcs	XP10240	Aluminum Shim 3x5.5x1.0mm Red 10pcs
XP10252	4.8mm Flat Type Ball End 13mm 2pcs	XP10241	Aluminum Shim 3x5.5x2.0mm Red 10pcs
XP10253	4.8mm Flat Type Ball End 10mm 4pcs	XP10242	Brass Chassis Balancing Weights 10g 5g 4pcs
XP10254	4.8mm Low Profile Ball End Set	XP10243	Graphite 2.25mm Upper Bumper Holder
XP10259	Aluminum Center Post	XP10255	Camber Stiffener Link Ball End
XP10262	Composite Wheel Hub Set 4pcs	XP10256	Aluminum Upper Shock Cap 2pcs
XP10275	Composite Rear Upright 2pcs	XP10257	Aluminum Lower Shock Cap 2pcs
XP10276	Composite Front and Rear Arm	XP10258	Aluminum Spring Tension Adjust Nut 2pcs
XP10277	Composite Steering Block Set	XP10264	Composite Spool 3BT Set
XP10278	Composite C Hub 4 Degrees	XP10265	Composite Spool Cups 2pcs
XP10279	FRP 3.0mm Front Shock Tower	XP10365	Aluminum Wheel Adapter 6mm 2pcs
XP10280	FRP 3.0mm Rear Shock Tower	XP10368	Front CamberLink Mount 2pcs
XP10288	Gear Diff Outdrive Adapter 2pcs	XP10369	Rear CamberLink Mount 2pcs
XP10311	Graphite Option Steering Knuckle Plate	XP10373	Graphite 3.0mm Front Shock Tower
XP10313	Steel Universal Shaft 2pcs	XP10374	Graphite 3.0mm Rear Shock Tower
XP10314	Anti-Roll Bar 1.3mm Front and Rear 2pcs	XP10375	ECS Drive Shaft 2pcs
XP10315	Anti-Roll Bar 1.2mm Front and Rear 2pcs	XP10376	Graphite 3.0mm Front Shock Tower & Body Holder
XP10316	Anti-Roll Bar 1.4mm Front and Rear 2pcs	XP10378	4 Hole Damper Piston 4pcs
XP10327	Aluminum Anti-Roll Bar Bushing Set	XP10384	Spring Steel Double Joint Universal Shaft 2pcs
XP10336	Steel Tumbuckle 18mm 4pcs	XP10385	Aluminum Rear Shock Tower For XM1 XM1S
XP10377	3x18mm Flat Spot Suspension Pivot Pin	XP10386	Aluminum Front Shock Tower For XM1 XM1S
XP10381	Execute XM1 Graphite Body Post Stiffener Front and Rear	XP10387	Aluminum Upper Bumper Holder
XP10561	Bumper Body Post (Foam Bumper LIGHT)	XP10388	Aluminum Rear Upright 2pcs For XM1 XM1S
XP10600	Silicone Gear Differential X-RING 5x2mm 10pcs	XP10389	Aluminum Steering Block Set For XM1 XM1S
XP10601	Shock X-Ring 10pcs	XP10390	Aluminum C Hub 4 Degrees For XM1 XM1S
XP10644	Composite Center Pulley Set For XG 10 (A/B)	XP10395	3 x 5 x 0.2mm Shim 10pcs
XP10686	FRP 2.5mm Chassis	XP10458	Hard Composite Suspension Parts Set
XP10687	Motor Mount	XP10459	Hard Composite Front and Rear Arm
XP10688	Spur Gear Adaptor	XP10460	Hard Composite Rear Upright 2pcs
XP10694	FRP 2.0mm Rear Top Deck	XP10461	Hard Composite C Hub 4 Degrees
XP10695	FRP 2.0mm Front Top Deck	XP10462	Hard Composite Steering Block Set
XP10696	Graphite 2.0mm Top Deck	XP10494	Aluminum Steering Post For Dual Servo Saver 11.5mm 2pcs
XP10698	Center Pulley Post For FM1S 13.5MM	XP10556	Steel Spool Outdrive Adapter 2pcs
XP10721	Foam Bumper Light For FM1S	XP10634	Grey Composite 4.8mm Flat Type Ball End 10mm 4pcs
XP10722	Front Brass (58g)	XP10635	Grey Composite 4.8mm Flat Type Ball End 13mm 4pcs
XP10729	FRP 3.0mm FM1S Servo Mount Plate	XP10636	Grey Composite 4.8mm Flat Type Ball End 15mm 4pcs
XP10730	Kevlar Drive Belt: Front 3x249mm	XP10654	Anti Tweak Battery Holder
XP10734	FRP 4.0mm Servo Mount Spacer	XP10680	Aluminum Ball Bearing Tension Adjustment Hub 2pcs
XP10739	Composite Upper Deck Collar For Flex Elimination	XP10683	XG10 Aluminum Upper Deck Collar For Flex Elimination
XP10740	Xpress Execute XG1S XM1S FM1S Composite Steering Set	XP10723	Front Brass (31g)
XP10741	Composite Side Servo Mount FM1S	XP10727	Aluminum Servo Side Mount
XP10744	Rear Wheel Axle FM1S	XP10728	Aluminum Fan Mount FT1 Mid FM1S
XP40082	High Composite Spur Gear 64P 96T	XP10731	Bando Kevlar Drive Belt: Front 3x249mm
		XP10732	2mm Graphite Rear Top Deck
		XP10733	2mm Graphite Front Top Deck
		XP10742	FM1S 2.25mm Graphite Main Chassis
		XP10743	FM1S 3.0mm Graphite Servo Mount Plate
		XP40081	High Composite Spur Gear 64P 96T
		XP40086	5 x 7 x 0.2mm Spacer 10pcs
		XP40121	High Composite Spur Gear 64P 100T
		XP40122	High Composite Spur Gear 64P 94T

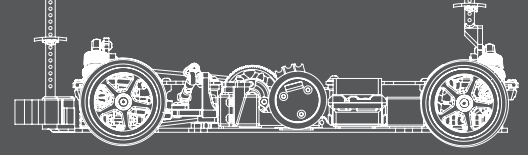

Xpress Execute FM15 (64Pitch-Spur Gear 80T to 100T)

Pinion	64 Pitch																				
	33	34	35	36	37	38	39	40	41	42	43	44	45	46	47	48	49	50	51	52	53
80	4.61	4.47	4.34	4.22	4.11	4.00	3.90	3.80	3.71	3.62	3.53	3.45	3.38	3.30	3.23	3.17	3.10	3.04	2.98	2.92	2.87
81	4.66	4.53	4.40	4.28	4.16	4.05	3.95	3.85	3.75	3.66	3.58	3.50	3.42	3.35	3.27	3.21	3.14	3.08	3.02	2.96	2.90
82	4.72	4.58	4.45	4.33	4.21	4.10	3.99	3.90	3.80	3.71	3.62	3.54	3.46	3.39	3.31	3.25	3.18	3.12	3.05	3.00	2.94
83	4.78	4.64	4.51	4.38	4.26	4.15	4.04	3.94	3.85	3.75	3.67	3.58	3.50	3.43	3.36	3.29	3.22	3.15	3.09	3.03	2.98
84	4.84	4.69	4.56	4.43	4.31	4.20	4.09	3.99	3.89	3.80	3.71	3.63	3.55	3.47	3.40	3.33	3.26	3.19	3.13	3.07	3.01
85	4.89	4.75	4.61	4.49	4.36	4.25	4.14	4.04	3.94	3.85	3.76	3.67	3.59	3.51	3.44	3.36	3.30	3.23	3.17	3.11	3.05
86	4.95	4.81	4.67	4.54	4.42	4.30	4.19	4.09	3.99	3.89	3.80	3.71	3.63	3.55	3.48	3.40	3.33	3.27	3.20	3.14	3.08
87	5.01	4.86	4.72	4.59	4.47	4.35	4.24	4.13	4.03	3.94	3.84	3.76	3.67	3.59	3.52	3.44	3.37	3.31	3.24	3.18	3.12
88	5.07	4.92	4.78	4.64	4.52	4.40	4.29	4.18	4.08	3.98	3.89	3.80	3.72	3.63	3.56	3.48	3.41	3.34	3.28	3.22	3.15
89	5.12	4.97	4.83	4.70	4.57	4.45	4.34	4.23	4.12	4.03	3.93	3.84	3.76	3.68	3.60	3.52	3.45	3.38	3.32	3.25	3.19
90	5.18	5.03	4.89	4.75	4.62	4.50	4.38	4.28	4.17	4.07	3.98	3.89	3.80	3.72	3.64	3.56	3.49	3.42	3.35	3.29	3.23
91	5.24	5.09	4.94	4.80	4.67	4.55	4.43	4.32	4.22	4.12	4.02	3.93	3.84	3.76	3.68	3.60	3.53	3.46	3.39	3.33	3.26
92	5.30	5.14	4.99	4.86	4.72	4.60	4.48	4.37	4.26	4.16	4.07	3.97	3.88	3.80	3.72	3.64	3.57	3.50	3.43	3.36	3.30
93	5.35	5.20	5.05	4.91	4.78	4.65	4.53	4.42	4.31	4.21	4.11	4.02	3.93	3.84	3.76	3.68	3.61	3.53	3.46	3.40	3.33
94	5.41	5.25	5.10	4.96	4.83	4.70	4.58	4.47	4.36	4.25	4.15	4.06	3.97	3.88	3.80	3.72	3.64	3.57	3.50	3.43	3.37
95	5.47	5.31	5.16	5.01	4.88	4.75	4.63	4.51	4.40	4.30	4.20	4.10	4.01	3.92	3.84	3.76	3.68	3.61	3.54	3.47	3.41
96	5.53	5.36	5.21	5.07	4.93	4.80	4.68	4.56	4.45	4.34	4.24	4.15	4.05	3.97	3.88	3.80	3.72	3.65	3.58	3.51	3.44
97	5.58	5.42	5.27	5.12	4.98	4.85	4.73	4.61	4.50	4.39	4.29	4.19	4.10	4.01	3.92	3.84	3.76	3.69	3.61	3.54	3.48
98	5.64	5.48	5.32	5.17	5.03	4.90	4.77	4.66	4.54	4.43	4.33	4.23	4.14	4.05	3.96	3.88	3.80	3.72	3.65	3.58	3.51
99	5.70	5.53	5.37	5.23	5.08	4.95	4.82	4.70	4.59	4.48	4.37	4.28	4.18	4.09	4.00	3.92	3.84	3.76	3.69	3.62	3.55
100	5.76	5.59	5.43	5.28	5.14	5.00	4.87	4.75	4.63	4.52	4.42	4.32	4.22	4.13	4.04	3.96	3.88	3.80	3.73	3.65	3.58

Xpress Execute FM15 (64Pitch-Spur Gear 80T to 100T)

Pinion	64 Pitch																					
	54	55	56	57	58	59	60	61	62	63	64	65	66	67	68	69	70	71	72	73	74	75
80	2.81	2.76	2.71	2.67	2.62	2.58	2.53	2.49	2.45	2.41	2.38	2.34	2.30	2.27	2.24	2.20	2.17	2.14	2.11	2.08	2.05	2.03
81	2.85	2.80	2.75	2.70	2.65	2.61	2.57	2.52	2.48	2.44	2.40	2.37	2.33	2.30	2.26	2.23	2.20	2.17	2.14	2.11	2.08	
82	2.89	2.83	2.78	2.73	2.69	2.64	2.60	2.55	2.51	2.47	2.43	2.40	2.36	2.33	2.29	2.26	2.23	2.19	2.16	2.13		
83	2.92	2.87	2.82	2.77	2.72	2.67	2.63	2.59	2.54	2.50	2.46	2.43	2.39	2.35	2.32	2.29	2.25	2.22	2.19			
84	2.96	2.90	2.85	2.80	2.75	2.71	2.66	2.62	2.57	2.53	2.49	2.46	2.42	2.38	2.35	2.31	2.28	2.25				
85	2.99	2.94	2.88	2.83	2.78	2.74	2.69	2.65	2.60	2.56	2.52	2.48	2.45	2.41	2.38	2.34	2.31					
86	3.03	2.97	2.92	2.87	2.82	2.77	2.72	2.68	2.64	2.59	2.55	2.51	2.48	2.44	2.40	2.37						
87	3.06	3.01	2.95	2.90	2.85	2.80	2.76	2.71	2.67	2.62	2.58	2.54	2.50	2.47	2.43							
88	3.10	3.04	2.99	2.93	2.88	2.83	2.79	2.74	2.70	2.65	2.61	2.57	2.53	2.50								
89	3.13	3.07	3.02	2.97	2.92	2.87	2.82	2.77	2.73	2.68	2.64	2.60	2.56									
90	3.17	3.11	3.05	3.00	2.95	2.90	2.85	2.80	2.76	2.71	2.67	2.63	2.59	2.55	2.51	2.48	2.44	2.40	2.37			
91	3.20	3.14	3.09	3.03	2.98	2.93	2.88	2.83	2.79	2.74	2.70	2.66	2.62	2.58	2.54	2.50	2.47	2.43				
92	3.24	3.18	3.12	3.07	3.01	2.96	2.91	2.87	2.82	2.77	2.73	2.68	2.64	2.60	2.56							
93	3.27	3.21	3.16	3.10	3.05	2.99	2.95	2.90	2.85	2.80	2.76	2.71	2.67	2.62	2.58	2.54	2.50	2.47	2.43			
94	3.31	3.25	3.19	3.13	3.08	3.03	2.98	2.93	2.88	2.83	2.79	2.74	2.70	2.65	2.61	2.57	2.53	2.50				
95	3.34	3.28	3.22	3.17	3.11	3.06	3.01															
96	3.38	3.32	3.26	3.20	3.14	3.09																
97	3.41	3.35	3.29	3.23	3.18																	
98	3.45	3.39	3.33	3.27																		
99	3.48	3.42	3.36																			
100	3.52	3.45																				

Driver _____ Track Surface _____ Track Temperature _____
 Date _____ Track Traction _____ Result _____ Air Temperature _____
 Track _____ Country _____ Best Lap _____ Humidity _____ Remark _____

Front

Hex Offset _____ mm

Camber _____ mm

Ride Height _____ mm

DownStop _____ mm

Sway Bar _____ mm

Rear

Hex Offset _____ mm

Camber _____ mm

Ride Height _____ mm

DownStop _____ mm

Sway Bar _____ mm

C-Hub

M H

Steering Block

M H

Suspension Arm

M H

Rear Hub

M H

Suspension Arm

M H

Front Toe Out _____

Lower Arm Spacer _____ mm

Shock Tower Spacer _____ mm

Weight _____ g

Wheelbase Spacer _____

FF _____ mm

FR _____ mm

Flex Control

Aluminum

Composite

Composite (2 Dot)

Bearing

Rear Toe In _____

Shock Tower Spacer _____ mm

Weight _____ g

Front Tire Additive Area

Bump Steering Spacer _____ mm

1

2

Rear Tire Additive Area

Suspension Mount Setup

FF

1 Aluminium Spill

0.5 Brass Solid

FR

1 Aluminium Spill

0.5 Brass Solid

RR

1 Aluminium Spill

0.5 Brass Solid

RF

1 Aluminium Spill

0.5 Brass Solid

Flex Control

Graphite Chassis

Aluminum Chassis

Damper Setup

	Front	Rear
Spring	_____	_____
Oil	_____	_____
Rebound	_____	_____
Piston	_____	_____
Length	_____	_____
Foam Insert	<input type="checkbox"/>	<input type="checkbox"/>
Hole In Cap	<input type="checkbox"/>	<input type="checkbox"/>

Transmission Setup

Front _____

Oil _____

Weight _____ g

Position _____

Others

Servo _____ Tires _____

Esc _____ Additive _____

Motor _____ Body _____

Spur _____ P/ _____ T Rear Wing _____

Pinon _____ P/ _____ T FDR _____

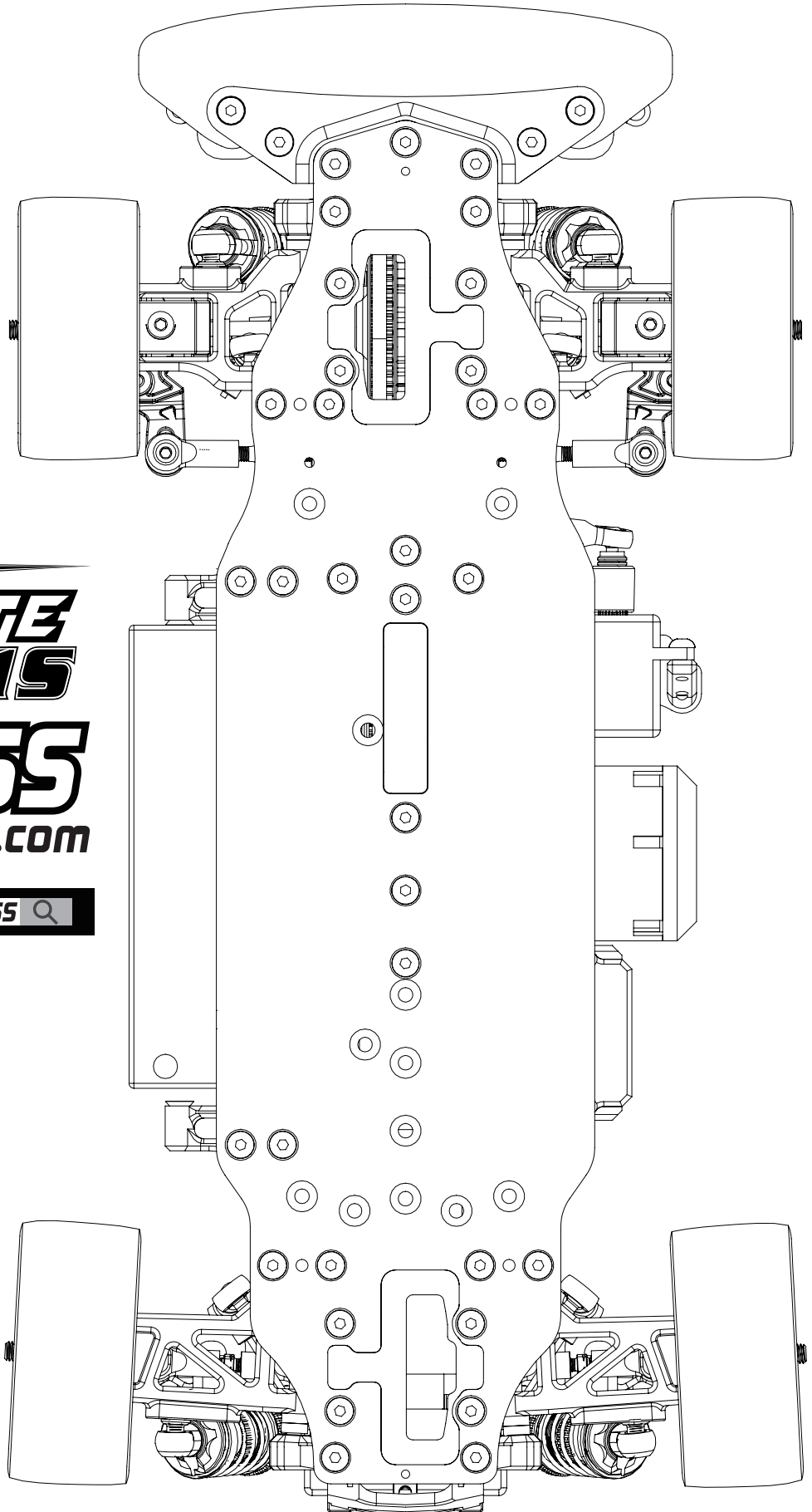

EXECUTE
1/10 SPORT FWD MINI TOURING CAR **FM15**

XPRESS
www.rc-xpress.com



RC XPRESS 🔍