

Open in So Dialed App

<input type="radio"/> Indoor	<input type="radio"/> Tight	<input type="radio"/> Smooth	<input type="radio"/> Hard Packed	<input type="radio"/> Blue Groove
<input type="radio"/> Wet	<input type="radio"/> Low Bite	<input type="radio"/> High Bite	<input type="radio"/> Outdoor	<input type="radio"/> Open
<input type="radio"/> Dry	<input type="radio"/> Dusty	<input type="radio"/> Med Bite	<input type="radio"/> Other	<input type="radio"/> Loose/Loamy

<b>ELECTRIC</b>		<b>ESC</b>	<b>MOTOR</b>		<b>BATTERY</b>	
<b>SPUR GEAR</b>		<b>T</b>	<b>PINION GEAR</b>		<b>T</b>	<b>Shoes</b> <input type="radio"/> 3 <input type="radio"/> 4 <b>Spring</b> <b>mm</b>
<b>Oil #</b>		<b>Oil #</b>		<b>Oil #</b>		
<b>T</b>	<b>X</b>	<b>T</b>	<b>Spur gear</b>		<b>T</b>	<b>T</b>

## FRONT SUSPENSION

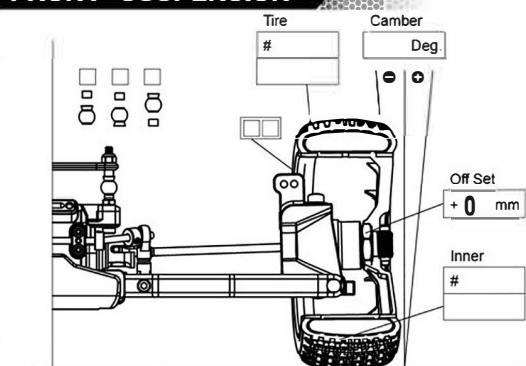

## FF

FF ☐ ☐ ☐

Y ☐ O ☐ B ☐

## FR

FR ☐ ☐ ☐

Y ☐ O ☐ B ☐

## RF

RF ☐ ☐ ☐

Y ☐ O ☐ B ☐

## RR

RR ☐ ☐ ☐

Y ☐ O ☐ B ☐

## REAR SUSPENSION

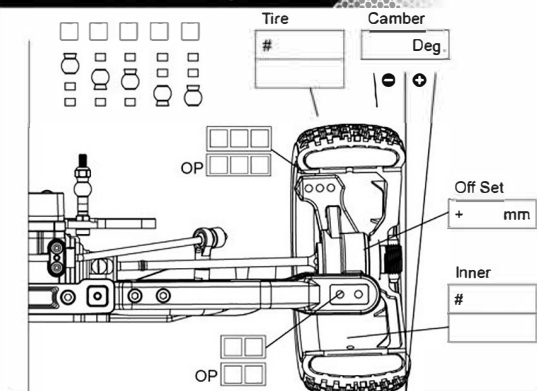

## FRONT TOE ANGLE

## CASTER ANGLE

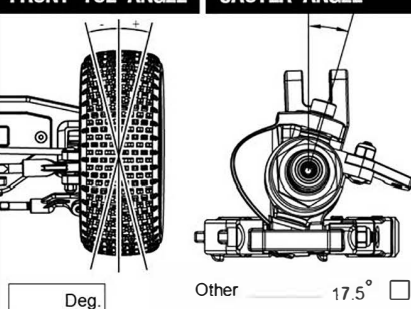

## ANTI ROLL BAR

FRONT

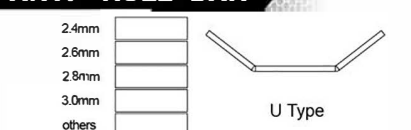

## WHEEL BASE



## ANTI ROLL BAR

REAR



## FRONT WING

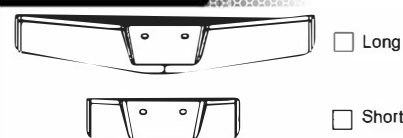

## RIDE HEIGHT

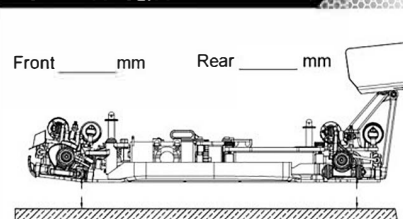

## CONFIGURATION

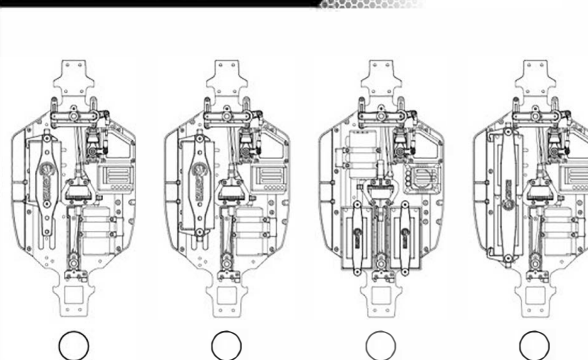

## FRONT SHOCK

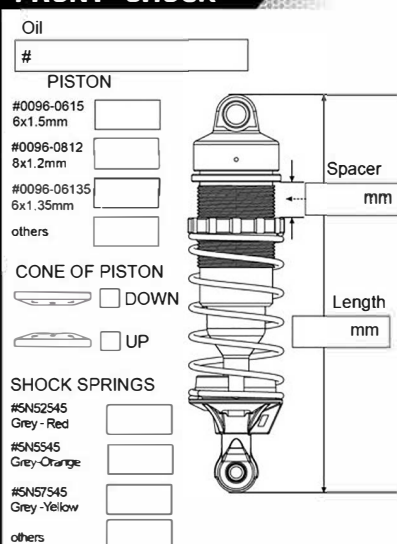

## REAR SHOCK

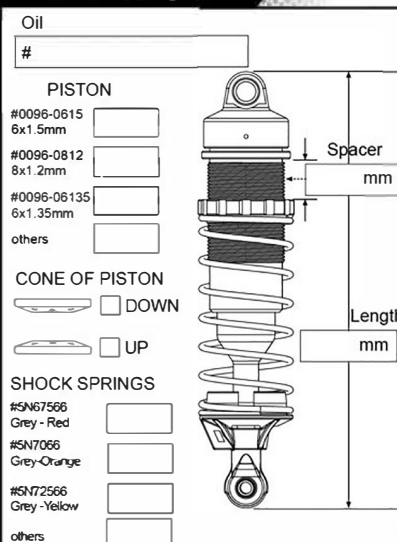

## DROOP LIMITER

