

Setup: My Base Setup

Full details in app: [sodialed.com/s/JRkq](https://sodialed.com/s/JRkq)

Driver

Herve Guinn

Date September 6, 2024 Track

Event

Track Condition

Temperature

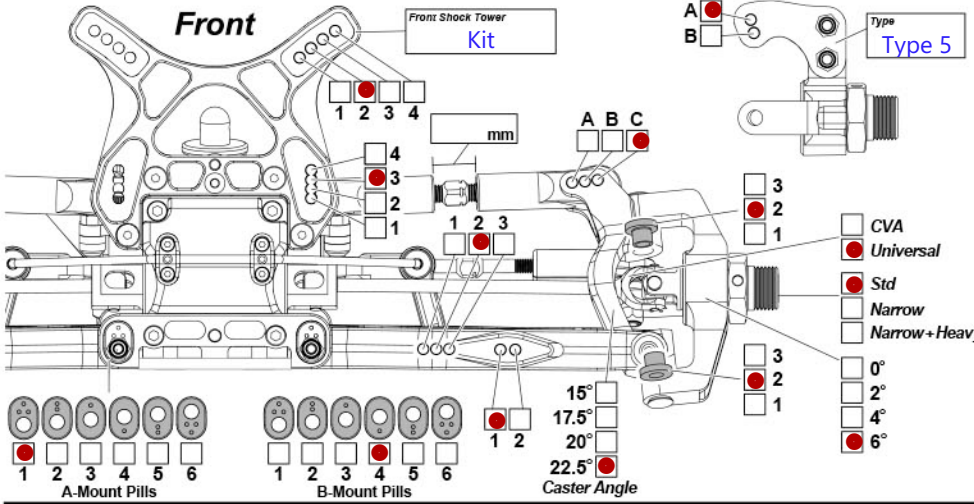

Ride Height 26 mm

Camber Angle -1.5 °

Toe Angle -2 °

Sway Bar 2.0 mm

Droop 0 mm

Shock Length mm

Shock Stroke mm

### Front Shocks

Oil weight 45 wt

Piston 5 x 1.5mm

Bladder Standard

Spring Yellow 73.8gF

Notes

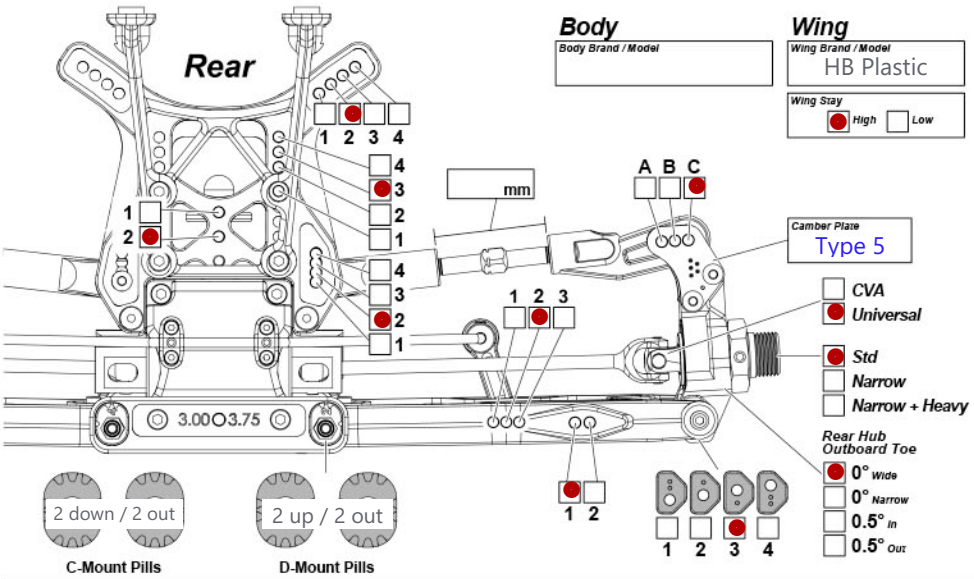

Ride Height 28 mm

Camber Angle -2 °

Toe Angle 3 °

Sway Bar 2.4 mm

Droop -5 mm

Shock Length mm

Shock Stroke mm

### Rear Shocks

Oil weight 40 wt

Piston 5 x 1.6mm

Bladder Standard

Spring Blue 61.6gF

Notes

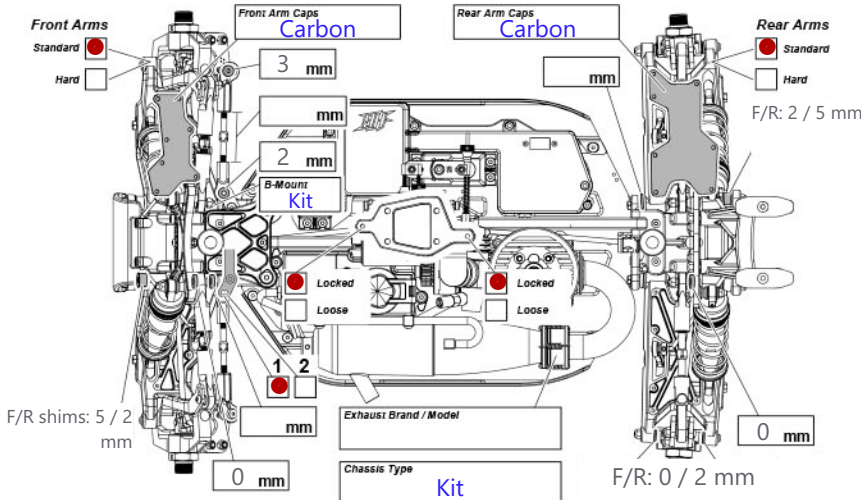

### Engine

Brand

Spur gear 48 Clutch Bell 13

Clutch shoes and springs: Aluminum shoes, 4 x 1.0 springs

Glow Plug

Glow Fuel

Tires	Front	Rear
Brand		
Compound		
Insert		
Wheel		
Notes		

Notes

### Diff Oils

	Front	Center	Rear
Brand			
Oil Weight / Grade	7,000	5,000	2,000