

Name: Wesley Knapp      December 29,      Event: Club Racing      Track: RC Excitement

Track Conditions      Setup: My Base Setup 3/21/25      [Open in So Dialed App](#)

Type: Indoor clay      Surface: Smooth       Blue Groove       Wet      Grip: High/Medium      Other: \_\_\_\_\_

Layout: Tight      Moisture: Dry       Dry       Dusty      Air temp: 13C/55F

**Front Suspension**

Ride Height	15	mm
Camber	-2	°
Toe	-1	°
Sway Bar	1.5mm	

Notes: -2 tower

V1 Composite  
 V1 Aluminum  
 V2 Aluminum

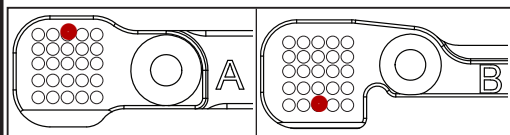
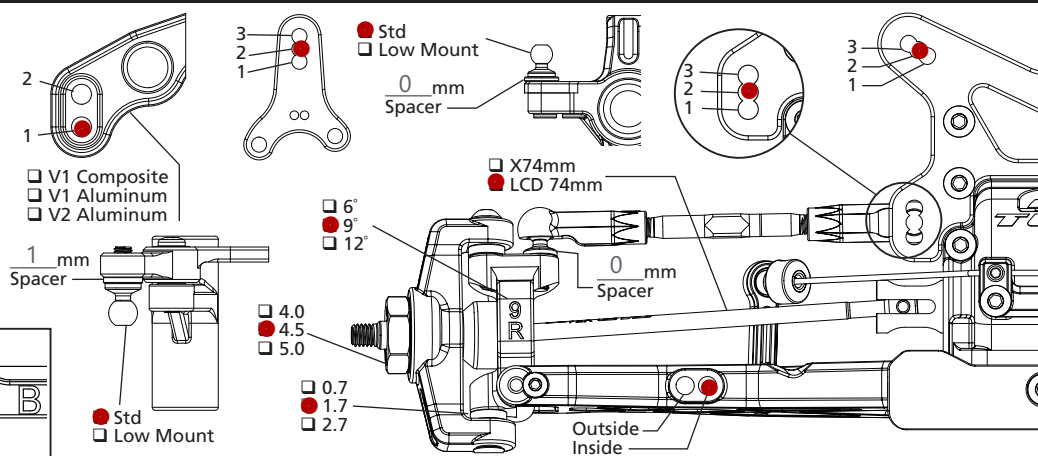

**Rear Suspension**

Ride Height	15	mm
Camber	-2	°
Sway Bar	1.5mm	mm

Notes:

Composite  Aluminum

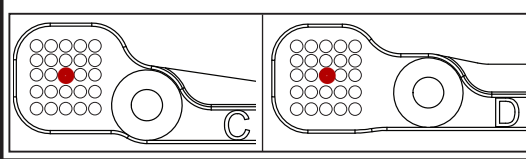
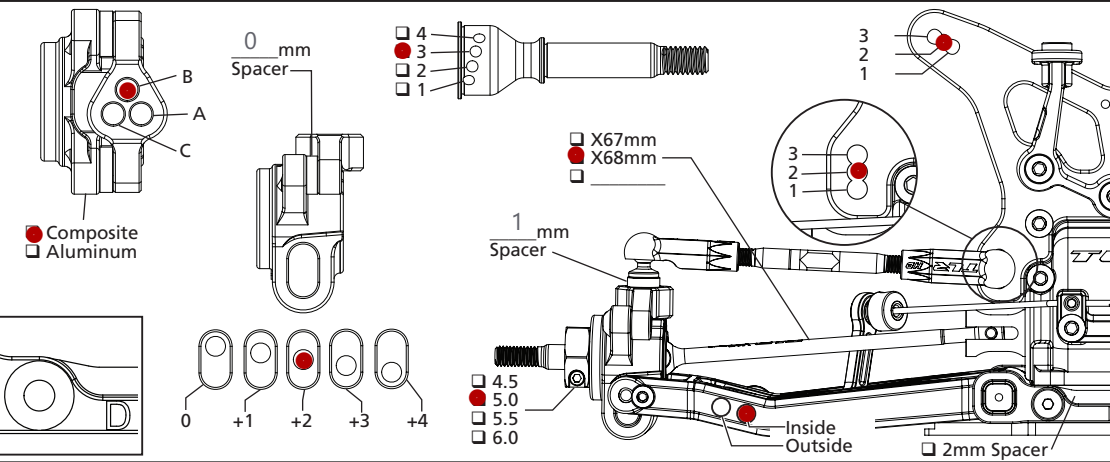

**Chassis**

	Fluid brand: Flash Point		
	Front	Center	Rear
Fluid	10,000 cst	500,000 cst	6,000 cst
Int Gears	Std <input checked="" type="checkbox"/> Comp <input type="checkbox"/>	Std <input checked="" type="checkbox"/> Comp <input type="checkbox"/>	Std <input checked="" type="checkbox"/> Comp <input type="checkbox"/>
Weight	19.4 g		19.4 g
Ring/Pin	Std <input type="checkbox"/> Comp <input checked="" type="checkbox"/>		Std <input type="checkbox"/> Comp <input checked="" type="checkbox"/>
Center Diff Cover	Composite <input checked="" type="checkbox"/> Aluminum <input type="checkbox"/>		
Slipper Pads	Differential		

Aerodynamics	
Body	Pro-Line Axis LW
Fr Scoop	TLR Scoop
Rr Wing	TLR Medium downforce 6.5"
Wicker	2nd line
Angle	0
Notes	

	Tires	
	Front	Rear
Brand	TZO	TZO
Tread		
Compound	Clay	Clay
Insert	Stock	Stock
Sauce	Pink FDJ	Pink FDJ
Wheel	Jconcepts	Jconcepts
Notes		

	Oil brand: Flash Point	
	Front	Rear
Shock Caps	Aluminum G3	Aluminum G3
Oil	425 cst	350 cst
Piston	G3 2 x 1.7mm	G3 2 x 1.8mm
Limiter, Int	Int/ext: 2/0 mm	0/0
Shaft Dia	Std 3.0mm <input type="checkbox"/> 3.5mm <input type="checkbox"/>	Std 3.0mm <input type="checkbox"/> 3.5mm <input type="checkbox"/>
Limiter, Ext		
Stroke	22.5 mm	30 mm
Eyelet	Std <input checked="" type="checkbox"/> +2mm <input type="checkbox"/>	Std <input checked="" type="checkbox"/> +2mm <input type="checkbox"/>
Spring	AE 13mm Orange	AE 13mm Blue
Spring Cup	Low <input type="checkbox"/> Mid <input checked="" type="checkbox"/> High <input type="checkbox"/>	Low <input type="checkbox"/> Mid <input checked="" type="checkbox"/> High <input type="checkbox"/>

Electronics			
Radio	Futaba	ESC	Hobbywing
Servo	ProTek	Thro Prof	
Battery	Trinity	Timing Adv	48 deg
Battery Wt		Initial Brake	
Motor	Trinity 13.5 t	Drag Brake	
Gearing	25 / 78	Thr/Bra EPA	100 % /

