

Instructions for Use (IFU)

1



IFU LANGUAGES

www.androvacuum.com/ifu/



VIDEOS

www.andromedical.com/videos



FAQs – QUESTIONS

www.androvacuum.com/faqs



MEDICAL CONSULTATION (online, chat & email)

www.androclinic.com

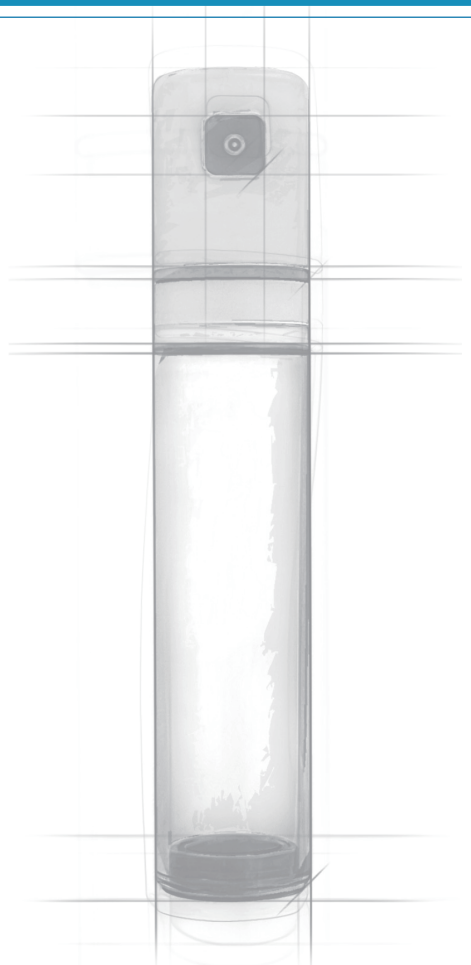

01

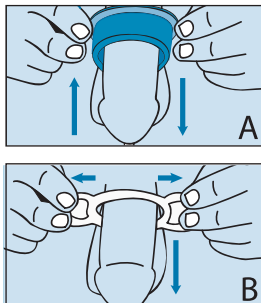

Please, choose the components according to the therapy and your penis size. For erectile dysfunction treatment, choose the cushioning ring (fig. A) and the constriction ring (fig. B) which fits your penis width better.

Bitte wählen Sie die zu Ihrer Therapie und Penisgröße passenden Bestandteile. Für erektile Dysfunktion, benutzen Sie den gepolsterten Ring (Abb. A) und den Einschnürungsring (Abb. B) der sich am Besten an Ihren Penis anpasst.

Sélectionner les composants suivants la thérapie à suivre et la taille de son pénis. Pour le traitement de la dysfonction érectile, sélectionner l'anneau amortisseur (image A) et l'anneau de constriction (figure B) qui s'adaptera mieux à la taille de son pénis.

Selecione los componentes según la terapia a seguir y el tamaño de su pene. Para el tratamiento de la disfunción eréctil, seleccione el anillo de amortiguación (figura A) y el anillo de constricción (figura B) que más se adapte al grosor de su pene

Selezionate i componenti in base alla terapia da seguire e alla dimensione del vostro pene. Per il trattamento della disfunzione erettile, selezionate l'anello di ammortizzazione (fig. A) e l'anello di costrizione (fig. B) che si adattino meglio alla dimensione del vostro pene.

治療のタイプとペニスのサイズにあった付属品を選んでいきます。
勃起不全の治療: ゴムパッキン(図A)と、ペニスの太さに合ったシリコンバンド(図B)を選んでください。

من فضلك ، اختر المكونات حسب العلاج وحجم قضيبك . لعلاج
ضعيف الانتصاب ، اختر حلقة التوسيد (الشكل أ) وحلقة الانقباض
(الشكل ب) التناسب عرض قضيبك بشكل أفضل

02

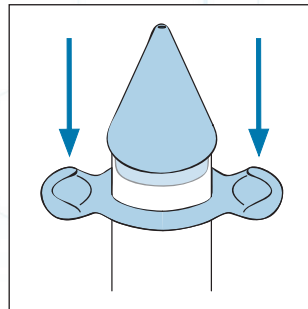

Fit the cone at one end of the cylinder. Apply lubricant gel to the cone of the cylinder and slide on the constriction ring until the ring snaps on to the cylinder.

Den Kegel auf ein Ende des Zylinders stecken. Gelschmiermittel in den Kegel am Zylinder auftragen und den Schließring aufziehen bis der Ring um den Zylinder aufliegt.

Fixez le cône à une extrémité du cylindre. Appliquez du gel lubrifiant sur le cône du cylindre et faites glisser sur lui l'anneau de constriction jusqu'à ce que l'anneau entoure le cylindre transparent.

Encaje el cono en un extremo del cilindro. Aplique gel lubricante en el cono del cilindro y deslice por él el anillo de constricción hasta que el anillo encaje en el cilindro.

Fissare il cono ad una estremità del cilindro. Applicare lubrificante sul cono ed introdurre l'anello di costrizione facendolo scorrere attraverso il cono fino a raggiungere il cilindro.

シリンドーにコーン型のアダプターを取り付け、潤滑剤(ジェル)を塗り、シリコンバンドを滑らすようにしてシリンドーにはめます。

ضع المخروط في أحد طرفي الأسطوانة. ضع هلام التشحيم على
مخروط الأسطوانة وحركه على حلقة الانقباض حتى تستقر الحلقة
على الأسطوانة



03

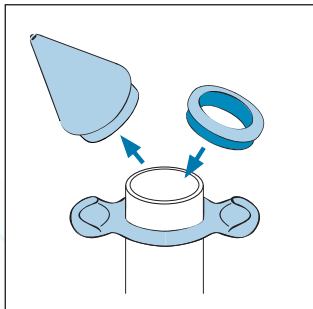

Remove the cone of the cylinder. Snap rings in place and place in the selected cushioning rings after applying Gel Lubricant.

Den Kegel vom Zylinder entfernen und an dessen Stelle die gewählten Dämpfungsringe anbringen und Gelschmiermittel auftragen.

Retirez le cône du cylindre et mettez à sa place, le ou les anneaux amortisseurs choisis et appliquez du gel lubrifiant sur eux.

Retire el cono del cilindro. Encaje en su lugar los anillos amortiguadores seleccionados y aplique gel lubricante sobre los mismos.

Rimuovere il cono del cilindro. Introdurre nel cilindro gli anelli ammortizzatori scelti e applicare gel lubrificante sugli stessi.

シリンダーからコーン型のアダプターを取り外し、シリンダーにゴムパッキンをはめ込み、潤滑剤(ジェル)を塗ります。

قم بإزالة مخروط الأداة من مكانها وضعها في حلقات التوسيد المحددة بعد وضع مادة التشحيم الهلامية

04

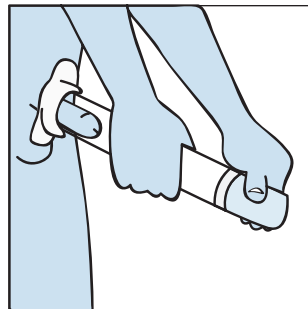

On the other end of the cylinder, snap in the electric motor, when fitted correctly there will be no movement and there will be a perfect seal.

Den Elektromotor auf das andere Ende des Zylinders stecken. Das Gerät ist dann richtig verschlossen wenn es nach dem Einschalten keine Bewegung vorweist.

À l'autre extrémité du cylindre, enclenchez le moteur électronique. Vous savez que le moteur est correctement enclenché s'il n'y a pas de jeu entre les pièces.

En el otro extremo del cilindro, encaje el motor electrónico. Sarà correttamente montato se non ci sarà movimento e tiene holgura.

Montare all'altra estremità del cilindro, il motore elettronico. Sarà correttamente montato se non ci sarà movimento e aderirà perfettamente.

シリンダーのゴムパッキンが付いていない方に、モーターのついた電源装置をはめ込みます。(しっかりととはめ込めているかを確認するようにしてください。)

على الطرف الآخر من الأسطوانة ، قم بإدخال المحرك الكهربائي ، عندما يتم تركيبه بشكل صحيح لن تكون هناك حركة وسيكون هناك ختم مثالي



05

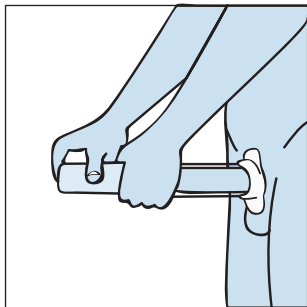

Insert the penis into the cylinder where the ring buffers are in place, insert the penis all the way until the pubis. I may be easier to create a vacuum if the hair is trimmed or shaved on the pubis where it is in contact with the cylinder.

Schieben Sie den Penis bis an Ihr Schambein ein. Wenn Sie an dieser Stelle Ihr Schamhaar rasieren kann es leichter sein, ein Vakuum herzustellen.

Insérez le pénis dans le cylindre jusqu'à l'appuyer sur le pubis. Il sera plus facile de créer un vide si la zone qui soutient le cylindre est épilée.

Introduzca el pene por la parte del cilindro con los anillos amortiguadores, hasta apoyarlo en su pubis. Puede resultar más fácil crear el vacío si se recorta el vello de la zona en la que se apoya el cilindro.

Inserire il pene attraverso il cilindro nella parte dove ci sono gli anelli ammortizzatori finché il cilindro non arrivi a toccare il pube. Può essere più facile creare il vuoto, se i peli sono tagliati nella zona che sostiene il cilindro.

シリンドーをペニスにかぶせ、ペニス全体が入ったら、しっかりと恥骨側に押さえます (シリンドーが当たる部分の陰毛を手入れすると、より簡単にアンドロバキュームを使用いただけます)。

دخل القضيب في الاسطوانة حيث توجد مخازن الحلقة ، أدخل القضيب بالكامل حتى العانة قد يكون من الأسهل صنع فراغ إذا تم قص الشعر أو حلقه في منطقة العانة حيث يكون ملامسًا للأسطوانة

06

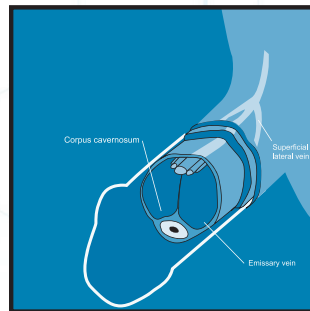

With one hand, hold the cylinder tight against the pubis, with the other hand press the motor button and start the motor. For manual model, grasp the motor with your hand and make up-and-down movements.

Halten Sie den Zylinder mit einer Hand gegen Ihr Schambein und betreiben Sie den Motor mit der anderen. Beim manuellen Modell fassen Sie den Motor mit der Hand und machen Auf- und Abwärtsbewegungen.

D'une main, maintenez le cylindre contre votre pubis et de l'autre actionnez le moteur électronique. Pour le modèle manuel, saisissez le moteur avec votre main et faites des mouvements de haut en bas.

Con una mano sujete el cilindro contra su pubis y con la otra accione el motor electrónico. Para el modelo manual, agarre el motor con la mano y haga movimientos hacia arriba y hacia abajo.

Con una mano, tenere il cilindro contro il pube e con l'altra, azionare il motore elettronico. Per il modello manuale, afferrare il motore con la mano ed eseguire movimenti di salita e discesa.

片手は器具を恥骨側に押さえるようにし、もう一方の手で、電源ボタンを操作するようにします (圧力が急激にかかることはありませんので、ご安心ください)。手動式の場合は、手でモーターをつかみ、上下に動かしてください。

بإحدى يديك ، امسك الأسطوانة بإحكام على العانة ، وباستخدام اليد الأخرى ، اضغط على زر المحرك وابدأ تشغيل المحرك. بالنسبة للطراز اليدوي ، امسك المحرك بيدك وقم بحركات لأعلى ولأسفل



07

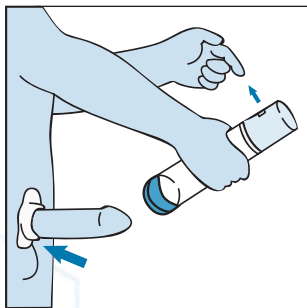

After achieving a full erection, slide the correct size of constriction ring down the outside of the cylinder and set at the base of the penis. Stop the vacuum by pressing the red button on the electric motor to release air back into the cylinder.

Nachdem Sie eine Erektion erreicht haben schieben sie den Schließring vom Zylinder über den Penis bis an dessen Anschlag. Lassen Sie die Luft in den Zylinder fließen indem Sie auf den roten Knopf am Elektromotor drücken und nehmen Sie den Zylinder ab.

Après avoir obtenu une érection, faites glisser l'anneau de constriction depuis le cylindre jusqu'à la base de la verge. Une fois que l'anneau est en place sur la verge, libérez l'air du cylindre en appuyant sur le bouton rouge du moteur électronique et retirez le cylindre.

Tras lograr la erección, deslice el anillo de constricción desde el cilindro y ajústelo en la base del pene. Libere el arie del cilindro pulsando el botón rojo del motor electrónico y retire el cilindro.

Dopo aver raggiunto l'erezione, far scorrere l'anello di costrizione dal cilindro fino alla base del pene. Liberare l'aria del cilindro premendo il tasto rosso del motore elettronico e rimuovere il cilindro.

勃起したら、シリンドラにつけてある、シリコンリングをペニスの根元に滑らすように移します。シリコンリングをペニスの根元についたら、電源装置にしている赤いボタンを押し、シリンドラの中に空気を入れ、器具を取り外すようにしてください。

بعد تحقيق الانتصاب الكامل ، حرك الحجم الصحيح لحلقة الانقباض لأسفل خارج الأسطوانة واضبطها عند قاعدة القضيب. أوقف الفراغ بالضغط على الزر الأحمر على المحرك الكهربائي لإخراج الهواء مرة أخرى إلى الأسطوانة



08

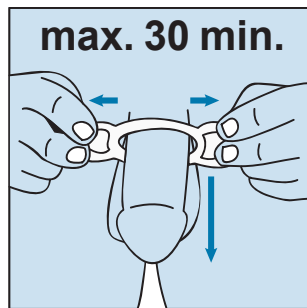

The constriction ring will keep blood in the penis and therefore hold the erection. It can be worn for up to 30 minutes.

Der Schließring wird die Erektion und die Durchblutung aufrechterhalten. Er darf höchstens 30 Minuten lang benutzt werden.

L'anneau de constriction maintiendra l'irrigation et l'érection. Il peut être porté jusqu'à 30 minutes au maximum.

El anillo de constricción mantendrá la irrigación y la erección. Puede llevarse puesto 30 minutos como máximo.

L'anello di costrizione manterrà l'irrigazione e l'erezione. Può essere indossato fino a 30 minuti al massimo.

シリコンリングで、陰茎内に血液を送りこんだ状態を保つことができます。30分以上の連続使用は控えるようにご注意ください。

ستحافظ حلقة الانقباض على الدم في القضيب وبالتالي تحافظ على الانتصاب. يمكن ارتداؤها لمدة تصل إلى ٣٠ دقيقة



Method Of Use

Read Before Use

Table of Contents

	Page
1. QR CODES AND LINKS	1
2. QUICK GUIDE	2
3. ABOUT Androvacuum®	7
4. DEVICE COMPONENTS	8
5. MEDICAL INDICATIONS	9
6. SELECT COMPONENTS	10
7. GUIDE TO USING THE SYSTEM	11
8. INSTRUCTIONS FOR USE	13
9. INSTRUCTIONS FOR USE FOR ERECTILE DYSFUNCTION	14
10. INSTRUCTIONS FOR USE FOR PENILE REHABILITATION	15
11. COMMON PROBLEMS AND SOLUTIONS	16
12. PRECAUTIONS	17
13. PORTFOLIO	19

NOTE: Androvacuum® has the following models: **Androvacuum® Premium** (with automatic motor, Deluxe model) and **Androvacuum® Manual** (with manual motor, Pro model).

The user instructions are the same for all models, with minor variations.

3 About Androvacuum®

Androvacuum® is a medically-proven top-grade penis pump which is a non-invasive, safe and effective solution to follow a **Penile Rehabilitation** routine and induces on demand drug-free instant erections as a solution to Erectile Dysfunction.

Ergonomically designed and engineered, **Androvacuum®** consists of a cylinder that fits over the penis, with an electronic or manual motor to create suction and induce a vacuum environment around the penis which draws blood into it and helps the penis to become engorged.

Please, read first, (only for model with battery):

Step 1- To remove the battery cover press on the arrow head and push up. See picture 1A.

Step 2- Insert the batteries into the battery compartment as indicated.

Step 3- Slide the battery cover back in place.

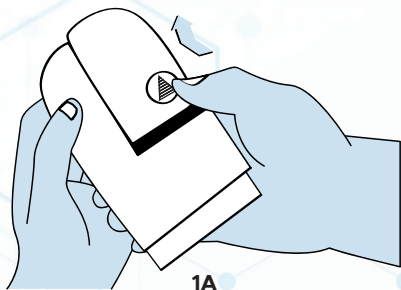

Notes: Read instructions carefully and completely before using **Androvacuum®**.

If directions are not followed, **Androvacuum®** will not work.

After inserting the batteries, check that the motor is working properly by pressing the ignition button firmly.

4 Device Components

Cushioning Ring: adapter necessary to keep the vacuum inside the cylinder.

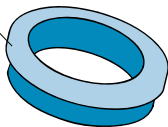

Manual vacuum release button.
It allows to reduce the negative pressure that is generated inside the cylinder.

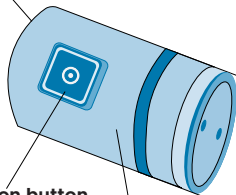

Activation button

Electronic or Manual Vacuum Motor
provides a quick seal

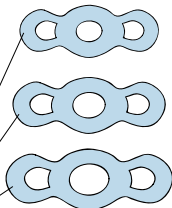

Erection Assistant Rings / Constriction Rings:
to help maintain the erection. For different penile thicknesses.

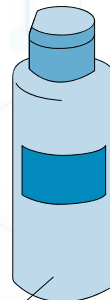

Sealing Gel for personal use

Note: Sealing gel is not included in the pack, only available in Pharmacies.

Medical Grade Removable Cylinder

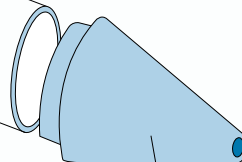

Easy Loading Conical System fits into penile tube to assist in placing ring on penile tube

ERECTILE DYSFUNCTION

Androvacuum® is meant for the treatment of Erectile Dysfunction. Millions of men are estimated to be affected. Erectile Dysfunction could be a sign of the existence of a serious blood flow or nerve problem. Erectile Dysfunction is often the side effect of a medication you may be taking. If you suspect this, talk to your doctor. You should never change or stop taking medication without first consulting your doctor. Smoking, alcoholism and drug abuse can all contribute to an erectile disorder.

Erectile Dysfunction Therapy with **Androvacuum®**, recommended for:

- ❑ Men who sometimes fail to get a full erection due to stress, excitement or fear.
- ❑ Men who easily get an erection but have problems maintaining it.
- ❑ Men with erection problems of all ages, even those who haven't achieved an erection in several years.
- ❑ Men with erection problems who can not take anti-ED drugs due to heart problems.

PENILE REHABILITATION

Vacuum environments increase blood flow into the penis when becoming engorged. Over time, regularly induced vacuum environments make the corpus cavernosum adapt to these continuously demanding situations. The penis ends up producing the referred increased blood flow by itself, even when no vacuum environment is created. This implies that the sexual organ reacts faster and stronger to sexual stimulation. A prolonged erection problem can lead to shrinkage of the penile tissues and a reduction in penile circulation (non-use atrophy). Regular use of **Androvacuum®** will duplicate benefits of nocturnal erections, reversing penis shrinkage, reconditioning penile circulation and promoting a return to good penis health. **Androvacuum®** can help to stretch tissues back to their normal state within as little as 4 weeks of regular use, combined with an improvement in penile circulation. At the same time, you would be inducing full penile engorgement and promoting good penile health.

Penile rehabilitation therapy with **Androvacuum®**, recommended to:

- ❑ Men experiencing weak erections.
- ❑ Men experiencing progressively weaker erections due to aging process, sedentary lifestyle, alcohol or tobacco consumption as well as high cholesterol or high stress levels.
- ❑ Men with low levels of testosterone (TDS or hypogonadism) and on hormonal supplementation.
- ❑ Men after prostatectomy, prostate surgery Peyronie's disease surgery or penile surgeries.

6 Select Components

1. Start with the largest Erection Assistant Rings. If you are unable to hold the vacuum and the erection with the largest rings, gradually use the next smallest Erection Assistant and Cushioning Ring until you are able to hold the vacuum and the erection.
2. Set the cylinder (with the smooth end up) on a flat surface. Place the Easy Loading Conical System in the penile tube.
3. Lubricate the entire surface of the Easy Loading Conical System with the sealing gel.
4. Grasp the two handles of the Erection Assistant Ring as shown. Place your thumb tips on top of the ring next to the Easy Loading Conic System and pull the ring down. Your thumb tips should glide along the surface of the Easy Loading Conical System. Place the Erection Assistant Ring near the end of the tube for later easy loading onto the base of the penis (do not load the ring onto the tube by pulling the handles, they may tear).

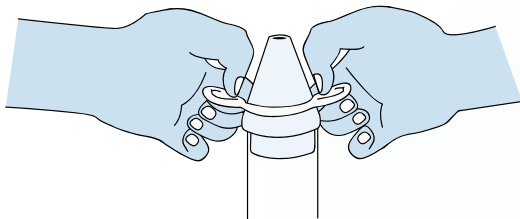

5. Remove the Easy Loading Conical System and attach the cylinder to the Vacuum Electronic Motor. Twist the cylinder on the motor 1/4 turn, locking it in place. Do not over tighten. Install the Cushioning Ring in the open end of the penile tube.
6. Running warm water over the cylinder (before attaching the motor) will help prevent the cylinder from fogging during use.

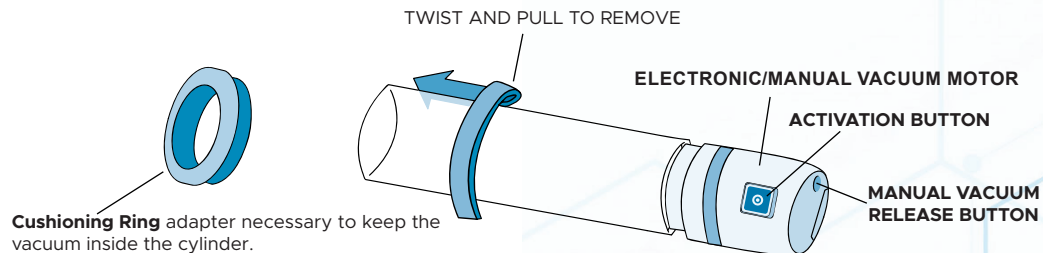

ERECTION ASSISTANT RINGS

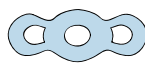
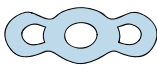
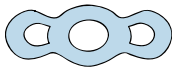

One of the most important steps is properly fitting the Erection Assistant Rings. To keep blood in the penis, the ring must fit comfortably tight, but should be no tighter than necessary. If **Androvacuum®** is giving you a good erection but with the Erection Assistant Ring is becoming loose while wearing it for five minutes or less, you need to try the next smaller ring.

Thirty minutes is the maximum recommended time period for wearing the Erection Assistant Rings. If worn longer, permanent damage is possible.

After the correct size ring has been decided, it will only take a few minutes to get an erection.

DO NOT WEAR AN ASSISTANT RING MORE THAN 30 MINUTES.

Androvacuum® will assist you in reaching a full and satisfying erection in most cases.

- ❑ Allow a minimum of 60 minutes between uses.
- ❑ Do not fall asleep wearing the Erection Assistant Ring.
- ❑ Erection Assistant Rings should not be used as a birth control method.
- ❑ Use the largest Erection Assistant Ring which holds an erection.
- ❑ Do not use Erection Assistant Rings while using alcohol or drugs.
- ❑ Frequent use of Erection Assistant Rings may result in bruising at the base of the penis (where the shaft of the penis meets the pubic area). Temporary side effects may include some bruising of the penis or some small red spots below the skin. Use caution and plenty of water soluble lubricating jelly when removing the support ring.
- ❑ Do not use oil based lubricants such as petroleum jelly, as they will be harmful to the Erection Assistant Rings and other latex type material such as condoms. Only use water soluble lubricating and sealing gel.

7 Guide To Using The System

MANUAL VACUUM RELEASE BUTTON AND VACUUM ENVIRONMENT CREATION

Your penis should become filled and rigid without pain in 10 to 90 seconds. You may feel pressure when your penis starts to become erect from the vacuum, which is normal. If you feel a slight pain when your penis becomes filled, try a lower vacuum level by pushing the manual vacuum release button (with a little practice you should find your correct vacuum level, so that you can create a full erection).

The manual vacuum release button can be pushed to lower the vacuum level. If too much vacuum is released, it can be easily increased by depressing the activation button.

To remove the penis from the Cylinder, push the manual vacuum release button until the vacuum pressure is gone. You can then remove the Cylinder.

Most men with Erectile Dysfunction will lose most of their erection soon after removing their penis from the Cylinder. This problem can be solved by correctly fitting the Erection Assistant Ring. On the other hand, if you find that you have enough of an erection for intercourse, you may not need to use the Erection Assistant Ring. You may be able to have a good sex life while only using the **Androvacuum®** device without the Erection Assistant Rings.

REMOVING THE ERECTION ASSISTANT RING

Caution: Do not wear the Erection Assistant Ring for more than 30 minutes.

Remove the ring by pulling the side loops outwards. The ring will stretch, allowing blood to move from the penis. You can then pull the Erection Assistant Ring off easily. To prevent tangling the Erection Assistant Ring in the pubic hair, try a little sealing gel in the hair before putting on the ring.

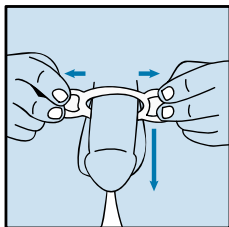

RECOMMENDED

Men's health
supplement



Andropharma Vigor

FOR ERECTILE DYSFUNCTION:

1. Lubricate your penis, the inside of the cylinder and pubic hair area (the area that comes in contact with the cushioning ring), with the sealing gel. This helps form a good vacuum seal to your body and prevents the penis from sticking to the walls of the cylinder.
2. Insert the penis into the cylinder and start the vacuum process. For electronic motors, operate the motor depressing the activation button. For manual motors, grasp the motor with your hand and make up-and-down movements until you get enough vacuum to obtain an erection. Depress the button for approximately 10 seconds, that should create a seal between the system and your body. Continue pressing the button until you have developed a sufficient vacuum. Use the least amount of vacuum necessary to obtain an erection.
3. As soon as the desired erection is achieved, transfer the Erection Assistant Ring from the cylinder onto the base of the penis with your fingertips. Make sure the Erection Assistant Ring is transferred all the way around. Any vacuum that is left can be released by depressing the manual vacuum release button. Practice a few times without the Erection Assistant Ring.

FOR PENILE REHABILITATION:

4. The therapeutic use of **Androvacuum®** once a day, from 5 to 7 times per week, may help to maintain penile length, dilate arteries and oxygenate penile tissues. Regular use of **Androvacuum®** can promote full erectile function. You do not need to use the Erection Assistant Rings. During a session of penile rehabilitation, we recommend you should aim to produce 5 erections or use **Androvacuum®** for at least 5-10 minutes. Never operate the motor to the point of causing pain.

- Note 1.** After you have been using the **Androvacuum®** for 30 to 60 days, you may want to recheck the sizing of the rings to be used. For example, you may find that you are now able to use the next size larger rings. Using the larger ring may increase comfort.
- Note 2.** Some couples may prefer to stop intercourse at least once and reuse the **Androvacuum®**.
- Note 3.** If a condom is desired it should be applied after an erection is formed.
- Note 4.** Following use, the Erection Assistant Ring, the Cushioning Ring and Cylinder can be washed with soap and water, dried and stored. Make sure the Erection Assistant Ring bag is air free and tightly sealed for longer life. Do not ever put the motor in water.

ATTENTION

When placing the Cylinder on the pump head, **DO NOT OVER TIGHTEN**. Twist one quarter (1/4) turn to tighten. Twisting too hard or too far will break your system. If this happens it **WILL NOT** be covered under warranty!

9 Instructions For Use

(FOR ERECTILE DYSFUNCTION)

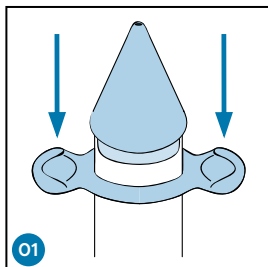

Slide the Erection Assistant Ring over the Easy Loading Conical System and onto the end of the Cylinder.

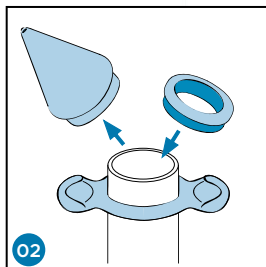

Remove the Easy Loading Conical System and load the Cushioning Ring.

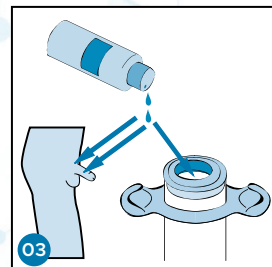

Lubricate your penis, the inside of the Cylinder and your pubic hair with sealing gel.

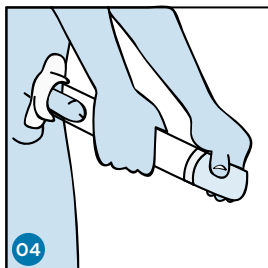

Insert your penis into the prepared Cylinder.

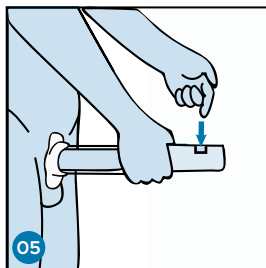

Start the vacuum process, depending on your model electronic or manual.

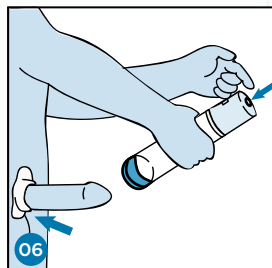

Once erection is achieved, slide the Erection Assistant Ring onto the base of the penis. Once ring transfer is complete you are ready.

10 Instructions For Use

(FOR PENILE REHABILITATION)

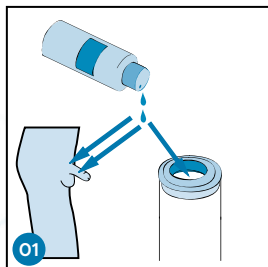

01 Apply the Sealing Gel on the edge of the Vacuum Cylinder and on the entire length of the penis.

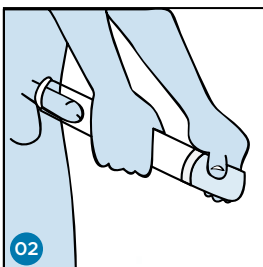

02 Insert the penis into the Cylinder. For manual model, grasp the motor with your hand and make up-and-down movements. For electronic model, follow the step 3.

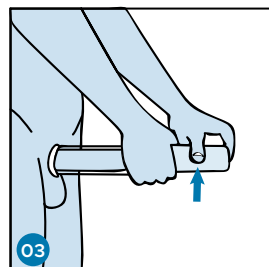

03 Operate the motor for 10 seconds and then stop for 5 to 10 seconds to slowly create a vacuum environment. Repeat until you gain a full erection.

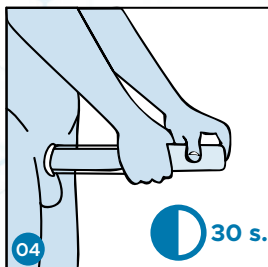

04 When you have reached a full erection, wait 30 seconds prior to releasing the vacuum. Tightness and some pressure is normal and expected.

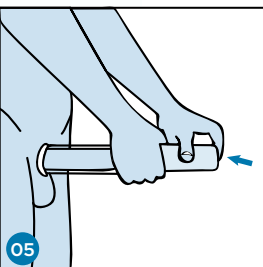

05 After 30 seconds, release the pressure within the Cylinder by pushing the red button.

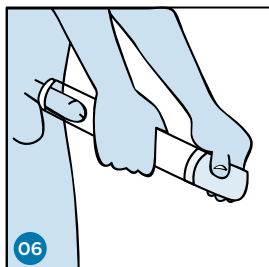

06 Wait until the penis has returned to a flaccid state and repeat the start-and-stop process again until bringing the penis back to a full erection.

PROBLEM	LIKELY CAUSE	REMEDY	COMMENTS
No erection	No vacuum because of air leak caused by poor seal	Use more sealing gel; apply firm pressure to body; trim pubic hair; check system for air leaks	Problem is most often associated with inexperience; it stops as you become better at using the system
Partial erection	Not enough practice sessions	More practice using system	Problem most often improves with continued use of system
Rapid Loss of erection (in less than 5 minutes)	Vacuum lost because of air leak, poor seal, poor lubrication, or too much pubic hair, too large support ring	Same as for "No erection". Use smaller or double support rings; remove support ring carefully	Require that you experiment with varying sizes support rings; see your doctor if you need help or support to continue
Pulling of the skin of the scrotum	Sealing gel on scrotum; improper pumping technique; inexperience with system	Remove sealing gel from scrotum; continue with practice sessions; angle cylinder downward during pumping	Problem may disappear as you become better at using the system
Discomfort or pain during pumping	Too rapid pumping; pulling of scrotal tissue	Slower pumping; continue to use the system	Problem usually stops as you become better at using the system
From Erection Assistant Ring	Erection Assistant Ring too small; anxiety	Use larger Erection Assistant Ring; continue to use the system	Problem usually stops as you continue to use the system
During intercourse	Poor lubrication; pressure on a sensitive area	More lubrication; position changes	
During ejaculation	Long periods without sex; infection or swelling of the prostate gland	Continue to use System	Problem usually stops as you continue to use the system; if pain or discomfort continues, see your doctor
Redness, irritation or bruising	Too rapid pumping; overpumping	Slower pumping; fewer pumps	Consult your doctor if this problem continues past the first few practice sessions
Penis feels cold (to you or your partner)	Constriction of blood flow to the penis; lubrication	Wash off lubricant or warm lubricant before use	
Penis pivots on its base	Constriction of blood flow to the penis	If manageable, apply the system after you have a partial erection	

12 Precautions

The potential risks identified in the literature are temporary and includes: Penile bruising, Penile pain, Penile numbness and Inability to ejaculate.

- ❗ You will feel pressure while applying **Androvacuum®**. This is not harmful. If you feel discomfort, however, it may be a signal that you are pumping too quickly. Simply press the manual vacuum release button, wait a moment and start again.
- ❗ Your penis turns slightly bluish in color after you apply the Erection Assistant Ring. This may be a normal response to the increase of blood in the penis. The bluish color should disappear when you remove the support ring.
- ❗ You experience some petechiae (tiny reddish spots beneath the skin) or bruising of the penis when you first begin using **Androvacuum®**. This may happen by placing the penis under too much vacuum pressure for too long, and too fast, or after a long period of not having an erection. If this happens, stop using **Androvacuum®** until spots or bruises completely disappear, about five to seven days.
- ❗ You or your partner notice a slight drop in the temperature of the penis. This coolness is normal and not harmful. It is a normal response to the reduced blood flow caused by the support ring.
- ❗ Your erection has a “hinge” effect. The penis may pivot at its base when the ring is in place. If this occurs, you may find it necessary to try different positions with your partner for successful intercourse.
- ❗ Your semen does not flow through at point of climax. The pressure of the Erection Assistant Ring may interfere with the ejaculation process. This is not harmful, and does not affect climax. Your semen may flow out when you remove the ring. Erection Assistant Rings are not a means of contraception or birth control and should not be used to avoid pregnancy.
- ❗ Your penile Cylinder develops condensation on the inside. This is simply the result of the heat from your body reacting with the sealing gel. “Fogging” can be reduced by running warm water over the Cylinder and then drying it before use.
- ❗ Use of **Androvacuum®** may bruise or break the blood vessels either right below the surface of the skin or within the deep structures of the penis or scrotum, resulting in bleeding or the forming of a blood filled swelling. Do not be too concerned if you notice some bruising of the penis, or small reddish spots below the skin. This is likely to happen if you have not had sex for some time. You should stop using the system until the problem has cleared up (5 or 6 days). When you do use the system again, be careful not to apply more vacuum than feels comfortable. Use caution and plenty of water soluble sealing gel when removing the Erection Assistant Ring.

12 Precautions

- ❗ If you have signs of Erectile Dysfunction, (i.e., unable to get an erection that is strong enough for sexual intercourse), talk to your doctor before using this system to avoid a possible harmful delay in discovering any of the most common causes of this condition, such as diabetes, multiple sclerosis, cirrhosis of the liver, chronic renal failure, or alcoholism.
- ❗ Do not wear the Erection Assistant Ring for longer than 30 minutes. It could cause pain, bruising, a blood blister, or permanent injury to the penis. Consult your doctor if any problems occur and stop using the system if they continue.
- ❗ If you do not follow these instructions you may cause personal injury.

Androvacuum® will not cure relationship problems or correct physical problems such as low sex drive, decreased sensation, and absent or premature ejaculation.

If you have Sickle Cell Trait or Disease, a history of prolonged erections, or are taking large quantities of aspirin or other blood thinners, do not use **Androvacuum®** without consulting your doctor.

- ❗ Misuse of **Androvacuum®** or its Erection Assistant Rings may worsen already existing medical conditions such as Peyronie's Disease (a condition that causes distortion or abnormal bends of the erect penis), prolonged erection, and blocked urethra (urinary tract).
- ❗ Misuse of **Androvacuum®** or its Erection Assistant Rings could result in swelling of the penis or serious permanent injury to the penis.
- ❗ Frequent use of the Erection Assistant Rings may result in bruising at the base of the penis (where the shaft of the penis meets the pubic area), blood blister or pain.
- ❗ Caution is advised when using **Androvacuum®** following the removal of a penile implant because of possible scarring and later impairment. Apply the vacuum gradually. Look for bruising or distortion of the penis.
- ❗ The devices can't be used with men who have had bleeding disorders, sickle cell anemia or priapisms.

PORTFOLIO



www.andropenis.com

Increase penis size with traction therapy and treat micropenis.



www.andropeyronie.com

Reduce penile curvature and treat Peyronie's disease.



www.androvacuum.com

Improve erections with vacuum therapy and treat erectile dysfunction.



andromedical.com/shop

Spare parts and accessories



www.andropharma.com

PENIS

Increase the own testosterone levels and improve penile lengthening.

VIGOR

Increase men's sexual desire and achieve long lasting erections.

CURVATURE

Inhibit the fibrous plaque of Peyronie with natural anti-inflammatories.

Further information, updates, privacy policy, return-refund policy, disclaimer and conditions of warranty can be found at: www.andromedical.com

© Copyright 1995-2023 Andromedical®, Madrid (Spain).