

Harbour Health Assisted Living

Osprey • Studio

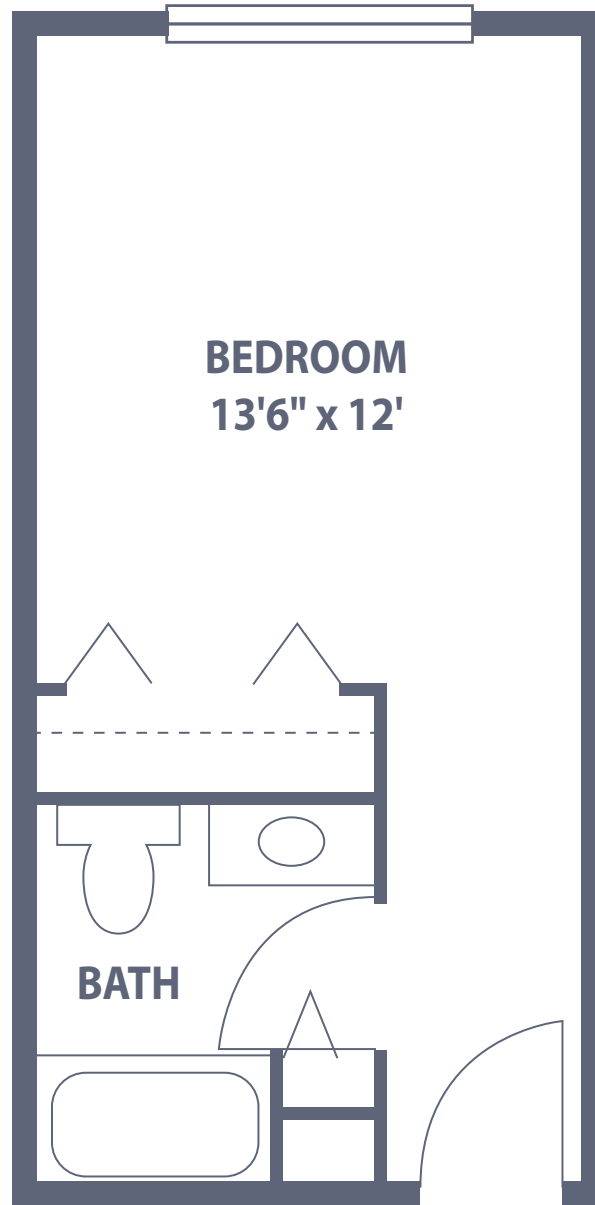

Dimensions are approximate.
Floor plans may vary.

Harbour Health Assisted Living and Memory Care
23013 Westchester Blvd. • Port Charlotte, FL 33980
941-625-1100 • SouthPortSeniorLiving.com

Managed by  Life Care Services® 

Harbour Health Assisted Living

Naples • Suite

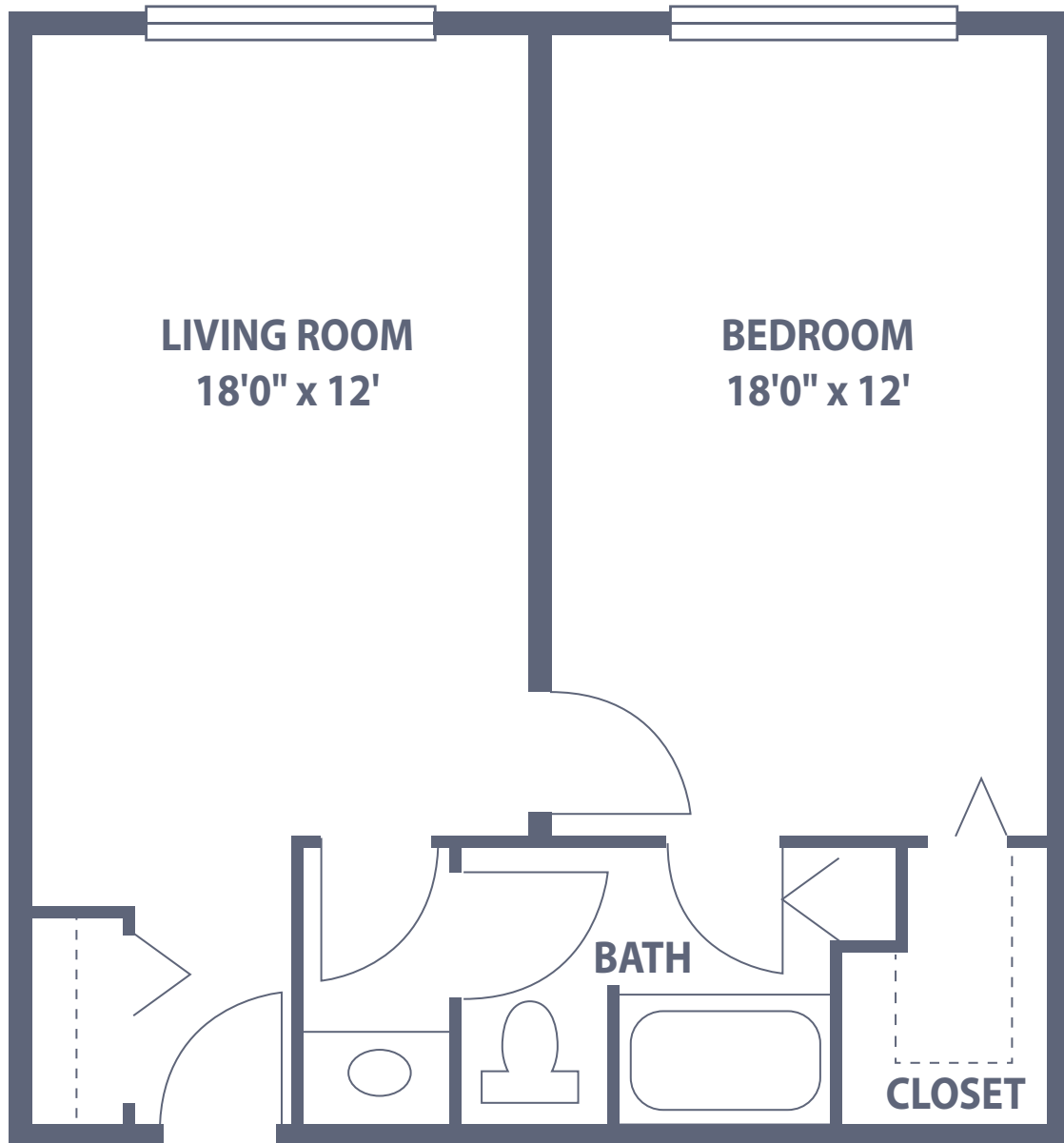

Dimensions are approximate.
Floor plans may vary.

Harbour Health Assisted Living and Memory Care
23013 Westchester Blvd. • Port Charlotte, FL 33980
941-625-1100 • SouthPortSeniorLiving.com

Managed by  Life Care Services® 

Harbour Health Assisted Living

Sarasota • Suite

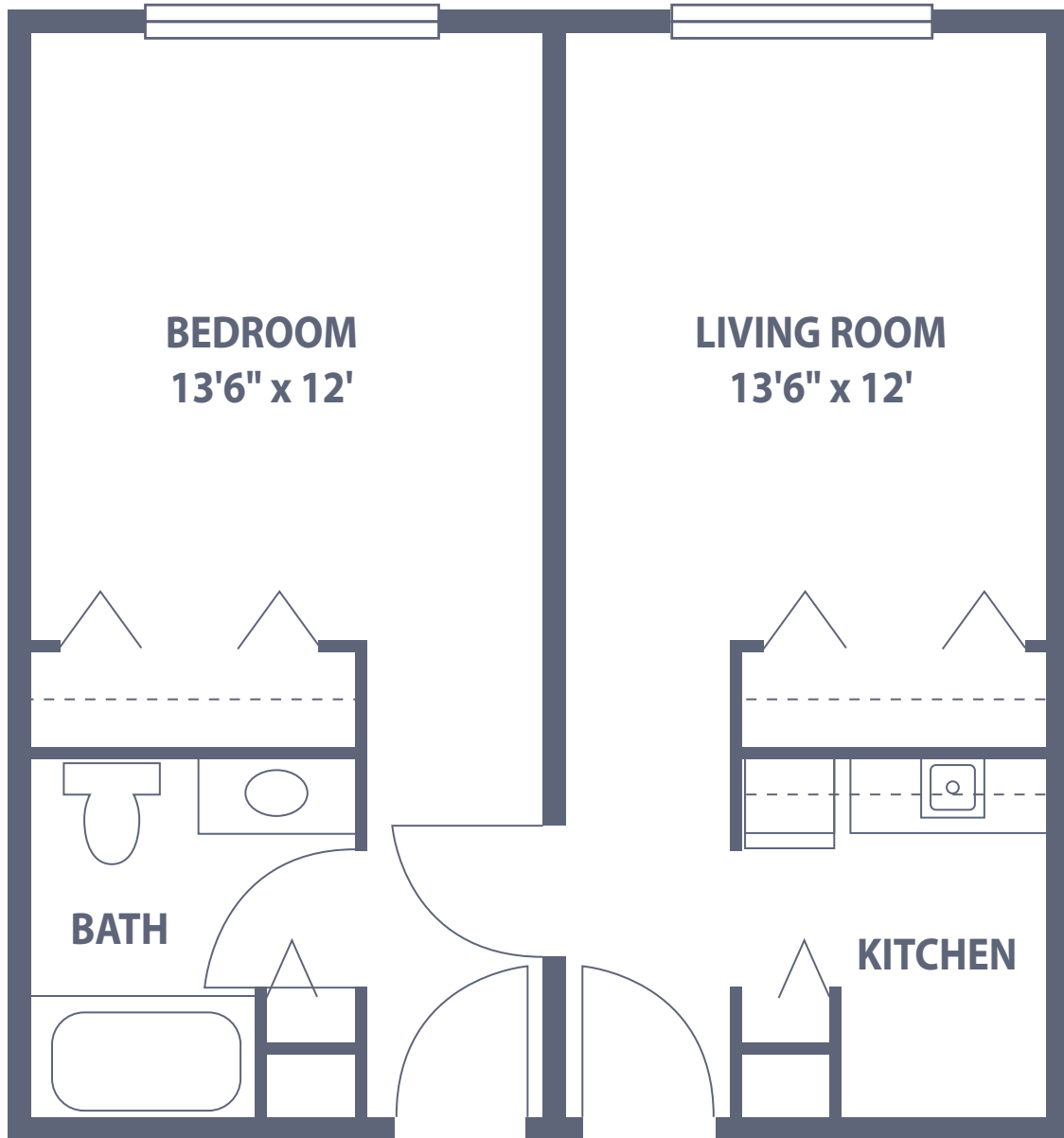

Dimensions are approximate.
Floor plans may vary.

Harbour Health Assisted Living and Memory Care
23013 Westchester Blvd. • Port Charlotte, FL 33980
941-625-1100 • SouthPortSeniorLiving.com

Managed by  Life Care Services® 