



**HIGH PERFORMANCE
FLOORING AND TILING PRODUCTS**

**MARCH 2017
SYSTEM DATA SHEET**

FIXING CERAMIC AND PORCELAIN WALL TILES TO MARMOX MULTIBOARD



- 1a. Uneven wall surface with perimeter band of ARDEX MICROTEC X 77 Flexible Wall & Floor Tile Adhesive
- 1b. Flat wall surface with ribbed bed of ARDEX MICROTEC X 77 Flexible Wall & Floor Tile Adhesive
2. Marmox Multiboard with joints sealed with Marmox Self-Adhesive Waterproof Tape (wet areas) or Marmox Reinforcing Tape (dry areas)
3. ARDEX MICROTEC X 77 Flexible Wall & Floor Tile Adhesive
4. ARDEX-FLEX FL Rapid Setting Flexible Tile Grout for Wide Joints or ARDEX-FLEX FS Flexible Tile Grout for Narrow Joints

Movement joint

DIRECT BONDING (DRY & WET AREAS)

This system applies to clean, sound brick, block or concrete walls.

(A) UNEVEN WALL SURFACES

The minimum thickness of Marmox Multiboard suitable for this application is 20mm. The Marmox Multiboard should be fixed to the wall using ARDEX MICROTEC X 77 Flexible Wall & Floor Tile Adhesive. The ARDEX adhesive should be applied either as perimeter strips or as adhesive dabs. Whilst the adhesive is still fresh and moist, the Marmox Multiboard should be placed onto the wall and thoroughly beaten in using a timber batten to ensure good all round contact and a flat surface.

All joints between the boards should be sealed during fixing using Marmox Self-Adhesive Waterproof Tape in wet areas, or Marmox Reinforcing Tape in dry areas.

(B) FLAT WALL SURFACES

The minimum thickness of Marmox Multiboard suitable for this application is 6mm. The Marmox Multiboard should be fixed to the wall using ARDEX MICROTEC X 77 Flexible Wall & Floor Tile Adhesive. The ARDEX adhesive should be applied to the existing sound wall surface or directly to the Marmox Multiboard, using an 8mm x 8mm square toothed and notched trowel to give a ribbed bed over the complete area. The board is then placed onto the wall surface and tapped into position.

All boards should be butt jointed, and all joints between the boards should be sealed during fixing with a Marmox Tape, as described in (A).

DOWEL FIXING ONLY

Where the wall is flat but either surface preparation cannot be provided and contamination will prevent adhesion, or where the surface is insufficiently sound but the wall structure beneath is solid, the Marmox Multiboard can be fixed using Marmox dowel fixings at a rate of 5 per square metre.

All the joints between the boards should be sealed during fixing with a Marmox Tape, as described in (A).

TILE FIXING

The tiles should be bedded on the Marmox Multiboard once the adhesive securing the board has hardened, after approximately 8 hours. Tiles should be fixed using ARDEX MICROTEC X 77 Flexible Wall & Floor Tile Adhesive, ensuring no voids are left behind the tiles. Once the tile bed has hardened sufficiently, after approximately 8 hours, the joints between the tiles can be grouted using ARDEX-FLEX FL Rapid Setting Flexible Tile Grout for Wide Joints or ARDEX-FLEX FS Flexible Tile Grout for Narrow Joints.

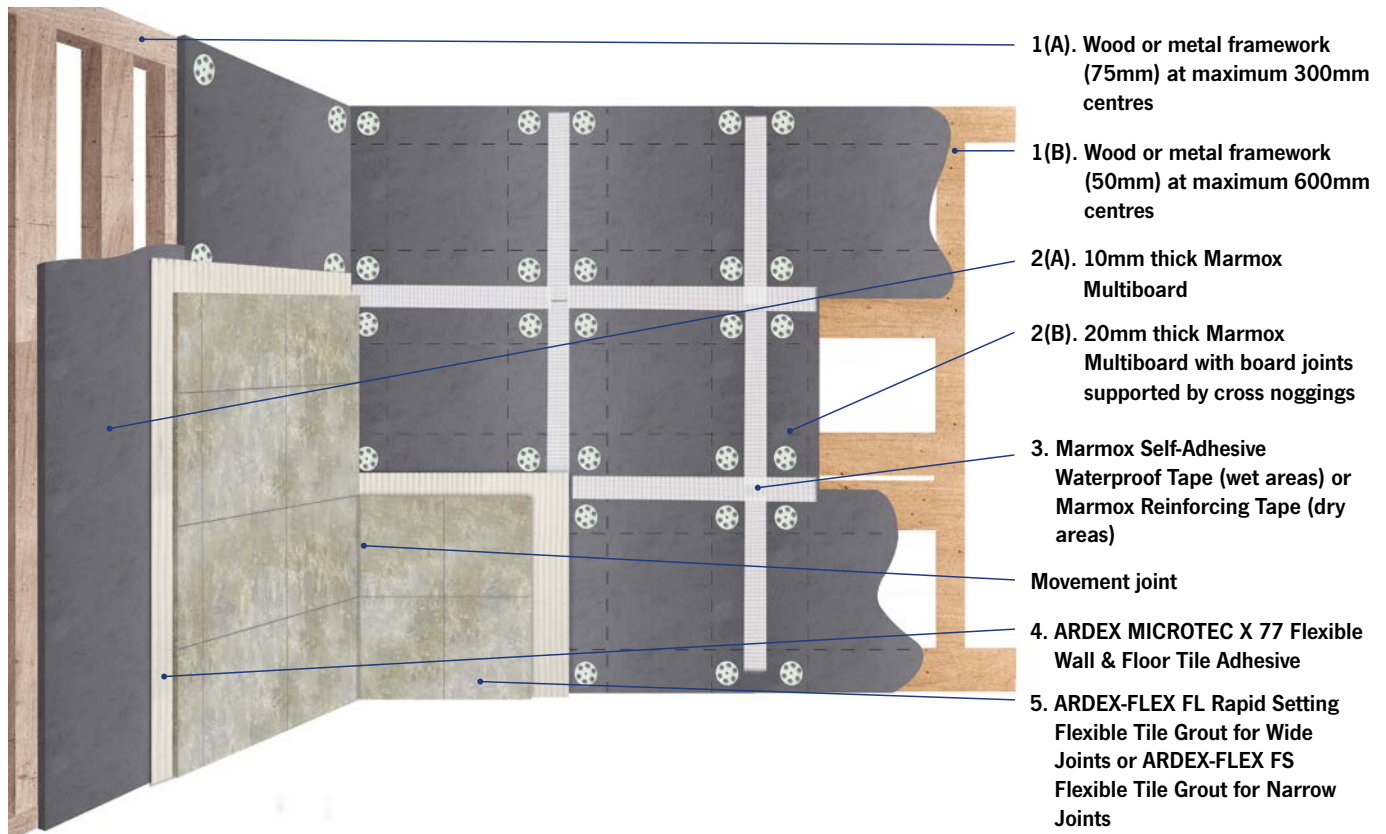

STUD WALLING/PARTITIONS (DRY & WET AREAS)

This system uses timber or metal studing designed to provide rigid support for Marmox Multiboard.

Marmox Multiboard should be fixed to the framework using stainless steel screw fixings and washers at a rate of 5 per square metre and two per batten (600mm centres); the fixings should be a minimum of 30mm from the edge of the Marmox Multiboard. The screw washer fixing should be tightened into the board until the screw head is flush with the surface; if required, it can be driven flush with the board surface using a rubber headed mallet and the screw then re-tightened.

All joints between the boards should be sealed during fixing using Marmox Self-Adhesive Waterproof Tape in wet areas, or Marmox Reinforcing Tape in dry areas.

NOTE FOR FRAMEWORK LAYOUT (A)

The minimum thickness of Marmox Multiboard suitable for this layout is 10mm. The maximum unsupported span is 300mm, and all board edges must be supported.

NOTE FOR FRAMEWORK LAYOUT (B)

The minimum thickness of Marmox Multiboard suitable this layout is 20mm. The maximum unsupported span is 600mm.

TILE FIXING

The tiles should be bedded on the Marmox Multiboard once the adhesive securing the board has hardened, after approximately 8 hours. Tiles should be fixed using ARDEX MICROTEC X 77 Flexible Wall & Floor Tile Adhesive, ensuring no voids are left behind the tiles. Once the tile bed has hardened sufficiently, after approximately 8 hours, the joints between the tiles can be grouted using ARDEX-FLEX FL Rapid Setting Flexible Tile Grout for Wide Joints or ARDEX-FLEX FS Flexible Tile Grout for Narrow Joints.

This advice is intended for general guidance. For further information, please consult the relevant product datasheets at www.ardex.co.uk and www.marmox.co.uk

NOTE: The information supplied in our literature or given by our employees is based upon extensive experience and, together with that supplied by our agents or distributors, is given in good faith in order to help you. Our Company policy is one of continuous Research and Development; we therefore reserve the right to update this information at any time without prior notice. We also guarantee the consistent high quality of our products; however, as we have no control over site conditions or the execution of the work, we accept no liability for any loss or damage which may arise as a result thereof.

ARDEX UK Ltd Homefield Road, Haverhill, Suffolk CB9 8QP. Telephone: 01440 714939 Fax: 01440 716640
Email: technical_admin@ardex.co.uk **ARDEX online: www.ardex.co.uk**

MARMOX UK Ltd Caxton House, 101-103 Hopewell Drive, Chatham, Kent, ME5 7NP. Telephone: 01634 835290 Fax: 01634 835299
Email: sales@marmox.co.uk **Website: www.marmox.co.uk** Twitter: @MarmoxUK Facebook: Marmox UK Ltd