



Clay County Free Press

Home of the Clay County Golden Delicious Apple



Volume 135 No. 10

Periodical Postage Paid at Clay, West Virginia 25043-0180

Thursday, May 23, 2024

\$1.⁰⁰

Clay County Judicial Annex gets closer to completion



Pictured from left to right are County Clerk Shelia Stone, Commissioner Joyce Johnson, and Commission Connie Kinder.

By Gary Lee Stuber

Two gentlemen from ZMM Architectural Firm, Adam Krason and Nathaniel Spencer, gave a presentation before the Clay County Commission during their latest meeting regarding an update of the redesign of the interior of the county's Judicial Annex. Following the flood of 2016 some redesign was necessary, and they felt ready to present changes to the commission before the board would jointly join them in a presentation to the West Virginia Supreme Court of Appeals who must finalize the design changes.

They provided two boards: an overhead view of the original design and a second board of proposed changes. Among the changes suggested was the addition of a very private door that would allow for the sudden exit of a judge. Sheriff King reminded them of the special door for the Sheriff, and they remembered and agreed to add that to the designs. There was another proposed change that needed returned to original specs where a clerk's

office was requested beyond the file room that could be locked, and yet the file room remains open. Otherwise the commission appeared happy with the design. Final approval would of course be up to the Supreme Court.

Commissioners Joyce Johnson and Connie Kinder were present and Commissioner David Schoolcraft was present by phone. They approved routine business such as wills, testaments, administrators and executor assignments. But when it came to paying bills, Commission Kinder noted that the county owed a \$3 million dollar jail bill. Last month alone, the bill was \$63,091.70. The prior month was \$75,000 and the month before that was \$59,000, at rates of \$1,961.40 per month per person or \$65.30 per person per day. As crime rises, so does the debt. Presently the county cannot pay this bill. They can only pay a pittance against it.

The commission accepted the resignation of Gary Drake from the Clay County

ANNEX cont. on page 7

CMI2 raises top beam for AEF Base Camp Building in Lizemores



Members of the CMI2 Adaptive Experimentation Facility (AEF) team in Clay County post with the final beam for the AEF Base Camp building along Route 16, including (l-r) Jared Lane, Elijah Morton, Shane Morton, Chris Hamrick, Walter Hatfield, Eric Thomas, and Adam Landers. Not pictured: Josh Walker, Brent Deboard, Derrick McCune, Ethan Nottingham, Landon Williams, and Micah Osborne.

CMI2 is making significant strides toward opening its new Adaptive Experimentation Facility (AEF) in Lizemores. Early Monday morning, the AEF staff signed the final steel beam before it was hoisted into place. The original building along Route 16 will soon house the AEF Base Camp for equipment, offices, and vehicles. Since CMI2 purchased the property in early March, the staff has worked to remove the interior walls, reinforce the exterior walls, replaced the roof on the main building, and added sewer and power for recreational vehicles/campers.

"Raising the top beam for the AEF Base Camp facility in just two months is a testament to our team's unwavering dedication to this project in Lizemores as we build a premier training and experimentation destination," said Walter Hatfield, Vice President of Training and

Experimentation. "Moving the facility as we stand up a new location is a significant task, but our team is incredible."

In conjunction with the activities in Lizemores, the AEF staff is working to decommission the existing temporary location in the Fola-Bickmore area by July 2024.

Local vendors and businesses supporting the Lizemores development include: Shane Morton, Morton Excavating Jody Pierson, Pierson Construction Jimmy Bodkins, Jimbo Trucking Trinity Vance, Legg Welding Tom and Aaron Vance, Vance Welding Amron Building Components Duane Legg, Legacy Foods "We deeply appreciate the unwavering support and invaluable partnerships from the people of Lizemores and throughout Clay County," Hatfield said. "We are excited for the future."



Graduation ceremonies held for high school seniors

By Gary Lee Stuber

The 108th annual Commencement and Baccalaureate Service was held at Clay County High School on May 18, 2024. Hundreds of family members and friends were present to watch 123 seniors walk across the stage and accept their diplomas. This included 99-year-old World War II veteran Charles Edward Bird, who was recognized by the US Congress and was gifted a flag that was flown over the US Capitol in his honor. His granddaughter Ashdon Miley Salisbury was also a graduating senior in this class. She just turned 17. There were 25 National Honor Society Members in this class. Principal Tanner announced that more

than \$50,000 worth of scholarships were awarded this year to Clay County seniors.

Music, including Pomp and Circumstance, was performed by James D. Ployar who directed the Clay County Concert Band. The Star Spangled Banner was performed by the Tanners (gospel group). Inspirational reading was performed by third ranking student Mr. Zane Minger; Salutatory Address by Miss Taylor Adkins; and the Valedictory address was performed by Mr. Issac Brown, Miss Gracey Champ, and Mr. Dylan McCumbers. Later, the Benediction would be given by fourth ranking students Miss Natalie Coleman and Miss Maggie Smith.

GRADUATION cont. on page 3

Area students named to Dean's, President's List at SNHU

Janae Grose of Ivydale has been named to Southern New Hampshire University's (SNHU) Winter 2024 President's List. The winter terms run from January to May. The following students have been named to the Winter 2024 Dean's List: Elizabeth Cullum of Bickmore, Zachary Griffin of Ivydale, Andrew Adamson of Spencer, and Virginia Adams of Spencer.

Full-time undergraduate students who have earned a minimum grade-point average of 3.700 and above for the reporting term are named to the President's List, and full-time undergraduate students who have earned a minimum grade-point average of 3.500 to 3.699 for the reporting term are named to the Dean's List.

Full-time status is achieved by earning 12 credits over each 16-week term or

paired 8-week terms grouped in fall, winter/spring, and summer.

Southern New Hampshire University (SNHU) is a private, nonprofit institution with a 91-year history of educating traditional-aged students and working adults. Now serving more than 225,000 learners worldwide, SNHU offers approximately 200 accredited undergraduate, graduate and certificate programs, available online and on its 300-acre campus in Manchester, NH. Recognized as one of the "Most Innovative" regional universities by U.S. News & World Report and one of the fastest-growing universities in the country, SNHU is committed to expanding access to high quality, affordable pathways that meet the needs of each learner. Learn more at www.snhu.edu.

Unofficial Primary Election results released

The results of the May 14 Primary Election have been released by the Secretary of State's office with the following totals:

There were 2,070 ballots cast out of 5,250 registered voters in Clay County, or 39.43% voter turnout. Of those, 1,092 cast were Republican, 869 were Democrat, 107 were Nonpartisan, and 2 were Mountain Party.

RESULTS cont. on page 2

Panther track team competes at states



The 2024 shuttle hurdle team (top row, L-R) Daymian Stricker, Justin Nida, (bottom row L-R) Takota Quinn and Evan Bass

See story on Page 8

BOOKED



CLAY COUNTY



Joyce Marie DeMoss
Booked 5/19/24
Capias



Louis Richard Koch
Booked 5/16/24
Contempt



Adam Dwayne Parsons
Booked 5/15/24
Bond revocation



Ronnie Shane Dodrill
Booked 5/18/24
No registration, DUI third offense, driving revoked for DUI, no insurance



Justin Clayton Lee Flanagan
Booked 5/17/24
Delivery of a controlled substance, child abuse



Gary Gene Losh
Booked 5/17/24
Interfering with emergency communications

BRAXTON



Andrew Clayton Slaughter
Booked 5/16/24
Domestic battery, unlawful assault



OBITUARY

Brenda Joyce (Legg) Blaney, 79, of Bethesda, OH, joined her Lord and Savior, Jesus Christ, on May 18, 2024, following an extended illness. She was born on October 2, 1944, to the late R. Brooks Legg, Sr., and Monica (Moore) Legg of Indore, WV. In addition to her parents, she was preceded in death by her infant brother, Fredrick; sister, Carolyn Cruikshank; sister-in law, Diann Legg; in-laws, Guy and June Blaney; and brother-in-law, Robert Lurvey.

Brenda graduated from Clay County High School in 1962. She earned a Bachelor of Arts Degree in Elementary Education at Morris Harvey College, Charleston, WV, and later a master's degree in Reading and Literacy at West Virginia University. She began her teaching career at Brown Elementary in Indore, and continued to teach in Covington, Va, Sherrard Elementary (Marshall County), WV Belmont Technical, St. Clairsville Oh. She loved teaching students of all ages, especially the skill and love for reading. She volunteered her teaching at local libraries to assist countless adults in learning to read and improving comprehension and fluency.

During her time at WVU, she met the love of her life, James R. Blaney. They married on February 21, 1970. Together, they built a life of faith, love and unwavering dedication to family.

Brenda's long life is attributed to God's amazing grace and, in part, to a medical miracle in 1957 when she had heart surgery under Dr. Blalock and Dr. Taussig at Johns Hopkins Hospital. She was only the fifth patient to undergo the surgery and the third to survive.

Brenda enjoyed spending time with Jim and their family making memories. She loved and enjoyed helping animals. As a member of her local Belmont County Cat Stray Shun organization, she and Jim rescued numerous cats and mended them back to health.

She leaves to cherish her memory her beloved husband, Jim, of 54 years; her brother, Dr. Russell B Legg, Jr of Lizemores, WV; Kenneth D. Legg (Kathy), of Indore, WV; Sister-In-Law, Patricia Lurvey of Longmont, Co, brother-in-law Teleford Cruickshank of Okeechobee, Fla, additionally, she leaves her nieces and nephews whom she loved dearly; Elaine (Brian) Swallow, TG (Angela) Cruikshank, Carol and (Robert) Bond, Duane Legg, Jeanne (Eric) Carson, Jonathan Legg, Dr. Sally Ann (Spencer) Cruikshank-Elliott, Dr. Lydia Legg, Brooks Legg, Alexandra & Paige Cruikshank, Eric & Katelyn Bond, Patrick and Isaac Swallow, Sierra Wilson & Tyler Carson. Special adopted nieces; Rebecca (Pat) of Woodway, Tx. & Bebbie Shaver of Houston Tx.

The family will be forever grateful to the Nurses, Care Team & Residents at Montgomery Nursing and Rehabilitation Center for the exceptional, loving care and friendship Brenda received.

Graveside Services will be held on Wednesday, May 22, 2024, at 1:00 p.m. in the Cline Family Cemetery, Indore, WV., with Doug Newell & Jonathan Baileys officiating.

Puzzle Answers

Weekly SUDOKU

Answer

2	6	4	1	9	5	3	8	7
9	3	5	7	2	8	6	1	4
7	8	1	6	3	4	9	5	2
5	2	3	8	4	9	7	6	1
8	1	6	2	7	3	5	4	9
4	7	9	5	6	1	2	3	8
6	4	2	3	8	7	1	9	5
1	9	7	4	5	6	8	2	3
3	5	8	9	1	2	4	7	6

Super Crossword

Answers

MOCHA	SALAAM	ARMSRACE
USUAL	PIUSVI	DIOCESES
GOLDEN	ARCHES	ADVANCES
SLIT	DREINCO	EERILE
ENOLA	DAUGHTER	OFZION
AMA	OKRA	NEATONSA
FIRST	OLAF	STUNAPS
TOYOTA	SEQUOIA	UPSILON
TAXI	UNRATED	HELLA
TAM	LEIA	AGATEJASPER
ONEDGE	RFK	OSUAMTRAK
OSXYO	SEMITE	LIAM
TWINE	VANESSA	LALA
LECARRE	ALPINE	GLACIER
EROS	ARI	ETNA
TAN	NOLIN	VERB
GMCYUK	ONDENALI	ASCOT
OIL	SLR	SOVARKS
AVE		
ALEUTIAN	NATIONAL	PARK
TEARINTO	IDUNNO	ARTIE
SYRINGES	DETEST	PIECE

REGIONAL JAIL MUGSHOTS

NICHOLAS COUNTY

RESULTS

Continued from Page 1

Area winners include:

County Commissioner – Republican nominee:
Duane Legg: 831 votes

County Commissioner – Democrat nominee:
Connie Kinder: 570 votes

County Clerk – Democrat:
Sheila Stone: 692 votes

Sheriff – Republican nominee:
Allen C. King: 749 votes

Sheriff – Democrat nominee:
Randy N. Holcomb: 567 votes

Prosecuting Attorney – Democrat:
Wayne King: 550 votes

Assessor – Democrat:
Teresa L. Davis: 715 votes

Circuit Court Judge, 17th Judicial Circuit, Division 1:
Jasmine R.H. Morton (winner): 1,255 votes
William “Bill” McCourt Jr.: 451 votes

Circuit Court Judge, 17th Judicial Circuit, Division 2:
Mike Asbury: 1,753 votes

Family Court Judge, 16th Family Court Circuit, Division 1:
Harley E. Stollings: 1,402 votes

Magistrate, Division 1:

Scott L. Bass (winner): 757 votes
Ryan Thomas: 666 votes

Andy Bragg: 502 votes

Magistrate, Division 2:

Wesley Armes (winner): 606 votes
Jeff Davis: 577 votes

Frankie Jo West: 489 votes
Nicole Summers: 216 votes

Brandy Stuber Wood: 45 votes

Board of Education:

Aaron Williams (winner): 938 votes

Mike Mullins (winner): 927 votes

David W. Pierson Jr.: 765 votes
Susan Markle-Bodkins: 512 votes

Conservation District Supervisor:

Keyota Jarvis: 1,378 votes

BOE Levy:

For the Levies: 1,094 votes

Against the Levies: 835 votes

Library Levy:

For the Levies: 1,128 votes

Against the Levies: 874 votes

Student attendance awarded at Clay County Schools



The best attendance in the county goes to Myesscha Schoonover's 4th grade students at Lizemore Elementary with a rate of 98.63%. Pictured with Mrs. Schoonover's students is Superintendent Phil Dobbins.



Dawn Mullins' K/1 students at H.E. White Elementary were runners up in the county with a rate of 98.50%. Pictured with Ms. Mullins' students are Principal Megan Starcher and Superintendent Phil Dobbins.

We had excellent attendance for the ninth school month. We were led by Lizemore Elementary with a rate of 98.11%, followed by Clay County High School at 93.53% and third with Big Otter at 93.42%.

The classrooms with the best attendance at each school are as follows: Myesscha Schoonover's 4th grade classroom at Lizemore Elementary led the county with a 98.63%, followed by Dawn Mullins' K/1 classroom at H. E. White at 98.50%, and Megan Sears' 3-year-old preschool classroom at 98.13%. Next came Shawn Krajieski's classroom at Clay High School at 97.86%, followed by Nellie Elliott's students at Clay Elementary School with a rate of 94.72% and finally Michell Hamrick's and Pam Huffman's students at Clay Middle School were tied with the same rate at 94.36%.

Congratulations to all the students at each school who had outstanding attendance. One of the three top indicators of success in the school system is good attendance.

Big Otter students race Hot Wheels



(L-R) Liam Miller, Deric Cunningham, Matthew Drake

Students at Big Otter Elementary School are off to the races! Every day a student is present at school, they are eligible to win a Hot Wheels race car. At the end of each nine weeks, students race their cars on a huge racetrack. Congratulations to the winners!

Clay County Free Press

claycountyfreepress.com

Email:

news@claycountyfreepress.com

advertising@claycountyfreepress.com

subscriptions@claycountyfreepress.com

Michael Showell, Publisher

The Clay County Free Press (USPS 116-660) is published weekly at 291 Main Street, Clay, West Virginia. Subscription Rate: In County, \$31.00, Out of County, \$36.00, Out of State, \$41.00. Periodical postage paid at Clay, West Virginia. Address all mail (subscription, change of address) to: PO Box 429, Lewisburg WV 24901 or call (304) 647-5724 or Fax (304) 647-5767. POSTMASTER Please give old address and your new address.

Whatever Happened to Reality

Dr. James L. Snyder
During my health hiatus I did things I never had time to do before. One of them was to check out some Reality TV Shows.

I never had much interest in these TV shows, but I thought now would be a good time to check some of them just to see what their idea of reality really was.

Of course, my health probably affected my mental capacity, so I wasn't going to take much seriously. I checked them out all the more and discovered that if what I saw on TV was their idea of reality, I had a good deal on a Brooklyn Bridge for one of them.

I thought, and it's just me speaking, that reality had something to do with, what's that word? Oh yes, "truth." I watched several, and if there was any truth in what they were doing or even saying, I could not find it.

I found one show called Naked and Afraid, and I must tell you I didn't come anywhere near that because I was afraid. I was afraid that their idea of naked reality was nowhere near the truth. Who in their right mind, and there are plenty who aren't in their right mind, would spend their time watching such nonsense?

I checked out a few of these reality shows but could never find any reality in anything they showed.

After watching some of these, I got to thinking about the reality in my life. Is my life a "Reality Show", or is it for real?

That's what I got out of looking at some of those shows. I don't want to blame somebody else for doing things I might be doing myself. After all, reality is reality.

During my health hiatus, I was beginning to think that health was not a reality for me. The only thing real about me during that time was sickness, which was characterized by coughing and sneezing.

I must admit that the sickness was a reality at the time. But, it wasn't a reality forever.

Coming out of that health hiatus, I realized that there are more important things in life than just feeling sorry for yourself because you're sick.

During my sickness The Gracious Mistress of the Parsonage was a reality to me. She brought me pill after pill after pill after pill. At the time, I referred to her as my drug Lord. I got so tired of taking pills that I just did not know what to do.

Looking back on that, I realize that wasn't reality. Oh yes, I was sick for a short period of time, but the key is that it was a short period of time.

The Gracious Mistress of the Parsonage told me time after time that I would get better. At the time, I didn't care if I got better or not. But, eventually, I realized that she was right. After all, isn't she right all the time?

Now that I'm up and getting back to a somewhat normal schedule, I've been thinking a lot about reality. There are things in my life that just are not reality.

My challenge is to find what is real in my life and what is artificial.

My wife and I agree on many things except for one. I'm a firm believer that the strongest aspect of reality is an Apple Fritter. She thinks that broccoli is a reality.

The reality is that both of us are right, and both of us are wrong. I'm not going to try to explain that because if I do, I'm not going to understand it myself.

The one thing that got me through all that health nonsense was thinking about an Apple Fritter when I was healthy.

The danger is that if I got an Apple Fritter and The Gracious Mistress of the Parsonage found out, it might be a challenge to my health at that time.

Every day, my wife asks me how I'm feeling, and I always reply, "I'm fine."

She responds, "No, you're not fine."

And then reality sets in.

At my last doctor's visit, the doctor examined me quite thoroughly and went over all of the forms. Finally, the doctor looked at me and said, "I have good news for you. You're fine."

Sitting right next to me was The Gracious Mistress of the Parsonage, and so I said, "I'm sorry Dr., what did you say?"

"I said, you're fine."

Looking at my wife with a giggly smile, I said, "My dear, did you hear that? Doctors don't lie."

All the way home from the doctor's visit, I kept chuckling and saying under my breath, "I'm fine."

I did not want to say it out loud because The Gracious Mistress of the Parsonage was driving, and that's all I'll say about it.

It's a beautiful day when you find reality in your life.

Thinking about this I was reminded what the Apostle Paul said. "Finally, brethren, whatsoever things are true, whatsoever things are honest, whatsoever things are just, whatsoever things are pure, whatsoever things are lovely, whatsoever things are of good report; if there be any virtue, and if there be any praise, think on these things" (Philippians 4:8).

This is a challenge for everyone. Personally, my reality starts in the Bible. I work on adjusting my life to the realty presented in the Bible. Each day I search for that reality that applies to me.

Dr. James L. Snyder lives in Ocala, FL with the Gracious Mistress of the Parsonage. Telephone 1-352-216-3025, e-mail jamesnsnyder51@gmail.com, website www.jamesnsnyderministries.com

BACKUP POWER.
PEACE OF MIND.



Get a Standard
Warranty of **7 YEARS** **\$849 Value**

Call 1-855-609-1433

BRIGGS & STRATTON
POWER EQUIPMENT

Who We Are Supposed To Be

By Joe Mazzella

I turned my television on after breakfast this morning. The news was the usual every single horrible thing that is happening in the world. That wasn't the worst of it, though. This being an election year the commercials were all the most venomous, hate-filled, political attack ads I had ever seen. It turned my stomach listening to them. And my heart felt weighed down with sadness. "Is this who we have become?" I asked myself. "Is this who we are supposed to be?"

I turned the TV off and instead went over to my vinyl records. I opened up the record player that my beautiful daughter had bought me a few years ago, took out a 40 year old record and put it on. The delightful music of my childhood filled the room and I thanked my daughter in my heart for buying this record player for me.

Just as I was thinking of her I looked out my window and saw her across the road, in the driveway of her

house. She was patiently standing between two plates of cat food so the two stray cats she was feeding wouldn't fight each other. I knew, too, that when she was done she would also set out food on her porch banister to feed the cardinals, robins, and blue jays nesting in the trees around her home. Seeing this humble, sweet soul going about her morning acts of love made me smile. Watching her filled my heart with love. And in that moment the truth washed over me: "This is who we are supposed to be!" "This is who we truly are!"

We are all Children of God. We are all beings of light. We are all creatures of love. Whether we live up to who we are supposed to be, however, is up to us. The choice is yours. You can fill your days with anger, hatred, fear, violence and prejudice. Or like my daughter you can fill your days with kindness, acceptance, empathy, peace, and unconditional love. May you choose wisely. May you choose to be who you truly are.

GRADUATION

Continued from Page 1



99-year-old Charles Edward Bird



Three seniors also graduated from Clay Christian Academy this past Friday night, May 17, 2024. From left to right: Gracey Morton, who will be attending Marshall University this fall; Madison Taylor, who will attend BridgeValley Community College in Nursing; and Layla Frame who is undecided.

The commencement address was given by Major General James A. Hoyer, retired, now Vice President for Economic Innovation at West Virginia University and an important part of the CMI2 project at Lizemores. At the end of the address Major General Hoyer announced that CMI2 is taking on 25 students this year for summer employment. Welcome news as all gave him a hardy applause.

Mr. Tanner gave out scholarship awards and Superintendent Dobbins and the Clay County Board of Education handed out diplomas as names were called. Mr. Tanner also recognized seven seniors who were going into the military upon graduation. Acceptance of the diplomas was by Mr. Caden Delwarte, President of the Senior Class.

The full list of graduating seniors from Clay County High School is as follows:

Adkins, Isaiah Hunter
Adkins, Michael Cody
Adkins, Morgan Leighann
Adkins, Taylor Brooke
Akers, Trevor John
Auxier, Ethan Cole
Auxier, Logan Garrett
Bailey, Lauryn Skylar
Belt, Jaylyn Alexis
Bickford, Dylan Scott
Bird, Charles E.
Black, Braden Michael
Blankenship, Colton Nathaniel
Bodkins, Jamison Rian
Brady, Michael Phillip
Brown, Isaac Trenton
Brown, Joshua Michael
Bullard, Cody Allen
Burdette, James Martin
Caldwell, Natalie Brook
Campbell, Jacob Joseph
Carper Jr, Jeffery Shannon
Champ, Gracey Paige
Chapman, Haley Gracen
Coleman, Natalie Sharlotte

Cummings, Ashton Joseph
Cummings, Nevaeh Hope
Cutlip, Coalton Ray
Deems, Austin Levi
Deems, Mallory Paige
Delwarte, Caden Alan
Deyton, Zachary Levi
Dobbins, Charlee Jean
Drake, Glenda Louise
Duffield, Eian Matthew
Edwards, Jonathan David
Elliott, Elijah Lee
Ferrebee, Jarod Isaac
Ferrebee, Shane Preston
Frame, Jillian Brooke
Frame, Jonathan Wade
Friend, Matthew Ryan
Gandee, Michael David
Gill, Madison Renee
Goldizen, Lilly Mae
Goodwin, Haylee Brooke
Hamrick, Hunter Ray
Hinkle, Kennah Alexyss
Hively, Jessee James
Holcomb, Elijah Craig
Holcomb, Elijah Keith
Holley, Abigail Marie
James, Savannah Jo
Johnston, Bryson Scott
Johnston, Lindsey Rose Lauren
Jones, Kaylee Autumn
Jones, Makayla Brooke
Keiffer, Eric Michael
Koch, Kylei Elizabeth
Lindenthal, Gavin Seth
Loos, Marylynn Elizabeth
Lowe-Neal, Tara Gail
Lowe, Myrikah Angelina
Luzader, Abigail Lynn
Martin, Helenia Marie
McCumbers, Dylan Lee
McKinney, Brayden Michael
Meadows, Lillian Grace
Means, Andrew Clinton
Metheney, Cecelia Faith
Metheney, Temmeria Jean Nicole
Miller Jr, Justin Rebel
Miller, Blade Alexander
Miller, Hunter Austin
Miller, Jaden Lucinda

Minger, Zane Michael
Mitchell III, Allen Wayne
Mitchell, Matthew Brayton
Moore II, Jason Wyatt
Moore, Kamryn Nichole
Morrison, Nathaniel Alan
Mullins, Isaac Monroe
Murphy, Haley Madison
Myers, Logan Wayne
Myers, Tristan Ora Briar
Naylor, Rebecca Danielle
Neal, Cohen Mark
Nottingham, Ethan Wayne
Nottingham, Tanner Bryson
Osborne, Megan Tracy
Osborne, Micah Todd
Prest, Auston Jay
Price III, Danny Ray
Puenta, Lucas Jesse
Quinn, Jackson Henry
Remias, Natalie Patricia
Rogers, Lukas Mace
Rose, Marlena Faye
Salisbury, Ashdon Miley
Salisbury, Evan Eugene
Samples, Bratton Robert
Santiago, Beonca Esmerelda
Sears, Eric Michael
Sheldon, Hayden Scott
Sigman, Kayleigh Lynn
Sizemore III, Michael Karl
Sizemore, Jake Everette
Smith, James Phillip
Smith, Maggie Maelyn
Starcher, Zachary Ryan
Stoops, Savannah Dawn
Taylor, Abagale Brooke
Taylor, Devon Harvey
Taylor, Garrett Andrew
Taylor, Hailey Nicole
Taylor, Jimmy Allan
Truman, Kendall Charles
Tucker, Lillian Ashley P
Waseleski II, Michael
Williams, Benjamin Joseph
Williams, Landon Walker
Witt, Olivia Marie
Wynn, Nathan Palmer

THIS WEEK IN West Virginia History

The following events happened on these dates in West Virginia history. To read more, go to *e-WV: The West Virginia Encyclopedia* at www.wvencyclopedia.org.

May 22, 1947: Supreme Court Justice Margaret “Peggy” Workman was born in Charleston. In November 1988, she became the first woman elected to the West Virginia Supreme Court of Appeals and to statewide office in West Virginia.

May 23, 1862: In what became known as the Battle of Lewisburg, Union troops repelled a Confederate advance, killing 38 and wounding 66, while losing only 13 men.

May 23, 1941: Rod Thorn was born in Princeton. Declared by the legislature a state “natural resource,” Thorn attended West Virginia University, where he was an All-American guard. Thorn had a distinguished NBA career

as a player and executive, which included drafting Michael Jordan.

May 24, 1896: Confederate General John Echols died in Staunton, Virginia. Echols served in the Kanawha Valley in 1862 and commanded Confederate forces at their defeat at the Battle of Droop Mountain in November 1863.



May 25, 1903: Industrialist and philanthropist Bernard Patrick McDonough Jr. was born in Texas. Starting with a Parkersburg construction business in the 1930s, McDonough built a Fortune 500 company with operations in hand tools, building materials and barge building. The Bernard McDonough Foundation remains one

of the largest private foundations in West Virginia.

May 25, 1937: William H. “Teepi” Kendrick died in Morgantown. Kendrick was a pioneer in West Virginia’s 4-H program. He broadened the program to emphasize more than just agriculture, and he was primarily responsible for establishing the state 4-H camp at Jackson’s Mill.



May 26, 1895: Athlete Ira Errett “Rat” Rodgers was born in Bethany. He was WVU’s first football

All-American, lettering in 1915–17 and 1919.



May 26, 1923: Playwright Maryat Lee was born in Kentucky. In 1970, she moved to Summers County and developed her Eco Theater into a national organization.



May 27, 1912: Legendary golfer Sam Snead was born at Ashwood, Virginia. When The Greenbrier reopened as a resort after World War

II, Snead returned as the golf pro.

May 27, 1922: Labor leader Bill Blizzard was acquitted of treason charges following the 1921 Battle of Blair Mountain. The trial was held in the Jefferson County Courthouse, where John Brown had been convicted of treason against Virginia in 1859.

May 28, 1863: Arthur Boreman was elected as the first governor of the new state of West Virginia.



May 28, 1920: Elmer Bird--“The Banjo Man from Turkey Creek”--was born in Putnam County. He was named

best old-time banjo player in the country four times in his 60s.



May 28, 1938: Basketball player Jerry West was born on Cabin Creek, Kanawha County. West led East Bank High School to the state basketball championship in 1956 and then rewrote the record books at West Virginia University and with the Los Angeles Lakers.

May 28, 1998: The Robert C. Byrd United States Courthouse in downtown Charleston was dedicated. The 440,000-square-foot building incorporated Neoclassic, Egyptian and Art Deco designs.

HOCUS-FOCUS BY HENRY BOLTINOFF

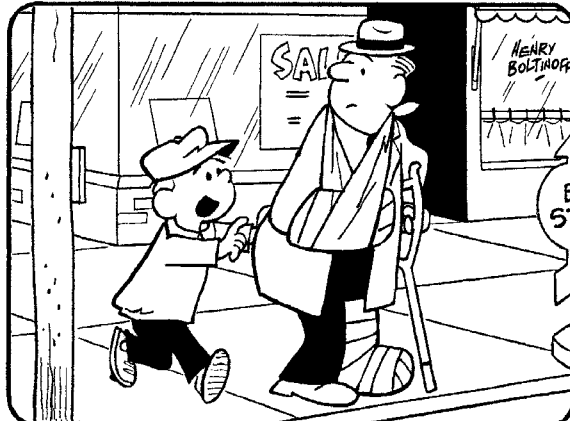

Find at least six differences in details between panels.

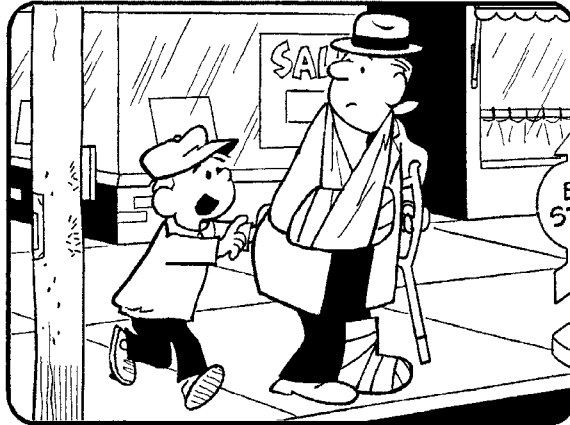

Differences: 1. Crutch is shorter. 2. Leg is different. 3. Cast is thicker. 4. Hat is larger. 5. Sign in window is different. 6. Pole is smaller. 7. Hat is larger. 8. Sign in window is different. 9. Cast is thicker. 10. Hat is larger. 11. Sign in window is different. 12. Pole is smaller. 13. Hat is larger. 14. Sign in window is different. 15. Cast is thicker. 16. Hat is larger. 17. Sign in window is different. 18. Pole is smaller. 19. Hat is larger. 20. Sign in window is different. 21. Cast is thicker. 22. Hat is larger. 23. Sign in window is different. 24. Pole is smaller. 25. Hat is larger. 26. Sign in window is different. 27. Cast is thicker. 28. Hat is larger. 29. Sign in window is different. 30. Pole is smaller. 31. Hat is larger. 32. Sign in window is different. 33. Cast is thicker. 34. Hat is larger. 35. Sign in window is different. 36. Pole is smaller. 37. Hat is larger. 38. Sign in window is different. 39. Cast is thicker. 40. Hat is larger. 41. Sign in window is different. 42. Pole is smaller. 43. Hat is larger. 44. Sign in window is different. 45. Cast is thicker. 46. Hat is larger. 47. Sign in window is different. 48. Pole is smaller. 49. Hat is larger. 50. Sign in window is different. 51. Cast is thicker. 52. Hat is larger. 53. Sign in window is different. 54. Pole is smaller. 55. Hat is larger. 56. Sign in window is different. 57. Cast is thicker. 58. Hat is larger. 59. Sign in window is different. 60. Pole is smaller. 61. Hat is larger. 62. Sign in window is different. 63. Cast is thicker. 64. Hat is larger. 65. Sign in window is different. 66. Pole is smaller. 67. Hat is larger. 68. Sign in window is different. 69. Cast is thicker. 70. Hat is larger. 71. Sign in window is different. 72. Pole is smaller. 73. Hat is larger. 74. Sign in window is different. 75. Cast is thicker. 76. Hat is larger. 77. Sign in window is different. 78. Pole is smaller. 79. Hat is larger. 80. Sign in window is different. 81. Cast is thicker. 82. Hat is larger. 83. Sign in window is different. 84. Pole is smaller. 85. Hat is larger. 86. Sign in window is different. 87. Cast is thicker. 88. Hat is larger. 89. Sign in window is different. 90. Pole is smaller. 91. Hat is larger. 92. Sign in window is different. 93. Cast is thicker. 94. Hat is larger. 95. Sign in window is different. 96. Pole is smaller. 97. Hat is larger. 98. Sign in window is different. 99. Cast is thicker. 100. Hat is larger. 101. Sign in window is different. 102. Pole is smaller. 103. Hat is larger. 104. Sign in window is different. 105. Cast is thicker. 106. Hat is larger. 107. Sign in window is different. 108. Pole is smaller. 109. Hat is larger. 110. Sign in window is different. 111. Cast is thicker. 112. Hat is larger. 113. Sign in window is different. 114. Pole is smaller. 115. Hat is larger. 116. Sign in window is different. 117. Cast is thicker. 118. Hat is larger. 119. Sign in window is different. 120. Pole is smaller. 121. Hat is larger. 122. Sign in window is different. 123. Cast is thicker. 124. Hat is larger. 125. Sign in window is different. 126. Pole is smaller. 127. Hat is larger. 128. Sign in window is different. 129. Cast is thicker. 130. Hat is larger. 131. Sign in window is different. 132. Pole is smaller. 133. Hat is larger. 134. Sign in window is different. 135. Cast is thicker. 136. Hat is larger. 137. Sign in window is different. 138. Pole is smaller. 139. Hat is larger. 140. Sign in window is different. 141. Cast is thicker. 142. Hat is larger. 143. Sign in window is different. 144. Pole is smaller. 145. Hat is larger. 146. Sign in window is different. 147. Cast is thicker. 148. Hat is larger. 149. Sign in window is different. 150. Pole is smaller. 151. Hat is larger. 152. Sign in window is different. 153. Cast is thicker. 154. Hat is larger. 155. Sign in window is different. 156. Pole is smaller. 157. Hat is larger. 158. Sign in window is different. 159. Cast is thicker. 160. Hat is larger. 161. Sign in window is different. 162. Pole is smaller. 163. Hat is larger. 164. Sign in window is different. 165. Cast is thicker. 166. Hat is larger. 167. Sign in window is different. 168. Pole is smaller. 169. Hat is larger. 170. Sign in window is different. 171. Cast is thicker. 172. Hat is larger. 173. Sign in window is different. 174. Pole is smaller. 175. Hat is larger. 176. Sign in window is different. 177. Cast is thicker. 178. Hat is larger. 179. Sign in window is different. 180. Pole is smaller. 181. Hat is larger. 182. Sign in window is different. 183. Cast is thicker. 184. Hat is larger. 185. Sign in window is different. 186. Pole is smaller. 187. Hat is larger. 188. Sign in window is different. 189. Cast is thicker. 190. Hat is larger. 191. Sign in window is different. 192. Pole is smaller. 193. Hat is larger. 194. Sign in window is different. 195. Cast is thicker. 196. Hat is larger. 197. Sign in window is different. 198. Pole is smaller. 199. Hat is larger. 200. Sign in window is different. 201. Cast is thicker. 202. Hat is larger. 203. Sign in window is different. 204. Pole is smaller. 205. Hat is larger. 206. Sign in window is different. 207. Cast is thicker. 208. Hat is larger. 209. Sign in window is different. 210. Pole is smaller. 211. Hat is larger. 212. Sign in window is different. 213. Cast is thicker. 214. Hat is larger. 215. Sign in window is different. 216. Pole is smaller. 217. Hat is larger. 218. Sign in window is different. 219. Cast is thicker. 220. Hat is larger. 221. Sign in window is different. 222. Pole is smaller. 223. Hat is larger. 224. Sign in window is different. 225. Cast is thicker. 226. Hat is larger. 227. Sign in window is different. 228. Pole is smaller. 229. Hat is larger. 230. Sign in window is different. 231. Cast is thicker. 232. Hat is larger. 233. Sign in window is different. 234. Pole is smaller. 235. Hat is larger. 236. Sign in window is different. 237. Cast is thicker. 238. Hat is larger. 239. Sign in window is different. 240. Pole is smaller. 241. Hat is larger. 242. Sign in window is different. 243. Cast is thicker. 244. Hat is larger. 245. Sign in window is different. 246. Pole is smaller. 247. Hat is larger. 248. Sign in window is different. 249. Cast is thicker. 250. Hat is larger. 251. Sign in window is different. 252. Pole is smaller. 253. Hat is larger. 254. Sign in window is different. 255. Cast is thicker. 256. Hat is larger. 257. Sign in window is different. 258. Pole is smaller. 259. Hat is larger. 260. Sign in window is different. 261. Cast is thicker. 262. Hat is larger. 263. Sign in window is different. 264. Pole is smaller. 265. Hat is larger. 266. Sign in window is different. 267. Cast is thicker. 268. Hat is larger. 269. Sign in window is different. 270. Pole is smaller. 271. Hat is larger. 272. Sign in window is different. 273. Cast is thicker. 274. Hat is larger. 275. Sign in window is different. 276. Pole is smaller. 277. Hat is larger. 278. Sign in window is different. 279. Cast is thicker. 280. Hat is larger. 281. Sign in window is different. 282. Pole is smaller. 283. Hat is larger. 284. Sign in window is different. 285. Cast is thicker. 286. Hat is larger. 287. Sign in window is different. 288. Pole is smaller. 289. Hat is larger. 290. Sign in window is different. 291. Cast is thicker. 292. Hat is larger. 293. Sign in window is different. 294. Pole is smaller. 295. Hat is larger. 296. Sign in window is different. 297. Cast is thicker. 298. Hat is larger. 299. Sign in window is different. 300. Pole is smaller. 301. Hat is larger. 302. Sign in window is different. 303. Cast is thicker. 304. Hat is larger. 305. Sign in window is different. 306. Pole is smaller. 307. Hat is larger. 308. Sign in window is different. 309. Cast is thicker. 310. Hat is larger. 311. Sign in window is different. 312. Pole is smaller. 313. Hat is larger. 314. Sign in window is different. 315. Cast is thicker. 316. Hat is larger. 317. Sign in window is different. 318. Pole is smaller. 319. Hat is larger. 320. Sign in window is different. 321. Cast is thicker. 322. Hat is larger. 323. Sign in window is different. 324. Pole is smaller. 325. Hat is larger. 326. Sign in window is different. 327. Cast is thicker. 328. Hat is larger. 329. Sign in window is different. 330. Pole is smaller. 331. Hat is larger. 332. Sign in window is different. 333. Cast is thicker. 334. Hat is larger. 335. Sign in window is different. 336. Pole is smaller. 337. Hat is larger. 338. Sign in window is different. 339. Cast is thicker. 340. Hat is larger. 341. Sign in window is different. 342. Pole is smaller. 343. Hat is larger. 344. Sign in window is different. 345. Cast is thicker. 346. Hat is larger. 347. Sign in window is different. 348. Pole is smaller. 349. Hat is larger. 350. Sign in window is different. 351. Cast is thicker. 352. Hat is larger. 353. Sign in window is different. 354. Pole is smaller. 355. Hat is larger. 356. Sign in window is different. 357. Cast is thicker. 358. Hat is larger. 359. Sign in window is different. 360. Pole is smaller. 361. Hat is larger. 362. Sign in window is different. 363. Cast is thicker. 364. Hat is larger. 365. Sign in window is different. 366. Pole is smaller. 367. Hat is larger. 368. Sign in window is different. 369. Cast is thicker. 370. Hat is larger. 371. Sign in window is different. 372. Pole is smaller. 373. Hat is larger. 374. Sign in window is different. 375. Cast is thicker. 376. Hat is larger. 377. Sign in window is different. 378. Pole is smaller. 379. Hat is larger. 380. Sign in window is different. 381. Cast is thicker. 382. Hat is larger. 383. Sign in window is different. 384. Pole is smaller. 385. Hat is larger. 386. Sign in window is different. 387. Cast is thicker. 388. Hat is larger. 389. Sign in window is different. 390. Pole is smaller. 391. Hat is larger. 392. Sign in window is different. 393. Cast is thicker. 394. Hat is larger. 395. Sign in window is different. 396. Pole is smaller. 397. Hat is larger. 398. Sign in window is different. 399. Cast is thicker. 400. Hat is larger. 401. Sign in window is different. 402. Pole is smaller. 403. Hat is larger. 404. Sign in window is different. 405. Cast is thicker. 406. Hat is larger. 407. Sign in window is different. 408. Pole is smaller. 409. Hat is larger. 410. Sign in window is different. 411. Cast is thicker. 412. Hat is larger. 413. Sign in window is different. 414. Pole is smaller. 415. Hat is larger. 416. Sign in window is different. 417. Cast is thicker. 418. Hat is larger. 419. Sign in window is different. 420. Pole is smaller. 421. Hat is larger. 422. Sign in window is different. 423. Cast is thicker. 424. Hat is larger. 425. Sign in window is different. 426. Pole is smaller. 427. Hat is larger. 428. Sign in window is different. 429. Cast is thicker. 430. Hat is larger. 431. Sign in window is different. 432. Pole is smaller. 433. Hat is larger. 434. Sign in window is different. 435. Cast is thicker. 436. Hat is larger. 437. Sign in window is different. 438. Pole is smaller. 439. Hat is larger. 440. Sign in window is different. 441. Cast is thicker. 442. Hat is larger. 443. Sign in window is different. 444. Pole is smaller. 445. Hat is larger. 446. Sign in window is different. 447. Cast is thicker. 448. Hat is larger. 449. Sign in window is different. 450. Pole is smaller. 451. Hat is larger. 452. Sign in window is different. 453. Cast is thicker. 454. Hat is larger. 455. Sign in window is different. 456. Pole is smaller. 457. Hat is larger. 458. Sign in window is different. 459. Cast is thicker. 460. Hat is larger. 461. Sign in window is different. 462. Pole is smaller. 463. Hat is larger. 464. Sign in window is different. 465. Cast is thicker. 466. Hat is larger. 467. Sign in window is different. 468. Pole is smaller. 469. Hat is larger. 470. Sign in window is different. 471. Cast is thicker. 472. Hat is larger. 473. Sign in window is different. 474. Pole is smaller. 475. Hat is larger. 476. Sign in window is different. 477. Cast is thicker. 478. Hat is larger. 479. Sign in window is different. 480. Pole is smaller. 481. Hat is larger. 482. Sign in window is different. 483. Cast is thicker. 484. Hat is larger. 485. Sign in window is different. 486. Pole is smaller. 487. Hat is larger. 488. Sign in window is different. 489. Cast is thicker. 490. Hat is larger. 491. Sign in window is different. 492. Pole is smaller. 493. Hat is larger. 494. Sign in window is different. 495. Cast is thicker. 496. Hat is larger. 497. Sign in window is different. 498. Pole is smaller. 499. Hat is larger. 500. Sign in window is different. 501. Cast is thicker. 502. Hat is larger. 503. Sign in window is different. 504. Pole is smaller. 505. Hat is larger. 506. Sign in window is different. 507. Cast is thicker. 508. Hat is larger. 509. Sign in window is different. 510. Pole is smaller. 511. Hat is larger. 512. Sign in window is different. 513. Cast is thicker. 514. Hat is larger. 515. Sign in window is different. 516. Pole is smaller. 517. Hat is larger. 518. Sign in window is different. 519. Cast is thicker. 520. Hat is larger. 521. Sign in window is different. 522. Pole is smaller. 523. Hat is larger. 524. Sign in window is different. 525. Cast is thicker. 526. Hat is larger. 527. Sign in window is different. 528. Pole is smaller. 529. Hat is larger. 530. Sign in window is different. 531. Cast is thicker. 532. Hat is larger. 533. Sign in window is different. 534. Pole is smaller. 535. Hat is larger. 536. Sign in window is different. 537. Cast is thicker. 538. Hat is larger. 539. Sign in window is different. 540. Pole is smaller. 541. Hat is larger. 542. Sign in window is different. 543. Cast is thicker. 544. Hat is larger. 545. Sign in window is different. 546. Pole is smaller. 547. Hat is larger. 548. Sign in window is different. 549. Cast is thicker. 550. Hat is larger. 551. Sign in window is different. 552. Pole is smaller. 553. Hat is larger. 554. Sign in window is different. 555. Cast is thicker. 556. Hat is larger. 557. Sign in window is different. 558. Pole is smaller. 559. Hat is larger. 560. Sign in window is different. 561. Cast is thicker. 562. Hat is larger. 563. Sign in window is different. 564. Pole is smaller. 565. Hat is larger. 566. Sign in window is different. 567. Cast is thicker. 568. Hat is larger. 569. Sign in window is different. 570. Pole is smaller. 571. Hat is larger. 572. Sign in window is different. 573. Cast is thicker. 574. Hat is larger. 575. Sign in window is different. 576. Pole is smaller. 577. Hat is larger. 578. Sign in window is different. 579. Cast is thicker. 580. Hat is larger. 581. Sign in window is different. 582. Pole is smaller. 583. Hat is larger. 584. Sign in window is different. 585. Cast is thicker. 586. Hat is larger. 587. Sign in window is different. 588. Pole is smaller. 589. Hat is larger. 590. Sign in window is different. 591. Cast is thicker. 592. Hat is larger. 593. Sign in window is different. 594. Pole is smaller. 595. Hat is larger. 596. Sign in window is different. 597. Cast is thicker. 598. Hat is larger. 599. Sign in window is different. 600. Pole is smaller. 601. Hat is larger. 602. Sign in window is different. 603. Cast is thicker. 604. Hat is larger. 605. Sign in window is different. 606. Pole is smaller. 607. Hat is larger. 608. Sign in window is different. 609. Cast is thicker. 610. Hat is larger. 611. Sign in window is different. 612. Pole is smaller. 613. Hat is larger. 614. Sign in window is different. 615. Cast is thicker. 616. Hat is larger. 617. Sign in window is different. 618. Pole is smaller. 619. Hat is larger. 620. Sign in window is different. 621. Cast is thicker. 622. Hat is larger. 623. Sign in window is different. 624. Pole is smaller. 625. Hat is larger. 626. Sign in window is different. 627. Cast is thicker. 628. Hat is larger. 629. Sign in window is different. 630. Pole is smaller. 631. Hat is larger. 632. Sign in window is different. 633. Cast is thicker. 634. Hat is larger. 635. Sign in window is different. 636. Pole is smaller. 637. Hat is larger. 638. Sign in window is different. 639. Cast is thicker. 640. Hat is larger. 641. Sign in window is different. 642. Pole is smaller. 643. Hat is larger. 644. Sign in window is different. 645. Cast is thicker. 646. Hat is larger. 647. Sign in window is different. 648. Pole is smaller. 649. Hat is larger. 650. Sign in window is different. 651. Cast is thicker. 652. Hat is larger. 653. Sign in window is different. 654. Pole is smaller. 655. Hat is larger. 656. Sign in window is different. 657. Cast is thicker. 658. Hat is larger. 659. Sign in window is different. 660. Pole is smaller. 661. Hat is larger. 662. Sign in window is different. 663. Cast is thicker. 664. Hat is larger. 665. Sign in window is different. 666. Pole is smaller. 667. Hat is larger. 668. Sign in window is different. 669. Cast is thicker. 670. Hat is larger. 671. Sign in window is different. 672. Pole is smaller. 673. Hat is larger. 674. Sign in window is different. 675. Cast is thicker. 676. Hat is larger. 677. Sign in window is different. 678. Pole is smaller. 679. Hat is larger. 680. Sign in window is different. 681. Cast is thicker. 682. Hat is larger. 683. Sign in window is different. 684. Pole is smaller. 685. Hat is larger. 686. Sign in window is different. 687. Cast is thicker. 688. Hat is larger. 689. Sign in window is different. 690. Pole is smaller. 691. Hat is larger. 692. Sign in window is different. 693. Cast is thicker. 694. Hat is larger. 695. Sign in window is different. 696. Pole is smaller. 697. Hat is larger. 698. Sign in window is different. 699. Cast is thicker. 700. Hat is larger. 701. Sign in window is different. 702. Pole is smaller. 703. Hat is larger. 704. Sign in window is different. 705. Cast is thicker. 706. Hat is larger. 707. Sign in window is different. 708. Pole is smaller. 709. Hat is larger. 710. Sign in window is different. 711. Cast is thicker. 712. Hat is larger. 713. Sign in window is different. 714. Pole is smaller. 715. Hat is larger. 716. Sign in window is different. 717. Cast is thicker. 718. Hat is larger. 719. Sign in window is different. 720. Pole is smaller. 721. Hat is larger. 722. Sign in window is different. 723. Cast is thicker. 724. Hat is larger. 725. Sign in window is different. 726. Pole is smaller. 727. Hat is larger. 728. Sign in window is different. 729. Cast is thicker. 730. Hat is larger. 731. Sign in window is different. 732. Pole is smaller. 733. Hat is larger. 734. Sign in window is different. 735. Cast is thicker. 736. Hat is larger. 737. Sign in window is different. 738. Pole is smaller. 739. Hat is larger. 740. Sign in window is different. 741. Cast is thicker. 742. Hat is larger. 743. Sign in window is different. 744. Pole is smaller. 745. Hat is larger. 746. Sign in window is different. 747. Cast is thicker. 748. Hat is larger. 749. Sign in window is different. 750. Pole is smaller. 751. Hat is larger. 752. Sign in window is different. 753. Cast is thicker. 754. Hat is larger. 755. Sign in window is different. 756. Pole is smaller. 757. Hat is larger. 758. Sign in window is different. 759. Cast is thicker. 760. Hat is larger. 761. Sign in window is different. 762. Pole is smaller. 763. Hat is larger. 764. Sign in window is different. 765. Cast is thicker. 766. Hat is larger. 767. Sign in window is different. 768. Pole is smaller. 769. Hat is larger. 770. Sign in window is different. 771. Cast is thicker. 772. Hat is larger. 773. Sign in window is different. 774. Pole is smaller. 775. Hat is larger. 776. Sign in window is different. 777. Cast is thicker. 778. Hat is larger. 779. Sign in window is different. 780. Pole is smaller. 781. Hat is larger. 782. Sign in window is different. 783. Cast is thicker. 784. Hat is larger. 785. Sign in window is different. 786. Pole is smaller. 787. Hat is larger. 788. Sign in window is different. 789. Cast is thicker. 790. Hat is larger. 791. Sign in window is different. 792. Pole is smaller. 793. Hat is larger. 794. Sign in window is different. 795. Cast is thicker. 796. Hat is larger. 797. Sign in window is different. 798. Pole is smaller. 799. Hat is larger. 800. Sign in window is different. 801. Cast is thicker. 802. Hat is larger. 803. Sign in window is different. 804. Pole is smaller. 805. Hat is larger. 806. Sign in window is different. 807. Cast is thicker. 808. Hat is larger. 809. Sign in window is different. 810. Pole is smaller. 811. Hat is larger. 812. Sign in window is different. 813. Cast is thicker. 814. Hat is larger. 815. Sign in window is different. 816. Pole is smaller. 817. Hat is larger. 818. Sign in window is different. 819. Cast is thicker. 820. Hat is larger. 821. Sign in window is different. 822. Pole is smaller. 823. Hat is larger. 824. Sign in window is different. 825. Cast is thicker. 826. Hat is larger. 827. Sign in window is different. 828. Pole is smaller. 829. Hat is larger. 830. Sign in window is different. 831. Cast is thicker. 832. Hat is larger. 833. Sign in window is different. 834. Pole is smaller. 835. Hat is larger. 836. Sign in window is different. 837. Cast is thicker. 838. Hat is larger. 839. Sign in window is different. 840. Pole is smaller. 841. Hat is larger. 842. Sign in window is different. 843. Cast is thicker. 844. Hat is larger. 845. Sign in window is different. 846. Pole is smaller. 847. Hat is larger. 848. Sign in window is different. 849. Cast is thicker. 850. Hat is larger. 851. Sign in window is different. 852. Pole is smaller. 853. Hat is larger. 854. Sign in window is different. 855. Cast is thicker. 856. Hat is larger. 857. Sign in window is different. 858. Pole is smaller. 859. Hat is larger. 860. Sign in window is different. 861. Cast is thicker. 862. Hat is larger. 863. Sign in window is different. 864. Pole is smaller. 865. Hat is larger. 866. Sign in window is different. 867. Cast is thicker. 868. Hat is larger. 869. Sign in window is different. 870. Pole is smaller. 871. Hat is larger. 872. Sign in window is different. 873. Cast is thicker. 874. Hat is larger. 875. Sign in window is different. 876. Pole is smaller. 877. Hat is larger. 878. Sign in window is different. 879. Cast is thicker. 880. Hat is larger. 881. Sign in window is different. 882. Pole is smaller. 883. Hat is larger. 884. Sign in window is different. 885. Cast is thicker. 886. Hat is larger. 887. Sign in window is different. 888. Pole is smaller. 889. Hat is larger. 890. Sign in window is different. 891. Cast is thicker. 892. Hat is larger. 893. Sign in window is different. 894. Pole is smaller. 895. Hat is larger. 896. Sign in window is different. 897. Cast is thicker. 898. Hat is larger. 899. Sign in window is different. 900. Pole is smaller. 901. Hat is larger. 902. Sign in window is different. 903. Cast is thicker. 904. Hat is larger. 905. Sign in window is different. 906. Pole is smaller. 907. Hat is larger. 908. Sign in window is different. 909. Cast is thicker. 910. Hat is larger. 911. Sign in window is different. 912. Pole is smaller. 913. Hat is larger. 914. Sign in window is different. 915. Cast is thicker. 916. Hat is larger. 917. Sign in window is different. 918. Pole is smaller. 919. Hat is larger. 920. Sign in window is different. 921. Cast is thicker. 922. Hat is larger. 923. Sign in window is different. 924. Pole is smaller. 925. Hat is larger. 926. Sign in window is different. 927. Cast is thicker. 928. Hat is larger. 929. Sign in window is different. 930. Pole is smaller. 931. Hat is larger. 932. Sign in window is different. 933. Cast is thicker. 934. Hat is larger. 935. Sign in window is different. 936. Pole is smaller. 937. Hat is larger. 938. Sign in window is different. 939. Cast is thicker. 940. Hat is larger. 941. Sign in window is different. 942. Pole is smaller. 943. Hat is larger. 944. Sign in window is different. 945. Cast is thicker. 946. Hat is larger. 947. Sign in window is different. 948. Pole is smaller. 949. Hat is larger. 950. Sign in window is different. 951. Cast is thicker. 952. Hat is larger. 953. Sign in window is different. 954. Pole is smaller. 955. Hat is larger. 956. Sign in window is different. 957. Cast is thicker. 958. Hat is larger. 959. Sign in window is different. 960. Pole is smaller. 961. Hat is larger. 962. Sign in window is different. 963. Cast is thicker. 964. Hat is larger. 965. Sign in window is different. 966. Pole is smaller. 967. Hat is larger. 968. Sign in window is different. 969. Cast is thicker. 970. Hat is larger. 971. Sign in window is different. 972. Pole is smaller. 973. Hat is larger. 974. Sign in window is different. 975. Cast is thicker. 976. Hat is larger. 977. Sign in window is different. 978. Pole is smaller. 979. Hat is larger. 980. Sign in window is different. 981. Cast is thicker. 982. Hat is larger. 983. Sign in window is different. 984. Pole is smaller. 985. Hat is larger. 986. Sign in window is different. 987. Cast is thicker. 988. Hat is larger. 989. Sign in window is different. 990. Pole is smaller. 991. Hat is larger. 992. Sign in window is different. 993. Cast is thicker. 994. Hat is larger. 995. Sign in window is different. 996. Pole is smaller. 997. Hat is larger. 998. Sign in window is different. 999. Cast is thicker. 1000. Hat is larger. 1001. Sign in window is different. 1002. Pole is smaller. 1003. Hat is larger. 1004. Sign in window is different. 1005. Cast is thicker. 1006. Hat is larger. 1007. Sign in window is different. 1008. Pole is smaller. 1009. Hat is larger. 1010. Sign in window is different. 1011. Cast is thicker. 1012. Hat is larger. 1013. Sign in window is different. 1014. Pole is smaller. 1015. Hat is larger. 1016. Sign in window is different. 1017. Cast is thicker. 1018. Hat is larger. 1019. Sign in window is different. 1020. Pole is smaller. 1021. Hat is larger. 1022. Sign in window is different. 1023. Cast is thicker. 1024. Hat is larger. 1025. Sign in window is different. 1026. Pole is smaller. 1027. Hat is larger. 1028. Sign in window is different. 1029. Cast is thicker. 1030. Hat is larger. 1031. Sign in window is different. 1032. Pole is smaller. 1033. Hat is larger. 1034. Sign in window is different. 1035. Cast is thicker. 1036. Hat is larger. 1037. Sign in window is different. 1038. Pole is smaller. 1039. Hat is larger. 1040. Sign in window is different. 1041. Cast is thicker. 1042. Hat is larger. 1043. Sign in window is different. 1044. Pole is smaller. 1045. Hat is larger. 1046. Sign in window is different. 1047. Cast is thicker. 1048. Hat is larger. 1049. Sign in window is different. 1050. Pole is smaller. 1051. Hat is larger. 1052. Sign in window is different. 1053. Cast is thicker. 1054. Hat is larger. 1055. Sign in window is different. 1056. Pole is smaller. 1057. Hat is larger. 1058. Sign in window is different. 1059. Cast is thicker. 1060. Hat is larger. 1061. Sign in window is different. 1062. Pole is smaller. 1063. Hat is larger. 1064. Sign in window is different. 1065. Cast is thicker. 1066. Hat is larger. 1067. Sign in window is different. 1068. Pole is smaller. 1069. Hat is larger. 1070. Sign in window is different. 1071. Cast is thicker. 1072. Hat is larger. 1073. Sign in window is different. 1074



THE WIDEN NEWS



The people who think alike
should vote alike.

"DUNDON"
RED ASH COAL

Where all think alike, no one
thinks very much.

December 1957

Photo Of Widen High School Class Of 1937-33



This eight above zero morning with a snow covered scene to behold seems like a good time to let you see the results of the photo taken one late evening of this enjoyable affair held at the Widen Recreation Area last July, when members of that class assembled their families and held a picnic to compare notes and talk over present and old times.

Someone in the crowd had the

presence to dig up a collection of date records popular in the thirty years, and following the picnic, the whole gang got together at the Legion Hall for an evening of dancing.

Prisma Canal Zone, Princeton, Charleston, Birch River, were the near and far places contributing families to the affair, with Widen topping the list. The following identification should help you to

put the families together. If in doubt, call on class publicity director, Mrs. Vera Shaffer.

Seated in the front row left to right: Ricky Patton, Judy Wood, Mary Hamrick, David Hamrick, Dawne Carol Backus, Carol Hamrick, Linda Patton and Maria Stump.

Second row: Tommy Mullins, Ann Wood, Virginia Backus, Dixie Donohue, Judy Shaffer, Jerry Ham-

rick, and David Shaffer.

Back row: James D. Wood holding son James David, Ted Griffith, Pearle Williams, Charles Patton, Vera Shaffer, Karen Donohue with Marlon Taka peeking over her shoulder, top of Jerle Hamrick's head just behind his wife Maude, Reba Shaffer, Terry Shaffer (wearing glasses), Mrs. Richard Patton and her husband, Marvin and Melissa Stump.

Widen Relief Committee

With Ernie Acree, Doyle Waggoner, Joe Truman and Harold Dawson representing the employees and H. L. Beattie and G. D. Craft representing Elk River Coal and Lumber Company, the Widen Relief Committee met at the company offices in Widen on November 26 and approved benefits for 203 active or retired employees as well as 30 widows and 50 surviving minor children of deceased employees.

There was no change in the list of retired men, that having remained the same since last August, with 27 men receiving monthly benefits of \$100.00 each.

The longest list of disability applications ever considered at one of these committee meetings was presented this time, with thirteen employees receiving benefits for the full month of November and thirteen others being paid for a part of the month. Six of these returned to work during November and there were fourteen new applicants this month.

The only change in the list of survivors was the removal of one child from the eligible rolls as she reached age 18.

Hospital and medical care was provided at Camden-on-Gauley, Charleston, Clarksburg, Clay, Clendenin, Cowen, Craigsville, Gassaway, Grantsville, Marmet, Oak Hill, Richwood, Summersville, Sutton, Webster Springs, and

Weston, W. Va., and Salem, Indiana, for 169 employees, of whom 19 were also receiving retirement or disability benefits. Two bills were refused payment, one because it was for insulin, which is a drug that can be purchased without prescription, and the other because it was for dental work even though payment of one bill was deferred by the committee which felt that the amount of the bill was excessive for two office calls. The physician concerned has been asked to itemize the bill for further consideration.

Here's a holiday note for all employees. At this time of year, probably each one of you made sure that the name of each member of your family was on at least one package under the Christmas tree. Have you made sure that all those names are on your dependency card in the payroll office? Failure to have all your dependents listed could turn out to be a lot more expensive than all the Christmas presents your family purchased. It only takes a minute to be sure and the payroll department personnel will be glad to check it with you.

Guthrie-Morris-Campbell Co.

CHARLESTON, WEST VIRGINIA

Wholesale Distributors of

DRY GOODS - NOTIONS - READY-TO-WEAR
MEN'S FURNISHINGS - FLOOR COVERING
VENETIAN BLINDS

CAMEO HOSE: THE NYLON HOSE WITH THE FACE
POWDER FINISH, FAVORITE OF GLAMOROUS MOVIE
ACTRESSES. SEE CAMEO HOSE DISPLAYED AT

AT ALL

ELK RIVER COAL AND LUMBER COMPANY STORES
WIDEN . DILLE . SWANDALE . DUNDON

CLAY COUNTY FREE PRESS

PHONE: 304-647-5724 | FAX: 304-647-5767

Publisher

Michael Showell

publisher@mountainmedianews.com

Editor

Sarah Richardson

news@claycountyfreepress.com

Advertising

Debra Smith

debra@mountainmedianews.com

Obituaries

Jeanette Allbaugh

jeanette@mountainmedianews.com

Published By Mountain Media, LLC
P.O. Box 429, Lewisburg, WV 24901

Visit Us Online At:

www.claycountyfreepress.com

**To place
your legals
Call us
at (304)-
647-5724**

 **Like us on
Facebook**



**Here, exploring is
never boring.**

You're on track for an unforgettable railbike adventure. Coming soon, you can explore lush mountain landscapes from a new point of view.

WVtourism.com/RailExplorers



almost-heaven

LEGALS

PROPOSED LEVY ORDER AND RATES, PENDING CERTIFIED CANVAS Clay COUNTY BOARD OF EDUCATION For the Fiscal Year Ended June 30, 2025

The following is a true copy from the record of orders entered by CLAY COUNTY BOARD OF EDUCATION on the 28th day of May 2024.

Column E Certificate of Valuation Assessed Value for Tax Purposes	Current Expense Levy	
	Levy Rate/\$100	Taxes Levied
Class I		
Personal Property	\$ -	\$ -
Public Utilities	-	-
Total Class I	-	-
Class II		
Real Estate	104,738,960	406,387
Personal Property	3,683,884	14,293
Total Class II	108,422,884	420,680
Class III		
Real Estate	59,705,760	463,317
Personal Property	55,943,126	434,119
Public Utilities	46,913,072	364,045
Total Class III	162,561,958	1,261,481
Class IV		
Real Estate	6,567,590	50,964
Personal Property	2,753,902	21,370
Public Utilities	2,617,744	20,314
Total Class IV	11,939,236	92,648
Total Assessed Valuation and Projected		
Gross Tax Collections	\$ 282,924,038	\$ 1,774,809
Less uncollectibles, exonerations and delinquencies	8.00%	(141,985)
Less tax discounts	1.00%	(16,328)
Less Allowance for Tax Increment Financing - see worksheet (Subtracted from regular current expense tax levy only)		-
Net Projected Tax Collections, before allowance for Assessor's Valuation Fund		1,616,496
Less - Assessor's Valuation Fund (Subtracted from regular current expense tax levy only)	2.00%	(32,330)
Projected Net Taxes to be Collected		\$ 1,584,166
Note: Copies of all approved excess and/or bond levy orders and certified copies of the canvass of votes must be on file with the State Auditor's Office and the State Department of Education before excess or bond levy rates can be approved.		

SIGNED THIS 15th DAY OF May, 2024 by
Philip R. Dobbins
SECRETARY OF THE
BOARD OF EDUCATION

PROPOSED LEVY ORDER AND RATES, PENDING CERTIFIED CANVAS Clay COUNTY BOARD OF EDUCATION For the Fiscal Year Ended June 30, 2025

The following is a true copy from the record of orders entered by CLAY COUNTY BOARD OF EDUCATION on the 28th day of May 2024.

	Excess Levy Levy Rates/\$100	Permanent Improvement Taxes Levied	Levy Rate/\$100	Taxes Levied	Bond Levy Levy Rate/\$100	Taxes Levied
Class I						
Personal Property	13.00	\$ -	-	\$ -	-	\$ -
Public Utilities	-	-	-	-	-	-
Total Class I	-	-	-	-	-	-
Class II						
Real Estate	26.00	272,321	-	-	-	-
Personal Property	-	9,578	-	-	-	-
Total Class II	-	281,899	-	-	-	-
Class III						
Real Estate	52.00	310,470	-	-	-	-
Personal Property	-	290,904	-	-	-	-
Public Utilities	-	243,948	-	-	-	-
Total Class III	-	845,322	-	-	-	-
Class IV						
Real Estate	52.00	34,151	-	-	-	-
Personal Property	-	14,320	-	-	-	-
Public Utilities	-	13,612	-	-	-	-
Total Class IV	-	62,083	-	-	-	-
Total Assessed Valuation and Projected Gross Tax Collections						
	\$ 1,189,304	\$ -			\$ -	
Less uncollectibles, exonerations and delinquencies	8.00% (95,144)			-		-
Less tax discounts	1.00% (10,942)			-		-
Less Allowance for Tax Increment Financing - see worksheet (Subtracted from regular current expense tax levy only)	-			-		-
Net Projected Tax Collections, before allowance for Assessor's Valuation	-			-		-
Less-Assessor's Valuation Fund	0.00%	-		-		-
(Subtracted from regular current expense tax levy only)				-		-
Projected Net Taxes to be Collected	\$ 1,083,218	\$ -				

SIGNED THIS 15th day of May, 2024 by
Philip R. Dobbins
SECRETARY OF THE
BOARD OF EDUCATION

PROPOSED LEVY ORDER AND RATES, PENDING CERTIFIED CANVAS Clay COUNTY BOARD OF EDUCATION For the Fiscal Year Ended June 30, 2025

The following is a true copy from the record of orders entered by CLAY COUNTY BOARD OF EDUCATION on the 28th day of May 2024.

	Excess Levy Levy Rates/\$100	Permanent Improvement Taxes Levied	Levy Rate/\$100	Taxes Levied	Bond Levy Levy Rate/\$100	Taxes Levied
Class I						
Personal Property	0.94	\$ -	-	\$ -	-	\$ -
Public Utilities	-	-	-	-	-	-
Total Class I	-	-	-	-	-	-
Class II						
Real Estate	1.88	19,691	-	-	-	-
Personal Property	-	693	-	-	-	-
Total Class II	-	20,384	-	-	-	-
Class III						
Real Estate	3.76	22,449	-	-	-	-
Personal Property	-	21,035	-	-	-	-
Public Utilities	-	17,639	-	-	-	-
Total Class III	-	61,123	-	-	-	-
Class IV						
Real Estate	3.76	2,469	-	-	-	-
Personal Property	-	1,035	-	-	-	-
Public Utilities	-	984	-	-	-	-
Total Class IV	-	4,488	-	-	-	-
Total Assessed Valuation and Projected Gross Tax Collections						
	\$ 85,995	\$ -			\$ -	
Less uncollectibles, exonerations and delinquencies	8.00% (6,880)	5.00%		-		-
Less tax discounts	1.00% (791)	1.00%		-		-
Less Allowance for Tax Increment Financing - see worksheet (Subtracted from regular current expense tax levy only)	-			-		-
Net Projected Tax Collections, before allowance for Assessor's Valuation	0			-		-
Less-Assessor's Valuation Fund	0.00%	-		-		-
(Subtracted from regular current expense tax levy only)				-		-
Projected Net Taxes to be Collected	\$ 78,324	\$ -				
Total Projected Net Taxes from Regular and Excess Levies	\$ 2,745,708					

SIGNED THIS 15th day of May, 2024 by
Philip R. Dobbins
SECRETARY OF THE
BOARD OF EDUCATION

LEGAL

COUNTY ASSESSOR STAFF TO BEGIN FIELD REVIEW

The Clay County Assessor's staff is mandated by the WV State Tax Department to make door to door visitation in a three-year cycle. This year 2024 properties include Buffalo and Otter Districts.

Visitation to these areas will start in May and will continue through summer. We will be driving by and taking pictures from the county vehicle. Our vehicle is a white Jeep, clearly marked on both side doors and with county plates.

Property will be reviewed by Teresa Davis, Assessor and McKenzie Smith, Chief Deputy Assessor. Kari Scott, Transfer Clerk, Carole Pierson, and Stephanie Wayne, Deputy Assessors within the office.

Owners with new construction permits will be checked later in the fall. Contact our office if you have had any changes or improvements to your property, such as anything new built or any removal of buildings.

If you have questions or like to contact us, please call 304-587-4258 Monday - Friday 8 a.m. - 4 p.m.
Teresa Davis, Clay County Assessor

LEGALS

ADVERTISEMENT

Notice is hereby given that WV RECLAIM CO, LLC, 2122 LEATHERWOOD ROAD, BICKMORE, WV 25019 has a permit on file with the Department of Environmental Protection (DEP) for the surface mining of approximately 350.99 acres and has submitted an application to the DEP, 47 School Street, Suit 301, Philippi, WV 26416-1600, for renewal of Article 3 Permit Number S200798 to operate a surface mine and highwall miner in the Middle and Lower Kittanning seam of coal.

The operation is discharging into Bullpen Fork of Right Fork of Leatherwood Creek of Leatherwood Creek of Elk River of Kanawha River and is located 3.0 miles east of Bickmore, in Henry/Pleasant District of Clay County, Longitude 81° 4' 17" and Latitude 38° 22' 45" (Coordinates from USGS Topographic Map).

Surface of the area associated herewith is owned by:	
NAME	ADDRESS
EL2, LLC	11 Speltz Land, Oley, PA 19547
AppleAtcha Land, LLC	200 Park Ave., Ste 400, Orange Village, OH 44122
Osborne Properties, Inc.	P.O. Box 4769, Charleston, WV 25304
Dale Exline	251 Lowell Drive, Elkview, WV 25071
Lyle and Mary Exline	144 Edgewood Drive, Hendersonville, TN 37075
Lemoyne Land Co., Inc.	Kenneth D Ward, 6889 Vic Ar Rd, Atlanta, GA 30360

*and the mineral associated herewith is owned by:	
NAME	ADDRESS
AppleAtcha Land, LLC	200 Park Ave., Ste 400, Orange Village, OH 44122
Osborne Properties, Inc.	P.O. Box 4769, Charleston, WV 25304
Lemoyne Land Co., Inc.	Kenneth D Ward, 6889 Vic Ar Rd, Atlanta, GA 30360
*and the mineral within 100 feet of the permit area is owned by:	
AppleAtcha Land, LLC	200 Park Ave., Ste 400, Orange Village, OH 44122
Osborne Properties, Inc.	P.O. Box 4769, Charleston, WV 25304

Surface of the area within 100 feet of the permit area is owned by:	
NAME	ADDRESS
EL2, LLC	11 Speltz Land, Oley, PA 19547
AppleAtcha Land, LLC	200 Park Ave., Ste 400, Orange Village, OH 44122
Osborne Properties, Inc.	P.O. Box 4769, Charleston, WV 25304
Dale Exline	251 Lowell Drive, Elkview, WV 25071
Lyle and Mary Exline	144 Edgewood Drive, Hendersonville, TN 37075
James A. Exline, Jr.	314 Weatherstone Lane, Marietta, GA 30068

Written comments and/or requests for an informal conference of the permit renewal application shall identify the applicant and application number and will be received by the Permit Supervisor at the DEP address above until 7/8/24, or thirty (30) days from the date of **final publication**. A copy of the application will be available for review until 7/8/24, or thirty (30) days from the date of final publication in the DEP Regional Office located at the address above and is available at:

http://apps.dep.wv.gov/WebApp/_dep/Search/ePermitting/ePermittingApplicationSearchPage.cfm
The above link can be accessed from a computer at all West Virginia public libraries.
DEP Telephone Number: 304-457-3219
Permit Number: S200798
*These items are to be completed only for operations involving mineral removal.

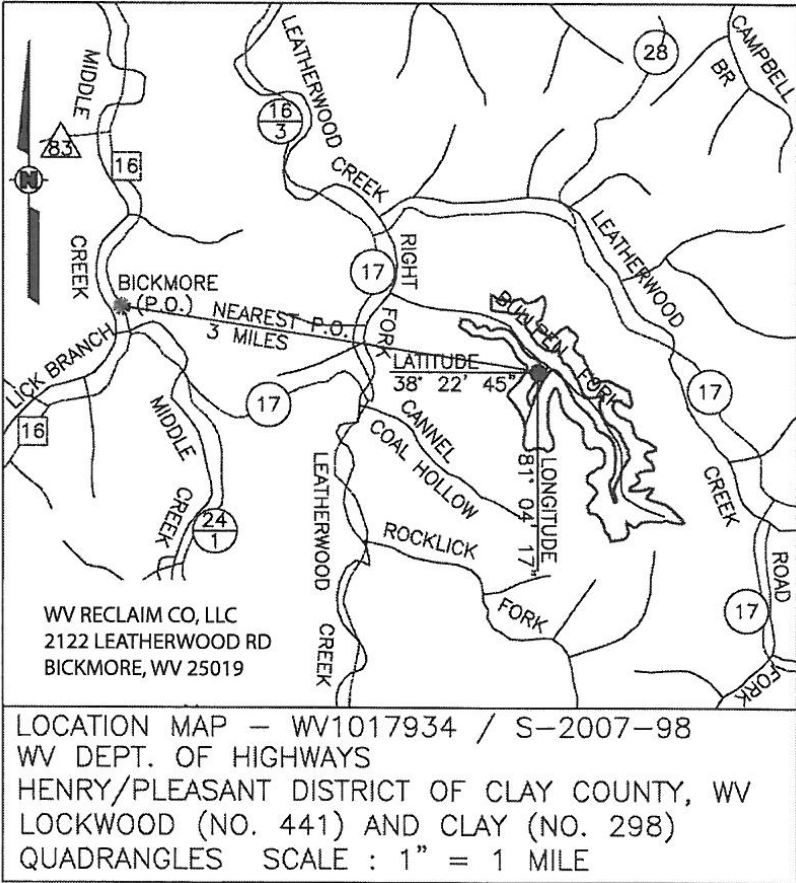

LEGALS

ADVERTISEMENT

Notice is hereby given that SCREAMING EAGLE COAL, LLC, 1245 22 MINE ROAD, HOLDEN, WV 25625, has a permit on file with the Department of Environmental Protection (DEP) for the surface mining of approximately 129.4 acres and has submitted an application to the DEP, 47 School Street, Suite 301, Philippi, WV 26416-1600, for renewal of Article 3 Permit Number O200893 to operate a haulroad in the N/A seam of coal.

The operation is discharging into Road Fork and Rocklick Fork of Leatherwood Creek of Elk River and Boardtree Branch and Peachorchard Branch of Twenty Mile Creek of Gauley River of Kanawha River and is located 4 miles, southeast of Bickmore, in Jefferson District of Nicholas County, Longitude 81° 2' 55" and Latitude 38° 20' 38" (Coordinates from USGS Topographic Map).

Surface of the area associated herewith is owned by:	
NAME	ADDRESS
Appleatcha Land, LLC	200 Park Ave Ste 400, Orange Village, OH 44122
*and the mineral associated herewith is owned by:	
NAME	ADDRESS
Appleatcha Land, LLC	200 Park Ave Ste 400, Orange Village, OH 44122
*and the mineral within 100 feet of the permit area is owned by:	
NAME	ADDRESS
Appleatcha Land, LLC	200 Park Ave Ste 400, Orange Village, OH 44122

Surface of the area within 100 feet of the permit area is owned by:	
NAME	ADDRESS
Appleatcha Land, LLC	200 Park Ave Ste 400, Orange Village, OH 44122
Written comments and/or requests for an informal conference of the permit renewal application shall identify the applicant and application number and will be received by the Permit Supervisor at the DEP address above until 7/13/24, or thirty (30) days from the date of final publication . A copy of the application will be available for review until 7/13/24, or thirty (30) days from the date of final publication in the DEP Regional Office located at the address above and is available at:	
http://apps.dep.wv.gov/WebApp/_dep/Search/ePermitting/ePermittingApplicationSearchPage.cfm	
The above link can be accessed from a computer at all West Virginia public libraries.	
DEP Telephone Number:	304-457-3219
Permit Number:	O200893

*These items are to be completed only for operations involving mineral removal.
Include location map in accordance with 38-2-3.2(b)(2)

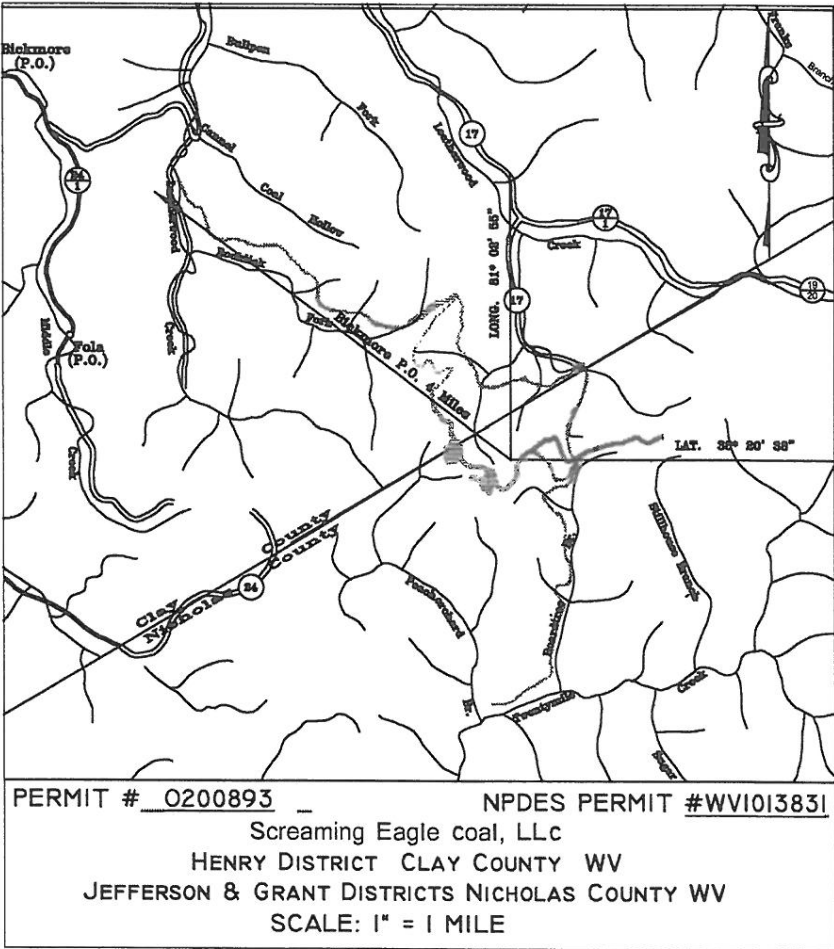

LEGALS

PUBLIC SERVICE COMMISSION OF WEST VIRGINIA CHARLESTON

CASE NO. 24-0322-E-IMM

APPALACHIAN POWER COMPANY and
WHEELING POWER COMPANY
Petition to Update the Broadband Surcharge Rates
Currently in Effect.

PUBLIC NOTICE OF CHANGE IN RATES UPON APPLICATION AND EVIDENTIARY HEARING

NOTICE is hereby given that Appalachian Power Company and Wheeling Power Company (the Companies), public utilities, have, on March 29, 2024, filed with the Public Service Commission of West Virginia a Petition to update their Broadband Surcharge (BBS) rates as required by W.Va. Code § 24-2-1p. If approved, the increased rates will apply to electric service to approximately 462,328 customers in the counties of Boone, Brooke, Cabell, Clay, Fayette, Greenbrier, Jackson, Kanawha, Lincoln, Logan, Marshall, Mason, McDowell, Mercer, Mingo, Monroe, Nicholas, Ohio, Putnam, Raleigh, Roane, Summers, Wayne, Wetzell, and Wyoming.

The Companies propose to increase BBS rates by approximately \$1.7 million, which is an overall total revenue increase of approximately 0.10%, effective for the period September 1, 2024 through August 31, 2025. If approved, the monthly bill for residential customers using 1,000 kWh as well as the average monthly usage bill for all classes of customers will be changed as follows:

	(\$) INCREASE	(%) INCREASE
Residential (1,000 kWh/month)	\$0.23	0.14%
Residential (1,150 kWh/month)	\$0.26	0.14%
Commercial	\$0.48	0.11%
Industrial	\$57.42	0.02%
Special Contract customers that are not on standard tariff rates	\$19.52	0.00%
Other	\$0.01	0.04%

The increases shown are based on the averages of all customers in the indicated class. Individual customers may receive an increase that is greater or less than average. Furthermore, the requested rates are only a proposal and are subject to change (increases or decreases) by the Public Service Commission in its review of this Petition. Any increase in rates will not become effective until authorized and approved by the Public Service Commission. The Public Service Commission will conduct an evidentiary hearing at 9:30 a.m. on September 11, 2024, in the Howard M. Cunningham Hearing Room, Public Service Commission Building, 201 Brooks Street, Charleston, West Virginia.

Anyone desiring to intervene should file a written petition to intervene by June 28, 2024. Failure to intervene timely can affect your right to participate in the proceeding. Requests to intervene must comply with the Commission's rules on intervention. Anyone desiring to protest should file a written or electronic protest at any time up to the start of the evidentiary hearing. All protests or requests to intervene should briefly state the reason for the protest or intervention. All protests and interventions should be addressed to: The Executive Secretary, Public Service Commission of West Virginia, P.O. Box 812, Charleston, West Virginia 25323.

APPALACHIAN POWER COMPANY and
WHEELING POWER COMPANY

LEGAL

NOTICE OF PUBLIC MEETING

The West Virginia Department of Environmental Protection has scheduled a public meeting on June 13, 2024, at 9:30 a.m. to discuss the ***Draft Fiscal Year 2025 Intended Use Plan*** for the Clean Water and Drinking Water State Revolving Funds Program. A part of the Intended Use Plan is the Fiscal Year 2025 Priority List. The meeting will take place in person at the WV DEP's Headquarters in Charleston, WV. An option to attend remotely or call-in is below. A copy of the draft Fiscal Year 2025 Intended Use Plan is available, and may be requested calling, writing, or sending an email request to the address below. The plan can also be viewed on DEP's web site.

Contact

Katheryn Emery
WV Department of Environmental Protection
Division of Water & Waste Management
Clean Water and Drinking Water State Revolving Funds
601 57th Street, SE
Charleston, WV 25304
(304) 926-0499 Ext. 43830
Katheryn.D.Emery@wv.gov

Google Meeting information

Video call link: <https://meet.google.com/bry-zmch-hhq>
Dial in number: (US) 1-202-888-5854
PIN: 588 630 971#
Promoting a healthy environment

LEGALS

PUBLIC SERVICE COMMISSION OF WEST VIRGINIA CHARLESTON

CASE NO. 24-0289-E-P

APPALACHIAN POWER COMPANY and
WHEELING POWER COMPANY
public utilities.

Petition to Update the MBRC Rates Currently in Effect

PUBLIC NOTICE OF CHANGE IN RATES UPON APPLICATION

NOTICE is hereby given that Appalachian Power Company and Wheeling Power Company (the Companies), public utilities, have, on March 15, 2024, filed with the Public Service Commission of West Virginia a Petition to update the Modified Rate Base Cost (MRBC) surcharge revenues. The Public Service Commission's June 30, 2021, Order in Case No. 20-1012-E-P required the Companies to file an annual MBRC update in March of 2022, 2023, and 2024. If approved, the increased rates will apply to electric service to approximately 460,774 customers in the counties of Boone, Brooke, Cabell, Clay, Fayette, Greenbrier, Jackson, Kanawha, Lincoln, Logan, Marshall, Mason, McDowell, Mercer, Mingo, Monroe, Nicholas, Ohio, Putnam, Raleigh, Roane, Summers, Wayne, and Wyoming.

The Companies propose to recover total incremental revenue requirements for certain rate base increases added between October 1, 2022 and September 30, 2023. The proposed increased rates and charges will produce approximately \$32.2 million annually in additional revenue, and increase of 1.82% over revenue at current rate and usage levels. The average monthly bill for the various class of customers will be changed as follows:

	(\$) INCREASE	(%) INCREASE	Avg. Monthly kWh
Residential	\$4.11	2.42%	1,000
Residential	\$4.59	2.39%	1,150
Commercial	\$7.39	1.74%	3,491
Industrial	\$3,635.30	1.40%	3,570,241
Special Contract ¹	\$8,532.52	1.59%	7,868,548
Other	\$0.23	1.39%	108

¹Excludes Special Contract customers who are billed standard tariff rates.

The increases requested vary by customer class and customer usage level. Individual customers may receive an increase that is greater or less than average. Furthermore, the requested rates are only a proposal and are subject to change (increases or decreases) by the Public Service Commission in its review of this Petition. Any increase in rates will not become effective until authorized and approved by the Public Service Commission. The Public Service Commission will conduct an evidentiary hearing at 9:30 a.m., August 28, 2024, in the Howard M. Cunningham Hearing Room, Public Service Commission Building, 201 Brooks Street, Charleston, West Virginia.

Anyone desiring to intervene should file a written petition to intervene by 4:00 p.m. May 31, 2024. Failure to intervene timely can affect your right to participate in the proceeding. Requests to intervene must comply with the Commission's rules on intervention. Anyone desiring to protest should file a written or electronic protest at any time up to the start of the evidentiary hearing. All protests or requests to intervene should briefly state the reason for the protest or intervention. All protests and interventions should be addressed to: The Executive Secretary, Public Service Commission of West Virginia, P.O. Box 812, Charleston, West Virginia 25323. A complete copy of this tariff, as well as a representative of the Company to provide any information requested concerning it, is available to all customers, prospective customers, or their agents at the following office of the Companies: 200 Association Drive, Charleston, WV 25311. A copy of this tariff is also available to all customers, prospective customers, or their agents on the website of the Companies: www.appalachianpower.com/account/bills/rates/APCORatesTariffsWV.aspx

Any customer wishing to receive a reduced-size copy of the tariff can telephone toll-free at 800-982-4237, request such a copy, and provide the necessary mailing information, and a copy will be mailed to the customer. A copy of this tariff is also available for public inspection at the office of the Executive Secretary of the PUBLIC SERVICE COMMISSION at 201 Brooks Street, Charleston, West Virginia.

APPALACHIAN POWER COMPANY
And WHEELING POWER COMPANY

LEGAL

IN THE CIRCUIT COURT OF CLAY COUNTY, WEST VIRGINIA

In the Matter of Petition of Name Change of

Angel Lanae McDivitt

Current Name

To

New Name Angel Lanae Petry

Civil Action No. 24-P-12

Judge Alsop

Legal Notice of Publication Change of Name

Order of Publication Circuit Court of Clay County West Virginia

Notice is hereby given that on the 17th day of June, 2024 at 10:50 a.m., or as soon thereafter as the matter can be heard, Petitioner Angel Lanae McDivitt will apply by Petition to the Circuit Court of Clay County, West Virginia, for the entry of an order by said court, changing name of Angel Lanae McDivitt to Angel Lanae Petry at which time any interested party may appear and be heard, if they so desire. A copy of said Petition can be obtained from the undersigned Clerk at his office.

ENTERED by the Clerk of said Court this 16th day of May 2024.

Charissa Harshaw
Circuit Clerk of Clay County, WV

IN THE FAMILY COURT OF CLAY COUNTY, WEST VIRGINIA

CIVIL ACTION NO. 24-D-27

PETITIONER,

JANET ANN HAYS

RESPONDENT,

WILLIAM TRAVIS HAYS

ORDER OF PUBLICATION

THE OBJECT OF THIS SUIT IS TO OBTAIN A PETITION FOR DIVORCE:

It appearing by affidavit filed in this action that **WILLIAM TRAVIS HAYS** may or may not be a resident of the State of West Virginia or has an unknown address. It is hereby ordered that **WILLIAM TRAVIS HAYS** appear for a PETITION FOR DIVORCE hearing on JUNE 27, 2024 at 12:00 PM, including any related counterclaim or defense you may have to the **Petition for DIVORCE** filed in this action. If you fail to appear, a judgement may be taken against you for the relief demanded in the Petition.

A copy of said Petition can be obtained from the undersigned Clerk's Office.

Entered by the Clerk of said Court on May 17, 2024.

Charissa Harshaw
Clerk of the Court

LEGAL

ANNEX

Continued from Page 1

Adam Krasen and Nathaniel Spencer of ZMM Architectural Firm.

PSD Board and the appointment of Morgan Triplett as the Triplett Ridge replacement. They approved the appointment of Marjorie Mullins to the Library Board term ending June 2029. They approved removing Maria Moles and Jeremy Cantrell from the BDA Board.

They approved the purchase of a big commercial mower for the purposes of cutting grass at Spread Park and at Maysel Park. It will be kept by Parks and Recreation at the Maysel Park location. They also added Logan's Towing to the County 911 Rotation Schedule. They are based in Widen, and rotation began on Wednesday, May 15.

The commission approved a resolution allowing the county's 911 employees to join the Emergency Medical Services Retirement System. Clay is one of three remaining counties that had not as yet made this move, mandated by the State Legislature in 2023 with a deadline coming up on May 31st of this year.

The commission cancelled the second regular County Commission meeting at the end of the month due to it falling on the Memorial Day holiday. The next meeting will be on June 10. Commissioner David Schoolcraft suggested that county payroll should go out that previous Friday so that employees would not have to wait through the holiday. They all agreed to pay utilities and payroll early.

Terry Martin gave an update on the Big Otter/Nebo water project. He ran a legal ad last Wednesday, they are working on easements and cleared it environmentally. It will be ready to go to bid in July or August for construction.

Commissioner Kinder announced that she was at the last CAEZ board meeting where she sits, and they are finally getting ready to sell the old Mount Hope commercial property to an owner of the adjacent property for \$86,000.



Terry Martin

Sheriff King then announced that his department may possibly be getting a canine unit. They have grant money and someone who will pick up the rest of the cost. A dog that would be attached to the county, a vehicle would be equipped for special transportation, training for the dog and a Sheriff Deputy are in the works. The sheriff was inquiring about liability insurance. Commission Schoolcraft and Joyce Johnson said that was probably covered under policies of the court, but would check into it for him. Deputy Traub would be the officer trained for canine care and handling. Training would begin in June so the sheriff was trying to get all this finalized quickly. This could be a game changer, Sheriff King said, when it comes to drug interdiction. This would be a first for Clay County.

Commissioner Kinder announced she attended a meeting with the Ohio Valley Workforce where they announced they had set aside \$360,000 for Clay County exclusively that the state has created a summer program that will take 20 youth, 15 of which were seniors this year. They are going to send them out to CM12 at Lizemores to train them in survival skills and more. And there is the potential that following the summer program, that up to 15 students could get job offers to become full time employees at CM12.

NORTH AMERICA'S
#1 Selling Walk-In Tub
Featuring our **Free Shower Package**

SPECIAL OFFER

Call today and receive a **FREE SHOWER PACKAGE PLUS \$1600 OFF**

Call Toll-Free **1-844-803-1282**

SAFE-STEP WALK-IN TUB

Call Today for Your Free Shower Package

1-844-803-1282

FINANCING AVAILABLE WITH APPROVED CREDIT

A CASE OF LIFE

MADE IN THE USA

BBB

LIFETIME WARRANTY

Donate Your Vehicle

Call (888) 964-4167 to donate your car, truck, boat, RV, and more today!

How It Works:

1. Donate Your Vehicle
2. Schedule Pickup
3. Receive Top Tax Deduction

Call today 888-964-4167

We'll pickup your vehicle for FREE - no title and no paperwork required.

You may qualify for a tax deduction.

Support Veteran Nonprofits.

Free Pickup & Towing.

Top Tax Deduction.

Donate Your Vehicle Today

888-964-4167

AMERICAN CAR DONATION

Panther shuttle hurdle team places eighth at states



Evan Bass competed in the 110 meter hurdles.

By Allen Hamrick

The CCHS track team took their skills to the state competition held in Charleston at UC Stadium/Laidley Field this past week. Here is where the competition would be running, jumping, and throwing to see who would be called the best in the state in their respective events. This year, the Panthers sent four athletes to represent CCHS at the meet. When someone makes it to the state level of track competition, it means that they are already some of the best athletes in the state regardless of where they place; it is quite an accomplishment. One of the biggest highlights for the Panthers in the meet was the shuttle hurdle team. In the AA division, there are many teams who compete at this level, and only the best of them get top ten statuses.

The Panther team went head to head against some tough competition at the state level. When they were done, the shuttle hurdle team made up of Daymian



Daymian Stricker competes in the pole vault.

Stricker, Justin Nida, Takota Quinn and Evan Bass placed 8th in the event. Evan Bass and Daymian Stricker were also some of the top athletes in other events. Bass participated in the 110 low hurdles, placing 12th, and Stricker was in the pole vault, placing 15th, and also competed in the high jump. Even though they didn't medal in these events, just to be there competing means you're in the top 25 in the state. All in all, it has been a great season for the CCHS track team. Track hardly ever gets the recognition that it deserves, but the shuttle hurdle team and all the other CCHS athletes that competed proved that, without a doubt, the track program just gets better with age. This year's state competition is solid proof of that.

Congratulations to these Clay County athletes for gutting out the season and landing among the top in the field of hurdling. The next season looks promising with new athletes coming up to the team and others that will be returning to make next year one of the best yet.



Lest We Forget Celebrate • Honor • Remember

On Memorial Day, we pay tribute to those who fought and made the ultimate sacrifice for our country. Their courage and service will never be forgotten, and we owe them and their loved ones a debt of gratitude that can never be repaid. Let us always remember that freedom is not free.

★★★★★★★★

From the Staff of
The Clay County Free Press

YARD SALE

Large Multi-Family Yard Sale. 234 Center St., Two Run, May 31-June 2 Clothing of all sizes, Toddler chairs/mattresses, Household items, toys, shoes, tires., car parts, above-ground swimming pool. Rain date June 3-4.

JOHN G. HUBBARD, DDS, PLLC

John G. Hubbard, DDS • R. Brooks Legg, Jr., DDS

Honor graduates of West Virginia University School of Dentistry
Over 60 Years Combined Clinical Experience



We love kids!
We have over 100,000 pediatric visits (children 12 and under)

SERVICES:

- Cosmetic Dentistry • Pediatric Dentistry • Extractions
- Oral Cancer Examinations • Porcelain Veneers/Crowns/Bridges
- Root Canal Therapy • Implants/Implant retained Dentures & Crowns
- Nitrous Oxide Sedation • Bleaching

DISCOUNTS:
Veterans 10% • Senior Citizens 10% • Private Pay Patients With No Dental Insurance 10%

Preferred providers for Mountain State Blue Cross/Blue Shield, Delta Dental, MetLife, United Concordia, 4 Most, CHIPS, WV Pre-employment Program, Adults & Child Medicaid.

HOURS: Monday thru Friday 8 am - 4 pm

63 Carr Street • Clay, WV 25043

304-587-4232 • johnghubbarddds@gmail.com

"We Treat Others As We Like To Be Treated Ourselves." – Matthew 7:12

West Virginia Statewide Classified Network

Featured in WVPA Newspapers Across West Virginia

HEALTH/MEDICAL

IS 2024 YOUR YEAR? We're here for it and here for you. Reach your goals this year with WeightWatch-ers. Get started with THREE months FREE, visit www.weightwatchersoffer.com/46

DONT LET THE STAIRS LIMIT YOUR MOBILITY! Discover the ideal solution for anyone who struggles on the stairs, is concerned about a fall or wants to regain access to their entire home. Call AmeriGlide today! 1-844-592-5113

PORTABLE OXYGEN CONCENTRATOR May Be Covered by Medicare! Reclaim independence and mobility with the compact design and long-lasting battery of Inogen One. Free information kit! Call 833-274-3943

DENTAL INSURANCE from Physicians Mutual Insurance Company. Coverage for 400 plus procedures. Real dental insurance - NOT just a discount plan. Do not wait! Call now! Get your FREE Dental Information Kit with all the details! 1-855-405-3412 [#6258](http://www.dental50plus.com/press)

INTERNET/TV

GET DISH SATELLITE TV + INTERNET! Free Install, Free HD-DVR Upgrade, 80,000 On-Demand Movies, Plus Limited Time Up To \$600 In Gift Cards. Call Today! 1-855-736-4350

CONNECT TO THE BEST WIRELESS

HOME INTERNET WITH EARTHLINK. Enjoy speeds from 5G and 4G LTE networks, no contracts, easy installation, and data plans up to 300 GB. Call 844-230-3640

SWITCH AND SAVE up to \$250/year on your talk, text and data. No contract and no hidden fees. Unlim-ited talk and text with flexible data plans. Premium nationwide coverage. 100% U.S. based customer service. For more information, call 1-855-615-6411

JOBS

TRAIN ONLINE TO DO MEDICAL BILLING! Become a Medical Office Professional online at CTI! Get Trained, Certified & ready to work in months! Call 877-635-0244. The Mission, Program Information and Tuition is located at Career-Technical.edu/consumer-information. (M-F 8am-6pm ET)

MISCELLANEOUS

DONATE YOUR CAR, truck, boat, RV and more to support our veterans! Schedule a FAST, FREE vehi-cle pick-up and receive a top tax deduction! Call Veteran Car Donations at 1-888-964-4167 today!

BATH & SHOWER UPDATES in as little as ONE DAY! Affordable prices - No payments for 18 months! Lifetime warranty & professional installs. Senior & Military Discounts available. Call:

844-601-2044

HANDS ON THE RIVER MASSAGE, Geraldine Gardner, LMT, 3422 Pennsylvania Ave., Charleston, WV. Call (304) 541-9139 for an appointment.

ELIMINATE GUTTER CLEANING FOREVER! LeafFilter, the most advanced debris-blocking gutter protection. Schedule a FREE LeafFilter estimate today. 20% off Entire Purchase. Plus 10% Senior & Military Discounts. Call 1-844-295-2840

PREPARE FOR POWER OUTAGES TODAY with a Generac Home Stand-by Generator. Act now to re-ceive a FREE 5-Year warranty with qualifying purchase. Call 1-844-901-2301 today to schedule a free quote. It's not just a generator. It's a power move.

UP TO \$15,000.00 OF GUARANTEED LIFE INSURANCE! No medical exam or health questions. Cash to help pay funeral and other final expenses. Call Physicians Life Insurance Company - 888-217-5559 or visit www.Life55plus.info/wv

SAFE STEP. NORTH AMERICAS #1 WALK-IN TUB. Comprehensive lifetime warranty. Top-of-the-line installation and service. Now featuring our FREE shower package and \$1600 Off for a limited time! Call today! Financing available. Call Safe Step 1-844-803-1282

**Your Ad
Could Be
Here!**

Call us at
304-647-5724

FOLLOW US ON



Place YOUR statewide ad today
Call the WV Press at (304) 342-1011

