

TYP. CAULKING DETAIL

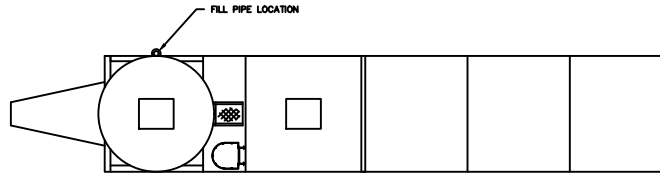

PLAN VIEW

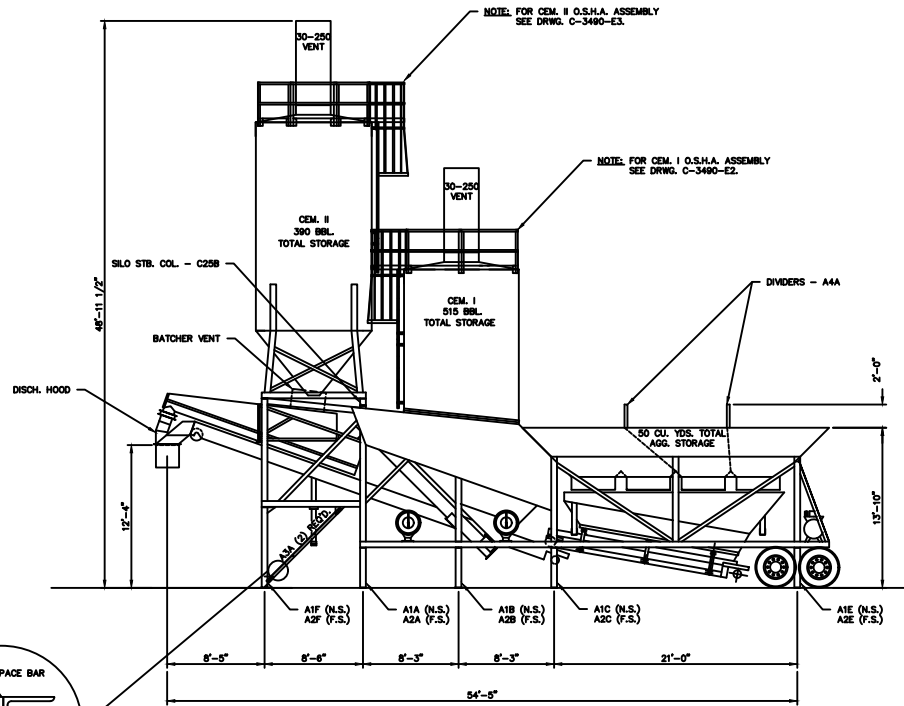

SIDE ELEVATION

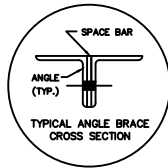
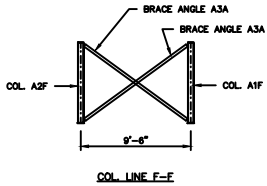

TYPICAL ANGLE BRACE CROSS SECTION

\*\*\* STANDARD LO-PRO \*\*\*

QUAN	PC-MK	PART DESCRIPTION
1		MODEL 10 LO-PRO PORTABLE PLANT
1		KEYS FOR ELECTRICAL SERVICE PANEL (WIRED IN MAIN DISCONNECT)
1		INSTRUCTION AND PARTS MANUAL
1	AAA	AGGREGATE BIN DIVIDER
1		DC-14 CEMENT BATCHER VENT
6		LOWER SUPPORT COLUMNS
1		(A1A, A2A, A1C, A2C, A1E, A2E)
1		DISCHARGE HOOD 1/2" DIA. X 24" SHROUD
1		ELEPHANT TRUNK SHROUD, 12" DIA. X 12' LG. (LOWER SHROUD)
1		HYFALON SHROUD, 12" DIA. X 10' LONG (UPPER SHROUD)
3		HOSE CLAMP, 1 1/2" DIA.
1	CANS	DASHPOT OIL
3	GAL.	TOUCH-UP PAINT
80		SHelf LEVER WEIGHTS
14		BOLTS, 3/4" DIA. X 2" (A325) W/NUTS & L.W. (A.C. & E. COLLARS)
14		BOLTS, 3/8" DIA. X 1 1/2" W/NUTS, L.W. & L.W. (AGGREGATE DIVIDER)
40		BOLTS, 3/8" DIA. X 1" W/NUTS & L.W. & F.W. (VENTS)
5		BOLTS, 1/2" DIA. X 1 1/2" W/NUTS & L.W. (DISCHARGE HOOD)
2		HOSE CLAMPS, 1/2" DIA. (MANIFOLD TO BAG FILTER)
1		MAIN CONTROL CABLE X 40'-0" (MNTD.)
1		CEMENT SCALE CABLE X 30'-0"
1		AGGREGATE SCALE CABLE X 30'-0"
1		CONTROL PANEL, CON-E-CO MODEL 80 SERIES BATCH DATA RECORDER

\*\*\* CEMENT I EXTENSION \*\*\*

QUAN	PC-MK	PART DESCRIPTION
1	B15A	300 BBL. AUXILIARY CEMENT STORAGE MODULE COMPLETE W/ 6" FILL PIPE, HOSE LADDER, MANIFOLD & 7" DIA. PRESSURE RELIEF VALVE
1	B7A	FILTER VENT (MODEL 30-250)
1		HOSE CLAMP, 5 1/2" DIA. (E50)
85		BOLTS, 1/2" DIA. X 1 1/2" W/NUTS, L.W.
2		LOWER SUPPORT COLUMNS (A1B, A2B)
10		BOLTS, 3/4" DIA. X 2" (A325) W/NUTS & L.W. (COLUMN B)
6	TUBES	CAULKING

\*\*\* CEMENT I LADDER & HANDRAIL \*\*\*

QUAN	PC-MK	PART DESCRIPTION
1	B22A	HANDRAIL SECTION
1	B22B	HANDRAIL SECTION
4	B22D	HANDRAIL ANGLES
2	B22E	TOEBOARDS
1	B22F	HANDRAIL POST
1	B22C	HANDRAIL SECTION (WITH CATWALK)
1	B21A	CROSSOVER CATWALK
1	B17A	LADDER, 6'-0"
1	B18A	CAGE, ENTRY, 4'-0"
1	B20A	CAGE, TOP
100	B18A	LADDER BRACKET
		BOLTS, 1/2" DIA. X 1 1/2" W/NUTS, L.W. & F.W. (HANDRAILS, LADDER AND CAGE)

\*\*\* LO-PRO CEMENT II EXTENSION \*\*\*

QUAN	PC-MK	PART DESCRIPTION
1	C25A	390 BBL. CEMENT II & III SILO (SPLIT) COMPLETE W/ (2)-4" FILL PIPES, INSIDE LADDERS, MANIFOLD & (2)-7" DIA. PRESSURE RELIEF VALVES
2	C28A	FILTER VENT (MODEL 30-250)
1		FLEXHAUST, 2" DIA. X 12'-0"
2		HOSE CLAMP, 2" DIA.
2	C26A	FILL PIPE, 4" DIA. X 12' 4-3/4"
2	C28B	FILL PIPE MOUNTING BRACKET ASSEMBLY
3	C28B	SILO STR. COLUMNS
3		SHIMS 6" X 6" (12 GA.)
2		SHIMS 6" X 6" (16 GA.)
2		ANDREWS COUPLING, 4" W/DUST CAP
2		FILL PIPE GASKET, 4" (RED RUBBER)
2		HYFALON SHROUD, 10" DIA. X 10' LONG
2		HOSE CLAMP, 10" DIA.
4		LOWER SUPPORT COLUMN (A1E, A2E)
2	A3A	ANGLE BRACES X 10' 10-5/8"
2	A3B	ANGLE BRACES X 6' 11-1/2"
2		BOLT-ON (CEMENT BATCHER/FLY ASH SHROUD ATTACHMENT RING)
16		BOLTS, 3/8" DIA. X 1 1/2" W/NUTS & L.W. (SHROUD ATTACHMENT RING)
16		BOLTS, 3/4" DIA. X 3 1/2" W/NUTS & L.W. (FILL PIPE)
80		BOLTS, 3/8" DIA. X 1" W/NUTS, L.W. & F.W. (BAG FILTER)
12		BOLTS, 1/2" DIA. X 1 1/2" W/NUTS & L.W. (FILL PIPE BRACKET)
16		BOLTS, 3/4" DIA. X 2" (A325) W/NUTS, L.W. & COLLARS
30		BOLTS, 3/4" DIA. X 2" (A325) W/NUTS & L.W. (ANGLE BRACES)
25		BOLTS, 3/4" DIA. X 2" (A325) W/NUTS & L.W. (SILO MOUNTING)
4		1/2" DIA. X 15'-0" AIR HOSE (CEMENT II & FILTER VENT)
8		1/2" DIA. HOSE CLAMPS

\*\*\* CEMENT II 10'-0" SILO HANDRAIL \*\*\*

QUAN	PC-MK	PART DESCRIPTION
8	C38A	HANDRAIL POSTS
16	C38A	HANDRAIL ANGLES
7	C40A	TOEBOARDS
1	C33A	LADDER, 10'-0"
1	C34A	LADDER, 3'-0"
8	C32A	LADDER BRACKETS
1	C36A	CAGE, ENTRY, 4'-0"
1	C37A	CAGE, TOP
100		BOLTS, 1/2" DIA. X 1 1/2" W/NUTS, L.W. & F.W.

SCALE	3/16"=1'-0"
SHEET NO.	
DATE	7-9-87
DRAWN	JHS
CHECKED	

TITLE	LO-PRO ASSEMBLY
COMPANY	HARRIS TRUCK & EQUIP., CO.
LOCATION	TREMONTON, UTAH



PART NO.	
JOB NO.	C-3490
DWG NO.	
	C-3490-E1