

RESIDENCIAL AZURE IV

LO ROMERO GOLF - PILAR DE LA HORADADA

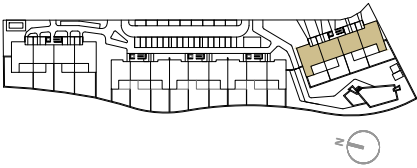

VIVIENDA TIPO V.108

SUPERFICIES ÚTILES / OCCUPIABLE AREA

LIVING ROOM - KITCHEN	36.20 m2
PASO / CORRIDOR	1.70 m2
DORMITORIO 1 / BEDROOM 1	15.50 m2
BAÑO 1 / BATHROOM 1	3.60 m2
DORMITORIO 2 / BEDROOM 2	11.25 m2
DORMITORIO 3 / BEDROOM 3	10.80 m2
BAÑO 2 / BATHROOM 2	3.60 m2

TERRAZA 1 / TERRACE 1	24.30 m2
JARDIN 1 / GARDEN 1	13.20 m2
JARDIN 2 / GARDEN 2	47.90 m2

SUPERFICIES CONST. / BUILT AREA

SUP. CERRADA / CLOSED AREA	100.05 m2
CLOSED AREA + TERRACE	124.35 m2
CLOSED AREA + TERRACE + GARDEN	185.45 m2

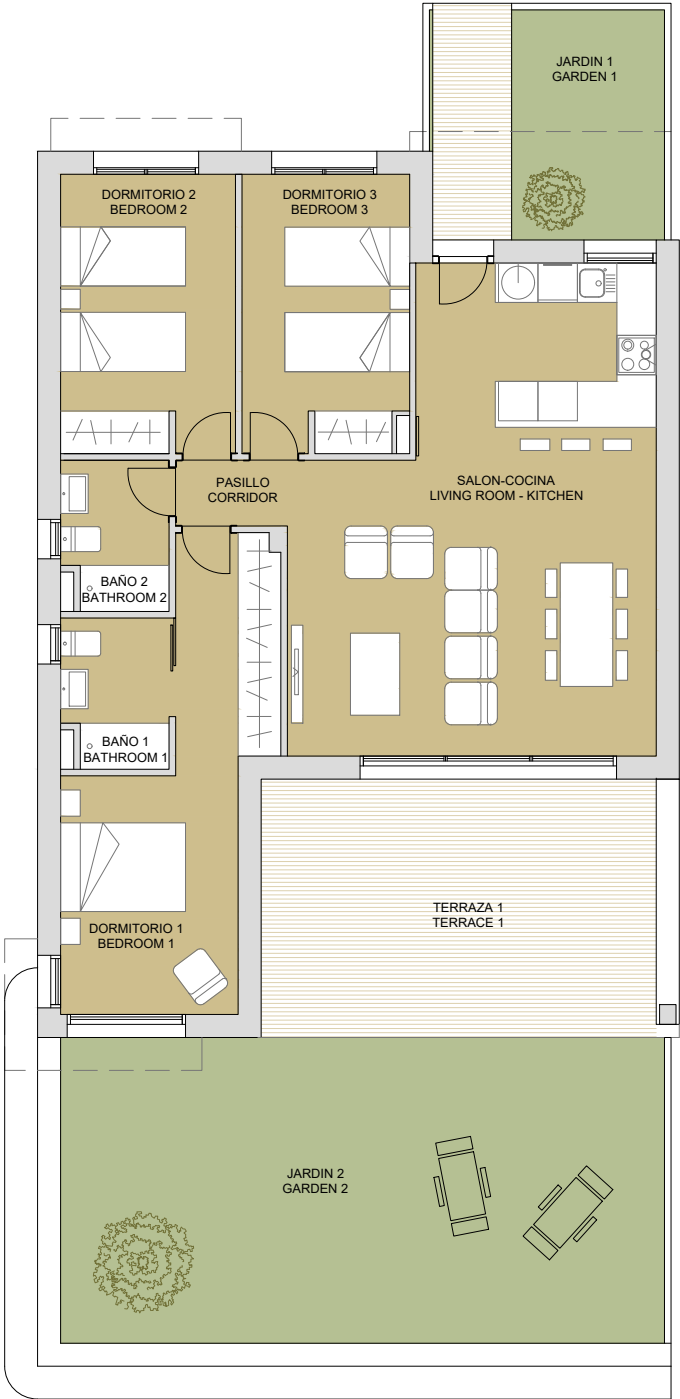
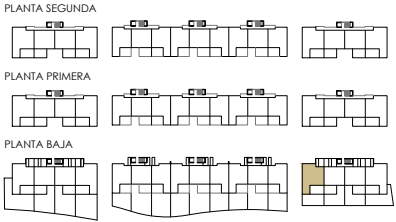

PLAN SUBJECT TO POSSIBLE MODIFICATIONS FOR TECHNICAL OR LEGAL REASONS. THE MEASUREMENTS SHOWN ARE APPROXIMATE
 PLANO SUJETO A POSIBLES MODIFICACIONES DE INDOLE TÉCNICA O JURÍDICA. LAS SUPERFICIES SON APROXIMADAS



CONTACT: 0034 650 834 472
 info@binomiumproperties.com
 www.binomiumproperties.com