

# RESIDENCIAL AZURE IV

LO ROMERO GOLF - PILAR DE LA HORADADA

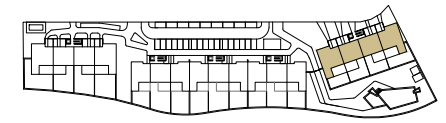

## VIVIENDA TIPO V.117

### SUPERFICIES ÚTILES / OCCUPIABLE AREA

LIVING ROOM - KITCHEN	36.20 m2
PASO / CORRIDOR	1.70 m2
DORMITORIO 1 / BEDROOM 1	15.50 m2
BAÑO 1 / BATHROOM 1	3.60 m2
DORMITORIO 2 / BEDROOM 2	11.25 m2
DORMITORIO 3 / BEDROOM 3	10.80 m2
BAÑO 2 / BATHROOM 2	3.60 m2

TERRAZA 1 / TERRACE 1	24.30 m2
JARDIN 1 / GARDEN 1	13.20 m2
JARDIN 2 / GARDEN 2	68.25 m2

### SUPERFICIES CONST. / BUILT AREA

SUP. CERRADA / CLOSED AREA	100.05 m2
CLOSED AREA + TERRACE	124.35 m2
CLOSED AREA + TERRACE + GARDEN	205.80 m2

PLANTA SEGUNDA

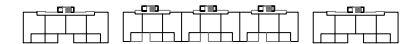

PLANTA PRIMERA

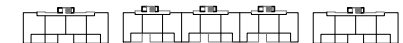

PLANTA BAJA

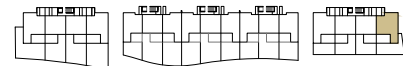

PLAN SUBJECT TO POSSIBLE MODIFICATIONS FOR TECHNICAL OR LEGAL REASONS. THE MEASUREMENTS SHOWN ARE APPROXIMATE  
PLANO SUJETO A POSIBLES MODIFICACIONES DE INDOLE TÉCNICA O JURÍDICA. LAS SUPERFICIES SON APROXIMADAS

**binomium**  
properties

CONTACT: 0034 650 834 472  
info@binomiumproperties.com  
www.binomiumproperties.com