

RESIDENCIAL AZURE IV

LO ROMERO GOLF - PILAR DE LA HORADADA

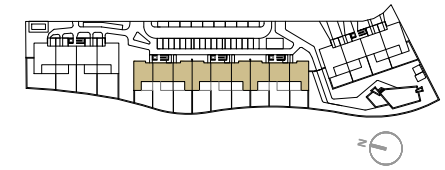

VIVIENDA TIPO V.96

SUPERFICIES ÚTILES / OCCUPIABLE AREA

| | |
|--------------------------|----------------------|
| LIVING ROOM - KITCHEN | 35.00 m ² |
| PASO / CORRIDOR | 1.55 m ² |
| DORMITORIO 1 / BEDROOM 1 | 14.10 m ² |
| BAÑO 1 / BATHROOM 1 | 3.50 m ² |
| DORMITORIO 2 / BEDROOM 2 | 10.30 m ² |
| BAÑO 2 / BATHROOM 2 | 3.50 m ² |

| | |
|-----------------------|----------------------|
| TERRAZA 1 / TERRACE 1 | 19.75 m ² |
| JARDIN 1 / GARDEN 1 | 65.50 m ² |

SUPERFICIES CONST. / BUILT AREA

| | |
|--------------------------------|-----------------------|
| SUP. CERRADA / CLOSED AREA | 82.85 m ² |
| CLOSED AREA + TERRACE | 102.60 m ² |
| CLOSED AREA + TERRACE + GARDEN | 168.10 m ² |

PLANTA SEGUNDA

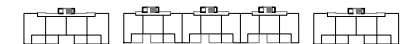

PLANTA PRIMERA



PLANTA BAJA

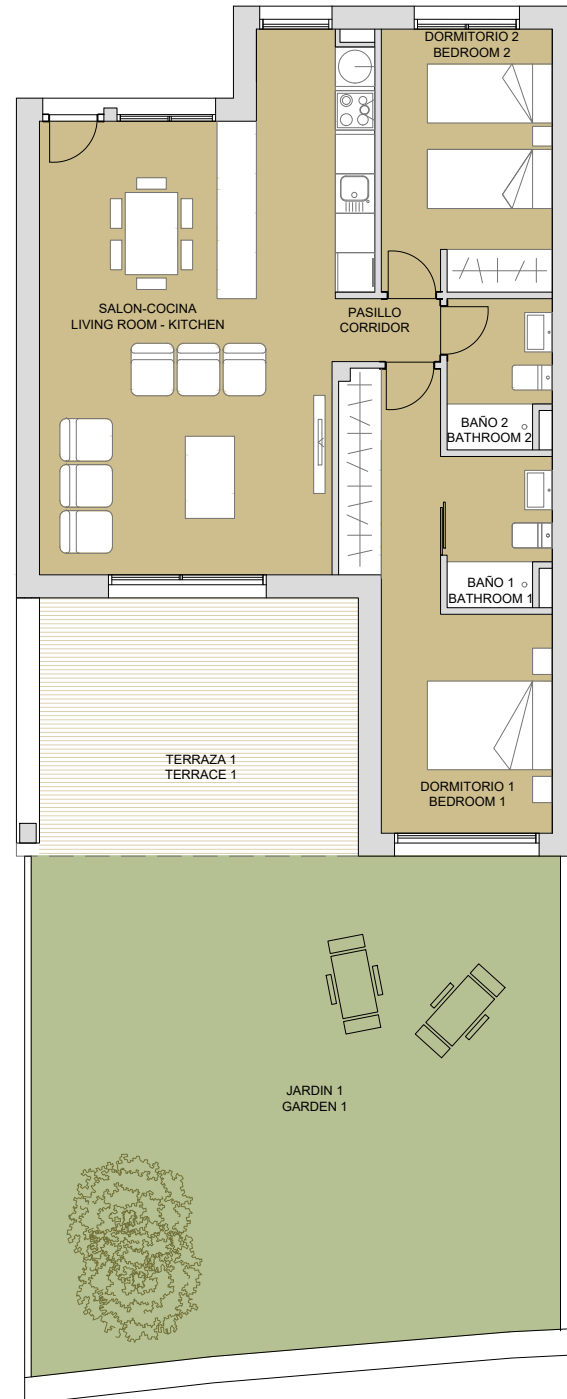
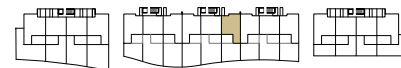

PLAN SUBJECT TO POSSIBLE MODIFICATIONS FOR TECHNICAL OR LEGAL REASONS. THE MEASUREMENTS SHOWN ARE APPROXIMATE
PLANO SUJETO A POSIBLES MODIFICACIONES DE INDOLE TÉCNICA O JURÍDICA. LAS SUPERFICIES SON APROXIMADAS



b binomium
properties

CONTACT: 0034 650 834 472
info@binomiumproperties.com
www.binomiumproperties.com