

Let's get started

Google Nest Protect (Battery)
Smoke and carbon monoxide alarm
User's Guide

Google

Table of contents

Meet your Nest Protect	4
Setup and installation	6
Location in your home	8
Placement on the ceiling or wall	10
Heads-Up and Emergency Alarms	12
Daily Use and Emergency Preparation	14
General Maintenance	16

Visit g.co/nest/protectbasics to learn more about installing, using and troubleshooting Nest Protect.

¿Prefieres leer esto en español? Visita g.co/nest/esuserguide



Meet your Nest Protect

Nest Protect is designed to detect smoke and carbon monoxide in a residential environment.

It has multiple sensors to help it understand what's happening in your home, including a Split-Spectrum Sensor to detect a wide range of slow-smoldering and fast-flaming fires.

This guide covers the installation of Nest Protect (Battery) - Model number O6A.

Requirements

You need Wi-Fi, an iOS or Android phone or tablet, and a free account in order to use some Nest Protect features: spoken room names, wireless mobile notifications, and software updates. During setup, Wi-Fi and a free account are required for wireless interconnect and room naming. After all the Nest Protects in your home are connected, they can communicate with each other without Wi-Fi.

Inside the box you'll find:



Nest Protect



Backplate



4 mounting screws



5.3 in
(13.5 cm)

1.5 in
(3.9 cm)

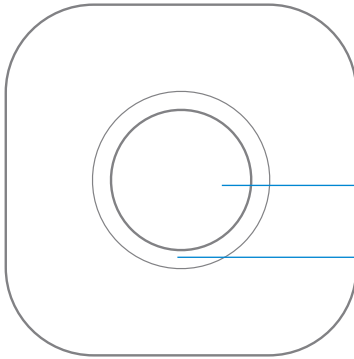

The horn enables Nest Protect to alert you with a loud emergency sound.

The speaker allows Nest Protect to speak with a human voice.

Push the button to hush alarms or run a test.

The light ring changes color to alert you.

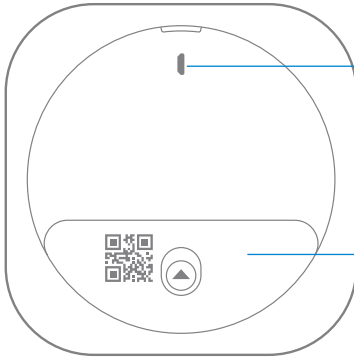

Micro-USB connector
(not for normal use).

Battery compartment:
Six AA Energizer® Ultimate
Lithium batteries (L91).

Setup and installation

1. Get the Nest app

Before you install your Nest Protect on the ceiling or wall, you'll need to set it up with the Nest app. Download the app from the Apple App Store or Google Play and create a free account. You can use a phone or tablet for setup.

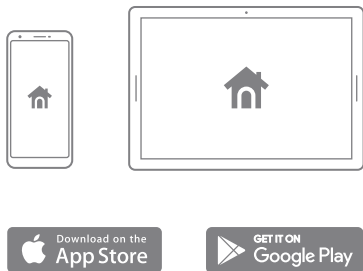

2. Set up Nest Protect

The Nest app will guide you through each step: scanning the Nest Protect QR code, connecting it to the internet, and connecting it to other Nest Protects in your home. Go to g.co/nest/installprotect to watch the video.

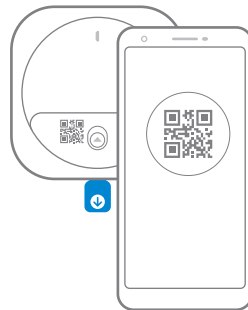

Tip: Lay everything out on a table for easy setup.

3. Have more Nest Protects?

The Nest app will ask if you have more Nest Protects to set up. If you do, it'll take you through a faster setup. Be sure to keep all your Nest Protects together until they're all set up and ready to be installed.

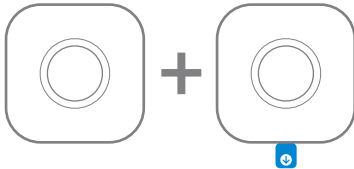

Already added

New

Tip: Your Nest Protect came packed in a plastic cover. Keep the cover on so your Nest Protect stays clean until you install it.

4. Test before you install

Once you're done setting up all of your Nest Protects, make sure they've been added to your account. Push the button on one Nest Protect and follow the instructions. All of your Nest Protects should speak up. Now you can install them on the ceiling or wall.

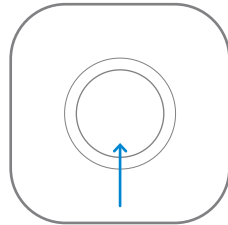

Tip: To double check Nest Protect's room name, press the button once. You'll hear the location you assigned it during setup. It'll say something like, "Ready in the bedroom."

Location in your home

The National Fire Protection Association (NFPA) recommends installing a smoke alarm in the following areas:

- On every floor, including finished attics and basements.
- Inside and outside every sleeping area.
- At the top of the first- to second-floor stairway and on the basement ceiling near the entry of the stairs.
- In homes with more than 1,000 square feet (93 m²) on one level, additional alarms may be required.

Nest Protect should be installed at least 10 feet (3 m) away from cooktops or cooking appliances.

Nest Protect should NOT be installed in unfinished attics or garages.

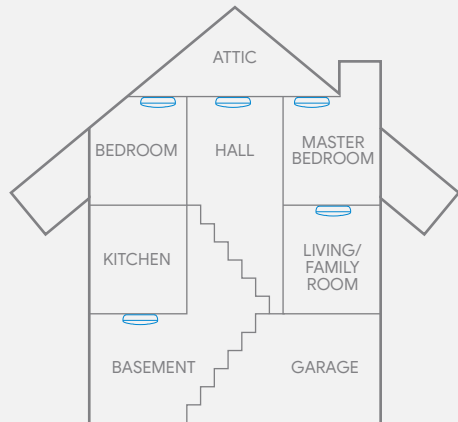

5. Remove your old smoke alarm

You may have to twist the alarm to release it. Carefully remove it to keep from damaging your ceiling or wall. Unscrew and remove the backplate if there is one.

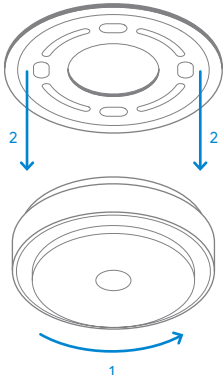

Tip: Your old smoke alarm might make a loud noise when you disconnect it.

6. Install the new backplate

Screw the new backplate to the ceiling or wall using the included screws. Make sure the screws are all the way in and snug against the backplate.

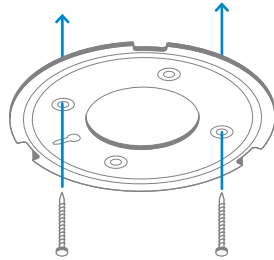

Tip: All smoke alarms prefer to live in a dust free area, so remove any dust before you install Nest Protect.

Placement on the ceiling or wall

Installing on the ceiling is recommended. Mark where the screws will go using the base as a guide. If you're installing on the wall, make sure it's within 12 inches of the ceiling.

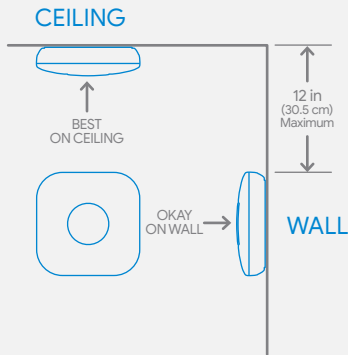

Figure 1

Placement on a sloped ceiling

If you have a sloped, peaked or cathedral ceiling, Nest Protect should be 4 inches from the highest point.

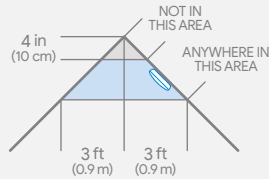

Figure 2

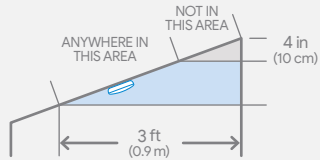

Figure 3

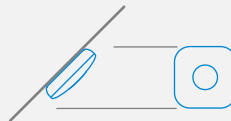
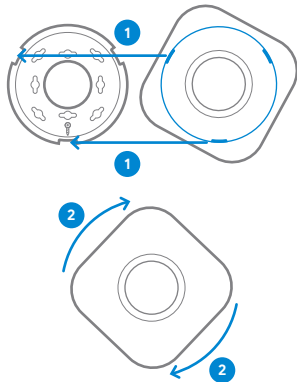

Figure 4

7. Install your Nest Protect

Line up the three tabs on the back of your Nest Protect with the notches on the backplate. Hold Nest Protect against the backplate and turn it clockwise. Continue turning until it's square with the wall or ceiling. Install the rest of your Nest Protects if you have more.



Tip: If you ever need to remove your Nest Protect (for cleaning or battery replacement), turn it counterclockwise until it disconnects from the backplate.

8. Press to test

Press the button on one Nest Protect. It will tell you what to do next. Every Nest Protect in the house should speak up, confirming that they're connected to each other.

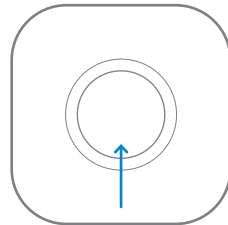

Heads-Up and Emergency Alarms

Alerts

When Nest Protect has something to say, it will speak to you in words and light up instead of just beeping. Nest Protect has two kinds of voice alerts: Heads-Up and Emergency Alarms.

When smoke or carbon monoxide levels are heightened but haven't yet reached Emergency Alarm levels, Nest Protect can sound a Heads-Up as an early warning. Nest Protect will pulse yellow and tell you where there's smoke or carbon monoxide.

You'll get an Emergency Alarm when smoke or carbon monoxide reach critical levels. Nest Protect will pulse red, sound a loud alarm, and tell you what room the emergency is in. If there's both smoke and CO present, the smoke alarm will take priority.

Silencing

Heads-Up alerts and some Emergency Alarms can be hushed by using the Nest app or pressing the button. In some cases, the smoke level may be too high for the Emergency Alarm to be hushed. Only silence an alarm once you have checked conditions at the Nest Protect that first sounded the alarm. Do not silence Nest Protect by removing the batteries. This will disable the alarm so it cannot sense smoke or carbon monoxide, leaving you at risk.







Because there are many different types of fires, you may experience an Emergency Alarm without having first experienced a Heads-Up alert. This means that critical levels of smoke or CO occurred extremely quickly and Nest Protect has to sound the Emergency Alarm.

Have more than one Nest Protect?

After all the Nest Protects in your home are connected to each other, if there's a Heads-Up or an Emergency Alarm in one room, they'll all tell you what the danger is and which room it's in.

If multiple Nest Protects are interconnected, a Heads-Up alert or Emergency Alarm can be silenced only at the Nest Protect that originally sounded the alert. You'll need to go to that room to silence all the Nest Protects in your home. Always check the conditions near the Nest Protect that first detected the smoke or carbon monoxide before silencing it.

Heads-Up and Emergency Alarms

	What You Hear	What You See	What It Means	What To Do
Alerts	"HEADS-UP. THERE'S SMOKE IN THE [ROOM NAME]. THE ALARM MAY SOUND."	 YELLOW pulses.	Smoke levels are rising.	Put out the source of the smoke. Then use the Nest app or press the button to hush the alert.
	"HEADS-UP. THERE'S CARBON MONOXIDE IN THE [ROOM NAME]. THE ALARM MAY SOUND."	 YELLOW pulses.	Carbon monoxide levels have been high for a while.	Open a window or door to get fresh air. Then use the Nest app or press the button to hush the alert.
	(Alarm horn) "EMERGENCY. THERE'S SMOKE IN [ROOM NAME]."	 RED pulses.	The smoke in the room has reached critical levels.	Get out of the house immediately.
	(Alarm horn) "EMERGENCY. THERE'S CARBON MONOXIDE IN [ROOM NAME]. MOVE TO FRESH AIR."	 RED pulses.	The carbon monoxide in the room has reached critical levels.	<ol style="list-style-type: none"> 1) Operate reset/silence button. 2) Call your fire dept. or 911. 3) Move to fresh air. 4) Do not reenter the premises until the emergency services tell you to.
Silencing	"SMOKE ALARM HUSHED."	 YELLOW or RED pulses.	You've hushed an alert. Nest Protect will now keep quiet, unless smoke or carbon monoxide remains at critical levels.	Make sure you're safe and have put out the source of smoke or carbon monoxide.
	"CARBON MONOXIDE ALARM HUSHED."			
	"THE ALARM IS OVER."	 GREEN pulses.	Smoke or carbon monoxide levels are decreasing.	Make sure you're safe and have put out the source or smoke or carbon monoxide.

Daily Use and Emergency Preparation

Daily Use

Nightly Promise

Nest Protect continuously tests itself, so you don't have to wonder if it's working. Nightly Promise reports on every Nest Protect in your home.

When you turn out the lights for the night, Nest Protect will glow green for a moment – that means everything is working. If it glows yellow, one of the Nest Protects in your home needs your attention. For instance, the batteries are low, Wi-Fi is down, or there's an issue with the sensors. Just push the button or use the Nest app to see what's wrong.

Pathlight

Usually Nest Protect has its light turned off, but it can light your way as you walk underneath it in the dark. You can enable or disable Pathlight and set its brightness with the Nest app.

Emergency Preparation

Testing

Perform a manual test of your battery powered Nest Protect at least weekly. During a test, all interconnected Nest Protects in your home check their sensors, power, Wi-Fi connection, light ring, emergency horn, speaker and microphone.

When you run a test, Nest Protect will give you a countdown before sounding the alarm so you have time to move away from the loud noise.





Test procedure:

1. Start a test by pressing the button twice.
2. Nest Protect will say: "This is only a test. The alarm will sound."
3. Ensure that the alarm sounds and the light illuminates on each Nest Protect.
4. Once the Nest Protect has made sure it's working, it'll tell you everything's okay. If you have interconnected Nest Protects, all of them should speak.

Sound Check

Nest Protect can automatically perform a monthly test to confirm that its speaker and horn are working properly. You can choose to enable this option during initial setup with the app, but you can change it at any time. For more information, visit g.co/nest/soundcheck

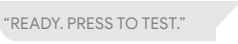
Daily Use And Emergency Preparation

	What You Hear	What You See	What It Means	What To Do
Daily Use		 You turn off the room lights for the night, and the GREEN light pulses once.	Nest Protect has tested its sensors, power and Wi-Fi to confirm they are working correctly.	Sleep well thanks to Nightly Promise.
		 WHITE light.	Pathlight lights your way at night as you pass under it.	
Emergency Preparation	 "READY. PRESS TO TEST."	 BLUE rotates.	To set up or run a manual test.	Press the button. Nest Protect will walk you through next steps.

▲ WARNING

- DO NOT stand close to the alarm when the horn is sounding. Exposure at close range may be harmful to your hearing. When testing, step away before the horn starts sounding.
- If the alarm ever fails to test correctly, have it replaced immediately! If the alarm is not working properly, it cannot alert you to a problem.
- DO NOT use a match, cigarette or any other makeshift fire to test the smoke alarm.
- To test the CO alarm, NEVER use vehicle exhaust! Exhaust may cause permanent damage and will void your warranty.
- NEVER use an open flame of any kind to test this alarm. You might accidentally damage or set fire to the unit or to your home.

General Maintenance

Cleaning your Nest Protect

Nest Protect has been designed to be as maintenance free as possible, but you should keep it clean. As with any smoke alarm, dust buildup on the outside or inside of Nest Protect can stop it from working properly.

To clean Nest Protect:

1. Remove it from the wall or the ceiling (turn counterclockwise until it comes off the backplate).
2. Wipe the outside with a clean, slightly damp cloth. Don't use any soaps or solvents.
3. Place Nest Protect on a soft, dry cloth with the button facing down. Open the battery compartment door and remove the batteries. Remove the screws and lift off the back. Be careful to not lose the screws.
4. Gently vacuum the inside. Make sure to clean all the way around the mesh sides of the smoke chamber (the large metal circle).

Note: Never use detergents or solvents (like glass cleaner) on your Nest Protect and do not spray air fresheners, hair spray or other aerosols near it. Do not get water inside the alarm or paint over it.

Replacing the batteries

Nest Protect uses six AA Energizer® Ultimate Lithium batteries (L91). These batteries can be purchased at your local retailer.





1. Twist Nest Protect counterclockwise until it disconnects from the backplate.
2. Open the battery door on the back of Nest Protect.
3. Replace the batteries. Align the + positive and - negative ends with the markings in the battery compartment.
4. Close the battery compartment. Do not force the door closed.
5. Push Nest Protect onto the backplate and turn it clockwise until you feel it grip.
6. Press the button twice.



Servicing

If your Nest Protect needs servicing, first contact our support team at [g.co/nest/support](https://www.google.com/g.co/nest/support) to get a return number and shipping information.

General maintenance

	What You Hear	What You See	What It Means	What To Do
General Maintenance	"THE SENSORS HAVE FAILED IN THE [ROOM NAME]. REPLACE NEST PROTECT NOW." Single chirp every 60 seconds.	 YELLOW pulses.	Nest Protect has tested its sensors and there is a problem.	Clean according to instructions on p. 16. If the problem persists, replace Nest Protect.
	"THE BATTERY IS LOW IN THE [ROOM NAME]. REPLACE THE BATTERY SOON."	 YELLOW pulses.	Low battery.	Change the batteries of Nest Protect soon.
	"THE BATTERY IS LOW IN THE [ROOM NAME]. REPLACE THE BATTERY NOW." Single chirp every 60 seconds.	 YELLOW pulses.	Low battery.	Change the batteries of Nest Protect now.
	"NEST PROTECT CAN'T SOUND THE ALARM IN THE [ROOM NAME]." Two chirps every 60 seconds.	 YELLOW pulses.	There's a problem with the horn of Nest Protect.	Replace Nest Protect now.
	"NEST PROTECT HAS EXPIRED. REPLACE IT NOW." Two chirps every 60 seconds.	 YELLOW pulses.	Nest Protect has expired and reached the end of its life.	Replace Nest Protect now.

▲ WARNING

- Use only batteries specified by Google. Use of a different battery model will have a detrimental effect on the smoke alarm operation.
- Never remove the batteries to stop an unwanted alarm (caused by cooking smoke, etc.) Removing the batteries disables the alarm so it cannot sense smoke or carbon monoxide (CO). Instead open a window or fan the smoke away from the unit.
- The batteries cannot work until you install the batteries in the correct position (Match + to + and - to -).
- Once Nest Protect has expired you'll no longer be protected from smoke or CO if you don't replace it.

General Maintenance

Expiration

Like any smoke and CO alarm, Nest Protect has a limited life. You will need to replace Nest Protect after 10 years with a brand new Nest Protect. You can check the date of replacement written on the back of Nest Protect to see when it will expire.

About two weeks before it expires, Nest Protect will light up with a yellow light. Press the button and it will say, "Nest Protect has expired. Replace it now." Buy a new alarm and recycle the expired one. Make sure you test your new Nest Protect once it's installed.

Recycling and Disposal

Once Nest Protect has expired you will need to recycle it according to local regulations. Please visit [g.co/nest/recycle](https://www.google.com/nest/recycle) for more information.

Resetting Nest Protect

You can reset Nest Protect to erase all your settings and reset the wireless interconnection with other Nest Protects. You may want to do this when you move to a new home. Follow the steps below on each Nest Protect you want to reset.

1. Press and hold the button. Nest Protect will chime and glow blue.
2. Keep holding the button until Nest Protect begins to say its version number. Then release the button.
3. Nest Protect will start a verbal countdown and tell you it's erasing all settings. You can cancel the reset by pressing the button during the countdown.
4. After a few seconds it will restart.

Your Nest Protect will still detect smoke and carbon monoxide after being reset.

Go to [g.co/nest/protectreset](https://www.google.com/nest/protectreset) for complete reset instructions.

Wireless interconnect

Nest Protects connect wirelessly to each other so that when one speaks, they all speak. That means when one Nest Protect raises any kind of alert, every Nest Protect in the house will tell you which room the smoke or CO is in. For example, if you're in the bedroom and the alarm goes off in the basement, the Nest Protect in the bedroom will tell you where the smoke or CO is. To silence the alert, go to the room where the alarm was triggered. All of the Nest Protects in the house can be hushed from there. Either press the button on the Nest Protect or use the Nest app to hush the alarm.

Nest Protect - Battery (model numbers 05A and 06A) and Nest Protect - Wired 120V (model numbers 05C and 06C) are compatible and can be interconnected wirelessly. Nest Protect wireless interconnect will not work with other smoke or CO alarms from other brands.

Nest Protect's 120V connector does not have a red/orange/yellow wire for interconnect because it connects wirelessly. There's no need to connect any Nest Protect wire to the red/orange/yellow interconnect wire coming from the ceiling or wall.

Nest Protects can typically communicate with each other if they're 50 feet (15 m) or less apart inside a home. Some features of a home may reduce Nest Protect's wireless interconnect range, including the number of floors, number and size of rooms, furniture, type of building materials, suspended ceilings, ductwork, large metal appliances and metal studs. This kind of interference can be overcome by adding more Nest Protects that can route wireless signals around obstructions.

▲ WARNING

- The range and proper operation of any wireless device will vary depending on its surroundings.
- Nest Protect alarms are not to be used outdoors or to transmit between buildings. The alarms will not communicate properly in those conditions.
- Metal objects and metallic wallpaper may interfere with signals from wireless alarms. Test your Nest Protects with metal doors opened and closed.

Note: Nest Protect can be used as a single station or multiple station alarm.

ATTENTION: Please read carefully and keep this user's guide in a safe place.
Refer to the included Safety and Warranty document for
regulatory information and additional precautions.