

Installation Guide Floor Stand

**WARNING: DO NOT CLEAN JAMBOARD
WITH ANY LIQUID SOLVENTS**

Floor Stand Installation Parts

Floor Stand Box

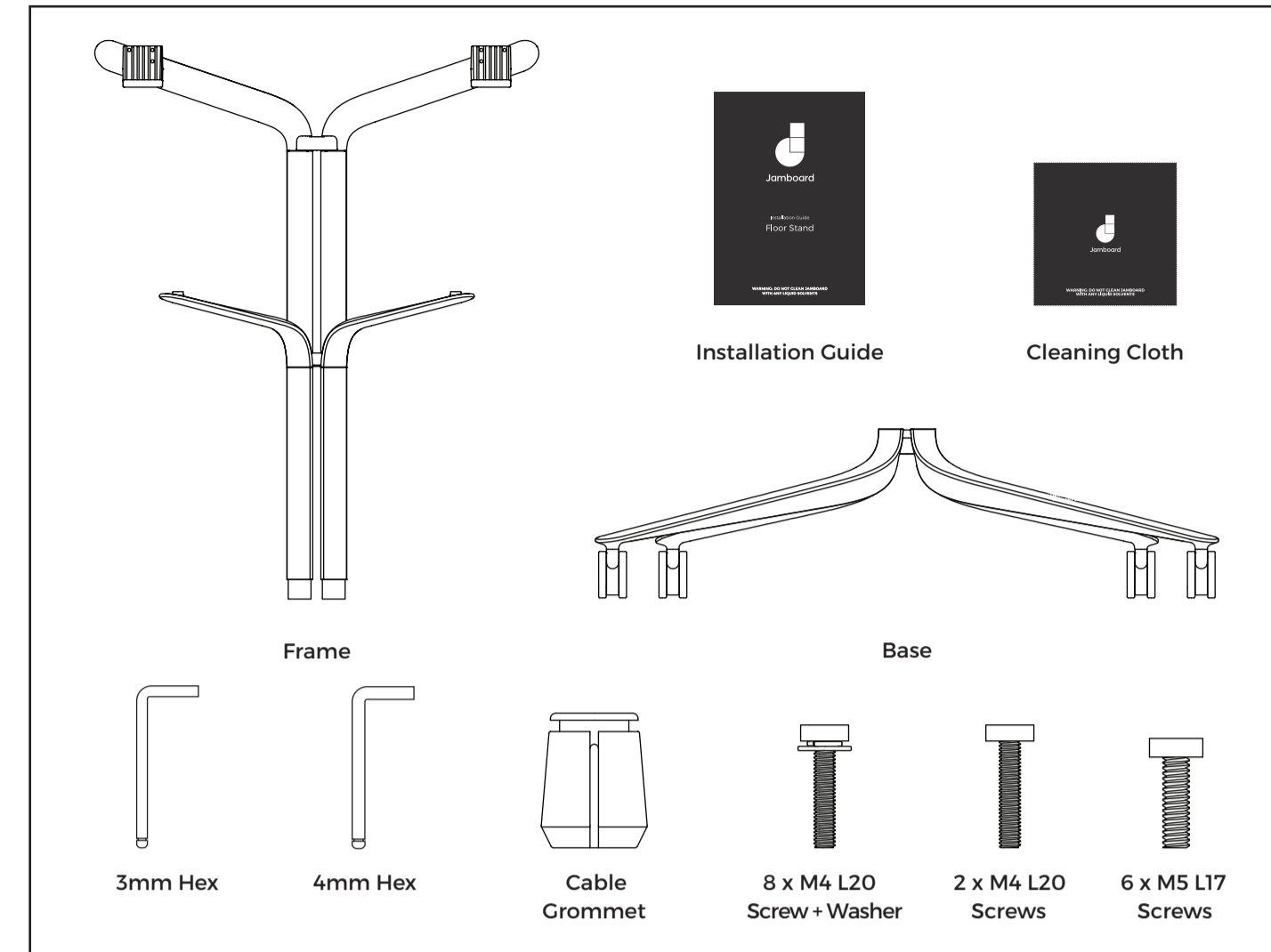

Display and Wall Mount Box

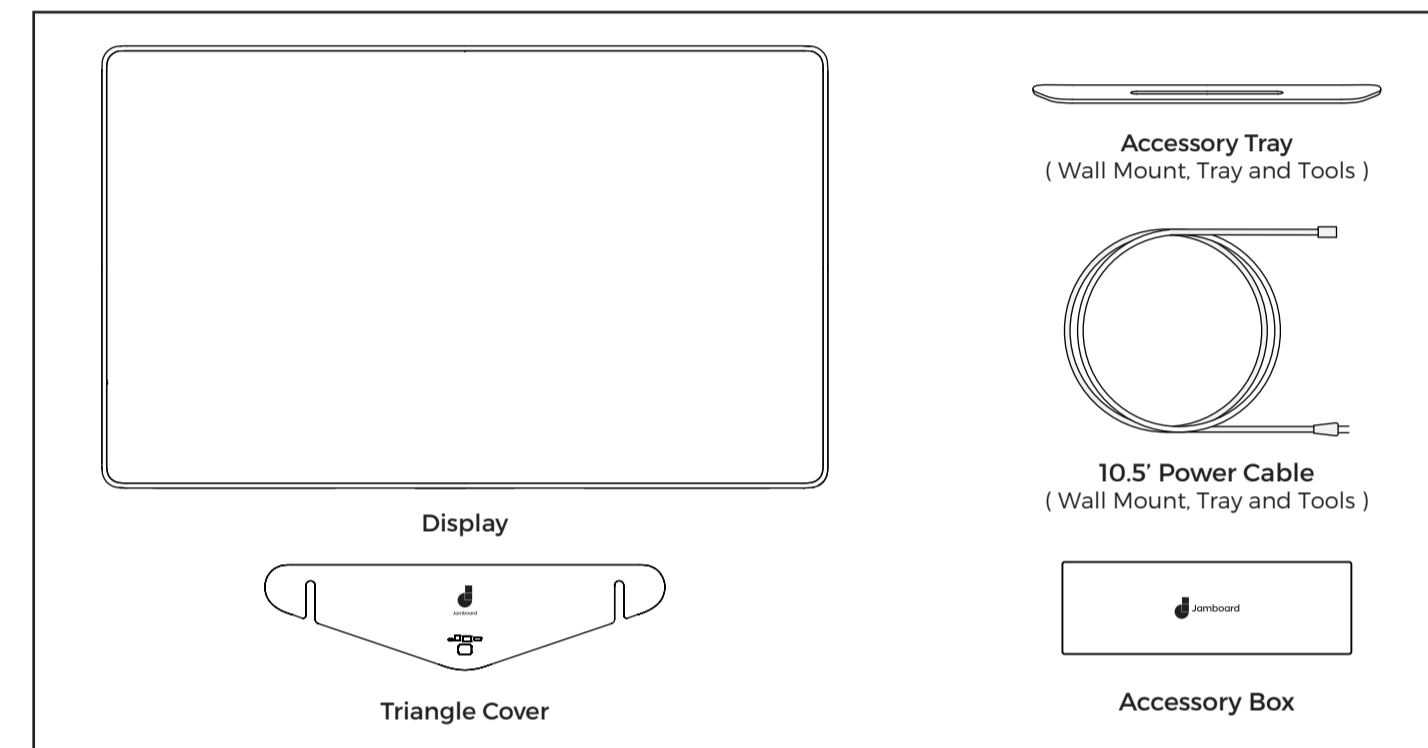

1 Feed 10.5' power cord from the bottom upward through frame.

⚠ Lock castor brakes to prevent base from moving during installation

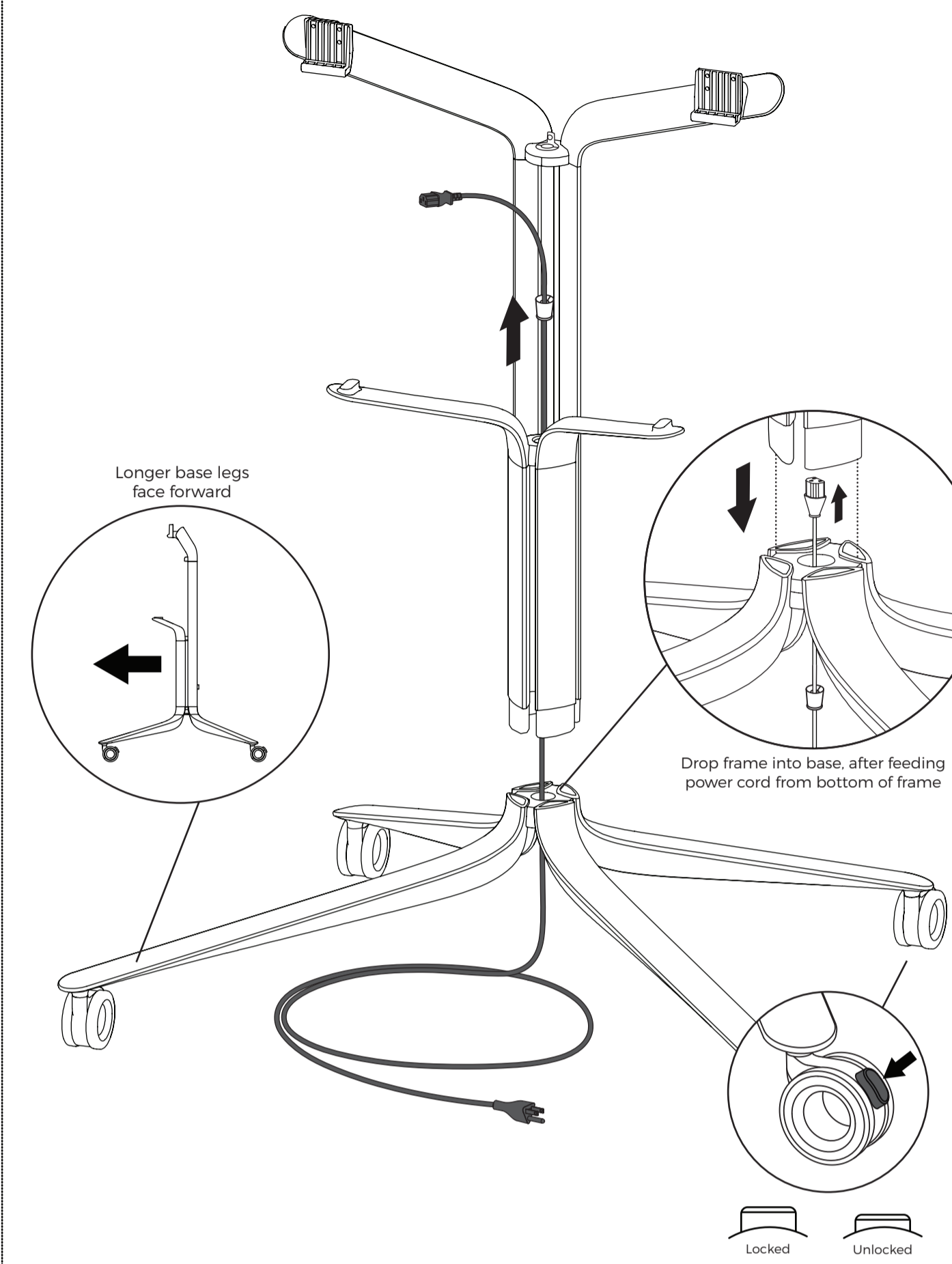

2 Unscrew cord clamp from frame and secure to bushing on cord. Reattach clamp and cord to frame.

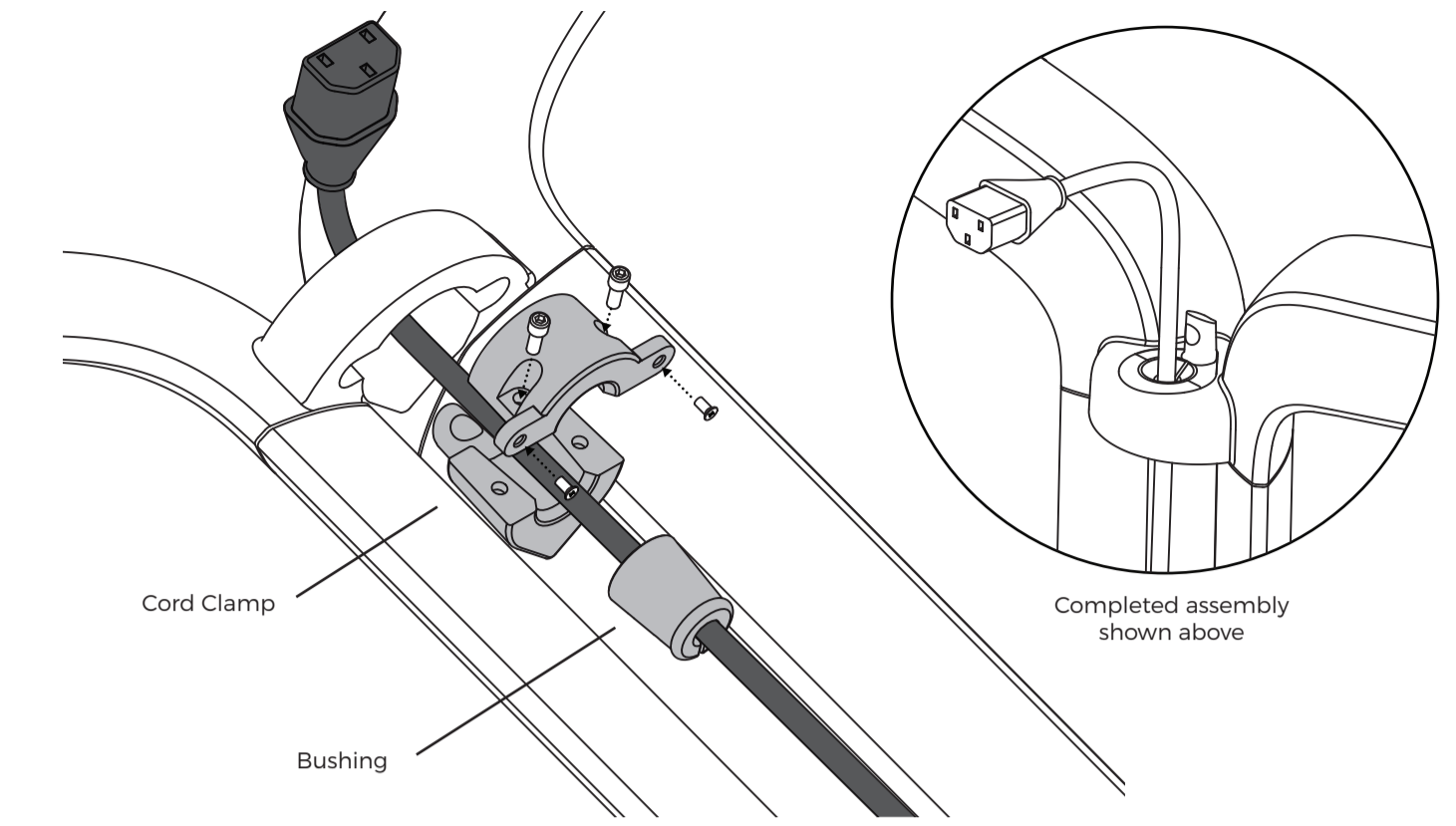

3 Secure frame to base with 8 x M4 Screws.

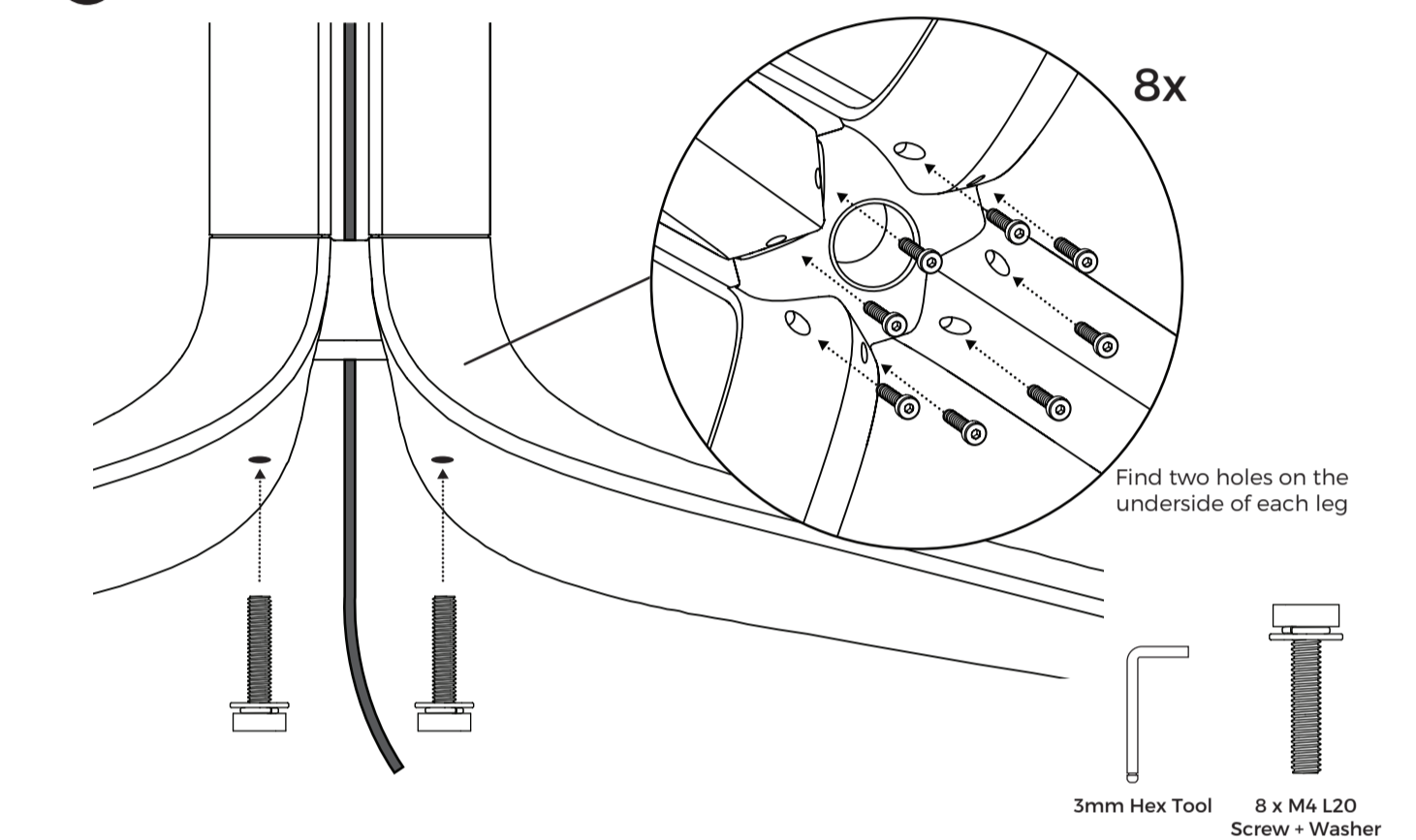

4 Slide cable grommet along power cord up into base.

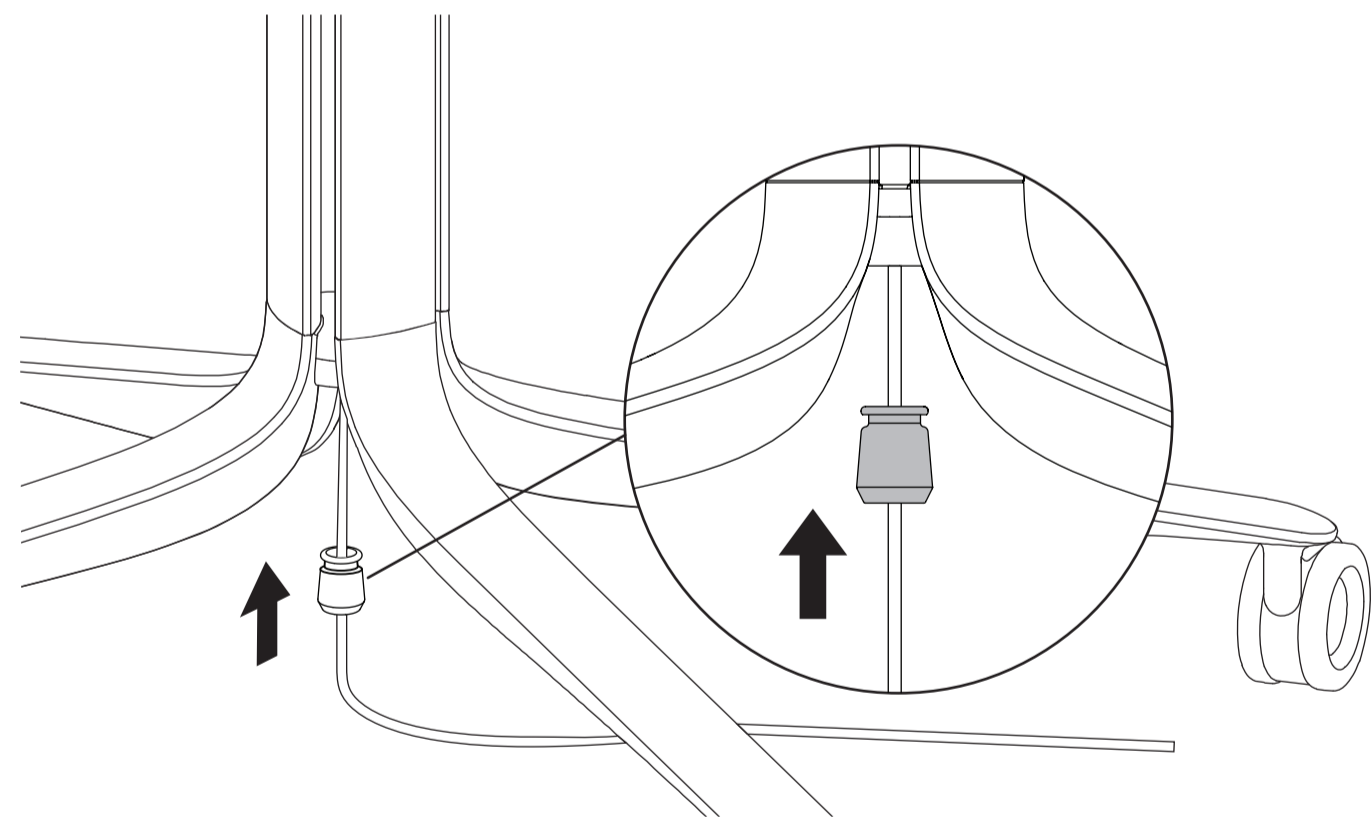

6 Angle display to 20 degrees to seat lower hooks. Rotate the display to vertical to engage upper hooks.

⚠ This assembly step requires minimum 2 people

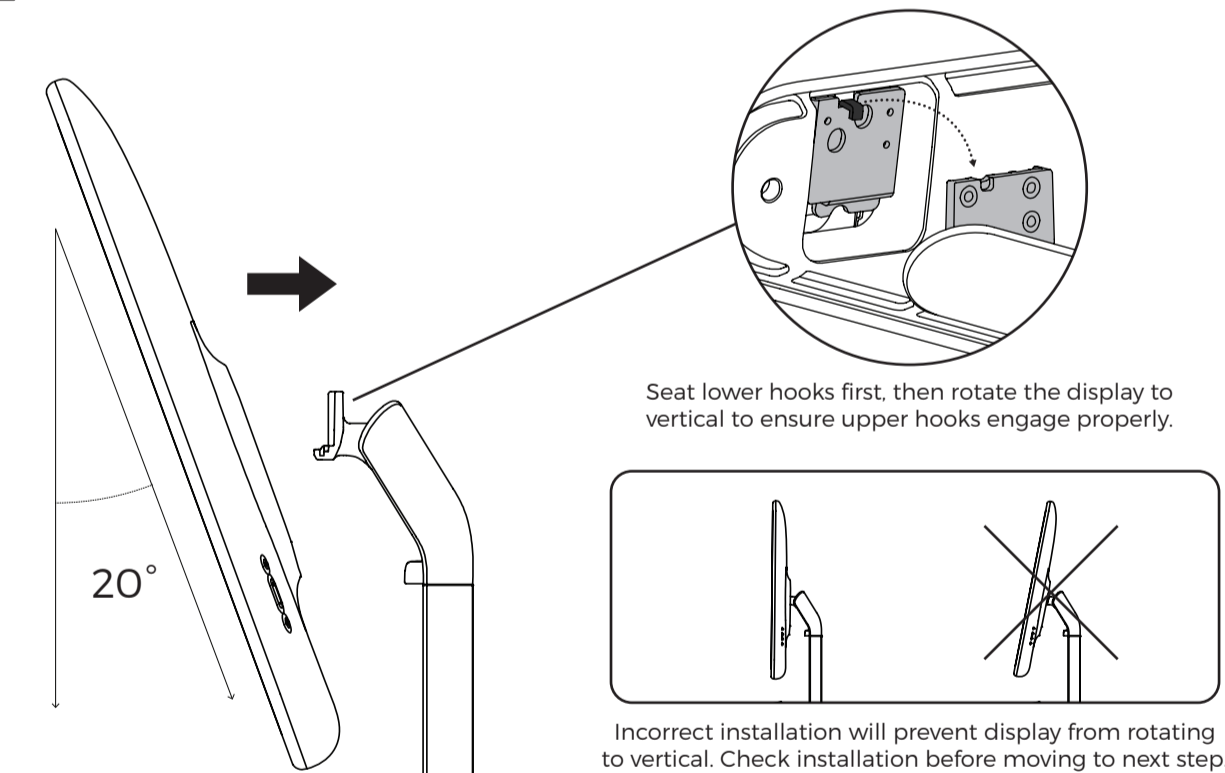

8 Attach triangle cover with embedded magnets.

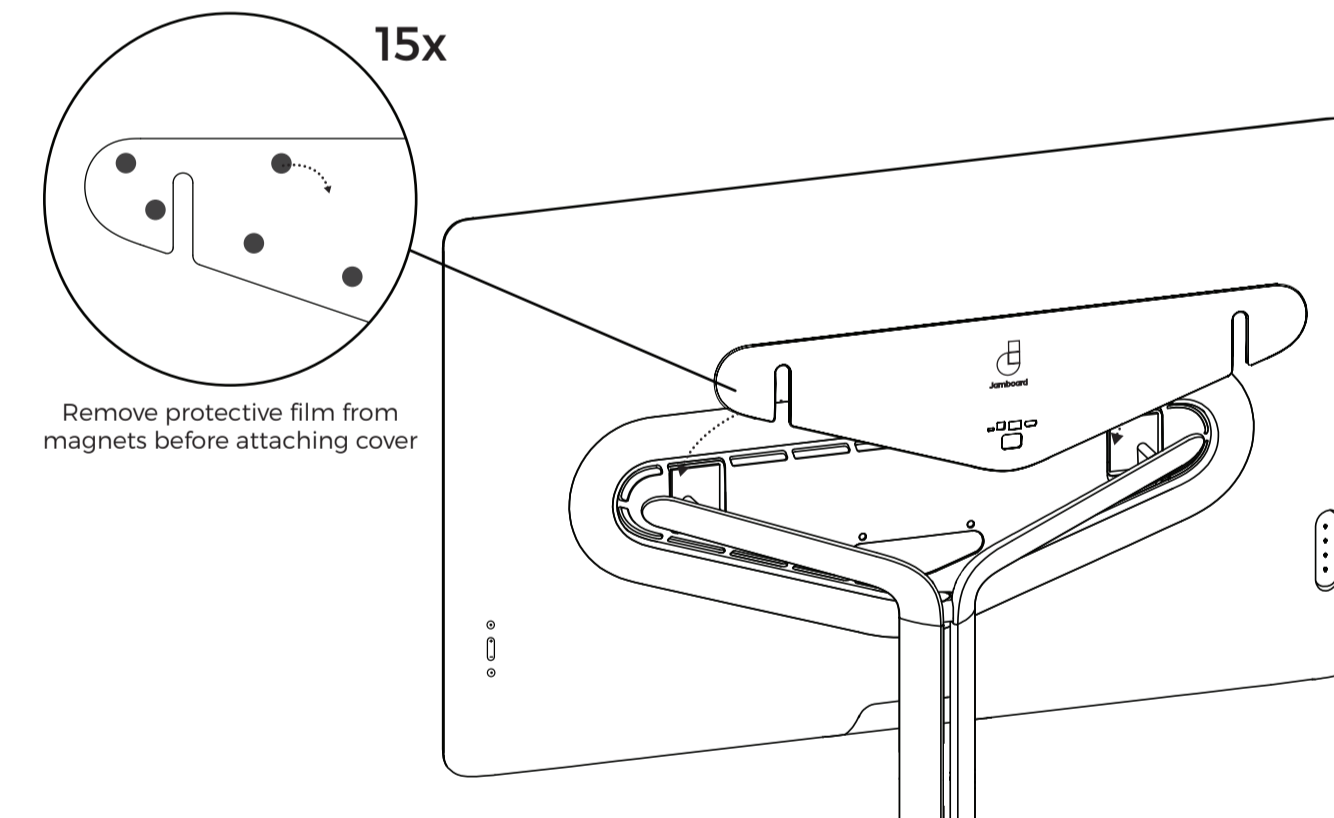

5 Mount tray to arms via 2 x M4 screws.

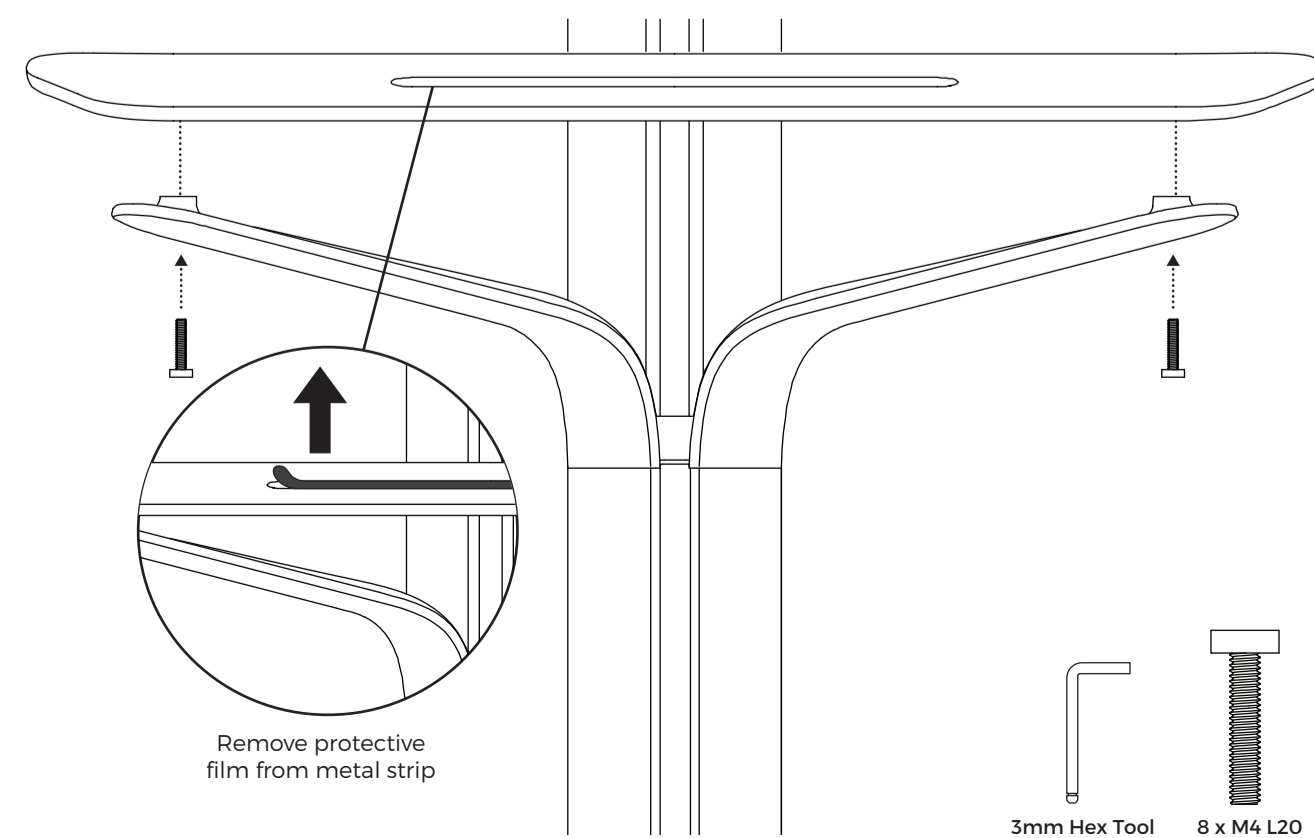

7 Secure display to frame via 6 x M5 Screws.

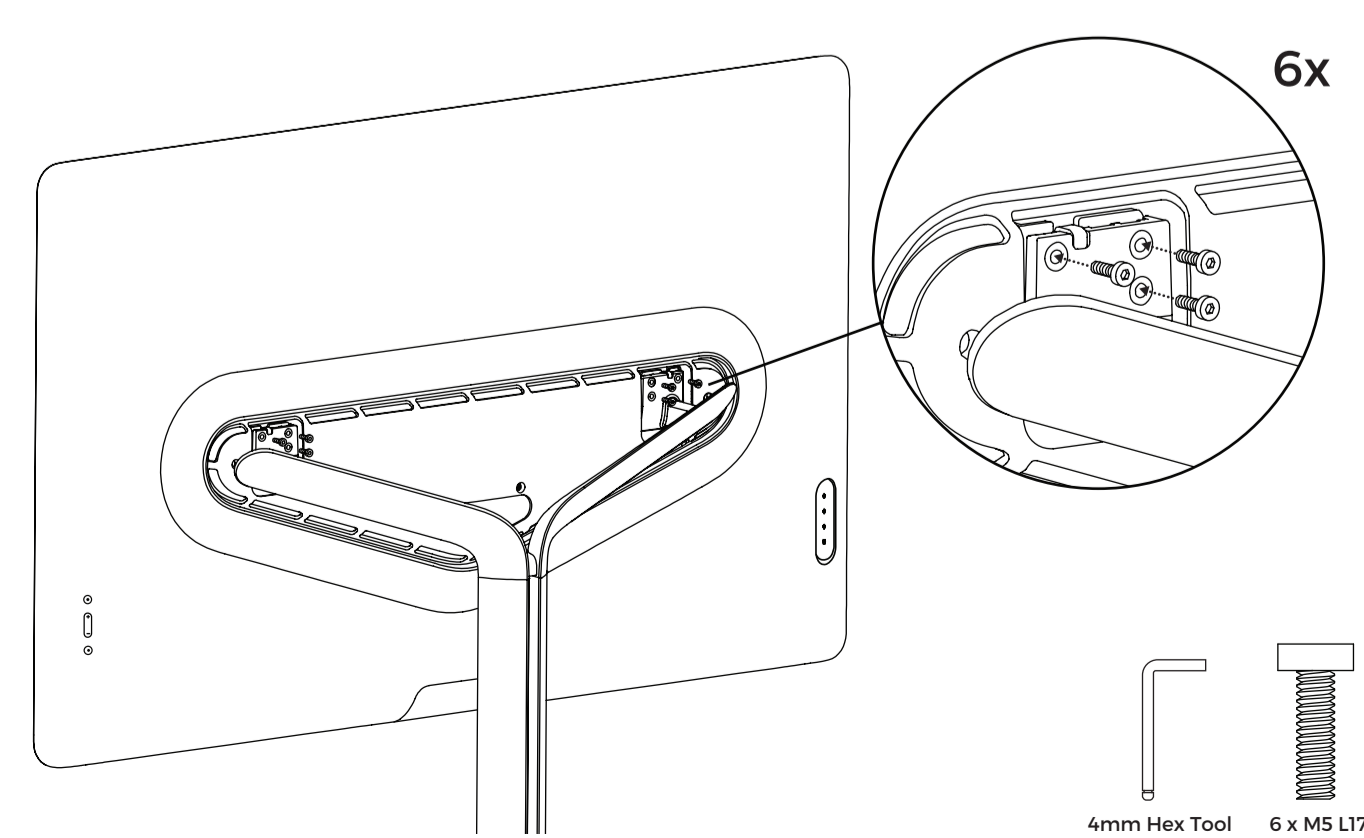

9 Place accessory box on tray.

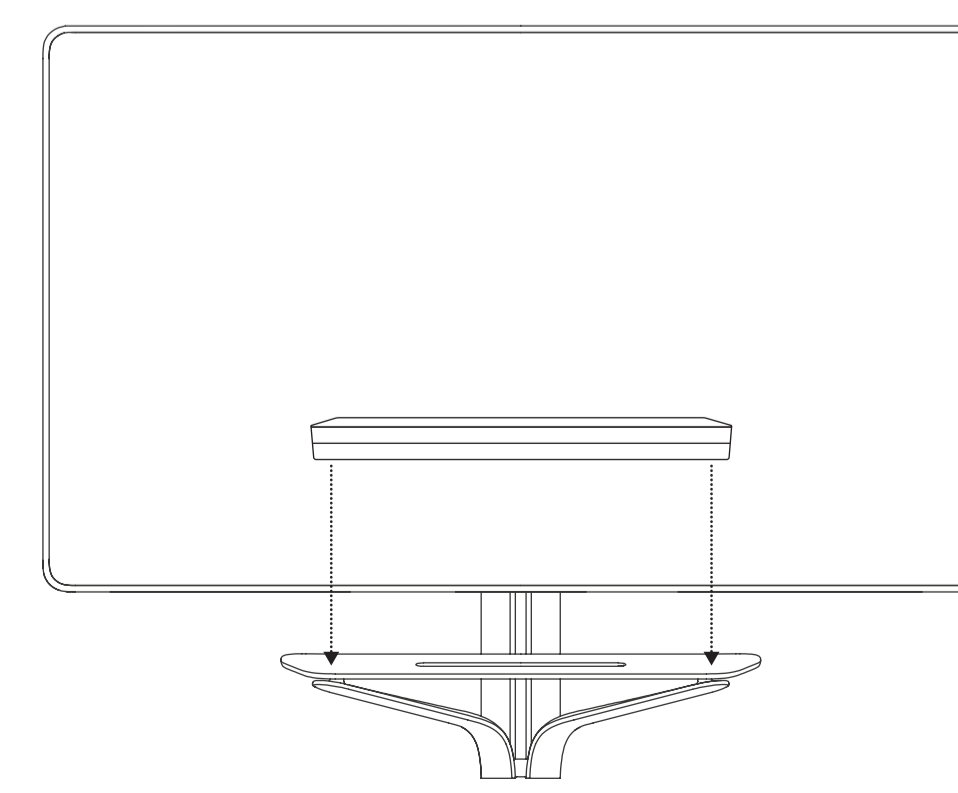

**WARNING:
DO NOT CLEAN JAMBOARD
WITH ANY LIQUID SOLVENTS**

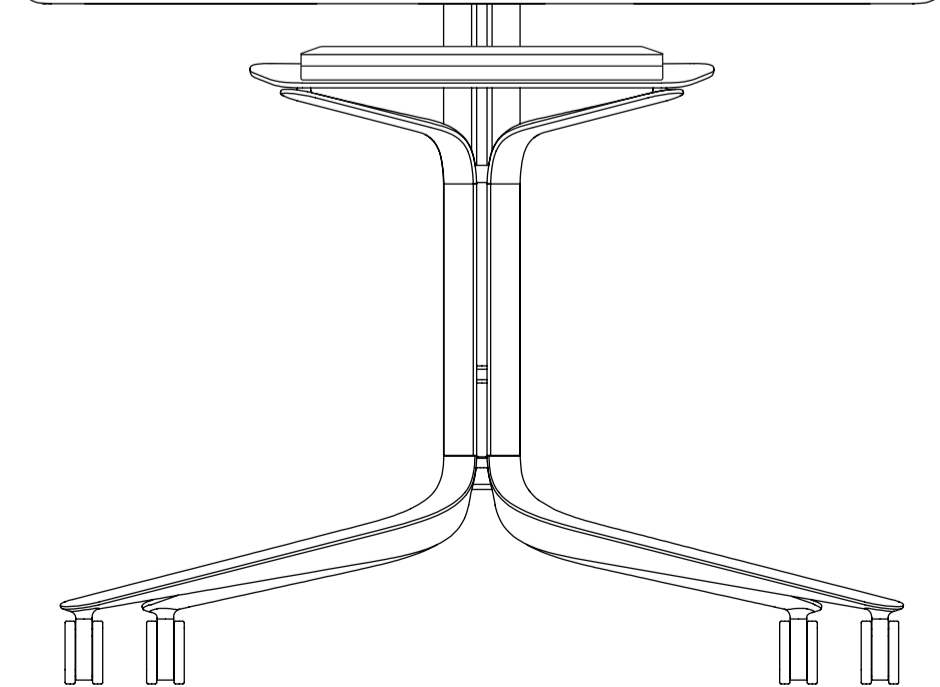

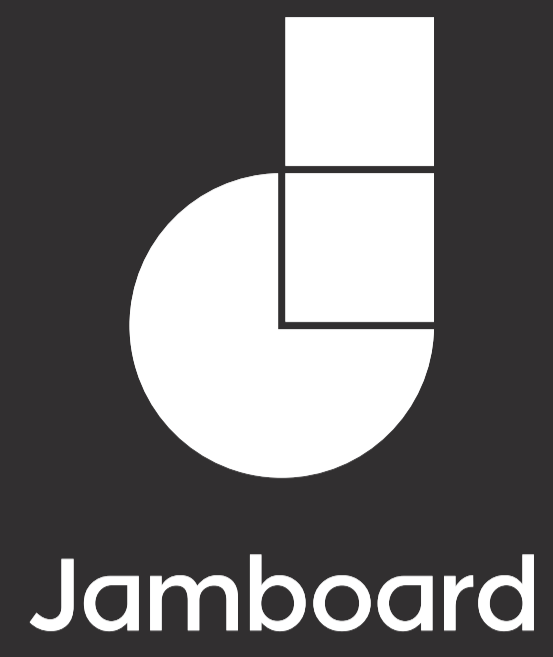

Installation Guide
Wall Mount

WARNING: DO NOT CLEAN JAMBOARD WITH ANY LIQUID SOLVENTS

Wall Mount Installation Parts

Display and Wall Mount Box

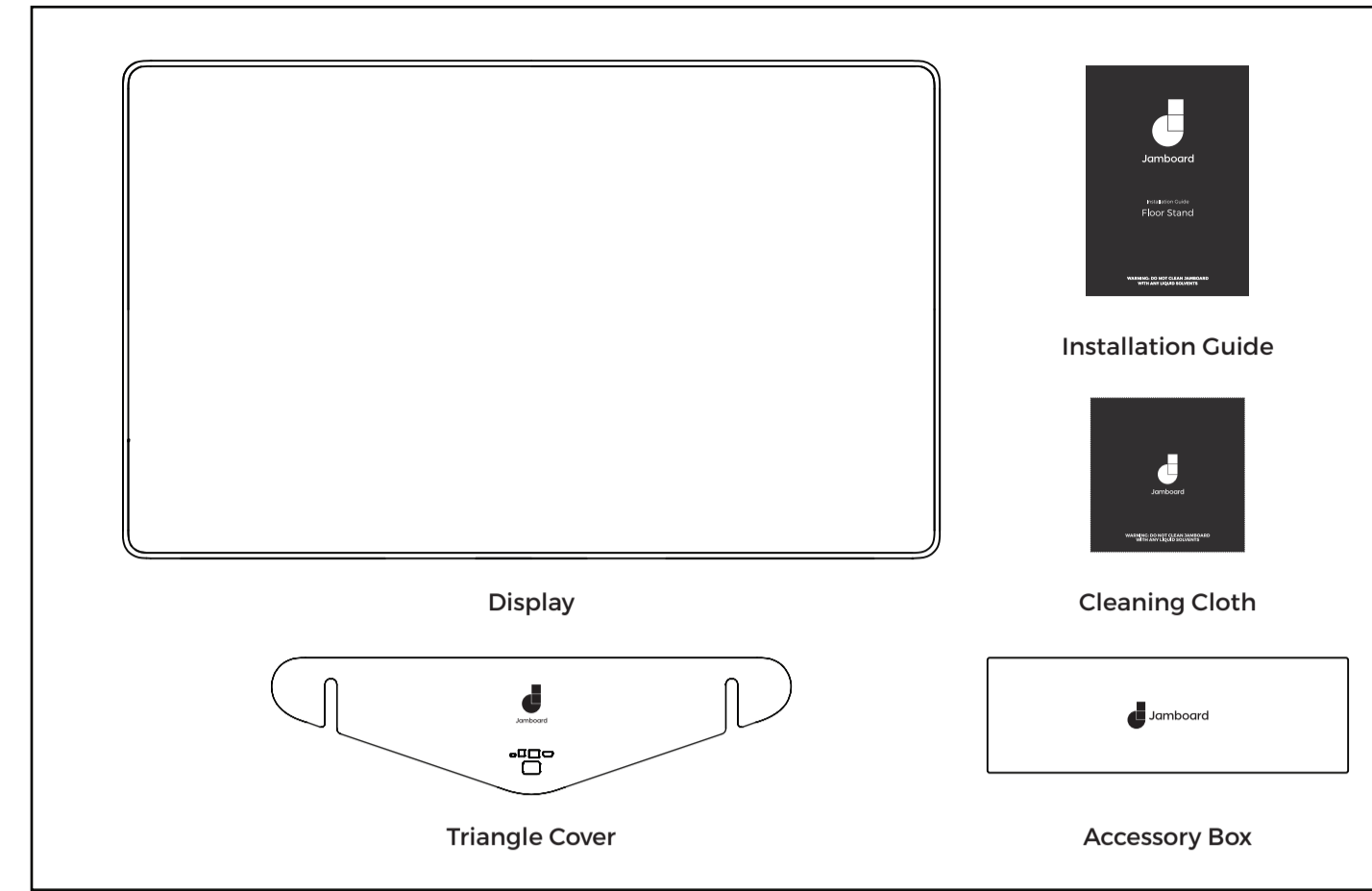

Wall Mount, Tray and Tools Box

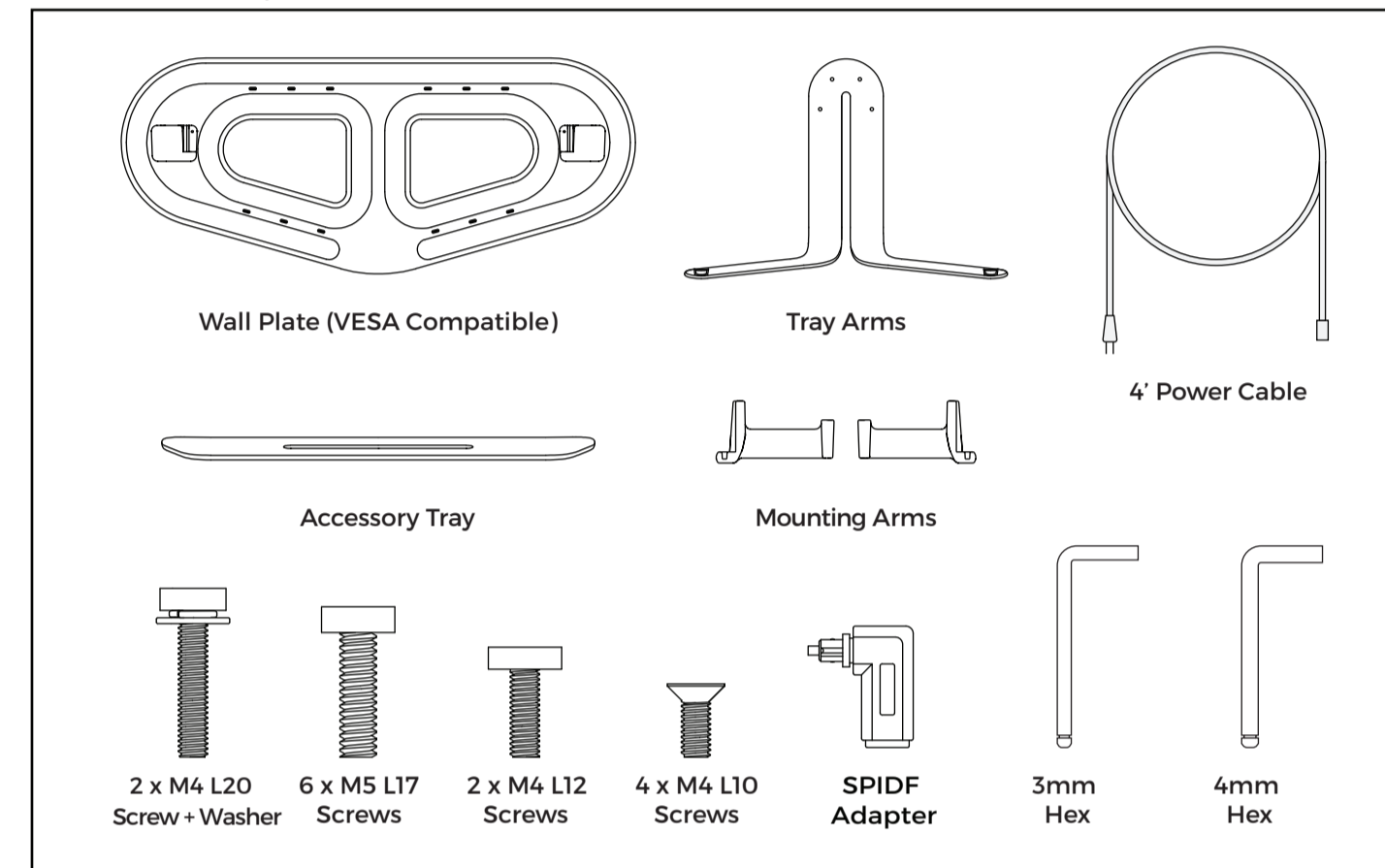

1 Attach tray arms to wall plate.

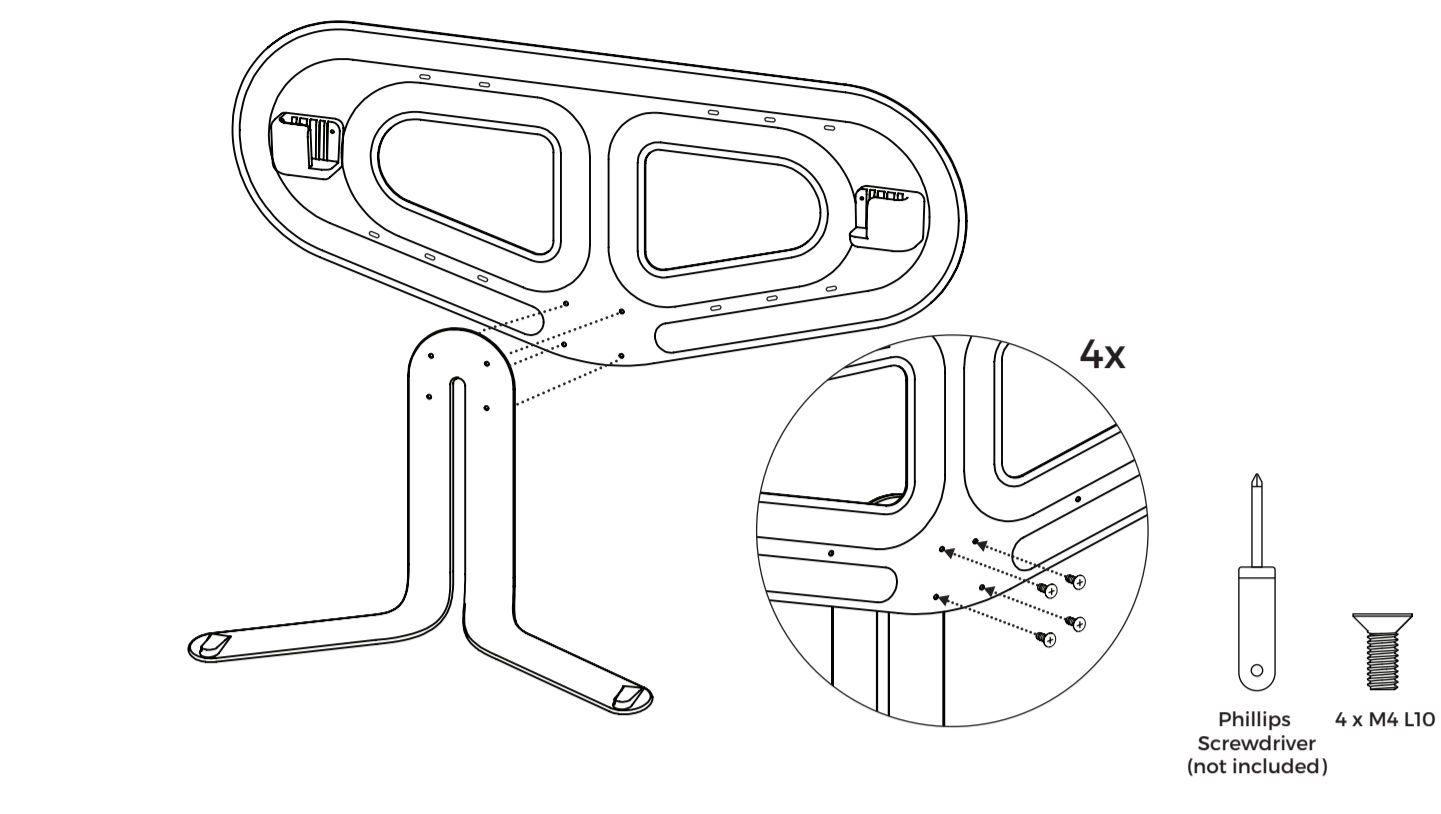

2 Mount wall plate to designated wall.

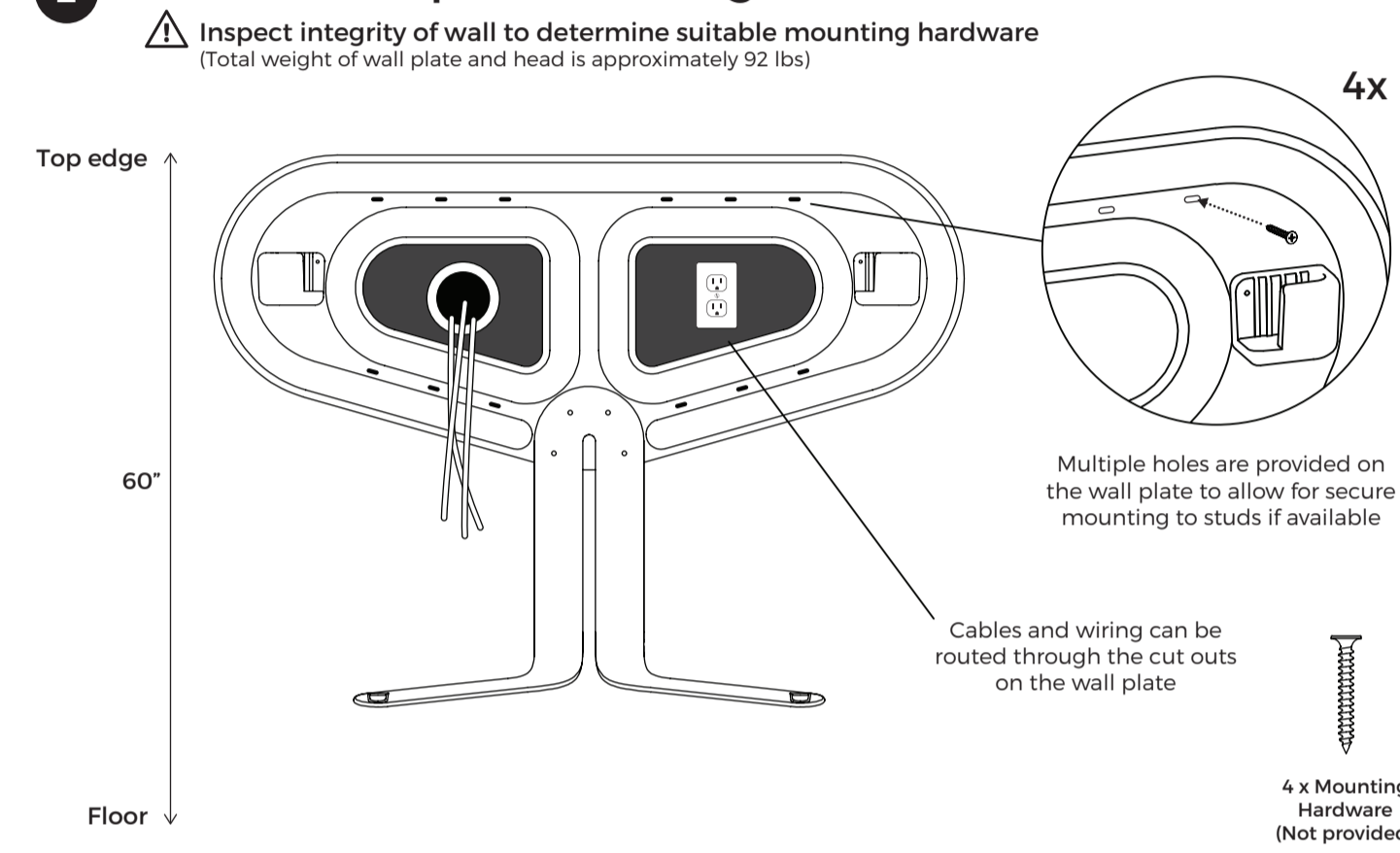

3 Attach mounting arms to display via 6 x M5 Screws.

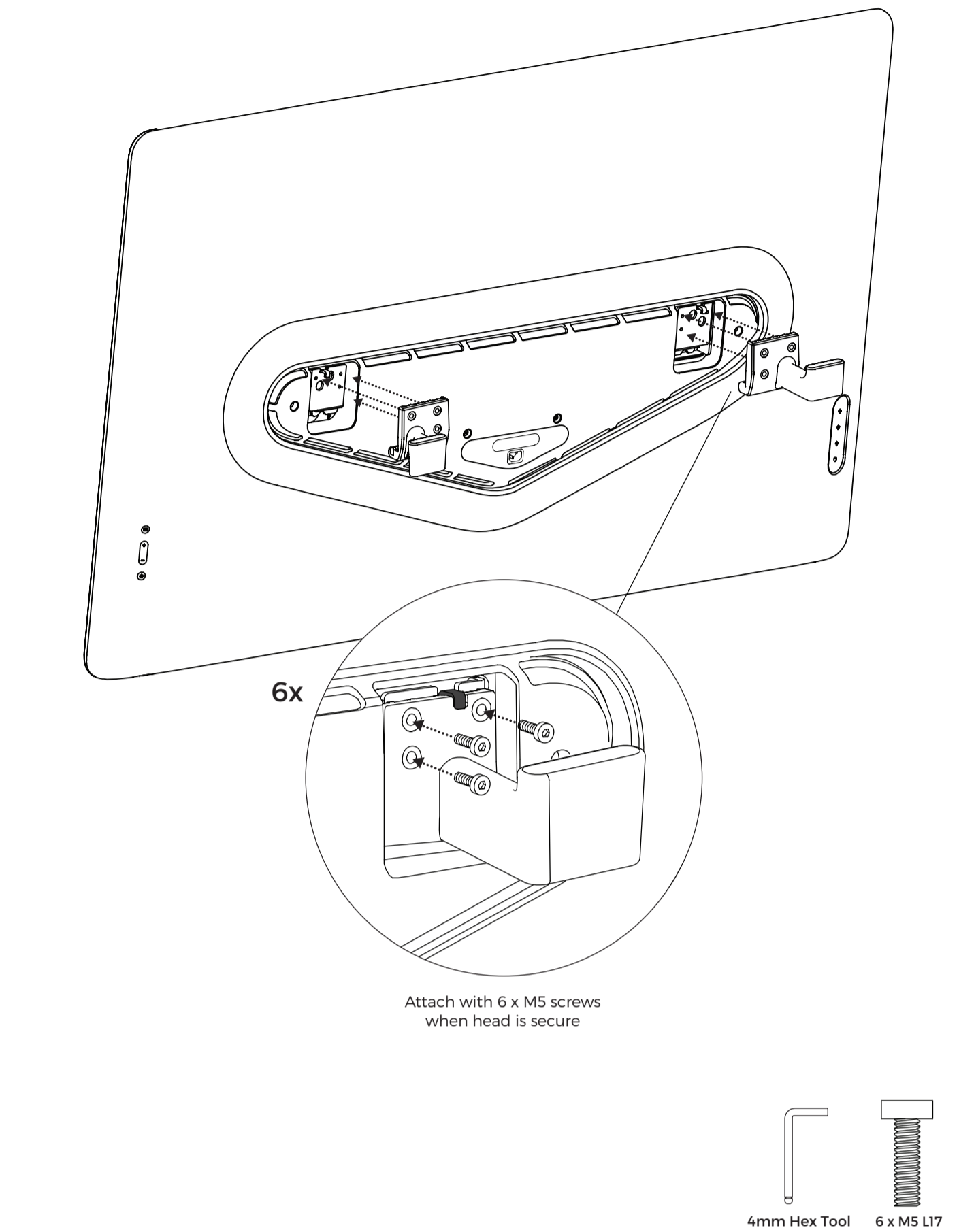

4 Slide display onto wall plate, fix via 2 x M4 Screws.

⚠ This assembly step requires minimum 2 people

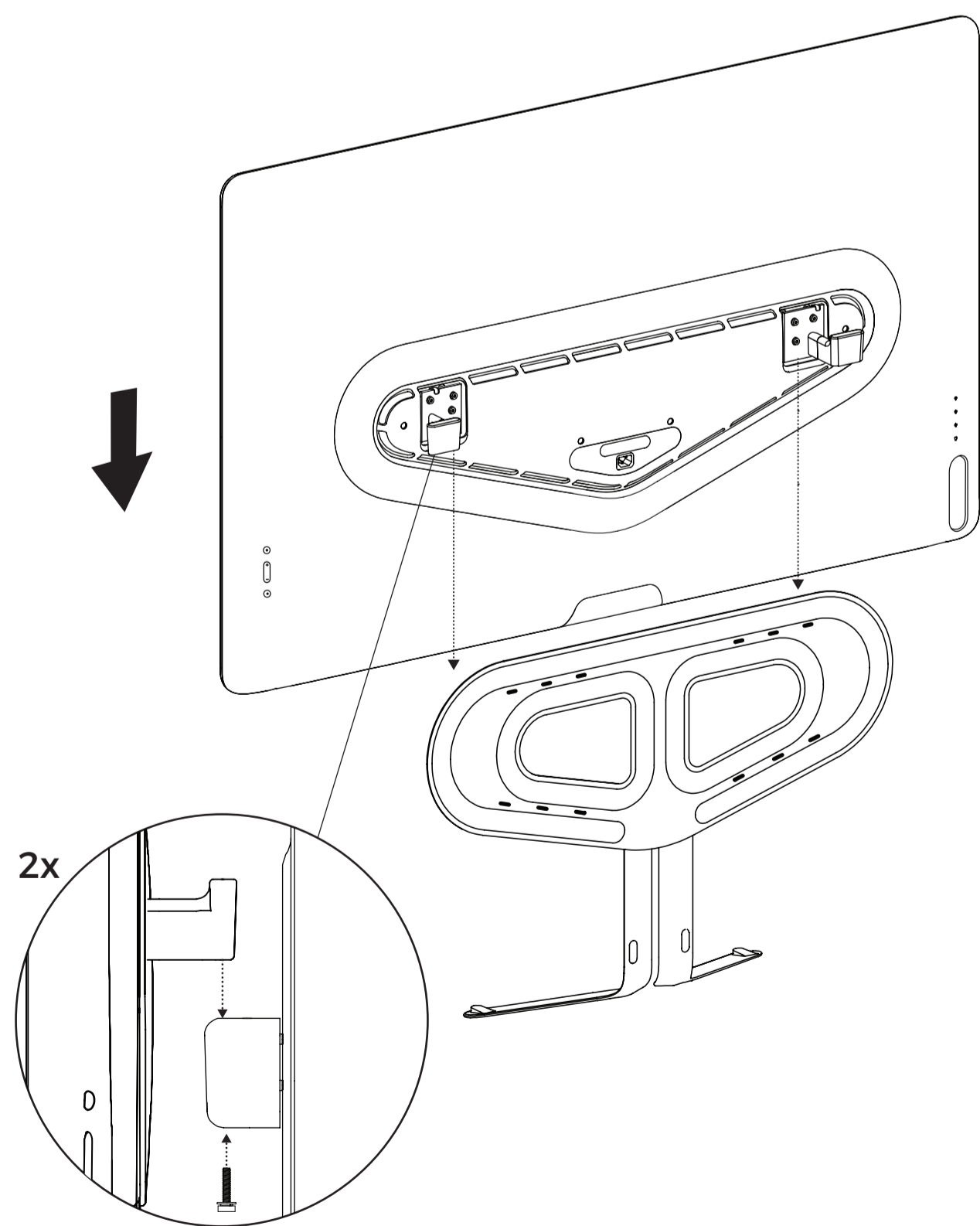

When display is secure on wall plate, fix with screws

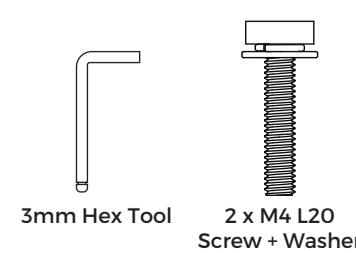

5 Attach triangle cover with embedded magnets.

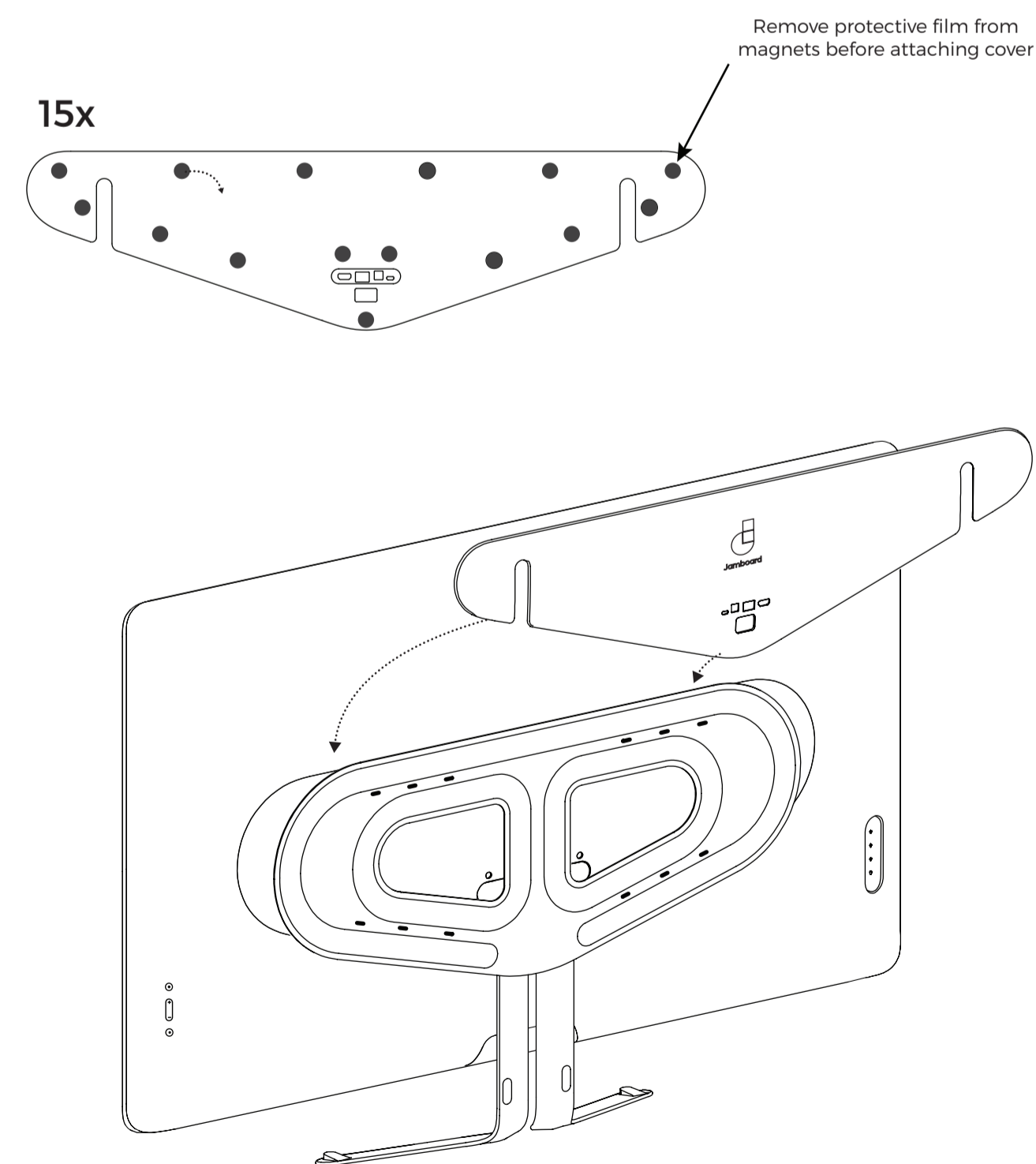

6 Attach tray to wishbone via 2 x M4 Screws.

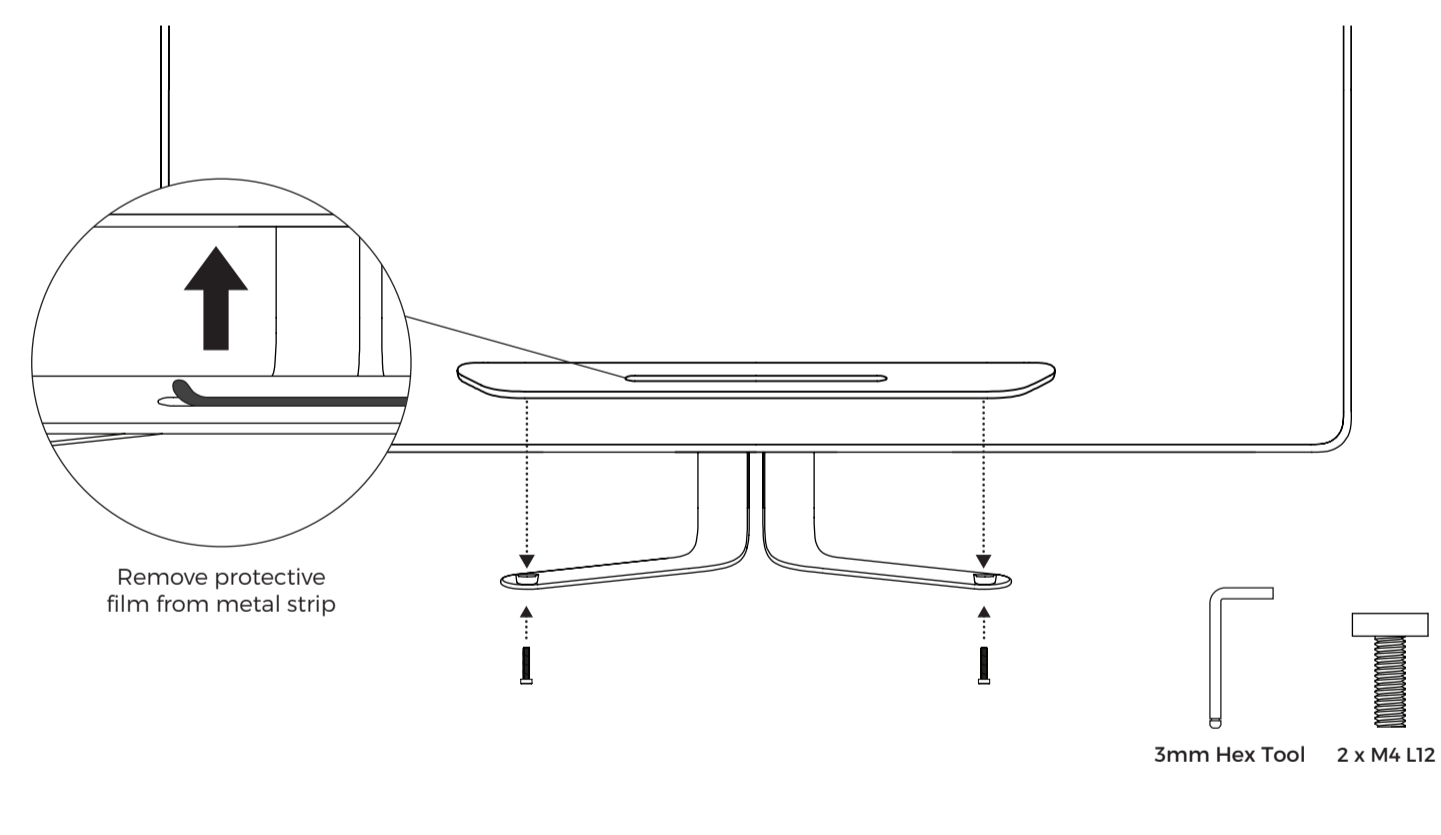

7 Place accessory box on tray.

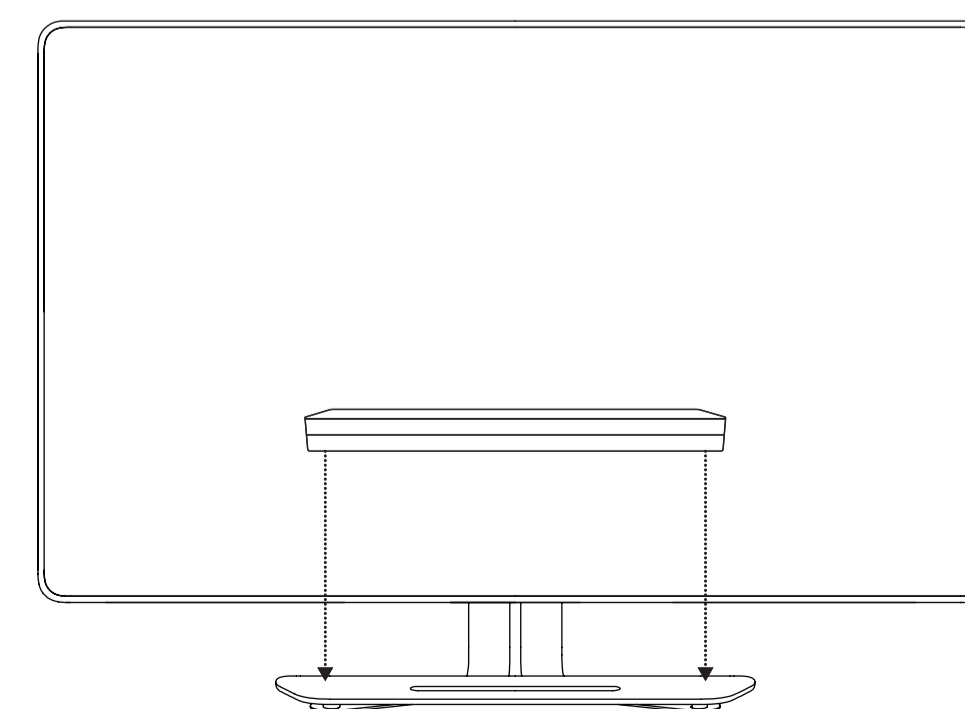

WARNING: DO NOT CLEAN JAMBOARD WITH ANY LIQUID SOLVENTS

