



ChromeOS 132 Enterprise and Education release notes

For administrators who manage Chrome devices for a business or school.

These release notes were published on January 08, 2025.

See the latest version of these release notes online at <https://g.co/help/ChromeEnterpriseReleaseNotes>

ChromeOS 132 release summary	2
Current ChromeOS changes	3
Upcoming ChromeOS changes	10
Additional resources	12
Still need help?	12

ChromeOS 132 release summary

Current ChromeOS changes	Security/ Privacy	User productivity/ Apps	Management
Customized Chrome Web Store for enterprises			
Native Client (NaCl) support ending on ChromeOS		✓	
Onboarding refresh		✓	
Migrate data for graduating students		✓	✓
Rounded corners for Apps		✓	
ChromeOS Passwordless Authentication	✓		
Face control on ChromeOS	✓	✓	
Turn off the touchpad		✓	
Password Manager biometric authentication	✓		
Apps discovery removed from Explore		✓	
Remote management for idle devices			✓
ChromeOS device Bedtime Hours policy			✓
Improved management disclosure on locked device	✓		
Upcoming ChromeOS changes	Security/ Privacy	User productivity/ Apps	Management
AI wallpapers and backgrounds		✓	
Deprecating Chrome Apps support on ChromeOS		✓	✓

The enterprise release notes are available in 9 languages. You can read about ChromeOS updates in English, German, French, Dutch, Spanish, Portuguese, Korean, Indonesian, and Japanese. Allow 1 to 2 weeks for translation for some languages.

Current ChromeOS changes

Customized Chrome Web Store for enterprises

Admins can now use new settings to customize the Chrome Web Store for their managed users, which includes the ability to:

- Add company logos
- Add hero banners and custom announcements
- Curate extension collections
- Implement category-based controls

These settings are configurable using the Admin console and are available to all signed-in managed users (users signed-in to the Chrome Web Store with a managed Google Account).

For more details, see [Customized Chrome Web Store for enterprises](#).

Additionally, all managed users who sign in to the Chrome Web Store will see the following changes:

- New tags for items **Blocked by their admin** when searching for an item
- Private domain item search and advanced filtering capabilities
- Private items and recommended items are relocated to the **Extensions** tab

Enrolled browsers (without the need to sign in) will be supported later in 2025.

- **Chrome 132 on ChromeOS, Linux, macOS, Windows**

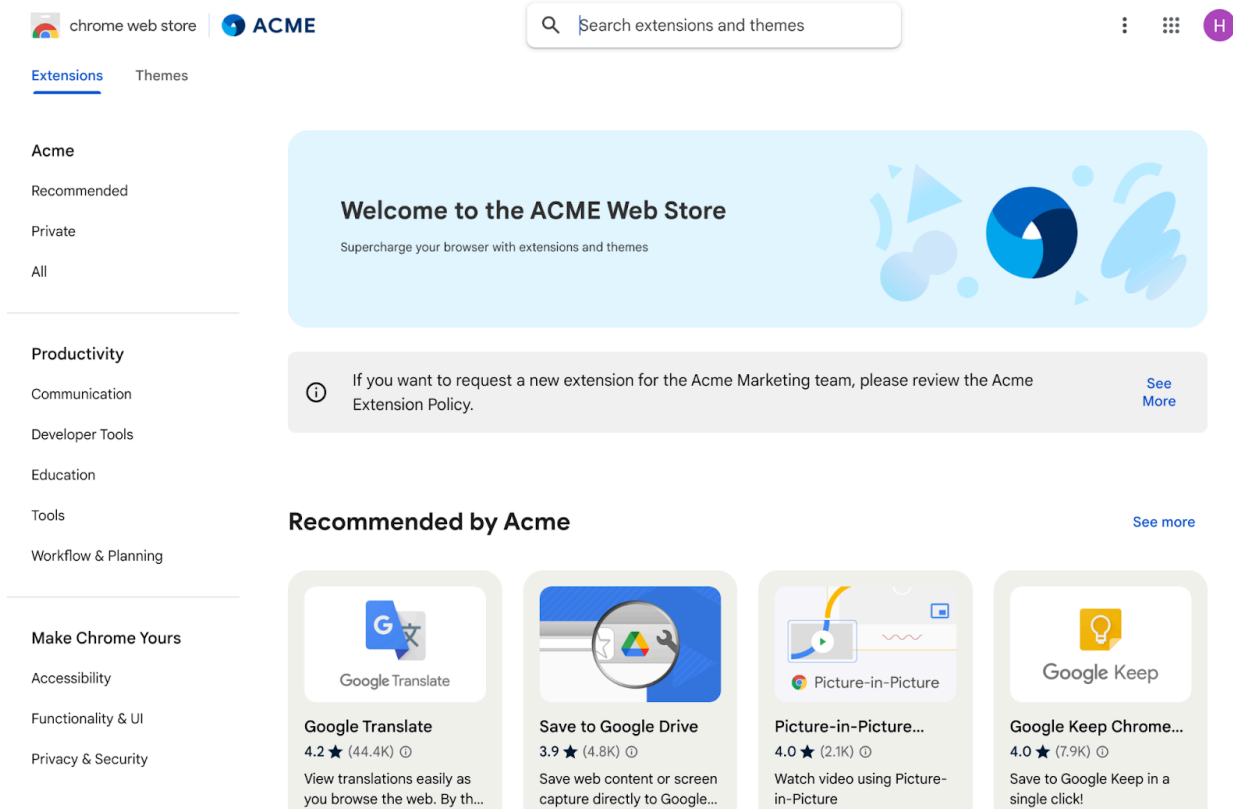

Native Client (NaCl) support ending on ChromeOS

ChromeOS 132 is the last release with NaCl support for unmanaged or consumer devices, followed by ChromeOS 138 in **July 2025** for managed devices. For more details, see [About ChromeOS device management](#).

In 2017, we announced the end of support of [Native Client \(NaCl\)](#) in favor of [WebAssembly](#). With most developers and users having migrated away from NaCl, we confirm the following NaCl discontinuation dates:

- **January 2025:** Native Client (NaCl) will be disabled from ChromeOS 132 onwards.
 - For unmanaged and consumer users, ChromeOS 132 will be the last ChromeOS release with support for NaCl.
 - For managed environments (including Kiosk sessions), administrators who manage ChromeOS devices for a business or school will have the option of extending the ability to use NaCl with a [DeviceNativeClientForceAllowed](#) NaCl allow policy through the ChromeOS 138 release. To enable device policies,

please refer to [Set ChromeOS device policies](#) in the Chrome Enterprise and Education Help Center.

- **July 2025:** ChromeOS 138 will be the last version with NaCl support.
 - For managed environments, ChromeOS 138 is a [Long-term Support \(LTS\)](#) ChromeOS release available to administrators who manage ChromeOS devices for a business or school.
 - For devices that have been [switched to the LTS channel](#) and have the NaCl allow policy enabled, NaCl will be available until LTS Last Refresh in **April 2026**.
 - **No exceptions will be granted.**

For Chrome Apps that use NaCl, migrate to [WebAssembly](#) (WASM). To help you with the transition, we've published the [WebAssembly Migration Guide](#).

For more information about this change or if you need assistance, you can refer to any of the following:

- [WebAssembly Migration Guide](#).
- [ChromeOS developer community on Discord](#).
- [ChromeOS release schedule](#) for release dates and updates.

To find out more, see [Manage policies for ChromeOS devices](#) in the Chrome Enterprise and Education Help Center.

Onboarding refresh

There are many different setup items that users might look to change once they've started using their devices, including setting up a printer, connecting Bluetooth devices, changing touchpad direction, and so on. This feature consolidates many of these common setup items into a simple task list, with deep linking to where a user can change a particular setting, to simplify the process of completing many of these steps.

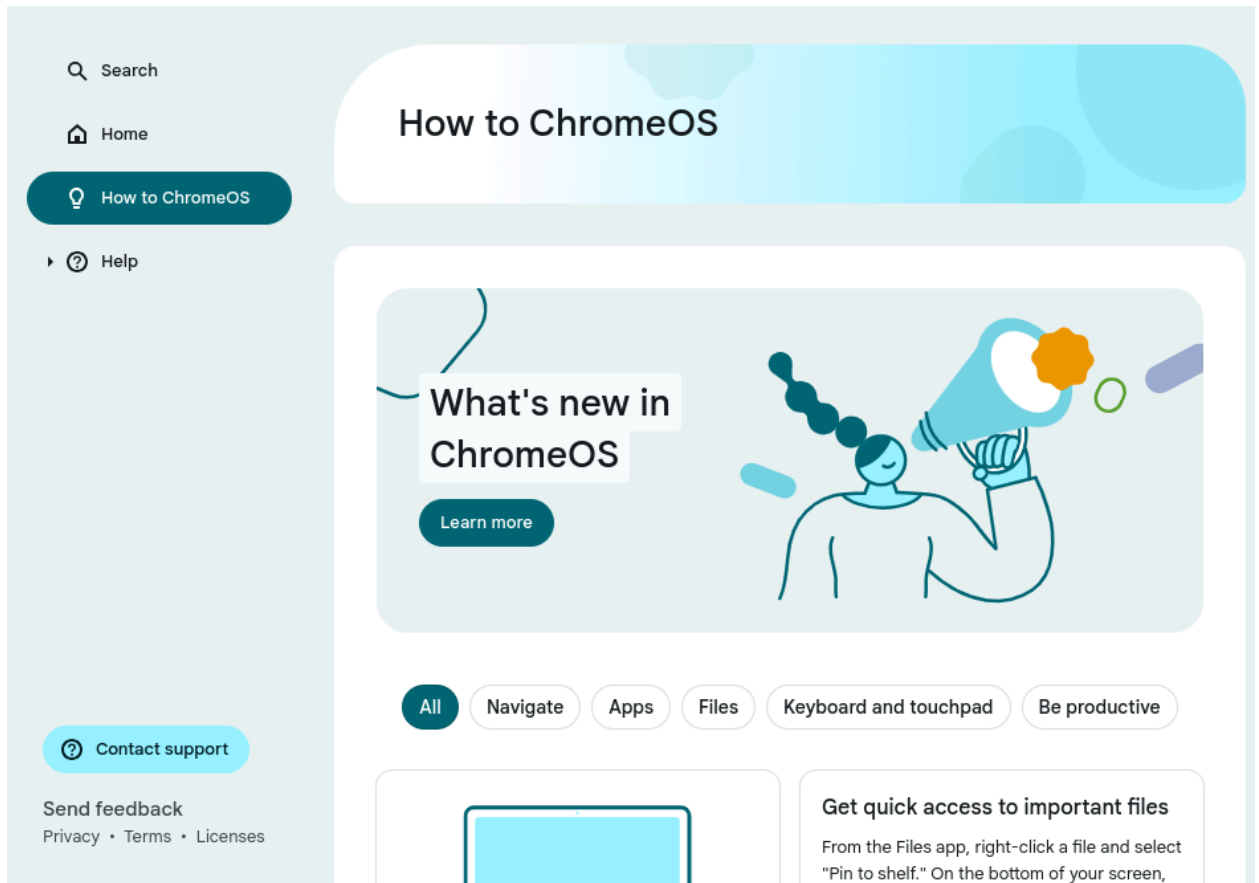

Migrate data for graduating students

As early as ChromeOS 132, a new Content transfer tool will guide graduating students or other EDU-managed users who want to migrate their data through the updated Google Takeout Transfer process. This allows them to take their Docs, Sheets, Slides, and Gmail content to a Gmail account of their choice.

This new application allows school administrators to pin an icon to the shelf, notify students and faculty on their Chromebooks, and set dates to trigger these nudges to encourage them to use Content transfer..

Rounded corners for Apps

As part of a new UI design, ChromeOS now features rounded corners on all app windows on Chromebook Plus devices.

ChromeOS passwordless authentication

The passwordless ChromeOS feature allows users to access their device with PIN or a local password as their primary authentication factor. This means that you will be able to log in to your ChromeOS device with a password you set explicitly for your device, as well as with a PIN no longer tying your gmail password with your device password. It is not possible to enable the PIN feature on managed devices.

Face control on ChromeOS

ChromeOS now features AI-powered face control; you can now use face and gesture tracking to navigate your Chromebook, open apps, and even compose emails – all without a keyboard or mouse. This built-in technology, inspired by [Project Gameface](#), provides greater accessibility for users with motor disabilities and offers a more efficient way for everyone to interact with their devices. To read more about this feature, see this Google [blog post](#).

Turn off the touchpad

Chromebook users can now disable their touchpads. This accessibility improvement helps those who rely on screen readers or may experience accidental clicks. To turn it off, go to **Settings > Accessibility > Cursor and Touchpad**.

Password Manager biometric authentication

ChromeOS 132 enables biometrics in Password Manager and autofill on Chrome for ChromeOS devices.

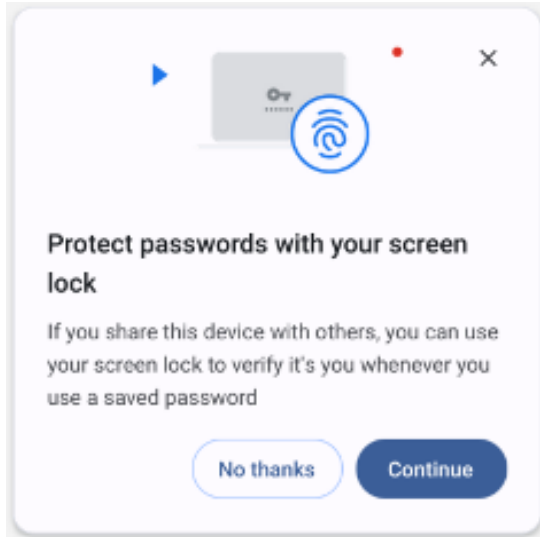

Apps discovery removed from Explore

ChromeOS 132 removes the Apps & Games module in the Explore app. To discover new apps for your ChromeOS device, navigate to <https://discover.apps.chrome>.

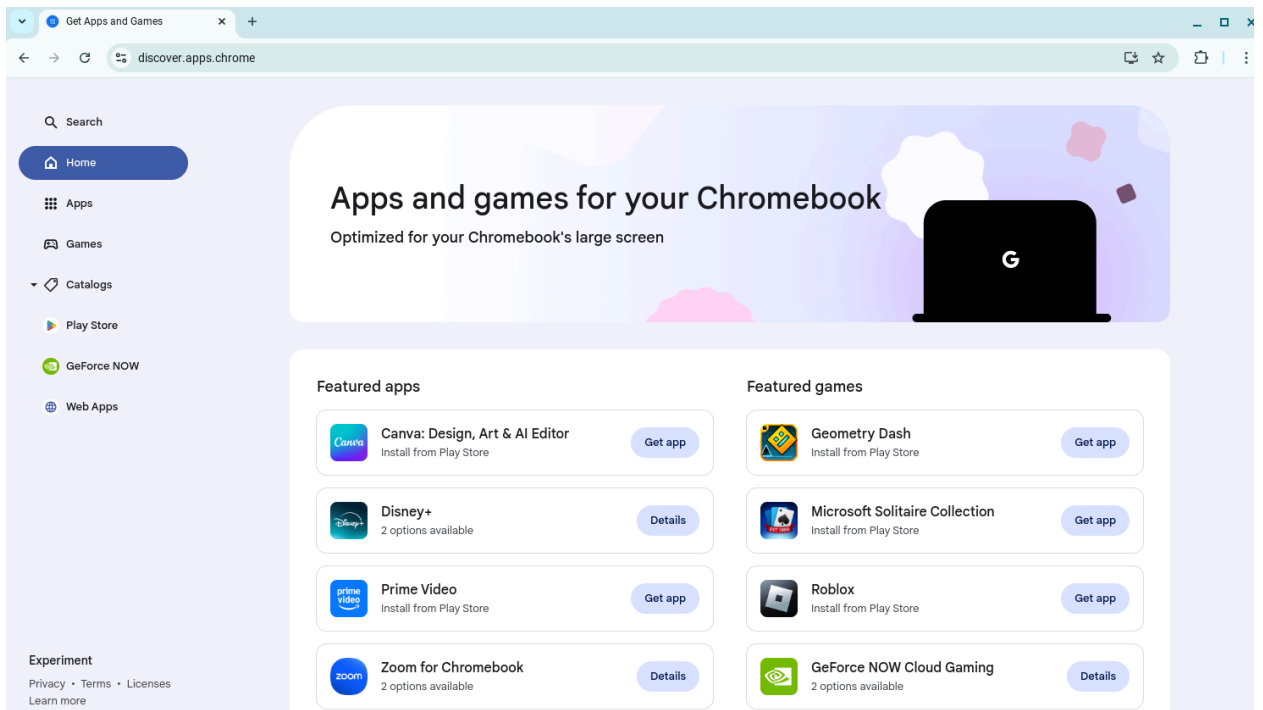

Remote management for idle devices

Chrome Remote Desktop (CRD) is a feature that allows for remote control of ChromeOS devices, primarily for troubleshooting purposes, where a device is idle and unused. Admins can now initiate a CRD connection to a ChromeOS device sitting on the login screen. This enables an admin to sign-in to a managed device with their own set of credentials for troubleshooting or testing.

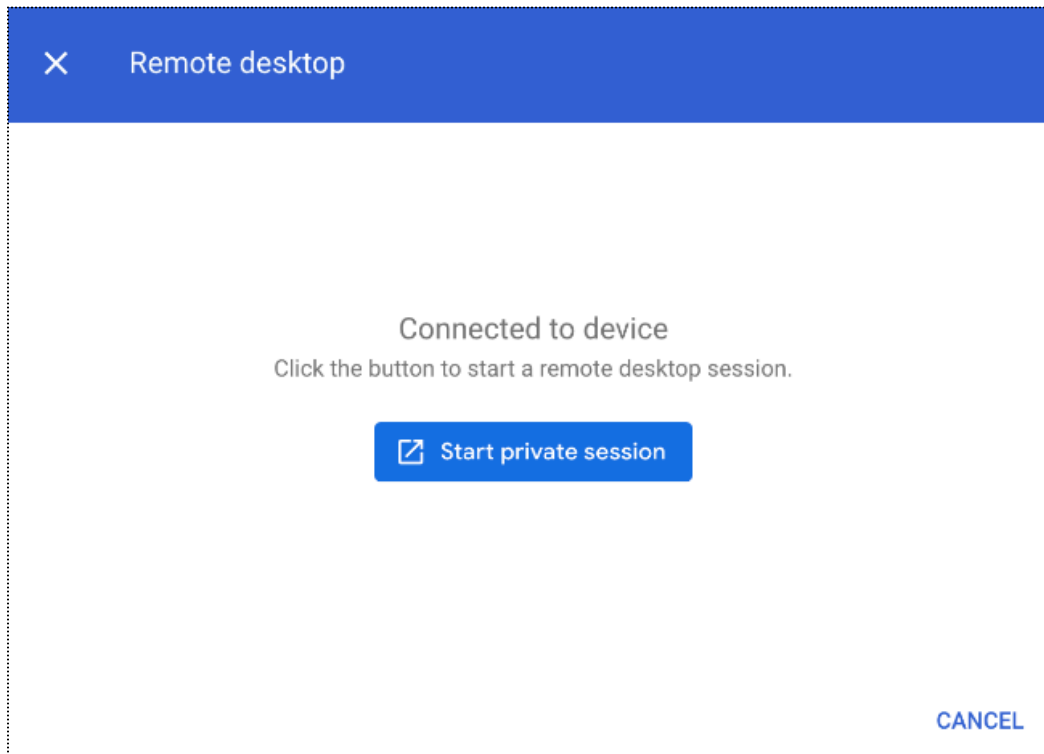

ChromeOS device Bedtime Hours policy

The new [DeviceRestrictionSchedule](#) policy allows ChromeOS administrators to disallow users from logging in to specified Chromebooks during certain hours on specified days of the week. During these hours, kiosk apps are also unavailable.

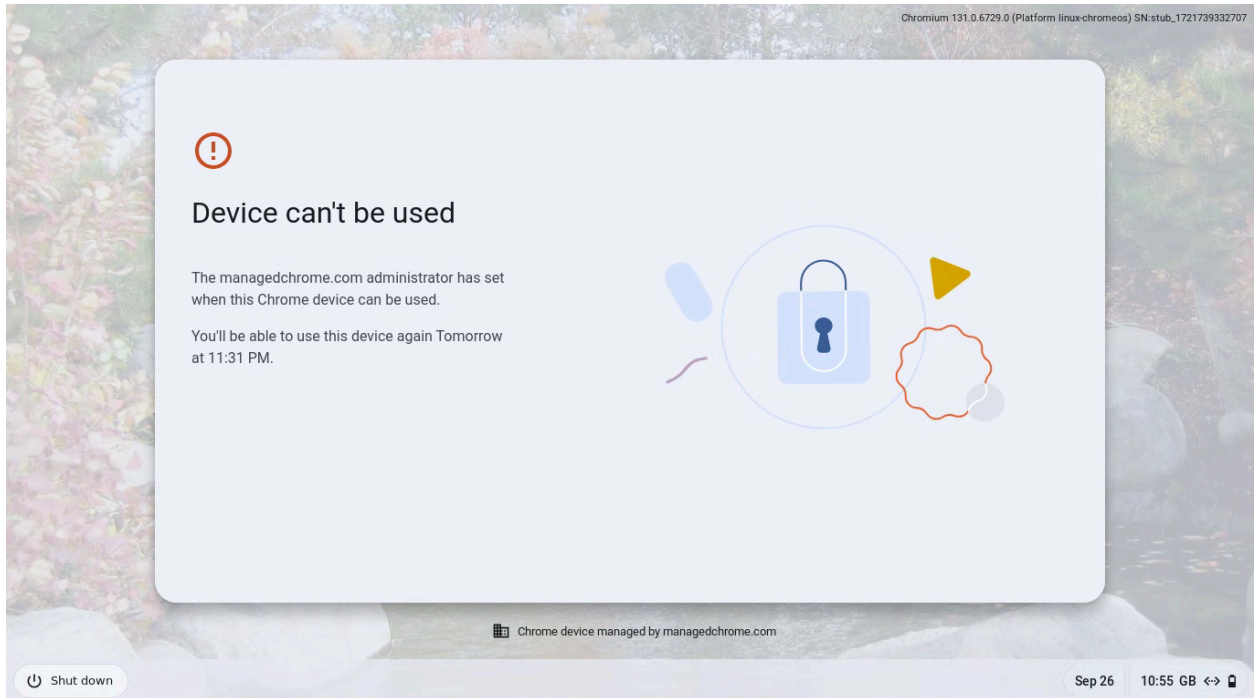

Improved management disclosure on locked device

This feature improves the management disclosure on the device's lock screen. To enhance user understanding before using their device for personal or work, we provide a clear explanation of what managed devices entail. This way, users can make informed decisions regarding their device usage. By providing necessary information, users gain the knowledge needed to make choices that align with their privacy and security concerns and preferences.

Upcoming ChromeOS changes

AI wallpapers and backgrounds

As early as ChromeOS 134, we plan to introduce high-resolution, generative AI wallpapers and video call backgrounds on ChromeOS. With this feature, you can unleash your creativity and turn your Chromebook into a canvas of personal expression. Choose from a diverse collection of templates and, in just a few clicks, infuse your Chromebook with your unique personality, mood, or interest.

Two new policies will be available to control these features; **GenAIVcBackgroundSettings** and **GenAIWallpaperSettings**. This feature will be available on [Chromebook Plus devices](#) only.

Deprecating Chrome Apps support on ChromeOS

In 2016, we announced the deprecation of Chrome Apps in favor of web apps, and in 2021, we [announced on the Chromium Blog](#) that support for Chrome Apps for ChromeOS Enterprise and Education customers and developers on ChromeOS would be extended until at least January 2025. With the majority of our customers having migrated off of Chrome Apps (including [Legacy \(v1\) packaged apps](#) and [Hosted apps](#)), we can confirm the following updates about Chrome Apps discontinuation dates.

- **July 2025: End of support for user-installed Chrome Apps (scheduled for ChromeOS M138).**
 - Chrome Apps that are force-installed through the admin console will continue to be supported.
- July 2026: Last ChromeOS release with support for Chrome Apps in Kiosk Mode (scheduled for ChromeOS M150).
 - Devices on the LTS channel with Chrome Apps in Kiosk Mode will receive support until April 2027.
- February 2028: Last ChromeOS release with support for Chrome Apps (scheduled for ChromeOS M168), marking the end of life for all Chrome Apps.
 - Devices on the LTS channel can continue to use Chrome Apps until October 2028.
 - No exceptions will be granted.

These deprecation timelines also apply to self-hosted Chrome Apps.

While no new Chrome Apps can be added to the Chrome Web Store, existing Chrome Apps can continue to be updated through October 2028 when they will reach end of life on ChromeOS. After this date, Chrome Apps will be removed from the Chrome Web Store.

If your organization has developed in-house Chrome Apps and you need assistance, please refer to [Transition from Chrome Apps](#) guide. You can also join us in the [ChromeOS developer community on Discord](#), or reach out to us through the form at

<https://chromeos.dev/work-with-us>. Refer to the [ChromeOS release schedule](#) for release dates and updates.

In the coming weeks, additional detailed information will be sent to all remaining Chrome App developers and all ChromeOS Administrators.

Additional resources

- For emails about future releases, [sign up here](#).
- To try out new features before they're released, sign up for the [trusted tester program](#).
- Connect with other Chrome Enterprise IT admins through the [Chrome Enterprise Customer Forum](#).
- How Chrome releases work—[Chrome Release Cycle](#)
- Chrome Browser downloads and Chrome Enterprise product overviews—[Chrome Browser for enterprise](#)
- Chrome version status and timelines—[Chrome Platform Status](#) | [Google Update Server Viewer](#)
- Announcements: [Chrome Releases Blog](#) | [Chromium Blog](#)
- Developers: Learn about [changes to the web platform](#).

Still need help?

- Google Workspace, Cloud Identity customers (authorized access only)—[Contact support](#)
- Chrome Browser Enterprise Support—Sign up to [contact a specialist](#)
- [Chrome Administrators Forum](#)
- [Chrome Enterprise Help Center](#)

Google and related marks and logos are trademarks of Google LLC. All other company and product names are trademarks of the companies with which they are associated.