

marko™
heating

Turbo Convection Heater



MHT-CTR20

USER INSTRUCTIONS

TECHNICAL CHARACTERISTICS

RATED POWER INPUT: 2000W

RATED VOLTAGE RANGE: 220-240V~ 50/60Hz

IMPORTANT

Read these instructions fully before using the heater. Retain these instructions for future reference.

ASSEMBLY OF THE HEATER

Before using the heater, the feet (supplied separately in the carton), must be fitted to the unit. These are to be attached to the base of the heater using the 4 self-tapping screws provided, taking care to ensure that they are located correctly in the bottom ends of the heater side moldings.

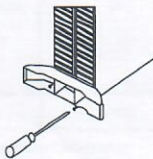

SAFETY INSTRUCTIONS (to be read before operating the heater)

1. Do not use the heater unless the feet are correctly attached.
2. Ensure the power supply to the socket into which the heater is plugged is in accordance with the rating label on the heater and that the socket is earthed.
3. Keep the power cord away from the hot body of the heater.
4. Warning: Do not use this heater in the immediate surroundings of a bath, a shower or a swimming pool.
5. Warning: In order to avoid overheating, do not cover the heater.
6. Indoor use only.
7. Do not place the heater on carpets having a very deep pile.
8. Always ensure that the heater is placed on a firm level surface.
9. Do not place the heater close to curtain or furniture in order to avoid a fire hazard.
10. Warning: Heater is not located immediately below a socket-outlet.
11. Do not insert any object through the heat outlet or air grilles of the heater.
12. Do not use the heater in areas where flammable liquids are stored or where flammable fumes may be present.
13. Always unplug the heater when moving it from one location to another.
14. Warning: If the supply cord is damaged, it must be replaced by the manufacturer, its service agent or a similarly qualified person in order to avoid a hazard.
15. This appliance is not intended for use by persons (including children) with reduced physical, sensory or mental capabilities, or lack of experience and knowledge, unless they have been given supervision or instruction concerning use of the appliance or a person responsible for their safety.
16. Children should be supervised to ensure that they do not play with the appliance.

OPERATION OF THE HEATER

Note: It is normal when the heaters are turned on for the first time or when they are turned on after having been used for a long period of time the heaters may emit some smell and fumes. This will disappear when the heater has been on a short while.

Thermostat

Choose a suitable location for the heater, taking into account the safety instructions above.

Insert the plug of the heater into a suitable socket.

Turn the thermostat knob fully in a clockwise direction to the maximum setting.

Turn on the heating elements by means of the rocker switches on the side panel. When the heating elements are on the switches will illuminate. For maximum heat output both switches should be on.

When the desired room temperature has been reached, the thermostat knob should be turned slowly anti-clockwise until the thermostat is heard to click off and the lights on the elements switches are seen to go out. After this the heater will keep the air temperature in the room at the set temperature by switching on and off automatically.

Convectector heater with thermostat and fan

the also incorporates an internal fan, which can be switched on independent of the heating elements.

Fan Operation: This is operated by means of the switch with the fan symbol along side it. The fan will only operate with the thermostat in the “-” position and can be used when the heating elements are “-” to blow warm air into the room.

In warm conditions the fan can be used with the heating elements “0” to blow cool air into the room.

CLEANING THE HEATER

Always un-plug the heater from the wall socket and allow it to cool down before cleaning.

Clean the outside of the heater by wiping with a damp cloth and buff with a dry cloth.

Do not use any detergents or abrasives and do not allow any water to enter the heater.

STORING THE HEATER

When the heater is not used for long period of time it should be protected from dust and stored in a clean dry place.

Conformity with directives

This product is CE marked to denote conformity with Directives 2014/35/EU (Low Voltage) and the EMC directive (2014/30/EU), as amended.

Correct Disposal of this product



This marking indicates that this product should not be disposed with other household wastes throughout the EU. To prevent possible harm to the environment or human health from uncontrolled waste disposal, recycle it responsibly to promote the sustainable reuse of material resources. To return your used device, please use the return and collection systems or contact the retailer where the product was purchased. They can take this product for environmental safe recycling.

English Part

Model Identifier(s): CTR20					
Item	Symbol	Value	Unit	Item	Unit
Heat output				Type of heat input, for electric storage local space heaters only (select one)	
Nominal heat output	Pnom	1.8-2.0	KW	Manual heat charge control with integrated thermostat	[no]
Minimum heat output (indicative)	Pmin	0.75	KW	Manual heat charge control with room and/or outdoor temperature feedback	[no]
Maximum continuous heat output	Pmax	1.8-2.0	KW	Electronic heat charge control with room and/or outdoor temperature feedback	[no]
Auxiliary electricity consumption				Fan assisted heat output	[no]
At nominal heat output	elmax	--	KW	Type of heat output/room temperature control (select one)	
At minimum heat output	elmin	--	KW	Single stage heat output and no room temperature control	[no]
In standby mode	eISB	0	KW	Two or more manual stages, no room temperature control	[no]
				With mechanic thermostat room temperature control	[yes]
				With electronic room temperature control	[no]
				Electronic room temperature control plus day timer	[no]
				Electronic room temperature control plus week timer	[no]
				Other control options (multiple selections possible)	
				Room temperature control, with presence detection	[no]
				Room temperature control, with open window detection	[no]
				With distance control option	[no]
				With adaptive start control	[no]
				With working time limitation	[no]
				With black bulb sensor	[no]
Contact details					