

## INSTRUCTIONS FOR USE

### SAFETY INSTRUCTIONS

1. Please keep this instruction sheet safely for future reference.
2. Please do not modify the product or the assembly details in any way. Modifications will affect the structural integrity and replacement parts will be at the buyer's expense. Inappropriate use or faulty application of the product are explicitly forbidden and absolve the manufacturer of all liability. This product needs to be mounted by an adult before use.
3. The use of the item is allowed only under continuous supervision by an adult. The product is suitable for individuals weighing up to 100 kg. The product is not suitable for children under 36 months, due to a lack of extra safety precautions and taking into account the limited mental capacities of toddlers.
4. This product meets all security aspects of the European standard EN71-1, EN71-2, EN71-3 and EN 71-8. It is only suitable for domestic use, outdoors.
5. When installing the product, ensure that the play system or other construction can support the weight (minimum 200 kg) and that there is no risk of entrapment.
6. The product should be at a distance of at least 2 m from all other installations e.g. fences, branches, clothes-line, ...
7. In this safety area no hard, angular or pointed objects should be present. The surface underneath the product should be flat and shock absorbing. The product must not be placed on asphalt, concrete or any other hard surface. We advise the removal and storage of all accessories during the winter because the characteristics of the soil (when frozen) are not suitable for safe play.
8. The minimum distance between the suspension points of a swing measured along the crossbeam equals or is more than distance between the junction points of the swing element, plus 4% of the distance from ground to the upper rotation point of swing hook. See FIG I.
9. The minimum clearance between the adjacent swing elements should be 45 cm. The minimum clearance between the swing element and the adjacent structures should be 30 cm. For: Rubber Swing: the minimum clearance from the bottom of the swing elements to the ground surface shall not be less than 35 cm. For Trapeze Bar: the minimum clearance from the bottom of the swing elements to the ground surface shall not be less than 100 cm. See FIG I.
10. Specific instructions for adjusting the rope-length: see FIG II. Ensure that the swing element hangs horizontal after adjustment of the ropes.
11. Please ensure that the crossbeam is never higher than 2.5 m. Please ensure that the crossbeam is never lower than 1.8 m. Please make sure that children do not climb the swing device to reach the top beam.
12. All pieces should be checked regularly. For replacement material and expansion of the playground equipment, please contact the supplier. Consequently safety will be guaranteed.
13. This product can only be used in combination with sufficiently strong swing hooks with a nylon bearing. Only in this case the safety can be ensured. It is explicitly forbidden to use the metal rings on a suspension system without a hinged element. For the suspension of a swing use the upper suspension connector of a design that will prevent unintentional disconnection (e.g. hook type 810.x, 811.x, hooks wound over 540° or spring-hook type).
14. This product should be installed at a safe clearance from adjacent swing elements, slides, carousel etc. This product should not be installed in locations where it would allow or encourage children to reach adjacent structures.

### INSPECTION AND MAINTENANCE

The frequency of inspection and maintenance will vary with the type of equipment or materials used or other factors (e.g. heavy use, levels of vandalism, coastal location, air pollution, age of equipment, ...). Special attention should be given to the swing hooks, rings, eights, plastic welds and ropes. Moving metal parts must be oiled regularly.

If these checks are not carried out the activity toy could overturn or otherwise become a hazard.

It is of particular importance that the maintenance instructions be followed at the beginning of each season as well as at regular intervals during the usage season.

#### Routine visual inspection (weekly to monthly)

- Always check that the bolts and nuts are securely fastened.
- Check the shock absorbing surface for objects that don't belong there.
- Check for missing parts.
- Check the equipment ground clearances.

#### Operational inspection (1 to 3 months)

- Check the stability of the construction.
- Check every part for excessive wear and replace defective parts in accordance with manufacturer's instruction.

#### Annual inspection (1 to 2 times per year)

- Check for rust and corrosion.
- Check every part for excessive wear and replace defective parts in accordance with manufacturer's instruction.



# ASSEMBLY

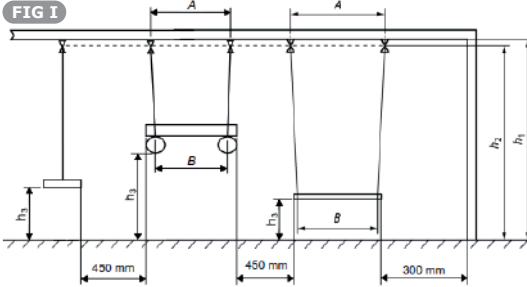
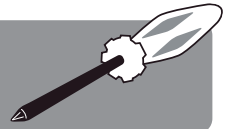

**A** distance between the suspension points along the crossbeam.  
**B** distance between the junction points of the swing element and the means of suspension.  
**h<sub>1</sub>** height of crossbeam.  
**h<sub>2</sub>** distance from the ground to the upper rotation point.  
**h<sub>3</sub>** distance from the ground to the swing element.

$$A \geq 0,04 h_2 + B$$

example:

$$h_2 = 2,45 \text{ m} \quad B = 38 \text{ cm}$$

$$(0,04 \times 245 \text{ cm}) + 38 \text{ cm} \quad A \geq 47,8 \text{ cm}$$

For Rubber swing:  $35 \text{ cm} < h_3 < 45 \text{ cm}$

FIG II

assembly of the ropes  
 montage van de touwen  
 montage des cordes  
 Montage der Seile  
 montaje de las cuerdas  
 montaggio delle corde  
 montáž lin

samling af rebene  
 köysien asennus  
 monterng av tauene  
 monterng av repen  
 kötélösszeszerelés  
 montáž lan  
 köite kokkupanek

asamblarea frânghiilor  
 montáž lán  
 virvju montáža  
 virvių surinkimas  
 sestavljanje vrvi  
 montagem das cordas  
 συναρμολόγηση των σχοινιών

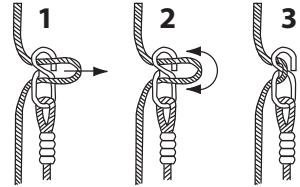

**Warnings:** Only for domestic use.  
 Maximum user weight 100kgs  
 Not recommended for children under the age of 36 months.  
 Strangulation on hazard. To be assembled by an adult.  
 Please retain details for future reference.

Manufactured for: The Magic Toy Shop Ltd  
 Customer Support: [Support@TheMagicToyShop.com](mailto:Support@TheMagicToyShop.com)  
 Website: [www.TheMagicToyShop.com](http://www.TheMagicToyShop.com)