

GEEZY®

Assembly Instructions for the Water fountain w/ LED Light

Item: SS2193096

- Take the fountain out of the box.
- Connect the pump to the tubing in the fountain (Step 1)
- Plug the LED light into the adaptor that is connected to the pump (Step. 2)
- Connect the adaptor to the pump cable. (Step 3)
- Put water (2000ML approx.) in the fountain (about ½ way full) take all cords and pump and place it in the water, be sure to make sure there is enough water in the bottom of the fountain so that the pump will be completely submersed. (Step 4)
- Plug the pump in and enjoy. (Step 5)

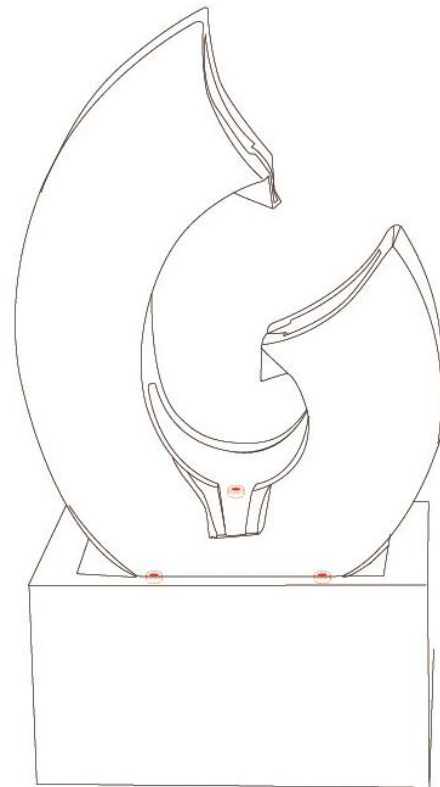
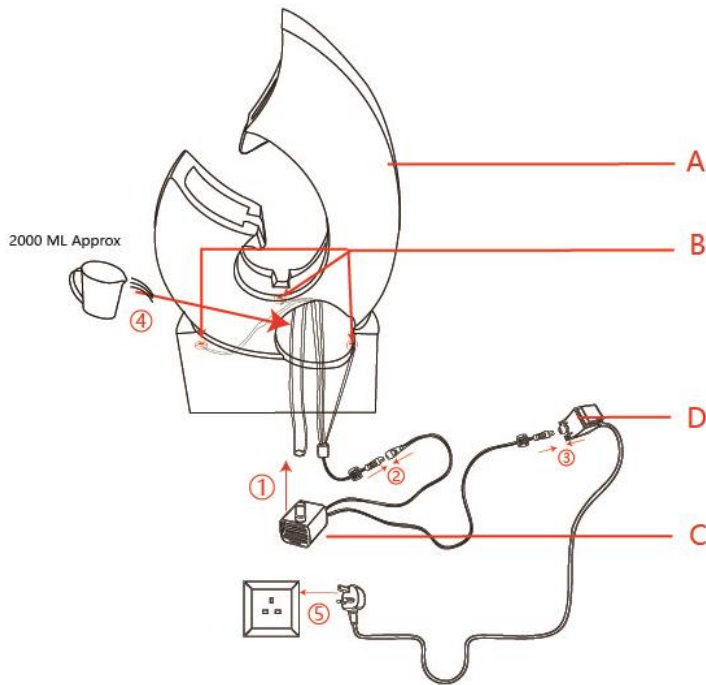

Part	Description	Quantity	Part	Description	Quantity
A	Fountain	1pc	C	Water pump	1pc
B	LED light	3pcs	D	Adaptor	1pc



NOTE: Allow the pump power cord to hang at a lower level than the wall outlet to form a “drip loop”. This will help prevent water from dripping down the power cord and getting into the wall outlet. Be careful not to spill water onto the plug of the pump. DO NOT allow the pump to run dry!

WASTE BATTERIES AND ELECTRICAL PRODUCTS SHOULD NOT BE DISPOSED OF WITH HOUSEHOLD WASTE. PLS RECYCLE WHERE FACILITIES EXIST. CHECK WITH YOU LOCAL AUTHORITY OR RETAILER FOR RECYCLING ADVICE.



MADE IN CHINA