

www.UkBuyZone.co.uk

gO EASY

Assembly Instructions for the Solar powered water fountain w/ LED Light Item: SS7189003

- Take the fountain out of the box.
- Plug the LED set(part B) into the adapter that is connected to the pump (Step. 1)
- Connect the pump to the tubing on the bottom of the fountain (Step 2)
- Lead the cord out through the hole on the back side of the fountain base. (Step 3)
- Put the assembled LED set(part B) on the basin (Step 4)
- Put water (800 ml approx.) in the basin of the fountain (about ½ way full) take all cords and pump and place them in the water, ensure that there is enough water in the bottom of the fountain so that the pump is completely submersed. (Step 5)
- Connect the faucet to the PVC pipe,make sure that the PVC pipe is tightly inserted into the faucet.(Step 6)
- Add included decorative rocks on the fountain.(Step 7)
- Assemble the solar panel as shown,push the switch to “ON” position to turn on the solar pump.Insert the solar panel in the ground and adjust the angle of the solar panel to make sure it can receive maximum direct sunlight. (Step 8)
- Connect the pump to the solar panel and enjoy this solar fountain. (Step 9)

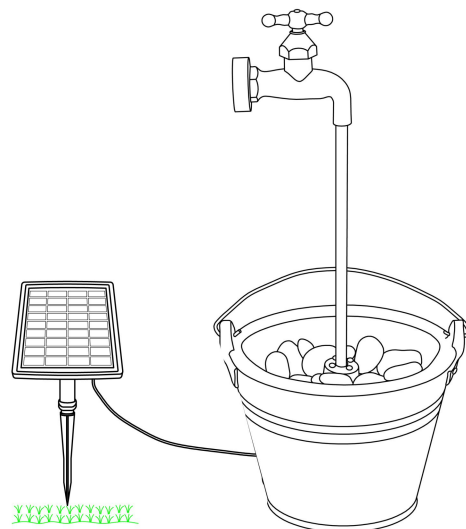
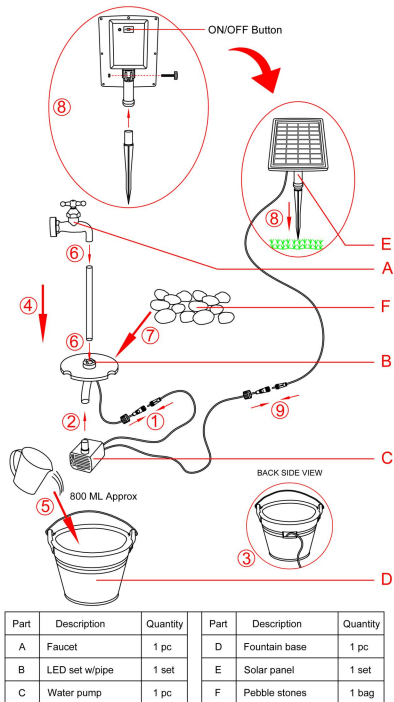

Part	Description	Quantity	Part	Description	Quantity
A	Faucet	1 pc	D	Fountain base	1 pc
B	LED set w/pipe	1 set	E	Solar panel	1 set
C	Water pump	1 pc	F	Pebble stones	1 bag

WASTE BATTERIES AND ELECTRICAL PRODUCTS SHOULD NOT BE DISPOSED OF WITH HOUSEHOLD WASTE.PLS RECYCLE WHERE FACILITIES EXIST.
CHECK WITH YOU LOCAL AUTHORITY OR RETAILER FOR RECYCLING ADVICE.



MADE IN CHINA

HOW TO USE:

For maximum performance the solar panel should receive at least 8 hours direct sunlight each day. Shady locations will shorten the running time at night.

Do not place the solar panel close to artificial lighting such as street lighting.

TROUBLESHOOTING

If your solar panel is not working

- Check for a protective film on the solar panel
- Check the location of the solar panel is not in a shady position
- Eliminate artificial light sources from the area
- Check the panel is clean. Wipe with a soft damp cloth
- Switch the light off and place in an optimum sun lit position and deep charge for a minimum of 8 hours. The battery will still charge if switched off

CHARGING AND OPERATION

1. Turn the switch, which is located under the solar panel, to “ON” position and the battery will work automatically. Charge the solar product by placing it under direct sunlight for at least 8 hours. Longer charging time is recommended for the first use. If the switch is “OFF” the battery will not work, solar panel ensures the pump works directly. The light will work automatically.
2. If there is no water, disconnect the pump from the battery and solar panel, running the pump dry will reduce the life of the pump.
3. When there is no sunlight, panel charged previously will power the fountain water & light for a minimum of a few hours. In the circumstances of a period of time with no sun, it will not work due to battery charged consumption being used up.
4. If the fountain is not to be used for a long period or before transportation, please disconnect pump from the battery. Periodically clean the pump filter.
5. 1 x Battery Ni-MH, 7.4V, 1500mAh - included



WARNING: Freezing Temperatures and Winter Storage

Do not leave the fountain outside in winter if you get freezing temperatures in your area. Freezing can cause damage to the product. Before the temp get down to 0°C/32°F store the entire fountain in a frost-proof environment such as a shed, garage or basement. Any issues caused by freezing temps, snow, or ice from leaving it outside in the winter are not covered under the manufacturer's warranty.

DO NOT allow the pump to run dry!