

Booster Clip Pro Assembly Instructions

With a few parts from the store and a few minutes of assembly time, you can make your very own Booster Clip that will serve you well for years to come.



Materials:

- A: plastic clamp (hardware store)
- B: 1" square magnet clip (office supply store)
- C: 3" flat head screw (6-32)
- D: washer (6-32)
- E: zinc wing nut (6-32)
- F: lock washer/nut combo (6-32)
- G: nylon wing nut (6-32)
made by Midwest Fastener,
#62541 A (6-32) – about 50 cents

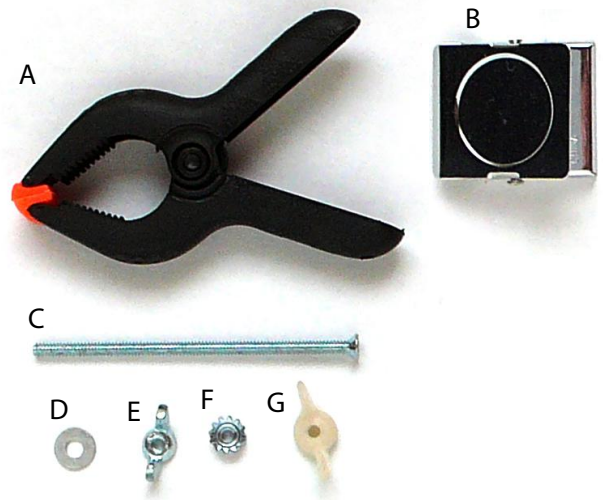

Instructions:

- 1) With a center punch, make a dent midway in the back edge of the magnet clip
- 2) Drill 1/8" hole in the back edge and ream slightly
- 3) Grind screw head to 1/32" rim... just slightly wider than thread width
- 4) Insert screw into Clip edge, then place washer and wing nut.
- 5) Bend screw about midway in a gentle 90o arc,
leaving enough of the screw (about 1") to feed through the plastic clamp (see next step)
- 6) Drill 9/64" hole straight through the black plastic clamps.
- 7) Screw lock washer onto screw, then push the screw through the hole in the clamp.
- 8) Put the nylon wing on the end of the screw.
- 9) Change the clamp angle to suit by adjusting the either (or both) wing nuts.

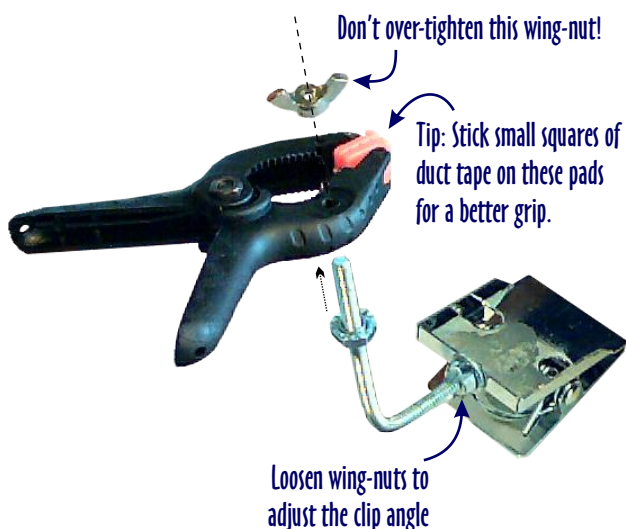

This alternative model (below) uses a different clamp to span two tuning posts. It works well for the fiddle too.

