

ACCOMMODATIONS SYMBOL LEGEND

- ★ 2 Twin Beds (convert to King) and Single Sofa Bed
  - 2 Twin Beds (convert to King) and 1 Upper Pullman
  - ◇ 2 Twin Beds (convert to King), 1 Lower Pullman, and 1 Upper Pullman
  - ⋮ 2 Twin Beds (convert to King) and 2 Upper Pullmans
  - † 2 Twin Beds (convert to King) and Double Sofa Bed
  - ◆ Stateroom with 2 Porthole Windows
- ◁ Connecting staterooms (ideal for families and groups of friends)
  - ★ Twin beds do not convert to a King Bed.
  - U Unisex Wheelchair Accessible Restroom
- 8A 8B 8C 8D Balcony Staterooms: Beds do not convert to King when both Upper Pullmans in use.

All accommodations are non-smoking.

Accessible staterooms are available for guests with disabilities. Please contact Guest Access Services at 1-800-438-6744 ext. 70025 for details, or visit <http://www.carnival.com/about-carnival/special-needs.aspx>.

CATEGORIES

- 1A Interior Upper/Lower
- PT Porthole
- 4A 4B 4C 4D 4E 4I Interior
- 6A 6B 6C 6D 6E Ocean View
- 8A 8B 8C 8D Balcony
- 8M Aft-View Extended Balcony
- OB Junior Suite (obstructed views)
- JS Junior Suite
- GS Grand Suite
- ES Extended Balcony Grand Suite

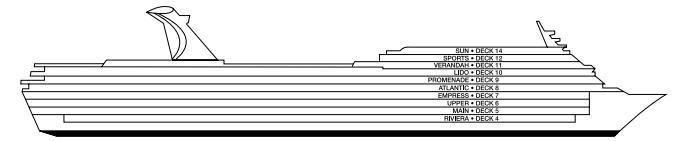

Gross Tonnage: 70,367 Length: 855 Feet Beam: 103 Feet  
 Cruising Speed: 21 Knots Guest Capacity: 2,056 (Double Occupancy)  
 Total Staff: 920 Registry: Panama

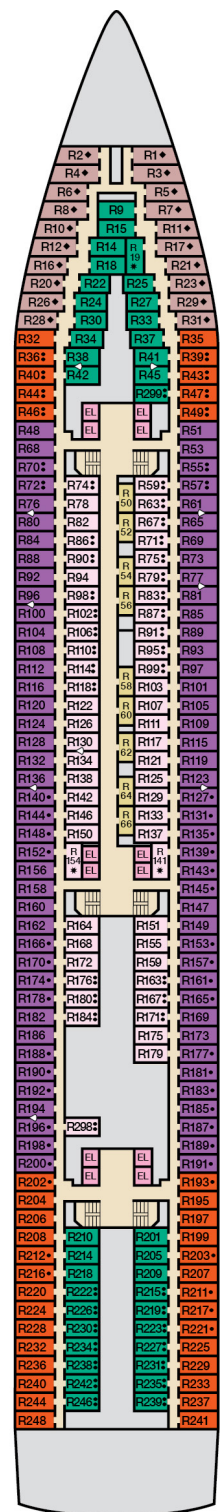

Riviera • Deck 4

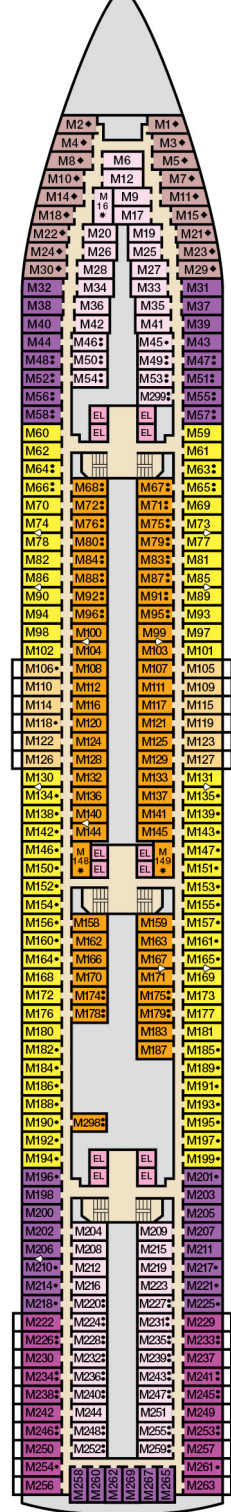

Main • Deck 5

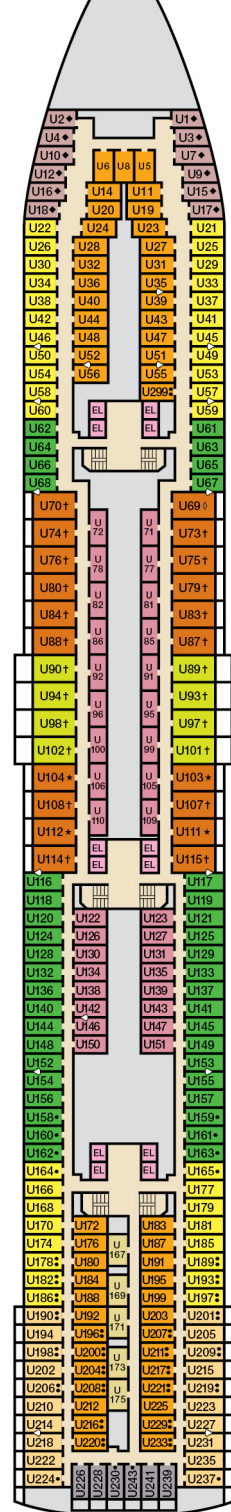

Upper • Deck 6

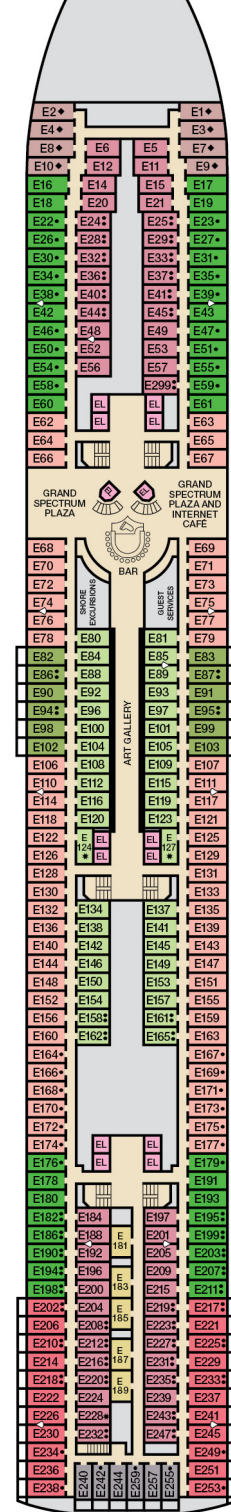

Empress • Deck 7

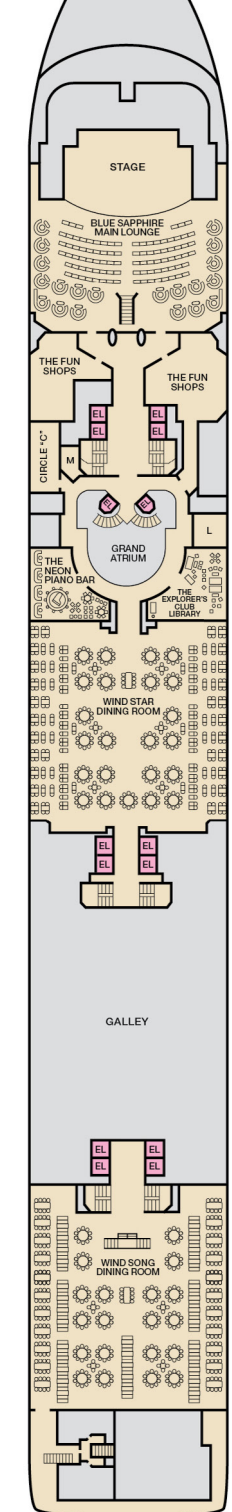

Atlantic • Deck 8

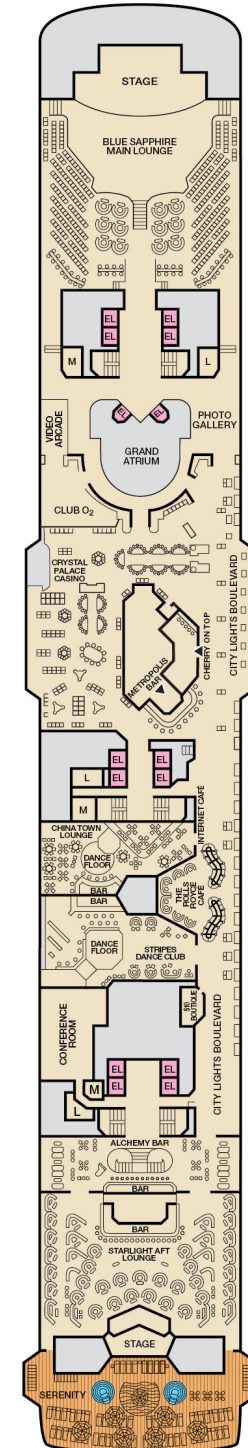

Promenade • Deck 9

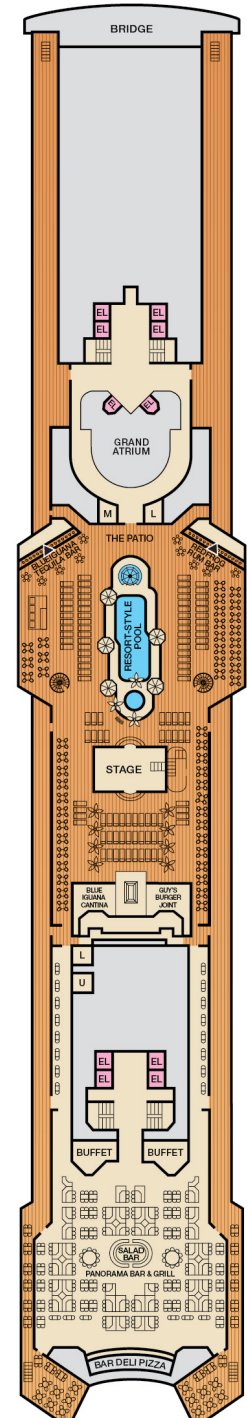

Lido • Deck 10

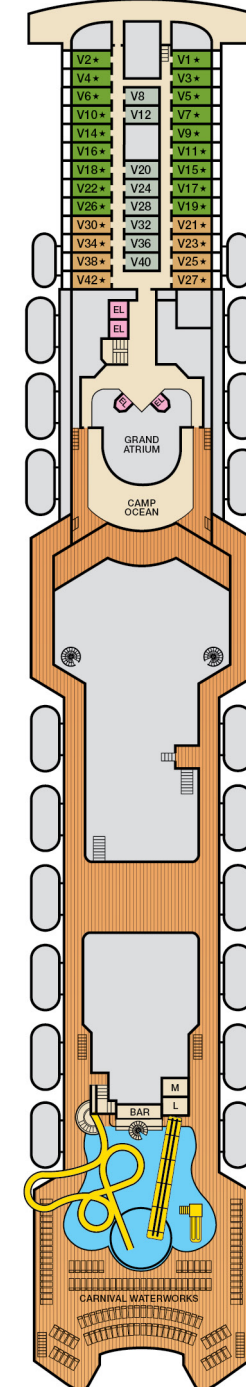

Verandah • Deck 11

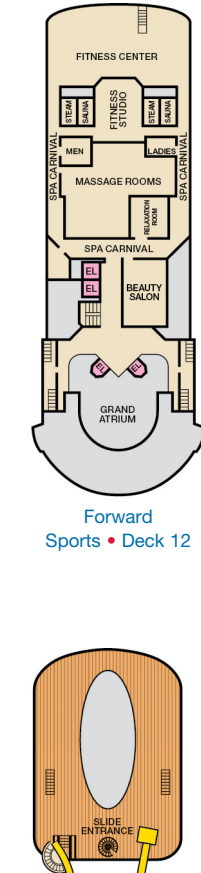

Aft Sports • Deck 12

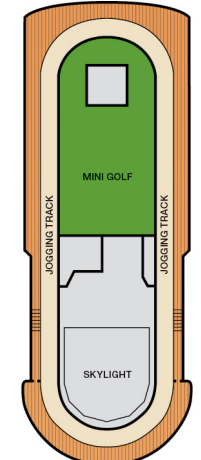

Sun • Deck 14