

NK4 - L10 - S100 - M2 - M100W - B

型號
Model

導程
Lead

行程
Stroke

馬達方向
Motor direction

馬達廠牌及出力
Model brand and output

剎車
Brake

- M2 馬達外置 Motor outside position
- M3 馬達外置右側 Motor outside ,rightward position
- M4 馬達外置左側 Motor outside , left ward position
- M6 馬達外置下方 Motor outside ,lower position

- H 上銀 Hiwin
- X 西門子 Siemens
- M 三菱 Mitsubishi
- Y 安川 Yaskawa
- P 松下 Panasonic
- F 富士 Fuji
- T 台達 Delta

NK4規格表(NK4 Specification)

馬達出力 Step motor output	100W			
重複定位精度 Repeatability(mm)	±0.01			
滾珠絲桿外徑 B.S(Ø)	Ø10			
滾珠螺桿導程 Lead(mm)	2	5	10	
最快速度 Maximun speed(mm/sec)	100	250	500	
最大載重 Maximum payload(kg)	水平使用 (H)	25	20	12
	垂直使用 (V)	8	5	2
額定推力 Rated thrus(N)	424	141	71	
行程 Stroke(mm)	100-800 50間隔 (interval)			

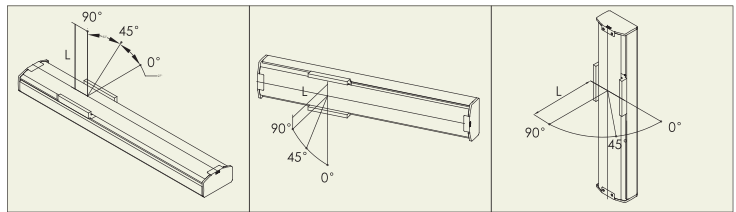

水平安裝應用: 單位Unit:mm Horizontal use					牆面安裝應用: 單位Unit:mm Wall installation use					垂直安裝應用: 單位Unit:mm During vertical use						
導程 Lead	荷重 Payload	0°	45°	90°	導程 Lead	荷重 Payload	0°	45°	90°	導程 Lead	荷重 Payload	0°	45°	90°		
Lead 2	12kg	80	505	1000	Lead 2	12kg	1000	70	80	Lead 2	4kg	200	165	200		
	18kg	50	355	750		Lead 5	18kg	750	42		50	Lead 5	8kg	100	76	100
	25kg	32	260	500			Lead 10	25kg	500		20		32	Lead 10	-	-
Lead 5	10kg	70	270	550	Lead 5	10kg		550	58	72	Lead 5	3kg	200		165	200
	15kg	45	187	350		Lead 10	15kg	345	36	45		Lead 10	5kg	120	85	120
Lead 10	20kg	31	140	250	Lead 10		20kg	250	21	31	Lead 10		-	-	-	-
	8kg	75	130	305		Lead 10	8kg	300	60	75		Lead 10	1.5kg	350	266	350
	10kg	57	115	240			Lead 10	10kg	240	44			58	Lead 10	2kg	260
	12kg	47	90	195		12kg		190	35	47		-	-		-	-

*滑塊表面中心到搬送物重心的距離(僅供參考)
Distance center of slider top to center of gravity of object being transported (For reference only)

靜態容許負載慣量
Stidic Loading Moment

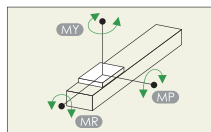

(單位:N.m) (Unit:N.m)
水平使用時 Static Loading Moment

MY	79
MP	79
MR	116

"此款型號不建議當多軸負載軸"
This model suggest not be used as load axis of multi axes.

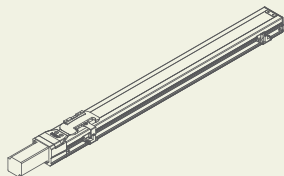

M2

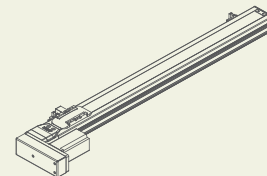

M3

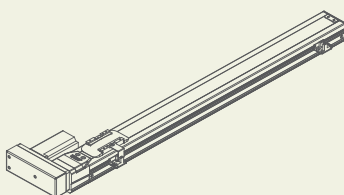

M4

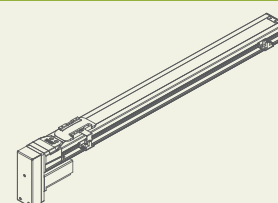

M6

M2

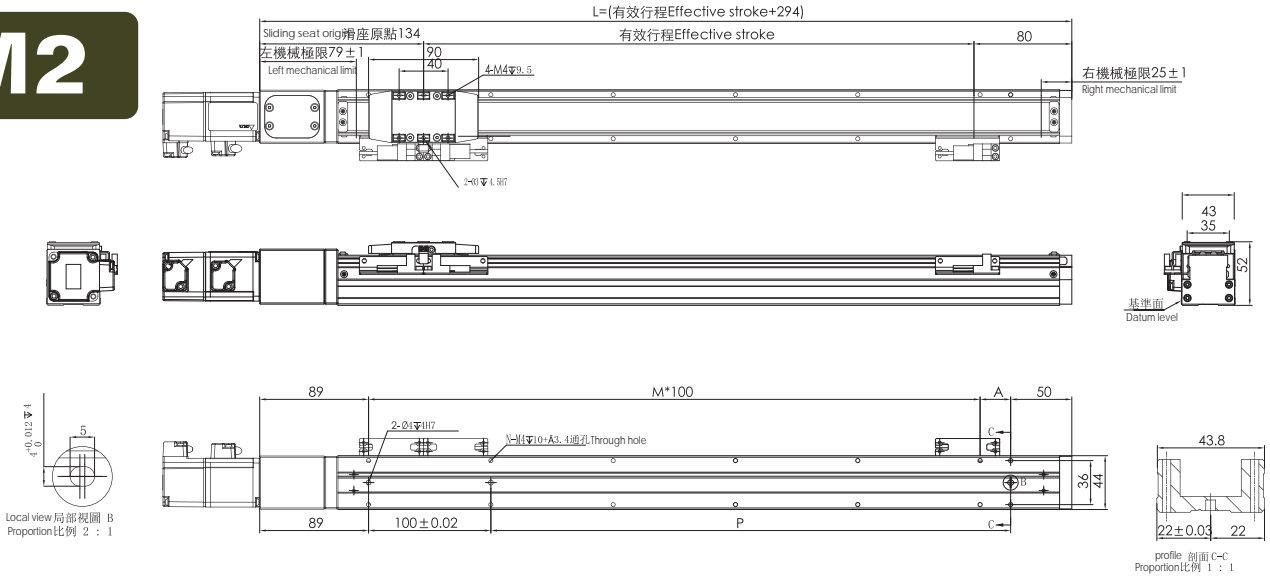

行程 Stroke	50	100	150	200	250	300	350	400	450	500	550	600	650	700	750	800
L	264	314	364	414	464	514	564	614	664	714	764	814	864	914	964	1014
A	25	75	25	75	25	75	25	75	25	75	25	75	25	75	25	75
M	1	1	2	2	3	3	4	4	5	5	6	6	7	7	8	8
N	6	6	8	8	10	10	12	12	14	14	16	16	18	18	20	20
P	25	75	125	175	225	275	325	375	425	475	525	575	625	675	725	775
重量(kg)	0.95	1.12	1.29	1.47	1.65	1.83	2.01	2.19	2.37	2.55	2.73	2.91	3.09	3.27	3.45	3.63

※本公司享有變更規格之權益，恕不另行通知 ※Drawings and specifications are subject to change without prior notice.

M3

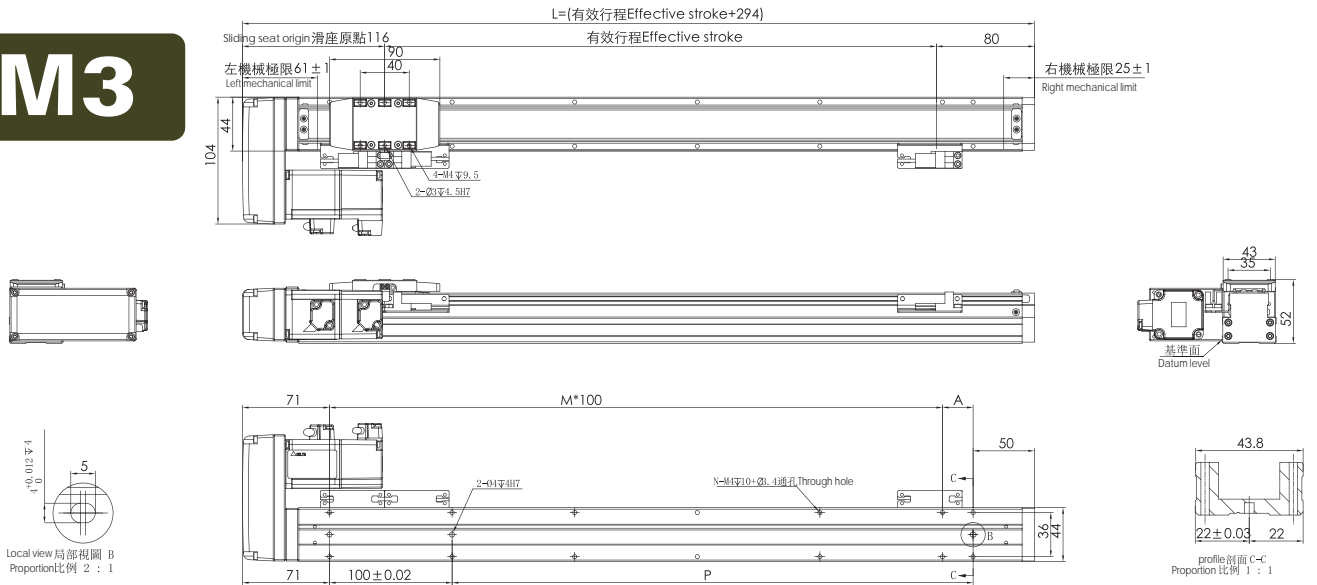

行程 Stroke	50	100	150	200	250	300	350	400	450	500	550	600	650	700	750	800
L	246	296	346	396	446	496	546	596	646	696	746	796	846	896	946	996
A	25	75	25	75	25	75	25	75	25	75	25	75	25	75	25	75
M	1	1	2	2	3	3	4	4	5	5	6	6	7	7	8	8
N	6	6	8	8	10	10	12	12	14	14	16	16	18	18	20	20
P	25	75	125	175	225	275	325	375	425	475	525	575	625	675	725	775
重量(kg)	1.04	1.22	1.40	1.58	1.76	1.94	2.12	2.30	2.48	2.66	2.84	3.02	3.20	3.38	3.56	3.74

※本公司享有變更規格之權益，恕不另行通知 ※Drawings and specifications are subject to change without prior notice.

M4

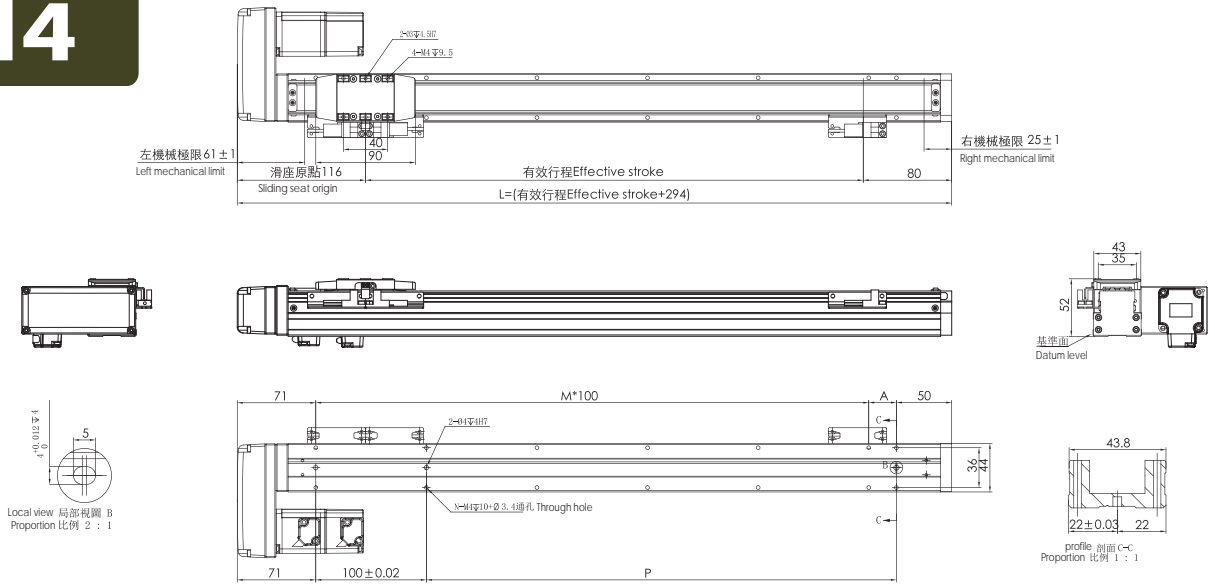

行程 Stroke	50	100	150	200	250	300	350	400	450	500	550	600	650	700	750	800
L	246	296	346	396	446	496	546	596	646	696	746	796	846	896	946	996
A	25	75	25	75	25	75	25	75	25	75	25	75	25	75	25	75
M	1	1	2	2	3	3	4	4	5	5	6	6	7	7	8	8
N	6	6	8	8	10	10	12	12	14	14	16	16	18	18	20	20
P	25	75	125	175	225	275	325	375	425	475	525	575	625	675	725	775
重量 (kg)	1.04	1.22	1.40	1.58	1.76	1.94	2.12	2.30	2.48	2.66	2.84	3.02	3.20	3.38	3.56	3.74

※本公司享有變更規格之權益，恕不另行通知 ※Drawings and specifications are subject to change without prior notice.

M6

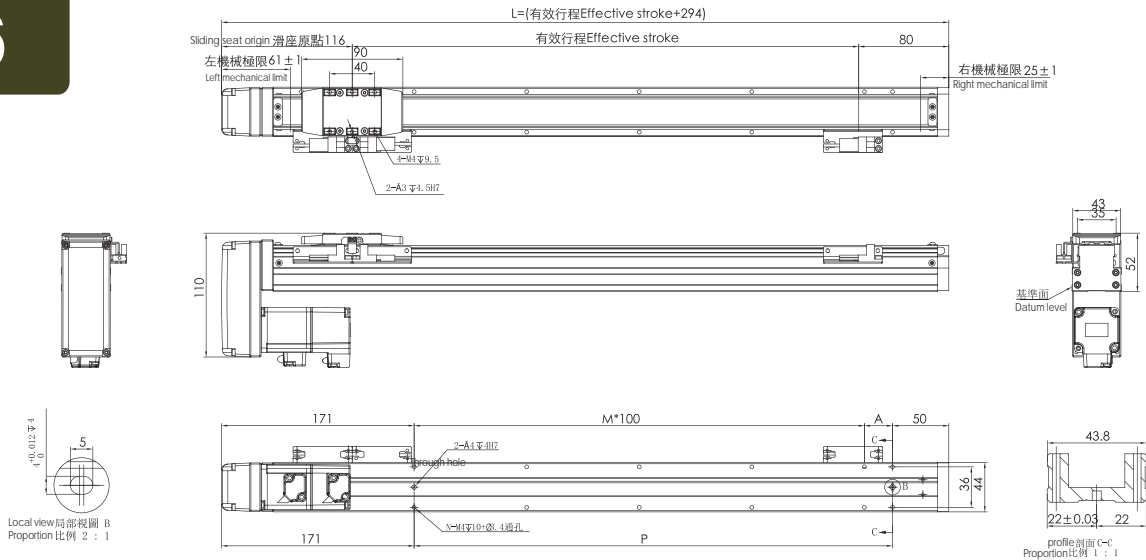

行程 Stroke	50	100	150	200	250	300	350	400	450	500	550	600	650	700	750	800
L	246	296	346	396	446	496	546	596	646	696	746	796	846	896	946	996
A	25	75	25	75	25	75	25	75	25	75	25	75	25	75	25	75
M	1	1	2	2	3	3	4	4	5	5	6	6	7	7	8	8
N	6	6	8	8	10	10	12	12	14	14	16	16	18	18	20	20
P	25	75	125	175	225	275	325	375	425	475	525	575	625	675	725	775
重量 (kg)	1.04	1.22	1.40	1.58	1.76	1.94	2.12	2.30	2.48	2.66	2.84	3.02	3.20	3.38	3.56	3.74

※本公司享有變更規格之權益，恕不另行通知 ※Drawings and specifications are subject to change without prior notice.