

136S -TL10 - S1050 - M1 - M 200W - B

型號 Model	孔型與導程 Hole type and Lead	行程 Stroke	馬達方向 Motor direction	馬達廠牌及出力 Motor brand and output	煞車 Brake
	T 底部通孔 Through hole Y 底部牙孔 Thread hole	馬達方向 Motor direction M1 馬達內置 Motor inside position M2 馬達外置 Motor outside position M3 馬達外置右側 Motor outside, rightward position M4 馬達外置左側 Motor outside, leftward position M5 馬達外置上方 Motor outside, upper position M6 馬達外置下方 Motor outside, lower position		馬達廠牌及出力 Motor brand and output H 上銀 Hiwin X 西門子 Siemens M 三菱 Mitsubishi Y 安川 Yaskawa P 松下 Panasonic F 富士 Fuji T 台達 Delta	

136S規格表(136S Specification):

馬達出力 AC Servo motor output(W)	200W				
重覆定位精度 Repeatability(mm)	±0.01				
滾珠螺桿外徑 B.S(Ø)	16	16	16	20	
滾珠螺桿導程 Lead(mm)	5	10	16	20	
最快速度 Maximun speed(mm/sec)	250	500	800	1000	
最大載重 Maximun payload(kg)	水平使用(H)	75	60	40	30
	垂直使用(V)	18	12	8	5
額定推力 Rated thrust(N)	640	320	225	160	
行程 Stroke(mm)	100~1050 50 間隔(interval)				

線性滑軌15x12.5-2支 (Linear Guide15x12.5-2)

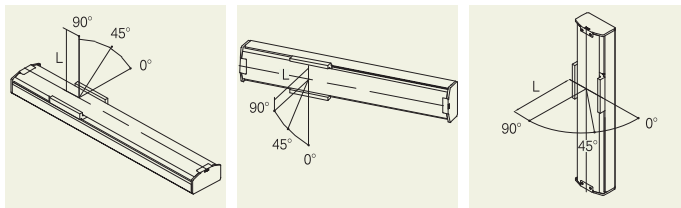

水平安裝應用(單位:mm) Horizontal use					牆面安裝應用(單位:mm) Wall installation use					垂直安裝應用(單位:mm) During vertical use						
導程 Lead	荷重 Payload	0°	45°	90°	導程 Lead	荷重 Payload	0°	45°	90°	導程 Lead	荷重 Payload	0°	45°	90°		
Lead 20	5kg	756	766	1520	Lead 20	5kg	935	565	860	Lead 20	1kg	1029	1200	2108		
	15kg	310	321	710		Lead 16	15kg	426	288		290	Lead 16	3kg	525	625	1055
	30kg	199	268	737			Lead 10	30kg	356		130		125	Lead 10	5kg	265
Lead 16	20kg	263	325	565	Lead 16	20kg		431	189	124	Lead 16	4kg	250		402	730
	30kg	145	189	368		Lead 10	30kg	100	77	32		Lead 10	6kg	121	236	405
	40kg	125	188	358			Lead 5	40kg	13	4			0	Lead 5	8kg	39
Lead 10	30kg	209	260	482	Lead 10	30kg		395	184	122	Lead 10	8kg	168		212	894
	45kg	133	177	353		Lead 5	40kg	248	50	29		Lead 5	10kg	129	187	350
	60kg	101	145	349			Lead 5	50kg	0	0			0	Lead 5	12kg	99
Lead 5	50kg	165	223	560	Lead 5	35kg		933	128	99	Lead 5	10kg	102		145	300
	60kg	135	188	500		Lead 5	45kg	570	50	35		Lead 5	14kg	65	92	170
	75kg	102	134	410			Lead 5	55kg	0	0			0	Lead 5	18kg	37

*滑塊表面中心到搬送物重心的距離(僅供參考)
Distance center of slider top to center of gravity of object being transported (For reference only)

"此款型號不建議當多軸負載軸"
This model suggest not be used as load axis of multi axes.

靜態容許負載慣量
Static Loading Moment

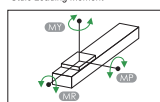

[單位:N.m] (Unit:N.m)
水平使用時 Static Loading Moment

MY	174
MP	175
MR	153

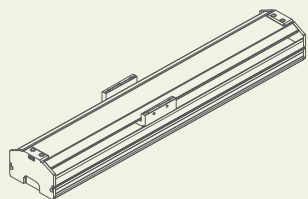

M1

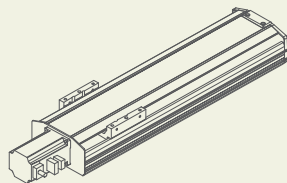

M2

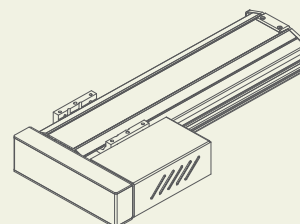

M3

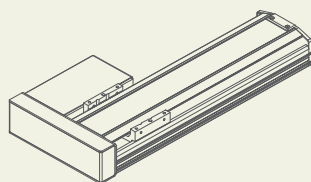

M4

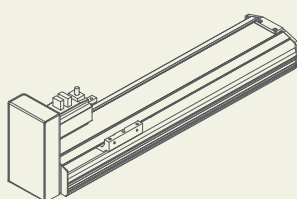

M5

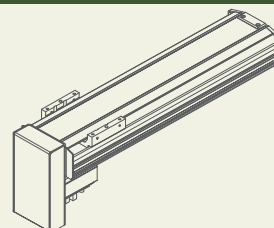

M6

M1

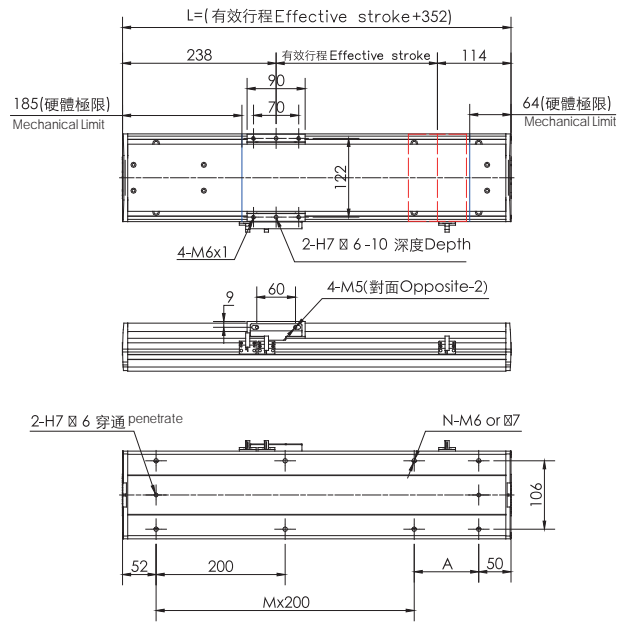
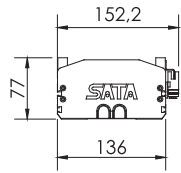

行程 Stroke	100	150	200	250	300	350	400	450	500	550	600	650	700	750	800	850	900	950	1000	1050
L	452	502	552	602	652	702	752	802	852	902	952	1002	1052	1102	1152	1202	1252	1302	1352	1402
A	150	200	50	100	150	200	50	100	150	200	50	100	150	200	50	100	150	200	50	100
M	1	1	2	2	2	2	3	3	3	3	4	4	4	4	5	5	5	5	6	6
N	6	6	8	8	8	8	10	10	10	10	12	12	12	12	14	14	14	14	16	16
重量(kg)	6.0	6.5	7.0	7.5	8.0	8.5	9.0	9.5	10.0	10.5	11.0	11.5	12.0	12.5	13.0	13.5	14.0	14.5	15.0	15.5

※本公司享有變更規格之權益，恕不另行通知 ※Drawings and specifications are subject to change without prior notice.

M2

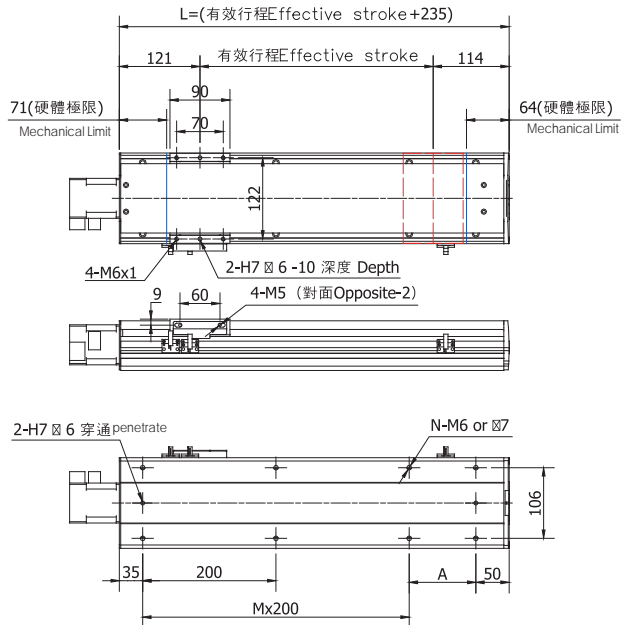
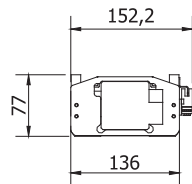

行程 Stroke	100	150	200	250	300	350	400	450	500	550	600	650	700	750	800	850	900	950	1000	1050
L	335	385	435	485	535	585	635	685	735	785	835	885	935	985	1035	1085	1135	1185	1235	1285
A	50	100	150	200	50	100	150	200	50	100	150	200	50	100	150	200	50	100	150	200
M	1	1	1	1	2	2	2	2	3	3	3	3	4	4	4	4	5	5	5	5
N	6	6	6	6	8	8	8	8	10	10	10	10	12	12	12	12	14	14	14	14
重量(kg)	5.6	6.1	6.6	7.1	7.6	8.1	8.6	9.1	9.6	10.1	10.6	11.1	11.6	12.1	12.6	13.1	13.6	14.1	14.6	15.1

※本公司享有變更規格之權益，恕不另行通知 ※Drawings and specifications are subject to change without prior notice.

M3

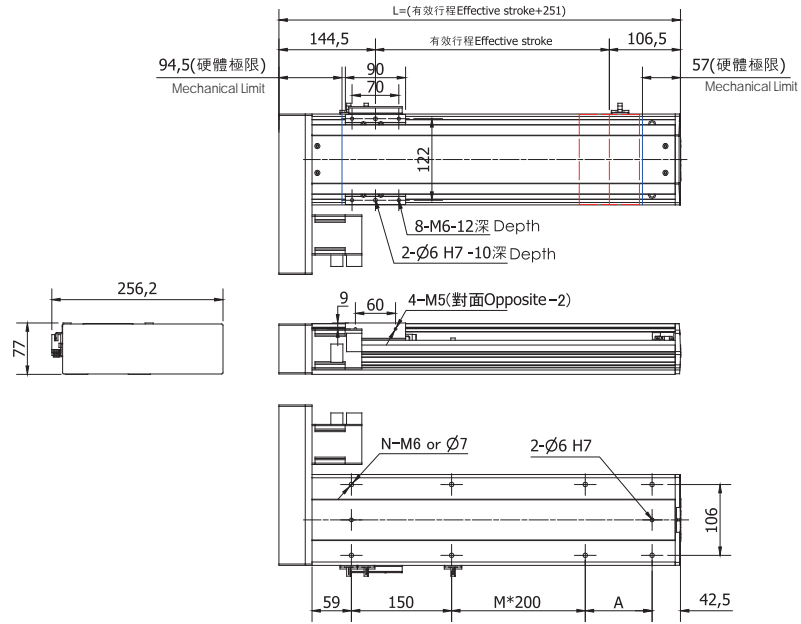

行程 Stroke	100	150	200	250	300	350	400	450	500	550	600	650	700	750	800	850	900	950	1000	1050
L	351	401	451	501	551	601	651	701	751	801	851	901	951	1001	1051	1102	1151	1202	1251	1301
A	50	100	150	200	50	100	150	200	50	100	150	200	50	100	150	200	50	100	150	200
M	0	0	0	0	1	1	1	1	2	2	2	2	3	3	3	3	4	4	4	4
N	6	6	6	6	8	8	8	8	10	10	10	10	12	12	12	12	14	14	14	14
重量(kg)	7.8	8.3	8.8	9.3	9.8	10.3	10.8	11.3	11.8	12.3	12.8	13.3	13.8	14.3	14.8	15.3	15.8	16.3	16.8	17.3

※本公司享有變更規格之權益，恕不另行通知 ※Drawings and specifications are subject to change without prior notice.

M4

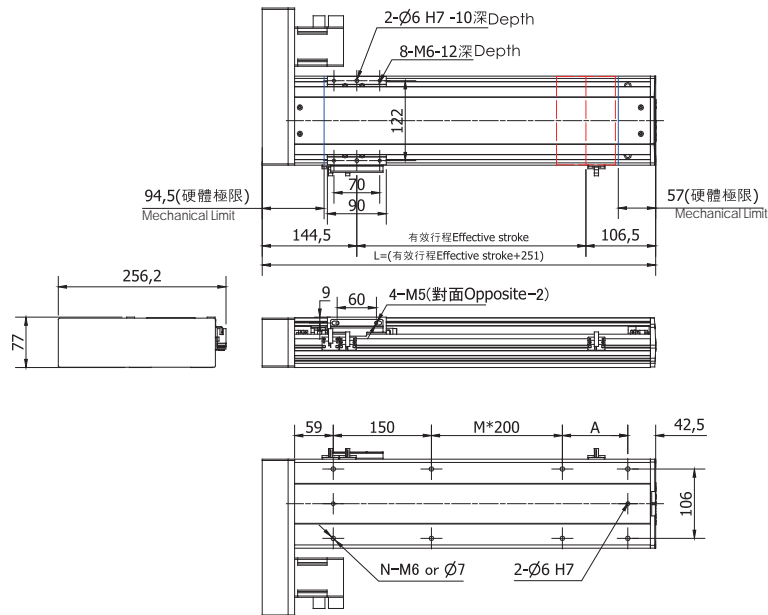

行程 Stroke	100	150	200	250	300	350	400	450	500	550	600	650	700	750	800	850	900	950	1000	1050
L	351	401	451	501	551	601	651	701	751	801	851	901	951	1001	1051	1102	1151	1202	1251	1301
A	50	100	150	200	50	100	150	200	50	100	150	200	50	100	150	200	50	100	150	200
M	0	0	0	0	1	1	1	1	2	2	2	2	3	3	3	3	4	4	4	4
N	6	6	6	6	8	8	8	8	10	10	10	10	12	12	12	12	14	14	14	14
重量(kg)	7.8	8.3	8.8	9.3	9.8	10.3	10.8	11.3	11.8	12.3	12.8	13.3	13.8	14.3	14.8	15.3	15.8	16.3	16.8	17.3

※本公司享有變更規格之權益，恕不另行通知 ※Drawings and specifications are subject to change without prior notice.

M5

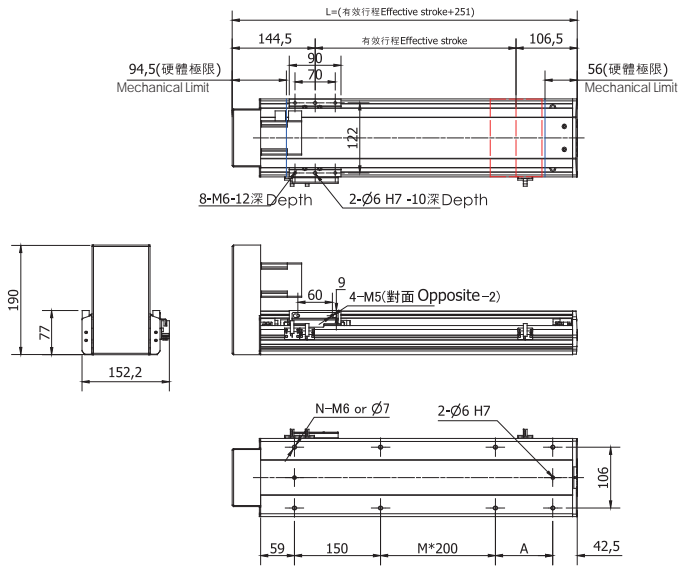

行程 Stroke	100	150	200	250	300	350	400	450	500	550	600	650	700	750	800	850	900	950	1000	1050
L	351	401	451	501	551	601	651	701	751	801	851	901	951	1001	1051	1102	1151	1202	1251	1301
A	50	100	150	200	50	100	150	200	50	100	150	200	50	100	150	200	50	100	150	200
M	0	0	0	0	1	1	1	1	2	2	2	2	3	3	3	3	4	4	4	4
N	6	6	6	6	8	8	8	8	10	10	10	10	12	12	12	12	14	14	14	14
重量(kg)	7.8	8.3	8.8	9.3	9.8	10.3	10.8	11.3	11.8	12.3	12.8	13.3	13.8	14.3	14.8	15.3	15.8	16.3	16.8	17.3

※本公司享有變更規格之權益，恕不另行通知 ※Drawings and specifications are subject to change without prior notice.

M6

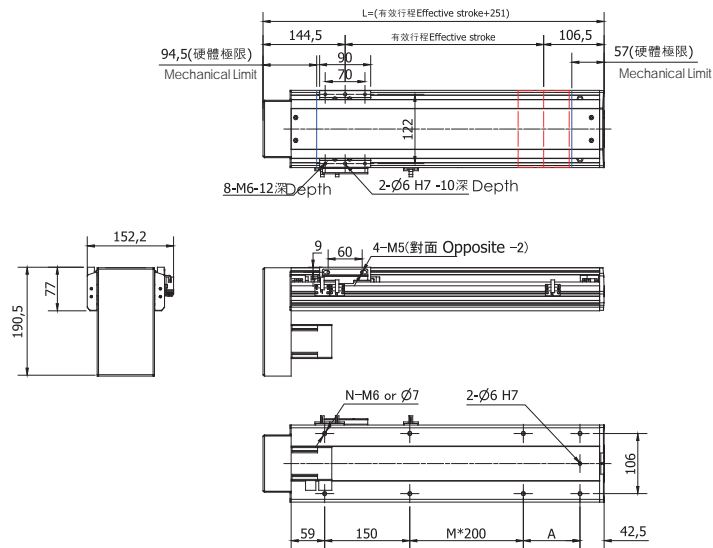

行程 Stroke	100	150	200	250	300	350	400	450	500	550	600	650	700	750	800	850	900	950	1000	1050
L	351	401	451	501	551	601	651	701	751	801	851	901	951	1001	1051	1102	1151	1202	1251	1301
A	50	100	150	200	50	100	150	200	50	100	150	200	50	100	150	200	50	100	150	200
M	0	0	0	0	1	1	1	1	2	2	2	2	3	3	3	3	4	4	4	4
N	6	6	6	6	8	8	8	8	10	10	10	10	12	12	12	12	14	14	14	14
重量(kg)	7.8	8.3	8.8	9.3	9.8	10.3	10.8	11.3	11.8	12.3	12.8	13.3	13.8	14.3	14.8	15.3	15.8	16.3	16.8	17.3

※本公司享有變更規格之權益，恕不另行通知 ※Drawings and specifications are subject to change without prior notice.