

# CB136D - YL40 - S3050 - B1 - M 200W - B

型號  
Model

孔型與每轉移動量  
Hole type and movement per revolution

行程  
Stroke

馬達方向  
Motor direction

馬達廠牌及出力  
Motor brand and output

煞車  
Brake

Y 底部牙孔  
Thread hole

馬達方向 Motor direction

B1 馬達左折上端 Motor leftward,upper position  
B2 馬達右折上端 Motor rightward,upper position  
B3 馬達左折水平 Motor leftward,horizontal position  
B4 馬達右折水平 Motor rightward,horizontal position  
B5 馬達左折下端 Motor leftward,lower position  
B6 馬達右折下端 Motor rightward,lower position

馬達廠牌及出力 Motor brand and output

H 上銀 Hiwin  
X 西門子 Siemens  
M 三菱 Mitsubishi  
Y 安川 Yaskawa  
P 松下 Panasonic  
F 富士 Fuji  
T 台達 Delta

## CB136D規格表(CB136D Specification):

馬達出力 AC Servo motor output(W)	200W
重覆定位精度 Repeatability(mm)	±0.04
每轉移動量 Equivalent to lead(mm)	39.9291
最大載重 Maximun payload(kg)	32
最快速度 Maximun speed(mm/sec)	2000
行程 Stroke(mm)	150~3050 100間隔 (interval)

## 線性滑軌15x12.5-2支(Linear Guide15x12.5-2 )

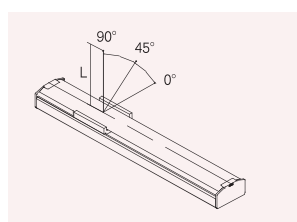

水平安裝應用(單位:mm) Horizontal use				
	90°	45°	0°	
5kg	2629	1279	1150	
10kg	1559	719	712	
20kg	1209	475	434	
32kg	766	310	288	

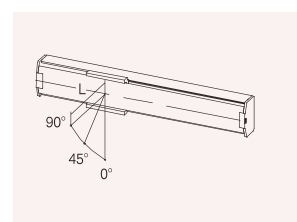

牆面安裝應用(單位:mm) Wall installation use				
	90°	45°	0°	
5kg	1365	1219	2339	
10kg	699	649	1319	
20kg	379	385	935	
30kg	199	220	600	

\*滑塊表面中心到搬送物重心的距離(僅供參考)  
Distance center of slider top to center of gravity of object being transported (For reference only)

靜態容許負載慣量  
Static Loading Moment

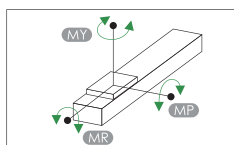

(單位:N.m) (Unit:N.m)  
水平使用時 Static Loading Moment

MY	551
MP	552
MR	485

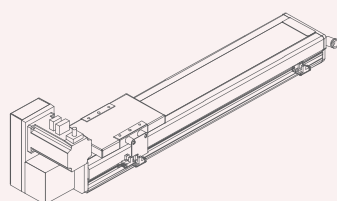

B1

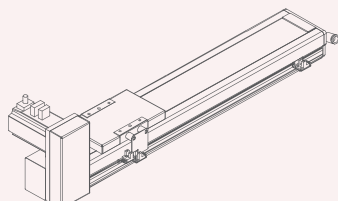

B2

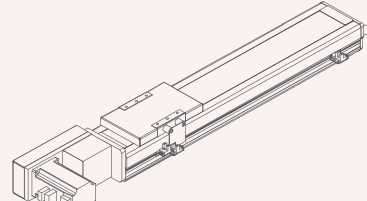

B3

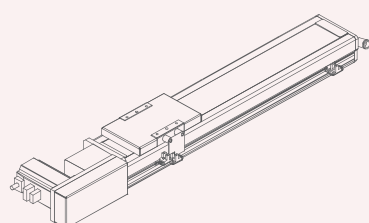

B4

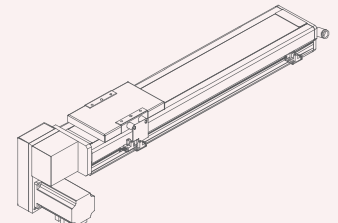

B5

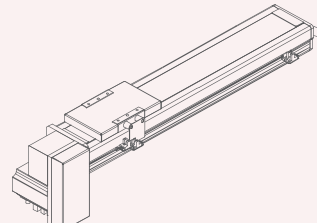

B6

## B1

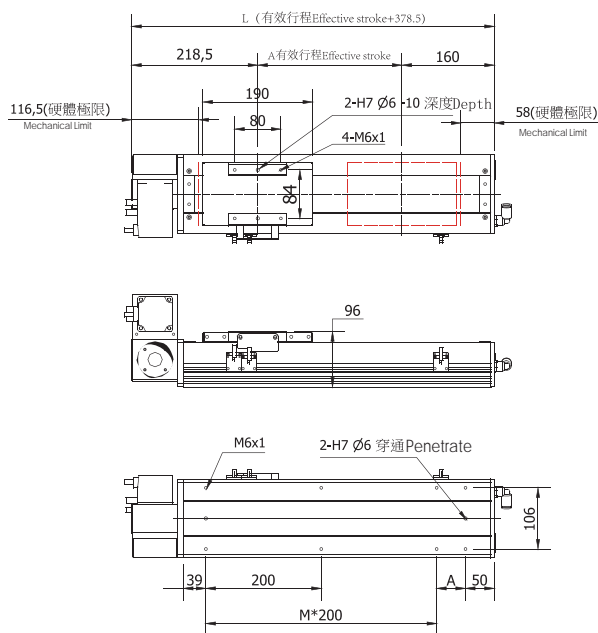
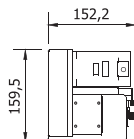

行程 Stroke	150	250	350	450	550	650	750	850	950	1050	1150	1250	1350	1450	1550	1650	1750	1850	1950	2050	2150	2250	2350	2450	2550	2650	2750	2850	2950	3050				
L	428.5	528.5	628.5	728.5	828.5	928.5	1028.5	1128.5	1228.5	1328.5	1428.5	1528.5	1628.5	1728.5	1828.5	1928.5	2028.5	2128.5	2228.5	2328.5	2428.5	2528.5	2628.5	2728.5	2828.5	2928.5	3028.5	3128.5	3228.5	3328.5	3428.5	3528.5	3628.5	3728.5
A	150	50	150	50	150	50	150	50	150	50	150	50	150	50	150	50	150	50	150	50	150	50	150	50	150	50	150	50	150	50	150	50	150	50
M	1	2	2	3	3	4	4	5	5	6	6	7	7	8	8	9	9	10	10	11	11	12	12	13	13	14	14	15	15	16	16	17	17	
N	6	8	8	10	10	12	12	14	14	16	16	18	18	20	20	22	22	24	24	26	26	28	28	30	30	32	32	34	34	36	36	38	38	
重量(kg)	9.0	10.0	11.0	12.0	13.0	14.0	15.0	16.0	17.0	18.0	19.0	20.0	21.0	22.0	23.0	24.0	25.0	26.0	27.0	28.0	29.0	30.0	31.0	32.0	33.0	34.0	35.0	36.0	37.0	38.0	39.0	40.0		

※本公司享有變更規格之權益，恕不另行通知 ※Drawings and specifications are subject to change without prior notice.

## B2

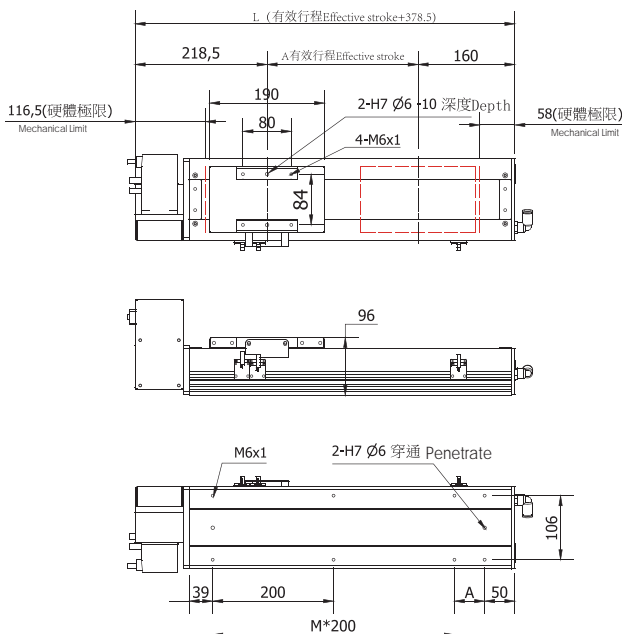
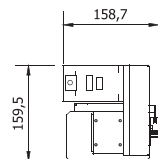

行程 Stroke	150	250	350	450	550	650	750	850	950	1050	1150	1250	1350	1450	1550	1650	1750	1850	1950	2050	2150	2250	2350	2450	2550	2650	2750	2850	2950	3050		
L	428.5	528.5	628.5	728.5	828.5	928.5	1028.5	1128.5	1228.5	1328.5	1428.5	1528.5	1628.5	1728.5	1828.5	1928.5	2128.5	2228.5	2328.5	2428.5	2528.5	2628.5	2728.5	3028.5	3128.5	3228.5	3328.5	3428.5	3528.5	3628.5	3728.5	
A	150	50	150	50	150	50	150	50	150	50	150	50	150	50	150	50	150	50	150	50	150	50	150	50	150	50	150	50	150	50	150	50
M	1	2	2	3	3	4	4	5	5	6	6	7	7	8	8	9	9	10	10	11	11	12	12	13	13	14	14	15	15	16		
N	6	8	8	10	10	12	12	14	14	16	16	18	18	20	20	22	22	24	24	26	26	28	28	30	30	32	32	34	34	36		
重量(kg)	9.0	10.0	11.0	12.0	13.0	14.0	15.0	16.0	17.0	18.0	19.0	20.0	21.0	22.0	23.0	24.0	25.0	26.0	27.0	28.0	29.0	30.0	31.0	32.0	33.0	34.0	35.0	36.0	37.0	38.0		

※本公司享有變更規格之權益，恕不另行通知 ※Drawings and specifications are subject to change without prior notice.

# B3

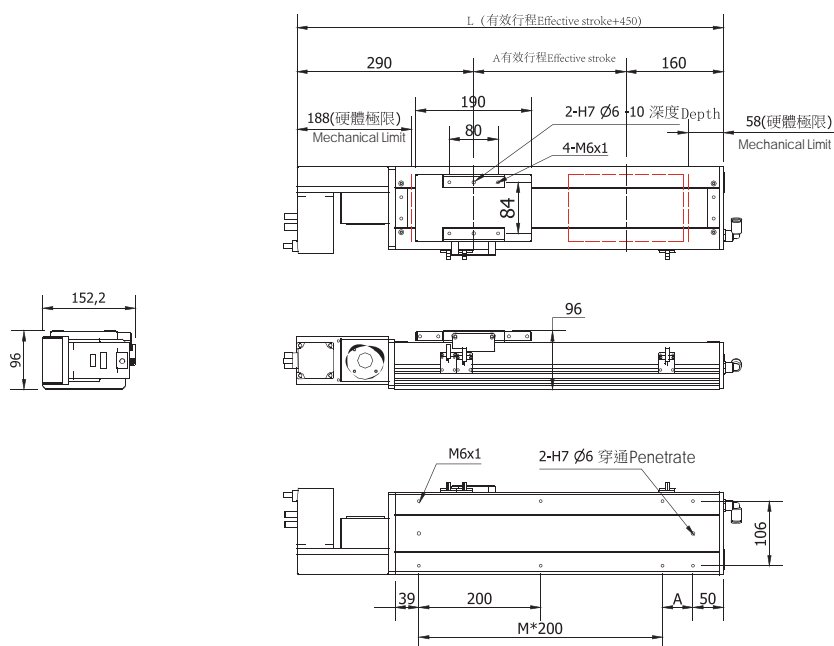

行程 Stroke	150	250	350	450	550	650	750	850	950	1050	1150	1250	1350	1450	1550	1650	1750	1850	1950	2050	2150	2250	2350	2450	2550	2650	2750	2850	2950	3050
L	600	700	800	900	1000	1100	1200	1300	1400	1500	1600	1700	1800	1900	2000	2100	2200	2300	2400	2500	2600	2700	2800	2900	3000	3100	3200	3300	3400	3500
A	150	50	150	50	150	50	150	50	150	50	150	50	150	50	150	50	150	50	150	50	150	50	150	50	150	50	150	50	150	50
M	1	2	2	3	3	4	4	5	5	6	6	7	7	8	8	9	9	10	10	11	11	12	12	13	13	14	14	15	15	16
N	6	8	8	10	10	12	12	14	14	16	16	18	18	20	20	22	22	24	24	26	26	28	28	30	30	32	32	34	34	36
重量(kg)	9.0	10.0	11.0	12.0	13.0	14.0	15.0	16.0	17.0	18.0	19.0	20.0	21.0	22.0	23.0	24.0	25.0	26.0	27.0	28.0	29.0	30.0	31.0	32.0	33.0	34.0	35.0	36.0	37.0	38.0

※本公司享有變更規格之權益，恕不另行通知 ※Drawings and specifications are subject to change without prior notice.

# B4

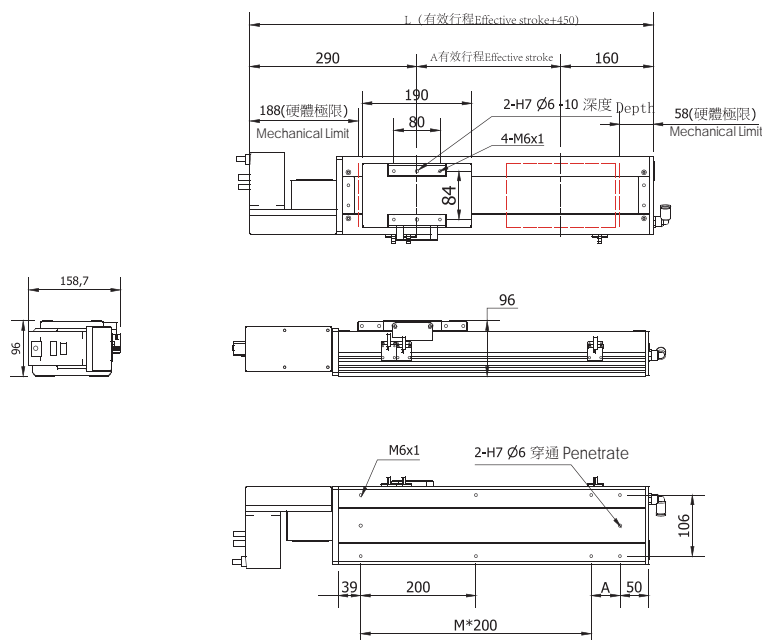

行程 Stroke	150	250	350	450	550	650	750	850	950	1050	1150	1250	1350	1450	1550	1650	1750	1850	1950	2050	2150	2250	2350	2450	2550	2650	2750	2850	2950	3050
L	600	700	800	900	1000	1100	1200	1300	1400	1500	1600	1700	1800	1900	2000	2100	2200	2300	2400	2500	2600	2700	2800	2900	3000	3100	3200	3300	3400	3500
A	150	50	150	50	150	50	150	50	150	50	150	50	150	50	150	50	150	50	150	50	150	50	150	50	150	50	150	50	150	50
M	1	2	2	3	3	4	4	5	5	6	6	7	7	8	8	9	9	10	10	11	11	12	12	13	13	14	14	15	15	16
N	6	8	8	10	10	12	12	14	14	16	16	18	18	20	20	22	22	24	24	26	26	28	28	30	30	32	32	34	34	36
重量(kg)	9.0	10.0	11.0	12.0	13.0	14.0	15.0	16.0	17.0	18.0	19.0	20.0	21.0	22.0	23.0	24.0	25.0	26.0	27.0	28.0	29.0	30.0	31.0	32.0	33.0	34.0	35.0	36.0	37.0	38.0

※本公司享有變更規格之權益，恕不另行通知 ※Drawings and specifications are subject to change without prior notice.

## B5

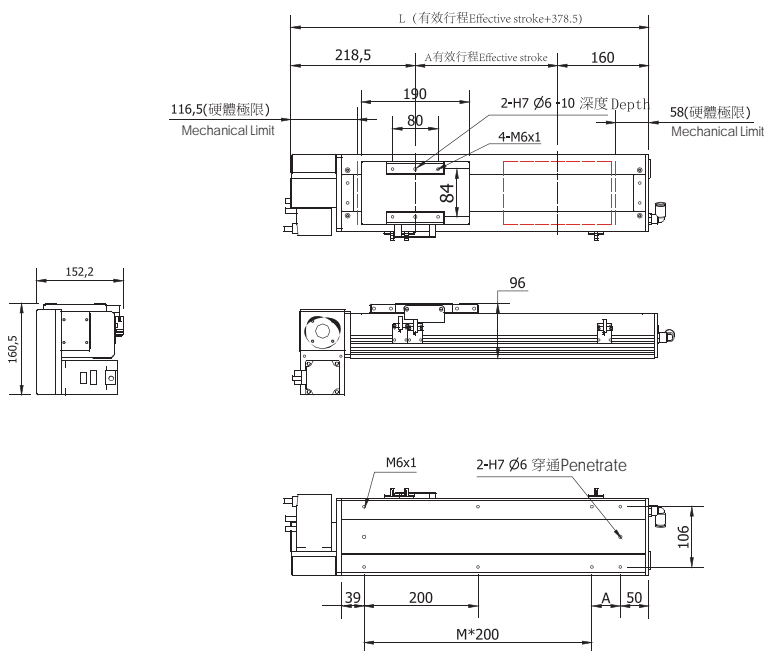

行程 Stroke	150	250	350	450	550	650	750	850	950	1050	1150	1250	1350	1450	1550	1650	1750	1850	1950	2050	2150	2250	2350	2450	2550	2650	2750	2850	2950	3050
L	528.5	628.5	728.5	828.5	928.5	1028.5	1128.5	1228.5	1428.5	1528.5	1628.5	1728.5	1828.5	1928.5	2028.5	2228.5	2328.5	2428.5	2528.5	2628.5	2728.5	2928.5	3128.5	3228.5	3328.5	3428.5	3528.5	3628.5	3728.5	3828.5
A	150	50	150	50	150	50	150	50	150	50	150	50	150	50	150	50	150	50	150	50	150	50	150	50	150	50	150	50	150	50
M	1	2	2	3	3	4	4	5	5	6	6	7	7	8	8	9	9	10	10	11	11	12	12	13	13	14	14	15	15	16
N	6	8	8	10	10	12	12	14	14	16	16	18	18	20	20	22	22	24	24	26	26	28	28	30	30	32	32	34	34	36
重量(kg)	9.0	10.0	11.0	12.0	13.0	14.0	15.0	16.0	17.0	18.0	19.0	20.0	21.0	22.0	23.0	24.0	25.0	26.0	27.0	28.0	29.0	30.0	31.0	32.0	33.0	34.0	35.0	36.0	37.0	38.0

※本公司享有變更規格之權益，恕不另行通知 ※Drawings and specifications are subject to change without prior notice.

## B6

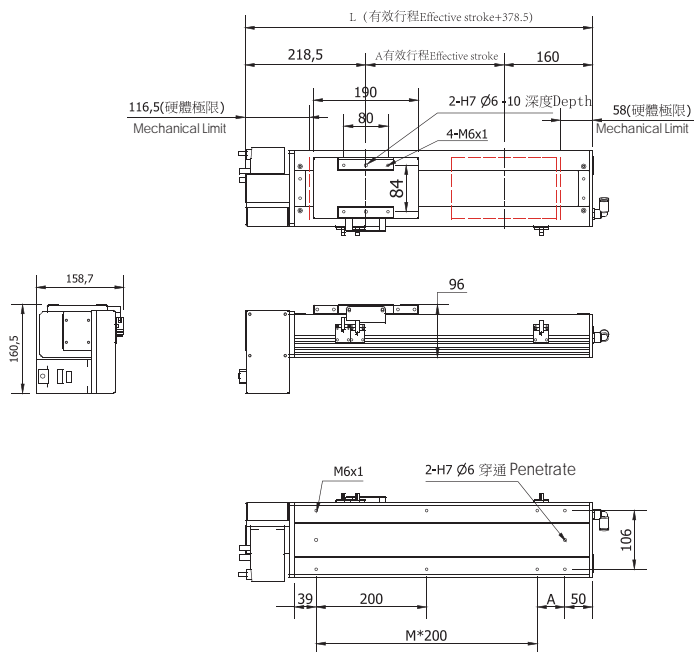

行程 Stroke	150	250	350	450	550	650	750	850	950	1050	1150	1250	1350	1450	1550	1650	1750	1850	1950	2050	2150	2250	2350	2450	2550	2650	2750	2850	2950	3050
L	528.5	628.5	728.5	828.5	928.5	1028.5	1128.5	1228.5	1428.5	1528.5	1628.5	1728.5	1828.5	1928.5	2028.5	2228.5	2328.5	2428.5	2528.5	2628.5	2728.5	2928.5	3128.5	3228.5	3328.5	3428.5	3528.5	3628.5	3728.5	3828.5
A	150	50	150	50	150	50	150	50	150	50	150	50	150	50	150	50	150	50	150	50	150	50	150	50	150	50	150	50	150	50
M	1	2	2	3	3	4	4	5	5	6	6	7	7	8	8	9	9	10	10	11	11	12	12	13	13	14	14	15	15	16
N	6	8	8	10	10	12	12	14	14	16	16	18	18	20	20	22	22	24	24	26	26	28	28	30	30	32	32	34	34	36
重量(kg)	9.0	10.0	11.0	12.0	13.0	14.0	15.0	16.0	17.0	18.0	19.0	20.0	21.0	22.0	23.0	24.0	25.0	26.0	27.0	28.0	29.0	30.0	31.0	32.0	33.0	34.0	35.0	36.0	37.0	38.0

※本公司享有變更規格之權益，恕不另行通知 ※Drawings and specifications are subject to change without prior notice.