

## SC80 - AL05 - S100 - M2 - M1000W - B

型號  
Model

安裝方法和導程  
Installation method and Lead

行程  
Stroke

馬達方向  
Motor direction

馬達廠牌及出力  
Motor brand and output

煞車  
Brake

- A. 電動缸本體打孔安裝  
Make thread hole in actuator's body  
B. 電動缸槽口安裝  
install in actuator's slot  
C. 電動缸上端部孔位安裝  
install in actuator's side thread hole  
D. 電動缸底部安裝  
install in bottom of actuator  
E. 電動缸滑塊安裝  
use bracket to install

電動缸安裝方式,可選擇多種安裝方式詳細安裝圖面請見366頁碼  
can choose multiple methods of actuator installation, see page.366

- 馬達方向 Motor direction  
M2 馬達外置 Motor outboard  
M0 馬達側置 Motor side

- 馬達廠牌及出力  
Motor brand and output  
S 山洋 Sanyo  
M 三菱 Mitsubishi  
Y 安川 Yaskawa  
P 松下 Panasonic  
F 富士 Fuji  
T 台達 Delta

### SC80 規格表(SC80 Specification):

馬達出力 AC SERVO MOTOR OUTPUT(W)	1000W (低慣量 Low inertia)		
額定扭矩 Rated torque (N)	3.18		
重複定位精度 Repeat positioning accuracy(mm)	±0.01		
活塞桿旋轉角度 Angle of rotation of the piston rod	±0.3°		
螺桿規格 Screw specifications	2505	2510	2525
最快速度 Fastest speed (mm/s)	250	500	1250
最大軸向推力 Maximum axial thrust (N)	3195N	1597N	639N
行程 Stroke (mm)	50-750		

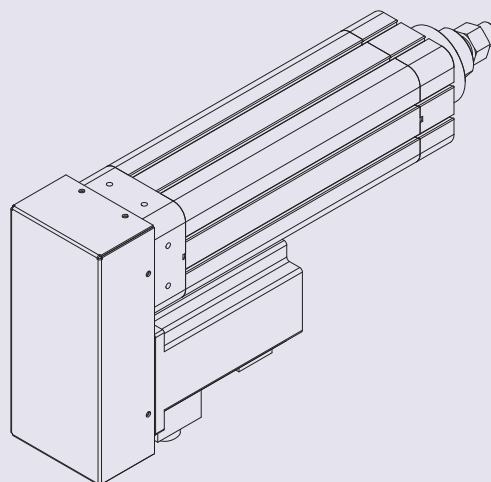
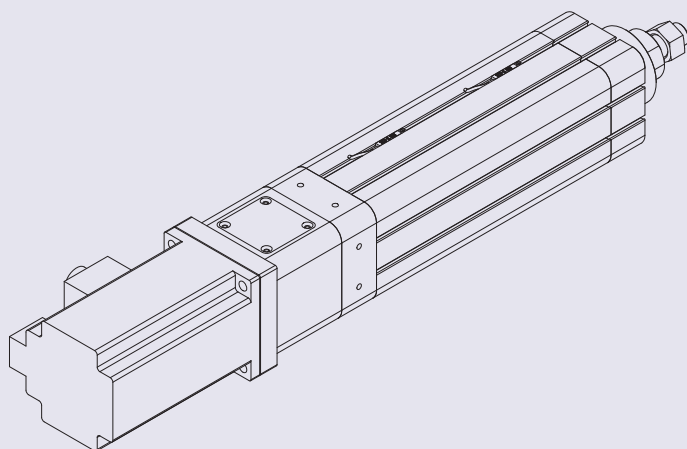

M2

M0

# M2

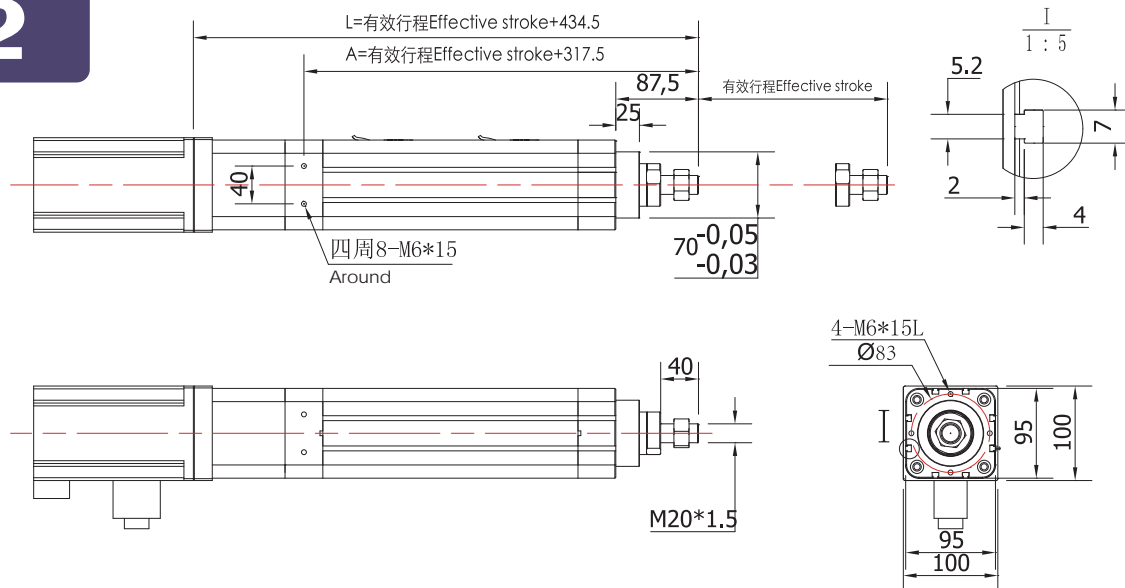

行程 Stroke	50	100	150	200	250	300	350	400	450	500	550	600	650	700	750
L	484.5	534.5	584.5	634.5	684.5	734.5	784.5	834.5	884.5	934.5	984.5	1034.5	1084.5	1134.5	1184.5
A	367.5	417.5	467.5	517.5	567.5	617.5	667.5	717.5	767.5	817.5	867.5	917.5	967.5	1017.5	1067.5
重量 Weight (kg)	13.8	14.8	15.8	16.8	17.8	18.8	19.8	20.8	21.8	22.8	23.8	24.8	25.8	26.8	27.8

※本公司享有變更規格之權益，恕不另行通知 ※Drawings and specifications are subject to change without prior notice.

# M0

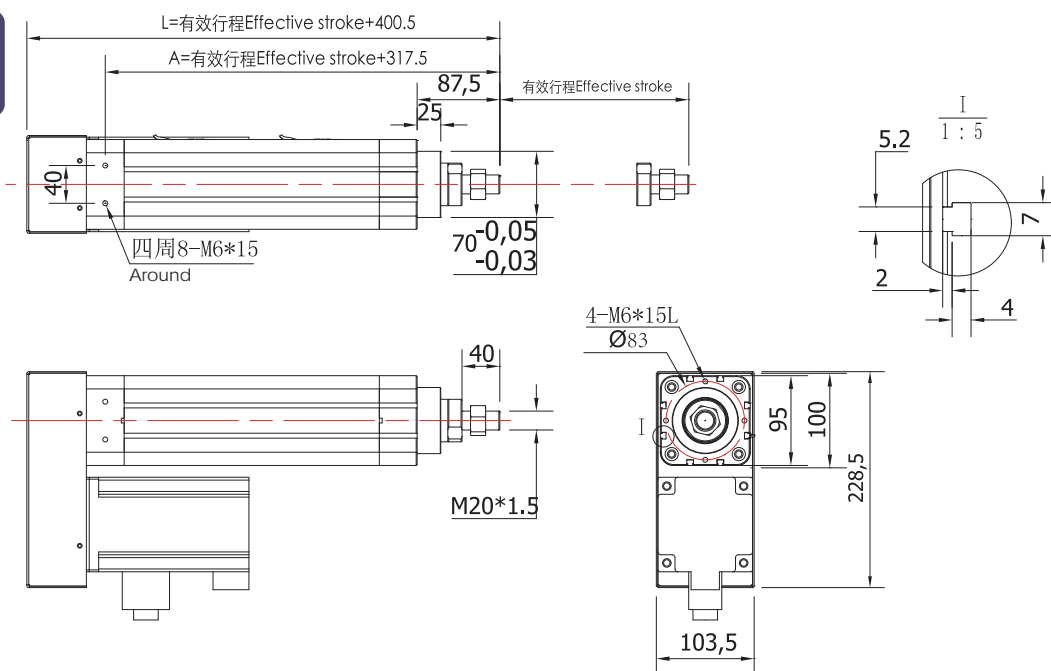

行程 Stroke	50	100	150	200	250	300	350	400	450	500	550	600	650	700	750
L	450.5	500.5	550.5	600.5	650.5	700.5	750.5	800.5	850.5	900.5	950.5	1000.5	1050.5	1100.5	1150.5
A	367.5	417.5	467.5	517.5	567.5	617.5	667.5	717.5	767.5	817.5	867.5	917.5	967.5	1017.5	1067.5
重量 Weight (kg)	14.5	15.5	16.5	17.5	18.5	19.5	20.5	21.5	22.5	23.5	24.5	25.5	26.5	27.5	28.5

※本公司享有變更規格之權益，恕不另行通知 ※Drawings and specifications are subject to change without prior notice.

## SC80L - AL05 - S100 - M2 - M1000W - B

型號  
Model

安裝方法和導程  
Installation method and Lead

行程  
Stroke

馬達方向  
Motor direction

馬達廠牌及出力  
Motor brand and output

煞車  
Brake

A. 電動缸本體打孔安裝  
Make thread hole in actuator's body

B. 電動缸槽口安裝  
install in actuator's slot

C. 電動缸上端部孔位安裝  
install in actuator's side thread hole

電動缸安裝方式, 可選擇多種安裝方式詳細安裝圖面請見366頁碼  
can choose multiple methods of actuator installation, see page: 366

馬達方向 Motor direction  
M2 馬達外置 Motor outboard  
M0 馬達側置 Motor side

馬達廠牌及出力  
Motor brand and output  
S 山洋 Sanyo  
M 三菱 Mitsubishi  
Y 安川 Yaskawa  
P 松下 Panasonic  
F 富士 Fuji  
T 台達 Delta

### SC80L 規格表(SC80L Specification):

馬達出力 AC SERVO MOTOR OUTPUT(W)	1000W (低慣量 Low inertia)		
額定扭矩 Rated torque (N)	3.18		
重複定位精度 Repeat positioning accuracy(mm)	±0.01		
活塞桿旋轉角度 Angle of rotation of the piston rod	±0.3°		
螺桿規格 Screw specifications	2505	2510	2525
最快速度 Fastest speed (mm/s)	250	500	1250
最大軸向推力 Maximum axial thrust (N)	3195N	1597N	639N
行程 Stroke (mm)	50-750		

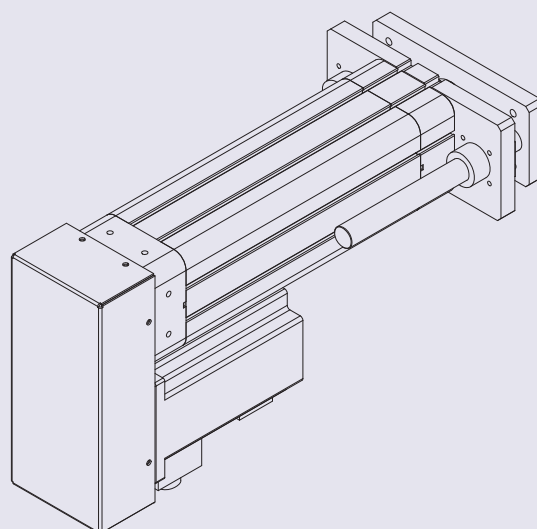
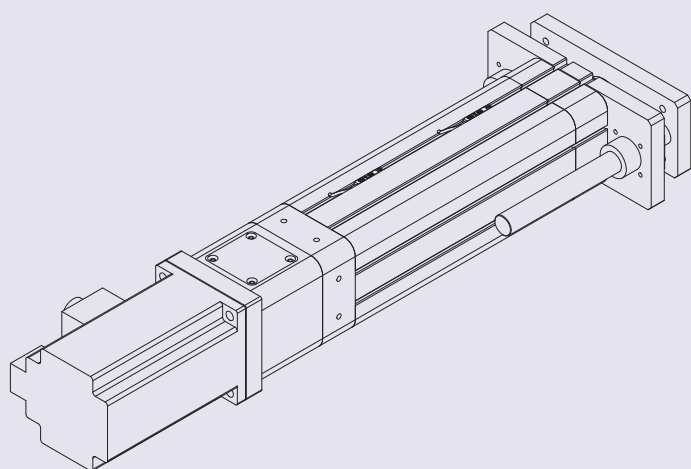

M2

M0

## M2

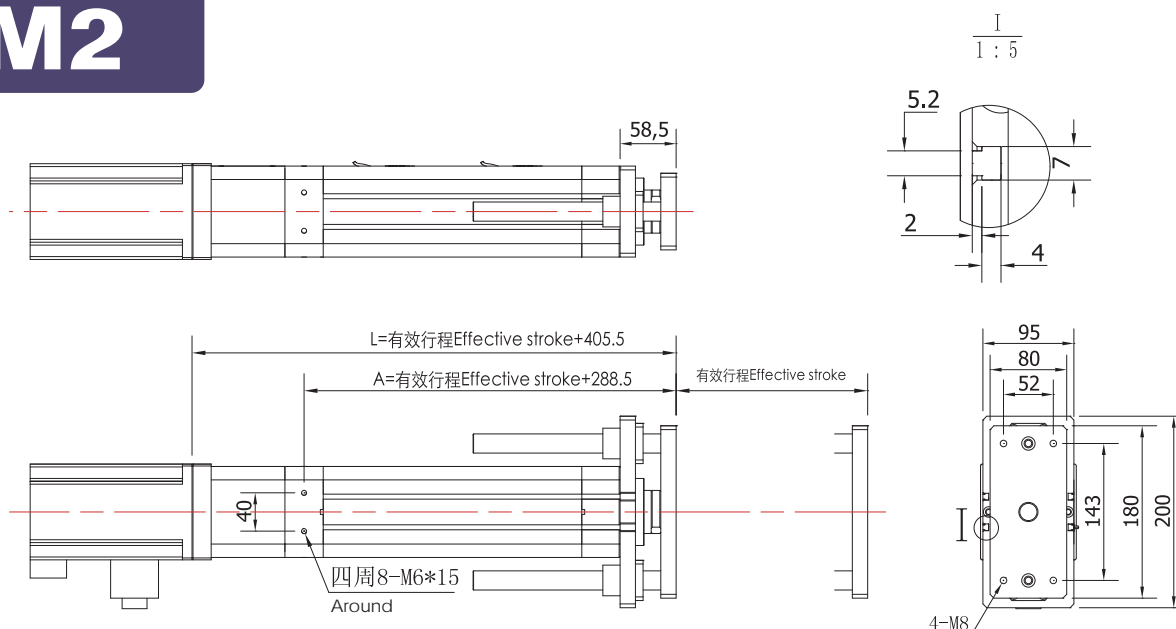

行程 Stroke	50	100	150	200	250	300	350	400	450	500	550	600	650	700	750
L	455.5	505.5	555.5	605.5	655.5	705.5	755.5	805.5	855.5	905.5	955.5	1005.5	1055.5	1105.5	1155.5
A	338.5	388.5	438.5	488.5	538.5	588.5	638.5	688.5	738.5	788.5	838.5	888.5	938.5	988.5	1038.5
重量 Weight (kg)	16.3	17.6	18.9	20.2	21.5	22.8	24.1	25.4	26.7	28	29.3	30.6	31.9	33.2	34.5

※本公司享有變更規格之權益，恕不另行通知 ※Drawings and specifications are subject to change without prior notice.

## M0

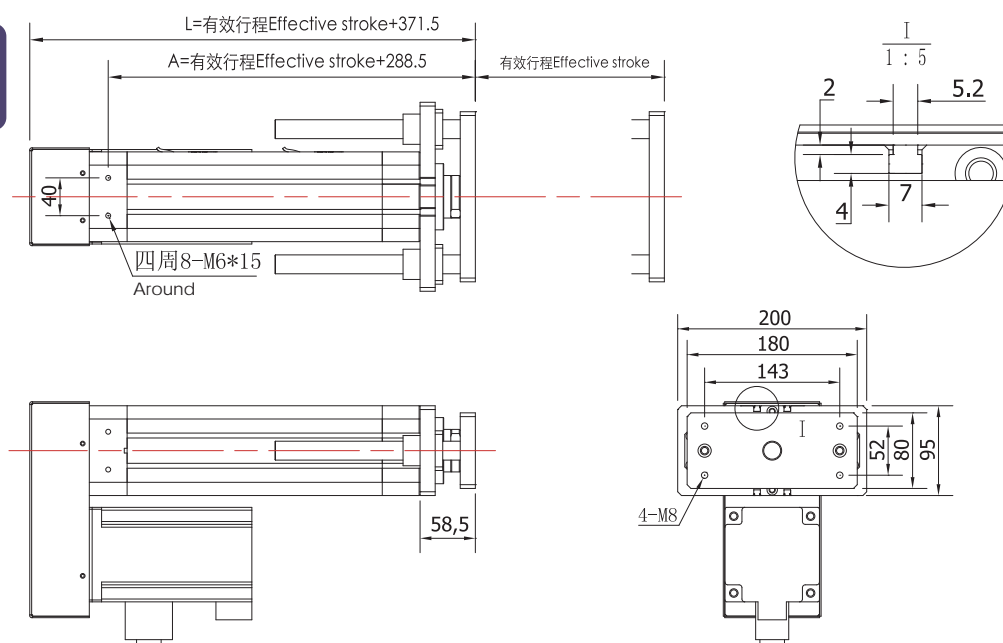

行程 Stroke	50	100	150	200	250	300	350	400	450	500	550	600	650	700	750
L	421.5	471.5	521.5	571.5	621.5	671.5	721.5	771.5	821.5	871.5	921.5	971.5	1021.5	1071.5	1121.5
A	338.5	388.5	438.5	488.5	538.5	588.5	638.5	688.5	738.5	788.5	838.5	888.5	938.5	988.5	1038.5
重量 Weight (kg)	17	18.3	19.6	20.9	22.2	23.5	24.8	26.1	27.4	28.7	30	31.3	32.6	33.9	35.2

※本公司享有變更規格之權益，恕不另行通知 ※Drawings and specifications are subject to change without prior notice.

## SC80Z - AL05 - S100 - M2 - M1000W - B

型號  
Model

安裝方法和導程  
Installation method and Lead

行程  
Stroke

馬達方向  
Motor direction

馬達廠牌及出力  
Motor brand and output

煞車  
Brake

A. 電動缸本體打孔安裝  
Make thread hole in actuator's body  
B. 電動缸槽口安裝  
install in actuator's slot  
C. 電動缸上端部孔位安裝  
install in actuator's side thread hole  
E. 電動缸滑塊安裝  
use bracket to install

電動缸安裝方式, 可選擇多種安裝方式詳細安裝圖面請見366頁碼  
can choose multiple methods of actuator installation, see page. 366

馬達方向 Motor direction  
M2 馬達外置 Motor outboard  
M0 馬達側置 Motor side

馬達廠牌及出力  
Motor brand and output  
S 山洋 Sanyo  
M 三菱 Mitsubishi  
Y 安川 Yaskawa  
P 松下 Panasonic  
F 富士 Fuji  
T 台達 Delta

### SC80Z規格表(SC80Z Specification):

馬達出力 AC SERVO MOTOR OUTPUT(W)	1000W (低慣量 Low inertia)		
額定扭矩 Rated torque (N)	3.18		
重複定位精度 Repeat positioning accuracy(mm)	±0.01		
活塞桿旋轉角度 Angle of rotation of the piston rod	±0.3°		
螺桿規格 Screw specifications	2505	2510	2525
最快速度 Fastest speed (mm/s)	250	500	1250
最大軸向推力 Maximum axial thrust (N)	3195N	1597N	639N
行程 Stroke (mm)	50-750		

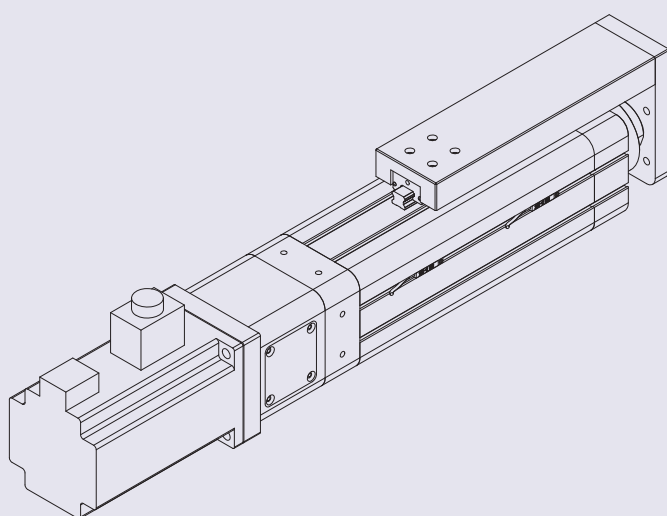

M2

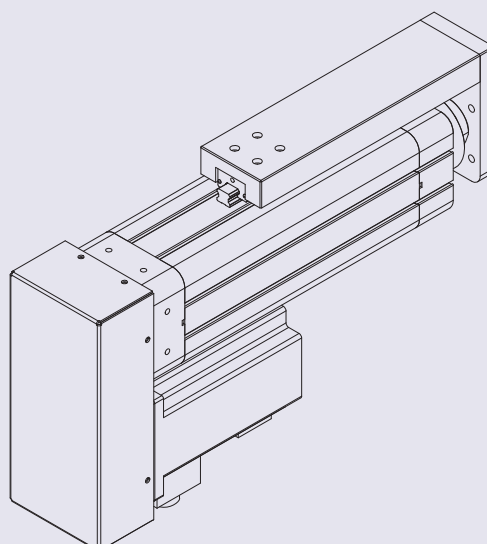

M0

## M2

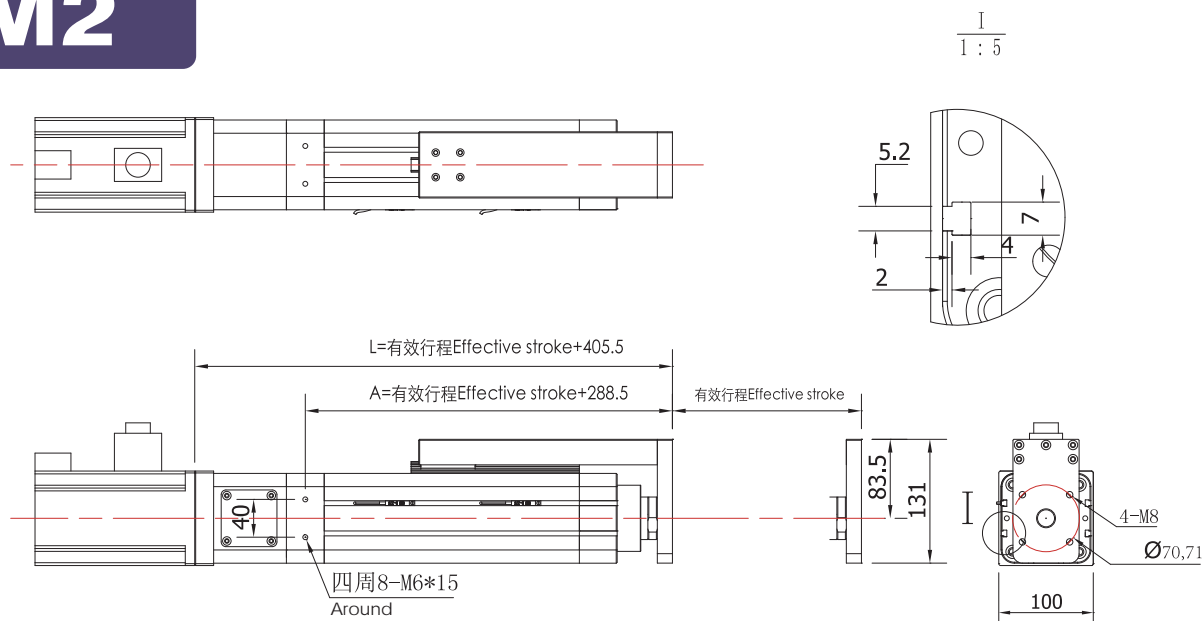

行程 Stroke	50	100	150	200	250	300	350	400	450	500	550	600	650	700	750
L	455.5	505.5	555.5	605.5	655.5	705.5	755.5	805.5	855.5	905.5	955.5	1005.5	1055.5	1105.5	1155.5
A	338.5	388.5	438.5	488.5	538.5	588.5	638.5	688.5	738.5	788.5	838.5	888.5	938.5	988.5	1038.5
重量 Weight (kg)	15.5	16.8	18.1	19.4	20.7	22	23.3	24.6	25.9	27.2	28.5	29.8	31.1	32.4	33.7

※本公司享有變更規格之權益，恕不另行通知 ※Drawings and specifications are subject to change without prior notice.

## M0

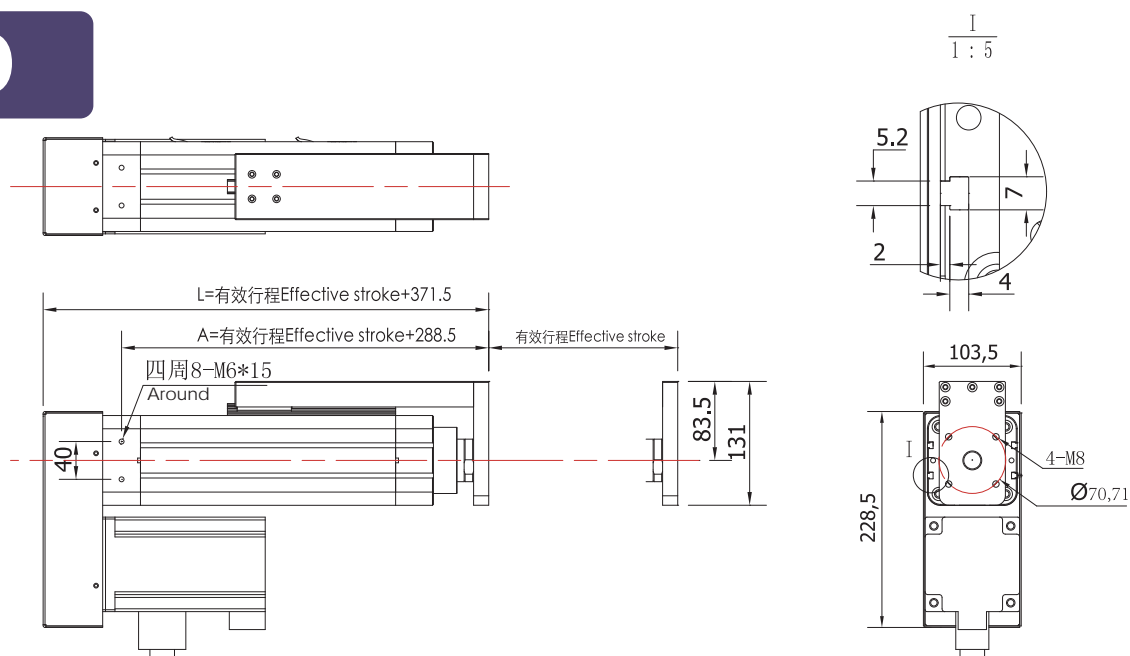

行程 Stroke	50	100	150	200	250	300	350	400	450	500	550	600	650	700	750
L	421.5	471.5	521.5	571.5	621.5	671.5	721.5	771.5	821.5	871.5	921.5	971.5	1021.5	1071.5	1121.5
A	338.5	388.5	438.5	488.5	538.5	588.5	638.5	688.5	738.5	788.5	838.5	888.5	938.5	988.5	1038.5
重量 Weight (kg)	16.2	17.5	18.8	20.1	21.4	22.7	24	25.3	26.6	27.9	29.2	30.5	31.8	33.1	34.4

※本公司享有變更規格之權益，恕不另行通知 ※Drawings and specifications are subject to change without prior notice.