

152 Bottle Black Metal Lattice Assembly Manual

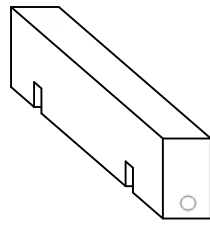

(2) Top connectors

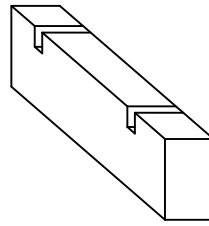

(3) Bottom connectors

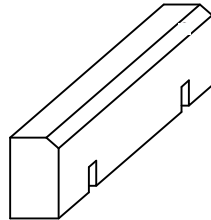

(2) Left connectors

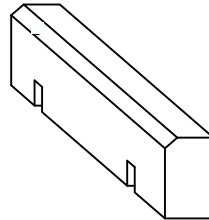

(2) Right connectors

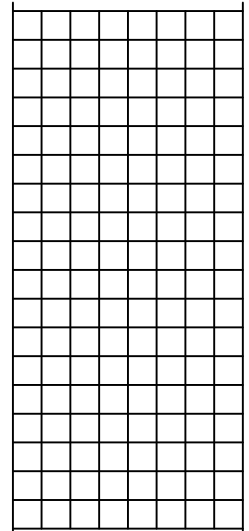

(2) metal lattice grids



(6) drywall anchors



(6) 1" corner brackets



(6) 1" - #8 screws



(6) 5/8" - #6 screws



(2) pin nails

Step 1

Use 5/8" - #6 screws to attach angle brackets

It is recommended to predrill holes with a 3/32" or 1/8" drill bit to avoid splitting

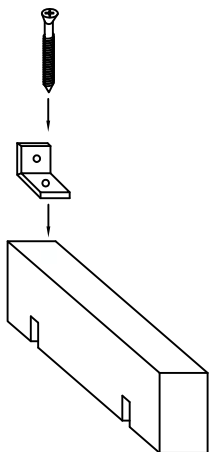

(2) top connectors

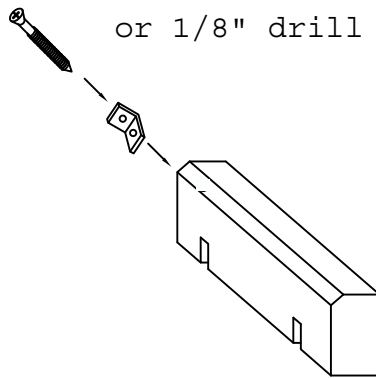

(2) right connectors

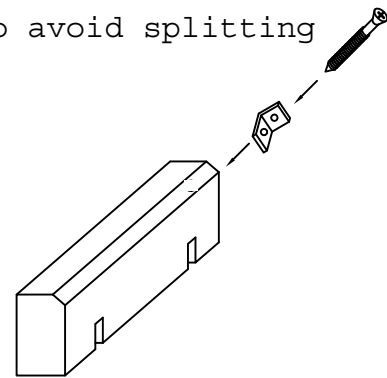

(2) left connectors

Step 2

Place (3) bottom connectors on floor.

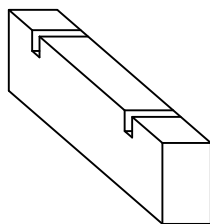
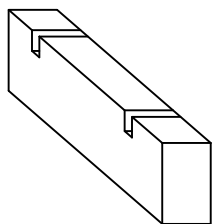
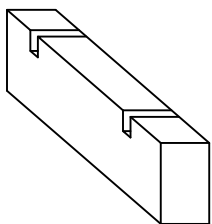

WALL

Place 3/4" off the wall without base.

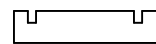

WALL

Place right up against wall with a base.

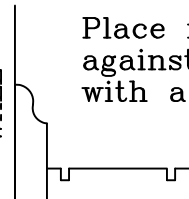

Step 3

Insert grids into bottom connector with horizontal bars facing as shown.

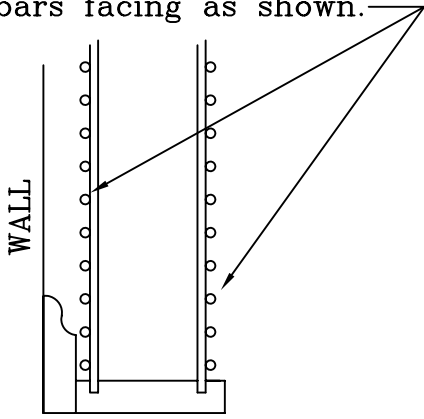

Step 4

Attach the top connectors; make sure they are placed at the most extreme left and right.

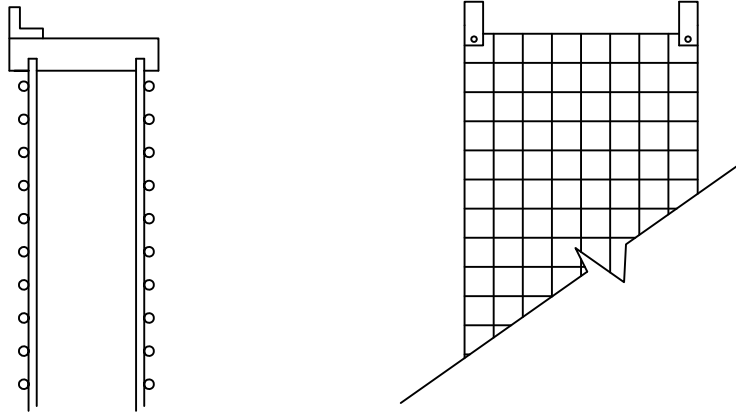

Step 5

Count down 6 holes from the top and attach a left and right connector. Then count 6 holes up from the bottom and attach a left and right connector.

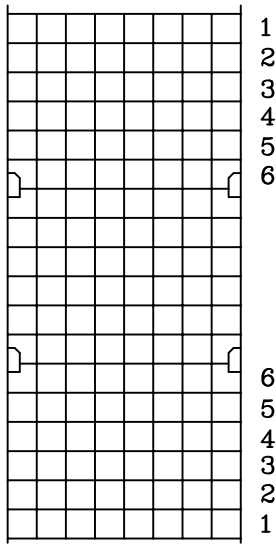

Step 6

Holding the racks against the wall, use a phillips head screwdriver to mark the location of the angle brackets. Mark the location by pushing the screwdriver through the hole in the angle bracket. Mark all holes where angle brackets are. You should have six hole locations marked when done.

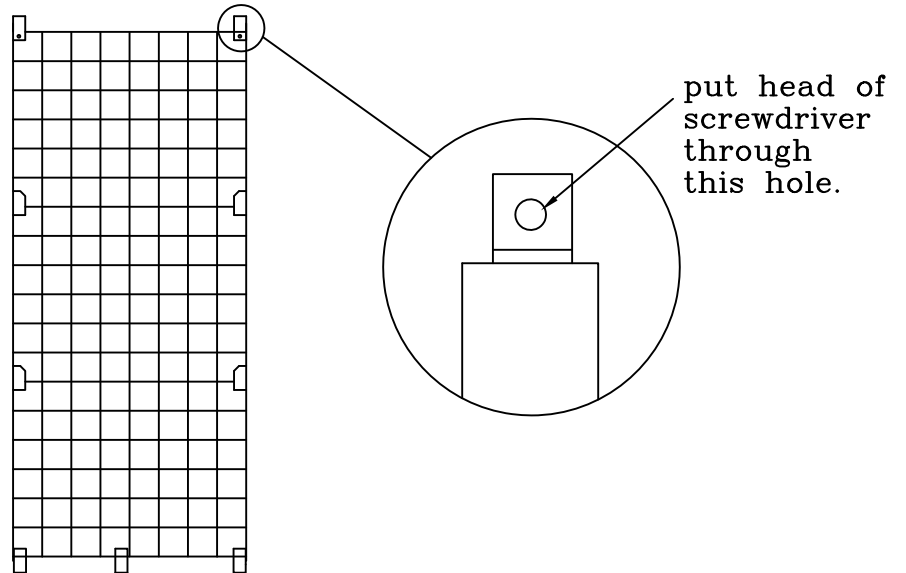

Step 7

Remove the racks from the area and use a 1/4" drill bit to drill a hole in all six locations you marked.

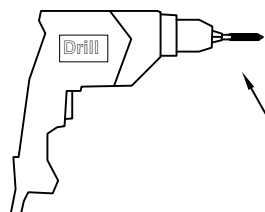

1/4" drill bit

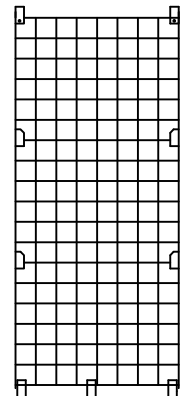
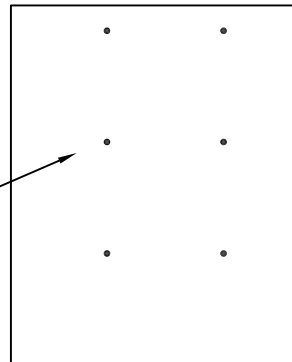

Step 8

Put 1 drywall anchor into each hole that you have drilled.

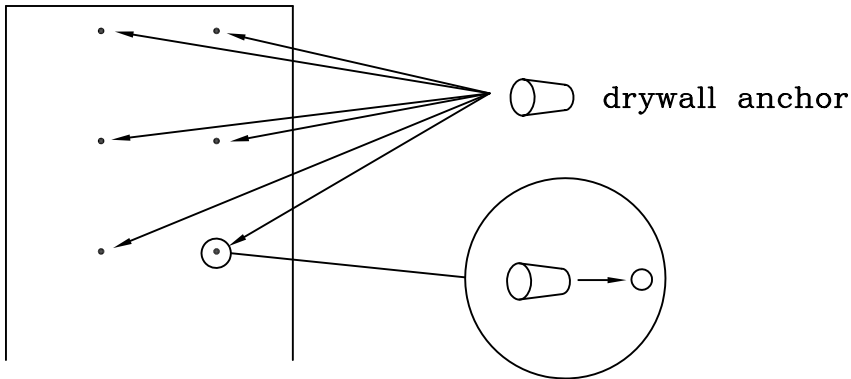

Step 9

Return the rack to the original position and line up the holes in the angle brackets with the holes in the drywall anchors.

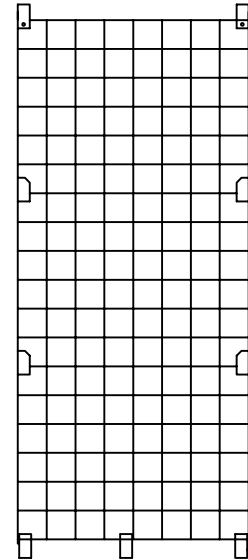

Step 10

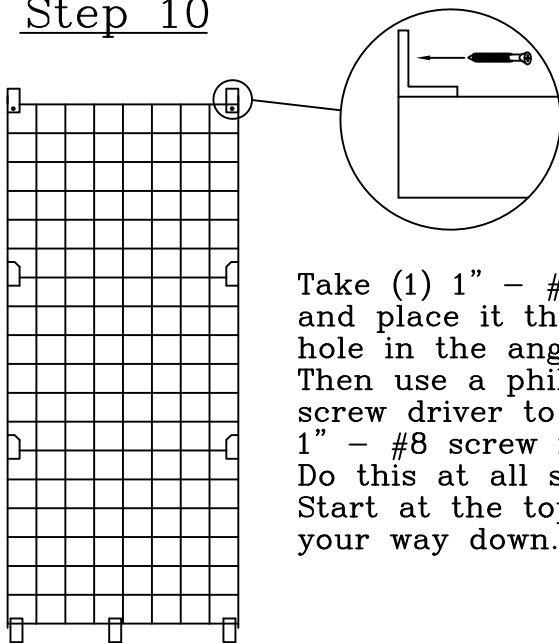

Take (1) 1" - #8 screw and place it through the hole in the angle bracket. Then use a phillips head (+) screw driver to screw the 1" - #8 screw into place. Do this at all six locations. Start at the top and work your way down.

Step 12

Now your rack is ready to be filled with wine and prepare for a life time of enjoyment. As advertised your rack will hold any standard burgundy or bordeaux bottle. Larger bottles are to be placed on top.

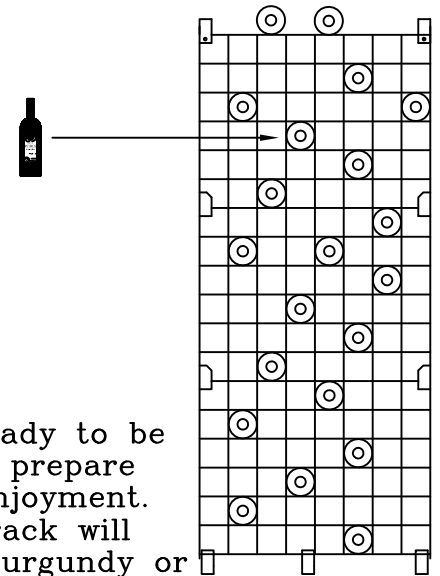

Step 11

Lock on top connector by sliding pin nail into hole on front of connector.

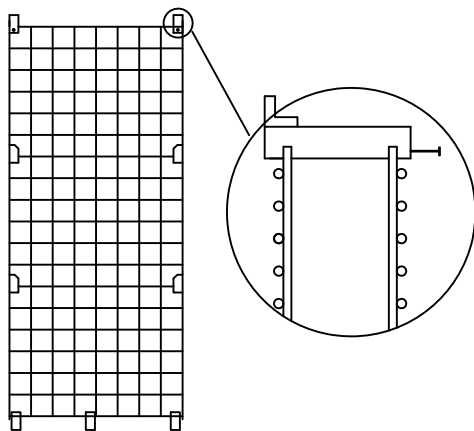

Please Note

Warranty does not cover racks placed on carpet. The nailer that is use on wall to wall carpeting causes the back of the bottom connector to sit higher than the front. This causes the rack to tilt forward.

